

PROJECT DATA			
Total Area (Right-Of-Way)	120 Ac	Runoff Coefficient for Pre-Construction Site	0.3-0.6
Project Earth Disturbed Area	106 Ac	Runoff Coefficient for Post Construction Site	0.7
Estimated Contractor Earth Disturbed Area	7 Ac	Post Construction BMP: Vegetated biofilters were provided to meet NPDES post-construction requirements. See cross section sheets for locations.	
Notice of Intent Earth Disturbed Area	113 Ac	Immediate Receiving Waters	Pee Pee Creek
Impervious (Paved) Area for Pre-Construction Site	10 Ac	Subsequent Receiving Water	Scioto River
Impervious (Paved) Area for Post Construction Site	40 Ac		

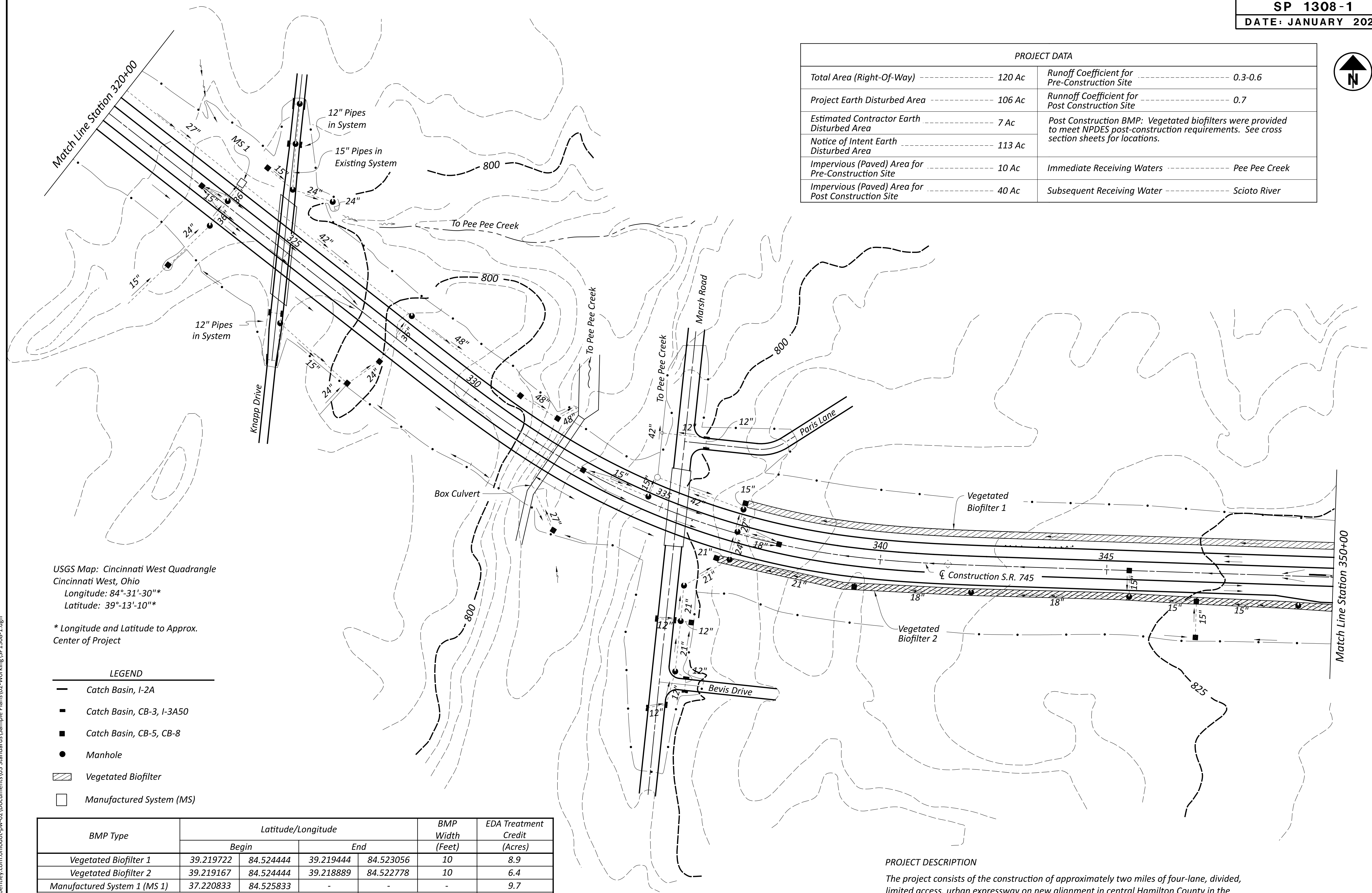

USGS Map: Cincinnati West Quadrangle  
Cincinnati West, Ohio  
Longitude: 84°-31'-30"\*  
Latitude: 39°-13'-10"\*

\* Longitude and Latitude to Approx. Center of Project

**LEGEND**

- Catch Basin, I-2A
- Catch Basin, CB-3, I-3A50
- Catch Basin, CB-5, CB-8
- Manhole
- ▨ Vegetated Biofilter
- Manufactured System (MS)

BMP Type	Latitude/Longitude				BMP Width (Feet)	EDA Treatment Credit (Acres)
	Begin		End			
Vegetated Biofilter 1	39.219722	84.524444	39.219444	84.523056	10	8.9
Vegetated Biofilter 2	39.219167	84.524444	39.218889	84.522778	10	6.4
Manufactured System 1 (MS 1)	37.220833	84.525833	-	-	-	9.7
					Treatment Provided	25.0
					Treatment Required*	24.4

\* Calculated per L&D Vol. 2, Sec. 1111.7

**PROJECT DESCRIPTION**

The project consists of the construction of approximately two miles of four-lane, divided, limited access, urban expressway on new alignment in central Hamilton County in the Cincinnati Metropolitan area. The highway has an east-west orientation beginning 300 feet west of Clovernoll Drive, ending 2,800 feet east of Sawmill Road. There is one interchange at Sawmill Road.

HAM-745-18.36

MODEL: SP1308-1.PAPER SIZE: 34x22 (in.) DATE: 1/17/2025 TIME: 8:00:00 AM  
pw:\ohiodot-pw.bentley.com\ohiodot-pw-02\Documents\03\_Standards\Sample Plans\02-Working\SP1308-1.dgn

PROJECT SITE PLAN  
STA. 320+00 TO STA. 350+00

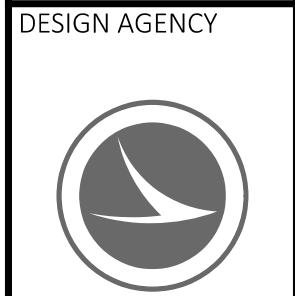

DESIGN AGENCY  
DESIGNER: JOH  
REVIEWER: JDH  
PROJECT ID: 130801  
SHEET: P.40 TOTAL: 484