

CROSS REFERENCES	
SHEET NO.	DESCRIPTION
P.3-P.4	☐ REFERENCES & BENCHMARKS
P.37	PROFILE
P.38	ESTIMATED QUANTITIES
P.79	DRIVE DETAILS AND QUANTITIES
P.86	CULVERT DETAIL AND QUANTITIES
P.92	INTERSECTION DETAIL

CLI-67-16.86

MODEL: SP1309-2, PAPER SIZE: 34x22 (in.), DATE: 1/17/2025, TIME: 8:00:00 AM
 pw:\ohiodot-pw\entire\com\ohiodot-pw-02\Documents\03_Standards\Sample Plans\SP1309-2.dgn

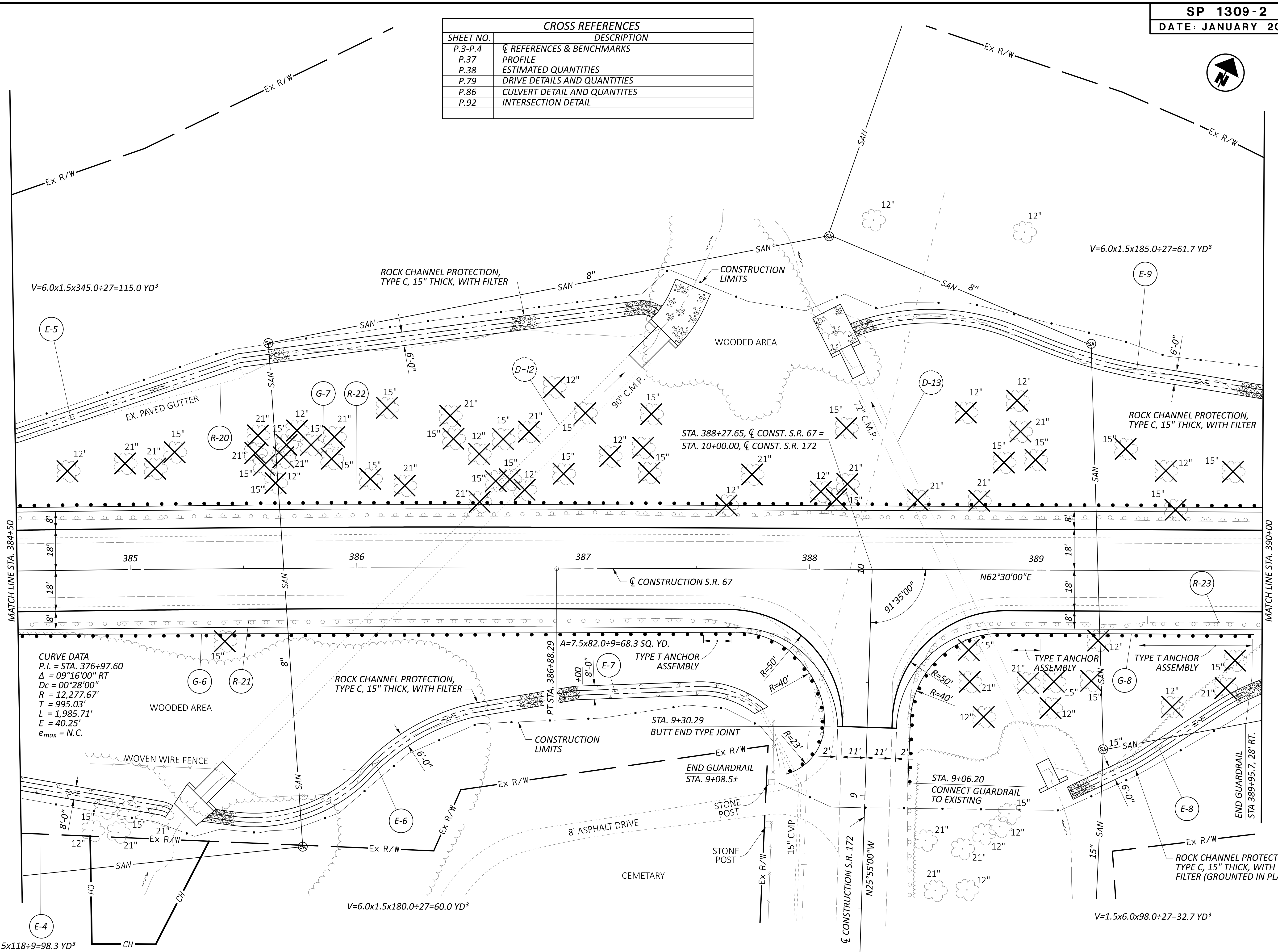

$V=6.0 \times 1.5 \times 345.0 \div 27 = 115.0 \text{ YD}^3$

$V=6.0 \times 1.5 \times 185.0 \div 27 = 61.7 \text{ YD}^3$

CURVE DATA
 P.I. = STA. 376+97.60
 $\Delta = 09^\circ 16' 00'' \text{ RT}$
 $D_c = 00^\circ 28' 00'' \text{ RT}$
 $R = 12,277.67'$
 $T = 995.03'$
 $L = 1,985.71'$
 $E = 40.25'$
 $e_{max} = \text{N.C.}$

$A = 7.5 \times 82.0 \div 9 = 68.3 \text{ SQ. YD.}$

$V=6.0 \times 1.5 \times 180.0 \div 27 = 60.0 \text{ YD}^3$

$V=1.5 \times 6.0 \times 98.0 \div 27 = 32.7 \text{ YD}^3$

PLAN - S.R. 67
 STA. 384+50 TO STA. 390+00

DESIGN AGENCY	Jane C. Smith Consulting, Inc. 9909 English Drive Columbiana, Ohio 43008
DESIGNER	MJG
REVIEWER	DSN 01/17/25
PROJECT ID	130902
SHEET	P.36
TOTAL	97