



UPS:  
UPS:  
UPS:  
UPS:  
UPS:



Safety Reminders / Adverse Conditions

?: THIS WORK RELOCATES SOUTH OAKLEY 54 FOR NEW ODOT BIKE PATH AND RETAINING WALL WORK. HEAVY TRAFFIC AND HIGHWAY CROSSINGS. STEEP SLOPES, WATCH YOUR FOOTING



FLAGGING REQUIRED. SHORT TERM HIGHWAY SHUTDOWN TO REMOVE OLD WIRES AND RUN NEW WIRES ACROSS. SEE ODOT PERMIT FOR REQUIREMENTS

REMEMBER: Work zone area conditions may have changed for this job! Everyone is responsible for verifying the above safety information is correct prior to any work being performed each day.

NOTE: SPECTRUM ALSO ON THIS POLE LINE AND NEEDING TO RELOCATE

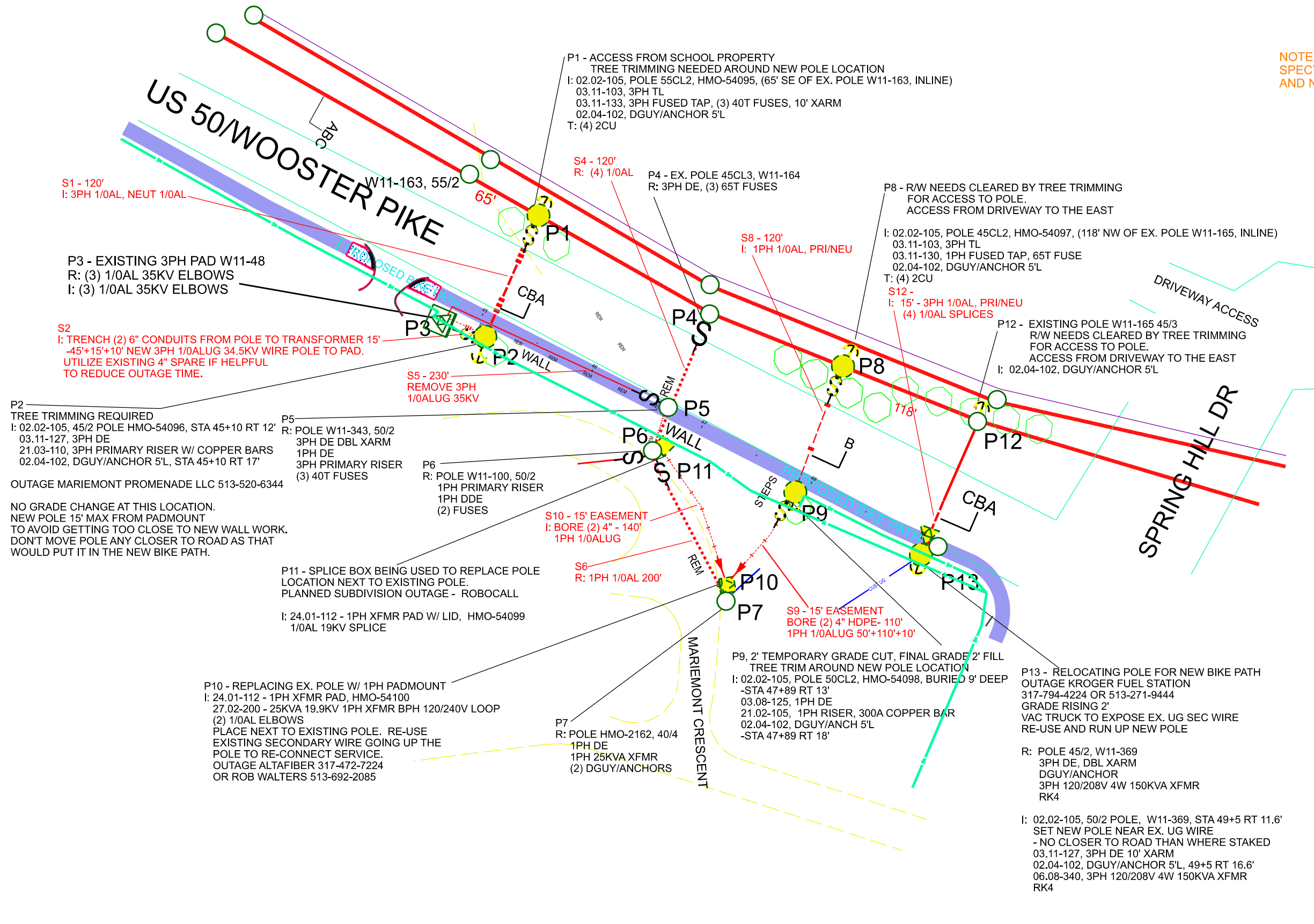

**P1 - ACCESS FROM SCHOOL PROPERTY**  
TREE TRIMMING NEEDED AROUND NEW POLE LOCATION  
I: 02.02-105, POLE 55CL2, HMO-54095, (65' SE OF EX. POLE W11-163, INLINE)  
03.11-103, 3PH TL  
03.11-133, 3PH FUSED TAP, (3) 40T FUSES, 10' XARM  
02.04-102, DGUY/ANCHOR 5'L  
T: (4) 2CU

**P3 - EXISTING 3PH PAD W11-48**  
R: (3) 1/0AL 35KV ELBOWS  
I: (3) 1/0AL 35KV ELBOWS

**S2**  
I: TRENCH (2) 6" CONDUITS FROM POLE TO TRANSFORMER 15' -45'+15'+10' NEW 3PH 1/0ALUG 34.5KV WIRE POLE TO PAD. UTILIZE EXISTING 4" SPARE IF HELPFUL TO REDUCE OUTAGE TIME.

**P2**  
TREE TRIMMING REQUIRED  
I: 02.02-105, 45/2 POLE HMO-54096, STA 45+10 RT 12'  
03.11-127, 3PH DE  
21.03-110, 3PH PRIMARY RISER W/ COPPER BARS  
02.04-102, DGUY/ANCHOR 5'L, STA 45+10 RT 17'

**P5**  
R: POLE W11-343, 50/2  
3PH DE DBL XARM  
1PH DE  
3PH PRIMARY RISER  
(3) 40T FUSES

OUTAGE MARIEMONT PROMENADE LLC 513-520-6344

NO GRADE CHANGE AT THIS LOCATION. NEW POLE 15' MAX FROM PADMOUNT TO AVOID GETTING TOO CLOSE TO NEW WALL WORK. DON'T MOVE POLE ANY CLOSER TO ROAD AS THAT WOULD PUT IT IN THE NEW BIKE PATH.

**P11 - SPLICE BOX BEING USED TO REPLACE POLE LOCATION NEXT TO EXISTING POLE.**  
PLANNED SUBDIVISION OUTAGE - ROBOCALL

I: 24.01-112 - 1PH XFMR PAD W/ LID, HMO-54099  
1/0AL 19KV SPLICE

**P10 - REPLACING EX. POLE W/ 1PH PADMOUNT**  
I: 24.01-112 - 1PH XFMR PAD, HMO-54100  
27.02-200 - 25KVA 19.9KV 1PH XFMR BPH 120/240V LOOP  
(2) 1/0AL ELBOWS  
PLACE NEXT TO EXISTING POLE. RE-USE EXISTING SECONDARY WIRE GOING UP THE POLE TO RE-CONNECT SERVICE.  
OUTAGE ALTA FIBER 317-472-7224 OR ROB WALTERS 513-692-2085

**P7**  
R: POLE HMO-2162, 40/4  
1PH DE  
1PH 25KVA XFMR  
(2) DGUY/ANCHORS

**P9, 2' TEMPORARY GRADE CUT, FINAL GRADE 2' FILL**  
TREE TRIM AROUND NEW POLE LOCATION  
I: 02.02-105, POLE 50CL2, HMO-54098, BURIED 9' DEEP  
-STA 47+89 RT 13'  
03.08-125, 1PH DE  
21.02-105, 1PH RISER, 300A COPPER BAR  
02.04-102, DGUY/ANCH 5'L  
-STA 47+89 RT 18'

**P13 - RELOCATING POLE FOR NEW BIKE PATH**  
OUTAGE KROGER FUEL STATION 317-794-4224 OR 513-271-9444  
GRADE RISING 2'  
VAC TRUCK TO EXPOSE EX. UG SEC WIRE RE-USE AND RUN UP NEW POLE

R: POLE 45/2, W11-369  
3PH DE, DBL XARM  
DGUY/ANCHOR  
3PH 120/208V 4W 150KVA XFMR  
RK4

I: 02.02-105, 50/2 POLE, W11-369, STA 49+5 RT 11.6'  
SET NEW POLE NEAR EX. UG WIRE  
- NO CLOSER TO ROAD THAN WHERE STAKED  
03.11-127, 3PH DE 10' XARM  
02.04-102, DGUY/ANCHOR 5'L, 49+5 RT 16.6'  
06.08-340, 3PH 120/208V 4W 150KVA XFMR  
RK4

Work Order Number	57446916
Customer/Contact	LUCAS BRAUN ODOT
Contact Phone	513-478-7769
Job Site Address	7385 WOOSTER PIKE (US 50)
City	CINCINNATI
County	HAMILTON
State, Zip	OH, 45227
Designer	SHANE ERHART
Designer Phone	513-508-9609
<b>OAKLEY 54</b>	
Circuit ID	
Primary Voltage	19.9/34.5 KV
Permit Required	Yes <input checked="" type="checkbox"/> No <input type="checkbox"/>
Permit Type/No. 1	ODOT
Permit Type/No. 2	
Permit Type/No. 3	
Permit Type/No. 4	