

TO ALLOW ACCESS FROM DRIVEWAYS OVER SPLITTER ISLAND, PROVIDE VERTICAL TAPERS AS SPECIFIED:
 (SOUTH LEG) 2" HEIGHT FROM STA. 41+40 TO 42+38, TAPER FROM 2" TO 6" FROM STA. 42+38 TO 42+48
 (NORTHEAST LEG) TAPER FROM 6" TO 2" FROM STA. 171+69 TO 171+79, 2" HEIGHT FROM STA. 171+79 TO 172+19
 (NORTHWEST LEG) TAPER FROM 6" TO 2" FROM STA. 43+86 TO 43+96, 2" HEIGHT FROM STA. 43+96 TO 44+28

LEGEND

- 10 ITEM 204: SUBGRADE COMPACTION AND PROOF ROLLING
- 1b ITEM 204: GEOTEXTILE FABRIC
- 2 ITEM 204: 12" EXCAVATION OF SUBGRADE, GRANULAR MATERIAL TYPE B
- 2a ITEM 254: 3" PAVEMENT PLANING, ASPHALT CONCRETE
- 3 ITEM 301: 6" ASPHALT CONCRETE BASE, PG64-22, (449)
- 4 ITEM 304: 4" AGGREGATE BASE
- 5 ITEM 407: NON-TRACKING TACK COAT (@0.05 GAL/SY)
- 6 ITEM 407: NON-TRACKING TACK COAT (@0.075 GAL/SY)
- 7 ITEM 441: 1.5" ASPHALT CONCRETE INTERMEDIATE COURSE, TYPE 1, (449), PG64-22
- 8 ITEM 442: 1.5" ASPHALT CONCRETE SURFACE COURSE, 12.5 MM, TYPE A (446), PG70-22
- 9 ITEM 442: 1.5" ASPHALT CONCRETE INTERMEDIATE COURSE, 12.5 MM, TYPE A (446) PG64-22
- 10 ITEM 442: 1.5" ASPHALT CONCRETE SURFACE COURSE, 12.5 MM, TYPE A (449), PG70-22
- 11 ITEM 451: REINFORCED CONCRETE PAVEMENT, MISC.: 9" TRUCK APRON, STAMPED AND STAINED
- 12 ITEM 605: 6" BASE PIPE UNDERDRAIN
- 13 ITEM 609: CURB, TYPE 6
- 14 ITEM 609: COMBINATION CURB AND GUTTER, TYPE 9
- 15 ITEM 609: 9" CONCRETE TRAFFIC ISLAND
- 16 ITEM 659: SEEDING AND MULCHING
- A ITEM 202: EXISTING PAVEMENT TO BE REMOVED, UNKNOWN THICKNESS
- B ITEM 202: EXISTING CURB TO BE REMOVED

TYPICAL SECTION

DESIGN AGENCY	AAH
DESIGNER	AAH
REVIEWER	KLL 05/01/26
PROJECT ID	116547
SHEET	TOTAL
05	86

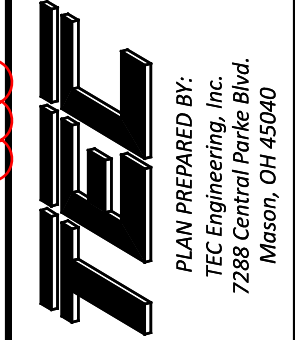

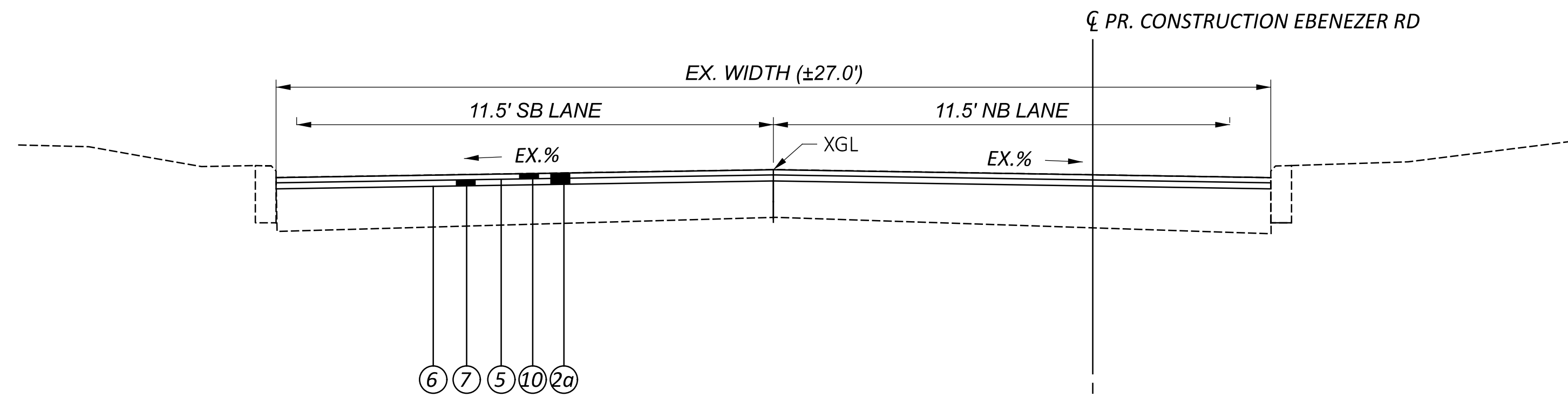

PR. EBENEZER CONSTRUCTION - RESURFACING SECTION
 STA. 29+90.00 TO STA. 40+58.70

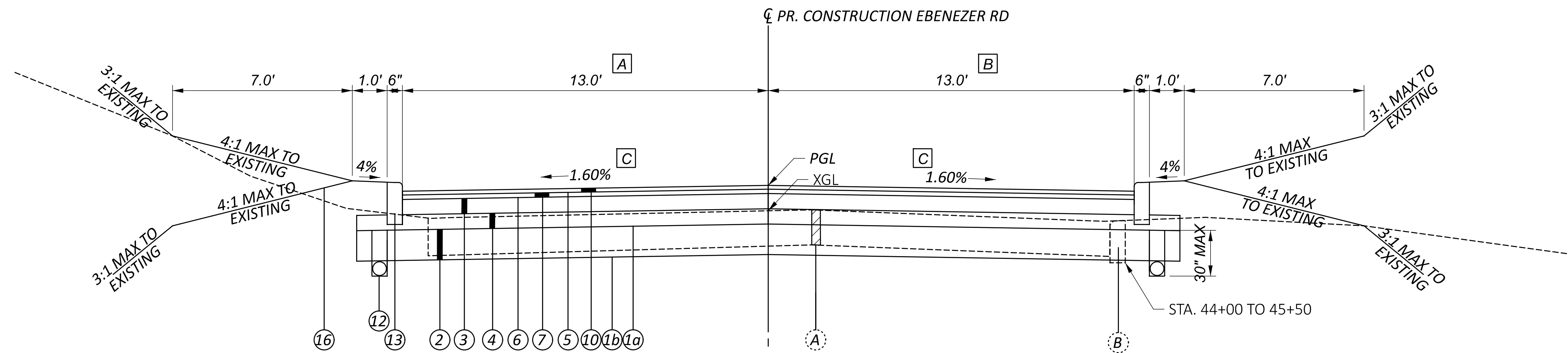

PR. EBENEZER CONSTRUCTION - NORMAL SECTION
 STA. 40+58.70 TO 41+39.72
 STA. 44+28.06 TO 47+40.00

- A** PR. EOP TAPER: 13.0' TO 17.2' FROM STA. 41+00.00 TO 41+39.72
 PR. EOP TAPER: 20.7' TO 13.0' FROM STA. 44+28.06 TO 45+85.00
- B** PR. EOP TAPER: 13.0' TO 11.5' (MEET EX. EOP) FROM STA. 47+00.00 TO 47+40.00
 PR. EOP TAPER: 12.0' (MEET EX. EOP) TO 13.0' FROM STA. 40+58.70 TO 40+85.00
 PR. EOP TAPER: 13.0' TO 15.6' FROM STA. 40+85.00 TO 41+39.72
- C** PR. EOP TAPER: 18.0' TO 13.0' FROM STA. 44+28.06 TO 45+85.00
 PR. EOP TAPER: 13.0' TO 13.6' (MEET EX. EOP) FROM STA. 47+00.00 TO 47+40.00
 CROSS SLOPE VARIES AT SPLITTER ISLAND, SEE INTERSECTION DETAILS
 1.60% FROM STA. 40+58.70 TO 41+00.00
 1.60% FROM STA. 45+41.74 TO 47+40.00

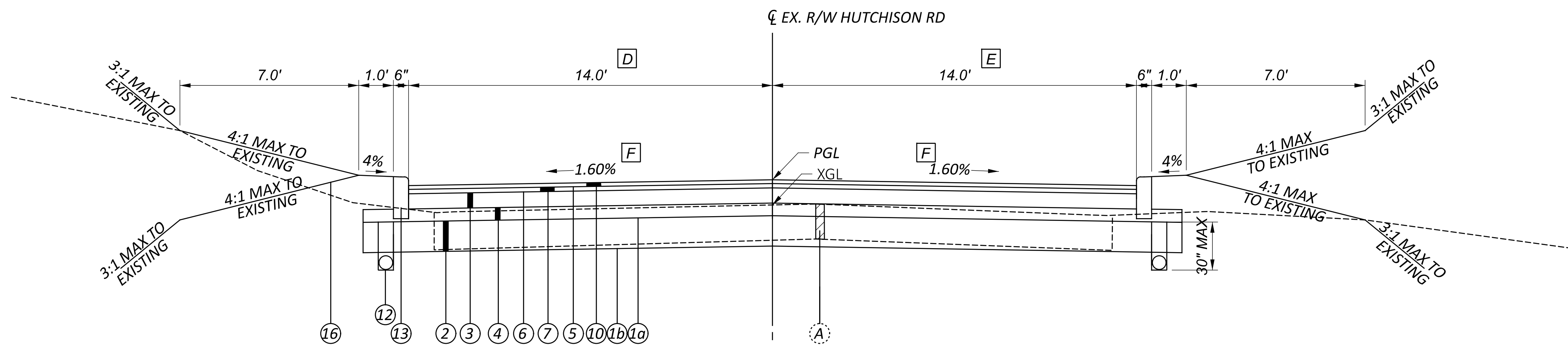

EX. HUTCHINSON RW - NORMAL SECTION
 STA. 172+47.56 TO 173+22.00

- D** PR. EOP TAPER: 14.0' TO 12.7' (MEET EX. EOP) FROM STA. 172+72.00 TO 173+22.00
- E** PR. EOP TAPER: 12.8' TO 10.2' (MEET EX. EOP) FROM STA. 172+72.00 TO 173+22.00
- F** CROSS SLOPE VARIES AT SPLITTER ISLAND, SEE INTERSECTION DETAILS
 1.60% FROM STA. 172+47.56 TO 173+22.00

- 10 ITEM 204: SUBGRADE COMPACTION AND PROOF ROLLING
- 1b ITEM 204: GEOTEXTILE FABRIC
- 2 ITEM 204: 12" EXCAVATION OF SUBGRADE, GRANULAR MATERIAL TYPE B
- 2a ITEM 254: 3" PAVEMENT PLANING, ASPHALT CONCRETE
- 3 ITEM 301: 6" ASPHALT CONCRETE BASE, PG64-22, (449)
- 4 ITEM 304: 4" AGGREGATE BASE
- 5 ITEM 407: NON-TRACKING TACK COAT (@0.05 GAL/SY)
- 6 ITEM 407: NON-TRACKING TACK COAT (@0.075 GAL/SY)
- 7 ITEM 441: 1.5" ASPHALT CONCRETE INTERMEDIATE COURSE, TYPE 1 (449), PG64-22
- 8 ITEM 442: 1.5" ASPHALT CONCRETE SURFACE COURSE, 12.5 MM, TYPE A (446), PG70-22
- 9 ITEM 442: 1.5" ASPHALT CONCRETE INTERMEDIATE COURSE, 12.5 MM, TYPE A (446) PG64-22
- 10 ITEM 442: 1.5" ASPHALT CONCRETE SURFACE COURSE, 12.5 MM, TYPE A (449), PG70-22
- 11 ITEM 451: REINFORCED CONCRETE PAVEMENT, MISC.: 9" TRUCK APRON, STAMPED AND STAINED
- 12 ITEM 605: 6" BASE PIPE UNDERDRAIN
- 13 ITEM 609: CURB, TYPE 6
- 14 ITEM 609: COMBINATION CURB AND GUTTER, TYPE 9
- 15 ITEM 609: 9" CONCRETE TRAFFIC ISLAND
- 16 ITEM 659: SEEDING AND MULCHING
- A ITEM 202: EXISTING PAVEMENT TO BE REMOVED, UNKNOWN THICKNESS
- B ITEM 202: EXISTING CURB TO BE REMOVED

ITEM 202 - REMOVE, MISC.: REMOVE EX. STORM STRUCTURE

THIS ITEM INCLUDES EQUIPMENT, MATERIAL AND LABOR TO REMOVE AND DISPOSE THE EXISTING STORM CONCRETE LID AND STRUCTURE NEAR STA. 47+30, LEFT OF THE CENTERLINE. THE SLOPE WILL BE GRADED TO DRAIN TOWARDS THE CURB LINE TO ELIMINATE DRIVE PIPES. THIS WORK INCLUDES REMOVING THE STRUCTURE AND CONNECTING PIPES AND FILLING WITH EMBANKMENT. THE GRADED SURFACE WILL CONSIST OF 4" OF TOPSOIL AND SEEDING AND MULCHING.

ANY WORK, LABOR, EQUIPMENT OR MATERIAL RELATED TO THE REMOVAL IS INCLUDED IN THE BID PRICE FOR ITEM 202 - REMOVE, MISC.: REMOVE EX. STORM STRUCTURE

ITEM 202 - REMOVE, MISC.: REMOVE EX. WOODEN RETAINING WALL

THIS ITEM INCLUDES EQUIPMENT, MATERIAL AND LABOR TO REMOVE THE WOODEN RETAINING WALL LOCATED AT 3880 EBENEZER ROAD NEAR STA. 41+60. THE CONTRACTOR SHALL COORDINATE WITH THE PROPERTY OWNER THE REMOVAL OF THE WOODEN RETAINING WALL. IF THE PROPERTY OWNER WOULD LIKE TO KEEP THE MATERIAL, THE CONTRACTOR SHALL PLACE THE MATERIAL ON THE PROPERTY OUTSIDE OF RIGHT-OF-WAY. IF THE OWNER DOES NOT WANT TO KEEP THE MATERIAL, THE CONTRACTOR SHALL DISPOSE OF THE MATERIAL. MATERIAL INCLUDES BUT IS NOT LIMITED TO THE WOODEN PLANKS, LANDSCAPE BORDER BRICKS, POST CAPS, AND ROCKS. ONCE REMOVED, THE CONTRACTOR SHALL GRADE TO THE RIGHT-OF-WAY LINE AT A 4:1 MAX SLOPE. THE GRADED SURFACE SHALL HAVE 4" OF TOPSOIL AND SEEDING AND MULCHING.

ANY WORK, LABOR, EQUIPMENT OR MATERIAL RELATED TO THE REMOVAL IS INCLUDED IN THE BID PRICE FOR ITEM 202 - REMOVE, MISC.: REMOVE EX. WOODEN RETAINING WALL.

ITEM 202 - REMOVE, MISC.: EX. TANK, RECONSTRUCTED

THIS ITEM INCLUDES EQUIPMENT, MATERIAL AND LABOR TO REMOVE THE EXISTING SEPTIC OUTLET SYSTEM AND RECONSTRUCT THE CHLORINATOR TANK TO GRADE AND LOCATED OUTSIDE OF R/W. THE PIPE OUTLET IS TO BE LOCATED 10' WITHIN THE PROPERTY LINES. THIS SYSTEM CAN BE FOUND NEAR STA. 45+40 TO THE LEFT OF THE CENTERLINE.

THE SYSTEM IS TO BE ADJUSTED SO THAT THE OUTLET OF THE SYSTEM DRAINS TOWARDS THE PROPOSED DITCH AT STA. 45+28.0, 22.0' LT. THE DITCH WILL THEN DRAIN INTO THE PROPOSED CATCH BASIN, D30.

PERMITTING FEES ARE INCIDENTAL TO THIS ITEM. AN ALTERATION PERMIT WILL BE REQUIRED.

ANY WORK, LABOR, EQUIPMENT OR MATERIAL RELATED TO THE ADJUSTMENT IS INCLUDED IN THE BID PRICE FOR ITEM 202 - REMOVE, MISC.: EX. TANK, RECONSTRUCTED

ITEM 204 - PROOF ROLLING

THE FOLLOWING QUANTITY IS PROVIDED IN THE GENERAL SUMMARY TO ADDRESS LOCATIONS REQUIRING PROOF ROLLING. SEE PLAN SHEET NO. 5 FOR ADDITIONAL INFORMATION.

ITEM 204 - PROOF ROLLING 2 HOUR.

ITEM 451 - REINFORCED CONCRETE PAVEMENT, MISC.: 9" TRUCK APRON, STAMPED AND STAINED

THIS ITEM INCLUDES MATERIAL AND LABOR TO PLACE THE REQUIRED CONCRETE FOR THE ROUNDABOUT TRUCK APRON. THIS ITEM IS TO BE AN INTEGRAL DARK GREY COLORED CONCRETE. THE CONCRETE SHALL HAVE A STAMPED SURFACE IN A COBBLESTONE PATTERN. THIS ITEM SHALL ALSO INCLUDE ALL LABOR AND MATERIAL TO FURNISH AN ON-SITE SAMPLE OF A 5'x5' FOR APPROVAL AND QUALITY CONTROL. THE SAMPLE MUST BE APPROVED BY THE ENGINEER PRIOR TO CONSTRUCTION OF THE TRUCK APRON.

ITEM 611 - CATCH BASIN, MISC.: CB/MH PER HCEO

THIS ITEM INCLUDES EQUIPMENT, MATERIAL AND LABOR TO INSTALL A COMBINATION CB-3A/MH-3 AT PER HAMILTON COUNTY ENGINEER'S OFFICE STANDARDS AT STA. 43+30.0, 59.4' LEFT OF THE CENTERLINE.

ANY WORK, LABOR, EQUIPMENT OR MATERIAL RELATED TO THE ADJUSTMENT IS INCLUDED IN THE BID PRICE FOR ITEM 611 - CATCH BASIN, MISC.: CB/MH PER HCEO

HCEO STORMWATER PLATES CAN BE FOUND AT THE WEBSITE BELOW:
https://cms2.revize.com/revize/hamiltoncountyoh/Documents/Government/Departments/Planning%20and%20Development/Stormwater%20and%20Infrastructure/Regulations/Download%20save%20to%20your%20computer%20for%20printing/SDS_PLATES.pdf?t=202502261002420&t=202502261002420

ITEM 625 - PULL BOX, MISC.: EX. TELECOM PULL BOX, ADJUSTED TO GRADE

THIS ITEM INCLUDES EQUIPMENT, MATERIAL AND LABOR TO ADJUST THE EXISTING TELECOM PULL BOX TO GRADE. IT CAN BE FOUND NEAR STA. 40+70 TO THE LEFT OF THE CENTERLINE.

ANY WORK, LABOR, EQUIPMENT OR MATERIAL RELATED TO THE ADJUSTMENT IS INCLUDED IN THE BID PRICE FOR ITEM 202 - REMOVE, MISC.: EX. TELECOM PULL BOX, ADJUSTED TO GRADE

ITEM 661 - PLANTING, MISC.: EX. LANDSCAPING BED, REMOVE AND REPLACE IN KIND

THIS ITEM INCLUDES MATERIAL AND LABOR REMOVE AND REPLACE, AS NEEDED, THE LANDSCAPING BED LOCATED AT 3881 EBENEZER RD. THE CONTRACTOR SHALL COORDINATE WITH THE PROPERTY OWNER THROUGH THE TOWNSHIP TO DETERMINE DESIRED REPLACEMENT PLANTS. ANY DISTURBED PORTIONS OF THE STONE RETAINING WALL SHALL BE REPLACED WITH MATCHING STONE. PRIOR TO ANY WORK, THE CONTRACTOR MUST HAVE WRITTEN APPROVAL BY THE TOWNSHIP.

IT IS ESTIMATED THAT 8 ORNAMENTAL GRASSES AND 10 SHRUBS WILL BE DISTURBED AND REPLACED.

A CONTINGENCY OF \$1,200 IS INCLUDED IN THE PROJECT'S ESTIMATE TO COVER THE REPLACEMENT OF THE PLANTS.

ANY WORK, LABOR, EQUIPMENT OR MATERIAL RELATED TO THE REMOVAL AND REPLACEMENT OF THE LANDSCAPING BED IS INCLUDED IN THE BID PRICE FOR ITEM 661 - PLANTING MISC.: EX, LANDSCAPING BED, REMOVE AND REPLACE IN KIND.

D103 - ITEM SPECIAL - FILL AND PLUG EXISTING CONDUIT

THIS ITEM CONSISTS OF THE CONSTRUCTION OF BULKHEADS IN AN EXISTING 12 INCH DIAMETER CONDUIT AND FILLING THE AREA SEALED OFF WITH ITEM 613, SAND OR OTHER MATERIAL APPROVED BY THE ENGINEER.

LOCATE THE BULKHEADS AT THE LIMITS OF THE AREA TO BE FILLED, AS INDICATED ON THE PLANS. THE BULKHEADS CONSIST OF BRICK OR CONCRETE MASONRY WITH A MINIMUM THICKNESS OF 12 INCHES.

PUMP THE FILL MATERIAL INTO PLACE OR BY OTHER MEANS APPROVED BY THE ENGINEER, SO THAT AFTER SETTLEMENT, AT LEAST 90 PERCENT OF THE CROSS- SECTIONAL AREA OF THE CONDUIT, FOR ITS ENTIRE LENGTH IS FILLED. THE LENGTH OF FILLED AND PLUGGED CONDUIT TO BE PAID FOR IS THE ACTUAL NUMBER OF FEET (MEASURED ALONG THE CENTERLINE OF EACH CONDUIT FROM OUTER FACE TO OUTER FACE OF BULKHEADS) FILLED AND PLUGGED AS DESCRIBED ABOVE.

IN LIEU OF FILLING AND PLUGGING THE EXISTING CONDUIT, THE PIPE MAY BE CRUSHED AND BACKFILLED PER 203, OR IT MAY BE REMOVED. THE LENGTH, MEASURED AS PROVIDED ABOVE, WILL BE PAID FOR AT THE CONTRACT PRICE PER FOOT FOR, ITEM SPECIAL, FILL AND PLUG EXISTING CONDUIT.

GCWW WATER MAIN
 ALL 12" WATER SHOWN AS TBR WILL BE ABANDONED EXCEPT WHERE IT IS IN CONFLICT WITH EXCAVATION
 ALL 8" WATER SHOWN AS TBR WILL BE ABANDONED EXCEPT WHERE IT IS IN CONFLICT WITH EXCAVATION

DESIGN AGENCY

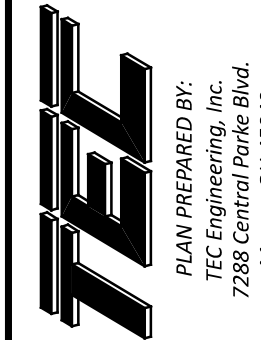

DESIGNER
AAH

REVIEWER
KLL 05/01/26

PROJECT ID
116547

SHEET TOTAL
09 | 86

ITEM 614, MAINTAINING TRAFFIC

A MINIMUM OF ONE LANE OF TRAFFIC IN EACH DIRECTION SHALL BE MAINTAINED AT ALL TIMES, EXCEPT FOR A PERIOD NOT TO EXCEED 75 CONSECUTIVE CALENDAR DAYS, WHEN THROUGH TRAFFIC MAY BE DETOURED AS SHOWN ON SHEET 10. A DISINCENTIVE SHALL BE ASSESSED IN THE AMOUNT OF \$13,687 PER DAY FOR EACH CALENDAR DAY THE ROADWAY REMAINS CLOSED TO TRAFFIC BEYOND THE SPECIFIED LIMIT.

IT IS THE INTENTION TO PERFORM THE REQUIRED WORK WITH THE LEAST INCONVENIENCE TO, AND THE MAXIMUM SAFETY OF, THE CONTRACTOR AND THE TRAVELING PUBLIC. ANY VARIANCES FROM THE INTENT OF THESE MAINTENANCE OF TRAFFIC NOTES MUST BE APPROVED IN ADVANCE IN WRITING BY THE ENGINEER. THE REQUIREMENTS FOR MAINTAINING TRAFFIC SHALL APPLY AS INDICATED IN THE OHIO MANUAL OF UNIFORM TRAFFIC CONTROL DEVICES FOR STREETS AND HIGHWAYS, CURRENT EDITION AND PERTINENT ITEMS OF SPECIFICATIONS.

THE CONTRACTOR WILL ADVISE THE TOWNSHIP AND HAMILTON COUNTY ENGINEER'S OFFICE A MINIMUM OF TWENTY-ONE (21) DAYS PRIOR TO THE START OF CONSTRUCTION ACTIVITIES. THE CONTRACTOR MUST ALSO PROVIDE NOTIFICATION TWENTY-ONE (21) DAYS PRIOR TO ANY DETOURS, LANE CLOSURES, DRIVEWAY CLOSURES OR ROAD CLOSURES. THE ENGINEER WILL FORWARD THE INFORMATION TO GREEN TOWNSHIP WHO WILL THEN PROVIDE WRITTEN NOTIFICATION TO LOCAL EMERGENCY SERVICES, AFFECTED SCHOOLS, AND BUSINESSES OF ANY UPCOMING PROJECT DETOURS OR CLOSURES.

TO MINIMIZE TRAFFIC IMPACTS, THE CLOSURE SHALL BEGIN DURING THE SUMMER FOR A TIME PERIOD NOT TO EXCEED 75 CONSECUTIVE DAYS.

BEFORE WORK BEGINS, THE CONTRACTOR SHALL SUBMIT TO THE TOWNSHIP AND HAMILTON COUNTY ENGINEER'S OFFICE THE NAMES AND TELEPHONE NUMBERS OF A PERSON OR PERSONS WHO CAN BE CONTACTED 24 HOURS PER DAY BY GREEN TOWNSHIP AND ALL INTERESTED POLICE AGENCIES. THIS PERSON OR PERSONS SHALL BE RESPONSIBLE FOR PLACING OR REPLACING NECESSARY TRAFFIC CONTROL DEVICES. IN ORDER TO PROVIDE A SAFE FACILITY FOR THE TRAVELING PUBLIC, THIS PERSON SHALL HAVE AVAILABLE ALL TOOLS AND MATERIAL NECESSARY TO PERFORM THIS FUNCTION AT ALL TIMES.

LENGTH AND DURATION OF CLOSURES AND RESTRICTIONS SHALL BE AT THE APPROVAL OF THE HAMILTON COUNTY ENGINEER'S OFFICE. IT IS THE INTENT TO MINIMIZE THE IMPACT TO THE TRAVELING PUBLIC. ROAD CLOSURES AND/OR RESTRICTIONS OVER SEGMENTS OF THE PROJECT IN WHICH NO WORK IS ANTICIPATED WITHIN A REASONABLE TIME FRAME, AS DETERMINED BY THE ENGINEER, SHALL NOT BE PERMITTED. NO CHANGES IN TRAFFIC CONTROL PATTERN OR TEMPORARY CLOSURES BY USE OF FLAGGERS SHALL BE MADE BETWEEN THE HOURS OF 6:00 AM TO 9:00 AM AND 3:00 PM TO 7:00 PM MONDAY THROUGH FRIDAY.

ACCESS TO ALL PROPERTY OWNERS SHALL BE MAINTAINED THROUGHOUT THE DURATION OF THIS PROJECT. CONSTRUCTION VEHICLES SHALL ALWAYS MOVE WITH AND NOT AGAINST THE FLOW OF TRAFFIC.

CONSTRUCTION VEHICLES AND EQUIPMENT SHALL NOT PARK OR STOP EXCEPT WITHIN DESIGNATED AREAS, AND SHALL ENTER AND LEAVE WORK AREAS IN A MANNER WHICH WILL NOT BE HAZARDOUS TO, OR INTERFERE WITH, THE NORMAL TRAFFIC FLOW. PERSONAL VEHICLES ARE NOT PERMITTED ON RIGHT-OF-WAY EXCEPT IN SPECIFIC AREAS DESIGNATED BY THE ENGINEER.

THE CONTRACTOR SHALL PROVIDE, ERECT AND MAINTAIN STANDARD 48X30 INCH "ROAD CLOSED" SIGNS, SIGN SUPPORTS, BARRICADES AND LIGHTS, AS DETAILED IN SCD MT-101.60 AT SPECIFIED LOCATIONS DURING PERIODS IN WHICH THE AFFECTED ROADS ARE CLOSED TO TRAFFIC.

ITEM 614, MAINTAINING TRAFFIC (CONT.)

DURING THE CLOSURE, TRAFFIC WILL BE ROUTED TO NEARBY ROADWAYS INCLUDING TAYLOR ROAD, RYBOLT RD, WESSELMAN RD, HARRISON AVE, FILVIEW CIR, RACE RD AND BRIDGETOWN RD. THE FOLLOWING PLAN SHOWS THE DESIGNATED ROUTES.

THE CONTRACTOR SHALL MAINTAIN ALL EXISTING DRAINAGE STRUCTURES WITHIN THE WORK AREA, AS DETERMINED BY THE ENGINEER, TO PROMOTE POSITIVE FLOW THROUGHOUT THE CONSTRUCTION PROJECT.

ALL AFFECTED UTILITIES SHALL BE PROTECTED OR RELOCATED PRIOR TO THE BEGINNING OF CONSTRUCTION FOR THIS PROJECT.

NOTICE OF CLOSURE SIGNS (W20-H13) SHALL BE ERECTED BY THE CONTRACTOR PRIOR TO THE SCHEDULED ROAD OR RAMP CLOSURE IN ACCORDANCE WITH THE NOTICE OF CLOSURE TIME TABLE BELOW.

THE SIGNS SHALL BE ERECTED ON THE RIGHT-HAND SIDE OF THE ROAD/RAMP FACING TRAFFIC. THEY SHALL BE PLACED SO AS NOT TO INTERFERE WITH THE VISIBILITY OF ANY OTHER TRAFFIC CONTROL SIGNS. ON ROADWAYS, THEY SHOULD BE ERECTED AT OR NEAR THE POINT OF CLOSURE. THE SIGNS MAY BE ERECTED ANYWHERE ON RAMPS AS LONG AS THEY ARE VISIBLE TO THE MOTORISTS USING THE RAMP. ON ENTRANCE RAMPS, THE SIGN SHALL BE ERECTED WELL IN ADVANCE OF THE MERGE AREA TO AVOID DISTRACTING MOTORISTS.

NOTICE OF CLOSURE SIGN TIME TABLE

ITEM	DURATION OF CLOSURE	SIGN DISPLAYED TO PUBLIC
RAMP & ROAD CLOSURES	>=2 WEEKS	14 CALENDAR DAYS PRIOR TO CLOSURE
	> 12 HOURS & < 2 WEEKS	7 CALENDAR DAYS PRIOR TO CLOSURE
	<= 12 HOURS	2 BUSINESS DAYS PRIOR TO CLOSURE

THE SIGN SHALL DISPLAY THE DATE OF THE CLOSURE IN MMM-DD FORMAT AND THE NUMBER OF DAYS OF THE CLOSURE. THE LAST LINE OF THE W20-H13 SIGN LISTS A PHONE NUMBER WHICH A MOTORIST MAY CALL FOR ADDITIONAL INFORMATION. THIS IS TO BE A SPECIFIC OFFICE WITHIN THE DISTRICT RATHER THAN THE GENERAL SWITCHBOARD NUMBER.

WINDOW CONTRACT

DESCRIPTION OF CRITICAL WORK	CALENDAR DAYS TO COMPLETE	DISINCENTIVE \$ PER DAY	WORK WINDOW	
			START	END
ALL WORK EXCEPT SURFACE COURSE ASPHALT, PERMANENT PAVEMENT MARKINGS AND RPMS.	75	\$13,687	07/01/26	09/30/26

LANE VALUE CONTRACT TABLE

DESCRIPTION OF CRITICAL LANE/RAMP TO BE MAINTAINED	RESTRICTED TIME PERIOD	TIME UNIT	DISINCENTIVE \$ PER TIME UNIT
EBENEZER RD HUTCHINSON RD	6AM-9AM MON-FRI 3PM-7PM MON-FRI	EACH HOUR	\$10,000

ITEM 614, MAINTAINING TRAFFIC (CONT.)

STANDARD 48 X 30 INCH ROAD CLOSED SIGNS, SIGN SUPPORTS, BARRICADES AND LIGHTS, AS DETAILED IN SCD MT-101.60 AT THE FOLLOWING LOCATIONS DURING PERIODS IN WHICH THE AFFECTED ROADS ARE CLOSED TO TRAFFIC.

- CR 128 EBENEZER RD - STA. 40+60
- CR 128 EBENEZER RD - STA. 47+50
- CR 161 HUTCHINSON RD - STA. 173+25

HUTCHINSON WILL BE CLOSED -----
FOR # DAYS
INFO: 513-574-4848

W20-H13-60

THE CONTRACTOR SHALL PROVIDE, ERECT AND MAINTAIN SIGNS AND SIGN SUPPORTS, AS DETAILED IN THE OHIO MANUAL OF UNIFORM TRAFFIC CONTROL DEVICES, AND TYPE III BARRICADES OF THE TYPE AND LOCATION AS FOLLOWS:

- CR 128 EBENEZER RD - STA. 40+60
- CR 128 EBENEZER RD - STA. 47+50
- CR 161 HUTCHINSON RD - STA. 173+25

THE CONTRACTOR SHALL PROVIDE, ERECT AND MAINTAIN SIGNS AND SIGN SUPPORTS, AS DETAILED IN THE OHIO MANUAL OF UNIFORM TRAFFIC CONTROL DEVICES, AND TYPE III BARRICADES OF THE TYPE AND LOCATION AS INDICATED ON THE MAINTENANCE OF TRAFFIC DETOUR MAP ON THE FOLLOWING PAGE OF THIS PLANSET. THE CONTRACTOR SHALL COVER ANY CONFLICTING MESSAGE THAT VARIES FROM THE DESIGNATED DETOUR PLAN. ANY CHANGES TO THE DETOUR PLAN MUST BE SUBMITTED FOR APPROVAL TO THE ENGINEER. DETOUR SIGNS, SUPPORTS AND BARRICADES ARE INCLUDED IN THE LUMP SUM PRICE FOR 614, DETOUR SIGNING.

ALL WORK AND TRAFFIC CONTROL DEVICES SHALL BE IN ACCORDANCE WITH C&MS 614 AND OTHER APPLICABLE PORTIONS OF THE SPECIFICATIONS, AS WELL AS THE OHIO MANUAL OF UNIFORM TRAFFIC CONTROL DEVICES. PAYMENT FOR ALL LABOR, EQUIPMENT AND MATERIALS SHALL BE INCLUDED IN THE LUMP SUM CONTRACT PRICE FOR ITEM 614, DETOUR SIGNING.

ITEM 614, MAINTAINING TRAFFIC, MISC.: TEMPORARY LIGHTING

THIS ITEM INCLUDES ALL MATERIALS, LABOR, AND EQUIPMENT REQUIRED TO PROVIDE, MAINTAIN, AND REMOVE TEMPORARY LIGHTING. THE CONTRACTOR SHALL PROVIDE LIGHTING WITHIN THE PROJECT AREA, SPECIFICALLY AT THE ROUNDABOUT AFTER THE CLOSURE ENDS, UNTIL DUKE ENERGY'S PERMANENT LIGHTING IS FULLY INSTALLED AND OPERATIONAL.

PRIOR TO INSTALLATION, THE CONTRACTOR MUST SUBMIT FOUR SETS OF A TEMPORARY LIGHTING PLAN TO THE ENGINEER FOR REVIEW AND APPROVAL. THIS PLAN SHALL SHOW THE POLE LOCATIONS, WHICH SHOULD BE IN THE APPROXIMATE LOCATION OF THE PERMANENT LIGHTING AS INDICATED IN THE LIGHTING PLAN ON SHEET 70, ALONG WITH BRACKET ARM LENGTHS, LUMINAIRE STYLES, MOUNTING HEIGHTS, AND WIRING METHODS. THE TEMPORARY LIGHTING MUST PROVIDE AN AVERAGE INITIAL INTENSITY OF 1.2 FOOTCANDLES WITH AN AVERAGE TO MINIMUM UNIFORMITY NOT EXCEEDING 3:1. THE MOUNTING HEIGHT FOR LUMINAIRES SHALL NOT BE LESS THAN 30 FEET, AND A MINIMUM OVERHEAD CONDUCTOR CLEARANCE OF 20 FEET MUST BE MAINTAINED.

ALL TEMPORARY OVERHEAD CONSTRUCTION MUST MEET AT LEAST GRADE "B" STRENGTH REQUIREMENTS AS DEFINED BY THE NATIONAL ELECTRIC SAFETY CODE AND ADHERE TO ALL FEDERAL AND STATE SAFETY CRITERIA.

THE CONTRACTOR IS RESPONSIBLE FOR FURNISHING AND INSTALLING ALL NECESSARY COMPONENTS, INCLUDING WOOD POLES. ALL WORK MUST BE COORDINATED WITH MITCH EBERNEZ OF DUKE ENERGY LIGHTING (PH: 513-287-1480). ONCE THE PERMANENT LIGHTING IS FUNCTIONAL, THE CONTRACTOR SHALL REMOVE THE TEMPORARY INSTALLATION AND RESTORE ANY DAMAGED GROUND

NOTIFICATION OF TRAFFIC RESTRICTIONS

THROUGHOUT THE DURATION OF THE PROJECT, THE CONTRACTOR SHALL NOTIFY THE ENGINEER IN WRITING OF ALL TRAFFIC RESTRICTIONS AND UPCOMING MAINTENANCE OF TRAFFIC CHANGES. THE CONTRACTOR SHALL ENSURE THE WRITTEN NOTIFICATION IS SUBMITTED IN A TIMELY MANNER TO ALLOW THE PROJECT TO MEET THE REQUIRED TIME FRAMES SET FORTH IN THE TABLE BELOW TO INFORM THE SPECIAL HAULING PERMITS SECTION (HAULING.PERMITS@DOT.OHIO.GOV) AND THE DISTRICT PUBLIC INFORMATION OFFICE (PIO). THIS NOTIFICATION SHALL BE RECEIVED BY THE ENGINEER PRIOR TO THE PHYSICAL SETUP OF ANY APPLICABLE SIGNS OR MESSAGE BOARDS.

INFORMATION SHOULD INCLUDE, BUT IS NOT LIMITED TO, ALL CONSTRUCTION ACTIVITIES THAT IMPACT OR INTERFERE WITH TRAFFIC AND SHALL LIST THE SPECIFIC LOCATION, TYPE OF WORK, ROAD STATUS, DATE AND TIME OF RESTRICTION, DURATION OF RESTRICTION, NUMBER OF LANES MAINTAINED, NUMBER OF LANES CLOSED, MINIMUM VERTICAL CLEARANCE, MINIMUM WIDTH OF DRIVABLE PAVEMENT, DETOUR ROUTES, IF APPLICABLE, AND ANY OTHER INFORMATION REQUESTED BY THE ENGINEER.

NOTIFICATION OF TRAFFIC RESTRICTIONS TIME TABLE

ITEM	DURATION OF CLOSURE	NOTICE DUE TO PERMITS & PIO
RAMP & ROAD CLOSURES	>= 2 WEEKS	21 CALENDAR DAYS PRIOR TO CLOSURE
	> 12 HOURS & < 2 WEEKS	14 CALENDAR DAYS PRIOR TO CLOSURE
	<= 12 HOURS	4 CALENDAR DAYS PRIOR TO CLOSURE
LANE CLOSURES & RESTRICTIONS	>= 2 WEEKS	14 CALENDAR DAYS PRIOR TO CLOSURE
	< 2 WEEKS	5 BUSINESS DAYS PRIOR TO CLOSURE
START OF CONSTRUCTION & TRAFFIC PATTERN CHANGES	N/A	14 CALENDAR DAYS PRIOR TO IMPLEMENTATION

ANY UNFORESEEN CONDITIONS NOT SPECIFIED IN THE PLANS REQUIRING TRAFFIC RESTRICTIONS SHALL ALSO BE REPORTED TO THE ENGINEER USING THE NOTIFICATION TIME TABLE.

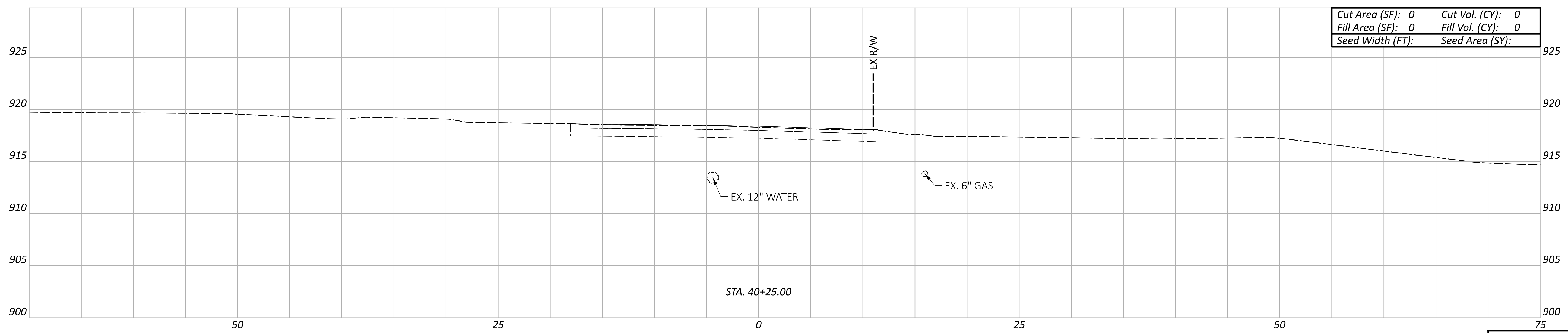
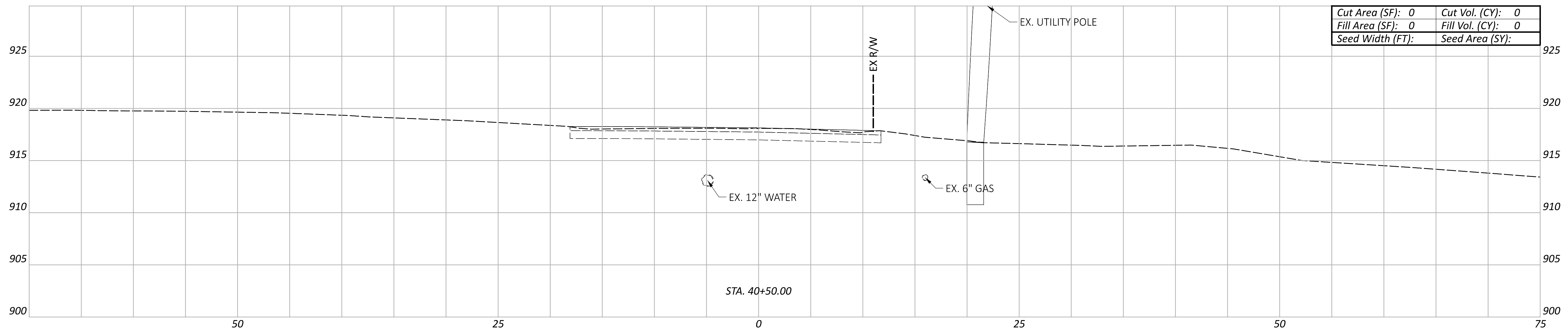
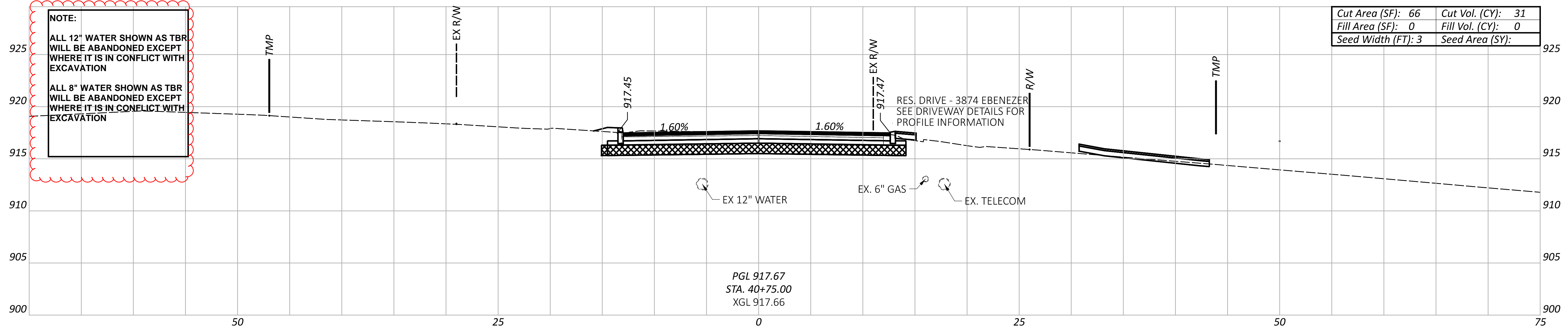

Sheet Totals			116547	
Seeding	Cut	Fill	SHEET	TOTAL
			28	86

CROSS SECTIONS - EBENEZER RD (CR128)
 STA. 40+25.00 TO STA. 40+75.00

DESIGN AGENCY

 PLAN PREPARED BY:
 TEC Engineering, Inc.
 7286 Central Parke Blvd.
 Mason, OH 45040

DESIGNER
 AAH

REVIEWER
 KLL 05/01/26

PROJECT ID
 116547