

PROJECT LOCATION



LOCATION MAP

POR-225-9.20

LATITUDE: 41°05'02" LONGITUDE: 81°03'04"

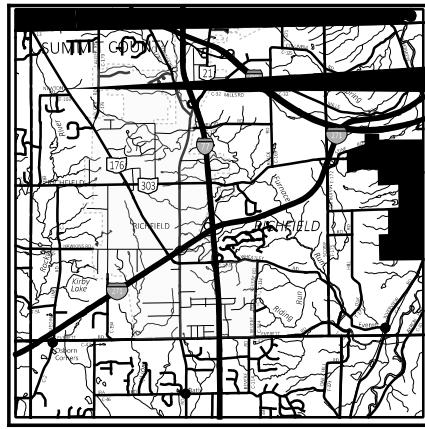

PROJECT LOCATION



LOCATION MAP

SUM-176-4.94

LATITUDE: 41°16'10" LONGITUDE: 81°40'44"

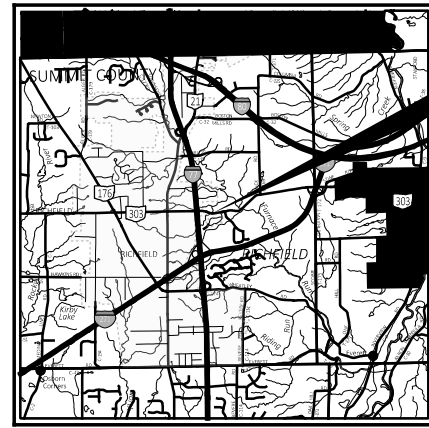

PROJECT LOCATION



LOCATION MAP

SUM-303-3.22

LATITUDE: 41°14'21" LONGITUDE: 81°37'25"

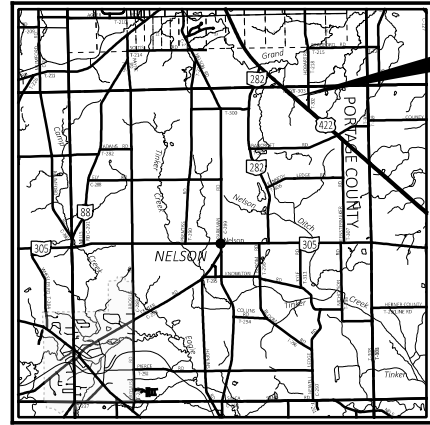

PROJECT LOCATION



LOCATION MAP

POR-422-0.94

LATITUDE: 41°20'20" LONGITUDE: 81°01'02"

RIGHT OF WAY LEGEND SHEET

POR-225-9.20 PART OF LOTS 19 & 20 PALMYRA TOWNSHIP

SUM-176-4.94 PART OF LOTS 5 & 6 RICHFIELD TOWNSHIP

SUM-303-3.22 PART OF LOT 8, TRACT 6 RICHFIELD TOWNSHIP

POR-422-0.94 PART OF LOT 52 NELSON TOWNSHIP

PROJECT DESCRIPTION

REPAIR AND REPLACEMENT OF MULTIPLE CULVERTS IN SUMMIT AND PORTAGE COUNTY.

PROJECT CONTROL POR-225-9.20
PORTAGE COUNTY LDP NAD 83 (2011) (Epoch: 2010.0000)

PROJECT CONTROL POR-422-0.94
STATE PLANE GRID NAD 83 (2011) (Epoch: 2010.0000)
PROJECT ADJUSTMENT FACTOR 1.0000897692978

PROJECT CONTROL SUM-176-4.94
SUMMIT COUNTY LDP NAD 83 (2011) (Epoch: 2010.0000)

PROJECT CONTROL SUM-303-3.22
SUMMIT COUNTY LDP NAD 83 (2011) (Epoch: 2010.0000)

UTILITY LIST

NOTES: THE LOCATION OF THE UNDERGROUND UTILITIES SHOWN ON THE PLANS ARE OBTAINED FROM THE OWNER OF THE UTILITIES AS REQUIRED BY SECTION 153.64 O.R.C.

INDEX OF SHEETS:

LEGEND SHEET	1
PROPERTY MAP POR-225-9.20	2
PROPERTY MAP SUM-176-4.94	3
PROPERTY MAP SUM-303-3.22	4
PROPERTY MAP POR-422-0.94	5
SUMMARY SHEET	6
DETAIL SHEET POR-225-9.20	7
DETAIL SHEET SUM-176-4.94	8
DETAIL SHEET SUM-303-3.22	9
DETAIL SHEET POR-422-0.94	10

PLANS PREPARED BY:

FIRM NAME : ODOT

R/W DESIGNER: TIM WARD

R/W REVIEWER: BRIAN HONAKER

FIELD REVIEWER: _____

PRELIMINARY FIELD REVIEW DATE: _____

TRACINGS FIELD REVIEW DATE: _____

OWNERSHIP UPDATED BY: TRAVIS SHORT

DATE COMPLETED: _____

PLAN COMPLETION DATE: _____

CONVENTIONAL SYMBOLS

County Line	-----	Edge of Shoulder (Ex)	-----
Township Line	-----	Edge of Shoulder (Pr)	-----
Section Line	-----	Ditch / Creek (Ex)	-----
Corporation Line	----- or -----	Ditch / Creek (Pr)	-----
Fence Line (Ex)	----- x----- x----- (Pr) ----- x----- x-----	Tree Line (Ex)	-----
Center Line	-----	Ownership Hook Symbol	Example -----
Right of Way (Ex)	----- Ex R/W -----	Property Line Symbol	Example -----
Right of Way (Pr)	----- R/W -----	Break Line Symbol	Example -----
Standard Highway Ease.(Ex)	----- Ex SH -----	Tree (Pr) Tree (Ex) Shrub (Ex)	-----
Standard Highway Ease.(Pr)	----- SH -----	Tree (Remove) Shrub (Remove)	-----
Temporary Right of Way	----- TMP -----	Evergreen (Ex) Stump	-----
Channel Ease. (Pr)	----- CH -----	Evergreen (Remove) Stump (Remove)	-----
Utility Ease. (Ex)	----- Ex U -----	Wetland (Pr) Grass (Pr) Aerial Target	-----
Railroad	----- or -----	Post (Ex) Mailbox (Ex) Mailbox (Pr)	-----
Guardrail (Ex)	----- (Pr) -----	Light (Ex) Telephone Marker (Ex) TEL	-----
Construction Limits	-----	Fire Hydrant (Ex) Water Meter (Ex)	-----
Edge of Pavement (Ex)	-----	Water Valve (Ex) Utility Valve Unknown (Ex)	-----
Edge of Pavement (Pr)	-----	Telephone Pole (Ex) Power Pole (Ex)	-----
		Light Pole (Ex)	-----

STRUCTURE KEY

	RESIDENTIAL
	COMMERCIAL
	OUT-BUILDING

TYPES OF TITLE LEGEND:
 WL = FEE SIMPLE WITH LIMITATION OF ACCESS
 WD = WARRANTY DEED
 PRW = PROPERTY RIGHT FEE SIMPLE
 SH = STANDARD HIGHWAY EASEMENT
 LA = LIMITED ACCESS EASEMENT
 T = TEMPORARY EASEMENT
 CH = CHANNEL EASEMENT
 A = AERIAL EASEMENT
 SL = SLOPE EASEMENT
 PRE = PROPERTY RIGHT EASEMENT

I, TIM WARD, P. S. have established the proposed right of way lines, calculated the Gross Take, Present Roadway Occupied (PRO), Net Take and Net Residue; as well as prepared the legal descriptions necessary to acquire these parcels as shown herein. As a part of this work ODOT has set right of way monuments at the property corners, property line intersections, points along the right of way and/or angle points on the right of way, Section Corners and other points as shown herein. All of my work contained herein was conducted in accordance with Ohio Administrative Code 4733-37 commonly known as "Minimum Standards for Boundary Surveys in the State of Ohio" unless noted. The words I and my as used herein are to mean either myself or someone working under my direct supervision.

TIM WARD, Professional Land Surveyor No. 8045,

Date:

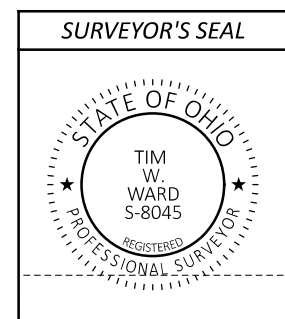

DESIGN AGENCY



DESIGNER

TWW

REVIEWER

BWH

PROJECT ID

112177

SUBSET

1

TOTAL

10

SHEET

TOTAL

