

# RIGHT OF WAY LEGEND SHEET

**PROJECT DESCRIPTION**  
REPAIR AND REPLACEMENT OF MULTIPLE CULVERTS IN ASHTABULA AND TRUMBULL COUNTY.

**PROJECT CONTROL** ATB-193-11.14  
STATE PLANE GRID NAD 83 (2011) (Epoch: 2010.0000)  
PROJECT ADJUSTMENT FACTOR 1.000032

**PROJECT CONTROL** TRU-193-23.90  
STATE PLANE GRID NAD 83 (2011) (Epoch: 2010.0000)  
PROJECT ADJUSTMENT FACTOR 1.000040

**PROJECT CONTROL** TRU-422-0.68  
STATE PLANE GRID NAD 83 (2011) (Epoch: 2010.0000)  
PROJECT ADJUSTMENT FACTOR 1.000040

**ATB-193-11.14  
PART OF LOTS 20 & 35  
DORSET TOWNSHIP**

**TRU-193-23.90  
PART OF LOTS 75 & 76  
GUSTAVUS TOWNSHIP**

## UTILITY LIST

NOTES: THE LOCATION OF THE UNDERGROUND UTILITIES SHOWN ON THE PLANS ARE OBTAINED FROM THE OWNER OF THE UTILITIES AS REQUIRED BY SECTION 153.64 O.R.C.

**PLANS PREPARED BY:**  
FIRM NAME : ODOT  
R/W DESIGNER: TIM WARD  
R/W REVIEWER: BRIAN HONAKER  
FIELD REVIEWER: \_\_\_\_\_  
PRELIMINARY FIELD REVIEW DATE: \_\_\_\_\_  
TRACINGS FIELD REVIEW DATE: \_\_\_\_\_  
OWNERSHIP UPDATED BY: \_\_\_\_\_  
DATE COMPLETED: \_\_\_\_\_  
PLAN COMPLETION DATE: \_\_\_\_\_

**INDEX OF SHEETS:**

LEGEND SHEET	1
PROPERTY MAP ATB-193-11.14	2
PROPERTY MAP TRU-193-23.90	3
SUMMARY SHEET	4
DETAIL SHEET ATB-193-11.14	5
DETAIL SHEET TRU-193-23.90	6

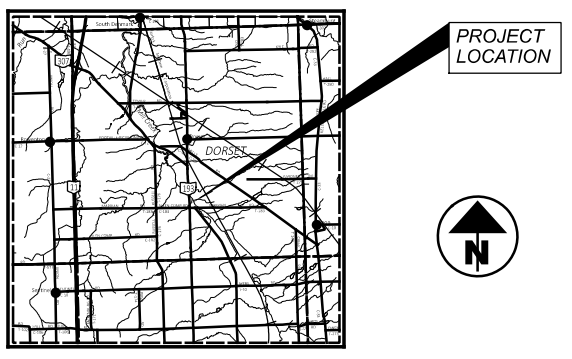

**LOCATION MAP**  
ATB-193-11.14  
LATITUDE: N 41°39'40" LONGITUDE: W 80°40'00"

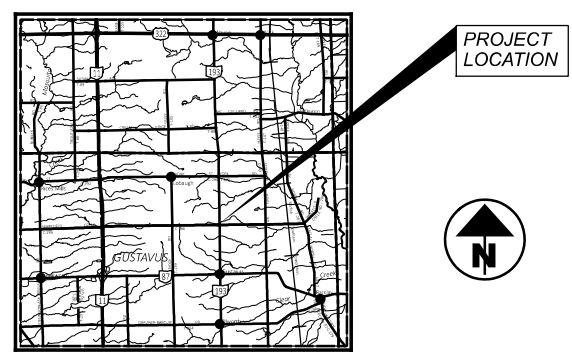

**LOCATION MAP**  
TRU-193-23.90  
LATITUDE: N 41°28'40" LONGITUDE: W 80°39'55"

**STRUCTURE KEY**

	RESIDENTIAL
	COMMERCIAL
	OUT-BUILDING

**TYPES OF TITLE LEGEND:**  
 WL = FEE SIMPLE WITH LIMITATION OF ACCESS  
 WD = WARRANTY DEED  
 PRW = PROPERTY RIGHT FEE SIMPLE  
 SH = STANDARD HIGHWAY EASEMENT  
 LA = LIMITED ACCESS EASEMENT  
 T = TEMPORARY EASEMENT  
 CH = CHANNEL EASEMENT  
 A = AERIAL EASEMENT  
 SL = SLOPE EASEMENT  
 PRE = PROPERTY RIGHT EASEMENT

### CONVENTIONAL SYMBOLS

County Line	-----	Edge of Shoulder (Ex)	-----
Township Line	-----	Edge of Shoulder (Pr)	-----
Section Line	-----	Ditch / Creek (Ex)	-----
Corporation Line	----- or -----	Ditch / Creek (Pr)	-----
Fence Line (Ex)	----- (Pr) -----	Tree Line (Ex)	-----
Center Line	-----	Ownership Hook Symbol	Example
Right of Way (Ex)	----- Ex R/W -----	Property Line Symbol	Example
Right of Way (Pr)	----- R/W -----	Break Line Symbol	Example
Standard Highway Ease. (Ex)	----- Ex SH -----	Tree (Pr) (Ex), Tree (Ex), Shrub (Ex)	
Standard Highway Ease. (Pr)	----- SH -----	Tree (Remove) (Ex), Shrub (Remove) (Ex)	
Temporary Right of Way	----- TMP -----	Evergreen (Ex), Stump (Remove)	
Channel Ease. (Pr)	----- CH -----	Evergreen (Remove), Stump (Remove)	
Utility Ease. (Ex)	----- Ex U -----	Wetland (Pr), Grass (Pr), Aerial Target	
Railroad	----- or -----	Post (Ex), Mailbox (Ex), Mailbox (Pr)	
Guardrail (Ex)	----- (Pr) -----	Light (Ex), Telephone Marker (Ex), TEL	
Construction Limits	-----	Fire Hydrant (Ex), Water Meter (Ex)	
Edge of Pavement (Ex)	-----	Water Valve (Ex), Utility Valve Unknown (Ex)	
Edge of Pavement (Pr)	-----	Telephone Pole (Ex), Power Pole (Ex)	
		Light Pole (Ex)	

I, TIM WARD, P. S. have established the proposed right of way lines, calculated the Gross Take, Present Roadway Occupied (PRO), Net Take and Net Residue; as well as prepared the legal descriptions necessary to acquire these parcels as shown herein. As a part of this work ODOT has set right of way monuments at the property corners, property line intersections, points along the right of way and/or angle points on the right of way, Section Corners and other points as shown herein. All of my work contained herein was conducted in accordance with Ohio Administrative Code 4733-37 commonly known as "Minimum Standards for Boundary Surveys in the State of Ohio" unless noted. The words I and my as used herein are to mean either myself or someone working under my direct supervision.

TIM WARD, Professional Land Surveyor No. 8045, Date: \_\_\_\_\_

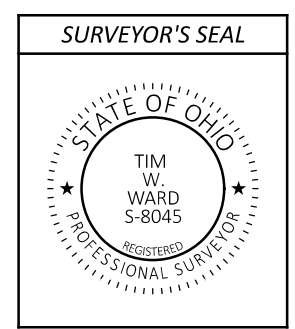

DESIGN AGENCY

DESIGNER: TWW  
REVIEWER: BWH  
PROJECT ID: 122339  
SUBSET: 1 TOTAL: 6  
SHEET: TOTAL:









