

1957

Year

Job No.

06171

Changes

County

FRANKLIN

Bridge No.

EPA-62-0624

Section

EPA-62-142

Location

over under

HAVER Rd

File No.

FES-6
46-40/7D-065

00421

DESIGN BY

	RECON	AUGER	CORE	DRIVE ROD
By		DICKASON		WETZEL
Dates		10/8-57		10/2-3/57
No. of Holes or Soundings		3		7
Footage		47.1		279.0
Samples Tested		10		

SITE PLANS	
Date Recl'd	9/3/57
Revised Plan	

Topo Sheet

Transmittal Date 10-16-57

No. of Tracings _____ Filed with year _____

Revisions

Remarks

Refer To

Auger Data			Drive Rod		Core Data		
No. of Holes	Footage	Samples	No. of Soundings	Footage	No. of Holes	Footage	Samples
3	47.1	10	7	279.0	-	-	-

Blank lined paper with horizontal ruling lines and a vertical margin line on the left side. There are some faint smudges and a small dark mark near the top left corner.



FIELD DATA - ROD PENETRATION

Location, No. B-1 County Franklin
PEAR Pier - Abut. Bridge No. 620624
 Station: 27+13 Over: HOOVER RD.
 Offset: 14' 2 1/2"
 Started: 10-2-57
 Completed: 10-2-57

Equipment: 21-U-31
 P.K. Diameter 1.35
 Ground Line

Proposed Footer

Depth feet	Elevation	Penetration
0	809.9	
5	804.9	15/16 13/16
10	779.9	1" 1/16 15/16 5/16
15	794.9	1/16 1/16 1/16 1/2 1/2 1/2 1/16 3/16 3/16 3/8
25	784.9	3/8 1/4

25	789.9	3/8 5/16 1/4 5/16
30	779.9	5/16 5/16 5/16 1/4
35	774.9	1/8 10 1/4 18
40		
45		
50		
55		
60		

Rod Condition: 32' Row

Chief of Party L. Davis

PK K. J. Davis

FIELD DATA - ROD PENETRATION

Location, No B2 County FRANKLIN
REAR Pier - Abut. Bridge No 62-0624
 Station: 27+96 Over: HEWER RD.
 Offset: 14' RT.
 Started: 10-2-57
 Completed: 10-2-57 Equipment: 210-32

D.R. Diameter 1.35
 Ground Line

Proposed Footer

Depth Feet	Penetration	Elevation
0		810.4
5	15/16 3/4 15/16 1 3/16 1 1/16 7/8	805.4
10	3/4 7/8 13/16 3/4 3/4	800.4
15	1 1/16 3/4 5/8 5/8 1/2	795.4
20	1/2 7/16 1/2 3/4 5/8	790.4
25	5/8	785.4

Party Busby

25	5/8 5/8 5/8 1/2 + 5/8	785.4	
30	5/8 1/2 + 3/16 3/8 3/8	780.4	
35	5/16 5/16 5/16 + 5/16 5/16	775.4	
40	5/16 5/16 5/16 5/16 3/16	770.4	
45	5/16 1/16	765.4 764.4	
50			
55			
60			

Rod Condition: 24' Bent

Chief of Party Leitch

FIELD DATA - ROD PENETRATION

Location No. B-2A County: FRANKLIN

PEAR Pier - Abut. Bridge No 62-0624

Station: 27+75 Over: HOOPER RD.

Offset: 14' 21"

Started: 10-3-57

Completed: 10-3-57 Equipment: 21-0-31

D.I. Diameter 1.25

Ground Line

Proposed Footer

Depth Feet	Penetration	Elevation
0		809.7
5	1" 11/8 7/8 13/16 3/4 15/16 1"	794.7
10	7/16 9/16 13/16 11/16 3/4	789.7
15	3/8 7/16 1/2 5/8 7/8	784.7
20	5/8 1 1/2 9/8 5/8 3/8	789.7
25	7/8	784.7

Party H. K. HARRIS

25	784.7	
	5/8 9/16 9/16 9/16	
30	789.7	
	1/2 9/16 7/8 1 1/2	
35	784.7	
	3/8 3/8 3/8	
40	789.7	
	1 1/2 1 1/2	
45	784.7	
50		
55		
60		

Rod Condition: 20' Bent

Chief of Party Postel

FIELD DATA - ROD PENETRATION

Location, No. # B-3 County: FRANKLIN

CENTER Pier - Abut. Bridge No 620624

Station: 28+76 Over: HOOVER

Offset: 14' 11"

Started: 10-2-54

Completed: 10-3-57 Equipment: Z1-D-31

D.R. Diameter 1.35

Ground Line

Proposed Footer

Depth Feet	Penetration	Elevation
0		808.9
5	1 1/2 2 1/8	803.9
10	1 7/8 1 5/8 3/8	798.9
15	5/8 1 1/8 1 3/8 7/8 3/8	793.9
20	1 1/8 1 1/8 1 1/8 5/8 1/2	788.9
25	9/16 3/16 3/8 9/16	783.9
		Over Nitc Cheels 5/16

Party McKENN DAVIS

25	783.9	
		7/16
		7/16
		5/16
		5/16
30	777.9	3/8
		5/16
		1/4
		3/16
		3/16
35	773.9	0+
40		
45		
50		
55		
60		

Rod Condition: 28' Bent

Chief of Party [Signature]

FIELD DATA - ROD PENETRATION

Location, No. B-4 County: FRANKLIN

F.W.D. Pier - Abut. Bridge No. 62-0624

Station: 29+98 Over: HOOVER RD.

Offset: 14' RT

Started: 10-2-57

Completed: 10-3-57 Equipment: 21-0-32

PR Diameter 1.35

Ground Line

Proposed Footer

Depth Feet	Penetration	Elevation
0		811.0
5	1 1/16 1 1/16 1 1/16+ 1 1/16+ 1 1/16	806.0
10	1 1/16 7/8 7/8 7/8 7/8	801.0
15	13/16 5/8 3/4 7/8 3/4	796.0
20	13/16 7/8 13/16 7/8 5/8	791.0
25	11/16	786.0

OVER NIGHT CHECK - 34

25	786.0	11/16 5/8 11/16 5/8
30	781.0	9/16 1/2+ 9/16 1/2 3/8
35	776.0	7/16 5/16 5/16 5/16
40	771.0	5/16 1/4+ 5/8 3/8+ 1/4+
45	766.0	5/16 3/8 1/4+ 1/8+
50	761.0	1/8
55		
60		

Rod Condition: 16' bent

Party BUGY FISHER

Chief of Party [Signature]

FIELD DATA - ROD PENETRATION

Location No. ~~13~~ ^{B-44} County: FRANKLIN

~~Cross~~ Pier - Abut. Bridge No 62-0624

Station: 29480 Over: LAVER Rd.

Offset: 14/16

Started: 10-3-57

Completed: 10-3-57 Equipment: 21-A-32

D.R. Diameter 1.55

Ground Line

Proposed Footer

Depth Feet	Penetration	Elevation
0		810.8
5	1 1/16 1 7/8 1 1/16 1 3/16 1 1/8	805.8
10	7/8 3/4 1 1/16 1 1/16 3/4	800.8
15	3/4 1 1/16 3/4 1 1/16 1 1/16	795.8
20	5/8 5/8 5/8 3/8	790.8
25	1/2	785.8

Party FISHER

25	3/8 5/16 1/4 5/16 5/16 + 280.8	785.8
30	3/8 1/4 5/16 1/4	
35	3/16 1/8 1/8	775.8 773.8
40		
45		
50		
55		
60		

Rod Condition: Good

Chief of Party Stetzel

FIELD DATA - ROD PENETRATION

Location No. 5 County: FRANKLIN
F.W.D. Pier - Abut. Bridge No. 62-0624
 Station: 30+39 Over: HOOVER RD.
 Offset: 14' LT.
 Started: 10-9-57
 Completed: 10-3-57 Equipment: 21-0-31

D.R. Diameter 1.35
 Ground Line

Proposed Footer

Depth Feet	Penetration	Elevation
0		810.2
5	1 7/16 1 15/16	805.2
	1/4 1/8 1/4 1"	
10	3/4	800.2
	5/8 5/8 5/8 1 1/16	
15	5/8	795.2
	5/8 9/16 1/2	
20	1/2	790.2
	1/2 7/16 7/16 1/4	
25	5/16	785.2

Party M. S. KENN. DAVE

25	785.2	
	1/4 5/16 5/16 7/16	
30	780.2	
	1/8 1 1/16	
35	775.2	
40		
45		
50		
55		
60		

Rod Condition: 2 1/2 Bent

Chief of Party [Signature]

FIELD DATA - SOIL LOG

Location No. 2 County: Fronk
Rean Pier-~~444~~ Bridge No. 62-0624
 Station: 27+96 ~~6~~: Hoover Road
 Offset: 14' RT
 Started: 10-8-57 Equipment: Hardsocg
 Completed: _____ Diameter 3"

Proposed Footer: 804.1

Water Level: Dry.

Depth Feet	Log	Samples	Elevation	
0			910.0	Ground Line
5		X#8		Moist dense brown silt clay
5.5			804.5	← tightened drilled stave
10		X#9		Moist dense brown silt clay & small limestone fragments
11.8			799.0	← tightened & started stalling.
15		X#10		Dry dense clay very hard to drill.
15.8			794.2	Tried several times but too dry & dense to drill farther.
20				
25				

26		
30		
35		
40		
45		
50		
55		
60		

Remarks: _____

Party _____

Chief of Party DICKASON

FIELD DATA - SOIL LOG

Location No. 3 County: Franklin
~~CENTER~~ Pier-~~1~~ Bridge No. 62-0624
 Station: 28+76 ~~Corner~~: Hoover Rd
 Offset: 14' LT
 Started: 10-8-57 Equipment: HARDSON
 Completed: _____ Diameter 3

Proposed Footer: 800.9

Water Level: Dry

Depth Feet	Log	Samples	Elevation	Ground Line
0			809.0	Ground Line
			15.8	
			83.2	
5		X #5		MOIST dense brown silt clay. Good solid MATERIAL for foundation
6.0			803.0	
10		X #6		MOIST dense brown silt clay + small limestone fragments. SIMILAR MATERIAL TO #5 slightly more moisture
11.0			798.0	← Tightened
15		X #7		Dry dense clay cemented + hard to drill
15.8			793.2	Stalled motor at 15.8 could not drill farther
20				
25				

26		
30		
35		
40		
45		
50		
55		
60		

Remarks: _____

Party _____

Chief of Party _____

FIELD DATA - SOIL LOG

Location No. 4 County: FRANKLIN
FWD. Pier Bridge No. 62-6624
 Station: 29+98 to: Hoover Rd
 Offset: 14' RT
 Started: 10-8-57 Equipment: HARDSAG
 Completed: _____ Diameter 3"

Proposed Footer: 803.6

Water Level: Dry

Depth Feet	Log	Samples	Elevation	
0			811.6	Ground Line
			815.5	
		X #1	807.5	2055 brown silt clay
3.5				← drilled slightly harder
5		X #2		MOIST dense brown silt clay
7.0			804.0	
10		X #3		moist dense brown silt clay + limestone fragments - good solid condition
13.0			798.0	← Tightened + started stalling drill
15		X #4		Dense grey cemented clay very dense + hard to drill
15.0			795.5	
20				
25				

26		
30		
35		
40		
45		
50		
55		
60		

Remarks: _____

Party _____

Chief of Party _____

**STATE OF OHIO
DEPARTMENT OF HIGHWAYS
TESTING LABORATORY**

SUMMARY OF SOIL TEST DATA

SAMPLE NUMBER	LABORATORY NUMBER SO-	PHYSICAL CHARACTERISTICS							WATER CONTENT	DESCRIPTION
		% AGGREGATE RET. # 10	% COARSE SAND 2.0MM - 0.42MM	% FINE SAND 0.42MM - 0.075MM	% SILT 0.075MM - 0.0075MM	% CLAY < 0.0075MM	LIQUID LIMIT	PLASTICITY INDEX		
1									BROWN SILTY CLAY	
2									BROWN SILTY CLAY	
3									BR. SILTY CLAY WITH STONE FRAGTS.	
4									BROWNISH GRAY SILTY CLAY	
5									BROWN SILTY CLAY	
6									BROWN SILTY CLAY	
7									BROWN SILTY CLAY	
8									BROWN SILTY CLAY	
9									BR. SILTY CLAY WITH STONE FRAGTS.	
10									BR. SILTY CLAY WITH STONE FRAGTS.	
									LOGS OF WILLIAMS AUGER BORINGS	
									Depth	
		STA 326+00	C.L.	SURF.	ELEV.	811.3'				
				V I S U A L					0.0-0.4 SOD & TOPSOIL	
38	52725	15	9	11	34	31	24	6	14	0.4-8.0 BROWN SANDY SILT
		STA 331+00	C.L.	SURF.	ELEV.	809.4'				
				V I S U A L					0.0-0.4 SOD & TOPSOIL	
39	52726	21	9	11	34	25	26	10	15	0.4-10.0 BR SANDY GRAVELLY SILT

CO., RT. NO., SEC. FRANKLIN
FRA-62-1.42
FRA-62-0624
US 62 UNDER HOOVER RD.
SHEET NO. 1 OF 4 SHEETS

VISUAL CLASSIFICATION

STATE OF OHIO
DEPARTMENT OF HIGHWAYS
TESTING LABORATORY
AND
BUREAU OF BRIDGES

FOUNDATION DATA

CO., RT. NO. SEC. FRA-62-1.42 BRIDGE NO. FRA-62-0624
 CENTER PIER US 62 UNDER HOOVER RD.
 LOCATION T.H. B3 STA. 28+76 OFFSET 14' LT. FED. NO. I-609(10)

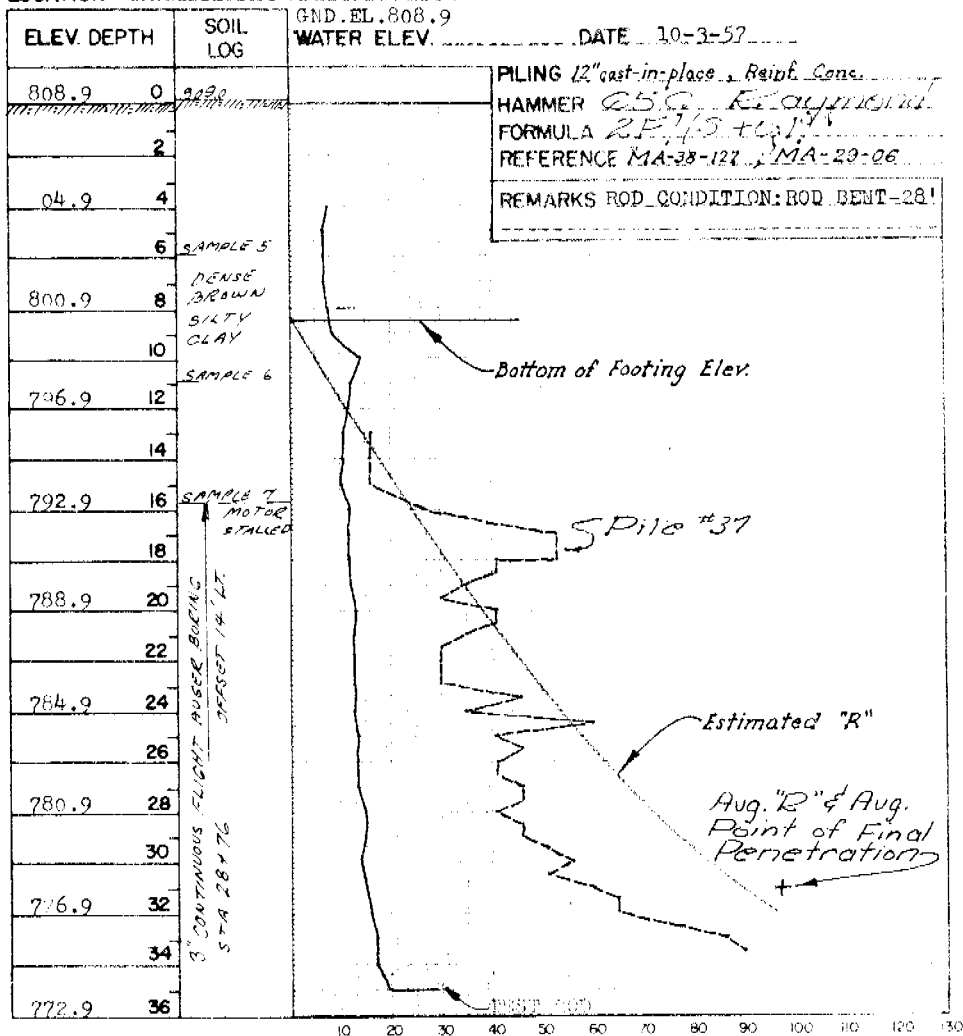

CAPACITY "R" IN THOUSANDS OF POUNDS BY EE
 DATE 10-16-57

FRANKLIN
FRA-62-0624
US 62 UNDER HOOPER RD.
US State Highway Form 584

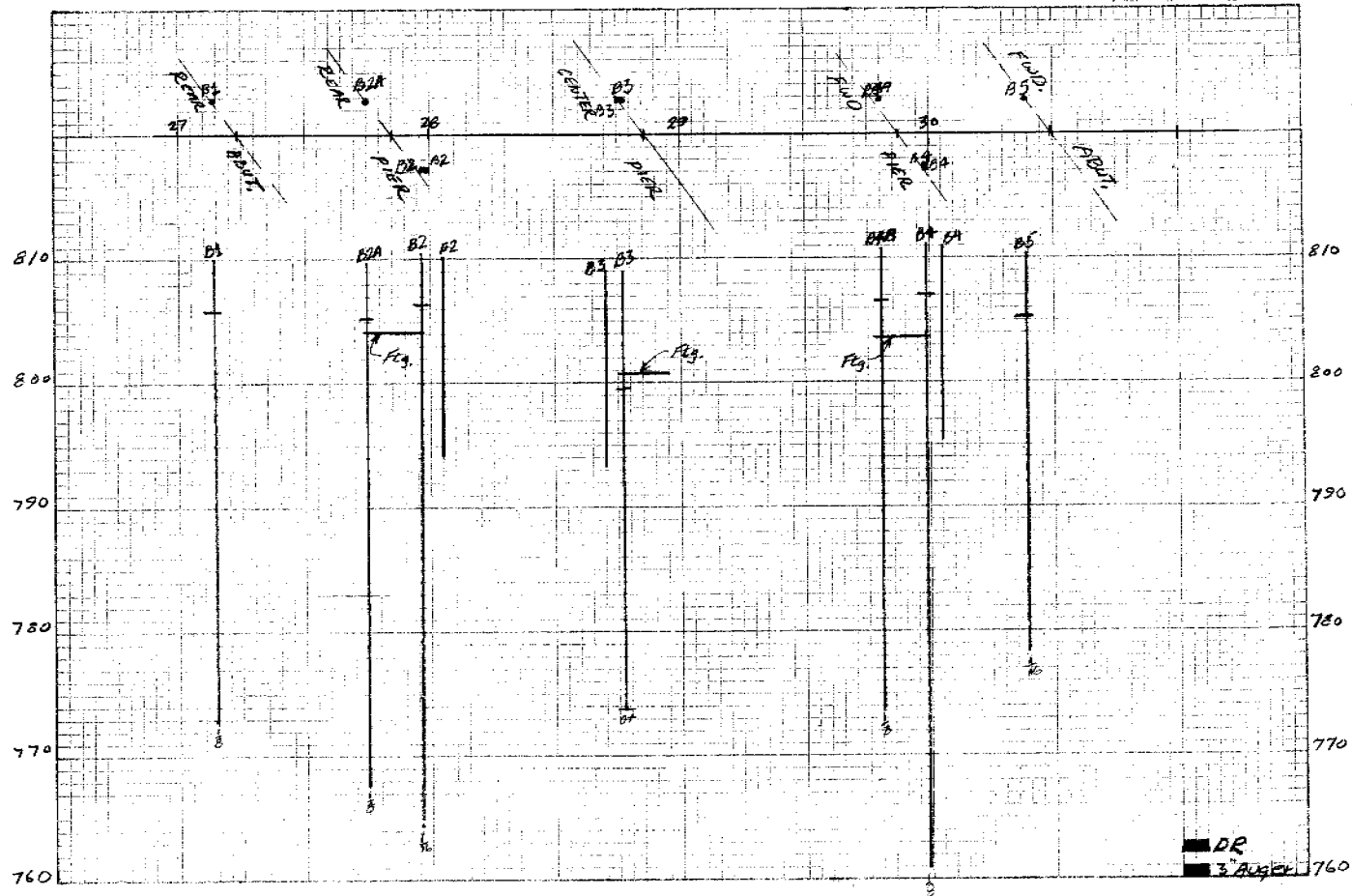

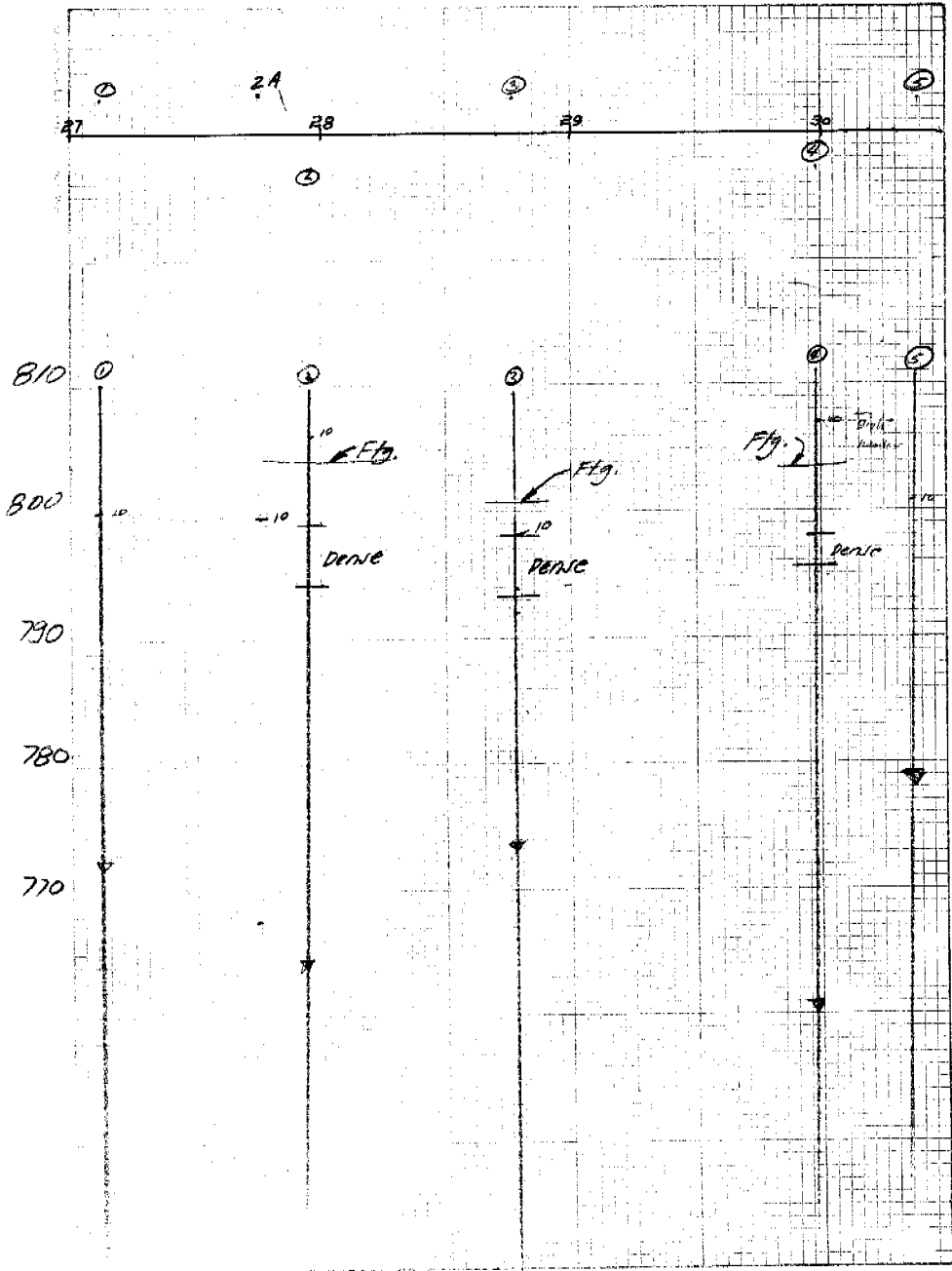

H. W. LOCHNER & COMPANY
ENGINEERS
20~~XXX~~ NORTH WACKER DRIVE
CHICAGO 6, ILLINOIS
FRANKLIN 2-7346

PRINCIPALS

HARRY W. LOCHNER
JOHN J. STEDJE
MERTON F. POSTLE

September 23, 1957

ASSOCIATES

KASIM ATLAS
EDUARDO FARIAS
WM. NED SAMUEL
EDWARD M. VANA

Re: Your File 13-4-1
Franklin County

Mr. R. R. Litehiser, Engineer of Tests
Ohio State Highway, Testing Laboratory
O. S. U. Campus
Columbus 10, Ohio

Attention: Mr. N. E. Mason, Assistant Engineer

Gentlemen:

This is in reply to your letter of September 4, 1957, requesting our survey crews to set stakes at the structural test locations indicated in your letter after which time you asked to be notified when staking had been completed.

You are hereby notified that all staking will be completed by September 24, 1957. It is respectfully suggested that the testing work begin on the south and proceed toward Columbus.

Very truly yours,

H. W. LOCHNER & COMPANY

Edward M. Vana

Edward M. Vana

EMV:fm

CC: Mr. R. E. Schultz

Attn: Mr. O. W. Gruebmeier



H. W. LOCHNER & COMPANY
ENGINEERS
20~~ND~~ NORTH WACKER DRIVE
CHICAGO 6, ILLINOIS
FRANKLIN 2-7348

PRINCIPALS

HARRY W. LOCHNER
JOHN J. STEDJE
MERTON F. POSTLE

September 23, 1957

ASSOCIATES

KABIN ATLAS
EDUARDO FARIAS
WM. NED SAMUEL
EDWARD H. VANA

Re: Your File 13-4-1
Franklin County

Mr. R. R. Litchiser, Engineer of Tests
Ohio State Highway, Testing Laboratory
O. S. U. Campus
Columbus 10, Ohio

Attention: Mr. N. E. Mason, Assistant Engineer

Gentlemen:

This is in reply to your letter of September 4, 1957, requesting our survey crews to set stakes at the structural test locations indicated in your letter after which time you asked to be notified when staking had been completed.

You are hereby notified that all staking will be completed by September 24, 1957. It is respectfully suggested that the testing work begin on the south and proceed toward Columbus.

Very truly yours,

H. W. LOCHNER & COMPANY

EMV:fm

Edward M. Vana

CC: Mr. R. E. Schultz

Attn: Mr. O. W. Grubnsyar

Dist. Hab.

October 24, 1957

File # 12-4-1
[Signature]

C. H. Altwater, Assistant Engineer of
Bridges - Preliminary Design

#6

Franklin

FRA-62-1.42

D. H. Sparks, Designing Engineer

FRA-62-0624

U. S. 62 under Hoover Rd.
58E, I-609(10)
06171

Bridge Foundation Investigation Report

Between the dates of October 2 and October 6, 1957, rod penetration tests and auger borings were made at the above proposed structure to determine the existing subsurface conditions. The field and laboratory operations of the investigations were performed by the Foundation Exploration Section and the Soil Section of the State Highway Testing Laboratory.

The Testing Laboratory reports that the structure site is on relatively deep glacial drift overlying limestone bedrock. Topography of the area is gently rolling in character. No test penetrated to bedrock, which is at such a depth as to have no effect on foundation design.

The attached sheets show the soil logs, soil classifications, and rod penetration curves which were reported by the Testing Laboratory.

The recommendations for the foundation design are as follows:

1. Both abutments shall be founded on spread footings in embankment at elevations as shown on plans. Maximum allowable bearing pressure shall be 2 tons per square foot.

2. 12" cast-in-place reinforced concrete piles shall be driven at all piers to a minimum bearing capacity of 40 tons per pile (Maximum design load, 37 tons per pile). Elevation of pier footings shall be as shown on plans. The estimated average pay length of the piles is 23 feet.

DHS:bn

cc: M. I. Johnson (attach)
R. V. Wood (attach)
Neil Mason (attach)
August Schofer (attach)
H. W. Lechner and Co.
B. F. I. File



D. H. Sparks

September 4, 1957

H. W. Lochner & Co.
150 N. Wacker Dr.
Chicago, Illinois

Filet 13-4-1
Franklin

Gentlemen:

Transmitted herein is a list of proposed test locations on four structures on the USR 62 relocation southwest of Columbus. It is respectfully requested that your survey crews set stakes at these points. The stakes should be marked showing test location number, station, offset and ground elevation at the stake.

<u>STRUCTURE</u>	<u>TEST LOCATION NUMBER</u>	<u>STATION</u>	<u>OFFSET</u>
Under Hoover Road FRA-62-0624	M 1	27+13	14' LT
	B 2	27+96	14' RT
	B 3	28+76	14' LT
	B 4	29+98	14' RT
	B 5	30+39	14' LT
Over Big Run Creek FRA-62-1030	B 1	544+22	77' LT
	B 2	544+31	37' LT
	B 3	544+90	77' LT
	B 4	544+99	37' LT
	B 5	543+53	37' RT
	B 6	543+67	77' RT
	B 7	544+27	37' RT
	B 8	544+36	77' RT
US 62 Over Frank Road FRA-62-1136	B 1	599+02	73' LT
	B 2	599+47	29' LT
	B 3	599+87	73' LT
	B 4	600+46	29' LT
	B 5	600+72	73' LT
	B 6	599+25	29' RT
	B 7	599+70	73' RT
	B 8	600+09	29' RT
	B 9	600+68	73' RT
	B 10	600+93	29' RT

<u>SEQUENCE</u>	<u>TEST LOCATION NUMBER</u>	<u>STATION</u>	<u>OFFSET</u>
US 62 Under	B 1	25+94	14' LT
Dyer Road	B 2	26+36	14' RT
FRA-62-1002	B 3	27+46	14' LT
	B 4	28+24	14' RT
	B 5	28+98	14' LT

Please notify this office when staking is complete.

R. E. Litchiser
 Engineer of Tests

Per:

E. E. Mason
 Assistant Engineer

MEM: DME:jn
 cc: File
 Found (5)

October 16, 1957

Mr. Henry Overman, Engineer of Bridges

C. H. Altwater

R. R. Litchiser, Engineer of Tests

Per: H. E. Mason

Report of Bridge Foundation Investigation
FRA-62-0624 Under Hoover Rd.

File: 13-4-1
Franklin

Transmitted herewith are the results of the foundation investigation made at the above structure site. Tests were made by means of drive rod and Hardsoeg auger between October 2 and 8, 1957.

This structure site is in gently rolling area of relatively deep glacial drift overlying limestone bedrock.

Soundings and borings disclose that the drift is very dense. Borings encountered an extremely dry, dense zone below approximately elevation 798 feet which could be penetrated only three to five feet. Soundings extended to greater depth and were also discontinued because of great penetration resistance. No test penetrated to bedrock.

R. R. Litchiser
Engineer of Tests

Per: _____
H. E. Mason
Assistant Engineer

NEM:DHR:jh

Encl.

cc: G. W. Alsdorf Attn: R. V. Wood (No encl.)
H. W. Lockmer & Co. Attn: Ed Vana
150 N. Wacker Drive
Chicago, Illinois
File
Found (3)

FRANKLIN - 62 - 0624

9/6/57
L.D.T.

U.S. 62 UNDER HOOVER RD.

GEOGRAPHICAL LOCATION: THIS

SITE IS LOCATED APPROXIMATELY 500' SOUTH OF
ORDERS RD. IN FRANKLIN
COUNTY (JACKSON TWP.).

GEOLOGY: THIS SITE IS SITUATED

ON THE GLACIATED MISSISSIPPI
VALLEY PLAIN AT AN ELEVATION OF 809'. BOTH THE

ILLINOIAN AND WISCONSIN
GLACIERS PASSED OVER

THIS AREA. THE DRIFT
IS VARIABLE IN THICKNESS,
VARYING FROM 20-180 FEET.

THE AREA IS UNDERLAIN
BY THE COLUMBUS LIMESTONE.

IT IS ASSUMED THAT THE DRIVE-ROD INVESTIGATION WILL ENCOUNTER NO BEDROCK. THE PREDOMINANT SOIL IS A SANDY SILT CLAY WITH GRAVEL AT 10' IN THE IMMEDIATE VICINITY OF THE SITE.

OBSERVATIONS: ALL THE HOLES ARE ACCESSIBLE, BUT AT (9/6/57) THE PRESENT TIME THE FIELD IS IN CORN AND IS NOT ACCESSIBLE WITHOUT INFLECTING DAMAGE.

RECOMMENDATIONS: IT IS SUGGESTED THAT SOUNDINGS BE MADE AT LOCATIONS: B₁, B₂, B₃, B₄, B₅

THE BROWN STEEL CO.

STEEL WAREHOUSE SERVICE

753 MARION ROAD HICKORY 4-1115 COLUMBUS, OHIO

APPROVED STEEL

From 2 0629

1	809.9	772.4	2 $\frac{1}{8}$
2	810.9	769.4	$\frac{1}{16}$
3	808.9	773.9	0+
4	811.0	761.0	2 $\frac{1}{8}$
5	810.2	778.2	$\frac{1}{16}$

"Pantograph Flame Cutting a Specialty"

FED. RD. DIVISION	STATE	PROJECT	TYPE FUNDS
2	OHIO		

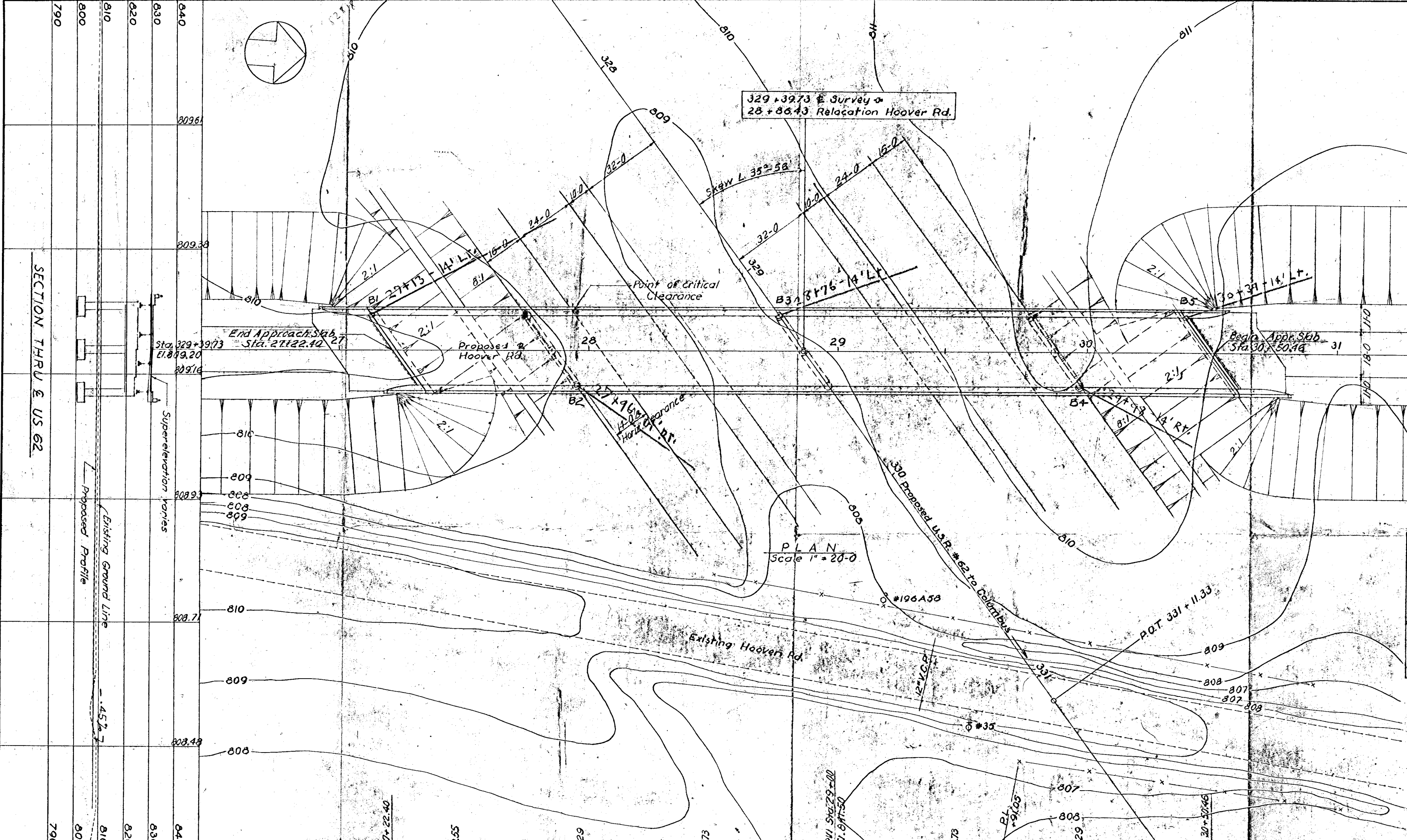
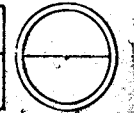

329+39.73 E Survey +
28+86.43 Relocation Hoover Rd.

Curve Data
for Hoover Road
A 30°00' Rt.
C 8°00'
E 716.20
T 191.91
L 375.00
P.I. 34+176.4

PLAN
Scale 1" = 20'-0"

PROPOSED STRUCTURE
Type: 4 Span continuous steel girders with reinforced concrete deck and reinforced concrete substructure.
Spans: 60'-6", 100'-9", 100'-9", 60'-6" & tie bearings.
Roadway: 28'-0" with 2'-0" safety curbs.
Load Frequency: CF=130 (S1)
Skew: 35°-56' R.F.
Wearing Surface: 3" Monolithic concrete.
Approach Slabs: AS-1-34 (25' long).
Alignment: Tangent.

Note:
Type and Length of piling, if any, to be determined after foundation survey has been completed.

Auger - 234

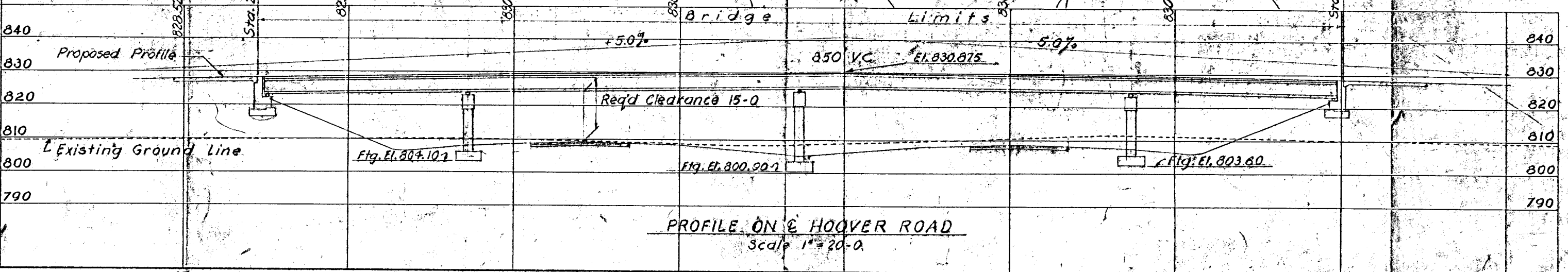
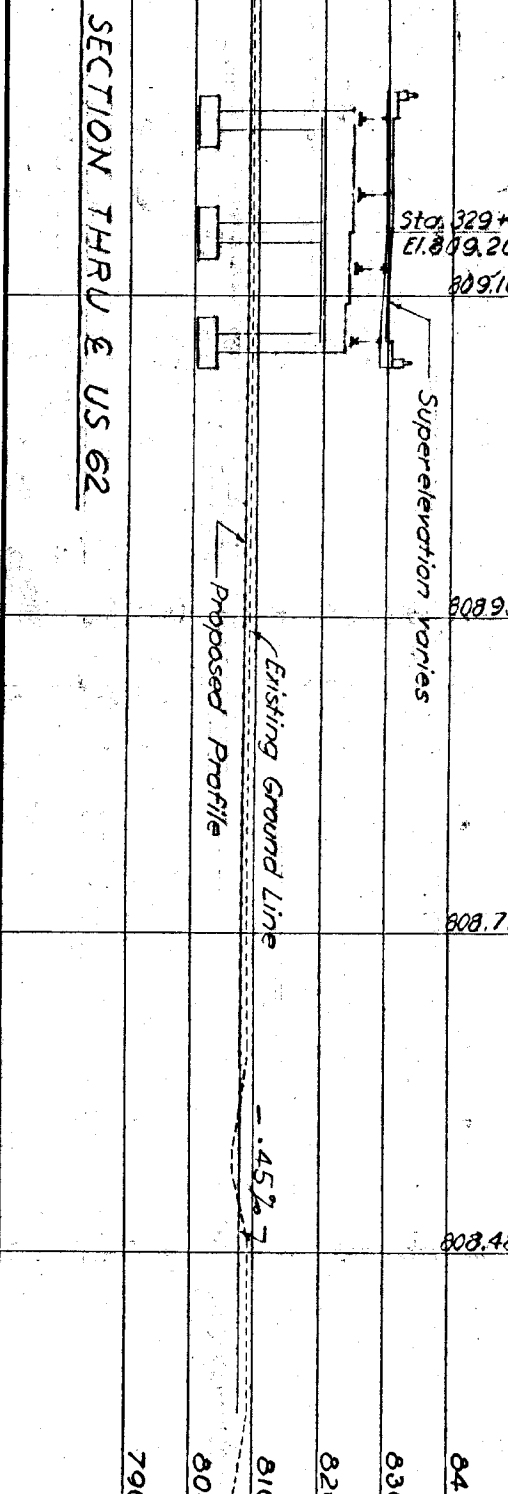

PROFILE ON HOVER ROAD
Scale 1" = 20'-0"

H. W. LOCHNER AND CO. CONSULTING ENGINEERS 20 N. WACKER DRIVE CHICAGO, ILLINOIS						
SITE PLAN						
BRIDGE NO. FRA-62-0624						
U.S. 62 UNDER HOOVER RD.						
FRANKLIN COUNTY				U.S. 62		
SEC. FRA-62-				STA. 329+39.73		
DESIGNED	DRAWN	TRACED	CHECKED	REVIEWED	DATE	REVISED
H.N.	H.N.		F.Z.	K.A.	5-7-57	

STATE OF OHIO
DEPARTMENT OF HIGHWAYS
TESTING LABORATORY
AND
BUREAU OF BRIDGES

FOUNDATION DATA

CO., RT. NO., SEC. FRA-62-1.42 BRIDGE NO. FRA-62-0624
 REAR PIER _____ US 62 UNDER HOOVER RD.
 LOCATION TH. B2A STA. 27+75 OFFSET 14' LT. FED. NO. I-609(10)

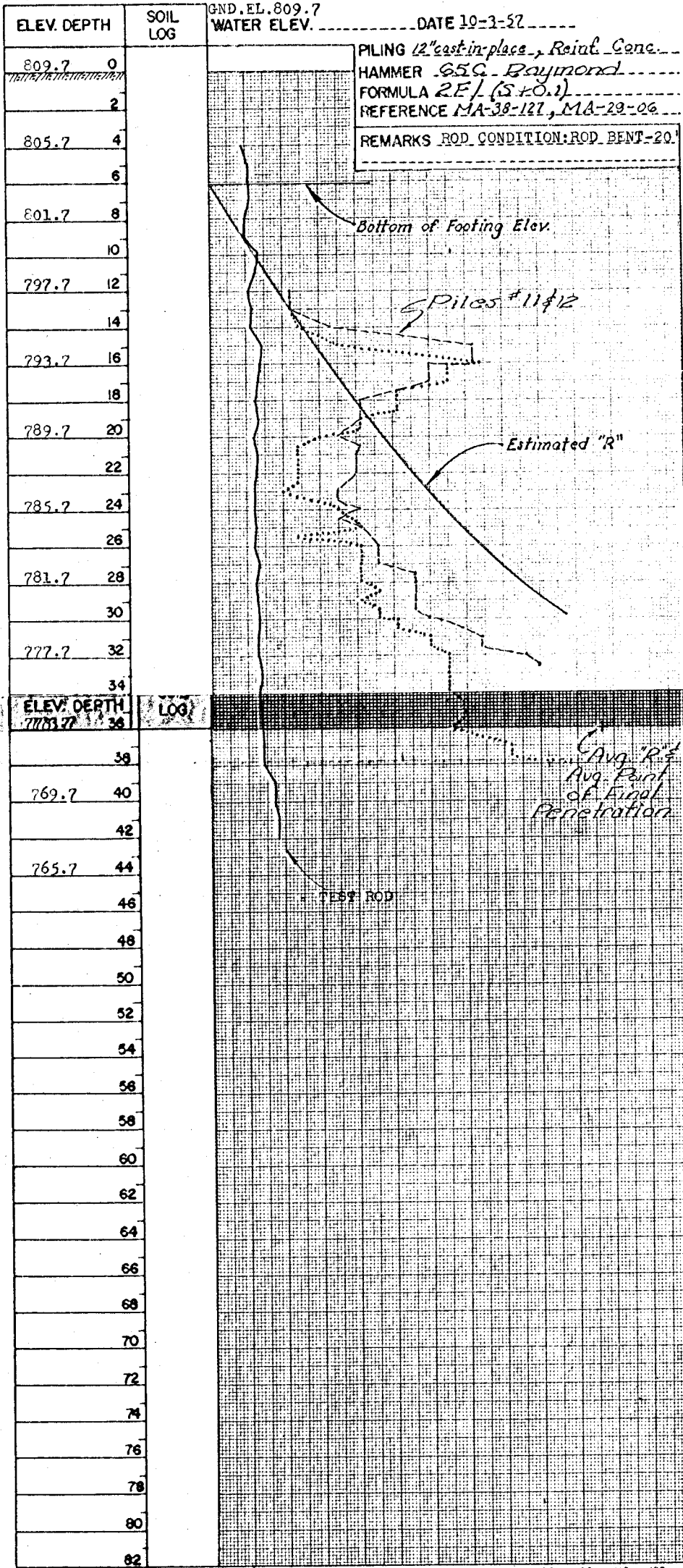

STATE OF OHIO
DEPARTMENT OF HIGHWAYS
TESTING LABORATORY
AND
BUREAU OF BRIDGES

FOUNDATION DATA

CO., RT. NO., SEC. FPA-62-1.42 BRIDGE NO. FPA-62-0624
BEAR ABUTMENT US 62 UNDER HOOVER RD.
 LOCATION TH. 31 STA. 27+13 OFFSET 14' LT. FED. NO. I-609 (10)

ELEV. DEPTH	SOIL LOG	WATER ELEV.	DATE
816.3	0	809.9	10-2-57
	2		
812.3	4		
	6		
808.3	8		
	10		
804.3	12		
	14		
800.3	16		
	18		
796.3	20		
	22		
792.3	24		
	26		
788.3	28		
	30		
784.2	32		
	34		
ELEV. DEPTH	LOG		
780.3	36		
	38		
776.3	40		
	42		
772.3	44		
	46		
	48		
	50		
	52		
	54		
	56		
	58		
	60		
	62		
	64		
	66		
	68		
	70		
	72		
	74		
	76		
	78		
	80		
	82		

Bottom of Footing Elev.

PILENG Spread Footing
 HAMMER
 FORMULA
 REFERENCE
 REMARKS ROD CONDITION: ROD BENT-32'

STATE OF OHIO
DEPARTMENT OF HIGHWAYS
TESTING LABORATORY
AND
BUREAU OF BRIDGES

FOUNDATION DATA

CO., RT. NO., SEC. FRA-62-1, 42 BRIDGE NO. FRA-62-0624
FORWARD PIER US 62 UNDER HOOVER RD.
LOCATION TH. B4A STA. 29+80 OFFSET 14' LT. FED. NO. X-603(10)

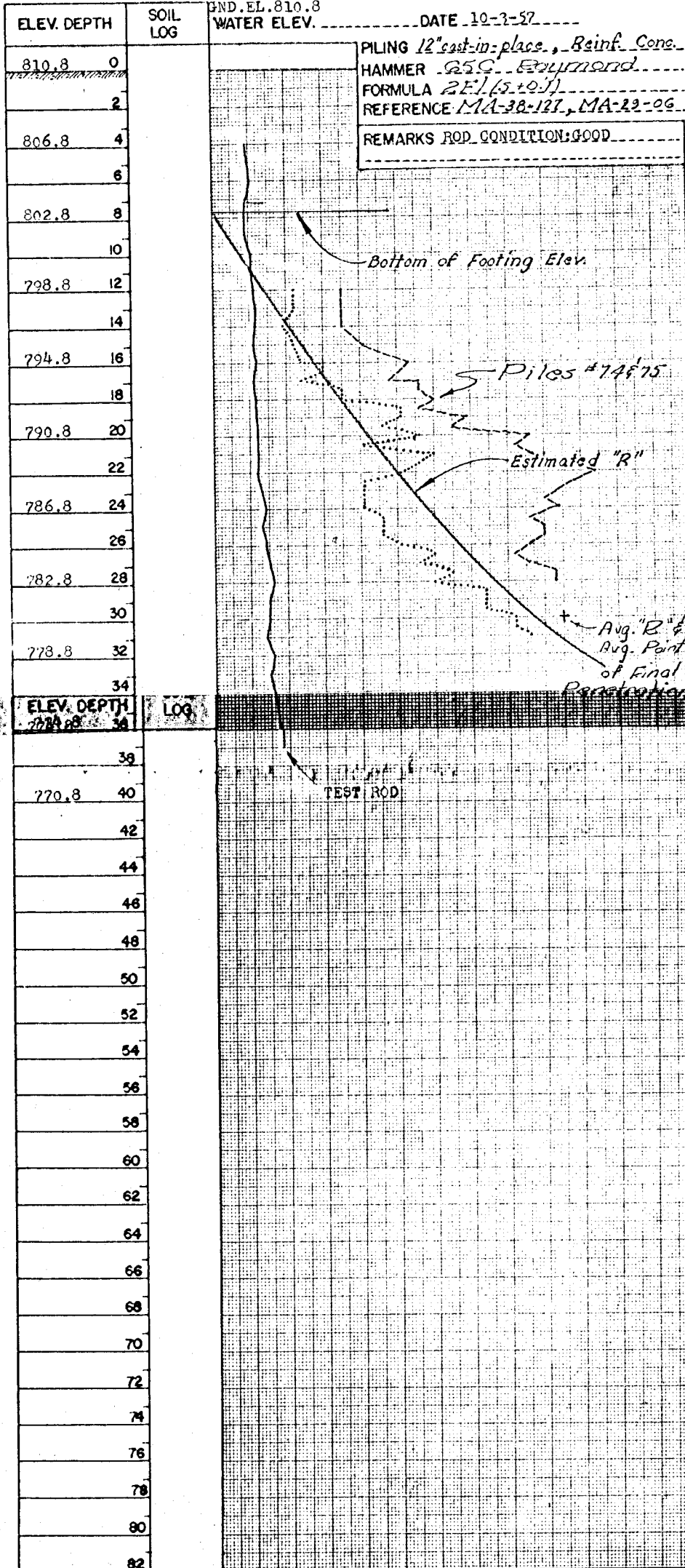

STATE OF OHIO
DEPARTMENT OF HIGHWAYS
TESTING LABORATORY
AND
BUREAU OF BRIDGES

FOUNDATION DATA

CO., RT. NO., SEC. FRA-62-1.42 BRIDGE NO. FRA-62-0624
 FORWARD ABUTMENT _____ US 62 UNDER HOOPER RD.
 LOCATION TH. 5 STA. 20+39 OFFSET 14' LT. FED. NO. I-609(10)

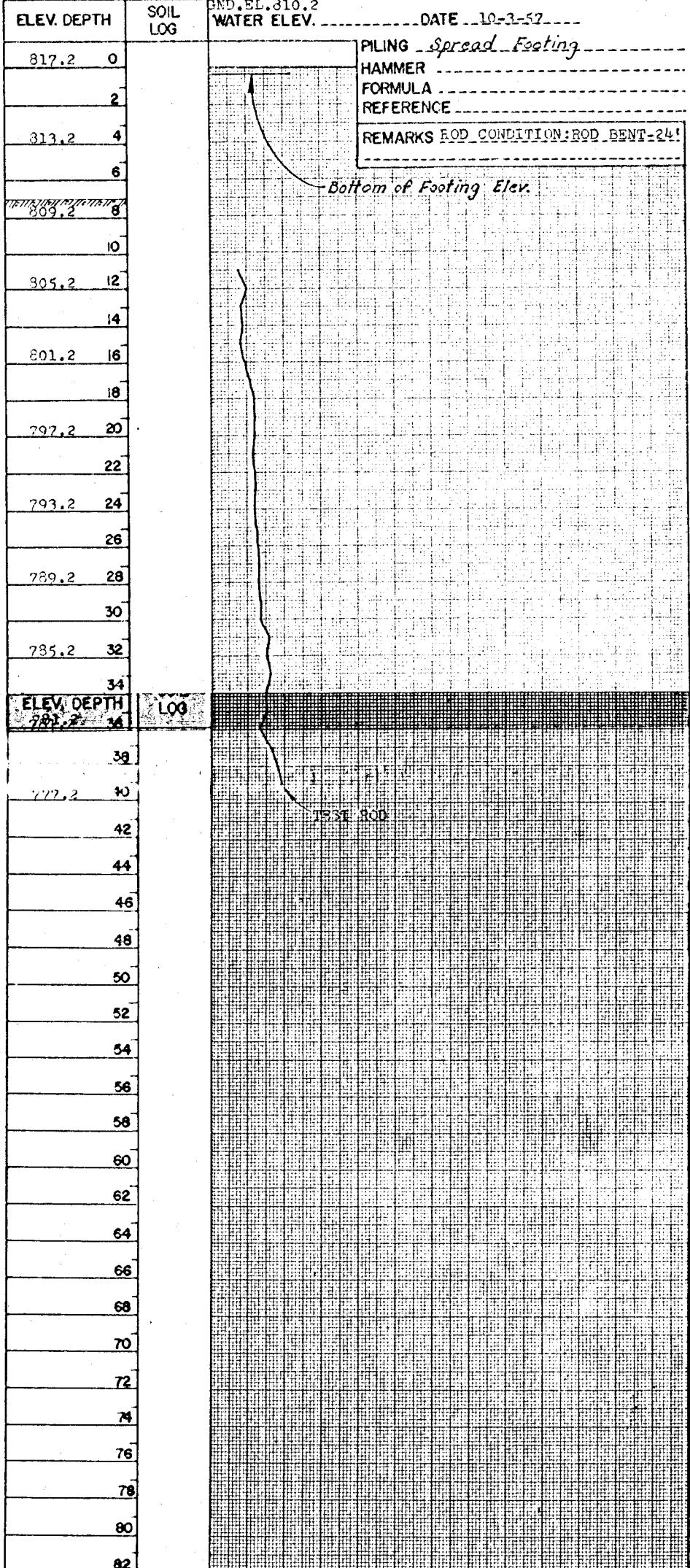

PILING Spread Footing
 HAMMER _____
 FORMULA _____
 REFERENCE _____
 REMARKS ROD CONDITION: ROD BENT-24'

Bottom of Footing Elev.

TEST ROD

STATE OF OHIO
DEPARTMENT OF HIGHWAYS
TESTING LABORATORY
AND
BUREAU OF BRIDGES

FOUNDATION DATA

CO., RT. NO. SEC. FRA-62-1.42 BRIDGE NO. FRA-62-0624
 REAR PIER US 62 UNDER HOOVER RD.
 LOCATION TH. B2 STA. 27+26 OFFSET 14' RT. FED. NO. I-603(02)

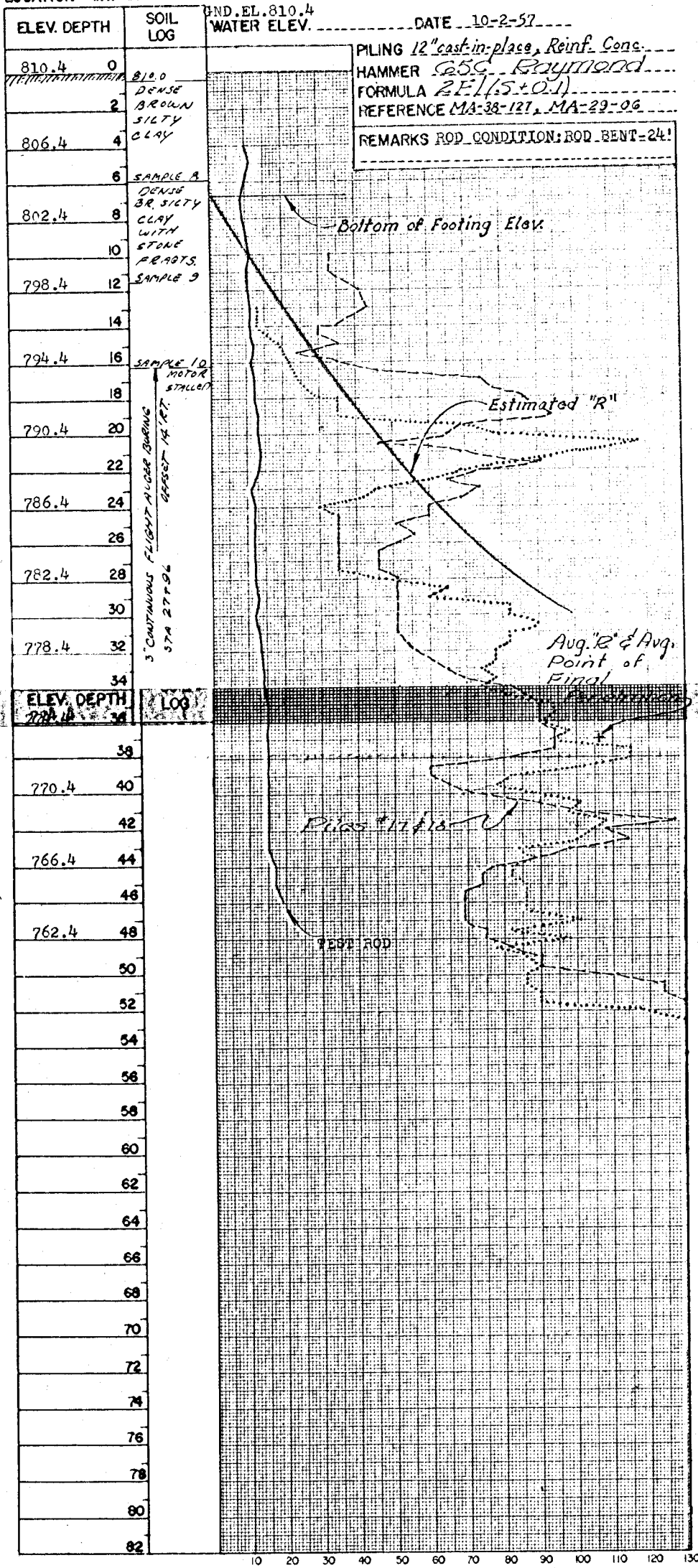

STATE OF OHIO
DEPARTMENT OF HIGHWAYS
TESTING LABORATORY
AND
BUREAU OF BRIDGES

FOUNDATION DATA

CO., RT. NO., SEC. FRA-62-1,42 BRIDGE NO. FRA-62-0624
 FORWARD PIER US 62 UNDER HOOVER FD.
 LOCATION TH. B4 STA. 29+28 OFFSET 14' RT. FED. NO. I-609(10)

