

STATE OF OHIO DEPARTMENT OF TRANSPORTATION

LOG-33-9.58

MCARTHUR TOWNSHIP LOGAN COUNTY

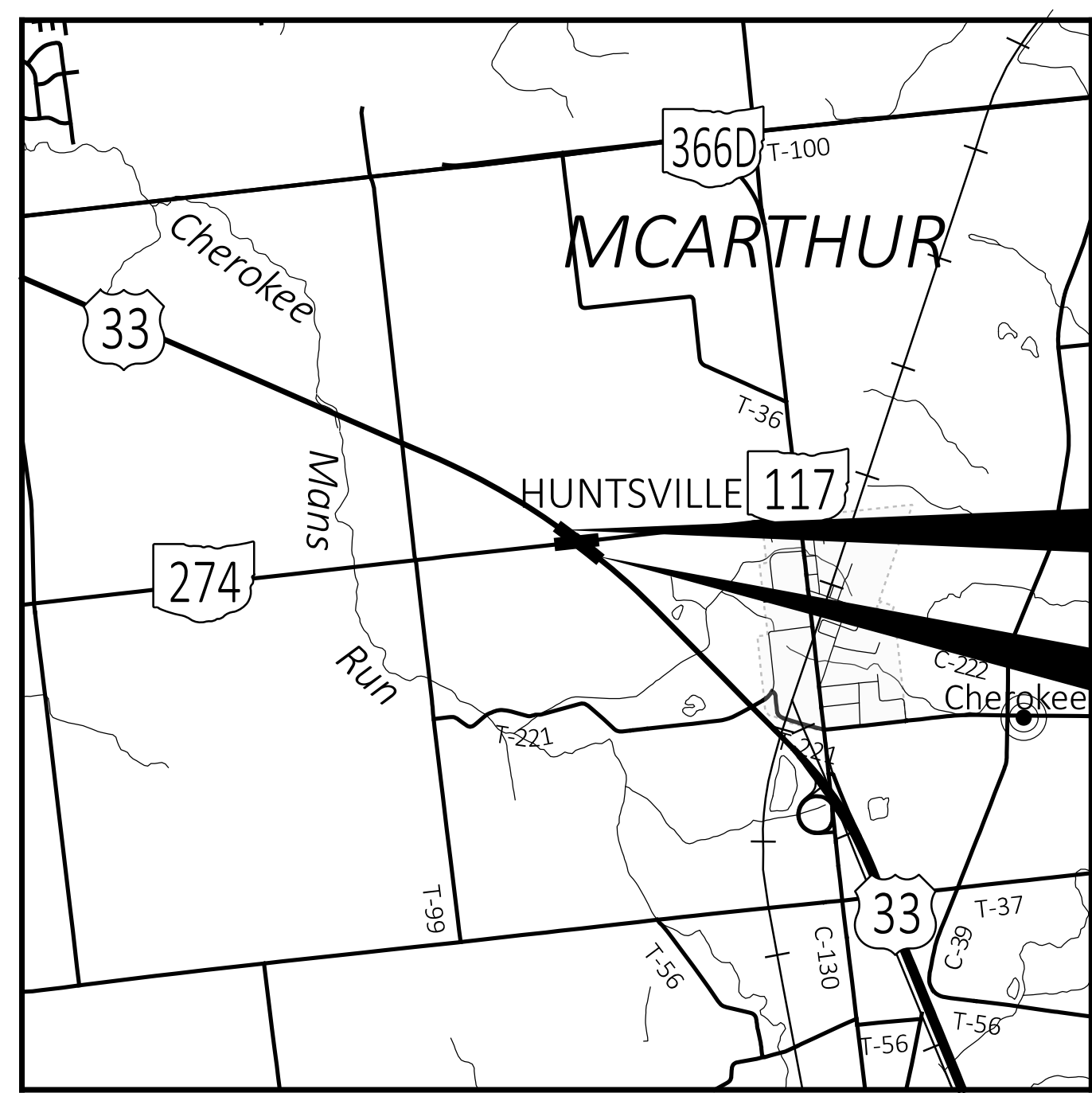

LOCATION MAP

LATITUDE: 40°26'45" N LONGITUDE: 83°49'10" W



PORTION TO BE IMPROVED	=====
INTERSTATE HIGHWAY	=====
FEDERAL ROUTES	=====
STATE ROUTES	=====
COUNTY & TOWNSHIP ROADS	=====
OTHER ROADS	=====

DESIGN DESIGNATION	SR 274	
	US 33	(WEST LEG)
CURRENT ADT (2024)	13,131	5,146
DESIGN YEAR ADT (2044)	17,994	8,695
DESIGN HOURLY VOLUME (2044)	1,743	1,031
DIRECTIONAL DISTRIBUTION	52%	62%
TRUCKS (24 HOUR B&C)	19%	18%
DESIGN SPEED	60 MPH	60 MPH
LEGAL SPEED	55 MPH	55 MPH
DESIGN FUNCTIONAL CLASSIFICATION:	03 - PRINCIPLE ARTERIAL (RURAL)	05 - MAJOR COLLECTOR (RURAL)
NHS PROJECT	YES	NO

DESIGN EXCEPTIONS

NONE REQUIRED

ADA DESIGN WAIVERS

NONE REQUIRED

UNDERGROUND UTILITIES
Contact Two Working Days
Before You Dig

OHIO811.org
Before You Dig

OHIO811, 8-1-1, or 1-800-362-2764
(Non members must be called directly)

PLAN PREPARED BY:

Evans, Mechwart, Homblston & Tilton, Inc.
Engineers • Surveyors • Planners • Scientists
5300 New Albany Road, Columbus, OH 43254
Phone: 614.775.4500 Fax: 614.775.4800

INDEX OF SHEETS:

TITLE SHEET	P.1
SCHEMATIC PLAN	P.2 - P.4
TYPICAL SECTIONS	P.5 - P.8
GENERAL NOTES	P.9 - P.10
MAINTENANCE OF TRAFFIC	P.11 - P.54
GENERAL SUMMARY	P.55 - P.57
SUBSUMMARIES	P.58 - P.60
PROJECT SITE PLAN	P.61
PLAN AND PROFILES - US 33	P.62 - P.66
PLAN AND PROFILES - SR 274	P.67 - P.69
CROSS SECTIONS - US 33	P.70 - P.78
CROSS SECTIONS - SR 274	P.79 - P.87
INTERSECTION DETAILS	P.88
ROUNDABOUT PROFILES	P.89 - P.91
SPLITTER ISLAND DETAILS	P.92 - P.93
TRUCK APRON DETAILS	P.94
DRIVE DETAILS	P.95
GRADING PLAN	P.96 - P.97
CULVERT DETAILS	P.98 - P.100
STORM PROFILES	P.101 - P.102
TRAFFIC CONTROL	P.103 - P.114
LIGHTING PLAN	P.115 - P.118
GEOTECHNICAL PROFILE - ROADWAY	P.119 - P.126
RIGHT OF WAY PLANS	

FEDERAL PROJECT NUMBER

E230274

RAILROAD INVOLVEMENT

NONE

PROJECT DESCRIPTION

CONSTRUCT A SINGLE LANE ROUNDABOUT AT US-33 AND SR-274 IN MCARTHUR TOWNSHIP, LOGAN COUNTY TO IMPROVE TRAFFIC SAFETY. IMPROVEMENTS INCLUDE CONSTRUCTION OF ASPHALT PAVEMENT, CURB AND GUTTER, STREET LIGHTING AND TRAFFIC CONTROL OVER A LENGTH OF 0.22 MILES ALONG US 33 AND A LENGTH OF 0.21 MILES ALONG SR 274.

EARTH DISTURBED AREAS

PROJECT EARTH DISTURBED AREA:	8.6 ACRES
ESTIMATED CONTRACTOR EARTH DISTURBED AREA:	0.2 ACRES
NOTICE OF INTENT EARTH DISTURBED AREA:	8.8 ACRES

LIMITED ACCESS

THIS IMPROVEMENT IS ESPECIALLY DESIGNED FOR THROUGH TRAFFIC AND HAS BEEN DECLARED A LIMITED ACCESS HIGHWAY OR FREEWAY BY ACTION OF THE DIRECTOR IN ACCORDANCE WITH THE PROVISIONS OF SECTION 5511.02 OF THE OHIO REVISED CODE.

2023 SPECIFICATIONS

THE STANDARD SPECIFICATIONS OF THE STATE OF OHIO, DEPARTMENT OF TRANSPORTATION, INCLUDING SUPPLEMENTAL SPECIFICATIONS LISTED IN THE PLANS, CHANGES LISTED IN THE PROPOSAL, AND THE SUPPLEMENTAL SPECIFICATION 800 VERSION INDICATED ON THE PROPOSAL SHALL GOVERN THIS IMPROVEMENT.

I HEREBY APPROVE THESE PLANS AND DECLARE THAT THE MAKING OF THIS IMPROVEMENT WILL NOT REQUIRE THE CLOSING TO TRAFFIC OF THE HIGHWAY EXCEPT FOR THE SIDE ROADS AS DESCRIBED ON SHEETS P.15 - P.16 AND THAT PROVISIONS FOR THE MAINTENANCE AND SAFETY OF TRAFFIC WILL BE AS SET FORTH ON THE PLANS AND ESTIMATES.

John W. O'Brien
District 07 Deputy Director

Pamela Boratyn
Director, Department of Transportation

STANDARD CONSTRUCTION DRAWINGS							SUPPLEMENTAL SPECIFICATIONS		SPECIAL PROVISIONS	
BP-3.1	1/19/24	RM-1.1	1/20/23	TC-41.30	4/21/23	HL-60.31	7/19/24	800-2023	7/18/25	WATERWAY PERMIT 7/03/2025
BP-4.1	7/19/13			TC-42.20	10/18/13			813	7/21/23	
BP-5.1	1/16/26			TC-52.10	10/18/13			825	7/19/24	
				TC-52.20	1/15/21			832	7/18/25	
CB-2-2A, 2B, 2C	7/19/24			TC-65.10	1/17/14			902	7/19/19	
		MT-95.45	7/21/23	TC-65.11	1/17/25			913	4/16/21	
DM-1.1	1/17/25	MT-97.10	7/18/25	TC-71.10	7/18/25					
DM-1.2	1/17/25	MT-97.12	7/18/25							
DM-4.3	1/15/16	MT-99.30	1/17/20	HL-10.11	7/21/23					
DM-4.4	1/15/16	MT-101.60	1/17/25	HL-10.12	7/21/23					
		MT-101.70	7/19/24	HL-10.13	1/20/23					
F-2.1	7/20/18	MT-101.75	7/21/23	HL-20.11	7/18/25					
		MT-101.90	7/17/20	HL-30.11	7/21/23					
HW-2.1	7/15/22	MT-105.10	1/17/20	HL-30.21	4/17/20					
HW-2.2	7/20/18			HL-40.20	7/18/25					
				HL-60.11	7/21/17					

ENGINEERS SEAL:

ENGINEERS SEAL:

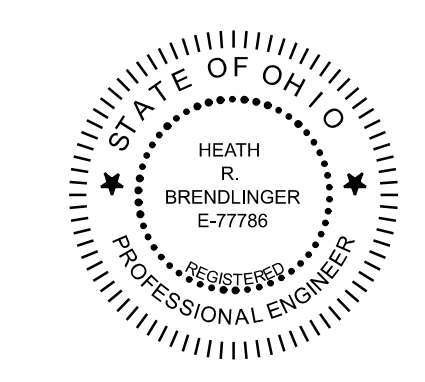

FOR LIGHTING PLANS:
P. 115 - P. 118

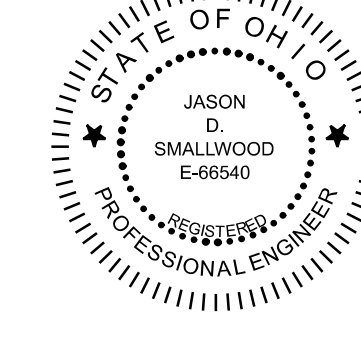

DESIGN AGENCY	
DESIGNER	JDK
REVIEWER	HRB
PROJECT ID	118109
SHEET	P.1
TOTAL	126

TITLE SHEET

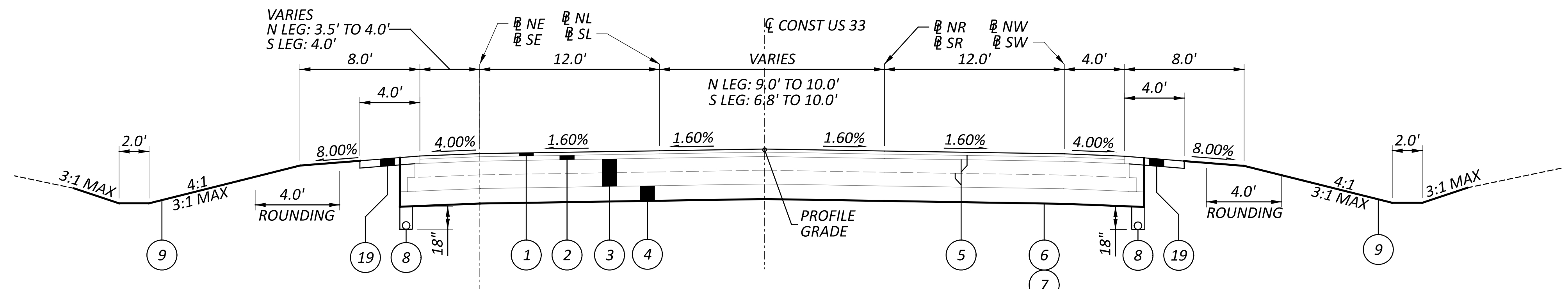
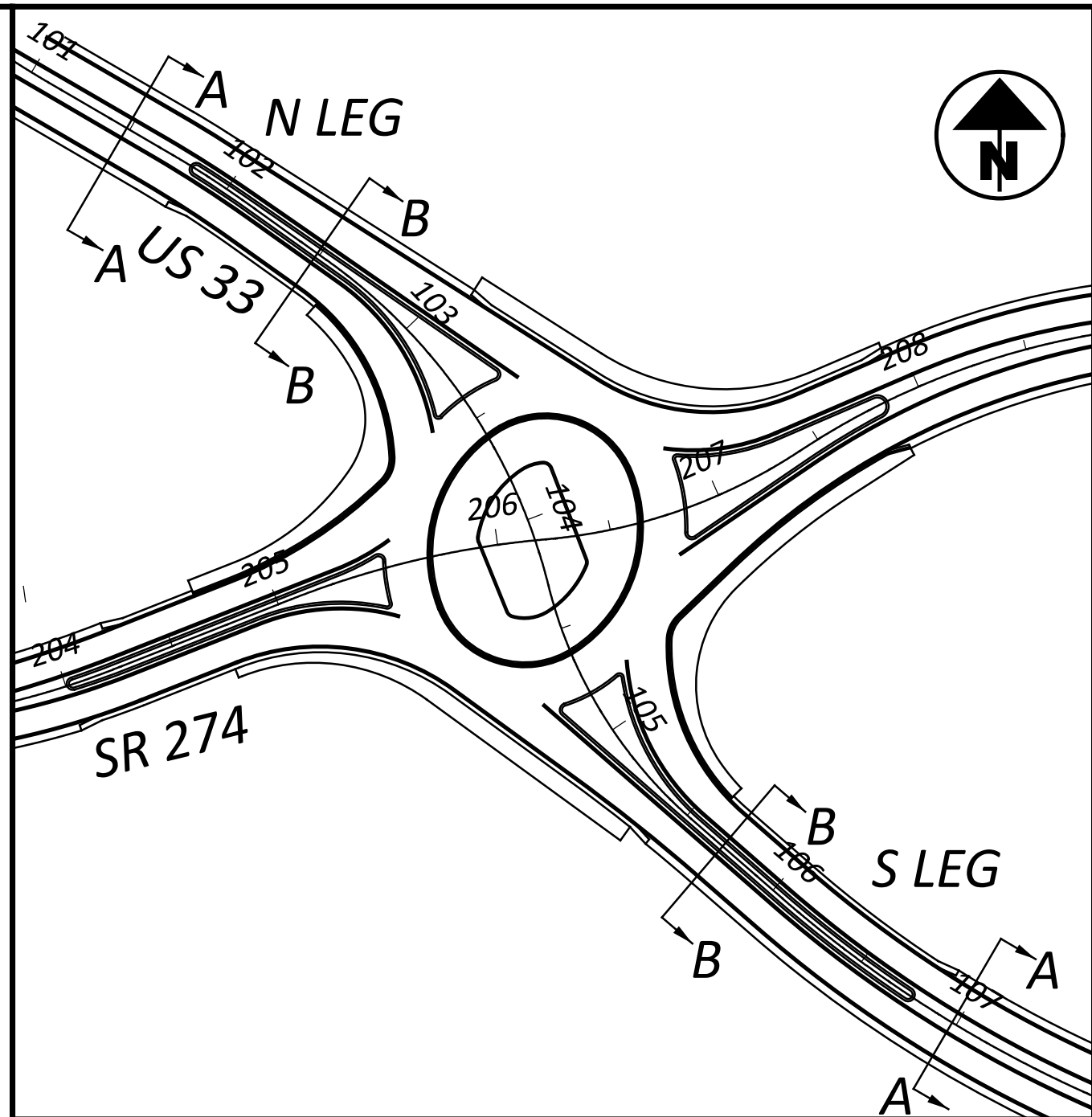

**PROPOSED SECTION A-A
US 33**

STA 100+00.00 TO STA 101+00.00 N LEG
 STA 106+78.00 TO STA 112+21.69 S LEG

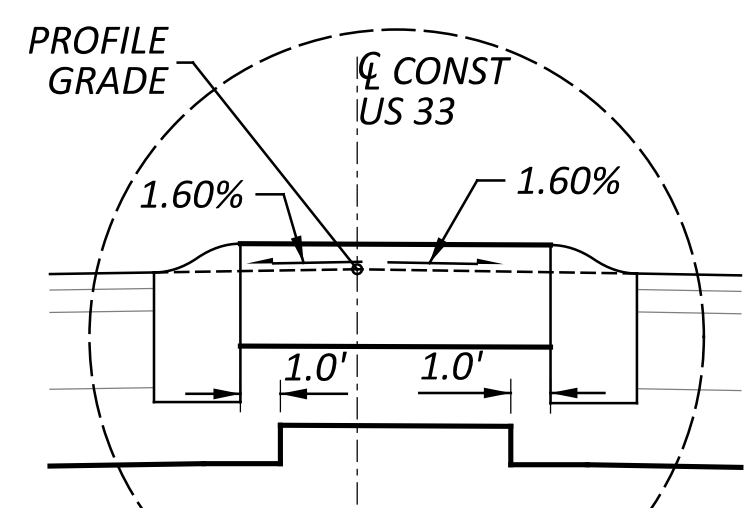

P1 PROFILE GRADE

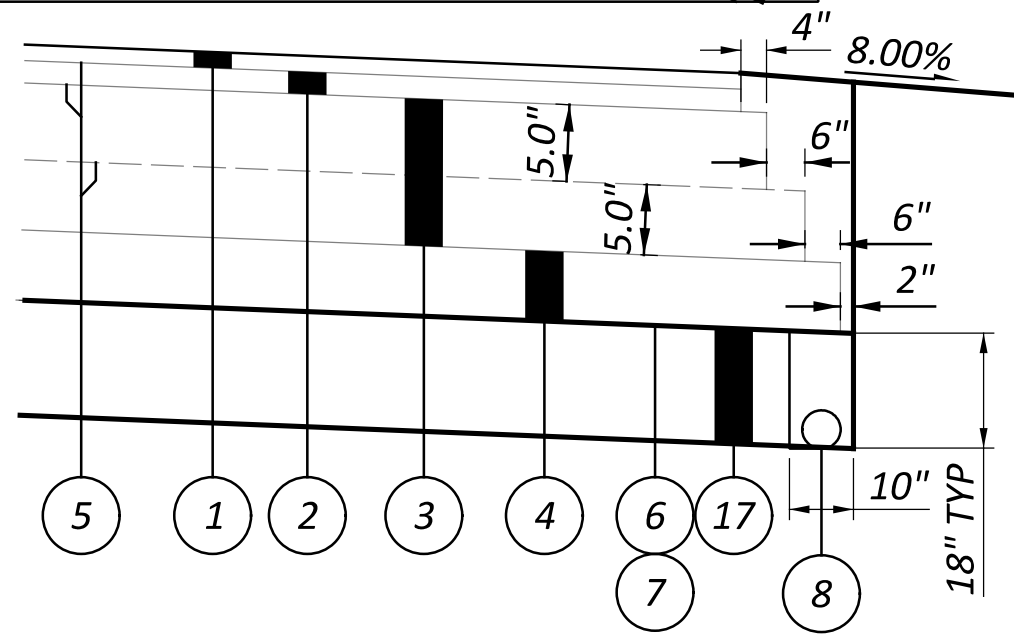

* - EXCAVATE AND REPLACE APPLIES TO ALL TYPICAL SECTIONS

PROPOSED LEGEND **STEP DETAIL**

- 1 ITEM 442 - 1.50" ASPHALT CONCRETE SURFACE COURSE, 12.5 MM TYPE A, (448) PG70-22
- 2 ITEM 442 - 1.75" ASPHALT CONCRETE INTERMEDIATE COURSE, 12.5 MM, TYPE A, (448) PG64-28
- 3 ITEM 302 - 10" ASPHALT CONCRETE BASE, PG64-22, (449) (2, 5.0" STEPS)
- 4 ITEM 304 - 6" AGGREGATE BASE
- 5 ITEM 407 - NON-TRACKING TACK COAT (@0.06 GAL/SY)
- 6 ITEM 204 - SUBGRADE COMPACTION
- 7 ITEM 204 - PROOF ROLLING
- 8 ITEM 605 - 6" BASE PIPE UNDERDRAINS
- 9 ITEM 659 - SEEDING AND MULCHING
 ITEM 653 - 4" TOPSOIL FURNISHED AND PLACED
 ITEM 609 - COMBINATION CURB & GUTTER, TYPE 3
- 11 ITEM 609 - CURB, TYPE 3-B, AS PER PLAN
- 12 ITEM 452 - NON-REINFORCED CONCRETE PAVEMENT, MISC.: CONCRETE STAINED, CLASS QC 1P, 8"
- 13 ITEM 452 - 8" NON-REINFORCED CONCRETE PAVEMENT, CLASS QC 1P
- 14 ITEM 609 - COMBINATION CURB & GUTTER, TYPE 9
- 15 ITEM 304 - 8" AGGREGATE BASE
- 16 ITEM 609 - CURB, TYPE 10
- 17 ITEM 204 - EXCAVATION OF SUBGRADE, 18" DEEP
 ITEM 204 - GRANULAR MATERIAL, TYPE B
 ITEM 204 - GEOTEXTILE FABRIC
- 18 ITEM 601 - ROCK CHANNEL PROTECTION, TYPE D WITH GEOTEXTILE FABRIC, AS PER PLAN
- 19 ITEM 411 - STABILIZED CRUSHED AGGREGATE

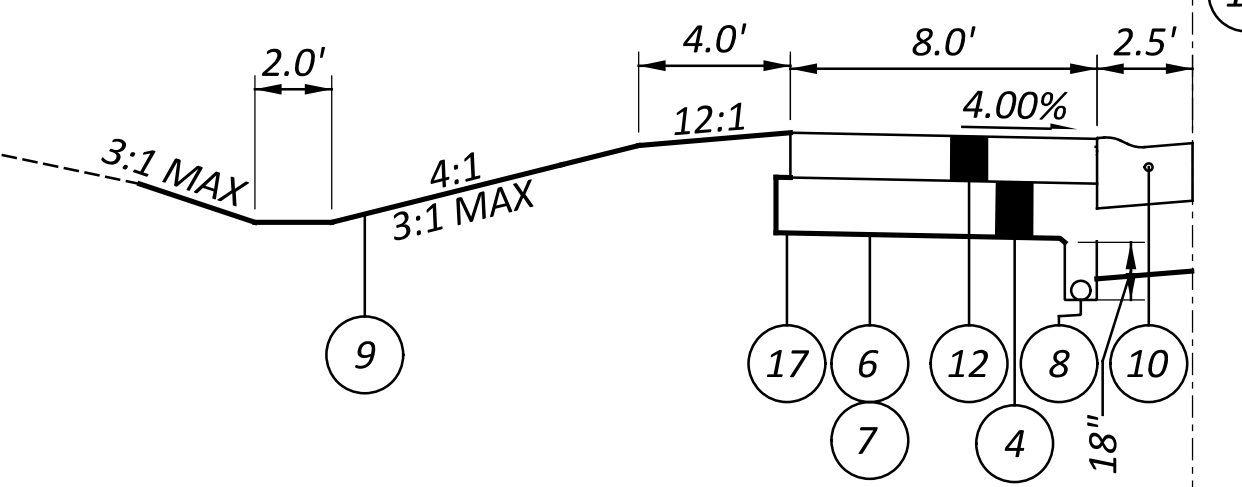

**PROPOSED SECTION B-B
US 33**

STA 101+00.00 TO STA 103+39.76 N LEG
 STA 104+80.92 TO STA 106+78.00 S LEG

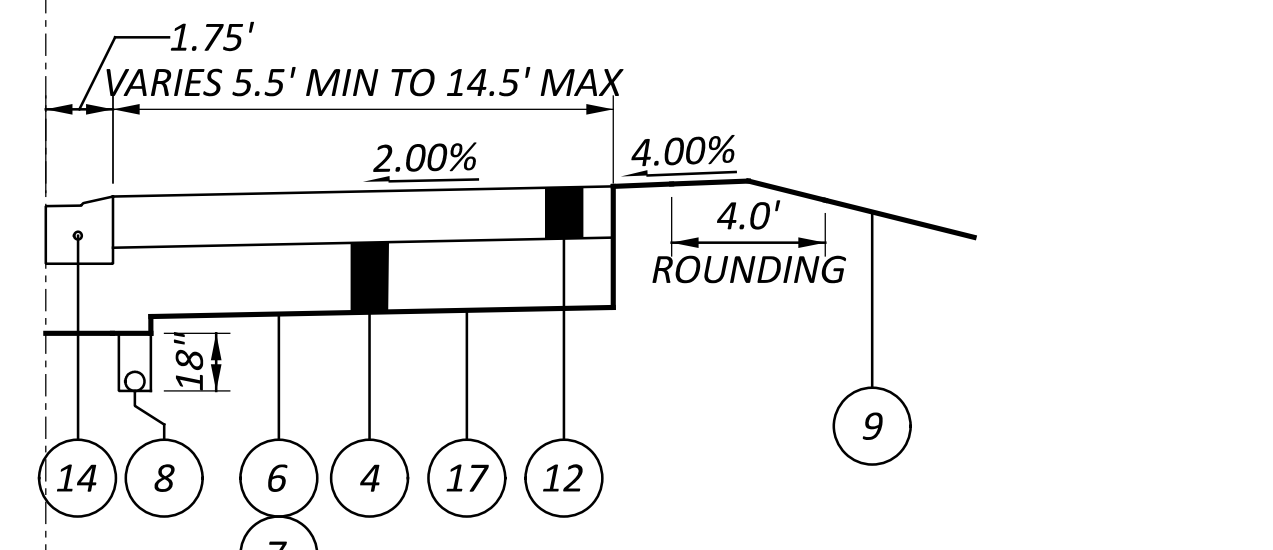

SECTION APPLIES:
 STA 102+61.97 TO STA 103+39.76 N LEG

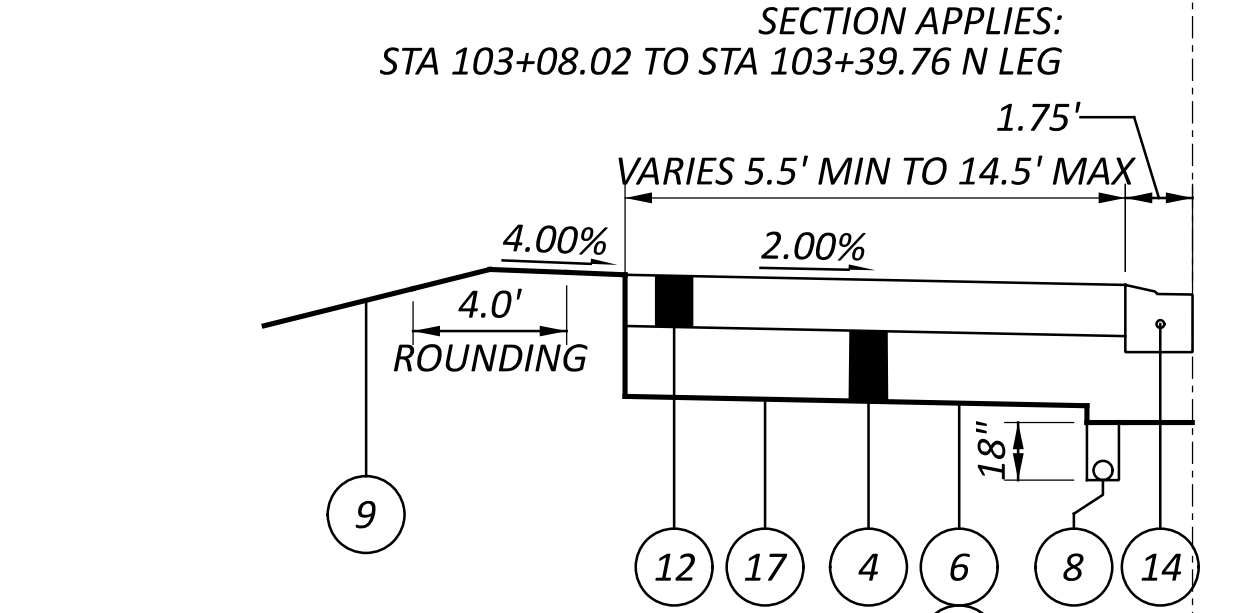

SECTION APPLIES:
 STA 104+80.92 TO STA 105+59.61 S LEG

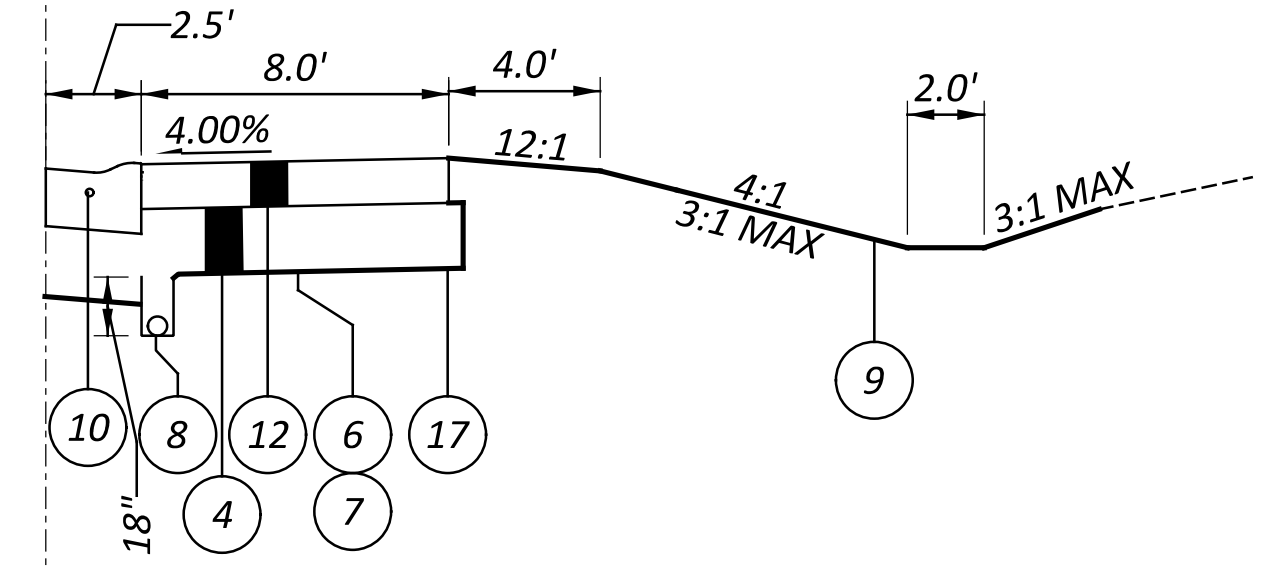

SECTION APPLIES:
 STA 104+80.92 TO STA 105+36.12

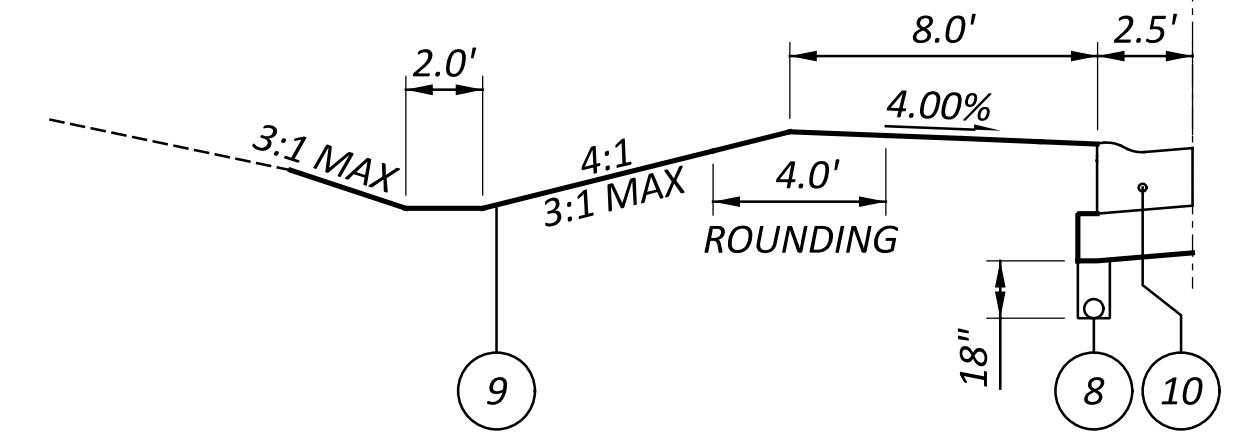

SECTION APPLIES:
 STA 105+59.61 TO STA 106+78.00 S LEG

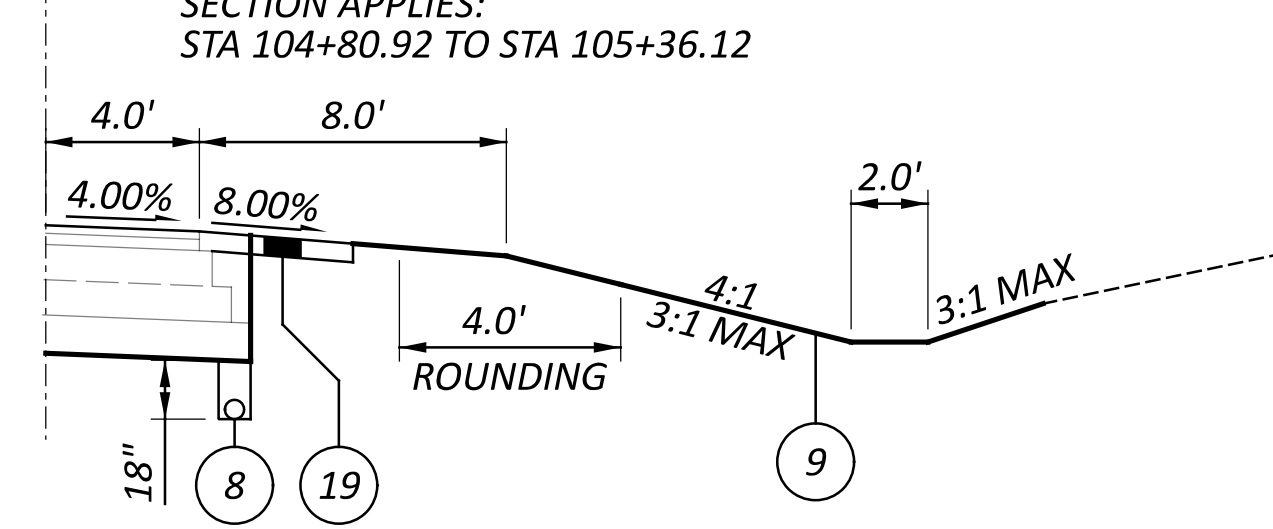

SECTION APPLIES:
 STA 105+45.06 TO STA 106+78.00 S LEG

* CROSS SLOPES WITHIN THE LIMITS OF THE SPLITTER ISLANDS ARE CONTROLLED BY THE INTERSECTION DETAILS.

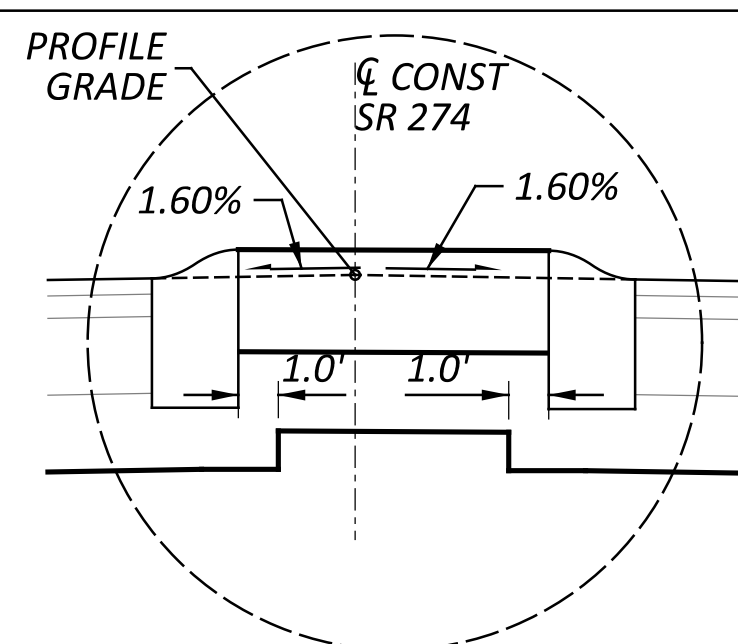
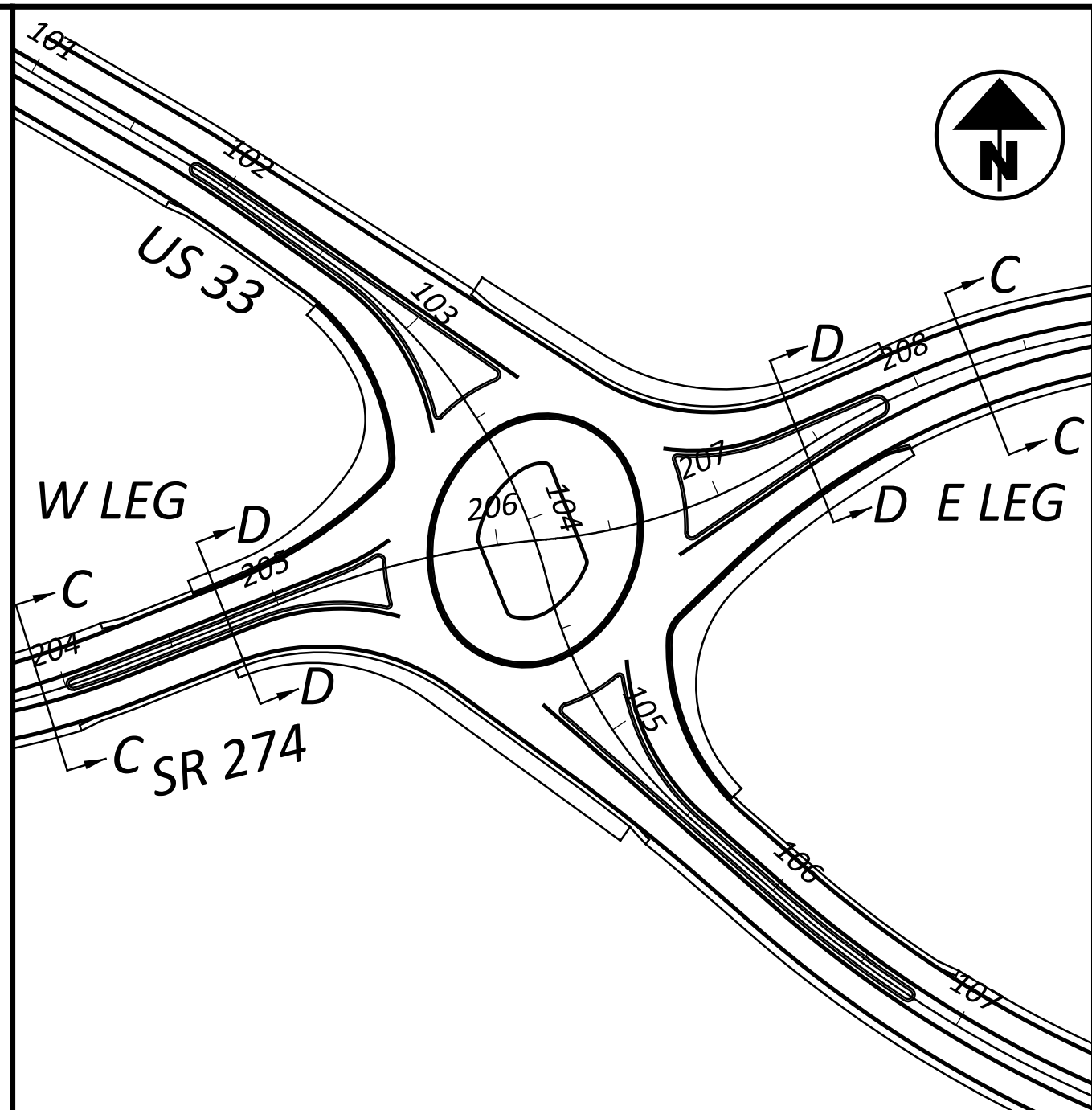

(P1) PROFILE GRADE
PROPOSED LEGEND

- 1 ITEM 442 - 1.50" ASPHALT CONCRETE SURFACE COURSE, 12.5 MM TYPE A, (448) PG70-22
- 2 ITEM 442 - 1.75" ASPHALT CONCRETE INTERMEDIATE COURSE, 12.5 MM, TYPE A, (448) PG64-28
- 3 ITEM 302 - 10" ASPHALT CONCRETE BASE, PG64-22, (449) (2, 5.0" STEPS)
- 4 ITEM 304 - 6" AGGREGATE BASE
- 5 ITEM 407 - NON-TRACKING TACK COAT (@0.06 GAL/SY)
- 6 ITEM 204 - SUBGRADE COMPACTION
- 7 ITEM 204 - PROOF ROLLING
- 8 ITEM 605 - 6" BASE PIPE UNDERDRAINS
- 9 ITEM 659 - SEEDING AND MULCHING
ITEM 653 - 4" TOPSOIL FURNISHED AND PLACED
ITEM 609 - COMBINATION CURB & GUTTER, TYPE 3
- 11 ITEM 609 - CURB, TYPE 3-B, AS PER PLAN
- 12 ITEM 452 - NON-REINFORCED CONCRETE PAVEMENT, MISC.: CONCRETE STAINED, CLASS QC 1P, 8"
- 13 ITEM 452 - 8" NON-REINFORCED CONCRETE PAVEMENT, CLASS QC 1P
- 14 ITEM 609 - COMBINATION CURB & GUTTER, TYPE 9
- 15 ITEM 304 - 8" AGGREGATE BASE
- 16 ITEM 609 - CURB, TYPE 10
- 17 ITEM 204 - EXCAVATION OF SUBGRADE, 18" DEEP
ITEM 204 - GRANULAR MATERIAL, TYPE B
ITEM 204 - GEOTEXTILE FABRIC
- 18 ITEM 601 - ROCK CHANNEL PROTECTION, TYPE D WITH GEOTEXTILE FABRIC, AS PER PLAN
- 19 ITEM 411 - STABILIZED CRUSHED AGGREGATE

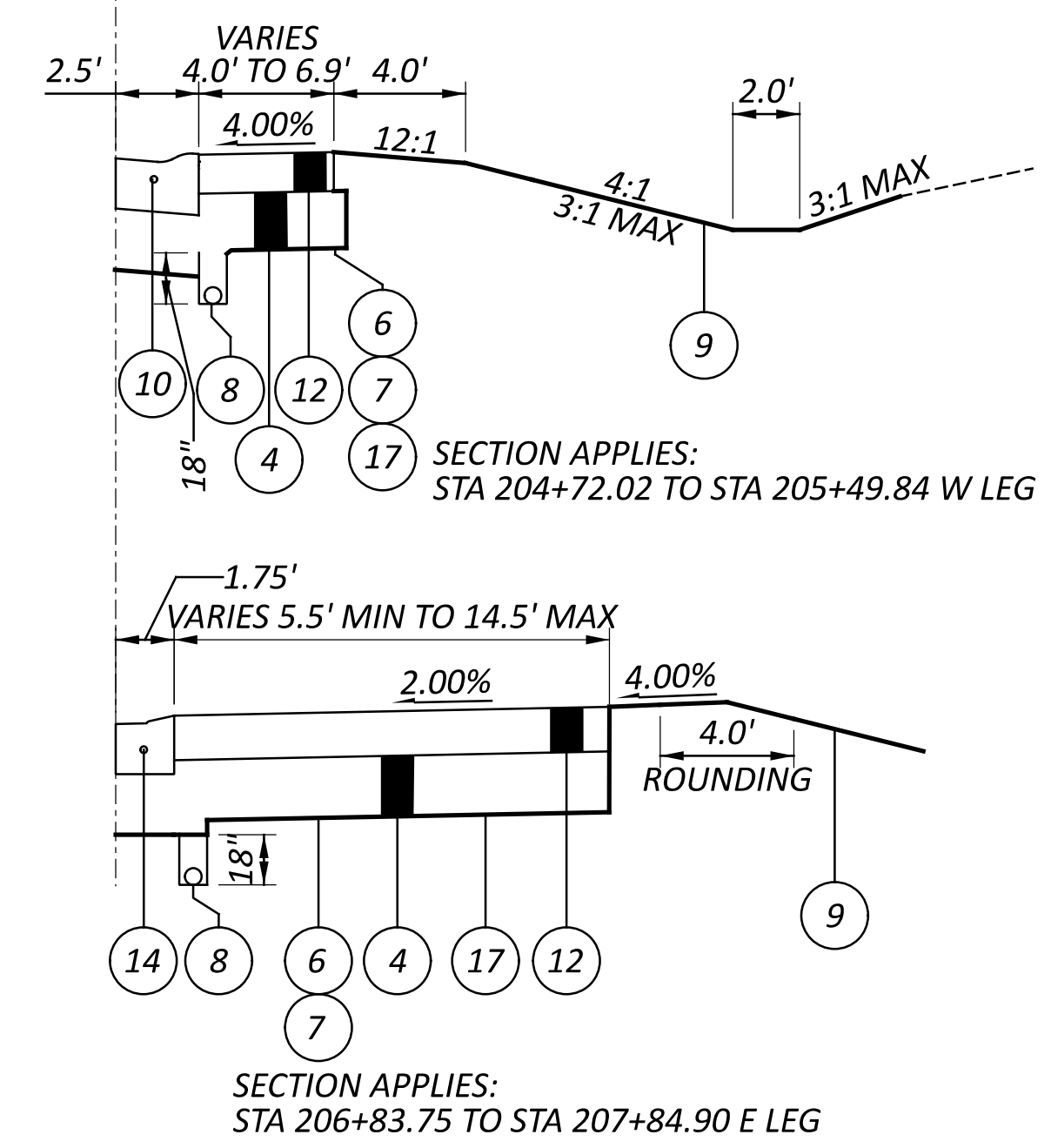
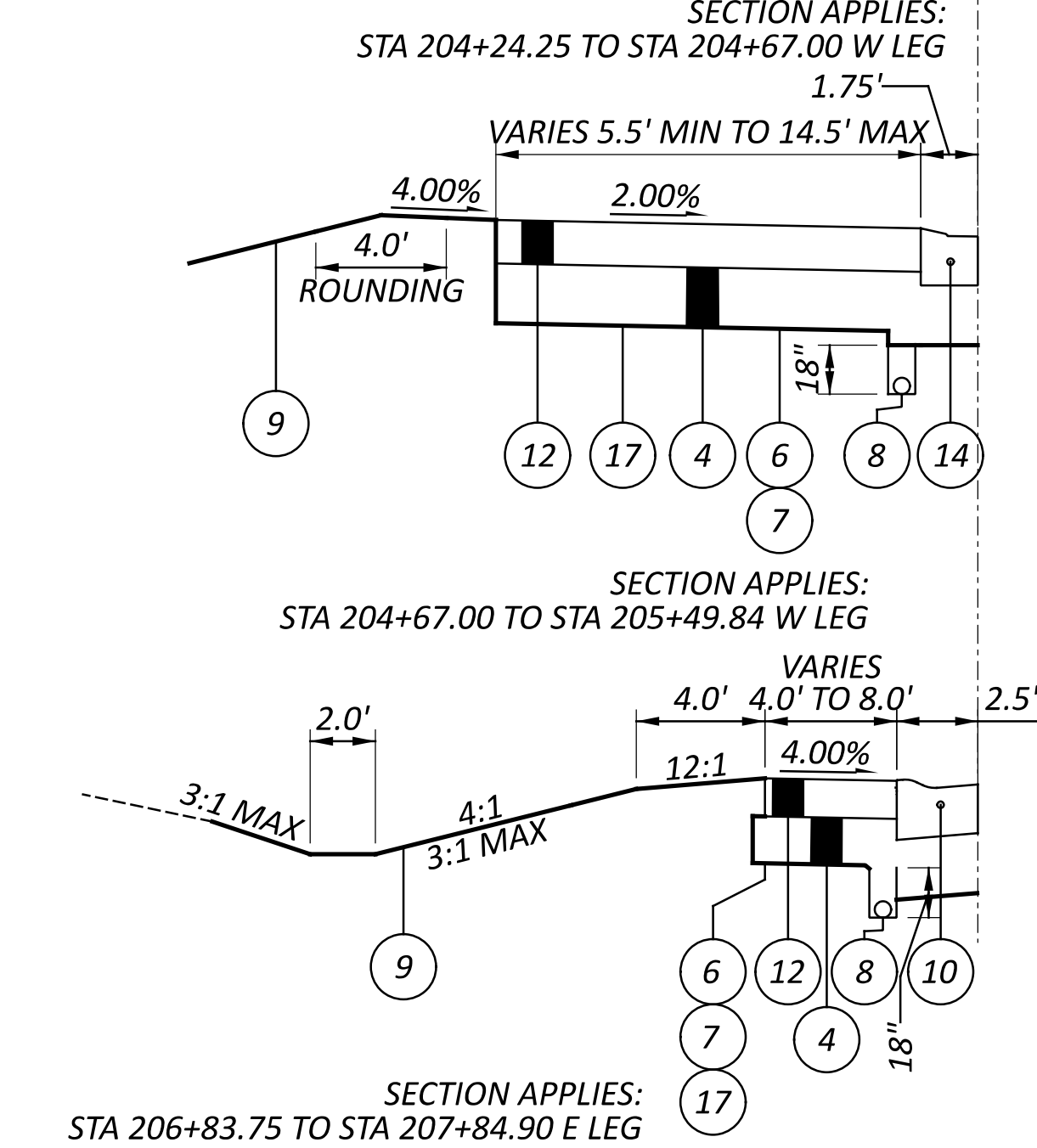
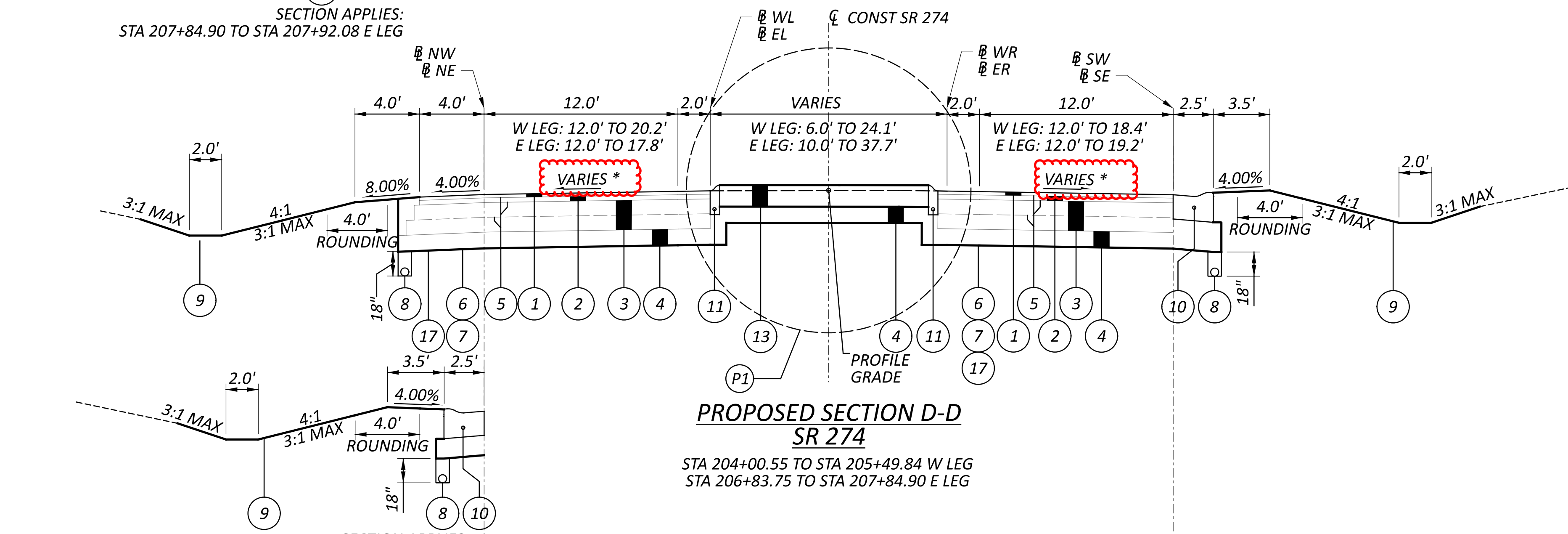
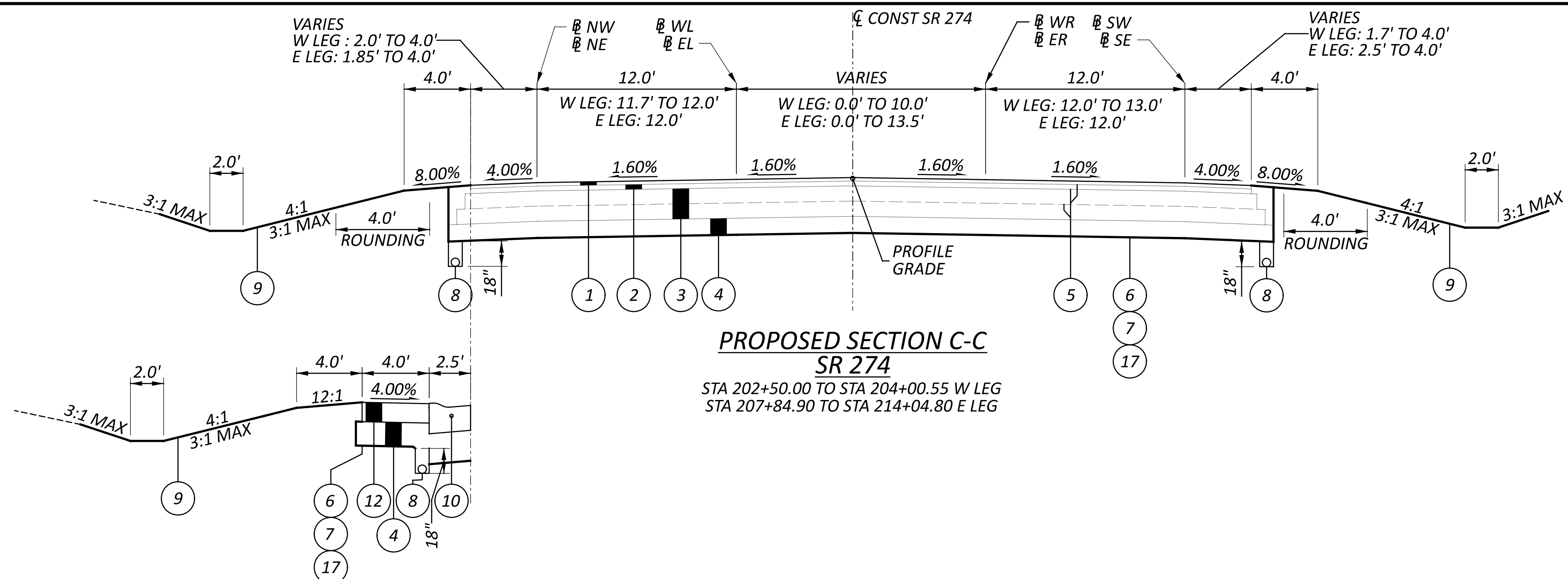

* CROSS SLOPES WITHIN THE LIMITS OF THE SPLITTER ISLANDS ARE CONTROLLED BY THE INTERSECTION DETAILS.

SHEET NUMBER												PART.	ITEM	ITEM	GRAND	UNIT	DESCRIPTION	SEE SHEET NO.
P.10	P.58	P.59	P.104	P.105	P.106	P.116						01/SAF	EXT	TOTAL				
PAVEMENT																		
20												20	251	01001	20	SY	PARTIAL DEPTH PAVEMENT REPAIR (441), AS PER PLAN	P.10
		2,705										2,705	302	56000	2,705	CY	ASPHALT CONCRETE BASE, PG64-22, (449)	
		2,103										2,103	304	20000	2,103	CY	AGGREGATE BASE	
		1,596										1,596	407	20000	1,596	GAL	NON-TRACKING TACK COAT	
		66										66	411	10000	66	CY	STABILIZED CRUSHED AGGREGATE	
		398										398	442	20000	398	CY	ASPHALT CONCRETE SURFACE COURSE, 12.5 MM, TYPE A (448), PG70-22	
		464										464	442	20170	464	CY	ASPHALT CONCRETE INTERMEDIATE COURSE, 12.5 MM, TYPE A (448)	
		764										764	452	12010	764	SY	8" NON-REINFORCED CONCRETE PAVEMENT, CLASS QC 1P	
		1,205										1,205	452	19200	1,205	SY	NON-REINFORCED CONCRETE PAVEMENT, MISC.:CONCRETE STAINED, CLASS QC 1P, 8"	P.10
	806											806	609	18000	806	FT	COMBINATION CURB AND GUTTER, TYPE 3	
	1,529											1,529	609	22001	1,529	FT	CURB, TYPE 3-B, AS PER PLAN	P.8
	722											722	609	31000	722	FT	COMBINATION CURB AND GUTTER, TYPE 9	
	180											180	609	33000	180	FT	CURB, TYPE 10	
LIGHTING																		
						13						13	625	00450	13	EACH	CONNECTION, FUSED PULL APART	
						13						13	625	00460	13	EACH	CONNECTION, UNFUSED PULL APART	
						18						18	625	00480	18	EACH	CONNECTION, UNFUSED PERMANENT	
						13						13	625	10491	13	EACH	LIGHT POLE, CONVENTIONAL, AS PER PLAN, (AT10B30)	P.115
						13						13	625	14000	13	EACH	LIGHT POLE FOUNDATION, 24" X 6' DEEP	
						699						699	625	23200	699	FT	NO. 4 AWG 2400 VOLT DISTRIBUTION CABLE	
						1,560						1,560	625	23400	1,560	FT	NO. 10 AWG POLE AND BRACKET CABLE	
						2,071						2,071	625	24320	2,071	FT	1-1/2" DUCT CABLE WITH THREE NO. 4 AWG 2400 VOLT CABLES	
						20						20	625	25408	20	FT	CONDUIT, 2", 725.051	
						203						203	625	25600	203	FT	CONDUIT, 4", 725.04	
						13						13	625	26253	13	EACH	LUMINAIRE, CONVENTIONAL, SOLID STATE (LED), AS PER PLAN, 120V	P.115
						2,042						2,042	625	29000	2,042	FT	TRENCH	
						5						5	625	30700	5	EACH	PULL BOX, 725.08, 18"	
						2						2	625	30706	2	EACH	PULL BOX, 725.08, 24"	
						13						13	625	32000	13	EACH	GROUND ROD	
						1						1	625	34001	1	EACH	POWER SERVICE, AS PER PLAN	P.115
						2,042						2,042	625	36010	2,042	FT	UNDERGROUND WARNING/MARKING TAPE	
						LS						LS	625	38000	LS		HIGH VOLTAGE TEST	
						1						1	625	76000	1	EACH	ARC FLASH CALCULATIONS AND LABEL, (PS-A)	
TRAFFIC CONTROL																		
				4								4	620	00500	4	EACH	DELINEATOR, POST GROUND MOUNTED	
			285									285	621	00100	285	EACH	RPM	
				364								364	630	03100	364	FT	GROUND MOUNTED SUPPORT, NO. 3 POST	
				14								14	630	08600	14	EACH	SIGN POST REFLECTOR	
				188								188	630	80100	188	SF	SIGN, FLAT SHEET	
					46							46	630	84900	46	EACH	REMOVAL OF GROUND MOUNTED SIGN AND DISPOSAL	
					45							45	630	86002	45	EACH	REMOVAL OF GROUND MOUNTED POST SUPPORT AND DISPOSAL	
			1.61									1.61	644	00104	1.61	MILE	EDGE LINE, 6"	
			0.84									0.84	644	00300	0.84	MILE	CENTER LINE	
			567									567	644	00700	567	FT	TRANSVERSE/DIAGONAL LINE	
				110								110	644	01520	110	FT	DOTTED LINE, 12"	
				72								72	644	20800	72	FT	YIELD LINE	

GENERAL SUMMARY

DESIGN AGENCY



DESIGNER
JDK
REVIEWER
HRB 09/15/25
PROJECT ID
118109
SHEET TOTAL
P.56 126

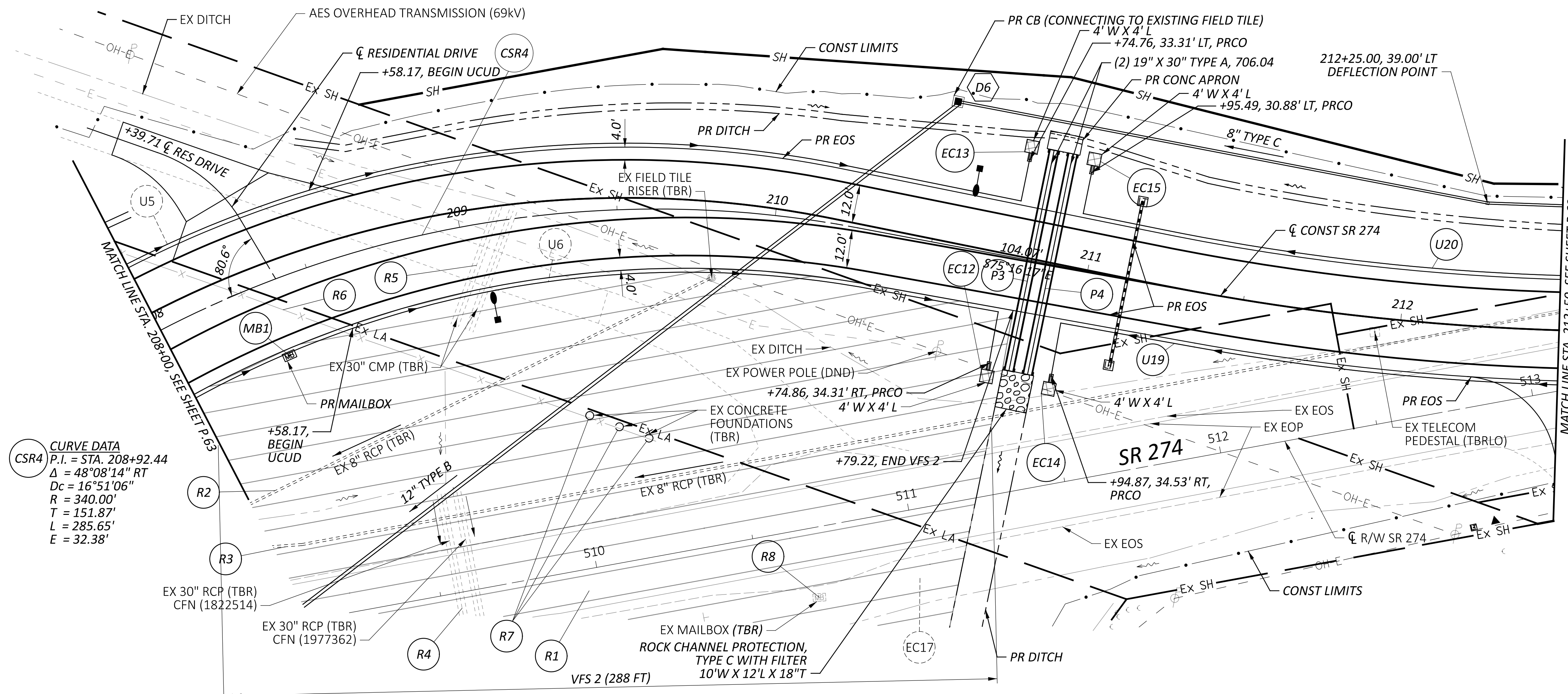

CURVE DATA
 CSR4
 P.I. = STA. 208+92.44
 $\Delta = 48^{\circ}08'14''$ RT
 $D_c = 16^{\circ}51'06''$
 $R = 340.00'$
 $T = 151.87'$
 $L = 285.65'$
 $E = 32.38'$

LEGEND

- ITEM 670 - SLOPE EROSION PROTECTION
- TBR = TO BE REMOVED
- DND = DO NOT DISTURB
- EOP = EDGE OF PAVEMENT
- EOS = EDGE OF SHOULDER

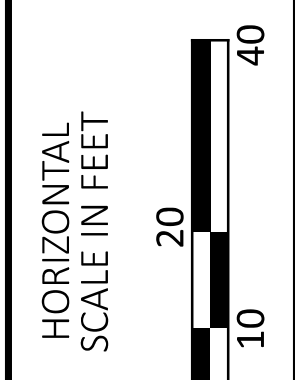
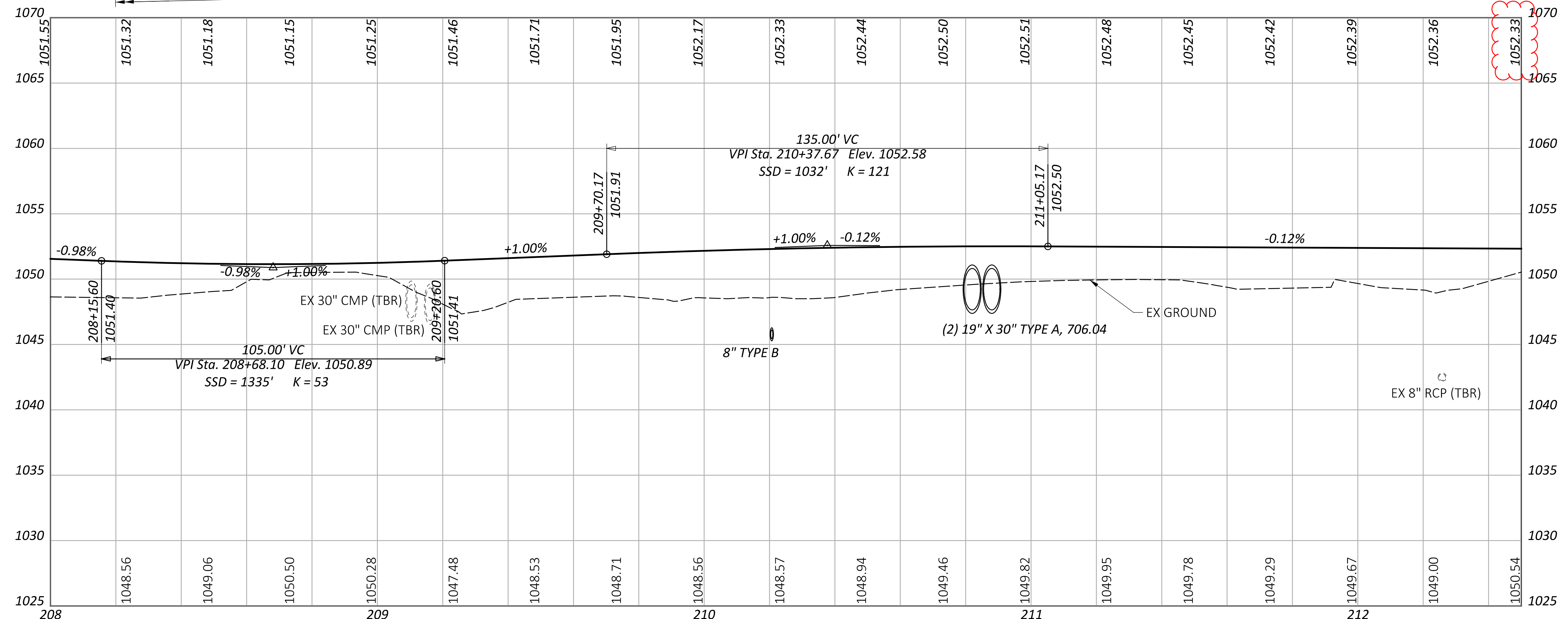

PLAN AND PROFILE - SR 274
STA 208+00 TO STA 212+50

DESIGN AGENCY	
EMHT	
DESIGNER	
JDK	
REVIEWER	
HRB 09/15/25	
PROJECT ID	
118109	
SHEET	TOTAL
P.68	126

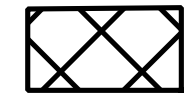
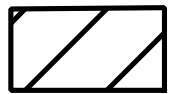
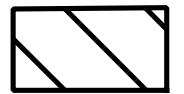
 = ITEM 204 - GRANULAR MATERIAL, TYPE B
 = UNSTABLE SOILS
 ITEM 204 - EXCAVATION OF SUBGRADE
 ITEM 204 - GRANULAR MATERIAL, TYPE B
 = UNSUITABLE SOILS
 ITEM 204 - EXCAVATION OF SUBGRADE
 ITEM 204 - GRANULAR MATERIAL, TYPE B

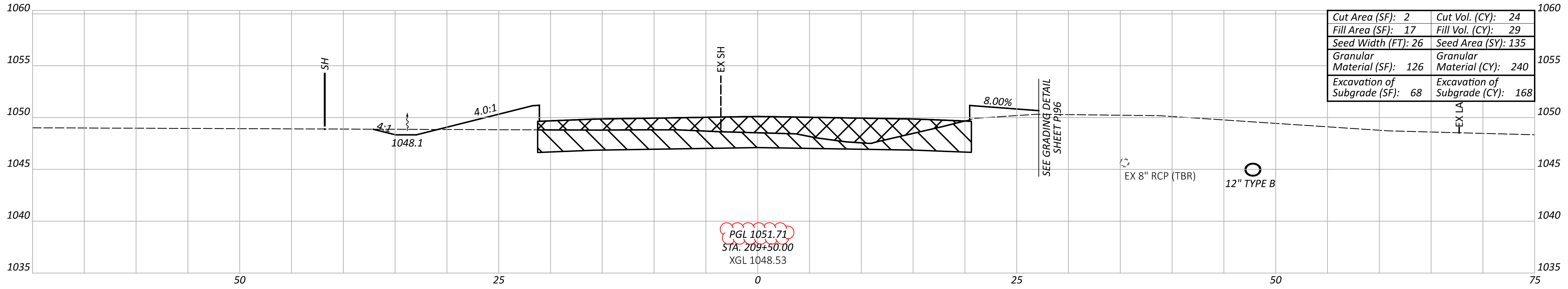

PGL 1051.71
 STA. 209+50.00
 XGL 1048.53

Cut Area (SF): 2	Cut Vol. (CY): 24
Fill Area (SF): 17	Fill Vol. (CY): 29
Seed Width (FT): 26	Seed Area (SY): 135
Granular Material (SF): 126	Granular Material (CY): 240
Excavation of Subgrade (SF): 68	Excavation of Subgrade (CY): 168

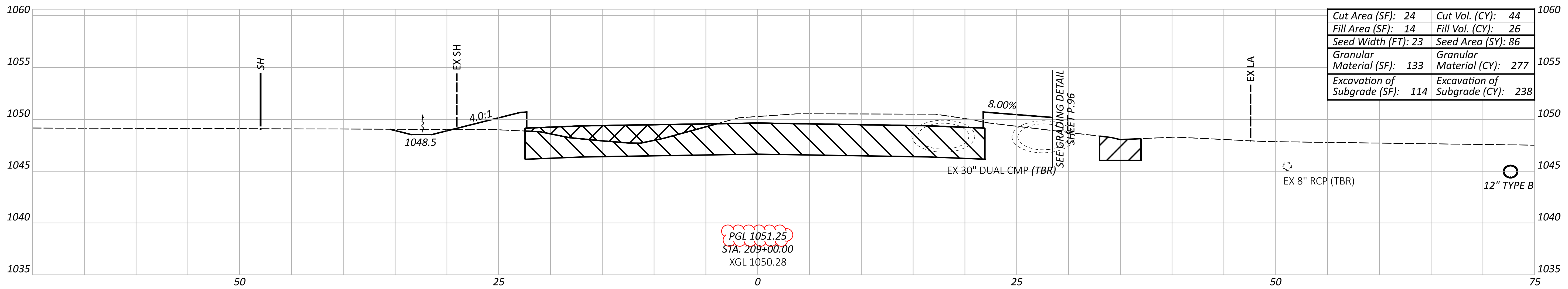

PGL 1051.25
 STA. 209+00.00
 XGL 1050.28

Cut Area (SF): 24	Cut Vol. (CY): 44
Fill Area (SF): 14	Fill Vol. (CY): 26
Seed Width (FT): 23	Seed Area (SY): 86
Granular Material (SF): 133	Granular Material (CY): 277
Excavation of Subgrade (SF): 114	Excavation of Subgrade (CY): 238

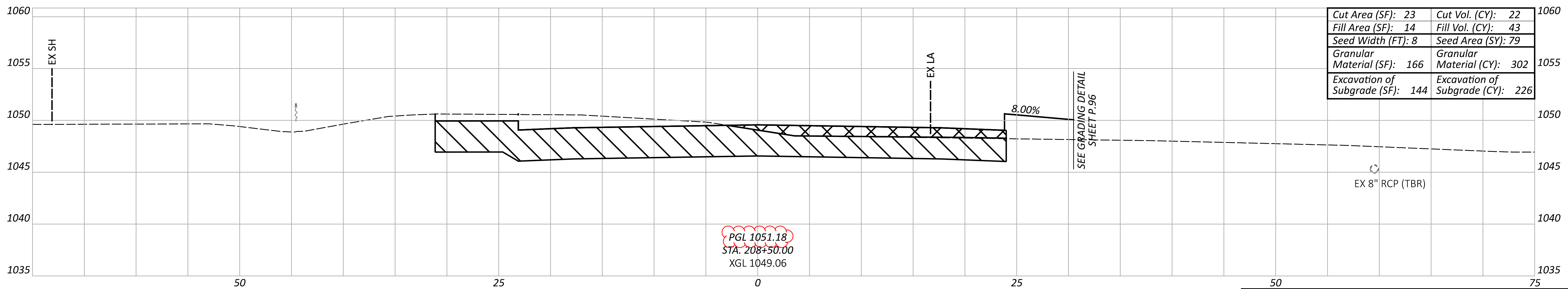

PGL 1051.18
 STA. 208+50.00
 XGL 1049.06

Cut Area (SF): 23	Cut Vol. (CY): 22
Fill Area (SF): 14	Fill Vol. (CY): 43
Seed Width (FT): 8	Seed Area (SY): 79
Granular Material (SF): 166	Granular Material (CY): 302
Excavation of Subgrade (SF): 144	Excavation of Subgrade (CY): 226

Sheet Totals				
Excavation of Subgrade	Granular material, Type B	Seeding	Cut	Fill
632	819	299	90	98

CROSS SECTIONS - SR 274
 STA 208+50 TO STA 209+50

DESIGN AGENCY



DESIGNER

JDK

REVIEWER

HRB 09/15/25

PROJECT ID

118109

SHEET TOTAL

P.83 126

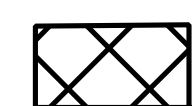
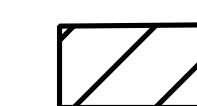
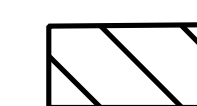
 = ITEM 204 - GRANULAR MATERIAL, TYPE B
 = UNSTABLE SOILS
 ITEM 204 - EXCAVATION OF SUBGRADE
 ITEM 204 - GRANULAR MATERIAL, TYPE B
 = UNSUITABLE SOILS
 ITEM 204 - EXCAVATION OF SUBGRADE
 ITEM 204 - GRANULAR MATERIAL, TYPE B

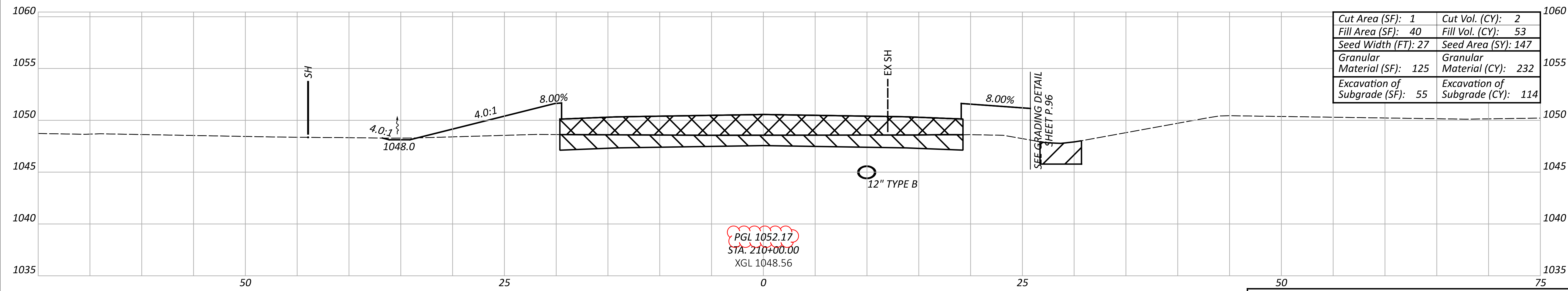
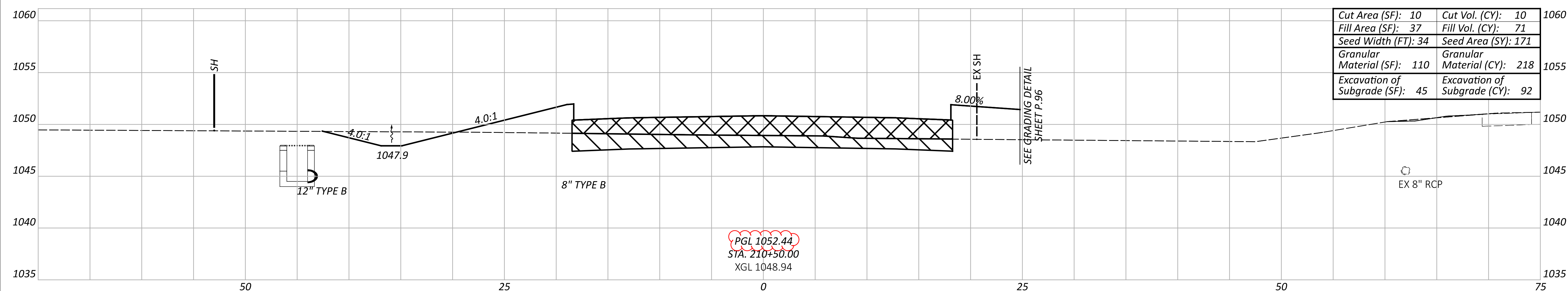
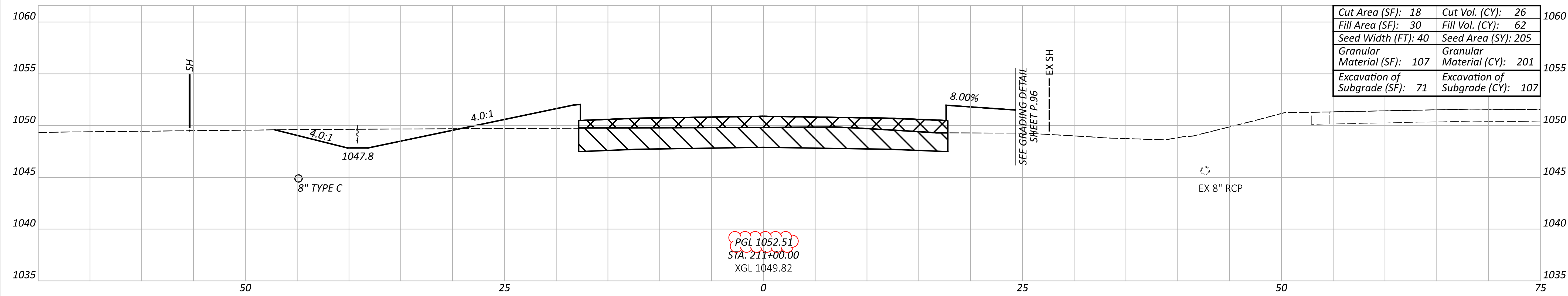



Sheet Totals				
Excavation of Subgrade	Granular material, Type B	Seeding	Cut	Fill
313	651	523	38	187

CROSS SECTIONS - SR 274
 STA 210+00 TO STA 211+00

DESIGN AGENCY



DESIGNER
 JDK
 REVIEWER
 HRB 09/15/25
 PROJECT ID
 118109
 SHEET TOTAL
 P.84 126

 = ITEM 204 - GRANULAR MATERIAL, TYPE B
 = UNSTABLE SOILS
 ITEM 204 - EXCAVATION OF SUBGRADE
 ITEM 204 - GRANULAR MATERIAL, TYPE B
 = UNSUITABLE SOILS
 ITEM 204 - EXCAVATION OF SUBGRADE
 ITEM 204 - GRANULAR MATERIAL, TYPE B

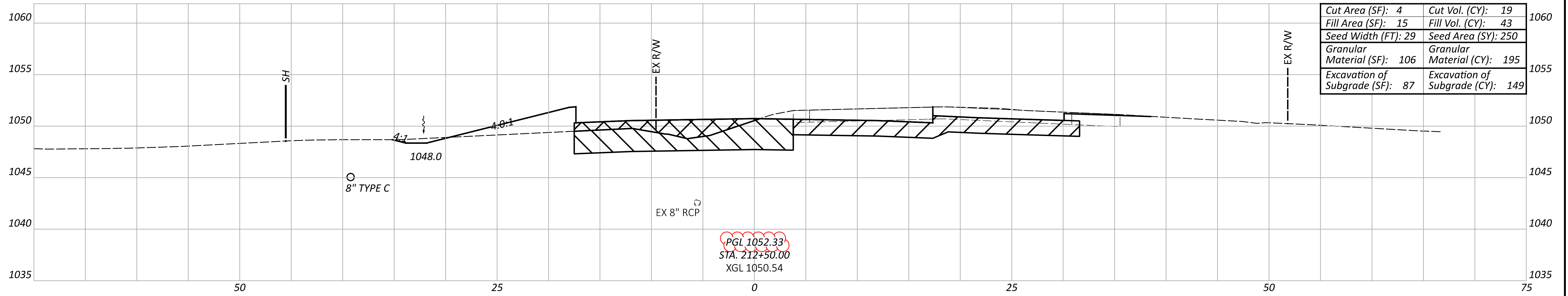

Cut Area (SF): 4	Cut Vol. (CY): 19
Fill Area (SF): 15	Fill Vol. (CY): 43
Seed Width (FT): 29	Seed Area (SY): 250
Granular Material (SF): 106	Granular Material (CY): 195
Excavation of Subgrade (SF): 87	Excavation of Subgrade (CY): 149

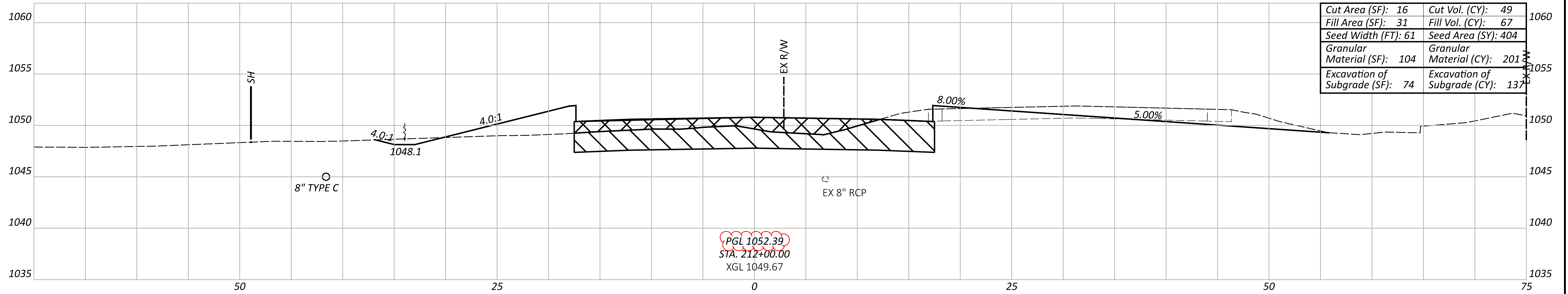

Cut Area (SF): 16	Cut Vol. (CY): 49
Fill Area (SF): 31	Fill Vol. (CY): 67
Seed Width (FT): 61	Seed Area (SY): 404
Granular Material (SF): 104	Granular Material (CY): 201
Excavation of Subgrade (SF): 74	Excavation of Subgrade (CY): 137

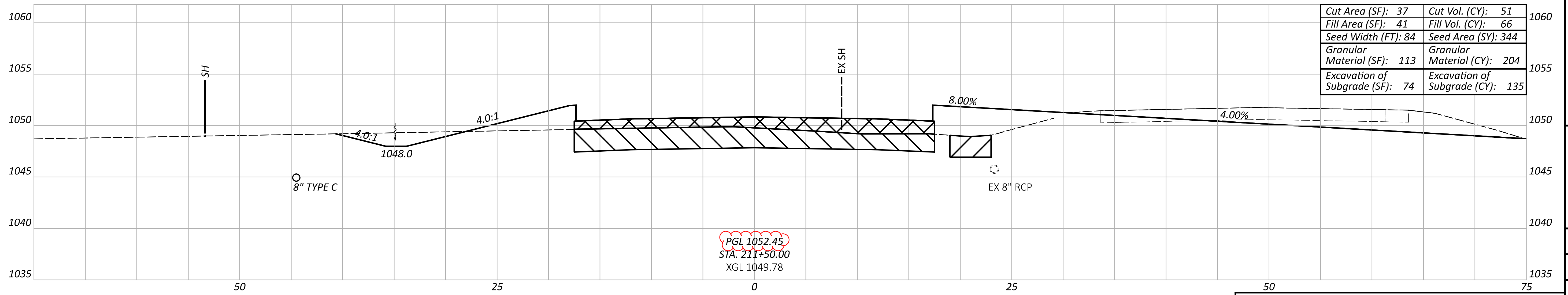

Cut Area (SF): 37	Cut Vol. (CY): 51
Fill Area (SF): 41	Fill Vol. (CY): 66
Seed Width (FT): 84	Seed Area (SY): 344
Granular Material (SF): 113	Granular Material (CY): 204
Excavation of Subgrade (SF): 74	Excavation of Subgrade (CY): 135

Sheet Totals				
Excavation of Subgrade	Granular material, Type B	Seeding	Cut	Fill
420	600	997	119	176

CROSS SECTIONS - SR 274
STA 211+50 TO STA 212+50

DESIGN AGENCY



DESIGNER

JDK

REVIEWER

HRB 09/15/25

PROJECT ID

118109

SHEET TOTAL

P.85 126

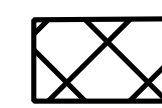
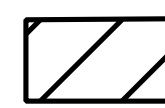
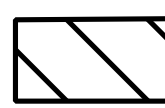
 = ITEM 204 - GRANULAR MATERIAL, TYPE B
 = UNSTABLE SOILS
 ITEM 204 - EXCAVATION OF SUBGRADE
 ITEM 204 - GRANULAR MATERIAL, TYPE B
 = UNSUITABLE SOILS
 ITEM 204 - EXCAVATION OF SUBGRADE
 ITEM 204 - GRANULAR MATERIAL, TYPE B

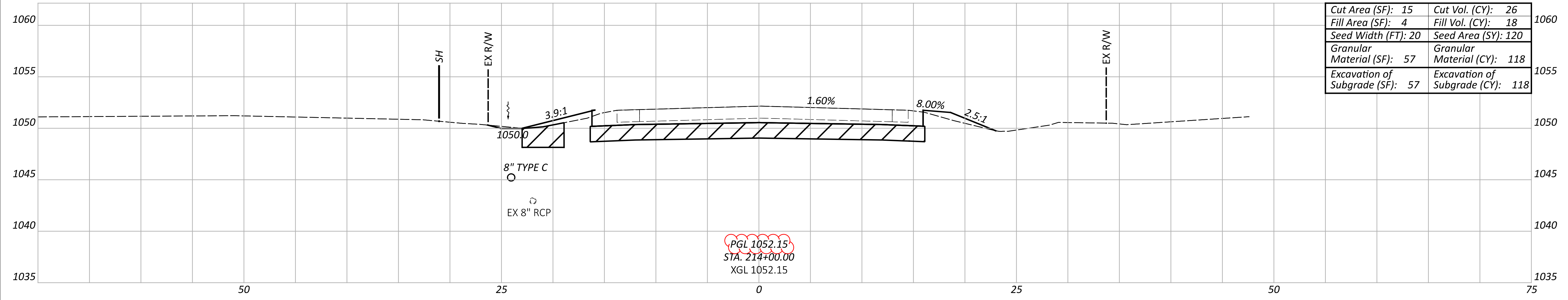

Cut Area (SF): 15	Cut Vol. (CY): 26
Fill Area (SF): 4	Fill Vol. (CY): 18
Seed Width (FT): 20	Seed Area (SY): 120
Granular Material (SF): 57	Granular Material (CY): 118
Excavation of Subgrade (SF): 57	Excavation of Subgrade (CY): 118

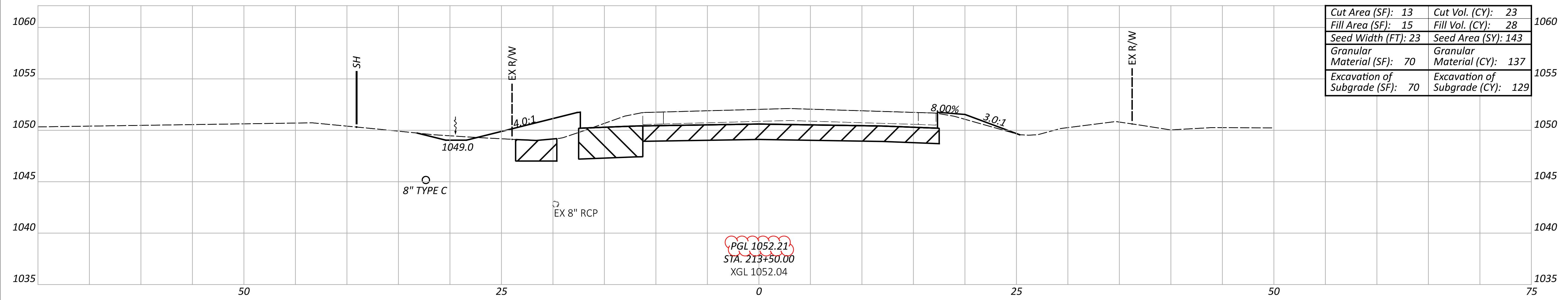

Cut Area (SF): 13	Cut Vol. (CY): 23
Fill Area (SF): 15	Fill Vol. (CY): 28
Seed Width (FT): 23	Seed Area (SY): 143
Granular Material (SF): 70	Granular Material (CY): 137
Excavation of Subgrade (SF): 70	Excavation of Subgrade (CY): 129

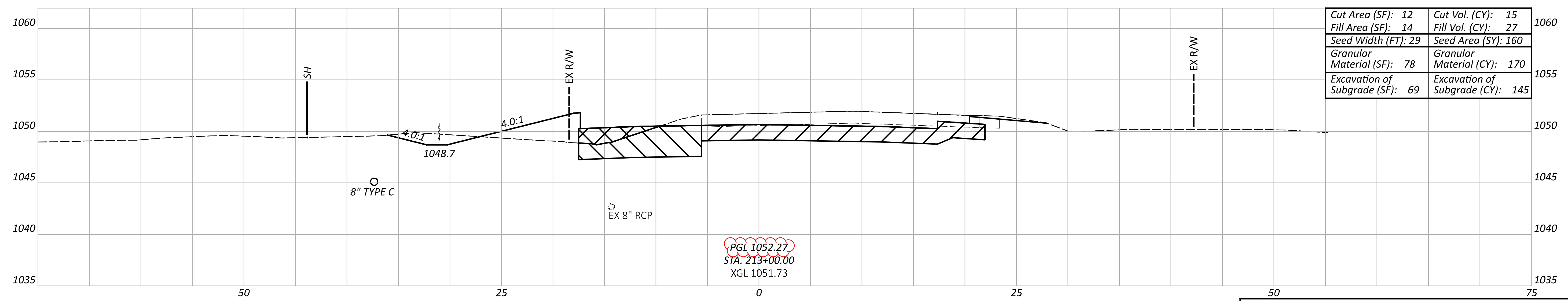

Cut Area (SF): 12	Cut Vol. (CY): 15
Fill Area (SF): 14	Fill Vol. (CY): 27
Seed Width (FT): 29	Seed Area (SY): 160
Granular Material (SF): 78	Granular Material (CY): 170
Excavation of Subgrade (SF): 69	Excavation of Subgrade (CY): 145

Sheet Totals				
Excavation of Subgrade	Granular material, Type B	Seeding	Cut	Fill
392	425	422	64	73

CROSS SECTIONS - SR 274
 STA 213+00 TO STA 214+00

DESIGN AGENCY

 DESIGNER
 JDK
 REVIEWER
 HRB 09/15/25
 PROJECT ID
 118109
 SHEET TOTAL
 P.86 126