

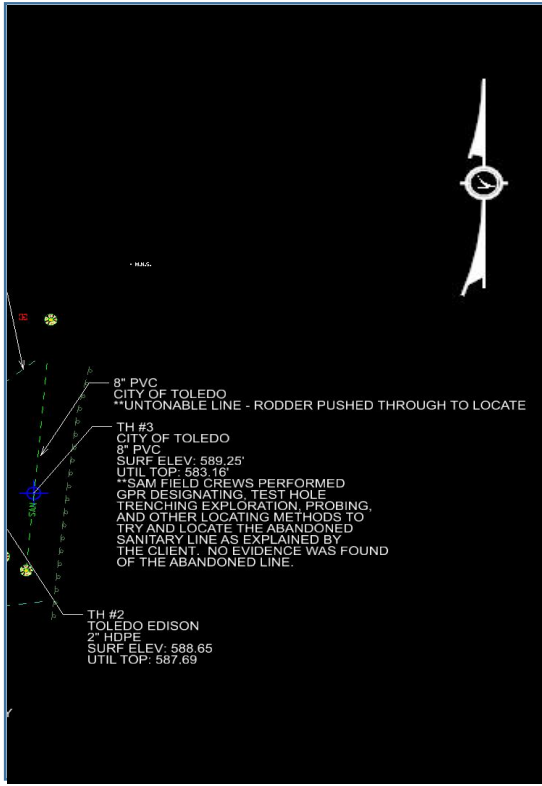

Surveying And Mapping, LLC (SAM)
 929 Eastwind Drive, Suite 201
 Westerville, Ohio 43081
 Office: 614-899-0079

SUE QUALITY LEVEL A
TEST HOLE #3
TOLEDO, OHIO

Project:	LUC 25 ANTHONY WAYNE TRAIL	Date Performed:	10/12/2022
SAM, LLC Project #	1022073581	Client:	Ohio Department of Transportation
Project Location:	LUCAS COUNTY	Surface Material	NATURAL GROUND
Utility Location:	3223 ERAWA DR	Surface Elevation:	589.25
Utility Sta./Offset:	N/A	Surface Condition:	POOR
Record Utility:	SANITARY	Trench Material:	SOIL
Utility Owner:	CITY OF TOLEDO	Utility Bedding Material:	N/A
Contact:	N/A	Utility Found:	8" PVC
Phone/Email:	N/A	Utility Condition:	GOOD
Field Crew:	JN/NB	Utility Depth (Top):	6.09'
Field Conditions:	SUNNY/COLD		



PROJECT CONTROL

Coordinates shown are based on Ohio State Plane NAD 83, South Zone, Grid, derived from GPS observations utilizing the Trimble Network.

UTILITY CENTERLINE COORD.

NORTHING	709329.61
EASTING	1668738.85
TOP ELEV.	583.16

Comments

1. SAM, LLC laid out this Test Hole by designating the Sanitary line prior to hand digging the utility.
2. No other utilities were found during excavation
3. All excavation was preformed with VAC truck
4. The Test Hole was backfilled with Excavated Marerial.
5. Location and elevation determined by satellite observations utilizing ODOT VRS.
6. Direct measure to top of pipe utilizing ODOT VRS.