

ALIGNMENT	STATION	GRID COORDINATES		
		NORTHING	EASTING	
S.R. 162	BEGIN	10+00	308065.210	199311.014
	END	30+00	307477.731	201185.154
STATE RD	BEGIN	40+00	306667.718	200023.006
	END	60+00	308623.851	200415.042

ALL COORDINATES SHOWN ARE IN U.S. SURVEY FEET

PRIMARY PROJECT CONTROL INFORMATION

POINT NAME	ALIGNMENT	STATION	OFFSET	GRID COORDINATES		ELEVATION	DESCRIPTION
				NORTHING	EASTING		
CP100	STATE RD	42+14.30	14.91' LT	306880.058	200055.557	1026.181	IRON PIN SET
CP101	SR 162	20+59.67	19.17' RT	307570.320	200247.857	1035.253	IRON PIN SET
CP201	SR 162	24+68.39	23.34' RT	307519.241	200654.650	1030.640	IRON PIN SET
CP102	SR 162	27+60.27	20.67' LT	307527.416	200949.724	1028.425	IRON PIN SET
CP103	STATE RD	49+91.86	3.41' RT	307638.168	200213.127	1036.797	IRON PIN SET
CP202	STATE RD	53+53.39	10.98' LT	307989.319	200298.861	1043.410	IRON PIN SET
CP104	STATE RD	56+85.53	16.17' LT	308315.269	200352.351	1040.761	IRON PIN SET
CP203	SR 162	16+29.99	39.47' LT	307800.039	199887.984	1060.961	IRON PIN SET
CP105	SR 162	13+31.52	15.25' LT	307923.828	199611.263	1076.817	IRON PIN SET
CP106	SR 162	10+41.66	24.78' LT	308067.657	199359.424	1082.635	IRON PIN SET
CP200	STATE RD	45+84.41	23.32' LT	307242.726	200128.573	1031.322	IRON PIN SET

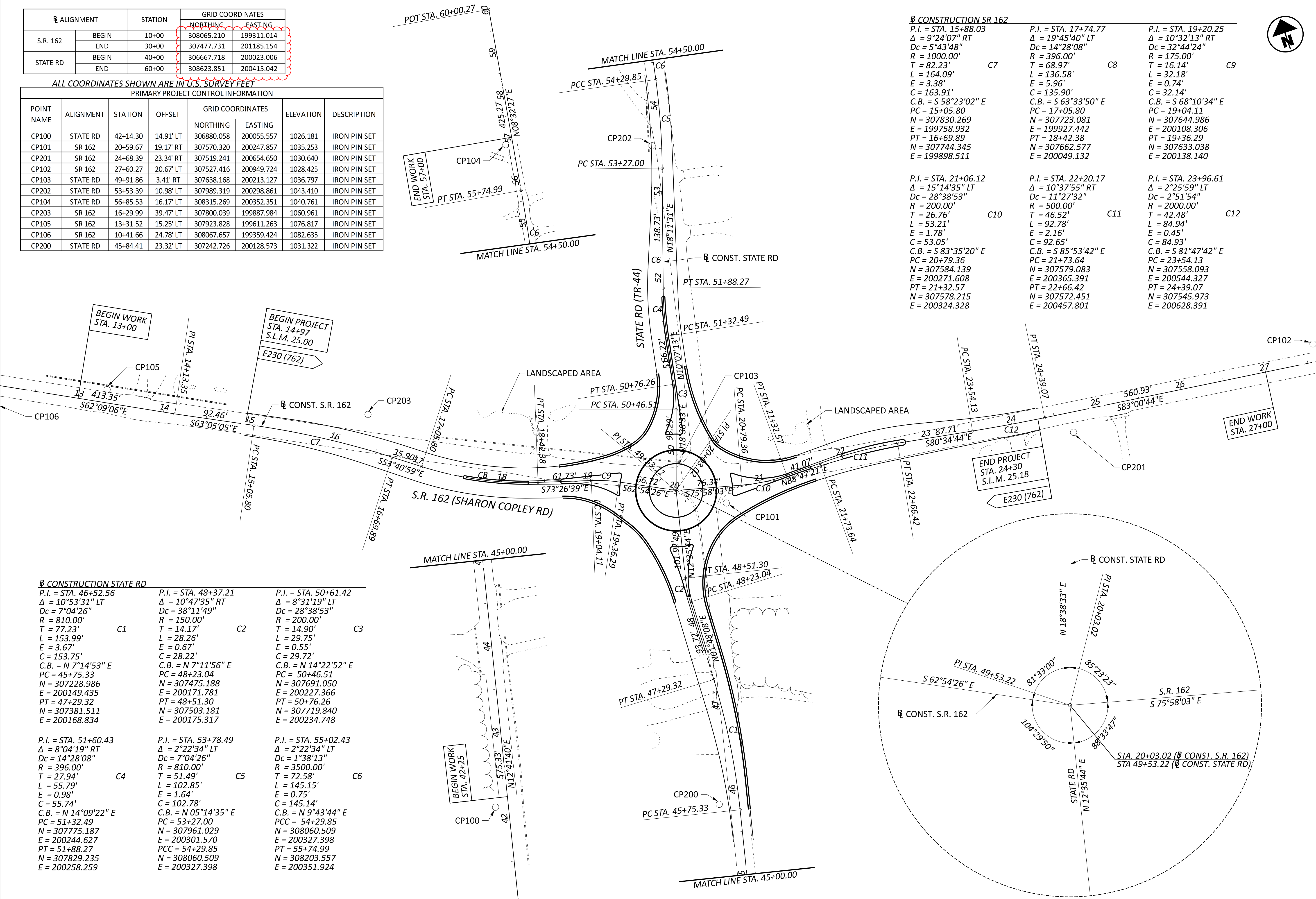

CONSTRUCTION STATE RD

P.I. = STA. 46+52.56 Δ = 10°53'31" LT Dc = 7°04'26" R = 810.00' T = 77.23' L = 153.99' E = 3.67' C = 153.75' C.B. = N 7°14'53" E PC = 45+75.33 N = 307228.986 E = 200149.435 PT = 47+29.32 N = 307381.511 E = 200168.834	P.I. = STA. 48+37.21 Δ = 10°47'35" RT Dc = 38°11'49" R = 150.00' T = 14.17' L = 28.26' E = 0.67' C = 28.22' C.B. = N 7°11'56" E PC = 48+23.04 N = 307475.188 E = 200171.781 PT = 48+51.30 N = 307503.181 E = 200175.317	P.I. = STA. 50+61.42 Δ = 8°31'19" LT Dc = 28°38'53" R = 200.00' T = 14.90' L = 29.75' E = 0.55' C = 29.72' C.B. = N 14°22'52" E PC = 50+46.51 N = 307691.050 E = 200227.366 PT = 50+76.26 N = 307719.840 E = 200234.748
--	---	---

P.I. = STA. 51+60.43 Δ = 8°04'19" RT Dc = 14°28'08" R = 396.00' T = 27.94' L = 55.79' E = 0.98' C = 55.74' C.B. = N 14°09'22" E PC = 51+32.49 N = 307775.187 E = 200244.627 PT = 51+88.27 N = 307829.235 E = 200258.259	P.I. = STA. 53+78.49 Δ = 2°22'34" LT Dc = 7°04'26" R = 810.00' T = 51.49' L = 102.85' E = 1.64' C = 102.78' C.B. = N 05°14'35" E PC = 53+27.00 N = 307961.029 E = 200301.570 PCC = 54+29.85 N = 308060.509 E = 200327.398	P.I. = STA. 55+02.43 Δ = 2°22'34" LT Dc = 1°38'13" R = 3500.00' T = 72.58' L = 145.15' E = 0.75' C = 145.14' C.B. = N 9°43'44" E PCC = 54+29.85 N = 308060.509 E = 200327.398 PT = 55+74.99 N = 308203.557 E = 200351.924
---	---	---

CONSTRUCTION SR 162

P.I. = STA. 15+88.03 Δ = 9°24'07" RT Dc = 5°43'48" R = 1000.00' T = 82.23' L = 164.09' E = 3.38' C = 163.91' C.B. = S 58°23'02" E PC = 15+05.80 N = 307830.269 E = 199758.932 PT = 16+69.89 N = 307744.345 E = 199898.511	P.I. = STA. 17+74.77 Δ = 19°45'40" LT Dc = 14°28'08" R = 396.00' T = 68.97' L = 136.58' E = 5.96' C = 135.90' C.B. = S 63°33'50" E PC = 17+05.80 N = 307723.081 E = 199927.442 PT = 18+42.38 N = 307662.577 E = 200049.132	P.I. = STA. 19+20.25 Δ = 10°32'13" RT Dc = 32°44'24" R = 175.00' T = 16.14' L = 32.18' E = 0.74' C = 32.14' C.B. = S 68°10'34" E PC = 19+04.11 N = 307644.986 E = 200108.306 PT = 19+36.29 N = 307633.038 E = 200138.140
---	--	--

P.I. = STA. 21+06.12 Δ = 15°14'35" LT Dc = 28°38'53" R = 200.00' T = 26.76' L = 53.21' E = 1.78' C = 53.05' C.B. = S 83°35'20" E PC = 20+79.36 N = 307584.139 E = 200271.608 PT = 21+32.57 N = 307578.215 E = 200324.328	P.I. = STA. 22+20.17 Δ = 10°37'55" RT Dc = 2°51'54" R = 500.00' T = 46.52' L = 92.78' E = 2.16' C = 92.65' C.B. = S 85°53'42" E PC = 21+73.64 N = 307579.083 E = 200365.391 PT = 22+66.42 N = 307572.451 E = 200457.801	P.I. = STA. 23+96.61 Δ = 2°25'59" LT Dc = 2°51'54" R = 2000.00' T = 42.48' L = 84.94' E = 0.45' C = 84.93' C.B. = S 81°47'42" E PC = 23+54.13 N = 307558.093 E = 200544.327 PT = 24+39.07 N = 307545.973 E = 200628.391
--	---	---

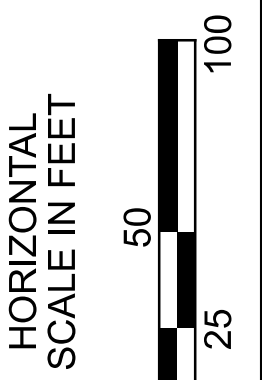

SCHEMATIC PLAN

DESIGN AGENCY



DESIGNER NJA

REVIEWER CJR 08/20/25

PROJECT ID 118357

SHEET P.2 TOTAL P.85

CENTERLINE & MONUMENT COORDINATE TABLE									
Station Offset (From C/L R/W)		Project Coordinates (See Survey Parameters)			Monument Description		Monuments To Be Set During Construction		R/W Mon. Expected to Be Disturbed
Station	Offset (ft)	Northing (ft)	Easting (ft)	Pt. #	DESCRIPTION	Mon. Assy. (623 Type D)	Ref. Mon. (623 Type A)	R/W Mon. (623 Type B)	
Existing Centerline of R/W - S.R. 162 (SHARON COPLEY RD.)									
1315+35.79	34.10' RT	307997.280	199378.974	43784	3/8" IPIN				
1317+05.66	29.82' LT	307977.001	199559.340	43576	3/8" IPIN - BENT				
1317+76.01	28.67' RT	307892.930	199595.422	43575	3/4" IPIN				
1319+40.79	30.14' LT	307870.416	199768.924	43574	3/8" IPIN				
1321+63.88	144.81' LT	307871.149	200019.753	42690	7/8" IPID W/ "LAURILA & ASSOC. #7663" CAP				
1324+35.62	29.57' LT	307644.988	200209.426	42575	3/8" IPIN			1	
1324+75.12	0.00' RT	307600.695	200231.165	45006	1/2" IPIN			1	
1324+91.55	163.24' RT	307436.724	200225.741	41068	1" IPIN				
1326+65.90	159.08' LT	307732.991	200441.409	41915	5/8" IPID W/ ILLEGIBLE CAP				
1326+76.72	29.94' LT	307603.560	200434.957	41914	3/8" IPIN - BENT			1	
1328+03.81	22.67' RT	307534.514	200553.926	41757	1/2" IPIN			1	
1329+19.36	30.82' RT	307511.075	200667.359	41541	3/4" IPIPE				
1331+54.70	0.00' RT	307510.323	200904.710	43787	1" IPIN				
1332+11.89	29.75' RT	307473.449	200957.583	41756	5/8" IPID W/ "WELLERT 6369" CAP				
1332+71.95	29.56' RT	307465.883	201017.171	41755	5/8" IPID W/ "WELLERT 6369" CAP				
1332+86.34	25.08' LT	307518.213	201038.482	41754	3/4" SQUARE AXLE				
Existing Centerline of R/W - T.R. 44 (STATE RD.)									
50+00.00	0.00' RT	305921.255	199865.516	45005	1/2" IPIN				
53+81.91	0.00' RT	306295.784	199940.240	45004	3/4" IPIN				
61+80.41	29.97' RT	307068.629	200143.251	40444	5/8" IPID W/ ILLEGIBLE CAP				
63+86.64	29.93' LT	307282.951	200129.665	40445	3/8" IPIN			1	
64+86.63	29.97' LT	307380.556	200151.382	41069	IPID W/ "LEWIS LAND PROFESSIONALS" CAP			1	
65+86.57	29.85' LT	307478.072	200173.245	41070	IPID W/ "CUNNINGHAM 5274" CAP			1	
69+88.98	30.56' LT	307871.966	200248.853	42574	1/2" IPIN - BENT			1	
72+53.60	30.39' LT	308132.383	200295.813	42140	5/8" IPID W/ "DAVID E. MOHR 5127" CAP				
72+53.65	30.60' LT	308132.473	200295.617	42141	IPIPE				
73+61.31	30.04' LT	308238.334	200315.204	42415	1 1/2" IPIPE				
74+63.14	30.29' LT	308338.606	200332.959	42417	IPID W/ "ILLEGIBLE" CAP				
74+63.18	30.65' LT	308338.705	200332.613	42418	5/8" IPIN				
74+63.31	30.59' LT	308338.826	200332.698	42416	1" IPIPE				
77+38.38	25.83' RT	308599.580	200436.863	42420	5/8" IPID W/ "DAVID E. MOHR 5127" CAP				
77+40.34	33.83' LT	308612.058	200378.492	42419	1" IPIN				
Proposed Centerline of R/W - S.R. 162 (SHARON COPLEY RD.)									
1317+84.19	46.00' RT	307873.773	199594.825	IP1S1	PR. 3/4" REBAR, W/ "N.E.A.S.-O.D.O.T. RW" ALUM. CAP				
1319+50.00	00.00' LT	307839.380	199763.426	MONBXS1	PR. MONUMENT TYPE D RM1.1 TO BE SET	1			
1319+92.28	30.00' LT	307846.884	199814.722	IP1S19	PR. 3/4" REBAR, W/ "N.E.A.S.-O.D.O.T. RW" ALUM. CAP			1	
1319+92.28	35.00' LT	307851.338	199816.995	IP1S20	PR. 3/4" REBAR, W/ "N.E.A.S.-O.D.O.T. RW" ALUM. CAP			1	
1319+92.95	54.00' RT	307771.760	199777.135	IP1S2	PR. 3/4" REBAR, W/ "N.E.A.S.-O.D.O.T. RW" ALUM. CAP				
1320+02.28	30.00' LT	307842.339	199823.629	IP1S22	PR. 3/4" REBAR, W/ "N.E.A.S.-O.D.O.T. RW" ALUM. CAP			1	
1320+02.28	35.00' LT	307846.792	199825.902	IP1S21	PR. 3/4" REBAR, W/ "N.E.A.S.-O.D.O.T. RW" ALUM. CAP			1	
1321+23.77	70.00' RT	307698.045	199886.389	IP1S3	PR. 3/4" REBAR, W/ "N.E.A.S.-O.D.O.T. RW" ALUM. CAP				
1321+84.55	87.00' RT	307655.273	199932.806	IP1S4	PR. 3/4" REBAR, W/ "N.E.A.S.-O.D.O.T. RW" ALUM. CAP				
1322+74.57	30.00' LT	307718.574	200066.165	IP1S23	PR. 3/4" REBAR, W/ "N.E.A.S.-O.D.O.T. RW" ALUM. CAP				
1322+74.64	90.00' RT	307611.653	200011.687	IP1S5	PR. 3/4" REBAR, W/ "N.E.A.S.-O.D.O.T. RW" ALUM. CAP				
1323+10.22	42.00' LT	307713.057	200103.377	IP1S24	PR. 3/4" REBAR, W/ "N.E.A.S.-O.D.O.T. RW" ALUM. CAP				
1323+60.44	131.85' LT	307770.269	200188.945	IP1S26	PR. 3/4" REBAR, W/ "N.E.A.S.-O.D.O.T. RW" ALUM. CAP				
1323+70.22	60.00' LT	307701.817	200165.004	IP1S25	PR. 3/4" REBAR, W/ "N.E.A.S.-O.D.O.T. RW" ALUM. CAP				
1323+70.53	103.00' LT	307556.488	200091.191	IP1S6	PR. 3/4" REBAR, W/ "N.E.A.S.-O.D.O.T. RW" ALUM. CAP				
1323+94.80	113.00' RT	307536.550	200108.262	IP1S7	PR. 3/4" REBAR, W/ "N.E.A.S.-O.D.O.T. RW" ALUM. CAP				
1324+15.20	152.03' RT	307492.514	200108.690	IP1S8	PR. 3/4" REBAR, W/ "N.E.A.S.-O.D.O.T. RW" ALUM. CAP				
1324+50.00	00.00' LT	307612.113	200208.791	CMONS1	PR. MONUMENT TYPE A RM1.1 TO BE SET		1		
1325+01.35	161.42' RT	307437.220	200235.701	IP1S13	PR. 3/4" REBAR, W/ "N.E.A.S.-O.D.O.T. RW" ALUM. CAP				
1325+07.34	92.00' RT	307505.228	200250.863	IP1S14	PR. 3/4" REBAR, W/ "N.E.A.S.-O.D.O.T. RW" ALUM. CAP				
1325+22.04	154.96' LT	307748.036	200298.276	IP1S33	PR. 3/4" REBAR, W/ "N.E.A.S.-O.D.O.T. RW" ALUM. CAP				
1325+19.58	99.59' LT	307693.490	200288.477	IP1S34	PR. 3/4" REBAR, W/ "N.E.A.S.-O.D.O.T. RW" ALUM. CAP				
1325+24.23	69.08' LT	307662.633	200289.029	IP1S35	PR. 3/4" REBAR, W/ "N.E.A.S.-O.D.O.T. RW" ALUM. CAP				
1325+45.20	72.00' RT	307520.016	200291.044	IP1S15	PR. 3/4" REBAR, W/ "N.E.A.S.-O.D.O.T. RW" ALUM. CAP				
1325+54.59	43.00' LT	307632.745	200315.651	IP1S36	PR. 3/4" REBAR, W/ "N.E.A.S.-O.D.O.T. RW" ALUM. CAP				
1326+67.89	40.00' RT	307535.416	200416.902	IP1S16	PR. 3/4" REBAR, W/ "N.E.A.S.-O.D.O.T. RW" ALUM. CAP				
1326+75.76	43.00' LT	307616.632	200435.741	IP1S37	PR. 3/4" REBAR, W/ "N.E.A.S.-O.D.O.T. RW" ALUM. CAP				
1327+26.21	42.00' LT	307608.931	200485.615	IP1S38	PR. 3/4" REBAR, W/ "N.E.A.S.-O.D.O.T. RW" ALUM. CAP				
1327+98.01	30.00' RT	307528.023	200547.197	IP1S18	PR. 3/4" REBAR, W/ "N.E.A.S.-O.D.O.T. RW" ALUM. CAP				
1327+98.23	40.00' RT	307518.082	200546.088	IP1S17	PR. 3/4" REBAR, W/ "N.E.A.S.-O.D.O.T. RW" ALUM. CAP				
1328+39.60	30.00' LT	307581.959	200596.400	IP1S39	PR. 3/4" REBAR, W/ "N.E.A.S.-O.D.O.T. RW" ALUM. CAP				
1328+50.00	00.00' LT	307550.843	200602.716	MONBXS2	PR. MONUMENT TYPE D RM1.1 TO BE SET	1			
Proposed Centerline of R/W - T.R. 44 (STATE RD.)									
60+70.79	30.00' LT	306974.688	200060.862	IP1S11	PR. 3/4" REBAR, W/ "N.E.A.S.-O.D.O.T. RW" ALUM. CAP				
61+82.09	40.00' RT	307068.080	200153.403	IP1S12	PR. 3/4" REBAR, W/ "N.E.A.S.-O.D.O.T. RW" ALUM. CAP				
63+86.62	59.00' LT	307289.254	200101.282	IP1S10	PR. 3/4" REBAR, W/ "N.E.A.S.-O.D.O.T. RW" ALUM. CAP				
64+86.62	72.00' LT	307389.688	200110.354	IP1S9	PR. 3/4" REBAR, W/ "N.E.A.S.-O.D.O.T. RW" ALUM. CAP				
69+78.17	40.00' RT	307848.847	200316.388	IP1S32	PR. 3/4" REBAR, W/ "N.E.A.S.-O.D.O.T. RW" ALUM. CAP				
69+83.22	61.00' LT	307871.675	200217.872	IP1S27	PR. 3/4" REBAR, W/ "N.E.A.S.-O.D.O.T. RW" ALUM. CAP				
70+91.03	55.00' RT	307957.275	200351.108	IP1S31	PR. 3/4" REBAR, W/ "N.E.A.S.-O.D.O.T. RW" ALUM. CAP				
71+97.29	30.00' RT	308066.283	200345.292	IP1S29	PR. 3/4" REBAR, W/ "N.E.A.S.-O.D.O.T. RW" ALUM. CAP				
71+97.29	55.00' RT	308061.863	200369.898	IP1S30	PR. 3/4" REBAR, W/ "N.E.A.S.-O.D.O.T. RW" ALUM. CAP				
72+53.52	36.00' LT	308133.300	200290.275	IP1S28	PR. 3/4" REBAR, W/ "N.E.A.S.-O.D.O.T. RW" ALUM. CAP				
Quantity Carried to General Summary						2	1	12	

CENTERLINE COMPARISON TABLE							
C/L R/W S.R. 162 (SHARON COPLEY RD.) TO C/L CONST. S.R. 162 (SHARON COPLEY RD.) STATION (C/L R/W), OFFSET, NORTHING, EASTING = STATION (C/L CONST.), OFFSET, NORTHING, EASTING							
CENTERLINE OF R/W S.R. 162 (SHARON COPLEY RD.)				CENTERLINE OF CONST. S.R. 162 (SHARON COPLEY RD.)			
STATION (CL R/W)	OFFSET FROM CL OF R/W	NORTHING	EASTING	STATION (CL CONST.)	OFFSET FROM CL OF R/W	NORTHING	EASTING
POT 1317+61.18	C/L	307925.2042	199595.2404	POT 10+00.00	-	308065.2100	199311.0140
1318+57.68	C/L	307881.3426	199681.1939	13+16.71	8.98' RT	307917.2638	199591.0453
1319+50.14	C/L	307839.3170	199763.5494	PI 14+13.35	10.35' RT	307872.1208	199676.4916
1321+13.52	C/L	307765.0541	199909.0786	PC 15+05.80	10.35' RT	307830.2688	199758.9321
1321+48.96	C/L	307748.9478	199940.6413	PT 16+69.89	23.25' RT	307744.3454	199898.5111
1322+84.85	C/L	307687.1791	200061.6864	PC 17+05.80	29.04' RT	307723.0808	199927.4415
1323+45.55	C/L	307659.5872	200115.7569	PT 18+42.38	27.62' RT	307662.5768	200049.1319
1323+77.56	C/L	307645.0401	200144.2642	PC 19+04.11	16.39' RT	307644.9858	200108.3059
1324+44.28	C/L	307614.7113	200203.6979	PT 19+36.29	13.47' RT	307633.0384	200138.1398
PI 1324+75.12	C/L	307600.6950	200231.1650	PI 20+03.02	13.54' RT	307602.6499	200197.5430
1325+17.40	C/L	307595.0718	200273.0750	20+36.11	6.26' RT	307594.6259	200229.6482
1325+70.44	C/L	307588.0185	200325.6435	PC 20+79.36	11.03' RT	307584.1389	200271.6081
1326+11.03	C/L	307582.6217	200365.8656	PT 21+32.57	9.89' RT	307578.2153	200324.3281
1326+39.19	C/L	307578.8772	200393.7737	PC 21+73.64	3.57' RT	307579.0831	200365.3908
1327+03.50	C/L	307570.3247	200457.5159	22+02.03	C/L	307578.8772	200393.7737
1327+61.25	C/L	307561.1421	200525.9537	PT 22+66.42	2.15' LT	307572.4506	200457.8011
1327+91.17	C/L	307558.6665	200544.4044	23+35.51	C/L	307561.1421	200525.9537
1328+76.09	C/L	307547.3725	200628.5791	PC 23+54.13	0.58' RT	307558.0934	200544.3275
1329+99.80	C/L	307530.9225	200751.1816	PT 24+39.07	1.41' RT	307545.9728	200628.3913
PI 1331+54.70	C/L	307510.3230	200904.7100	25+62.78	C/L	307530.9225	200751.1816
1334+37.00	C/L	307473.9137	201184.6571	27+17.67	1.77' LT	307512.0782	200904.9251
POT 1336+93.29	C/L	307440.8602	201438.8019	POT 30+00.00	3.85' LT	307477.7308	201185.1535

CENTERLINE COMPARISON TABLE							
C/L R/W T.R. 44 (STATE RD.) TO C/L CONST. T.R. 44 (STATE RD.) STATION (C/L R/W), OFFSET, NORTHING, EASTING = STATION (C/L CONST.), OFFSET, NORTHING, EASTING							
CENTERLINE OF R/W T.R. 44 (STATE RD.)				CENTERLINE OF CONST. T.R. 44 (STATE RD.)			
STATION (CL R/W)	OFFSET FROM CL OF R/W	NORTHING	EASTING	STATION (CL CONST.)	OFFSET FROM CL OF R/W	NORTHING	EASTING
POT 50+00.00	C/L	305921.2550	199865.5160	POT 40+00.00	0.15' LT	306667.7176	200023.0057
PI 53+81.91	C/L	306295.7840	199940.2400	40+68.99	C/L	306735.0224	200038.1665
57+62.94	C/L	306667.6845	200023.1538	PC 45+75.33	1.11' RT	307228.9856	200149.4351
58+31.93	C/L	306735.0224	200038.1665	46+19.64	C/L	307272.4525	200157.9846
63+38.27	C/L	307229.2280	200148.3478	PT 47+29.32	13.14' LT	307381.5109	200168.8341
63+82.56	C/L	307272.4525	200157.9846	PC 48+23.04	30.65' LT	307	