

CONSTRUCT TEMPORARY ACCESS DRIVE TO BE USED IN PHASE 3.

 - WORK AREA

**NOTES:**  
- REFER TO STANDARD CONSTRUCTION DRAWING MT-96.11 FOR SIGN PLACEMENT AND FURTHER DETAILS.

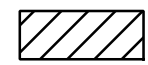
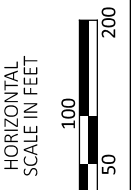

# MAINTENANCE OF TRAFFIC PHASE 2

DESIGN AGENCY



DESIGNER

JDW

REVIEWER

ARM 09/26/25

PROJECT ID

116282

SHEET TOTAL

P.018 P.207

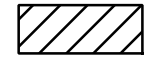
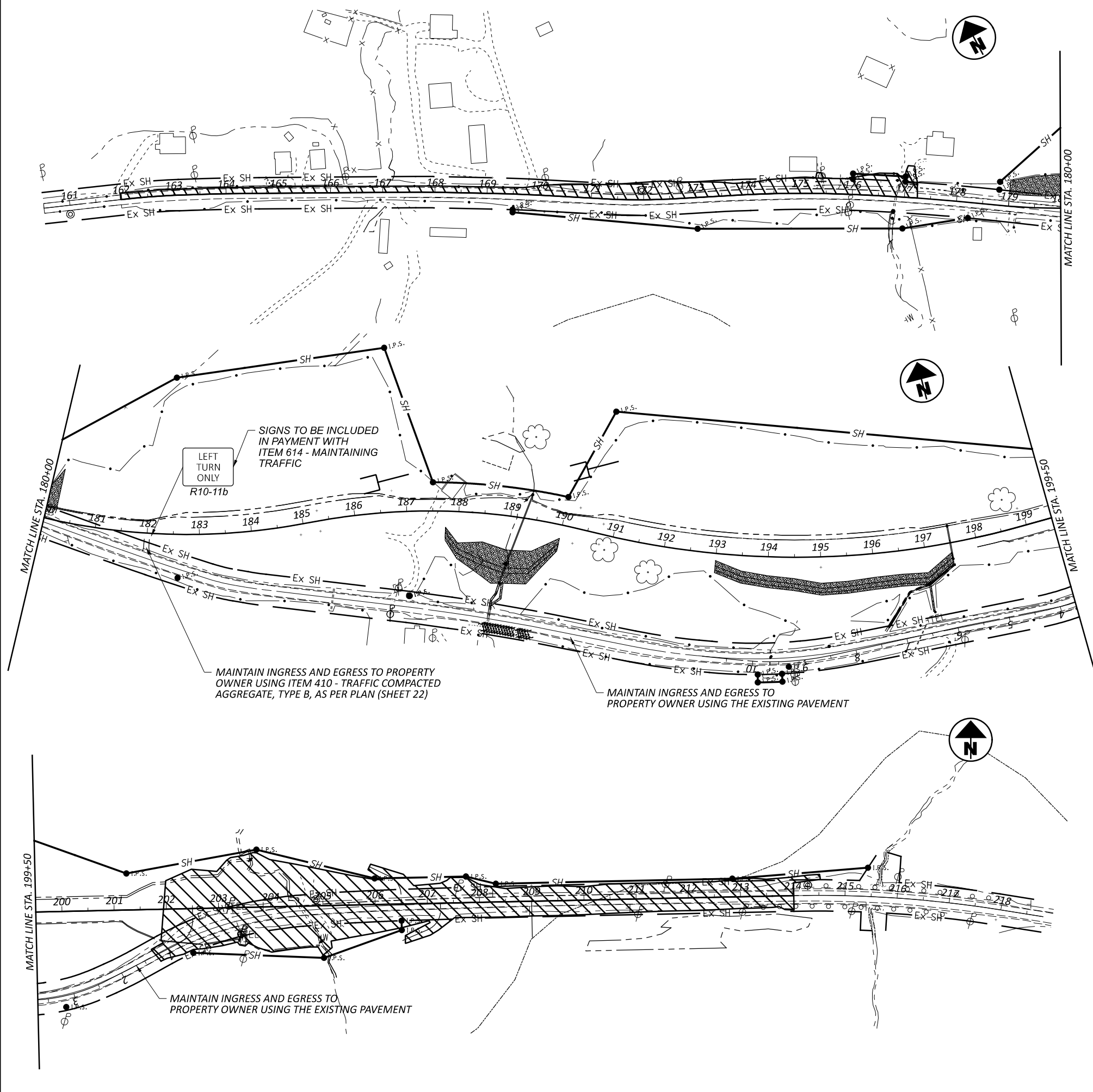

- WORK AREA

**NOTES:**

- REFER TO STANDARD CONSTRUCTION DRAWING MT-96.11 FOR SIGN PLACEMENT AND FURTHER DETAILS.

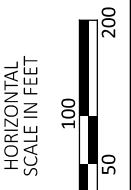

**MAINTENANCE OF TRAFFIC  
PHASE 3-A**

DESIGN AGENCY



DESIGNER  
JDW

REVIEWER  
ARM 09/26/25

PROJECT ID  
116282

SHEET	TOTAL
P.021	P.207

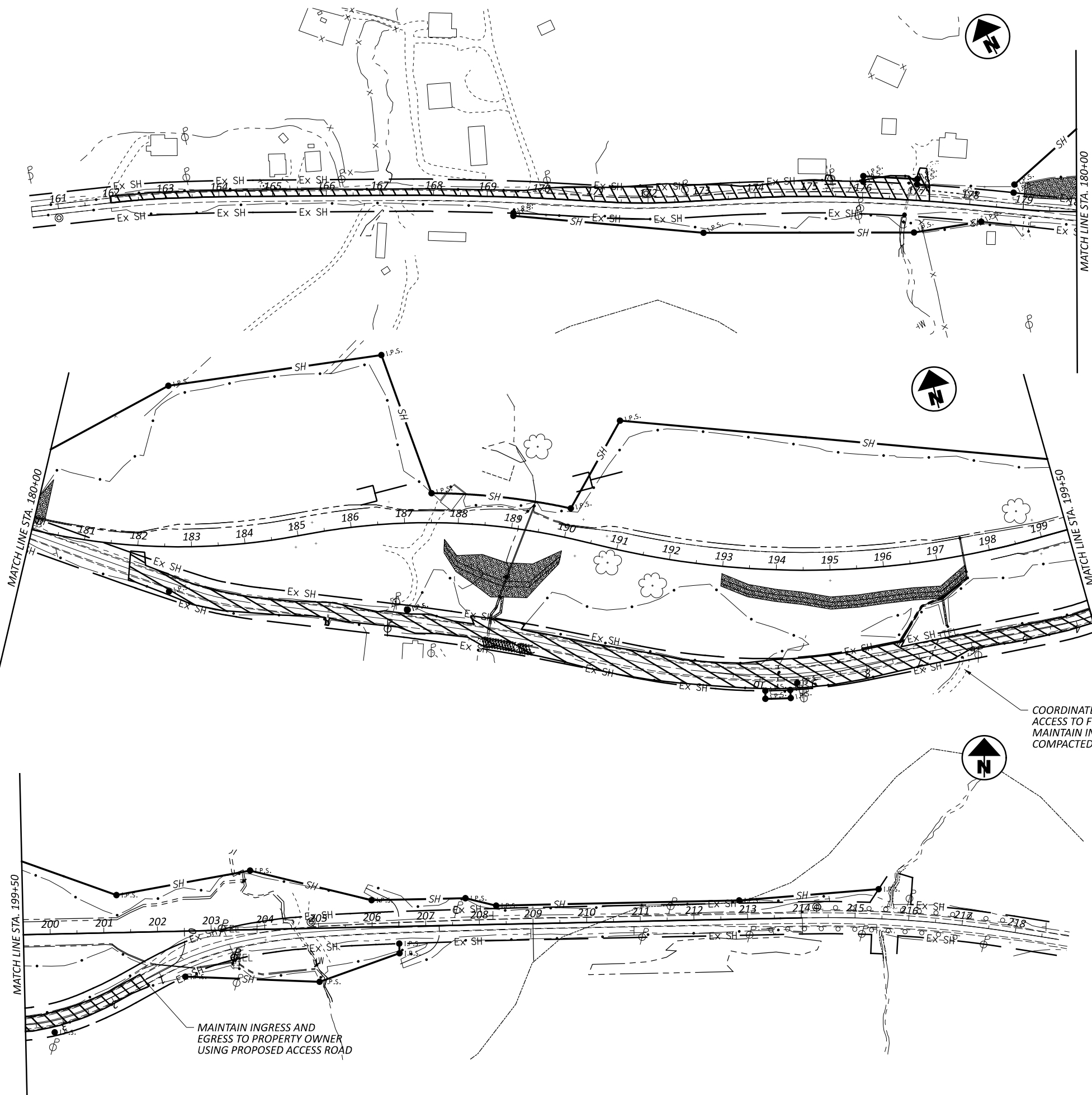

COORDINATE WITH PROPERTY OWNER FOR RESTRICTED ACCESS TO FIELD DRIVE DURING PAVEMENT REMOVAL. MAINTAIN INGRESS AND EGRESS USING ITEM 410 - TRAFFIC COMPACTED AGGREGATE, TYPE B, AS PER PLAN (SHEET 22).

MAINTAIN INGRESS AND EGRESS TO PROPERTY OWNER USING PROPOSED ACCESS ROAD

 - WORK AREA

**NOTES:**  
- REFER TO STANDARD CONSTRUCTION DRAWING MT-96.11 FOR SIGN PLACEMENT AND FURTHER DETAILS.

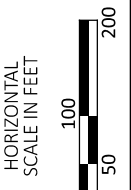

MAINTENANCE OF TRAFFIC  
PHASE 3-B

DESIGN AGENCY



DESIGNER  
JDW

REVIEWER  
ARM 09/26/25

PROJECT ID  
116282

SHEET TOTAL  
P.021A P.207

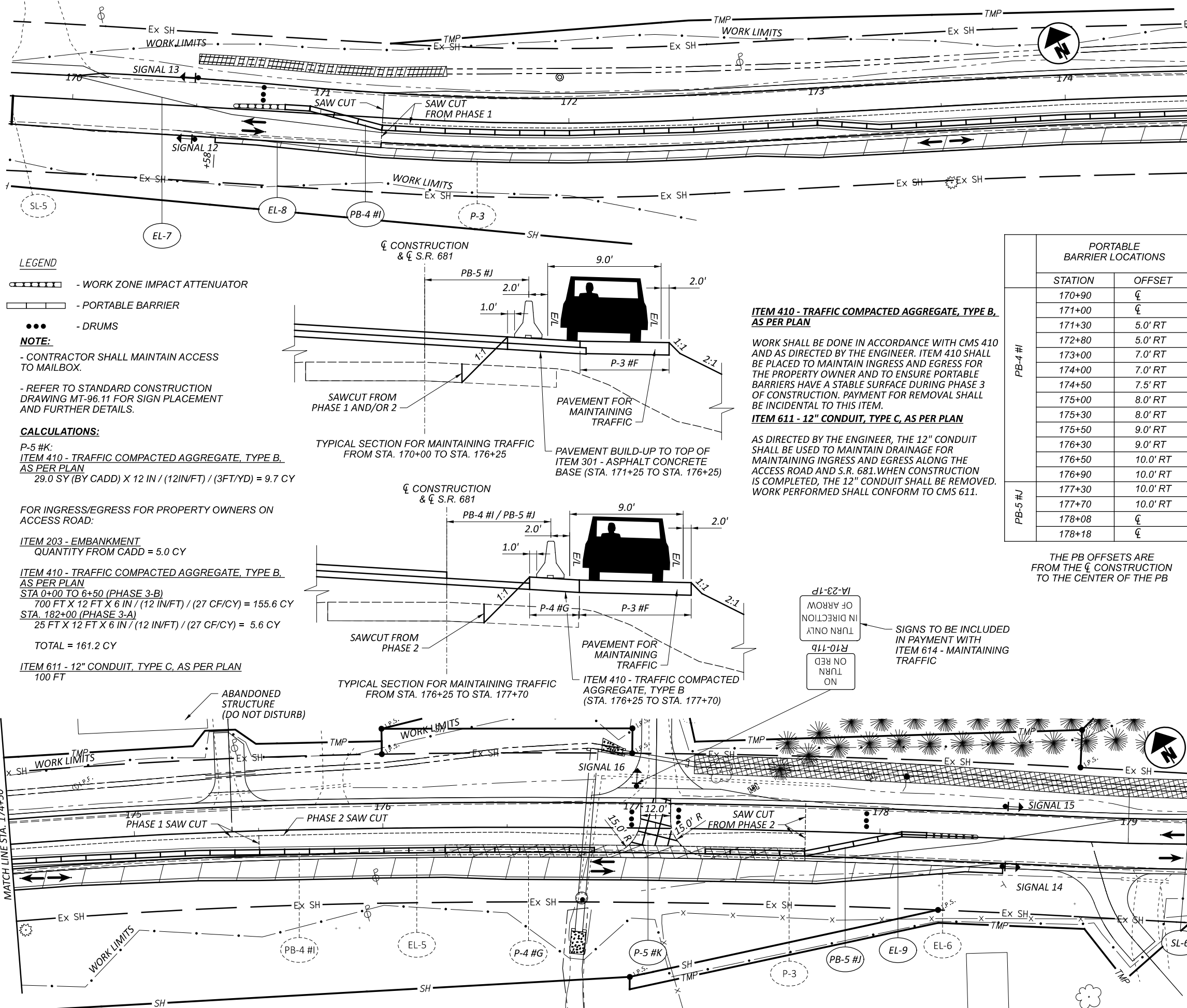

- LEGEND**
- WORK ZONE IMPACT ATTENUATOR
  - PORTABLE BARRIER
  - DRUMS

**NOTE:**

- CONTRACTOR SHALL MAINTAIN ACCESS TO MAILBOX.
- REFER TO STANDARD CONSTRUCTION DRAWING MT-96.11 FOR SIGN PLACEMENT AND FURTHER DETAILS.

**CALCULATIONS:**

P-5 #K:  
 ITEM 410 - TRAFFIC COMPACTED AGGREGATE, TYPE B, AS PER PLAN  
 $29.0 \text{ SY (BY CADD)} \times 12 \text{ IN} / (12 \text{ IN/FT}) / (3 \text{ FT/YD}) = 9.7 \text{ CY}$

FOR INGRESS/EGRESS FOR PROPERTY OWNERS ON ACCESS ROAD:

ITEM 203 - EMBANKMENT  
 QUANTITY FROM CADD = 5.0 CY

ITEM 410 - TRAFFIC COMPACTED AGGREGATE, TYPE B, AS PER PLAN  
 STA 0+00 TO 6+50 (PHASE 3-B)  
 $700 \text{ FT} \times 12 \text{ FT} \times 6 \text{ IN} / (12 \text{ IN/FT}) / (27 \text{ CF/CY}) = 155.6 \text{ CY}$   
 STA. 182+00 (PHASE 3-A)  
 $25 \text{ FT} \times 12 \text{ FT} \times 6 \text{ IN} / (12 \text{ IN/FT}) / (27 \text{ CF/CY}) = 5.6 \text{ CY}$

TOTAL = 161.2 CY

ITEM 611 - 12" CONDUIT, TYPE C, AS PER PLAN  
 100 FT

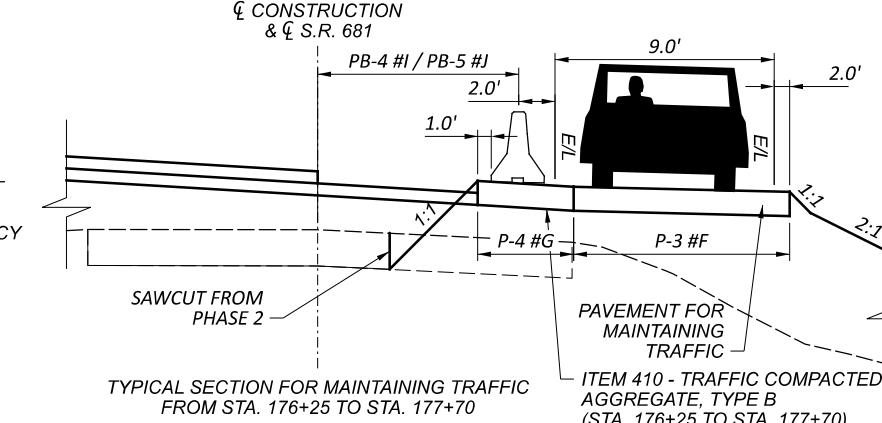
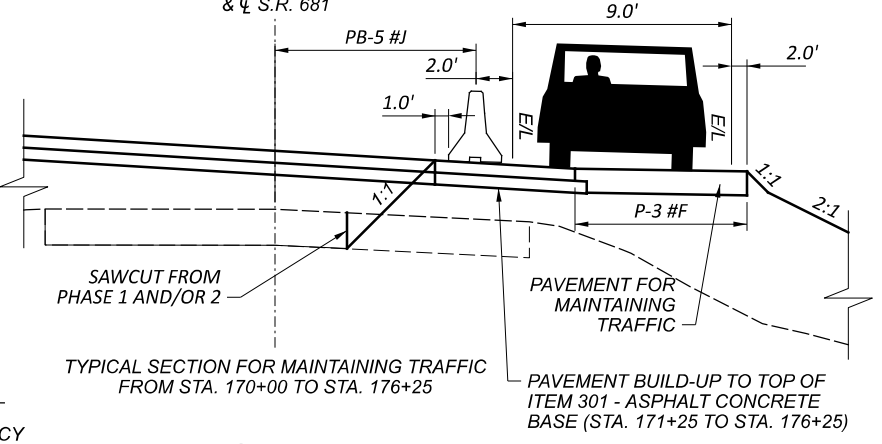

**ITEM 410 - TRAFFIC COMPACTED AGGREGATE, TYPE B, AS PER PLAN**

WORK SHALL BE DONE IN ACCORDANCE WITH CMS 410 AND AS DIRECTED BY THE ENGINEER. ITEM 410 SHALL BE PLACED TO MAINTAIN INGRESS AND EGRESS FOR THE PROPERTY OWNER AND TO ENSURE PORTABLE BARRIERS HAVE A STABLE SURFACE DURING PHASE 3 OF CONSTRUCTION. PAYMENT FOR REMOVAL SHALL BE INCIDENTAL TO THIS ITEM.

**ITEM 611 - 12" CONDUIT, TYPE C, AS PER PLAN**

AS DIRECTED BY THE ENGINEER, THE 12" CONDUIT SHALL BE USED TO MAINTAIN DRAINAGE FOR MAINTAINING INGRESS AND EGRESS ALONG THE ACCESS ROAD AND S.R. 681. WHEN CONSTRUCTION IS COMPLETED, THE 12" CONDUIT SHALL BE REMOVED. WORK PERFORMED SHALL CONFORM TO CMS 611.

PB-4 #I	PORTABLE BARRIER LOCATIONS	
	STATION	OFFSET
	170+90	CL
	171+00	CL
	171+30	5.0' RT
	172+80	5.0' RT
	173+00	7.0' RT
	174+00	7.0' RT
	174+50	7.5' RT
	175+00	8.0' RT
	175+30	8.0' RT
	175+50	9.0' RT
	176+30	9.0' RT
	176+50	10.0' RT
	176+90	10.0' RT
	177+30	10.0' RT
	177+70	10.0' RT
	178+08	CL
	178+18	CL

THE PB OFFSETS ARE FROM THE CL CONSTRUCTION TO THE CENTER OF THE PB

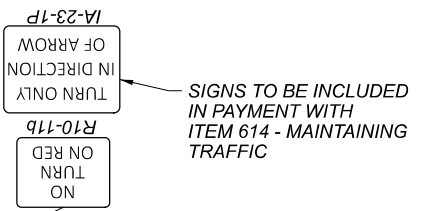

SIGNS TO BE INCLUDED IN PAYMENT WITH ITEM 614 - MAINTAINING TRAFFIC

REF NO.	STATION	SIDE	STATION		CY	EACH	LUMP	FEET	MILE	CLASS I	STOP LINE	OBJECT MARKER, TWO WAY	BARRIER REFLECTOR, TYPE 1	WORK ZONE IMPACT ATTEN.	TRAFFIC COMP. AGG., TYPE B, APP.	12" CONDUIT, TYPE C, APP.	WORK ZONE IMPACT ATTEN.	BARRIER REFLECTOR, TYPE 1	OBJECT MARKER, TWO WAY	WORK ZONE STOP LINE	WORK ZONE EDGE LINE, CLASS I	ROADS FOR MAINT. TRAFFIC	PORTABLE BARRIER	
			FROM	TO																				
EL-7	170+00	LT/RT	170+00	176+25																				
EL-8	170+43	RT	170+43	178+50																				
EL-9	177+70	LT/RT	177+70	179+00																				
SL-6	179+25	LT	179+25	179+25																				
PB-4	170+85	LT/RT	170+85	176+85																				
PB-5	177+30	LT/RT	177+30	178+19																				
P-5	176+98	LT	176+98	177+20																				
	202+00	RT	202+00	202+00																				
<b>TOTALS CARRIED TO GENERAL SUMMARY</b>																								

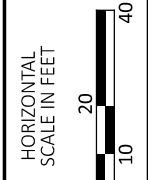

MAINTENANCE OF TRAFFIC  
 PHASE 3

DESIGN AGENCY

DESIGNER: JDW  
 REVIEWER: ARM 09/26/25  
 PROJECT ID: 116282  
 SHEET: P.022 TOTAL: P.207





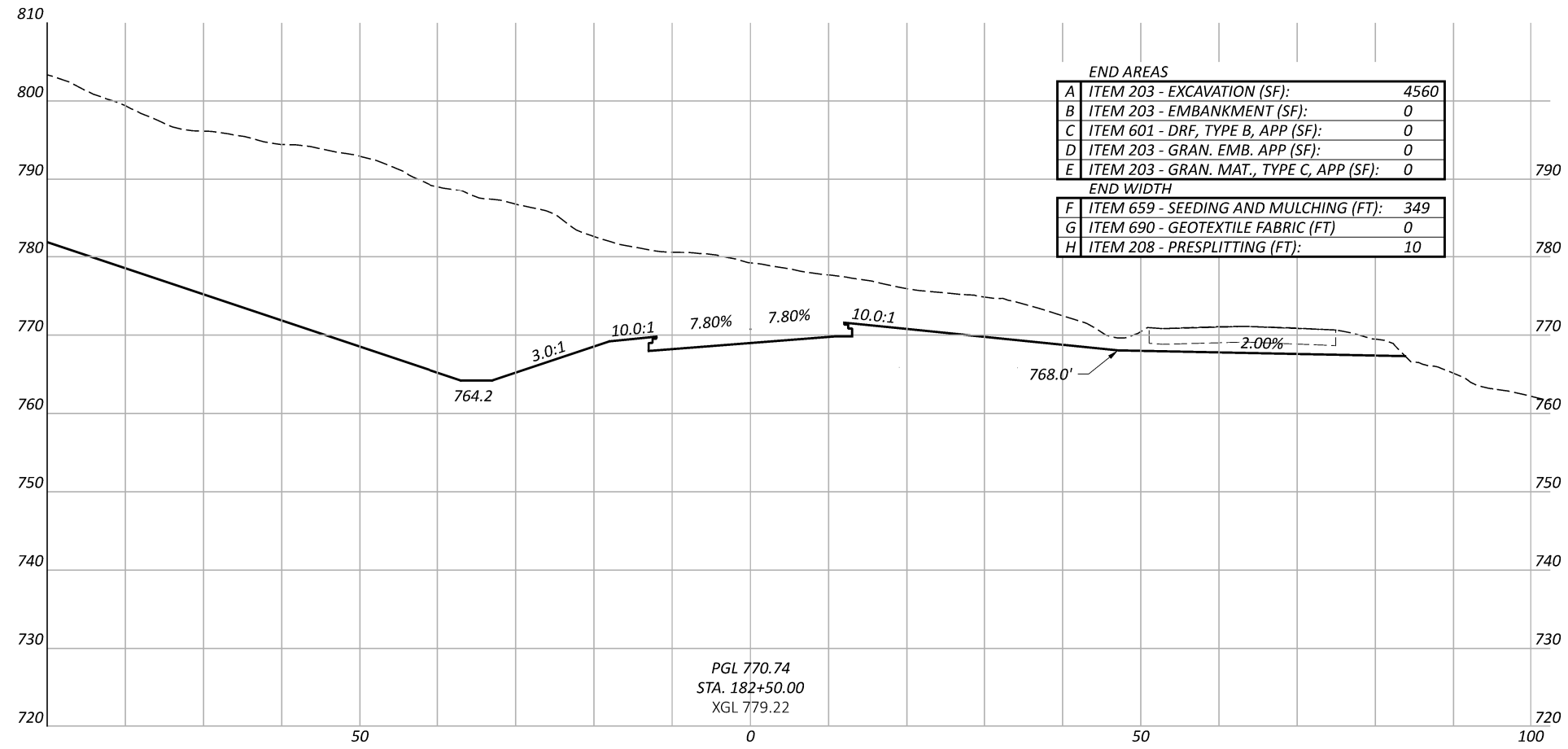
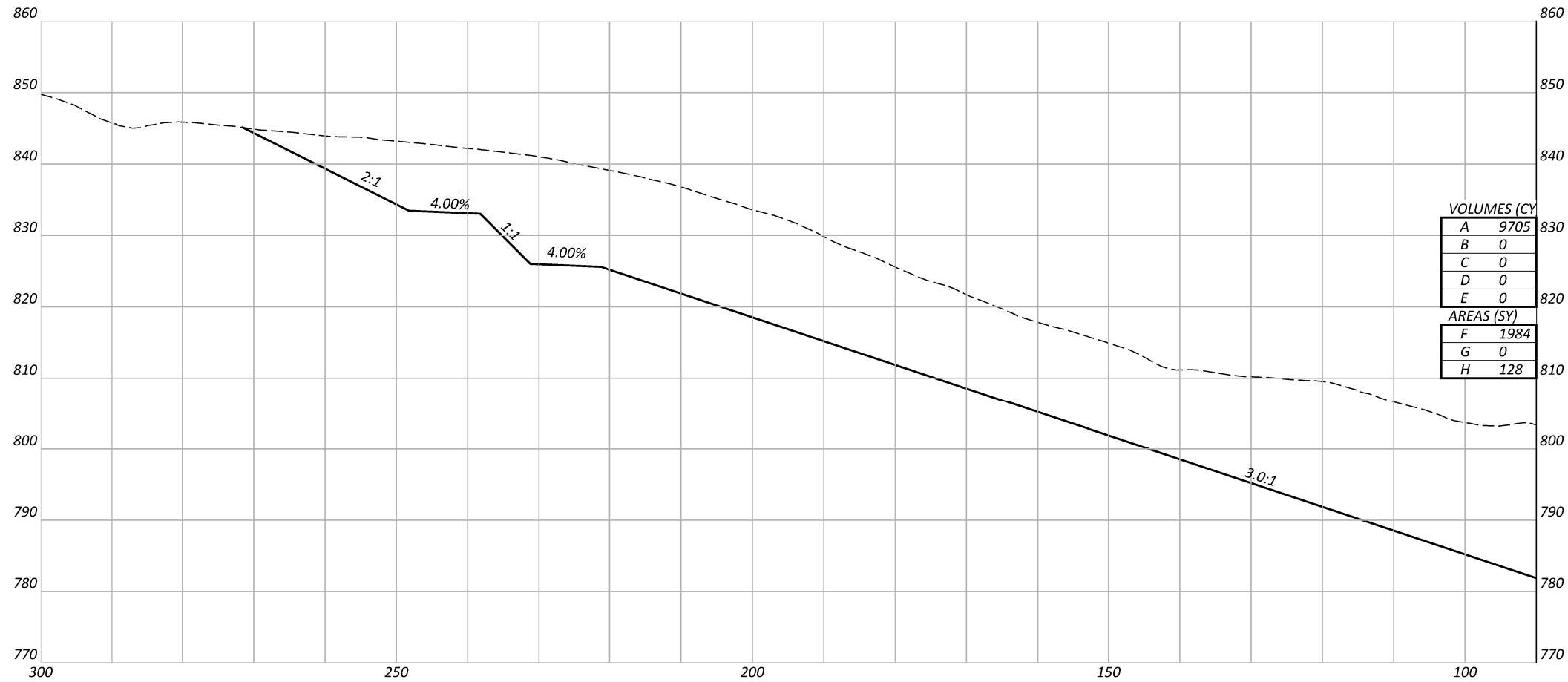

PGL 770.74  
 STA. 182+50.00  
 XGL 779.22

SR 681 CROSS SECTIONS  
 STA. 182+50

DESIGN AGENCY



TOTALS VOLUMES (CY)	
A	9705
B	0
C	0
D	0
E	0
AREAS (SY)	
F	1984
G	0
H	128

DESIGNER	JDW
REVIEWER	ARM
PROJECT ID	116282
SHEET TOTAL	P.058 P.207

PROJECT ID

116282

SHEET TOTAL

P.058 P.207