



STAKEOUT WO #: **10145568**

DESIGN TECH: **HUFFMAN, AARON** PHONE: **937-475-1915**

DESIGN DATE: \_\_\_\_\_ Page: **1 of 3**

DESCRIPTION: **Relocate OH- bridge replacement**

CUSTOMER NAME: **\*P-ODOT-7 (108792)**

ADDRESS: **1499 W Peterson Rd**

TWP / CITY: **Piqua** ZIP: **45356**

LOCATION: **0399 - Staunton Twp, Miami - OH52253990**

SUBDIVISION: \_\_\_\_\_

TRENCHING PARTY: \_\_\_\_\_

JOINT TRENCH: **No**

GRID: **E30-11-C2**

CIRCUIT: **OR1219** TAPS: **.12 KV (100%)**

PHASE: **T**

UPLINE FUSE: **A1502** SIZE: **40K**

STATION	POLE NO.	POLE H/C	PRI. SPAN	PRIMARY		TRANSFORMERS	GROUND	GUY		ANCHOR	SECONDARY AND SERVICE UNITS	SEC/SERV SPAN	SECONDARY/SERVICE WIRE	MISCELLANEOUS UNITS	REMARKS
				UNITS	WIRE			UNIT	LEAD						
Sta 7 - 9+39, 28R	97737	35-5 (R/M)		03-280 9' X-A 2ph (R/M)							04-010 IB (R/M)				R/P w/45'2 set 3ft extra deep for future grading. Backfill w/gravel.
		45-2 (I/S)		03-260 9' X-A 2ph (I/S)							Tie In (R/M)				
											04-010 IB (I/S)				
											Tie In (I/S)				
Sta 1	496702	45-2	101		(3)1/0 AAAC								08-120 C/O Solid	F1252, 300A Solids	
Sta 10	140284	35-5	90		(2)1/0 AAAC										
Sta 2	111601	50-2	202	03-520 D9'X-ADE 1200	(3)1/0 AAAC			02-060 5/16" PDG (I/S)	10 (I/S)	10" ANC (I/S)	04-010 S-DE (R/M)		(2)12-032 Jumper 1/0 (R/M)		
				(2)03-160 PDE (R/M)							04-010 S-DE (I/S)		(2)12-032 Jumper 1/0 (I/S)		
				(2)03-160 PDE (I/S)									12-032 Jumper 1/0 (R/M)		
													12-032 Jumper 1/0 (I/S)		
Sta 4 - 4+88, (I/S) 40R (I/S)	New Pole (I/S)	40-2 (I/S)	372 (I/S)	(2)03-160 DPDE (I/S)	(3)1/0 AAAC (I/S)			02-060 5/16" PDG (I/S)	15 (I/S)	10" ANC (I/S)	(2)04-010 IB (I/S)		(2)12-032 Jumper 1/0 (I/S)	Set new 40'2 pole 100ft W inline from Sta 5. Backfill w/gravel. Add anchor rod for future grading.	
								02-050 5/16" NDG (I/S)	15 (I/S)	Shared 10" ANC (I/S)	(2)04-010 S-DE (I/S)		12-032 Jumper 1/0 (I/S)		
Sta 5	103895	40-2													

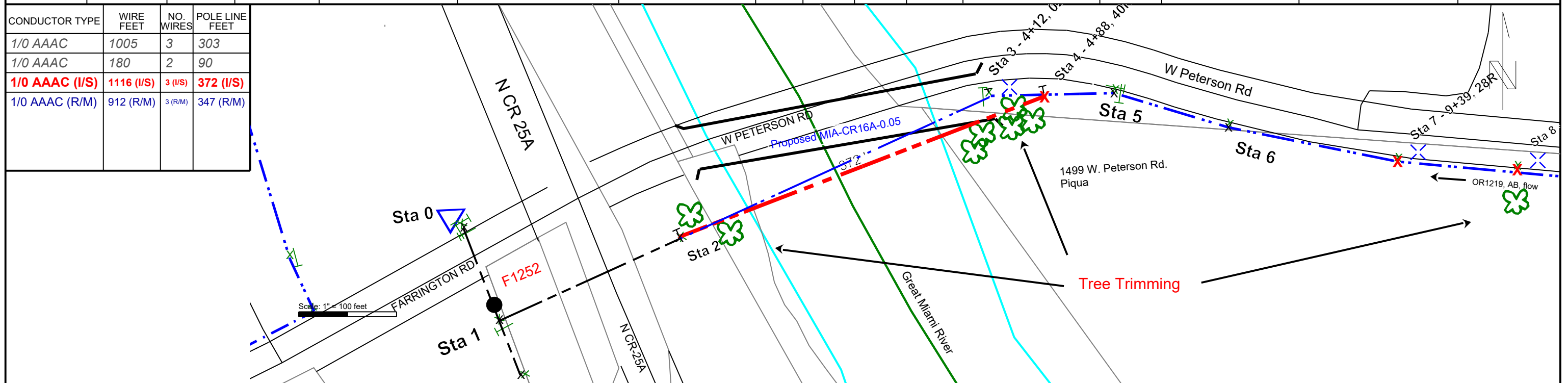

	STAKEOUT WO # : <b>10145568</b>	CUSTOMER NAME : <b>*P-ODOT-7 (108792)</b>	SUBDIVISION : _____	GRID : <b>E30-11-C2</b>
	DESIGN TECH : <b>HUFFMAN, AARON</b> PHONE : <b>937-475-1915</b>	ADDRESS : <b>1499 W Peterson Rd</b>	TRENCHING PARTY : _____	CIRCUIT : <b>OR1219</b> TAPS : <b>12 KV (100%)</b>
	DESIGN DATE : _____ Page : <b>2 of 3</b>	TWP / CITY : <b>Piqua</b> ZIP : <b>45356</b>	JOINT TRENCH : <b>No</b>	PHASE : <b>T</b>
	DESCRIPTION : <b>Relocate OH- bridge replacement</b>	LOCATION : <b>0399 - Staunton Twp, Miami - OH52253990</b>	UPLINE FUSE : <b>A1502</b> SIZE : <b>40K</b>	

STATION	POLE NO.	POLE H/C	PRI. SPAN	PRIMARY		TRANSFORMERS	GROUND	GUY		ANCHOR	SECONDARY AND SERVICE UNITS	SEC/SERV SPAN	SECONDARY/SERVICE WIRE	MISCELLANEOUS UNITS	REMARKS
				UNITS	WIRE			UNIT	LEAD						
Sta 3 - 4+12, (R/M)	103894 (R/M)	40-4 (R/M)	347 (R/M)	(2)03-160 DPDE (R/M)	(3)1/0 AAAC (R/M)			02-060 5/16" PDG (R/M)	7 (R/M)	10" ANC (R/M)	(2)04-010 IB (R/M)			(3)12-032 Jumper 1/0 (R/M)	Pole in conflict
02R (R/M)								02-050- 5/16" NDG (R/M)	7 (R/M)	Shared 10" ANC (R/M)	(2)04-010 S-DE (R/M)				with proposed new bridge alignment.
Sta 6	167339	40-5													
Sta 8 - 10+79,	97738	40-5 (R/M)		03-280 9' X-A 2ph (R/M)							04-010 IB (R/M)				R/L 5ft S. Set 2ft
26R		50-2 (I/S)		(2)03-510 3ph 9' X-AFS (I/S)							Tie In (R/M)				extra deep for future grading. Backfill w/gravel. Primary & Neutral on full side arm x-arms.
Sta 9 - 12+11,	154460	35-5 (R/M)		03-520 D9'X-ADDE 120 (R/M)							04-010 IB (R/M)			(2)12-032 Jumper 1/0 (I/S)	R/P w/40'2. Backfill
19R		40-2 (I/S)		03-520 D9'X-ADDE 120 (I/S)							04-010 IB (I/S)			(2)12-032 Jumper 1/0 (R/M)	w/gravel.
Sta 0	154351	45-2													

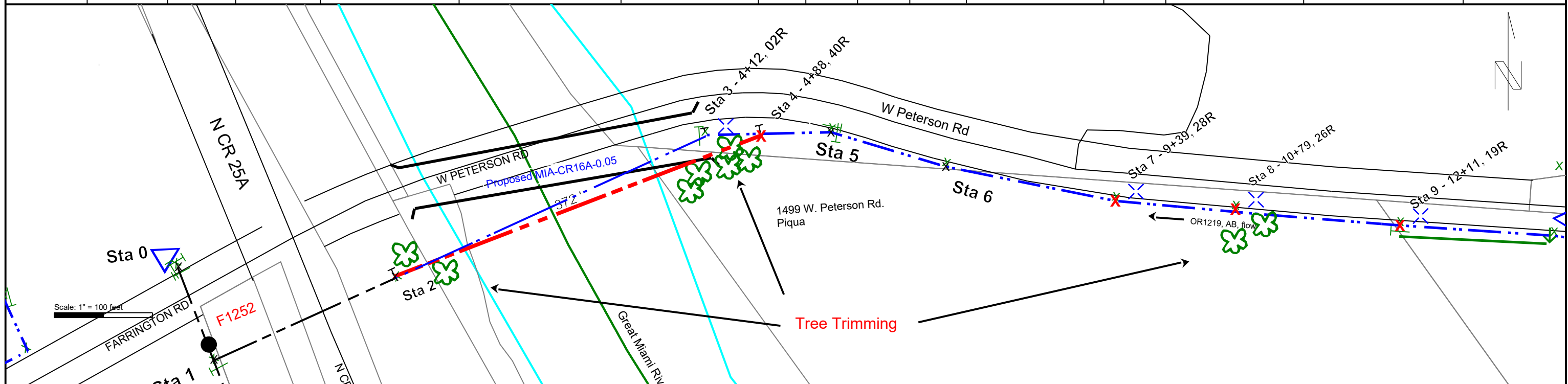



STAKEOUT WO #: **10145568**

DESIGN TECH: **HUFFMAN, AARON** PHONE: **937-475-1915**

DESIGN DATE: \_\_\_\_\_ Page: **3 of 3**

DESCRIPTION: **Relocate OH- bridge replacement**

CUSTOMER NAME: **\*P-ODOT-7 (108792)**

ADDRESS: **1499 W Peterson Rd**

TWP / CITY: **Piqua** ZIP: **45356**

LOCATION: **0399 - Staunton Twp, Miami - OH52253990**

SUBDIVISION: \_\_\_\_\_

TRENCHING PARTY: \_\_\_\_\_

JOINT TRENCH: **No**

GRID: **E30-11-C2**

CIRCUIT: **OR1219** TAPS: **.12 KV (100%)**

PHASE: **T**

UPLINE FUSE: **A1502** SIZE: **40K**

