

- 1

ITEM 441 - 1½" ASPHALT CONCRETE SURFACE COURSE, TYPE 1, (449), PG64-22
- 2

ITEM 407 - NON-TRACKING TACK COAT (APPLIED AT 0.055 GAL/SY)
- 3

ITEM 441 - 1¾" ASPHALT CONCRETE INTERMEDIATE COURSE, TYPE 2, (449)
- 4

ITEM 301 - 6" ASPHALT CONCRETE BASE, PG64-22 (449)
- 5

ITEM 304 - 6" AGGREGATE BASE
- 6

ITEM 204 - SUBGRADE COMPACTION
- 7

ITEM 204 - 12" EXCAVATION OF SUBGRADE (SEE GENERAL NOTES)
- 8

ITEM 204 - 12" GRANULAR MATERIAL, TYPE C (SEE GENERAL NOTES)

- 9

ITEM 609 - COMBINATION CURB AND GUTTER, TYPE 2, AS PER PLAN (CITY OF TROY)
- 10

ITEM 605 - 6" BASE PIPE UNDERDRAINS (18" MAX.)
- 11

ITEM 608 - 5" CONCRETE WALK, AS PER PLAN
- 12

ITEM 452 - 13" NON-REINFORCED CONCRETE PAVEMENT, CLASS QC1P WITH QC/QA
- 13

ITEM 605 - 6" SHALLOW PIPE UNDERDRAINS (18" MIN., 30" MAX.)
- 14

ITEM 622 - CONCRETE BARRIER, SINGLE SLOPE, TYPE D
- 15

NOT USED
- 16

ITEM 606 - GUARDRAIL, TYPE MGS WITH LONG POSTS

- 17

ITEM 659 - SEEDING AND MULCHING
- 18

ITEM 304 - 4" AGGREGATE BASE
- 19

ITEM 204 - GEOTEXTILE FABRIC
- 20

ITEM 608 - 4" CONCRETE WALK
- A

EXISTING PAVEMENT (4" ASPHALT ON 9" CONCRETE - SR 41)
- B

EXISTING SHOULDER
- C

EXISTING PARAPET WALL
- D

EXISTING CURB AND GUTTER
- E

EXISTING CONCRETE PAVEMENT (13" CONCRETE - RAMP D)

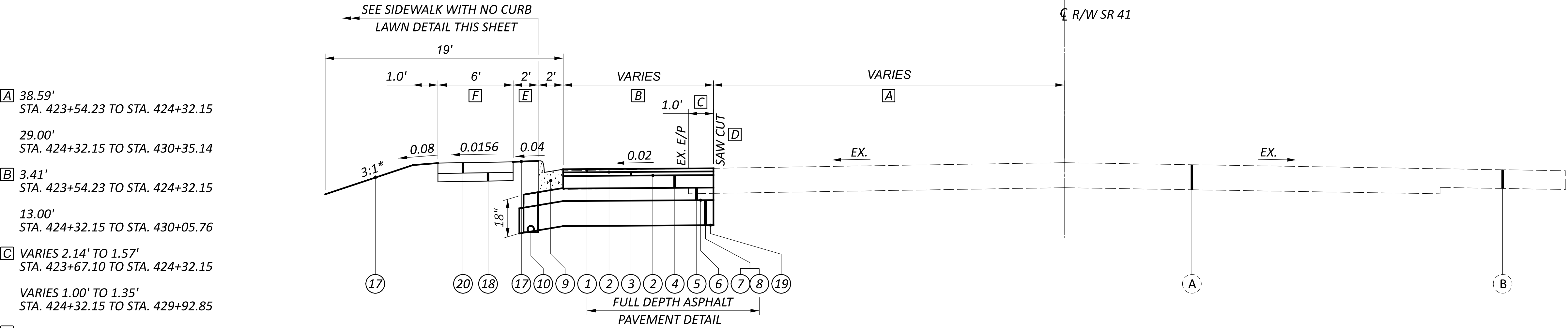

SR 41 WIDENING WITH CURB AND GUTTER, TREE LAWN, AND WALK LEFT SECTION
STA. 423+34.09, LT. TO STA. 430+63.12, LT.

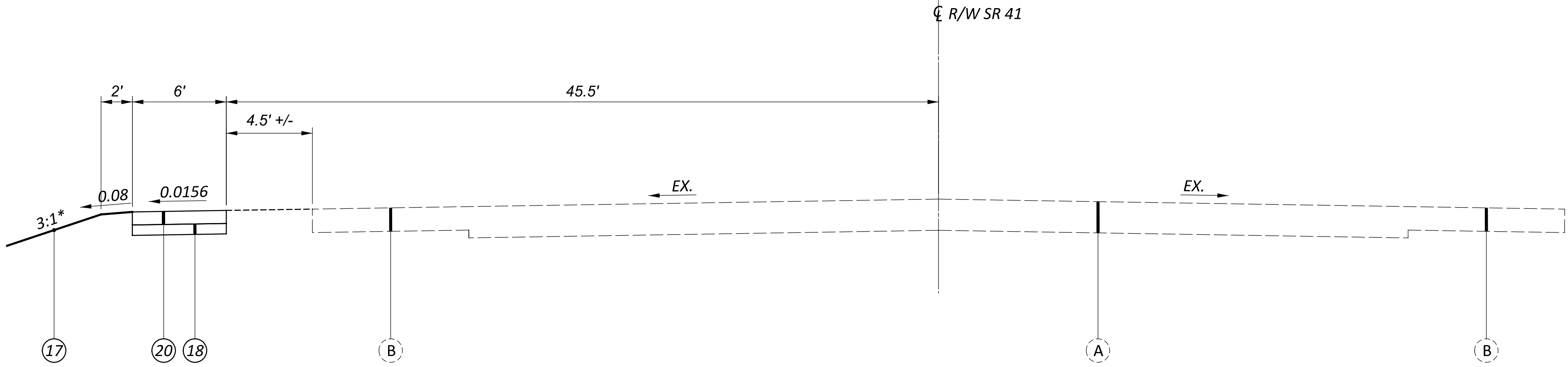

SR 41 WALK ONLY LEFT SECTION
STA. 430+95.97, LT. TO STA. 433+98.75, LT.

NOTE: SUBGRADE STABILIZATION LOCATIONS TO BE
DETERMINED BY THE ENGINEER. PLEASE SEE "ITEM 204 -
SUBGRADE COMPACTION AND PROOF ROLLING NOTE"

* OR AS SHOWN IN CROSS SECTIONS

- [A] VARIES 56.31' TO 42.92'
STA. 440+67.67 TO STA. 441+00.28
- [B] 0.00'
STA. 440+67.67 TO STA. 440+85.61
- 2.00'
STA. 440+85.61 TO STA. 441+00.80
- [C] VARIES 6.00' TO 4.87'
STA. 440+83.07 TO STA. 441+00.80
- [D] THE EXISTING PAVEMENT EDGES SHALL
BE SAW CUT INTO THE EXISTING
PAVEMENT TO LOCATE A SOUND
PAVEMENT EDGE.

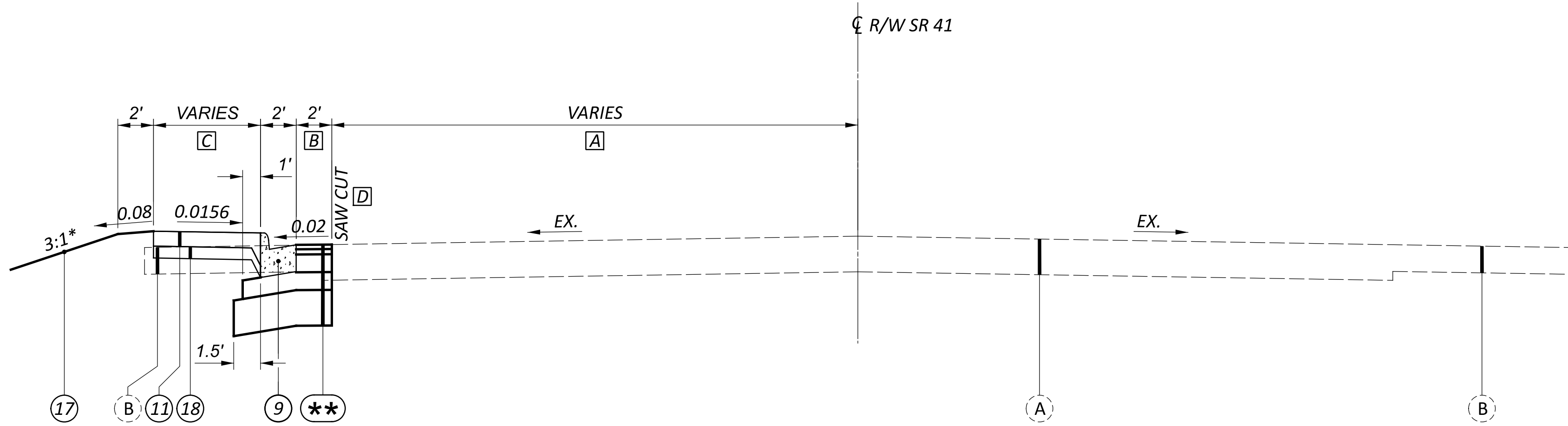

SR 41 CURB AND GUTTER AND WALK LEFT SECTION
STA. 440+67.67, LT. TO STA. 441+00.28, LT.

- [E] 12.00'
STA. 10+00.00 TO STA. 12+40.51
- VARIES 12.00' TO 16.00'
STA. 12+40.51 TO STA. 14+54.32
- [F] FOR PROPOSED CROSS SLOPES
SEE SUPERELEVATION TABLE SHEET P.44

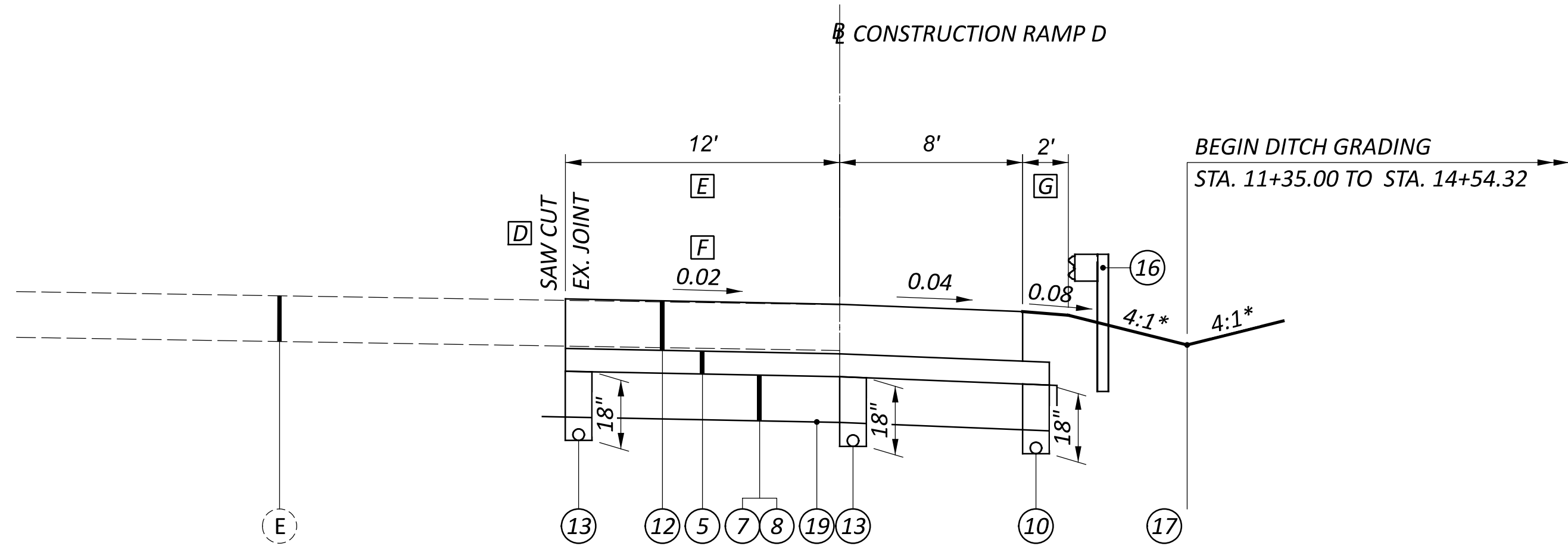

RAMP D SECTION
STA. 10+00.00 TO STA. 14+54.32

- [H] SEE GORE GRADING SHEETS P.74 AND P.75

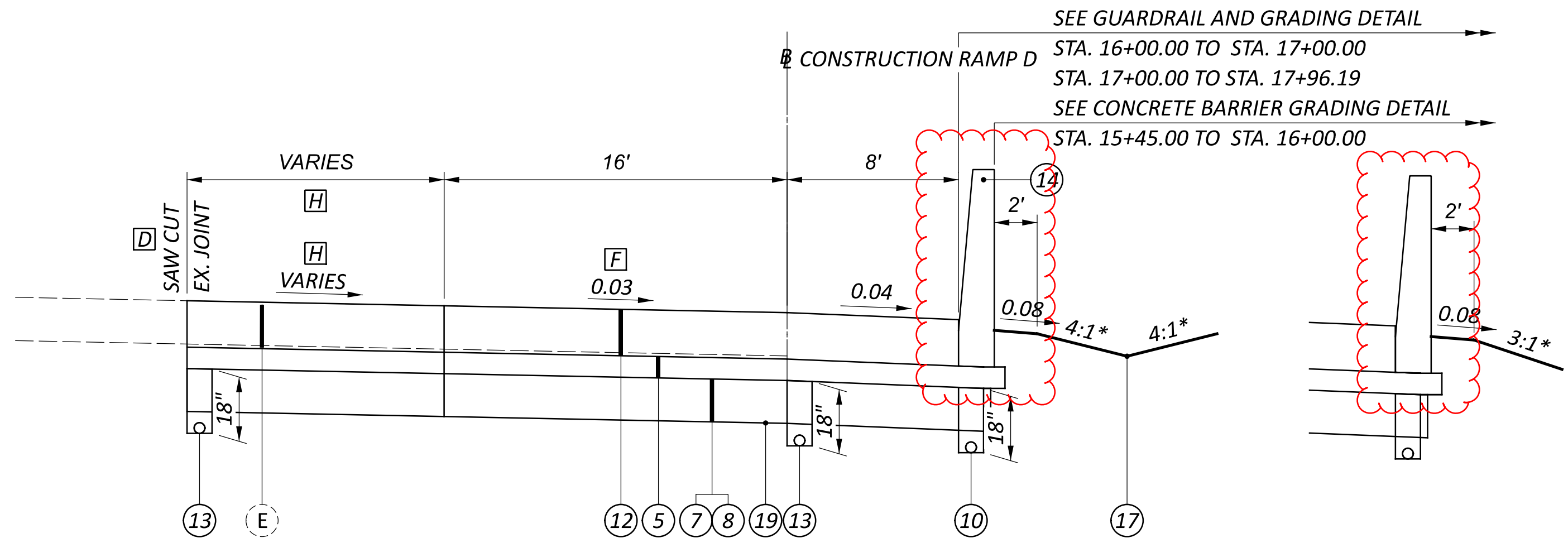

RAMP D SECTION
STA. 14+54.32 TO STA. 17+96.19

CONCRETE BARRIER
GRADING DETAIL
STA. 15+45.00 TO STA. 16+00.00

- [I] VARIES 0.00' TO 2.00'
STA. 16+00.00 TO STA. 16+50.00

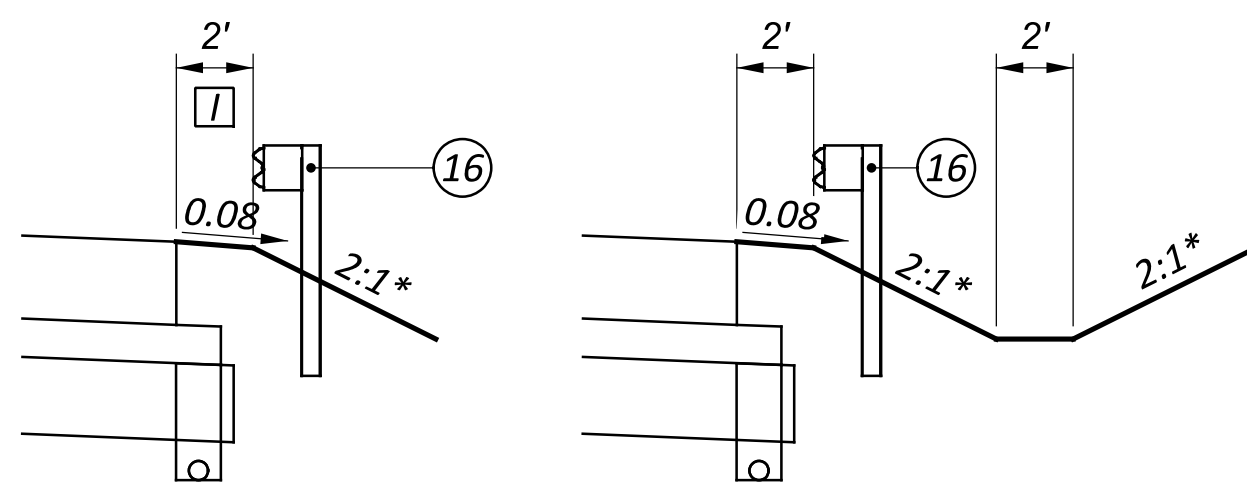

GUARDRAIL
GRADING DETAIL
STA. 16+00.00 TO STA. 16+50.00

GUARDRAIL
GRADING DETAIL
WITH DITCH
STA. 16+50.00 TO STA. 17+96.19

NOTE: SUBGRADE STABILIZATION LOCATIONS TO BE
DETERMINED BY THE ENGINEER. PLEASE SEE "ITEM 204 -
SUBGRADE COMPACTION AND PROOF ROLLING NOTE"

* OR AS SHOWN IN CROSS SECTIONS
** SEE FULL DEPTH ASPHALT PAVEMENT DETAIL
FOR LEGEND, SEE SHEET P.3

CROSSINGS AND CONNECTIONS TO EXISTING PIPES AND UTILITIES

WHERE PLANS PROVIDE FOR A PROPOSED CONDUIT TO BE CONNECTED TO, OR CROSS OVER OR UNDER AN EXISTING SEWER OR UNDERGROUND UTILITY, LOCATE THE EXISTING PIPES OR UTILITIES BOTH AS TO LINE AND GRADE BEFORE STARTING TO LAY THE PROPOSED CONDUIT.

IF IT IS DETERMINED THAT THE ELEVATION OF THE EXISTING CONDUIT, OR EXISTING APPURTENANCE TO BE CONNECTED, DIFFERS FROM THE PLAN ELEVATION OR RESULTS IN A CHANGE IN THE PLAN CONDUIT SLOPE, NOTIFY THE ENGINEER BEFORE STARTING CONSTRUCTION OF ANY PORTION OF THE PROPOSED CONDUIT WHICH WILL BE AFFECTED BY THE VARIANCE IN THE EXISTING ELEVATIONS.

IF IT IS DETERMINED THAT THE PROPOSED CONDUIT WILL INTERSECT AN EXISTING SEWER OR UNDERGROUND UTILITY IF CONSTRUCTED AS SHOWN ON THE PLAN, NOTIFY THE ENGINEER BEFORE STARTING CONSTRUCTION OF ANY PORTION OF THE PROPOSED CONDUIT WHICH WOULD BE AFFECTED BY THE INTERFERENCE WITH AN EXISTING FACILITY.

PAYMENT FOR ALL THE OPERATIONS DESCRIBED ABOVE IS INCLUDED IN THE CONTRACT PRICE FOR THE PERTINENT 611 CONDUIT ITEM.

EXISTING SUBSURFACE DRAINAGE

PROVIDE UNOBSTRUCTED OUTLETS FOR ALL EXISTING UNDERDRAINS OR AGGREGATE DRAINS ENCOUNTERED DURING CONSTRUCTION.

PROVIDE AN OUTLET PER STANDARD CONSTRUCTION DRAWING DM-1.1 FOR ALL UNDERDRAINS THAT OUTLET TO A SLOPE. UNDERDRAINS THAT CAN BE CONNECTED TO THE NEW OR EXISTING UNDERDRAINS AT THE END OF THE PROJECT LIMITS AS WELL AS ALL NECESSARY BENDS OR BRANCHES REQUIRED FOR CONNECTION ARE INCLUDED IN THE BASIS OF PAYMENT FOR UNCLASSIFIED PIPE UNDERDRAINS.

THE FOLLOWING ESTIMATED QUANTITIES FOR WORK ALONG SR-41 HAVE BEEN INCLUDED IN THE GENERAL SUMMARY FOR THE WORK NOTED ABOVE:

ITEM 611, 6" CONDUIT, TYPE F 100 FT.
ITEM 611, PRECAST REINFORCED CONCRETE OUTLET 1 EACH
ITEM 605, 6" UNCLASSIFIED PIPE UNDERDRAINS 100 FT.

THE FOLLOWING ESTIMATED QUANTITIES FOR WORK ALONG RAMP D HAVE BEEN INCLUDED IN THE GENERAL SUMMARY FOR THE WORK NOTED ABOVE:

ITEM 611, 6" CONDUIT, TYPE B 100 FT.
ITEM 611, 6" CONDUIT, TYPE F 100 FT.
ITEM 611, 12" CONDUIT, TYPE B 100 FT.
ITEM 611, 12" CONDUIT, TYPE C 100 FT.
ITEM 611, PRECAST REINFORCED CONCRETE OUTLET 1 EACH
ITEM 605, 6" UNCLASSIFIED PIPE UNDERDRAINS 100 FT.

CLEARING AND GRUBBING

ALTHOUGH THERE ARE NO TREES OR STUMPS SPECIFICALLY MARKED FOR REMOVAL WITHIN THE LIMITS OF THE PROJECT, A LUMP SUM QUANTITY IS INCLUDED IN THE GENERAL SUMMARY FOR ITEM 201, CLEARING AND GRUBBING. ALL PROVISIONS AS SET FORTH IN THE SPECIFICATIONS UNDER THIS ITEM ARE INCLUDED IN THE LUMP SUM PRICE BID FOR ITEM 201, CLEARING AND GRUBBING.

SEEDING AND MULCHING

THE FOLLOWING QUANTITIES ARE PROVIDED TO PROMOTE GROWTH AND CARE OF PERMANENT SEEDED AREAS ALONG SR-41:

659, SOIL ANALYSIS TEST 1 EACH
659, TOPSOIL 165 CU. YD.
659, SEEDING AND MULCHING 1,021 SQ. YD.
659, REPAIR SEEDING AND MULCHING 51 SQ. YD.
659, INTER-SEEDING 51 SQ. YD.
659, COMMERCIAL FERTILIZER 0.14 TON
659, LIME 0.21 ACRES
659, WATER 6 M. GAL.

THE FOLLOWING QUANTITIES ARE PROVIDED TO PROMOTE GROWTH AND CARE OF PERMANENT SEEDED AREAS ALONG RAMP D:

659, SOIL ANALYSIS TEST 1 EACH
659, TOPSOIL 935 CU. YD.
659, SEEDING AND MULCHING 5,785 SQ. YD.
659, REPAIR SEEDING AND MULCHING 290 SQ. YD.
659, INTER-SEEDING 290 SQ. YD.
659, COMMERCIAL FERTILIZER 0.81 TON
659, LIME 1.20 ACRES
659, WATER 33 M. GAL.

SEEDING AND MULCHING SHALL BE APPLIED TO ALL AREAS OF EXPOSED SOIL BETWEEN THE RIGHT-OF-WAY LINES, AND WITHIN THE CONSTRUCTION LIMITS FOR AREAS OUTSIDE THE RIGHT-OF-WAY LINES COVERED BY WORK AGREEMENT OR SLOPE EASEMENT. QUANTITY CALCULATIONS FOR SEEDING AND MULCHING ARE BASED ON THESE LIMITS. ALL AREA DESIGNATED FOR SEEDING SHALL HAVE A MINIMUM OF 3" OF TOPSOIL OVER THE ENTIRE AREA. THE AREA SHALL BE RAKED, ROLLED, AND DRESSED READY FOR SEEDING. NO STONE OVER 1" IN SIZE PERMITTED.

ITEM 611 - DRAINAGE STRUCTURE, MISC.: FERNCO COUPLER WITH SHEAR BAND

THE CONTRACTOR SHALL UTILIZE FERNCO COUPLERS WITH SHEAR BANDS WHEN CONNECTING PROPOSED DRAINAGE CONDUIT TO EXISTING DRAINAGE CONDUIT ALONG SR-41. ALL FERNCO COUPLERS SHALL BE SPECIFIED BASED UPON THE EXISTING AND PROPOSED CONDUIT SIZES AND TYPES. IN THE CASE THAT A FERNCO COUPLER IS NOT READILY AVAILABLE FOR USE, THE CONTRACTOR MAY UTILIZE STANDARD ODOT MASONRY ODOT COLLARS.

IF A MASONRY COLLAR IS USED, ITS COST SHALL BE INCLUDED IN THE UNIT PRICE BID FOR THE NEW CONDUIT AND NO PAYMENT WILL BE MADE FOR ITEM 611 - DRAINAGE STRUCTURE, MISC.: FERNCO COUPLER WITH SHEAR BAND.

ITEM 608 - 5" CONCRETE WALK, AS PER PLAN

THE CONTRACTOR SHALL CONSTRUCT ALL CONCRETE WALK AS SHOWN WITHIN THE PLANS AS TO CONFORM TO THE CITY OF TROY CONSTRUCTION STANDARDS, PAGE NO. 300-8 "SIDEWALK DETAIL". SEE SHEET TYPICAL SECTIONS FOR ADDITIONAL DETAILS.

NONRUBBER TIRE VEHICLES (CITY OF TROY)

NO NONRUBBER TIRE VEHICLES SHALL BE MOVED ON CITY STREETS. EXCEPTIONS MAY BE GRANTED BY THE CITY WHERE SHORT DISTANCES AND SPECIAL CIRCUMSTANCES ARE INVOLVED. GRANTING OF EXPECTATIONS MUST BE IN WRITING AND ANY RESULTING DAMAGE MUST BE REPAIRED TO THE SATISFACTION OF THE CITY. THE CONTRACTOR SHALL USE EXTREME CARE WHEN OPERATING NONRUBBER TIRE VEHICLES ON STREETS OR DRIVEAYS TO AVOID MARKING OR DAMAGING THE PAVEMENT. PROTECTION OF THE PAVEMENT FROM DAMAGE RESULTING FROM THE TRACKS OF NONRUBBER TIRE VEHICLES UTILIZED IN TRENCH EXCAVATION SHALL BE REQUIRED. A WOOD PLANK SYSTEM, USED TIRES, RUBBER MATS, OR OTHER MEANS AS APPROVED BY THE CITY'S REPRESENTATIVES SHALL BE USED TO PROTECT THE PAVEMENT.

ITEM 202 - STRUCTURE REMOVED, AS PER PLAN

THE CONTRACTOR SHALL REMOVE THE EXISTING CONCRETE PAD ALONG WITH THE EXISTING FOUNDATION TO A DEPTH OF 1 FT BELOW THE FINAL PROPOSED GRADE. RESTORATION SHALL INCLUDE ANY EMBANKMENT NECESSARY FOR FINAL GRADING.

PAYMENT FOR ALL WORK PERFORMED IN THE REMOVAL OF THE STRUCTURE, DISPOSAL, AND RESTORATION SHALL BE INCIDENTAL TO ITEM 202, STRUCTURE REMOVED, AS PER PLAN.

THE ESTIMATED DIMENSIONS OF THE STRUCTURE ARE AS FOLLOWS: LENGTH = 13.8', WIDTH = 11.8', DEPTH = 3.0'. IT IS ESTIMATED THAT 18 CY WILL BE REMOVED.

REVIEW OF DRAINAGE FACILITIES

PRIOR TO THE START OF WORK AND AGAIN BEFORE FINAL ACCEPTANCE, PERFORM AN INSPECTION WITH REPRESENTATIVES OF THE DEPARTMENT, CONTRACTOR AND LOCALS OF ALL EXISTING DRAINAGE FACILITIES THAT ARE TO REMAIN IN SERVICE WHICH MAY BE AFFECTED BY THE WORK. THE CONDITION OF THE EXISTING CONDUITS AND THEIR APPURTENANCES IS DETERMINED FROM FIELD OBSERVATIONS. RECORDS OF THE INSPECTION ARE MAINTAINED BY THE DEPARTMENT.

CONFIRM ALL EXISTING SEWERS INSPECTED INITIALLY BY THE ABOVE-MENTIONED PARTIES ARE MAINTAINED AND LEFT IN A CONDITION COMPARABLE TO THAT DETERMINED BY THE ORIGINAL INSPECTION. THE CONTRACTOR IS RESPONSIBLE TO CORRECT ANY CHANGE IN THE CONDITION RESULTING FROM THEIR OPERATIONS AS DIRECTED AND APPROVED BY THE ENGINEER.

PAYMENT FOR ALL OPERATIONS DESCRIBED ABOVE IS INCLUDED IN THE CONTRACT PRICE FOR THE PERTINENT 611 CONDUIT ITEMS.

ITEM 609 - COMBINATION CURB AND GUTTER, TYPE 2, AS PER PLAN (CITY OF TROY)

THE CONTRACTOR SHALL CONSTRUCT CURB AND GUTTER AS SHOWN WITHIN THE PLANS AS TO CONFORM TO THE CITY OF TROY CONSTRUCTION STANDARDS, PAGE NO. 300-13 "CURB DETAILS".

SUBCONTRACTOR SUPERVISION (CITY OF TROY)

THE CONTRACTOR IS REQUIRED TO HAVE A PROJECT SUPERVISOR ON-SITE TO SUPERVISE THE SUBCONTRACTOR FOR QUALITY CONTROL PURPOSES AND TO PROVIDE ANY NECESSARY ASSISTANCE TO THE SUBCONTRACTOR TO ENSURE QUALITY WORK.

UTILITIES (CITY OF TROY)

THE MAXIMUM LENGTH OF ANY UTILITY TRENCH TO BE OPEN AT ANY TIME SHALL BE 100' UNLESS OTHERWISE APPROVED.

ALL TEMPORARY PAVEMENT AND SIDEWALK SHALL BE MAINTAINED BY THE CONTRACTOR OR THE DEVELOPER AT HIS OWN EXPENSE IN A SUITABLE AND SAFE CONDITION FOR TRAFFIC UNTIL PERMANENT REPLACEMENT IS MADE OR THE PROJECT RECEIVES FINAL APPROVAL FROM THE CITY.

MUD (CITY OF TROY)

THE TRACKING OR SPILLING OF MUD, DIRT, OR DEBRIS UPON CITY STREETS IS PROHIBITED, AND ANY SUCH OCCURENCE SHALL BE CLEANED UP IMMEDIATELY BY THE CONTRACTOR.

ITEM 202 - REMOVAL MISC: UTILITY PULL BOX REMOVED AND LINES CAPPED

THE CONTRACTOR SHALL REMOVE THE EXISTING UTILITY PULL BOX AS CALLED OUT WITHIN THE PLANS. ALL CONNECTING LINES TO THE EXISTING BOX SHALL BE TRACED BACK TO THE PROPOSED LA R/W LINE AND CAPPED.

SAFETY (CITY OF TROY)

THE CONTRACTOR SHALL BE SOLELY RESPONSIBLE FOR COMPLYING WITH ALL FEDERAL, STATE, AND LOCAL SAFETY REQUIREMENTS TOGETHER WITH EXERCISING PRECAUTIONS AT ALL TIMES FOR THE PROTECTION OF PERSONS (INCLUDING EMPLOYEES) AND PROPERTY. IT IS ALSO THE SOLE RESPONSIBILITY OF THE CONTRACTOR TO INITIATE, MAINTAIN, AND SUPERVISE ALL SAFETY REQUIREMENTS, PRECAUTIONS, AND PROGRAMS IN CONNECTION WITH THE WORK.

BENCHING AROUND POLES

ALONG THE NORTH SIDE OF SR-41, THE CONTRACTOR SHALL NON-PERFORM THE LOWEST SECTION OF BENCHING WHEN WITHIN 10FT OF AN EXISTING AES POLE.

THE CONTRACTOR SHALL CONTACT AES TWO (2) WEEKS PRIOR TO CONSTRUCTING ANY GRADING WITHIN THE VICINITY OF THE EXISTING POLES. AES SHALL BE RESPONSIBLE FOR ALL BRACING OF EXISTING POLES.

ITEM 512 - SEALING OF CONCRETE SURFACES, AS PER PLAN (CITY OF TROY)

ALL EXPOSED CONCRETE SHALL HAVE A CURING AND SEALING COMPOUND APPLIED. THE CURING AND SEALING COMPOUND SHALL BE APPLIED IN 2 COATS. CURING AND SEALING COMPOUND SHALL CONFORM TO ODOT CMS 512 - NON-EPOXY SEALER. ALL WORK COMPLETED FOR THE CURING AND SEALING OF EXPOSED CONCRETE SHALL BE INCIDENTAL TO ITEM 512 - SEALING OF CONCRETE, AS PER PLAN (CITY OF TROY).

ITEM 512, SEALING OF CONCRETE SURFACES, AS PER PLAN (CITY OF TROY)

1002 SY

CONTROL OF SPILLS (CITY OF TROY)

BEST CONSTRUCTION PRACTICES ARE TO BE IMPLEMENTED TO MINIMIZE WATER QUALITY IMPACTS. IDLE EQUIPMENT, PETROCHEMICALS, AND TOXIC/HAZARDOUS MATERIALS SHALL NOT BE STORED NEAR DRAINAGE WAYS, DITCHES, OR STREAMS. A SPILL CONTAINMENT KIT IS TO BE MAINTAINED ONSITE THROUGHOUT CONSTRUCTION ACTIVITIES. SPILLS OF FUELS, OILS, CHEMICALS, OR OTHER MATERIALS WHICH COULD POSE A THREAT TO GROUNDWATER SHALL BE CLEANED UP IMMEDIATELY. IF THE SPILL IS A REPORTABLE AMOUNT, THE LOCAL FIRE DEPARTMENT IS TO BE CONTACTED.

CONSTRUCTION NOISE (CITY OF TROY)

IN ORDER TO MINIMIZE ANY ADVERSE CONSTRUCTION NOISE, ANY POWER - OPERATED CONSTRUCTION - TYPE DEVICES SHALL NOT BE OPERATED BETWEEN THE HOURS OF 7:00 PM AND 7:00 AM. IN ADDITION, ANY SUCH DEVICE SHALL NOT BE OPPERATED AT ANY TIME IN SUCH A MANNER THAT THE NOISE CREATED SUBSTANTIALLY EXCEEDS THE NOISE CUSTOMARILY AND NECESSARILY ATTENDANT TO THE REASONABLE AND EFFICIENT PERFORMANCE OF SUCH EQUIPMENT.

NOTE: GUIDANCE AS STATED ABOVE IS ONLY APPLICABLE FOR WORK COMPLETED FOR SR-41 WITHIN THE CITY OF TROY.

CONSTRUCTION IN PROXIMITY OF METRONET UTILITIES

THE CONTRACTOR SHALL NOTIFY AND COORDINATE WITH METRONET A MINIMUM OF ONE (1) WEEK PRIOR TO COMPLETING ANY WORK WITHIN THE PROXIMITY OF ALL EXISTING METRONET UTILITIES ALONG THE NORTH SIDE OF SR-41.

EX. PULL BOX-----STA. 423+85.42, OFF. 56.09' LT

EX. FIBER-----STA. 423+34.66, OFF. 54.84' LT
TO
STA. 426+75.33, OFF. 92.94' LT

DESIGN AGENCY

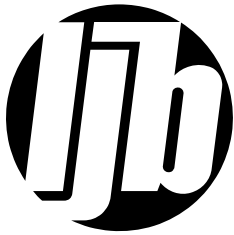

DESIGNER

AIM

REVIEWER

BMG 11/01/24

PROJECT ID

118156

SHEET

TOTAL

P.8

P.122

SHEET NUM.										PART.			ITEM	ITEM EXT	GRAND TOTAL	UNIT	DESCRIPTION	SEE SHEET NO.
OFFICE CALCS	P.7	P.8	P.32	P.33	P.34	P.58	P.70	RW.05		01/SAF/21	02/SAF/21	03/SAF/21						
																	ROADWAY	
										1			201	11000	LS		CLEARING AND GRUBBING	
			1							1			202	11005	1	EACH	STRUCTURE REMOVED, AS PER PLAN	P.8
			5,834							4,686		1,148	202	23000	5,834	SY	PAVEMENT REMOVED	
			220							157		63	202	30000	220	SF	WALK REMOVED	
			72							50		22	202	32000	72	FT	CURB REMOVED	
			60									60	202	32500	60	FT	CURB AND GUTTER REMOVED	
			99							87		12	202	35100	99	FT	PIPE REMOVED, 24" AND UNDER	
			954							954			202	38000	954	FT	GUARDRAIL REMOVED	
			533							533			202	75000	533	FT	FENCE REMOVED	
			1							1			202	98100	1	EACH	REMOVAL MISC.:UTILITY PULL BOX REMOVED AND CAPPED	P.8
		800					1,422	2,741		3,541		1,422	203	10000	4,963	CY	EXCAVATION	
	8,814	800					2,105	1,212		2,012		2,105	203	20000	4,117	CY	EMBANKMENT	
			202							7,897		1,119	204	10000	9,016	SY	SUBGRADE COMPACTION	
		661	69							237		493	204	13000	730	CY	EXCAVATION OF SUBGRADE	
		661	69							237		493	204	30020	730	CY	GRANULAR MATERIAL, TYPE C	
		2								1		1	204	45000	2	HOURL	PROOF ROLLING	
		1,976								697		1,279	204	50000	1,976	SY	GEOTEXTILE FABRIC	
			1,002									1,002	512	10001	1,002	SY	SEALING OF CONCRETE SURFACES, AS PER PLAN	P.8
				1,387.5						1,387.5			606	15100	1,387.5	FT	GUARDRAIL, TYPE MGS WITH LONG POSTS	
				1						1			606	26050	1	EACH	ANCHOR ASSEMBLY, MGS TYPE B	P.8A
				1						1			606	26550	1	EACH	ANCHOR ASSEMBLY, MGS TYPE T	
				1						1			606	35002	1	EACH	MGS BRIDGE TERMINAL ASSEMBLY, TYPE 1	
				1						1			606	35102	1	EACH	MGS BRIDGE TERMINAL ASSEMBLY, TYPE 2	
				527						527			607	23000	527	FT	FENCE, TYPE CLT	
			3,302									3,302	608	10000	3,302	SF	4" CONCRETE WALK	
			5,238							34		5,204	608	12001	5,238	SF	5" CONCRETE WALK, AS PER PLAN	P.8
			588							76		512	608	52000	588	SF	CURB RAMP	
			36							12		24	608	53020	36	SF	DETECTABLE WARNING	
				150						150			622	10160	150	FT	CONCRETE BARRIER, SINGLE SLOPE, TYPE D	
				2						2			622	25000	2	EACH	CONCRETE BARRIER END SECTION, TYPE D	
								4		4			623	40520	4	EACH	RIGHT-OF-WAY MONUMENT	
																	EROSION CONTROL	
					5					5			601	21050	5	SY	TIED CONCRETE BLOCK MAT WITH TYPE 1 UNDERLAYMENT	
		2								1		1	659	00100	2	EACH	SOIL ANALYSIS TEST	
		1,100								935		165	659	00300	1,100	CY	TOPSOIL	
		6,806								5,785		1,021	659	10000	6,806	SY	SEEDING AND MULCHING	
		341								290		51	659	14000	341	SY	REPAIR SEEDING AND MULCHING	
		341								290		51	659	15000	341	SY	INTER-SEEDING	
			0.95							0.81		0.14	659	20000	0.95	TON	COMMERCIAL FERTILIZER	
			1.41							1.2		0.21	659	31000	1.41	ACRE	LIME	
			39							33		6	659	35000	39	MGAL	WATER	
					2,795					2,172		623	670	00700	2,795	SY	DITCH EROSION PROTECTION	
					289					289			670	00720	289	SY	DITCH EROSION PROTECTION MAT, TYPE B	
										1			832	15000	LS		STORM WATER POLLUTION PREVENTION PLAN	
										1			832	15002	LS		STORM WATER POLLUTION PREVENTION INSPECTIONS	
										1			832	15010	LS		STORM WATER POLLUTION PREVENTION INSPECTION SOFTWARE	
										10,000			832	30000	10,000	EACH	EROSION CONTROL	
																	DRAINAGE	
					0.8					0.8			602	20000	0.8	CY	CONCRETE MASONRY	
					4,322					4,322			605	11100	4,322	FT	6" SHALLOW PIPE UNDERDRAINS	
		200								100		100	605	13300	200	FT	6" UNCLASSIFIED PIPE UNDERDRAINS	
					1,699					1,042		657	605	14000	1,699	FT	6" BASE PIPE UNDERDRAINS	
					100					80		20	611	00510	100	FT	6" CONDUIT, TYPE F FOR UNDERDRAIN OUTLETS	
			100							100			611	00900	100	FT	6" CONDUIT, TYPE B-707.33	
			200							100		100	611	01500	200	FT	6" CONDUIT, TYPE F-707.33	
			100			336				106		330	611	04400	436	FT	12" CONDUIT, TYPE B-706.02	
										100			611	04600	100	FT	12" CONDUIT, TYPE C-706.02	
			100			44				44			611	05900	44	FT	15" CONDUIT, TYPE B-706.02	

GENERAL SUMMARY

DESIGN AGENCY



DESIGNER

AIM

REVIEWER

BMG 11/01/24

PROJECT ID

118156

SHEET

P.29

TOTAL

P.122

SHEET NUM.											PART.			ITEM	ITEM EXT	GRAND TOTAL	UNIT	DESCRIPTION	SEE SHEET NO.
OFFICE CALCS	P.8	P.32	P.34	P.87	P.88	P.89	P.90	P.91	P.108	P.109	01/SAF/21	02/SAF/21	03/SAF/21						
			89								77		12	611	07400	89	FT	18" CONDUIT, TYPE B-706.02	
			12								12			611	07600	12	FT	18" CONDUIT, TYPE C-706.02	
			2										2	611	98150	2	EACH	CATCH BASIN, NO. 3	
			1								1			611	98470	1	EACH	CATCH BASIN, NO. 2-2B	
			2								1		1	611	99574	2	EACH	MANHOLE, NO. 3	
	2		5								6		1	611	99710	7	EACH	PRECAST REINFORCED CONCRETE OUTLET	
			2										2	611	99900	2	EACH	DRAINAGE STRUCTURE, MISC.: FERNCO COUPLER WITH SHEAR BANDS	P.8
																		PAVEMENT	
164											11		153	301	56000	164	CY	ASPHALT CONCRETE BASE, PG64-22, (449)	
1,370		137									1,214		293	304	20000	1,507	CY	AGGREGATE BASE	
109											8		101	407	20000	109	GAL	NON-TRACKING TACK COAT	
1,370											1,214		39	441	70000	1,507	CY	ASPHALT CONCRETE SURFACE COURSE, TYPE 1, (449), PG64-22	
50											5		45	441	70300	50	CY	ASPHALT CONCRETE INTERMEDIATE COURSE, TYPE 2, (449)	
7,034											7,004		30	452	16020	7,034	SY	13" NON-REINFORCED CONCRETE PAVEMENT, CLASS QC 1P WITH QC/QA	
		822											822	609	12001	822	FT	COMBINATION CURB AND GUTTER, TYPE 2, AS PER PLAN (CITY OF TROY)	P.8
		74									50		24	609	26000	74	FT	CURB, TYPE 6	
						6					6			625	00480	6	EACH	CONNECTION, UNFUSED PERMANENT	
						2,613					2,613			625	23200	2,613	FT	NO. 4 AWG 2400 VOLT DISTRIBUTION CABLE	
						785					785			625	25400	785	FT	CONDUIT, 2", 725.04	
						66					66			625	25500	66	FT	CONDUIT, 3", 725.04	
						851					851			625	29000	851	FT	TRENCH	
						3					3			625	30706	3	EACH	PULL BOX, 725.08, 24"	
						1							1	625	31506	1	EACH	PULL BOX REMOVED AND REPLACED	
						3					3			625	31510	3	EACH	PULL BOX REMOVED	
																		TRAFFIC CONTROL	
					93	50					143			621	00100	143	EACH	RPM	
					93	50					143			621	54000	143	EACH	RAISED PAVEMENT MARKER REMOVED	
								1			1			625	32000	1	EACH	GROUND ROD	
							126	56			56		126	630	03100	182	FT	GROUND MOUNTED SUPPORT, NO. 3 POST	
								28			28			630	06400	28	FT	GROUND MOUNTED STRUCTURAL BEAM SUPPORT, S4X7.7	
							56	56			56		56	630	08004	112	FT	ONE WAY SUPPORT, NO. 3 POST	
								2			2			630	09000	2	EACH	BREAKAWAY STRUCTURAL BEAM CONNECTION	
								1			1			630	72340	1	EACH	OVERHEAD SIGN SUPPORT, TYPE TC-12.31, DESIGN 12	
									10			10		630	79100	10	EACH	SIGN HANGER ASSEMBLY, MAST ARM	
							8	18	308		18	308	8	630	80100	334	SF	SIGN, FLAT SHEET	
								30			30			630	80200	30	SF	SIGN, GROUND MOUNTED EXTRUSHEET	
								160			160			630	80224	160	SF	SIGN, OVERHEAD EXTRUSHEET	
								2			2			630	84500	2	EACH	GROUND MOUNTED STRUCTURAL BEAM SUPPORT FOUNDATION	
								1			1			630	84510	1	EACH	RIGID OVERHEAD SIGN SUPPORT FOUNDATION	
								2			2			630	84900	2	EACH	REMOVAL OF GROUND MOUNTED SIGN AND DISPOSAL	
							13	10			10		13	630	86002	23	EACH	REMOVAL OF GROUND MOUNTED POST SUPPORT AND DISPOSAL	
								1			1			630	87400	1	EACH	REMOVAL OF OVERHEAD MOUNTED SIGN AND DISPOSAL	
							15	10			10		15	630	87520	25	EACH	REMOVAL OF POLE MOUNTED SIGN AND REERECTION	
								1		2	1	2		630	89706	3	EACH	REMOVAL OF OVERHEAD SIGN SUPPORT AND DISPOSAL, TYPE TC-12.30	
				1.11							1.11			642	50000	1.11	MILE	PAVEMENT MARKING, MISC.: BLACK CONTRAST	P.86
				1.2							1.12		0.08	644	00104	1.2	MILE	EDGE LINE, 6"	
				1.11							1.11			644	00204	1.11	MILE	LANE LINE, 6"	
				0.08									0.08	644	00300	0.08	MILE	CENTER LINE	
				963									963	644	00400	963	FT	CHANNELIZING LINE, 8"	
					44								44	644	00500	44	FT	STOP LINE	
													550	644	620	550	FT	CROSSWALK LINE, 12"	
				15									15	644	01300	15	EACH	LANE ARROW	
													765	644	30000	765	FT	REMOVAL OF PAVEMENT MARKING	
													1	644	30020	1	EACH	REMOVAL OF PAVEMENT MARKING	
					0.55						0.54		0.01	646	10010	0.55	MILE	EDGE LINE, 6"	
											1,026			646	10310	1,026	FT	CHANNELIZING LINE, 12"	
											49			646	10400	49	FT	STOP LINE	
											110			646	10620	110	FT	CHEVRON MARKING	
											12			646	20300	12	EACH	LANE ARROW	
											3			646	20320	3	EACH	WRONG WAY ARROW	
							794				794			646	20504	794	FT	DOTTED LINE, 6"	

GENERAL SUMMARY

DESIGN AGENCY



DESIGNER

AIM

REVIEWER

BMG 11/01/24

PROJECT ID

118156

SHEET

P.30

TOTAL

P.122



HORIZONTAL
SCALE IN FEET

10 20 40

PLAN AND PROFILE - RAMP D
STA. 20+00.00 TO STA. 25+00.00

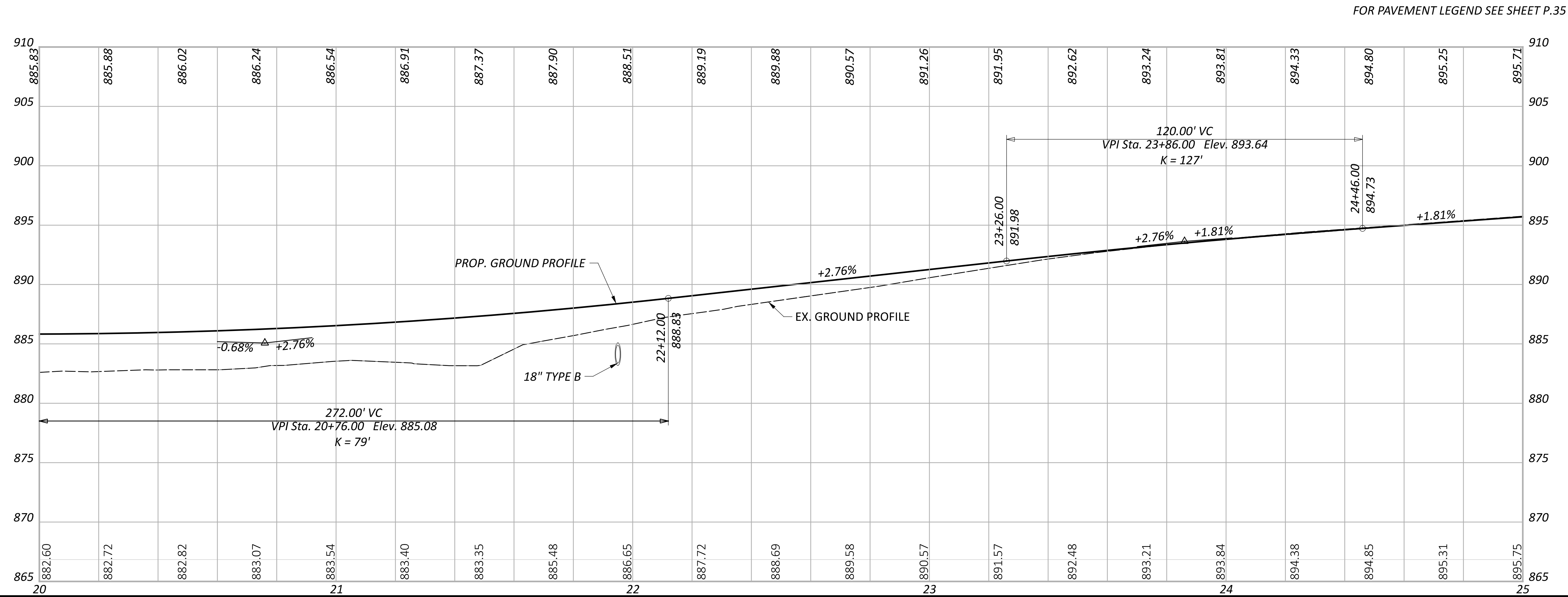

FOR PAVEMENT LEGEND SEE SHEET P.35



DESIGNER

AIM

REVIEWER

BMG 11/01/24

PROJECT ID

118156

110150

SHEET	TOTAL
1	1

P.42	P.1
------	-----