

OHIO DEPARTMENT OF TRANSPORTATION

PROJECT DESCRIPTION
4-LANE MULTI-LAYER MICROSURFACING
OF IR 70 IN MUSKINGUM AND LICKING
COUNTIES

LOCATION MAP

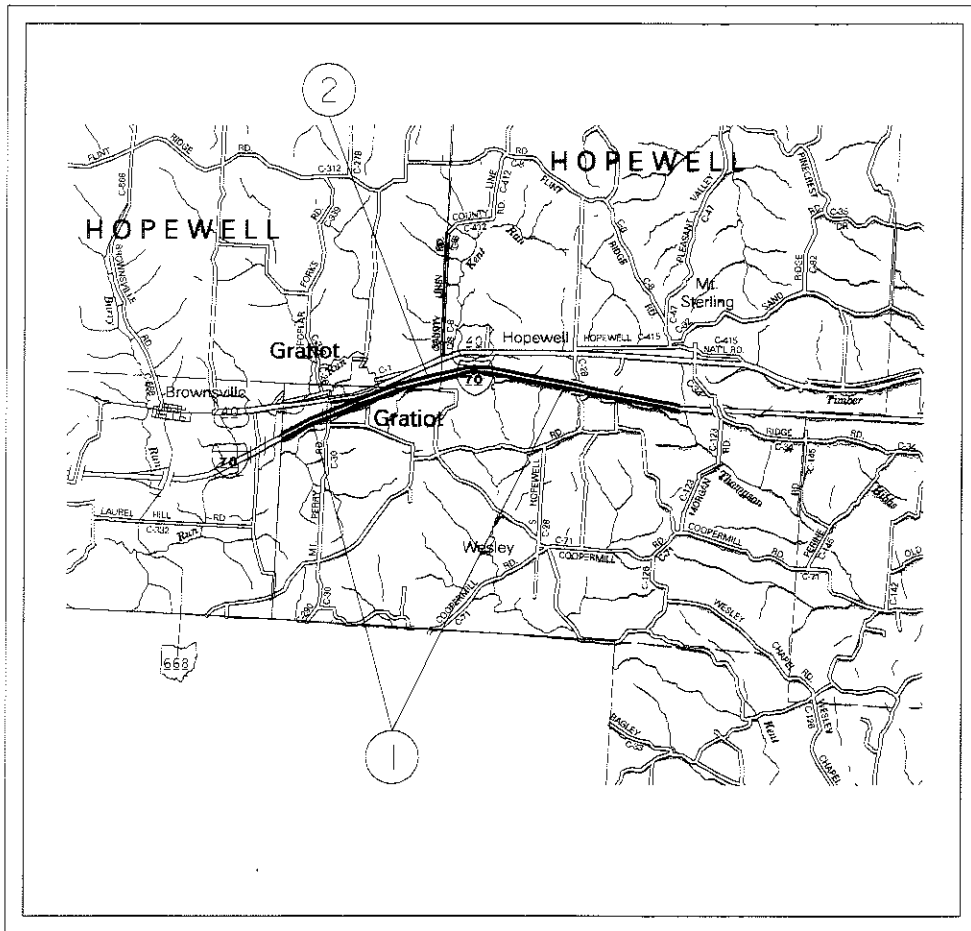

MUS-70-0.76/LIC-70-28.93
MUSKINGUM AND LICKING COUNTIES
HOPEWELL TOWNSHIP

LOCATION	COUNTY	ROUTE	SECTIONS	PROJECT TERMINI		NET LENGTH MILE	REMARKS
				BEGIN	END		
1	MUS	IR-70	(0.76)(1.43)	0.76	5.56	4.80	
2	LIC	IR-70	(28.93)	28.93	29.42	0.49	

INDEX OF SHEETS

TITLE SHEET	1
LOCATION PLAN	2,3
GENERAL NOTES	4, 5
MICRO-SURFACING CALC.	6
EXTRA AREAS	7
RPM SUB SUMMARY	8
PAVEMENT MARKINGS SUB SUMM.	9
GENERAL SUMMARY	10

2002 SPECIFICATIONS

The standard 2002 specifications of the State of Ohio, Department of Transportation, including changes and supplemental specifications listed in the proposal shall govern this improvement.

I hereby approve these plans and declare that the making of this improvement will not require the closing to traffic of the highway and that provisions for the maintenance and

————— PORTION TO BE IMPROVED

DESIGN EXCEPTIONS: NONE

Project Earth Disturbed Area =
N/A (Maintenance Project)
Estimated Contractor Earth Disturbed Area =
N/A (Maintenance Project)
Notice of Intent Earth Disturbed Area =
N/A (Maintenance Project)

Approved _____
Date 12/29/03 *Christopher T. Ruff*
District Deputy Director of Transportation

Approved _____
Date 1-16-04 *Brandon Proctor*
Director, Department of Transportation

MUS - IR 70-0.76/28.93
040231 PID - 76935
Dist 5 3/24/2004

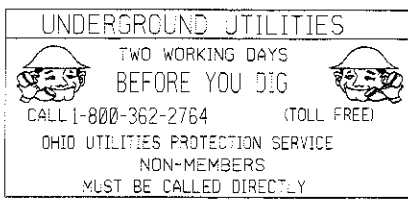
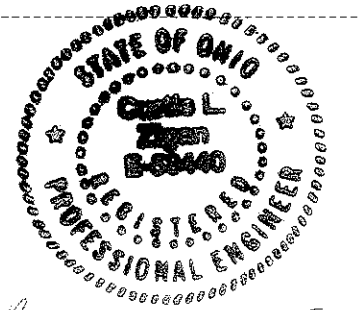

STANDARD DRAWINGS		STANDARD DRAWINGS		SUPPLEMENTAL SPECIFICATIONS	
TC-65.10	10/9/01	MT-99.20M	1/30/95	SS-1082	1/04/02
TC-65.11	10/19/01	MT-105.10	10/18/02	SS-881	10/18/02
TC-72.20	1/19/01	MT-105.11	10/18/02	SS-832	2/12/03
MT-95.30	4/19/02	BP-3.1	7/28/00	SS-833	2/12/03
MT-98.13	4/19/02	BP-9.1	10/17/03		
MT-98.14	4/19/02				
MT-98.15	4/19/02				
MT-98.16	4/19/02				

Christopher T. Ruff
12/29/03

FEDERAL PROJECT NO. _____
PID NO. 76935
CONSTRUCTION PROJECT NO. _____
TITLE SHEET
MUS-70-0.76
LIC-70-28.93

PLAN NO.

CALCULATED
CHECKED

PID NO.
76935

LOCATION PLAN

MUS-70-0.76
LIC-70-28.93

2
10

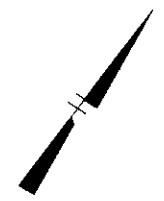
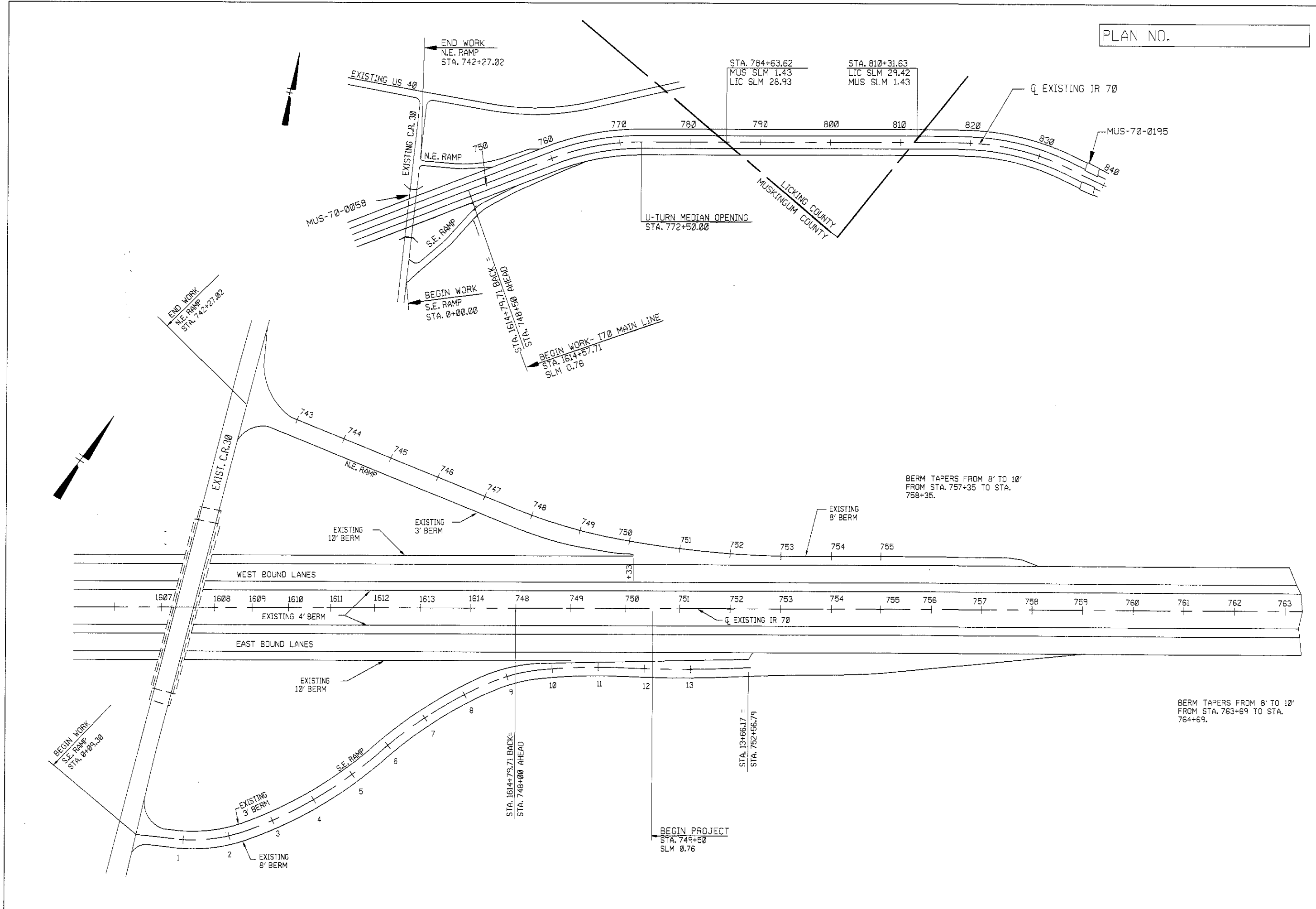

PLAN NO.

CALCULATED
CHECKED

PID NO.
76935

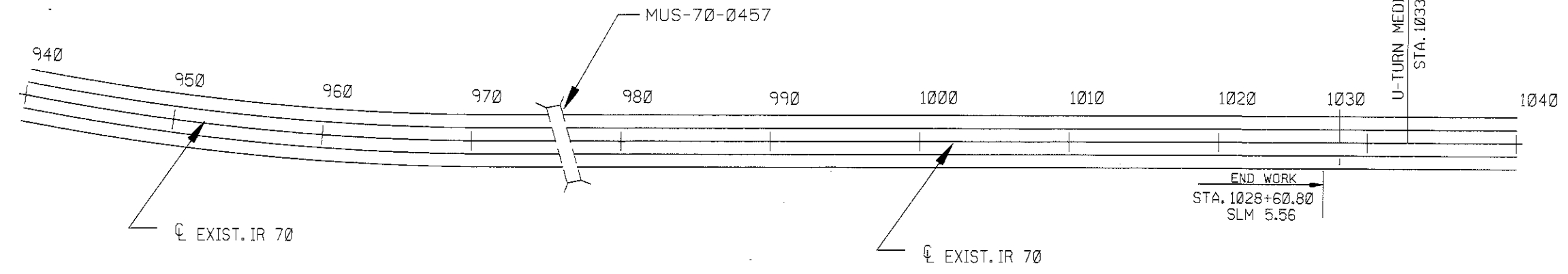
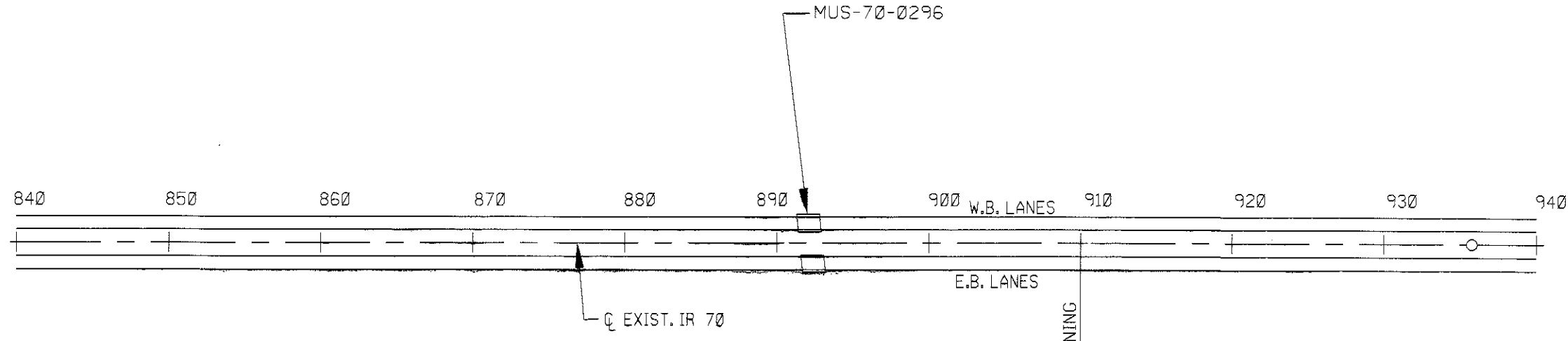

LOCATION PLAN

MUS-70-0.76
LIC-70-28.93

CONTINGENCY QUANTITIES

THE CONTRACTOR SHALL NOT ORDER MATERIALS OR PERFORM WORK FOR PLAN ITEMS SET UP TO BE USED "AS DIRECTED BY THE ENGINEER" UNLESS AUTHORIZED BY THE ENGINEER. THE ACTUAL WORK LOCATIONS AND QUANTITIES USED AT THE ENGINEER'S DISCRETION SHALL BE MADE A MATTER OF RECORD BY THE INCORPORATION INTO THE FINAL CHANGE ORDER GOVERNING COMPLETION OF THIS PROJECT.

WORK RESTRICTIONS AND LANE CLOSURES

WORK SHALL BE DONE AT NIGHT FROM 8:00 PM TO 5:30 AM ON ALL DAYS EXCEPT SATURDAY AND SUNDAYS, WHICH ARE FROM 10:00 PM TO 5:30 AM. ALL LANES OF TRAFFIC SHALL BE OPEN TO TRAFFIC AT ALL OTHER TIMES. ANY WORK DONE AFTER 5:30 AM SHALL HAVE LIQUIDATED DAMAGES APPLIED AT A RATE OF \$5000.00 PER HOUR.

THE CONTRACTOR MUST WORK THE ENTIRE LENGTH OF THE WORK ZONE. WHEN NECESSARY TO USE THE BERM TO MAINTAIN TRAFFIC, THE CONTRACTOR SHALL USE THE TRAFFIC CONTROL DEVICES PER STANDARD CONSTRUCTION DRAWINGS ANY CONFLICTING PAVEMENT MARKINGS SHALL BE REMOVED AND RESTORED AS PER STANDARD DRAWINGS.

ITEM 614 MAINTAINING TRAFFIC

TRAFFIC CONTROL SHALL BE MAINTAINED AS PER DETAIL SHEETS AND SPECIFICATIONS AND AS OUTLINED IN THE CONSTRUCTION AND MAINTENANCE OPERATIONS SECTION OF THE OHIO MANUAL OF UNIFORM TRAFFIC CONTROL DEVICES FOR STREETS AND HIGHWAYS AND IN ADDITION, THE FOLLOWING REQUIREMENTS SHALL APPLY. CLOSING 1 LANE OF A MULTI-LANE DIVIDED HIGHWAY DETAILED ON STANDARD DRAWING MT-95.40, 7-18-03.

THE CONTRACTOR SHALL SUBMIT IN WRITING A SCHEDULE OF OPERATIONS TO THE DEPUTY DIRECTOR AND RECEIVE APPROVAL BEFORE WORK IS STARTED ON THE PROJECT. PAYMENT FOR ALL THE ABOVE SHALL BE INCLUDED IN THE LUMP SUM BID FOR ITEM 614 MAINTAINING TRAFFIC, EXCEPT FOR THE ITEM QUANTITIES SHOWN ON THE GENERAL SUMMARY SHEET.

TRAFFIC SHALL NOT BE RESTRICTED BY LANE CLOSURE AT ANY TIME ON A STATE HOLIDAY.

ITEM 614 TEMPORARY PAVEMENT MARKINGS

THE PLACEMENT OF TEMPORARY PAVEMENT MARKINGS ON THE FINAL OVERLAY SHALL FOLLOW THE DETAILS FOR THE PERMINENT MARKINGS TO PREVENT ANY CONFLICT. ANY TEMPORARY PAVEMENT MARKINGS WHICH CONFLICT WITH THE PERMINENT MARKINGS SHALL BE REMOVED AT THE CONTRACTORS EXSPENSE TO THE SATISFACTION OF THE DISTRICT TRAFFIC ENGINEER.

CONVERSION OF METRIC STANDARD DRAWINGS

ANY METRIC STANDARD DRAWINGS REFERENCED IN THIS PLAN SHALL BE CONVERTED TO ENGLISH UNITS USING THE SI (METRIC) TO ENGLISH CONVERSION FACTORS PROVIDED IN SECTION 109.02 OF THE 2002 CONSTRUCTION MATERIALS SPECIFICATIONS. CONVERSIONS SHALL BE PRECISE AND SHALL REFLECT STANDARD INDUSTRY ENGLISH VALUES WHERE SUITABLE.

ITEM 202 WEARING COURSE REMOVED, AS PER PLAN

THIS ITEM OF WORK SHALL CONSIST OF FURNISHING ALL LABOR AND EQUIPMENT NECESSARY FOR REMOVING BUMPS AT RAISED PAVEMENT JOINTS. THE MILLING MACHINE SHALL BE CAPABLE OF MILLING A MINIMUM OF 18" WIDE AND SHALL BE CAPABLE OF ADJUSTING SLOPE AND DEPTH.

THE CONTRACTOR SHALL REMOVE ALL BUMPS IN EXCESS OF 3/8" DIFFERENCE IN ELEVATION AS MEASURED IN THE DIRECTION OF THE TRAFFIC WITH A 10' STRAIGHT EDGE. THE CONTRACTOR SHALL BE REQUIRED TO REMOVE ONLY THE PORTION OF THE BUMP THAT WILL AFFECT THE QUALITY OF THE FINISHED SURFACE.

THE MILLED SURFACE SHALL HAVE A VARIANCE OF NO MORE THAN 1/8" DIFFERENCE IN ELAVATION ABOVE AND 1/4" BELOW THE PAVEMENTS LONGITUDINAL PROFILE AS IT IS MEASURED WITH A 10' STRAIGHT EDGE.

IMMEDIATELY AFTER MILLING, THE SURFACE SHALL BE CLEANED THOROUGHLY OF ALL LOOSE MATERIAL AND DISPOSED OF IN ACCORDANCE WITH 203.05.

IF THE MILLING AND/OR CLEANING PROCESS REMOVES MATERIALS BELOW 1/4" OF THE LONGITUDINAL PROFILE AS MEASURED WITH A 10' STRAIGHT EDGE, THE DEPRESSION SHALL BE BACKFILLED WITH MICRO-SURFACING, PRIOR TO RESURFACING, AND AT THE CONTRACTORS EXSPENSE.

THE UNIT PRICE BID SHALL CONSIST OF ALL EQUIPMENT, MATERIALS AND LABOR NECESSARY FOR THE REMOVAL OF THE RAISED PAVEMENT JOINTS AND ACTIVITIES NECESSARY TO COMPLETE THE WORK. THE COST OF DISPOSING MATERIAL REMOVED FROM THE SURFACE AND CLEANING OF THE ROADWAY SHALL BE INCLUDED IN THE UNIT PRICE BID FOR ITEM 202 WEARING COURSE REMOVED, AS PER PLAN.

THIS ITEM OF WORK SHALL BE PERFORMED ON ALL TRAFFIC LANES WHERE MICRO-SURFACING WILL BE PLACED.

THE FOLLOWING QUANTITY IS CARRIED TO THE GENERAL SUMMARY FOR THE PURPOSE DESCRIBED ABOVE:

ITEM 202 WEARING COURSE REMOVED, AS PER PLAN LOC.1 - 200 SQ.YD.

TRAFFIC DATA

TOTAL VEHICLES - 35,300
TOTAL TRUCKS - 32.9%

ENCLARED
CHECKED
PID NO. 76935
GENERAL NOTES
MUS-70-0.76
LIC-70-28.93
4
10

ITEM SPECIAL-LAW ENFORCEMENT OFFICER WITH PATROL CAR:

IN ADDITION TO THE REQUIREMENTS OF 614 AND THE LATEST EDITION OF THE OHIO MANUAL OF UNIFORM TRAFFIC CONTROL DEVICES (OMUTCD), A UNIFORMED LAW ENFORCEMENT OFFICER (AND OFFICIAL PATROL CAR WITH WORKING TOP MOUNTED EMERGENCY FLASHING LIGHTS) SHALL BE PROVIDED FOR CONTROLLING TRAFFIC FOR THE FOLLOWING TASKS:
FOR LANE CLOSURES; DURING INITIAL SET-UP PERIODS, TEAR DOWN PERIODS, SUBSTANTIAL SHIFTS OF A CLOSURE POINT OR WHEN NEW LANE CLOSURE ARRANGEMENTS ARE INITIATED.

DURING PAVEMENT MARKINGS OPERATIONS;

LAW ENFORCEMENT OFFICERS (L.E.O.'S) SHOULD NOT BE USED WHERE THE OMUTCD INTENDS THAT FLAGGERS BE USED. THE LEO'S ARE CONSIDERED TO BE EMPLOYED BY THE CONTRACTOR AND THE CONTRACTOR SHALL BE RESPONSIBLE FOR THEIR ACTIONS. ALTHOUGH THEY ARE EMPLOYED BY THE CONTRACTOR, THE PROJECT ENGINEER SHALL HAVE CONTROL OVER THEIR PLACEMENT. THE OFFICIAL PATROL CAR SHALL BE A PUBLIC SAFETY VEHICLE AS REQUIRED BY THE OHIO REVISED CODE.

THE CONTRACTOR SHALL MAKE ARRANGEMENTS FOR THESE SERVICES WITH THE OHIO HIGHWAY PATROL, 1970 WEST BROAD SREET, COLUMBUS, OHIO.

TELEPHONE; 1-877-7-PATROL

LAW ENFORCEMENT OFFICERS (WITH PATROL CAR) REQUIRED BY THE TRAFFIC MAINTENANCE TASKS ABOVE SHALL BE PAID FOR ON A UNIT PRICE (HOURLY) BASIS UNDER ITEM SPECIAL-LAW ENFORCEMENT OFFICER (WITH PATROL CAR). THE FOLLOWING ESTIMATED QUANTITIES HAVE BEEN CARRIED TO THE GENERAL SUMMARY SHEET:

ITEM 614 SPECIAL, LAW ENFORCEMENT OFFICER, WITH PATROL CAR 30 HOURS.

THE HOURS PAID SHALL INCLUDE MINIMUM SHOW-UP TIME REQUIRED BY THE LAW ENFORCEMENT AGENCY INVOLVED.

IF THE CONTRACTOR WISHES TO UTILIZE LEO'S FOR FLAGGING AND TRAFFIC CONTROL OTHER THAN FOR THAT REQUIRED IN THESE PLANS, HE MAY DO SO AT HIS OWN EXPENSE. PAYMENT FOR THE EXCESS ABOVE THE CONTRACT REQUIREMENTS WILL BE INCLUDED UNDER ITEM 614 MAINTAINING TRAFFIC.

FLOODLIGHTING

FLOODLIGHTING OF THE WORK SITE FOR OPERATIONS CONDUCTED DURING NIGHT TIME PERIODS, SHALL BE ACCOMPLISHED SO THAT THE LIGHTS DO NOT CAUSE GLARE TO THE DRIVERS ON THE ROADWAY. TO ENSURE THE ADEQUACY OF THE FLOODLIGHT PLACEMENT, THE CONTRACTOR AND THE ENGINEER SHALL DRIVE THROUGH THE WORK SITE EACH NIGHT WHEN THE LIGHTING IS IN PLACE AND IS OPERATIVE PRIOR TO COMMENCING ANY WORK.

IF GLARE IS DETECTED, THE LIGHT PLACEMENT AND SHEILDING SHALL BE ADJUSTED TO THE SATISFACTION OF THE ENGINEER BEFORE ANY WORK PROCEEDS.

THE CONTRACTOR SHALL SUBMIT TO THE DISTRICT A COPY OF THEIR FLOODLIGHTING PLAN FOR APPROVAL BY THE AREA ENGINEER PRIOR TO COMMENCING ANY WORK.

PAYMENT FOR ALL LABOR, EQUIPMENT AND MATERIALS, SHALL BE INCLUDED IN THE LUMP SUM CONTRACT PRICE FOR ITEM 614-MAINTAINING TRAFFIC.

SEQUENCE OF OPERATION

1. PAVE RUMBLE STRIPS ON INSIDE SHOULDERS, SINGLE COURSE 4'.
2. PAVE DRIVING LANE WITH LEVELING COURSE 12' AND RUMBLE STRIPS ON OUTSIDE SHOULDER WITH SINGLE COURSE 2'. PAVE RAMPS WITH LEVELING COURSE 16'.
3. PAVE PASSING LANE WITH LEVELING COURSE 12'.
4. PAVE DRIVING AND PASSING LANES WITH SURFACE COURSE 25'. PAVE RAMPS WITH SURFACE COURSE 17'.
5. RE-CUT RUMBLE STRIPS ON INSIDE AND OUTSIDE SHOULDERS, BOTH DIRECTIONS.

(SEE TYPICAL SECTIONS)

GENERAL NOTES

MUS-70-0.76
LIC-70-28.93

105

CALCULATED

CHECKED

PID NO.

76935

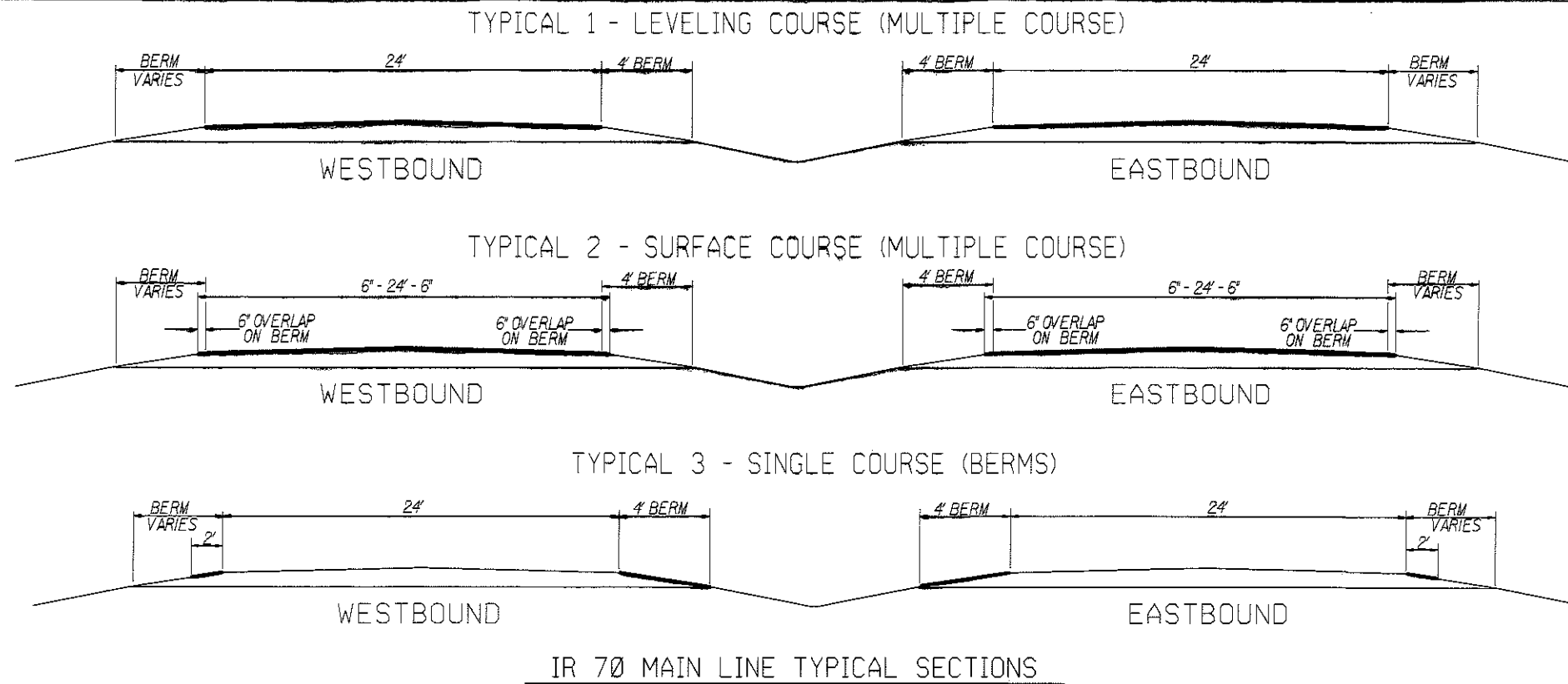

PLAN NO.

IR 70 MAIN LINE TYPICAL SECTIONS

ITEM 614 WORK ZONE MARKING SIGNS

SIGN	LOCATION 1	LOCATION 2	TOTAL
OW167	12	8	20

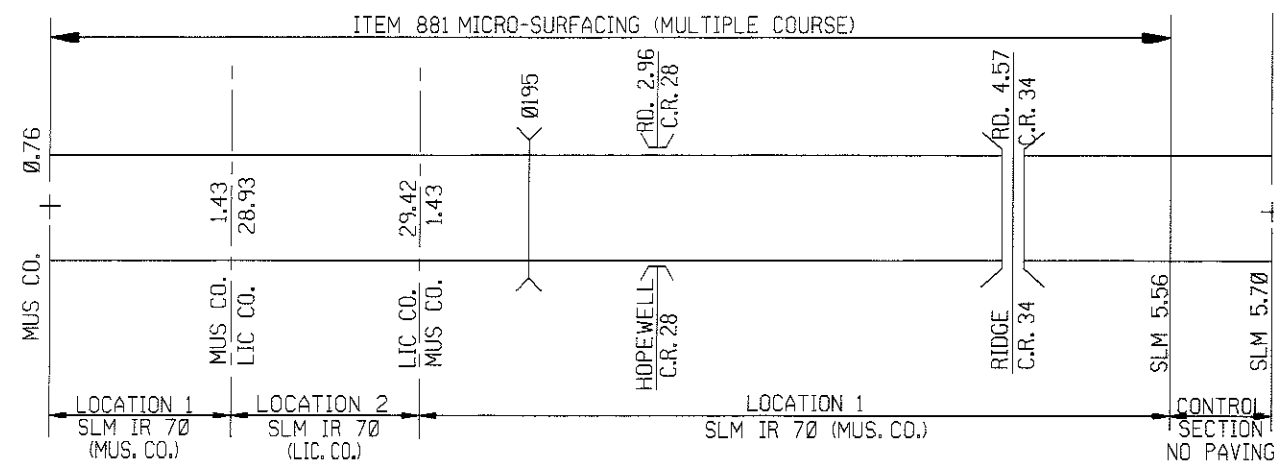

* BRIDGE DEDUCTIONS

BRIDGE LIMITS HAVE BEEN DEDUCTED OUT OF MAINLINE QUANTITIES AS FOLLOWS.

BRIDGE MUS-70-0195
198' LONG, L & R, PLUS 25' APPROACH SLABS.

BRIDGE MUS-70-0296
120' LONG, L & R, PLUS 25' APPROACH SLABS.

LOCATION	DEDUCT FOR BRIDGES ()			PAVEMENT DATA													
	ROUTE	LOCATION		PROJECT LENGTH	PROP. PAVEMENT WIDTH	TYPICAL	EXISTING PAVEMENT TYPE	PAVEMENT AREA *	PROPOSED PAVEMENT							RUMBLE STRIPS TYPE 2	
		FROM	TO						881	202	614		618				
				MILES	LIN. FT.	FEET	ITEM	SQ. YD.	SQ. YD.	SQ. YD.	EACH	MILE	MILE	FT	FT	MILE	
1	IR-70 MUS	0.76	5.56	4.80	25344	2 X 25'	1&2	446	140800	-	140800		9.60	19.20		9.60	
1		0.76	5.56	(4.80)	(25344)	2(3.5' + 1.5')	3	446	28160	28160							
	* BRIDGE DEDUCTIONS								(996)	(2322)							
	EXTRA AREAS FROM SHEET 7								7411	7427			0.76				
1	TOTALS			4.80	25344				27164	145905	679	9.60	19.96	1250	70	9.60	
2	IR-70 LIC	28.93	29.42	0.49	2587	2 X 25'	1&2	446	14372	-	14372		0.98	1.96		0.98	
2		28.93	29.42	0.49	(2587)	2(3.5' + 1.5')	3	446	2874	2874							
2	TOTALS			0.49	2587				3449	14372	64	0.98	1.96			0.98	

CALCULATED
CHECKED
PID NO. 76935
MICRO-SURFACING CALCULATIONS AND TYP. SECTIONS
MUS-70-0.76
LIC-70-28.93
66

* = CALCULATED AREA

PAVEMENT DATA													
LOCATION	LOCATION			DESCRIPTION	LENGTH		PROP. PAVEMENT WIDTH	TYPICAL	EXISTING PAVEMENT TYPE	* PAVEMENT AREA	PROPOSED PAVEMENT		
	ROUTE	S.L.M. SECTION			MILES	FEET					881	614	
		FROM	TO								MICRO-SURFACING COURSE MULTIPLE	WORK ZONE EDGE LINES CLASS I	
										SG. YD.	SG. YD.	MILE	
1	IR-70 MUS (ON RAMP)	0+09.30	0+74.30	S.E. ENTR. RAMP FROM C.R. 30					446	*320	328		
		0+74.30	10+65.00	S.E. ENTR. RAMP FROM C.R. 30		991	17'	2		*1872	1872		
				I-70 MAIN LINE (TAPER AREA)						1355	1355		
												0.46	
1	IR-70 MUS (OFF RAMP)	742+27.02	742+92.02	N.E. EXIT RAMP TO C.R. 30					446	*336	336		
		742+92.02	750+35.00	N.E. EXIT RAMP TO C.R. 30		743	17'	2		*1403	1403		
		742+92.02	I-70 MAIN	LINE (TAPER AREA)		840				1120	1120		
												0.30	
				SEE SHEETS 3 AND 4						*1013	1013		
				MEDIAN U-TURNS (2)									
	TOTALS		CARRIED TO SHEET 6			3589				7427	7427	0.76	

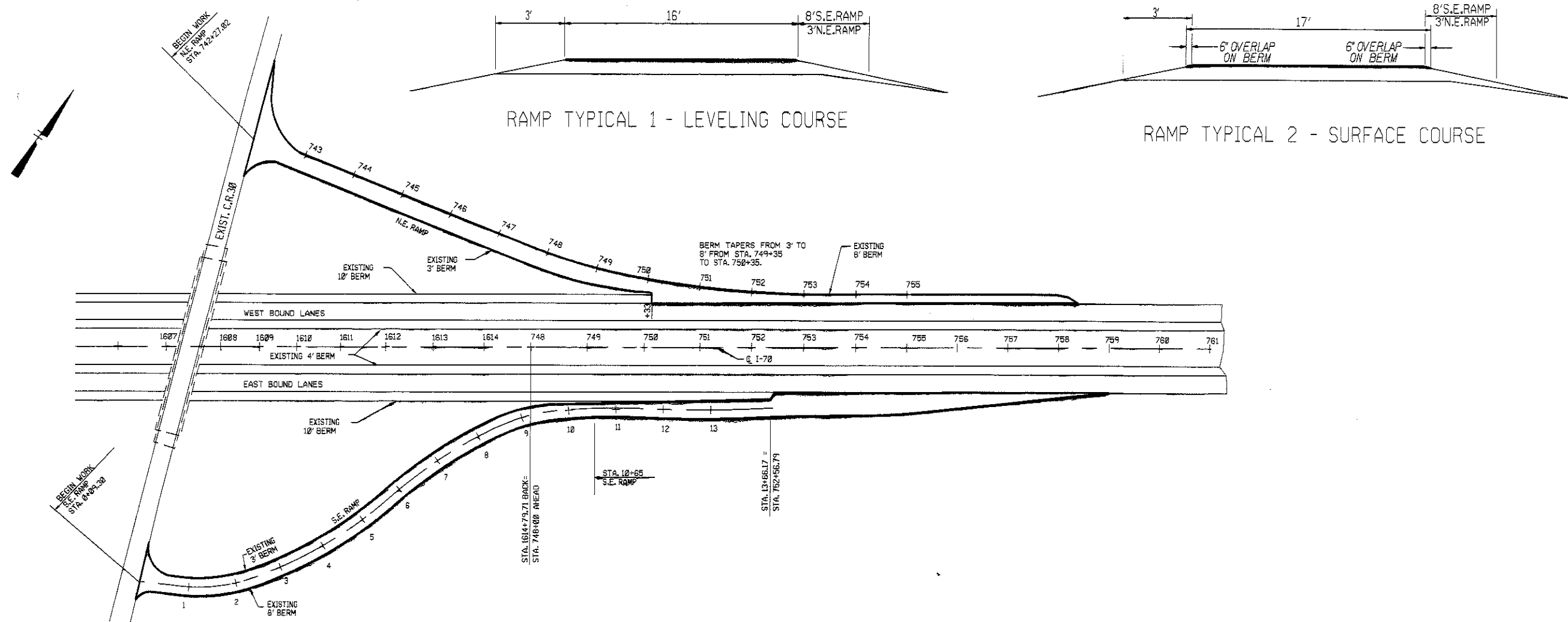

CALCULATED
 CHECKED
 PID NO. 76935
 EXTRA AREAS CO. RD. 30
 (RAMPS TO AND FROM)
 MUS-70-0.76
 LIC-70-28.93
 7
 0

ITEM 621 RPM SUB-SUMMARY

PLAN NO.

DETAIL	
1	MULTILANE UNDIVIDED
1	TYPICAL SPACING

DETAIL	
2	TAPERED ACCELERATION LANE
3	DECELERATION LANE
4	PARALLEL ACCELERATION LANE
5	MULTILANE DIVIDED/EXPRESSWAY

DETAIL	
6	STOP APPROACH
7	ONE LANE APPROACH W/LT. TURN LANE
8	THRU APPROACH
9	TWO LANE APPROACH W/LT. TURN LANE

DETAIL	
10	4 LANE DIVIDED TO 2 LANE TRANSITION
11	4 LANE UNDIVIDED TO 2 LANE TRANSITION
12	TWO LANE NARROW BRIDGE
13	TWO WAY LEFT TURN LANE
14	ONE LANE BRIDGE
15	HORIZONTAL CURVE

DETAIL	
16	HORIZONTAL CURVE ALT.
17	STOP APPROACH ALT.
GAP	CENTERLINE AT 80' TYP.

LOCATION	LOCATION				PROJECT LENGTH		DETAIL	ITEM 621	PRISMATIC RETRO-REFLECTOR COLORS					REMARKS	
	COUNTY	ROUTE	S.L.M. SECTION		MILES	FEET			RAISED PAVEMENT MARKERS INSTALLATION ONLY		TWO-WAY				
			FROM	TO					ONE-WAY	WHITE	YELLOW	WHITE/WHITE	YELLOW/RED		WHITE/RED
1	MUS	IR-70 E.B.	0.76	1.43	0.67	3537.6	5	29	44					BEGIN PROJECT TO LICKING COUNTY	
1	MUS	IR-70 E.B.	1.43	5.56	4.13	21806.4	5	182	182					LICKING COUNTY TO END PROJECT	
1	MUS	IR-70 E.B.	0.76		0.26	1372.8	2	25			20	5		ON RAMP FROM C.R. 30	
1	MUS	IR-70 W.B.	0.76	1.43	0.67	3537.6	5	29	29					BEGIN PROJECT TO LICKING COUNTY	
1	MUS	IR-70 W.B.	1.43	5.56	4.13	21806.4	5	182	182					LICKING COUNTY TO END PROJECT	
1	MUS	IR-70 W.B.	0.76		0.15	792.0	3	23			10	13		OFF RAMP TO C.R. 30	
1	TOTALS	(CARRIED TO GENERAL SUMMARY SHEET)						470	437			10	13		
2	LIC	IR-70 E.B.	28.93	29.42	0.49	2587.2	5	22	22					LICKING COUNTY	
2	LIC	IR-70 W.B.	28.93	29.42	0.49	2587.2	5	22	22					LICKING COUNTY	
2	TOTALS	(CARRIED TO GENERAL SUMMARY SHEET)						44	44						

CALCULATED
 CHECKED
 PID NO. 76935
RAISED PAVEMENT MARKER SUB SUMMARY
 MUS-70-0.76
 LIC-70-28.93



ITEM 644 EDGE LINE SUB-SUMMARY

LOCATION	COUNTY	ROUTE	S.L.M.		WHITE EDGE LINE QU.			YELLOW EDGE LINE QU.			PARTICIPATION TYPE				EDGE LINE TOTAL MILES	REMARKS
			FROM	TO	TOTAL MILES	HIGHWAY	RAMP	TOTAL MILES	HIGHWAY	RAMP	FED	FG	RSG	NON FED STATE		
1	MUS	IR 70 E.B.	0.76	5.56	5.06	4.80	0.26	5.00	4.80	0.20	LOC. 1				10.06	INCLUDES OFF RAMP QUANTITIES
1	MUS	IR 70 W.B.	0.76	5.56	4.95	4.80	0.15	4.95	4.80	0.15	LOC. 1				9.90	INCLUDES ON RAMP QUANTITIES
		TOTALS			10.01	9.60	0.41	9.95	9.60	0.35					19.96	
2	LIC	IR 70 E.B.	28.93	29.42	0.49	0.49		0.49	0.49		LOC. 2				0.98	
2	LIC	IR 70 W.B.	28.93	29.42	0.49	0.49		0.49	0.49		LOC. 2				0.98	
		TOTALS			0.98	0.98		0.98	0.98						1.96	

* = CALCULATED AREA

ITEM 644 LANE LINE SUB-SUMMARY

LOCATION	COUNTY	ROUTE	S.L.M.		QUANTITIES			PARTICIPATION TYPE					REMARKS
			FROM	TO	TOTAL MILES	4" LANE LINES		IRG	FG	RSG	NON FED STATE	FED	
						DASHED	SOLID						
1	MUS	IR 70 E.B.	0.76	5.56	4.80	4.80						LOC. 1	BEGIN WORK TO END WORK
1	MUS	IR 70 W.B.	0.76	5.56	4.80	4.80						LOC. 1	BEGIN WORK TO END WORK
1	* MUS	IR 70 E.B.	0.884	0.944	0.06	0.06						LOC. 1	USE W/CHANNELIZING LINES AT RAMP
1	* MUS	IR 70 W.B.	0.828	0.888	0.06	0.06						LOC. 1	USE W/CHANNELIZING LINES AT RAMP
		TOTALS			9.72	9.72							
2	LIC	IR 70 E.B.	28.93	29.42	0.49	0.49						LOC. 2	
2	LIC	IR 70 W.B.	28.93	29.42	0.49	0.49						LOC. 2	
		TOTALS			0.98	0.98							

* = CALCULATED AREA

ITEM 644 CHANNELIZING LINES

LOCATION	COUNTY	ROUTE	SIDE	24" TRANSVERSE LINES		STOP LINE	12" CROSSWALK LINES	WORDS ON PAVEMENT				LANE ARROWS				DOTTED LINES		8" CHANNEL LINE	REMARKS
				WHITE	YELLOW			ONLY	SCHOOL	TURN		THRU	COMB.	WHITE	YELLOW				
				FEET	FEET	72"	96"	72"	96"	LEFT	RIGHT					FEET	FEET		
				FEET	FEET	FEET	FEET	EACH	EACH	EACH	EACH	EACH	EACH	FEET	FEET	FEET			
1	MUS	IR 70	E.B.														*301	10+65 S.E. RAMP TO 13+66.17 S.E. RAMP 752+56.79 E.B. TO 756+05.79 E.B.	
			E.B.														*349		
			W.B.															*600	750+50 W.B. TO 753+35 W.B. (PLACE AS DIRECTED)
		N.E. RAMP				*70													
1	MUS	TOTALS				*70												*1250	

(TOTALS CARRIED TO GENERAL SUMMARY SHEET)

CALCULATED
 CHECKED
 PID NO. 76935
 SUB-SUMMARY
 PAVEMENT MARKINGS
 MUS-70-0.76
 LIC-70-28.93
 9
 10

GENERAL SUMMARY

PLAN NO.

LOCATION 1 SHT. TOTALS					LOCATION 2 SHT. TOTALS				ITEM	ITEM EXT. NO.	TOTAL	UNIT	DESCRIPTION
4	5	6	8	9	4	6	8	9					
									202	23501	200	SQ. YD.	WEARING COURSE REMOVED AS PER PLAN (SEE SHT. 4)
		679				64			202	54100	743	EACH	RAISED PAVEMENT MARKER REMOVED FOR STORAGE
	30								614	11100	30	HOUR	LAW ENFORCEMENT OFFICER WITH PATROL CAR
		12				8			614	12460	20	EACH	WORK ZONE MARKING SIGN
		9.60				0.98			614	20400	10.58	MILE	WORK ZONE LANE LINE, CLASS II
		19.96				1.96			614	22000	21.92	MILE	WORK ZONE EDGE LINE, CLASS I
		1250							614	23000	1250	FEET	WORK ZONE CHANNELIZING LINE, CLASS I
		70							614	26000	70	FEET	WORK ZONE STOP LINE, CLASS I
		9.60				0.98			618	40600	10.58	MILE	RUMBLE STRIPS, TYPE 2 (ASPHALT CONCRETE)
			470				44		621	00200	514	EACH	RPM, INSTALLATION ONLY
				19.96				1.96	644	00100	21.92	MILE	EDGE LINE
				9.72				0.98	644	00200	10.70	MILE	LANE LINE
				1250					644	00400	1250	FEET	CHANNELIZING LINE
				70					644	00500	70	FEET	STOP LINE
		27164				2874			881	10000	30038	SQ. YD.	MICRO SURFACING WITH WARRANTY, SINGLE COURSE
		145905				14372			881	20000	160277	SQ. YD.	MICRO SURFACING WITH WARRANTY, MULTIPLE COURSE
LUMP					LUMP				614	11000	LUMP		MAINTAINING TRAFFIC
									623	10000	LUMP		CONSTRUCTION LAYOUT STAKES
									624	10000	LUMP		MOBILIZATION

CALCULATED
 CHECKED
 PID NO. 76935
 GENERAL SUMMARY
 MUS-70-0-0.76
 LIC-70-28.93
10/10