

ITEM 202, GUARDRAIL REMOVED, AS PER PLAN

EXISTING GUARDRAIL POSTS SHALL REMAIN, EXCEPT WHERE THEY WILL INTERFERE WITH THE PLACEMENT OF THE PROPOSED GUARDRAIL POSTS. REMAINING EXISTING POSTS SHALL BE SAWCUT AT THE GROUND LEVEL OR AS DIRECTED BY THE ENGINEER.

GUARDRAIL, TYPE MGS WITH LONG POSTS, AS PER PLAN

THIS ITEM 606 SHALL INCLUDE ALL LABOR, MATERIALS AND EQUIPMENT NECESSARY TO REPLACE EXISTING GUARDRAIL USING STEEL POSTS, AS DIRECTED BY THE ENGINEER. THE GUARDRAIL POSTS SHALL CONFORM TO ITEM 606 AND 710.15 OF THE CMS.

IN ADDITION TO THE ABOVE, THE CONTRACTOR SHALL TAKE CARE TO NOT DISTURB ANY OF THE PROPOSED AGGREGATE DRAINS WHICH HAVE BEEN PUT IN PLACE DURING CONSTRUCTION OF THIS PROJECT, WHEN DRIVING THE PROPOSED GUARDRAIL POSTS INTO THE GROUND.

ITEM 606 - ANCHOR ASSEMBLY, MGS TYPE B

THIS ITEM SHALL CONSIST OF FURNISHING AND INSTALLING ANY OF THE GUARDRAIL END TERMINALS FOR TYPE MGS GUARDRAIL AS LISTED ON ROADWAY ENGINEERING'S WEB PAGE UNDER ROADSIDE SAFETY DEVICES FOR APPROVED GUARDRAIL END TREATMENTS. INSTALLATION SHALL BE AT THE LOCATIONS SPECIFIED IN THE PLANS, IN ACCORDANCE WITH THE MANUFACTURER'S SPECIFICATIONS.

REFER TO THE MANUFACTURER'S INSTRUCTIONS REGARDING THE INSTALLATION OF, AND THE GRADING AROUND, THE FOUNDATION TUBES AND GROUND STRUT. THE TOP OF ANY FOUNDATION TUBE SHOULD BE LESS THAN 4 INCHES ABOVE THE GROUND. THE PLACEMENT OF THE FOUNDATION TUBES SHOULD BE AN APPROPRIATE DEPTH BELOW THE LEVEL LINE IN ORDER TO MAINTAIN THE FINISHED GUARDRAIL HEIGHT OF 31 INCHES FROM THE EDGE OF THE SHOULDER.

ON-SITE GRADING IS REQUIRED IF THE TOP OF THE FOUNDATION TUBES OR TOP OF THE GROUND STRUT DOES PROJECT MORE THAN 4 INCHES ABOVE THE GROUND LINE.

THE FACE OF THE TYPE B IMPACT HEAD SHALL BE COVERED WITH TYPE G REFLECTIVE SHEETING, PER CMS 730.19.

PAYMENT FOR THE ABOVE WORK SHALL BE MADE AT THE UNIT PRICE BID FOR ITEM 606, ANCHOR ASSEMBLY, MGS TYPE B, EACH, AND SHALL INCLUDE ALL LABOR, TOOLS, EQUIPMENT AND MATERIALS NECESSARY TO CONSTRUCT A COMPLETE AND FUNCTIONAL ANCHOR ASSEMBLY SYSTEM, INCLUDING REFLECTIVE SHEETING AND ALL RELATED HARDWARE, GRADING, EMBANKMENT AND EXCAVATION NOT SEPARATELY SPECIFIED, AS REQUIRED BY THE MANUFACTURER.

ITEM 606 - ANCHOR ASSEMBLY, MGS TYPE E, MASH 2016

THIS ITEM SHALL CONSIST OF FURNISHING AND INSTALLING ANY OF THE GUARDRAIL END TERMINALS FOR TYPE MGS GUARDRAIL AS LISTED ON ROADWAY ENGINEERING'S WEB PAGE UNDER ROADSIDE SAFETY DEVICES FOR APPROVED GUARDRAIL END TREATMENTS. INSTALLATION SHALL BE AT THE LOCATIONS SPECIFIED IN THE PLANS, IN ACCORDANCE WITH THE MANUFACTURER'S SPECIFICATIONS.

THE FACE OF THE TYPE E IMPACT HEAD SHALL BE COVERED WITH A SHEET OF TYPE G REFLECTIVE SHEETING, PER CMS 730.19.

REFER TO THE MANUFACTURER'S INSTRUCTIONS REGARDING THE INSTALLATION OF, AND THE GRADING AROUND THE FOUNDATION TUBES AND GROUND STRUT. THE TOP OF ANY FOUNDATION TUBE SHOULD BE LESS THAN 4 INCHES ABOVE THE GROUND. THE PLACEMENT OF THE FOUNDATION TUBES SHOULD BE AN APPROPRIATE DEPTH BELOW THE LEVEL LINE IN ORDER TO MAINTAIN THE FINISHED GUARDRAIL HEIGHT OF 31 INCHES FROM THE EDGE OF THE SHOULDER.

ON-SITE GRADING IS REQUIRED IF THE TOP OF THE FOUNDATION TUBES OR TOP OF THE GROUND STRUT DOES PROJECT MORE THAN 4 INCHES ABOVE THE GROUND LINE.

PAYMENT FOR THE ABOVE WORK SHALL BE MADE AT THE UNIT PRICE BID FOR ITEM 606, ANCHOR ASSEMBLY, MGS TYPE E, EACH, AND SHALL INCLUDE ALL LABOR, TOOLS, EQUIPMENT AND MATERIALS NECESSARY TO CONSTRUCT A COMPLETE AND FUNCTIONAL ANCHOR ASSEMBLY SYSTEM, INCLUDING ALL RELATED TRANSITIONS, REFLECTIVE SHEETING, HARDWARE, GRADING, EMBANKMENT AND EXCAVATION NOT SEPARATELY SPECIFIED, AS REQUIRED BY THE MANUFACTURER.

ITEM 606 - MGS BRIDGE TERMINAL ASSEMBLY, TYPE TST-2, AS PER PLAN

THE CONTRACTOR SHALL PROVIDE ALL THE LABOR, EQUIPMENT AND MATERIALS NECESSARY TO INSTALL THE BRIDGE TERMINAL ASSEMBLIES PER SCD MGS-3.3 EXCEPT AS MODIFIED BELOW.

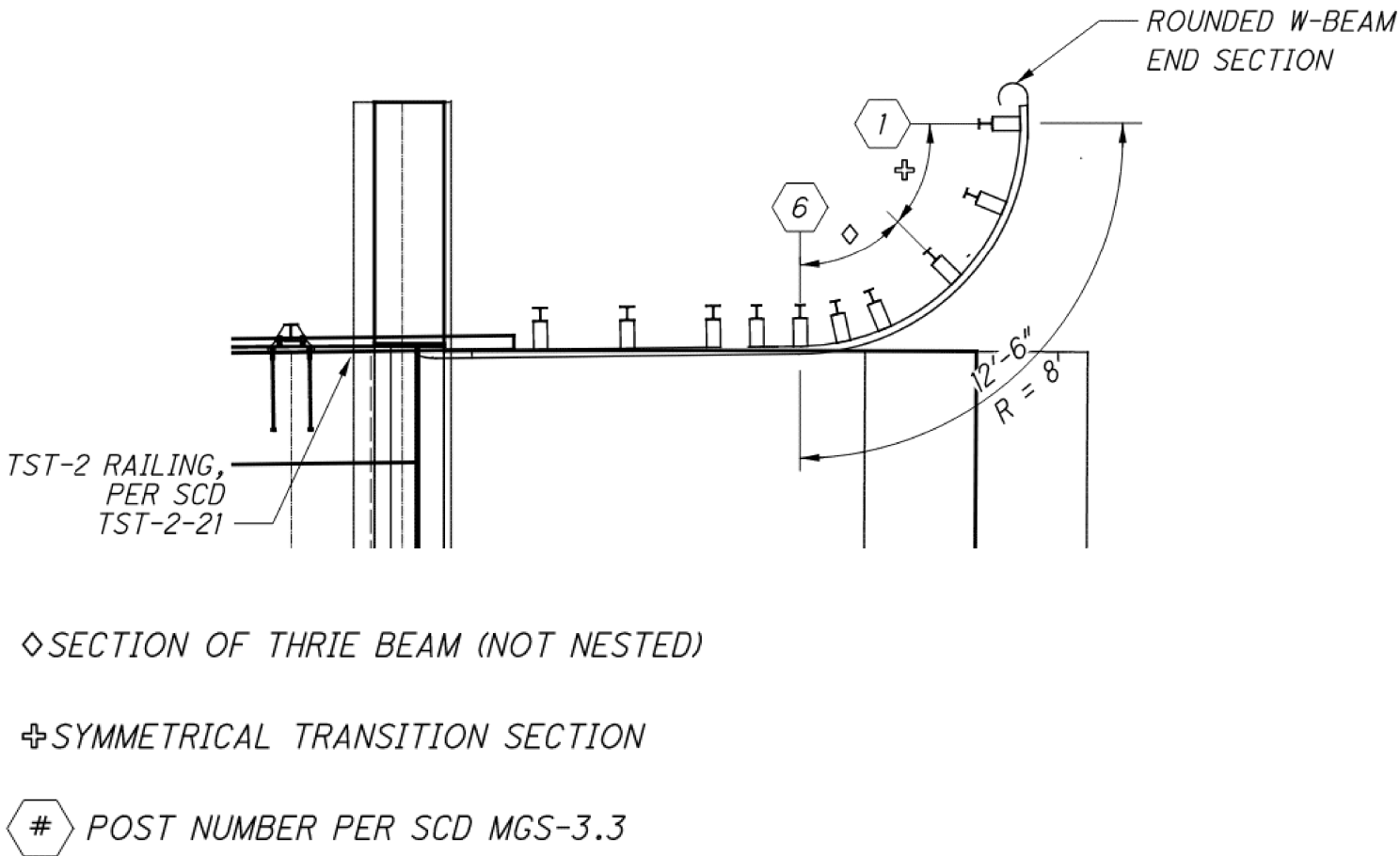

ITEM 203 - EMBANKMENT

THE FOLLOWING ESTIMATED QUANTITY HAS BEEN CARRIED TO THE GENERAL SUMMARY TO ADDRESS ANY AREAS REQUIRING EMBANKMENT UPON INSTALLATION OF GEOCELLS.

ITEM 203, EMBANKMENT 1555 CY

GENERAL NOTES

DESIGN AGENCY



DESIGNER

NE

REVIEWER

JMF 11/14/25

PROJECT ID

94332

SHEET

P.16

TOTAL

84

MODEL: Sheet PAPERSIZE: 34x22 (in.) DATE: 2/13/2026 TIME: 1:17:29 PM PLTDRV: OHDOT_PDF_Color.plt PENTBL: OHDOT_PenC.tbl USER: Nada.Elkehen@dol.ohio.gov WORKSPACE: OHDOTCEv02 WORKSET: 94332 PRODUCT: OpenRoadsDesigner 24.00.00.205
 pw:\ohdot-pw.bentley.com\ohdot-pw-02\Documents\01 Active Projects\District 02\Sardusky 94332\400-Engineering\Roadway\Sheets\94332 GG001.dgn

GENERAL SUMMARY



REVIEWER

94332

SHEET	TOTAL
-------	-------

P 20 | 8