







**PROJECT DESCRIPTION**

THE PROJECT INCLUDES THE WIDENING OF THE C.R. 111 (HIGHLAND ROAD) AND C.R. 25 (VALLEY VIEW ROAD) INTERSECTION TO CONSTRUCT SAFETY IMPROVEMENTS. THE PROJECT WILL WIDEN THE PAVEMENT ALONG C.R. 111 (HIGHLAND ROAD) TO EXTEND THE WESTBOUND LEFT TURN LANE AND ALONG C.R. 25 (VALLEY VIEW ROAD) TO PROVIDE LEFT AND RIGHT TURN LANES IN BOTH DIRECTIONS. ADDITIONAL WORK TASKS INCLUDE PAVEMENT RESURFACING, SIGNING AND PAVEMENT MARKINGS REPLACEMENT, DRAINAGE IMPROVEMENTS AND TRAFFIC SIGNAL INSTALLATION AND UPGRADES.

USGS MAP: TWINSBURG  
 MACEDONIA, OHIO  
 LONGITUDE: 41° 17' 56"  
 LATITUDE: 81° 29' 27"

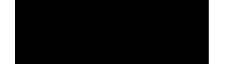
**LEGEND**

-   CATCH BASIN
-   MANHOLE
-  BMP TRIBUTARY AREA WITHIN R/W
-  BMP TRIBUTARY AREA OUTSIDE R/W

PROJECT DATA	
TOTAL AREA = 15.18 ACRES	RUNOFF COEFFICIENT FOR PRE-CONSTRUCTION SITE = 0.43
PROJECT EARTH DISTURBED AREA = 2.02 ACRES	RUNOFF COEFFICIENT FOR POST-CONSTRUCTION SITE = 0.45
ESTIMATED CONTRACTOR EARTH DISTURBED AREA = 0.44 ACRES	POST CONSTRUCTION BMP: A TYPE 2 MANUFACTURED SYSTEM WAS PROVIDED TO MEET NPDES POST-CONSTRUCTION REQUIREMENTS. SEE CROSS SECTION SHEETS FOR LOCATION.
NOTICE OF INTENT EARTH DISTURBED AREA = 2.46 ACRES	
IMPERVIOUS AREA FOR PRE-CONSTRUCTION SITE = 3.75 ACRES	IMMEDIATE RECEIVING WATERS = BRANDYWINE CREEK
IMPERVIOUS AREA FOR POST CONSTRUCTION SITE = 3.84 ACRES	SUBSEQUENT RECEIVING WATER = CUYAHOGA RIVER

BMP TYPE	LATITUDE/LONGITUDE		EDA TREATMENT CREDIT
			(ACRES)
MANUFACTURED SYSTEM 2	41.298772	81.491597	0.86
			TREATMENT PROVIDED: 0.86
			TREATMENT REQUIRED: 0.61

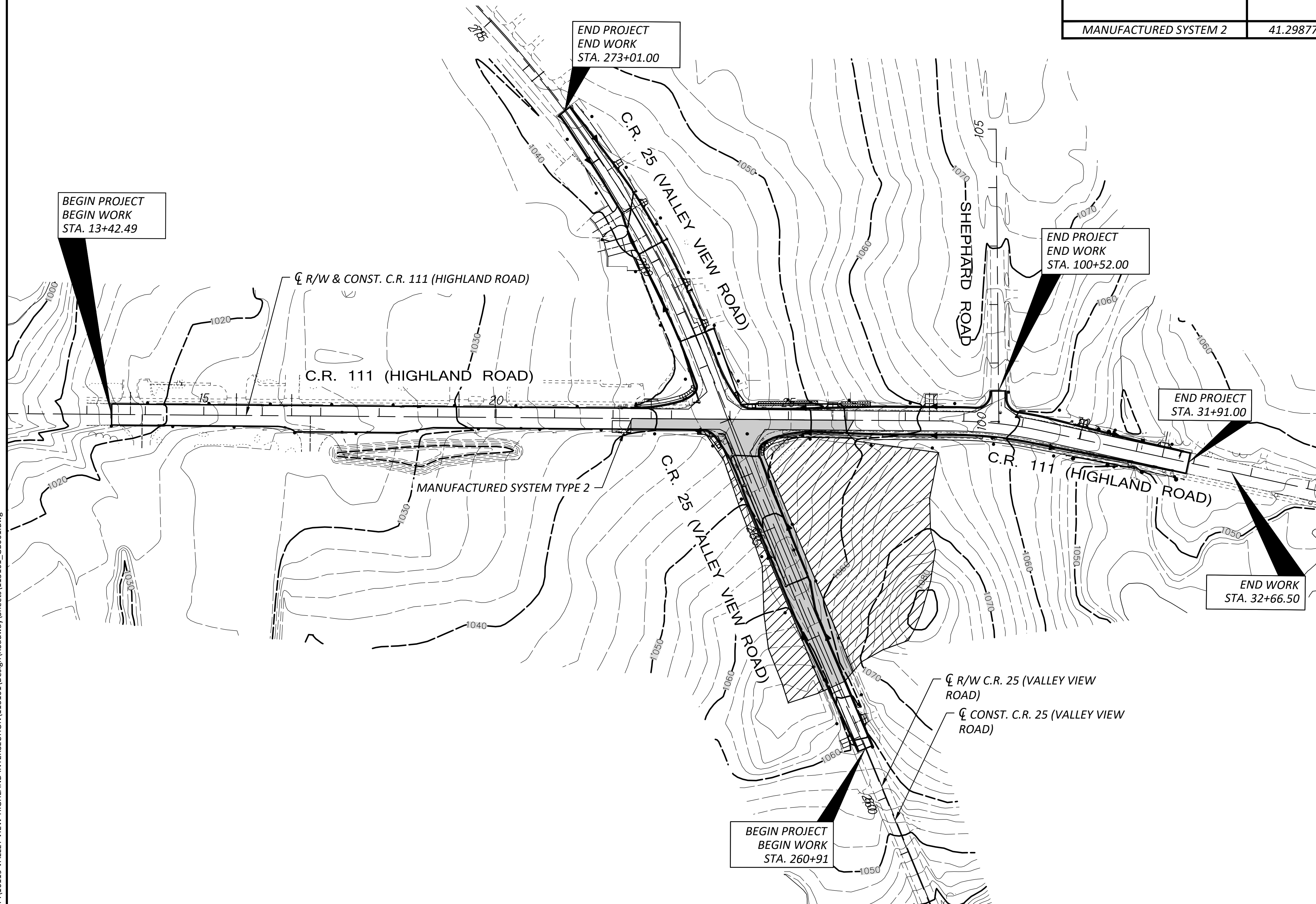

QUANTITIES CARRIED TO THE GENERAL SUMMARY		
ITEM	UNIT	QUANTITY
ITEM 832 - STORM WATER POLLUTION PEVENTION PLAN	-	LS
ITEM 832 - STORM WATER POLLUTION PEVENTION INSPECTIONS	-	LS
ITEM 832 - STORM WATER POLLUTION PEVENTION INSPECTION SOFTWARE	-	LS
ITEM 832 - EROSION CONTROL	EACH	63,000

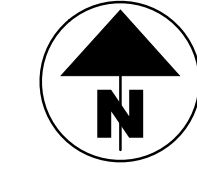

PROJECT SITE PLAN

DESIGN AGENCY

**CVE**  
 CHAGRIN VALLEY ENGINEERING, LTD.  
 22999 FORBES ROAD, UNIT B  
 CLEVELAND, OHIO 44146  
 PHONE: (440) 439-1999  
 FAX: (440) 439-1969

DESIGNER  
 REW  
 REVIEWER  
 BAK 06/24/24  
 PROJECT ID  
 113161  
 SHEET TOTAL  
 48 | 118