

- A EX. ASPHALT SURFACE COURSE (2")
 - B EX. ASPHALT INTERMEDIATE COURSE (4")
 - C EX. ASPHALT CONCRETE (MISC. DEPTH)
 - D EX. SUBBASE (6")
 - E EX. GUARDRAIL
-
- 1 ITEM 441 - ASPHALT CONCRETE SURFACE COURSE, TYPE 1, (449), PG64-22, 1.25"
 - 2 ITEM 441 - ASPHALT CONCRETE INTERMEDIATE COURSE, TYPE 2, (449), 1.75"
 - 3 ITEM 301 - ASPHALT CONCRETE BASE, (449), PG64-22, 11"
 - 4 ITEM 304 - AGGREGATE BASE, 6"
 - 5 ITEM 606 - GUARDRAIL, TYPE MGS WITH LONG POSTS
 - 6 ITEM 526 - REINFORCED CONCRETE APPROACH SLAB (T=15")
 - 7 ITEM 619 - SEEDING AND MULCHING
 - 8 ITEM 407 - TACK COAT (RATE PER C&MS TABLE 407.06-1)
 - 9 ITEM 254 - PAVEMENT PLANING, ASPHALT CONCRETE, 3"
 - 10 ITEM 411 - STABILIZED CRUSHED AGGREGATE, 3"
 - 11 ITEM 605 - AGGREGATE DRAINS
 - 12 ITEM 204 - SUBGRADE COMPACTION

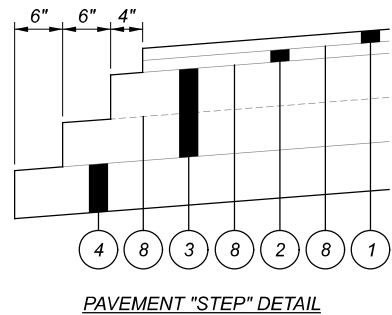

ADDENDUM	NUMBER	DATE	DESCRIPTION
	1	09/10/2025	ADDED SUBGRADE COMPACTION

TYPICAL SECTIONS



DESIGN AGENCY	TAS
REVIEWER	JMB 9/10/25
PROJECT ID	105442
SHEET	P. 3
TOTAL	59

NOTIFICATION OF TRAFFIC RESTRICTIONS

THROUGHOUT THE DURATION OF THE PROJECT, THE CONTRACTOR SHALL NOTIFY THE PROJECT ENGINEER IN WRITING OF ALL TRAFFIC RESTRICTIONS AND UPCOMING MAINTENANCE OF TRAFFIC CHANGES. THE CONTRACTOR SHALL ENSURE THE WRITTEN NOTIFICATION IS SUBMITTED IN A TIMELY MANNER TO ALLOW THE PROJECT ENGINEER TO MEET THE REQUIRED TIME FRAMES SET FORTH IN THE TABLE BELOW TO INFORM THE SPECIAL HAULING PERMITS SECTION (HAULING.PERMITS@DOT.OHIO.GOV) AND THE DISTRICT PUBLIC INFORMATION OFFICE (PIO). THIS NOTIFICATION SHALL BE RECEIVED BY THE PROJECT ENGINEER PRIOR TO THE PHYSICAL SETUP OF ANY APPLICABLE SIGNS OR MESSAGE BOARDS.

INFORMATION SHOULD INCLUDE, BUT IS NOT LIMITED TO, ALL CONSTRUCTION ACTIVITIES THAT IMPACT OR INTERFERE WITH TRAFFIC AND SHALL LIST THE SPECIFIC LOCATION, TYPE OF WORK, ROAD STATUS, DATE AND TIME OF RESTRICTION, DURATION OF RESTRICTION, NUMBER OF LANES MAINTAINED, NUMBER OF LANES CLOSED, MINIMUM VERTICAL CLEARANCE, MINIMUM WIDTH OF DRIVABLE PAVEMENT, DETOUR ROUTES, IF APPLICABLE, AND ANY OTHER INFORMATION REQUESTED BY THE PROJECT ENGINEER.

NOTIFICATION OF TRAFFIC RESTRICTIONS TIME TABLE

ITEM	DURATION OF CLOSURE	NOTICE DUE TO PERMITS & PIO
RAMP & ROAD CLOSURES	≥ 2 WEEKS	21 CALENDAR DAYS PRIOR TO CLOSURE
	> 12 HOURS & < 2 WEEKS	14 CALENDAR DAYS PRIOR TO CLOSURE
	≤ 12 HOURS	4 CALENDAR DAYS PRIOR TO CLOSURE
LANE CLOSURES & RESTRICTIONS	≥ 2 WEEKS	14 CALENDAR DAYS PRIOR TO CLOSURE
	< 2 WEEKS	5 BUSINESS DAYS PRIOR TO CLOSURE
START OF CONSTRUCTION & TRAFFIC PATTERN CHANGES	N/A	14 CALENDAR DAYS PRIOR TO IMPLEMENTATION

ANY UNFORESEEN CONDITIONS NOT SPECIFIED IN THE PLANS REQUIRING TRAFFIC RESTRICTIONS SHALL ALSO BE REPORTED TO THE PROJECT ENGINEER USING THE NOTIFICATION TIME TABLE.

ITEM 614, MAINTAINING TRAFFIC

ALL WORK AND TRAFFIC CONTROL DEVICES SHALL BE IN ACCORDANCE WITH C&MS 614 AND OTHER APPLICABLE PORTIONS OF THE SPECIFICATIONS, AS WELL AS THE OHIO MANUAL OF UNIFORM TRAFFIC CONTROL DEVICES. PAYMENT FOR ALL LABOR, EQUIPMENT AND MATERIALS SHALL BE INCLUDED IN THE LUMP SUM CONTRACT PRICE FOR ITEM 614, MAINTAINING TRAFFIC, UNLESS SEPARATELY ITEMIZED IN THE PLAN.

ITEM 614, MAINTAINING TRAFFIC (TIME LIMITATION ON A DETOUR) - PROPOSAL NOTE 124

CLOSURE OF SR-38. COMPLETION OF CRITICAL WORK SHALL BE DEFINED AS THE ROADWAY BEING REOPENED TO TRAFFIC WITH ALL ESSENTIAL SAFETY FEATURES IN PLACE, INCLUDING BUT NOT LIMITED TO: GUARDRAIL INSTALLATION, TEMPORARY PAVEMENT MARKINGS, INTERMEDIATE ASPHALT, AND NECESSARY SIGNAGE.

THE CONTRACTOR SHALL SCHEDULE ALL WORK AND ASSOCIATED CLOSURES TO ENSURE THAT BOTH THE ROADWAY AND STRUCTURE ARE FULLY OPEN TO TRAFFIC NO LATER THAN THE CRITICAL SCHOOL DATE (CSD) OF AUGUST 13, 2026. IN ADDITION TO, AND SEPARATE FROM, ANY DISINCENTIVES ASSOCIATED WITH EXCEEDING THE ALLOWABLE CLOSURE DURATION (B DURATION), THE CONTRACTOR SHALL BE ASSESSED LIQUIDATED DAMAGES OF \$5,000 PER CALENDAR DAY FOR EACH DAY THE CLOSURE EXTENDS BEYOND THE CSD. WHILE THE CLOSURE OF SR-38 MAY BEGIN PRIOR TO COMPLETION OF THE 2025-2026 ACADEMIC CALENDAR, THIS ADDITIONAL ASSESSMENT REFLECTS THE CRITICAL IMPORTANCE OF REOPENING THE ROADWAY PRIOR TO THE START OF THE ACADEMIC YEAR FOR A NEARBY SCHOOL. THE REVISED 108.06.C EXTENSION TO THE COMPLETION DATE FOR WEATHER OR SEASONAL CONDITIONS IN PN124 SHALL APPLY TO THE CSD DATE.

AT LEAST ONE LANE OF TWO-WAY TRAFFIC SHALL BE MAINTAINED AT ALL TIMES, EXCEPT FOR A PERIOD NOT TO EXCEED 120 CONSECUTIVE CALENDAR DAYS, WHEN THROUGH TRAFFIC MAY BE DETOURED AS SHOWN ON SHEETS P.7 & P.8. THE DETOUR CANNOT BE PLACED INTO AFFECT UNTIL SUNDAY 4/12/26 AT THE EARLIEST.

A INCENTIVE/DISINCENTIVE SHALL BE ASSESSED IN THE AMOUNT AS SHOWN IN THE TABLE BELOW PER DAY FOR EACH CALENDAR DAY THE ROADWAY REMAINS CLOSED TO TRAFFIC BEYOND THE SPECIFIED LIMIT.

DESCRIPTION OF CRITICAL WORK	MINIMUM DAYS	MAXIMUM DAYS	INCENTIVE/DISINCENTIVE \$ PER DAY	MAXIMUM INCENTIVE \$
ALL PROJECT WORK EXCEPT EROSION CONTROL	100	120	\$10,000	\$50,000

IN ADDITION TO THE FULL CLOSURE, THE CONTRACTOR SHALL BE PERMITTED TO IMPLEMENT A SINGLE-LANE CLOSURE ON US-38 FOR THE PURPOSE OF PERFORMING WORK ACTIVITIES SUBJECT TO THE FOLLOWING CONDITIONS:

- LANE CLOSURES SHALL BE LIMITED TO THE HOURS OF 9:00 AM TO 3:00 PM AND 7:00PM-6:00AM MONDAY THROUGH THURSDAY, 9:00 AM TO 3:00 PM FRIDAY, AND 24 HOURS SATURDAY AND SUNDAY. FLAGGERS SHALL BE USED AT EACH END OF THE CLOSURE TO MAINTAIN TWO-WAY TRAFFIC FLOW THROUGH THE WORK ZONE IN ACCORDANCE WITH THE OHIO MANUAL OF UNIFORM TRAFFIC CONTROL DEVICES (OMUTCD) AND MT-97.10. THE CONTRACTOR SHALL PROVIDE ADVANCE WARNING SIGNAGE, CHANNELIZING DEVICES, AND OTHER TRAFFIC CONTROL MEASURES AS REQUIRED TO ENSURE THE SAFETY OF THE TRAVELING PUBLIC AND WORK CREWS.
- SINGLE LANE CLOSURES OUTSIDE OF THIS ALLOWABLE TIMEFRAME SHALL BE ASSESSED \$500 PER 15 MINUTES, OR ANY PORTION THEREOF, WHEN TWO LANE TRAFFIC IS RESTRICTED.
- NO LANE CLOSURES SHALL BE PERMITTED OUTSIDE OF THE SPECIFIED HOURS WITHOUT PRIOR WRITTEN APPROVAL FROM THE DEPARTMENT.

ITEM 614, MAINTAINING TRAFFIC (NOTICE OF CLOSURE SIGN)

NOTICE OF CLOSURE SIGNS (W20-H13) SHALL BE ERECTED BY THE CONTRACTOR PRIOR TO THE SCHEDULED ROAD OR RAMP CLOSURE IN ACCORDANCE WITH THE NOTICE OF CLOSURE TIME TABLE BELOW.

THE SIGNS SHALL BE ERECTED ON THE RIGHT-HAND SIDE OF THE ROAD/RAMP FACING TRAFFIC. THEY SHALL BE PLACED SO AS NOT TO INTERFERE WITH THE VISIBILITY OF ANY OTHER TRAFFIC CONTROL SIGNS. ON ROADWAYS, THEY SHOULD BE ERECTED AT OR NEAR THE POINT OF CLOSURE. THE SIGNS MAY BE ERECTED ANYWHERE ON RAMPS AS LONG AS THEY ARE VISIBLE TO THE MOTORISTS USING THE RAMP. ON ENTRANCE RAMPS, THE SIGN SHALL BE ERECTED WELL IN ADVANCE OF THE MERGE AREA TO AVOID DISTRACTING MOTORISTS.

NOTICE OF CLOSURE SIGN TIME TABLE		
ITEM	DURATION OF CLOSURE	SIGN DISPLAYED TO PUBLIC
RAMP & ROAD CLOSURES	≥ 2 WEEKS	14 CALENDAR DAYS PRIOR TO CLOSURE
	> 12 HOURS	7 CALENDAR DAYS PRIOR TO CLOSURE
	< 2 WEEKS	7 CALENDAR DAYS PRIOR TO CLOSURE
	≤ 12 HOURS	2 BUSINESS DAYS PRIOR TO CLOSURE

THE SIGN SHALL DISPLAY THE DATE OF THE CLOSURE IN MMM-DD FORMAT AND THE NUMBER OF DAYS OF THE CLOSURE. THE LAST LINE OF THE W20-H13 SIGN LISTS A PHONE NUMBER WHICH A MOTORIST MAY CALL FOR ADDITIONAL INFORMATION. THIS IS TO BE A SPECIFIC OFFICE WITHIN THE DISTRICT RATHER THAN THE GENERAL SWITCHBOARD NUMBER.

ADDENDUM	NUMBER	DATE	DESCRIPTION
	▲	08/20/2025	ADDED TO NOTE FOR PN124 AND MOVED NOTES TO FIT SHEET

ITEM 614, MAINTAINING TRAFFIC (LANES OPEN DURING HOLIDAYS OR SPECIAL EVENTS)

PRIOR TO WHEN THE OFFICIAL DETOUR IS IN EFFECT, NO WORK SHALL BE PERFORMED AND ALL EXISTING LANES SHALL BE OPEN TO TRAFFIC DURING THE FOLLOWING DESIGNATED HOLIDAYS OR SPECIAL EVENTS:

NEW YEAR'S (OBSERVED)	GENERAL/REGULAR ELECTION DAY (NOV)
MEMORIAL DAY	THANKSGIVING
FORTH OF JULY (OBSERVED)	CHRISTMAS (OBSERVED)
LABOR DAY	(OTHER HOLIDAY OR SPECIAL EVENT)

THE PERIOD OF TIME THAT THE LANES ARE TO BE OPEN DEPENDS ON THE DAY OF THE WEEK ON WHICH THE HOLIDAY OR SPECIAL EVENT FALLS. THE FOLLOWING SCHEDULE SHALL BE USED TO DETERMINE THIS PERIOD:

DAY OF HOLIDAY OR EVENT	TIME ALL LANES MUST BE OPEN TO TRAFFIC
SUNDAY	12:00N FRIDAY THROUGH 6:00 AM MONDAY
MONDAY	12:00N FRIDAY THROUGH 6:00 AM TUESDAY
TUESDAY	12:00N MONDAY THROUGH 6:00 AM WEDNESDAY
TUESDAY	5:00 AM TUESDAY THROUGH 12:00 AM WEDNESDAY
(GEN./REG. ELECTION)	
WEDNESDAY	12:00N TUESDAY THROUGH 6:00 AM THURSDAY
THURSDAY	12:00N WEDNESDAY THROUGH 6:00 AM FRIDAY
THURSDAY	6:00 AM WEDNESDAY THROUGH 6:00 AM MONDAY
(THANKSGIVING ONLY)	
FRIDAY	12:00N THURSDAY THROUGH 6:00 AM MONDAY
SATURDAY	12:00N FRIDAY THROUGH 6:00 AM MONDAY

SHOULD THE CONTRACTOR FAIL TO MEET ANY OF THESE REQUIREMENTS, THE CONTRACTOR SHALL BE ASSESSED A DISINCENTIVE PER THE LANE VALUE CONTRACT (PN 127).

DESCRIPTION OF CRITICAL LANES TO BE MAINTAINED	RESTRICTED TIME PERIOD	TIME UNIT	DISINCENTIVE \$ PER TIME UNIT
ALL LANES OF SR 38 AND CR 58	AS PER THE DAY OF HOLIDAY OR EVENT TABLE ABOVE	EACH HOUR	\$500

COORDINATION WITH ADJACENT PROJECTS

THE CONTRACTOR SHALL COORDINATE WORK WITH ODOT AND THE CONTRACTORS ON THE ADJACENT PROJECTS.

UNI-38-0.31, PID 118866
UNI-736-4.06 PART 1 & 2, PID 107000

COORDINATION SHALL BE MADE TO PREVENT CONFLICTING ADVANCE WARNING SIGNS, CONFLICTING DETOUR ROUTES, OVERLAPING/CONFLICTING LANE CLOSURES, AND TO ENSURE THAT A MINIMUM DISTANCE OF 2 MILES BETWEEN ADJACENT LANE CLOSURES IS MAINTAINED. THIS IS NOT AN EXHAUSTIVE LIST OF COORDINATION ITEMS THAT MAY NEED TO BE RESOLVED BETWEEN PROJECTS. THE DEPARTMENT RESERVES THE RIGHT TO DECIDE WHICH PROJECT'S ACTIVITIES TAKE PRECEDENCE. PROJECTS THAT HAVE ACTIVITIES DELAYED DUE TO CONFLICTS WILL CONSIDER THIS AN EXCUSABLE, NON-COMPENSABLE DELAY PER 108.06.B. ON PROJECTS THAT HAVE ACTIVITIES DELAYED DUE TO CONFLICTS WHERE THE CONTRACTOR FAILED TO MEET THE NOTIFICATION REQUIREMENTS, THE DELAYS SHALL NOT BE CONSIDERED EXCUSABLE OR COMPENSABLE. ATTENDANCE AT DEPARTMENT ORDERED TRAFFIC COORDINATION MEETINGS BETWEEN ADJACENT PROJECTS SHALL BE CONSIDERED MANDATORY FOR EACH PROJECT'S SUPERINTENDENT AND WORKSITE TRAFFIC SUPERVISOR (WTS)*, AND INCIDENTAL TO THE LUMP SUM MAINTENANCE OF TRAFFIC PAYMENT ITEM

*IF REQUIRED BY THE PROJECT



DESIGNER
MTH

REVIEWER
JMB 08/20/25

PROJECT ID
105442

SHEET TOTAL
P. 6 59



SHEET NUM.							PART.	ITEM	ITEM	GRAND	UNIT	DESCRIPTION
P.4	P.11	P.12	P.17	P.18	P.20	P.24	01/STR/10		EXT	TOTAL		
												ROADWAY
LS							LS	201	11000	LS		CLEARING AND GRUBBING
	689						689	202	23000	689	SY	PAVEMENT REMOVED
	457						457	202	38000	457	FT	GUARDRAIL REMOVED
			134	35			169	203	10000	169	CY	EXCAVATION
			135	34			169	203	20000	169	CY	EMBANKMENT
		1,101					1,101	204	10000	1,101	SY	SUBGRADE COMPACTION
	457						457	606	15100	457	FT	GUARDRAIL, TYPE MGS WITH LONG POSTS
	4						4	606	34600	4	EACH	MGS BRIDGE TERMINAL ASSEMBLY, TYPE TST-2
												EROSION CONTROL
1							1	659	00100	1	EACH	SOIL ANALYSIS TEST
60							60	659	00300	60	CY	TOPSOIL
484							484	659	10000	484	SY	SEEDING AND MULCHING
25							25	659	14000	25	SY	REPAIR SEEDING AND MULCHING
25							25	659	15000	25	SY	INTER-SEEDING
0.1							0.1	659	20000	0.1	TON	COMMERCIAL FERTILIZER
0.1							0.1	659	31000	0.1	ACRE	LIME
2.7							2.7	659	35000	2.7	MGAL	WATER
							10,000	832	30000	10,000	EACH	EROSION CONTROL
												DRAINAGE
87							87	605	31100	87	FT	AGGREGATE DRAINS
												PAVEMENT
		267					267	254	01000	267	SY	PAVEMENT PLANING, ASPHALT CONCRETE, 3"
		259					259	301	56000	259	CY	ASPHALT CONCRETE BASE, PG64-22, (449)
		148					148	304	20000	148	CY	AGGREGATE BASE
		240					240	407	10000	240	GAL	TACK COAT
		6					6	411	10000	6	CY	STABILIZED CRUSHED AGGREGATE
		38					38	441	70000	38	CY	ASPHALT CONCRETE SURFACE COURSE, TYPE 1, (449), PG64-22
		53					53	441	70300	53	CY	ASPIALT CONCRETE INTERMEDIATE COURSE, TYPE 2, (449)
												ELECTRICAL
						1	1	625	33000	1	EACH	STRUCTURE GROUNDING SYSTEM
												TRAFFIC CONTROL
					15		15	621	00100	15	EACH	RPM
					15		15	621	54000	15	EACH	RAISED PAVEMENT MARKER REMOVED
	4						4	626	00102	4	EACH	BARRIER REFLECTOR, TYPE 1, BIDIRECTIONAL
	10						10	626	00110	10	EACH	BARRIER REFLECTOR, TYPE 2, BIDIRECTIONAL
					12		12	630	02100	12	FT	GROUND MOUNTED SUPPORT, NO. 2 POST
					6.3		6.3	630	80100	6.3	SF	SIGN, FLAT SHEET
					1		1	630	84900	1	EACH	REMOVAL OF GROUND MOUNTED SIGN AND DISPOSAL
					4		4	630	85100	4	EACH	REMOVAL OF GROUND MOUNTED SIGN AND REERECTION
					0.24		0.24	642	00104	0.24	MILE	EDGE LINE, 6", TYPE 1
					0.12		0.12	642	00300	0.12	MILE	CENTER LINE, TYPE 1
					21		21	642	00500	21	FT	STOP LINE, TYPE 1

ADDENDUM	NUMBER	DATE	DESCRIPTION
		09/10/2025	ADDED SUBGRADE COMPACTION

GENERAL SUMMARY

DESIGN AGENCY



DESIGNER

DJT

REVIEWER

JMB 09/10/25

PROJECT ID

105442

SHEET

P. 9

TOTAL

59

STATION RANGE			TYPICAL SECTION	SIDE	DISTANCE (D)	AVERAGE WIDTH (W)	SURFACE AREA (A) A=DxW/9	CADD GENERATED AREA	254 PAVEMENT PLANING, ASPHALT CONCRETE, 3"	204 SUBGRADE COMPACTION	301 ASPHALT CONCRETE BASE, PG64-22, (449), 11"		304 AGGREGATE BASE, 6"		407 TACK COAT			411 STABILIZED CRUSHED AGGREGATE, 3"		441 ASPHALT CONCRETE SURFACE COURSE, TYPE 1, (449), PG64-22, 1.25"	441 ASPHALT CONCRETE INTERMEDIATE COURSE, TYPE 2, (449), 1.75"						
					FT	FT	SY	SY	SY	SY	CY		CY		GAL			CY		CY	CY						
	TO																										
S.R. 38																											
169+00.00		169+50.00			50.00	24.00	133.33		133.33						21.33					4.63	6.48						
174+50.00		175+00.00			50.00	24.00	133.33		133.33						21.33					4.63	6.48						
169+50.00		170+44.30			94.30	33.17	347.55			366.72	106.20																
173+56.89		174+50.00			93.11	33.17	343.16			362.09	104.86																
169+50.00		170+44.30			94.30	34.67	363.26					60.54															
173+56.89		174+50.00			93.11	34.67	358.68					59.78															
169+50.00		170+44.30			94.30	32.00	335.29								53.65					11.64	16.30						
173+56.89		174+50.00			93.11	32.00	331.06								52.97					11.50	16.09						
169+50.00		170+44.30			94.30	32.67	342.31								27.38												
173+56.89		174+50.00			93.11	32.67	337.99								27.04												
169+00.00		169+50.00						33.04										2.75									
174+50.00		175+00.00						35.13										2.93									
107+46.43		170+71.63								104.17																	
173+29.01		173+54.01								104.17																	
BURNS RD																											
276+44.00		276+79.78						156.50			47.82																
276+44.00		276+79.78						162.19				27.03															
276+44.00		276+79.78						444.41							35.55												
276+44.00		276+79.78						146.84												5.10	7.14						
276+44.00		276+79.78						163.50		163.50																	

LEGEND

- 1

ITEM 441 - ASPHALT CONCRETE SURFACE COURSE, TYPE 1, (449), PG64-22, 1.25"
- 2

ITEM 441 - ASPHALT CONCRETE INTERMEDIATE COURSE, TYPE 2, (449), 1.75"
- 3

ITEM 301 - ASPHALT CONCRETE BASE, (449), PG64-22, 11"
- 4

ITEM 304 - AGGREGATE BASE, 6"
- 5

ITEM 606 - GUARDRAIL, TYPE MGS WITH LONG POSTS
- 6

ITEM 605 - AGGREGATE DRAINS
- 7

ITEM 619 - SEEDING & MULCHING
- 8

ITEM 407 - TACK COAT (RATE PER C&MS TABLE 407.06-1)
- 9

ITEM 204 - SUBGRADE COMPACTION

FOR DETAILS NOT SHOWN, SEE SHEETS P.13 AND P.19

ADDENDUM	NUMBER	DATE	DESCRIPTION
		09/10/2025	ADDED SUBGRADE COMPACTION

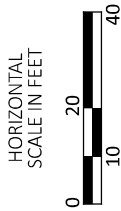
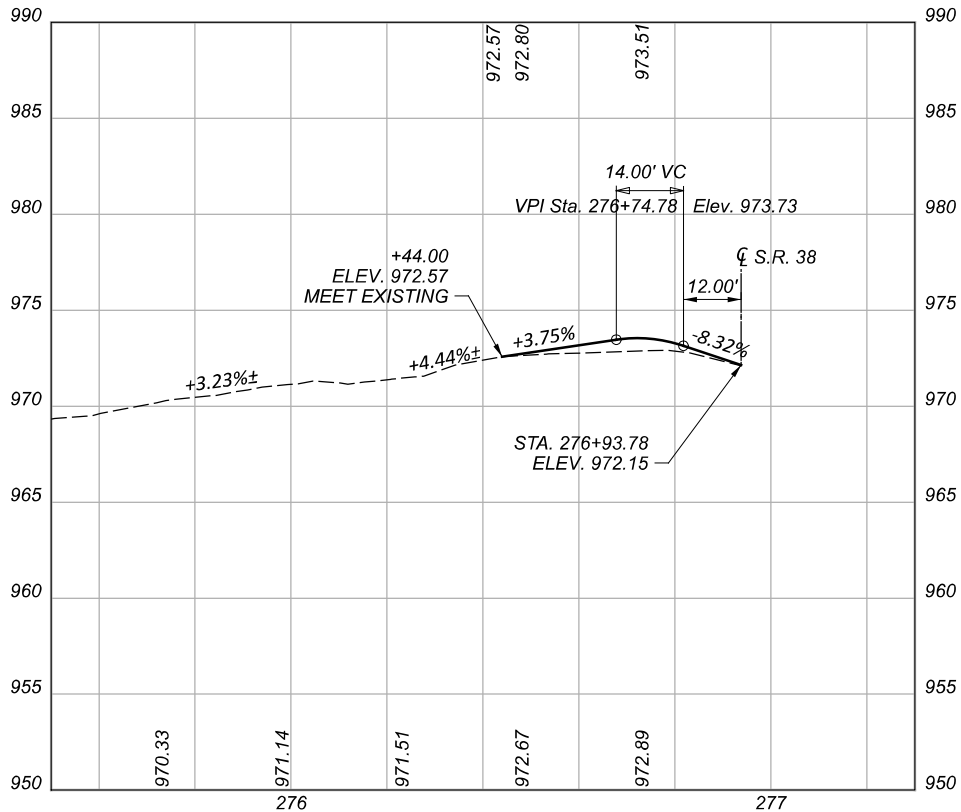
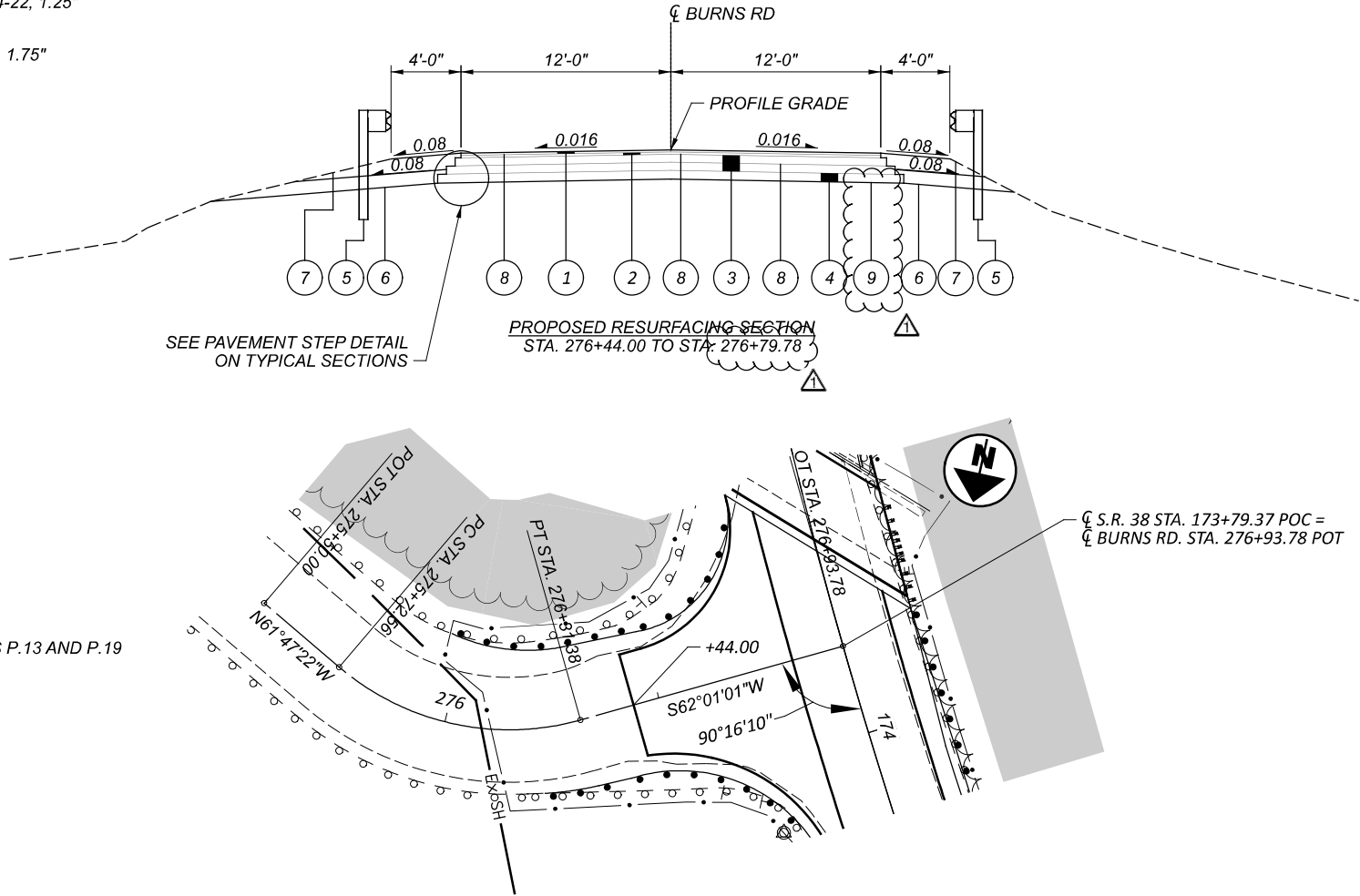

BURNS RD
PLAN, PROFILE, & TYPICAL SECTION



DESIGNER	DJT
REVIEWER	JMB
PROJECT ID	105442
SHEET	P. 14
TOTAL	59

					MADE BY: JH		6/20/2023			
					CHECKED BY: SAP		6/20/2023			
ITEM	EXTENSION	TOTAL	UNIT	ESTIMATED QUANTITIES				SEE SHEET NO.		
				DESCRIPTION	ABUT.	PIERS	SUPER.		GEN.	
202	11203	LS		PORTIONS OF STRUCTURE REMOVED, OVER 20 FOOT SPAN, AS PER PLAN				LS	3/38	
202	22900	134	SY	APPROACH SLAB REMOVED				134		
202	23500	972	SY	WEARING COURSE REMOVED				972		
								LS		
503	21300	LS		UNCLASSIFIED EXCAVATION						
509	10000	89576	LB	EPOXY COATED STEEL REINFORCEMENT	3693	2863	83020			
510	10000	508	EACH	DOWEL HOLES WITH NONSHRINK, NONMETALLIC GROUT	242	266				
511	33500	2	EACH	SEMI-INTEGRAL DIAPHRAGM GUIDE			2			
511	34410	49	CY	CLASS QC2 CONCRETE, SUPERSTRUCTURE			49			
511	34445	243	CY	CLASS QC2 CONCRETE, BRIDGE DECK, AS PER PLAN			243		3/38	
511	42511	12	CY	CLASS QC1 CONCRETE, PIER CAP, AS PER PLAN		12				3/38
511	44110	29	CY	CLASS QC1 CONCRETE, ABUTMENT NOT INCLUDING FOOTING	29					
512	10101	627	SY	SEALING OF CONCRETE SURFACES (EPOXY-URETHANE), AS PER PLAN	90	378	159		3/38	
512	10600	4	FT	CONCRETE REPAIR BY EPOXY INJECTION	4					
513	10261	236128	LB	STRUCTURAL STEEL MEMBERS, LEVEL 3, AS PER PLAN (SHOP METALLIZED)			236128		4/38	
513	10261	38483	LB	STRUCTURAL STEEL MEMBERS, LEVEL 3, AS PER PLAN (HOT-DIPPED GALVANIZED)			38483			4/38
513	20000	4512	EACH	WELDED STUD SHEAR CONNECTORS			4512			
516	10010	90	FT	ARMORLESS PREFORMED JOINT SEAL				90		
516	14020	114	FT	SEMI-INTEGRAL ABUTMENT EXPANSION JOINT SEAL	114					
516	44201	10	EACH	ELASTOMERIC BEARING (1'-3" DIA. X 3.75") WITH INTERNAL LAMINATES AND LOAD PLATE (1'-5"X1'-5"X1") (NEOPRENE), AS PER PLAN	10				19/38	
516	44201	10	EACH	ELASTOMERIC BEARING (1'-6" DIA. X 3.75") WITH INTERNAL LAMINATES AND LOAD PLATE (1'-8"X1'-8"X1.5") (NEOPRENE), AS PER PLAN		10				20/38
516	44201	5	EACH	ELASTOMERIC BEARING (1'-5" DIA. X 3.25") WITH INTERNAL LAMINATES AND LOAD PLATE (1'-7"X1'-11"X1.5") (NEOPRENE), AS PER PLAN		5			21/38	
517	70100	533	FT	RAILING (THREE STEEL TUBE BRIDGE RAILING)			533			
SPECIAL	51822300	637	FT	SPECIAL - STEEL DRIP STRIP			637		28/38	
526	25000	192	SY	REINFORCED CONCRETE APPROACH SLABS (T=15")				192		
526	90030	90	FT	TYPE C INSTALLATION				90		
SPECIAL	53050000	2	EACH	RETAINING WALL (WALLS BEHIND ABUTMENTS)	2				34/38 & 35/38	
843	50000	123	SF	PATCHING CONCRETE STRUCTURES WITH TROWELABLE MORTAR	101	22				

ADDENDUM	NUMBER	DATE	DESCRIPTION
		09/16/2025	ADDED STEEL DRIP STRIP QUANTITY

ESTIMATED QUANTITIES
BRIDGE NO. UNI-38-03.21
S.R. 38 OVER BIG DARBY CREEK

SFN
8002010

DESIGN AGENCY

a RJA company

DESIGNER
JH

CHECKER
SAP

REVIEWER
BMG 09/16/25

PROJECT ID
105442

SUBSET
6

TOTAL
38

SHEET
P.27

TOTAL
59

UNI-38-03.21

[illegible]

GENERAL SUMMARY