

LOCATION MAP

LATITUDE: N40°50'20" LONGITUDE: W81°53'50"



PORTION TO BE IMPROVED	
INTERSTATE HIGHWAY	
FEDERAL ROUTES	
STATE ROUTES	
COUNTY & TOWNSHIP ROADS	
OTHER ROADS	

DESIGN DESIGNATION

	SR 585	TR 68, N	TR 68, S
CURRENT ADT (2025)	7380	1110	740
DESIGN YEAR ADT (2045)	8110	1220	810
DESIGN HOURLY VOLUME (2045)	811	134	97
DIRECTIONAL DISTRIBUTION	55%	59%	62%
TRUCKS (24 HOUR B&C)	7%	4%	5%
DESIGN SPEED	55 MPH	35 MPH	55 MPH
LEGAL SPEED	55 MPH	35 MPH	55 MPH
DESIGN FUNCTIONAL CLASSIFICATION:	MINOR ARTERIAL	LOCAL	LOCAL
NHS PROJECT	NO	NO	NO

DESIGN EXCEPTIONS

NONE REQUIRED

ADA DESIGN WAIVERS

NONE REQUIRED

UNDERGROUND UTILITIES

Contact Two Working Days
Before You Dig

Before You Dig

OHIO 811, 8-1-1, or 1-800-362-2764
(Non members must be called directly)

PLAN PREPARED BY:
MEAD & HUNT
4700 LAKEHURST CT, SUITE 110
COLUMBUS, OH, 43016

STATE OF OHIO
DEPARTMENT OF TRANSPORTATION

WAY-585-2.73 KCK Construction Markups

CITY OF WOOSTER
WAYNE TOWNSHIP
WAYNE COUNTY

INDEX OF SHEETS:

TITLE SHEET	1
SCHEMATIC PLAN	2
TYPICAL SECTIONS	3-5
GENERAL NOTES	6-8, 8A
MAINTENANCE OF TRAFFIC	9-12
GENERAL SUMMARY	13-15
SUBSUMMARIES	16-18
PROJECT SITE PLAN	19
PLAN AND PROFILE - SR 585	20-24
PLAN AND PROFILE - TR 68	25-29
PLAN AND PROFILE - ROUNDABOUT	30
CROSS SECTIONS - LAYOUT PLAN	31
CROSS SECTIONS - SR 585	32-40
CROSS SECTIONS - TR 68	41-48
CROSS SECTIONS - ROUNDABOUT	49-52
SUPERELEVATION TABLES	53
INTERSECTION DETAILS	54-58
DRIVE DETAILS	59-60
STORM SEWER PROFILES	61
MISCELLANEOUS DETAILS	62-65
SUL TEST HOLE LAYOUT	66
TRAFFIC CONTROL	67-73, 68A, 68B
LIGHTING	74-81
LANDSCAPING	82
STRUCTURE (UNDER 20')	83-89
SOIL PROFILE - ROADWAY	90-93

FEDERAL PROJECT NUMBER

E230485

RAILROAD INVOLVEMENT

NONE

PROJECT DESCRIPTION

THIS PROJECT CONSISTS OF UPGRADING THE INTERSECTION OF SR 585 (AKRON ROAD) AND TR 68 (NORTH GEYERS CHAPEL ROAD) TO A MODERN ROUNDABOUT. THIS PROJECT INCLUDES LIGHTING, DRAINAGE, SIGNING, AND STRIPING WORK. THE TOTAL PROJECT WORK LENGTH IS 0.36 MILES.

EARTH DISTURBED AREAS

PROJECT EARTH DISTURBED AREA:	4.36 ACRES
ESTIMATED CONTRACTOR EARTH DISTURBED AREA:	0.88 ACRES
NOTICE OF INTENT EARTH DISTURBED AREA:	5.24 ACRES

2023 SPECIFICATIONS

THE STANDARD SPECIFICATIONS OF THE STATE OF OHIO, DEPARTMENT OF TRANSPORTATION, INCLUDING SUPPLEMENTAL SPECIFICATIONS LISTED IN THE PLANS, CHANGES LISTED IN THE PROPOSAL, AND THE SUPPLEMENTAL SPECIFICATION 800 VERSION INDICATED ON THE PROPOSAL SHALL GOVERN THIS IMPROVEMENT.

I HEREBY APPROVE THESE PLANS AND DECLARE THAT THE MAKING OF THIS IMPROVEMENT WILL REQUIRE THE CLOSING TO TRAFFIC OF THE HIGHWAY AND THAT DETOURS WILL BE PROVIDED AS INDICATED ON SHEET P.11 & P.12

Robert Weaver
District 03 Deputy Director

Pamela Boratyn
Director, Department of Transportation

STANDARD CONSTRUCTION DRAWINGS								SUPPLEMENTAL SPECIFICATIONS	SPECIAL PROVISIONS
BP-2.1	1/21/22	MGS-2.1	1/19/18	HL-30.22	1/15/21	TC-42.20	10/18/13	800-2023 7/19/25	WATERWAY
BP-2.2	1/15/21	MGS-4.2	7/19/13	HL-40.10	7/19/24	TC-52.10	10/18/13	813 7/21/23	PERMIT 2/19/25
BP-3.1	1/19/24	MGS-5.3	7/15/16	HL-60.11	7/21/17	TC-52.20	1/15/21	825 7/19/24	
BP-4.1	7/19/13			HL-60.12	7/21/23	TC-61.30	7/19/24	832 7/19/24	
BP-5.1	7/15/22	RM-1.1	1/20/23	HL-60.31	7/19/24	TC-65.10	1/17/14	913 4/16/21	
		RM-3.1	7/20/18			TC-65.11	1/19/24		
DM-1.1	7/17/20			MT-97.10	4/19/19	TC-71.10	4/21/23		
DM-1.2	7/16/21	HW-1.1	7/19/24	MT-97.12	1/20/17				
DM-4.1	7/17/20	HW-2.2	7/20/18	MT-101.60	4/21/23				
DM-4.2	7/20/12			MT-101.90	7/17/20				
DM-4.3	1/15/16	HL-10.11	7/21/23	MT-105.10	1/17/20				
DM-4.4	1/15/16	HL-10.12	7/21/23						
		HL-10.13	1/20/23	TC-41.20	10/18/13				
LA-1.2	1/16/09	HL-20.11	7/21/23	TC-41.30	4/21/23				
		HL-30.11	7/21/23	TC-41.40	10/18/13				
MGS-1.1	7/16/21	HL-30.21	4/17/20	TC-41.50	10/18/13				

ENGINEER'S SEAL



Steven Scheid Jr.

DESIGN AGENCY

Mead & Hunt

CLIENT



DESIGNER

LNB

REVIEWER

SJS 01/13/25

PROJECT ID

118336

SHEET

P.01

TOTAL

93

TITLE SHEET

Verifying
with City
of
Wooster

ITEM 609 - 6" CONCRETE TRAFFIC ISLAND, AS PER PLAN, TOOLED AND STAINED

THIS WORK SHALL CONSIST OF CONSTRUCTING THE COLORING AND JOINTING OF CONCRETE FOR THE SPLITTER ISLANDS.

MATERIALS:

- A. CONCRETE SHALL BE IN ACCORDANCE WITH THE PLANS AND SECTION 609 OF THE ODOT STANDARD SPECIFICATIONS.
- B. THE CONCRETE COLOR IS TO MATCH THE TRUCK APRON AND SHALL BE "BRICK RED" AS MANUFACTURED BY BOMANITE OR APPROVED EQUAL; PHONE 303-369-1115, E-MAIL INFO@BOMANITE.COM OR INTERNET WWW.BOMANITE.COM.
- C. COLORED CONCRETE WILL BE AN INTEGRAL COLORING APPLICATION, WITH COLORING ADDITIVES MIXED IN ACCORDANCE WITH MANUFACTURER'S INSTRUCTIONS. MIX UNTIL COLOR ADDITIVES ARE UNIFORMLY DISPERSED THROUGHOUT MIXTURE. COLOR SHALL BE UNIFORM THROUGHOUT THE CONCRETE.
- D. CURING COMPOUND FOR COLORED CONCRETE: CURING COMPOUND SHALL COMPLY WITH ASTM C309 AND BE APPROVED BY COLOR ADDITIVE MANUFACTURER FOR USE WITH COLORED CONCRETE. PROVIDE JS CLEAR COAT SEALER OR APPROVED EQUAL ON ALL SURFACES.
- E. ADMIXTURES: DO NOT USE CALCIUM CHLORIDE ADMIXTURES.

CONSTRUCTION REQUIREMENTS:

- A. PREPARE SUBGRADE AND INSTALL COLORED CONCRETE IN ACCORDANCE WITH THE PLANS AND SECTION 609 OF THE ODOT STANDARD SPECIFICATIONS, EXCEPT AS NOTED HEREIN.
- B. JOINTS SHALL BE TOOLED IN PATTERNS INDICATED ON PLANS, OR AS NOTED HEREIN. (PATTERN: BRICK RUNNING BOND). THE SPLITTER ISLANDS SHALL BE SCORED IN A 24-INCH RUNNING BOND PATTERN PERPENDICULAR TO THE REFERENCE LINE THAT THE SPLITTER ISLAND IS CONSTRUCTED.
- C. TOOLED JOINTS: FORM JOINTS AFTER INITIAL FLOATING BY GROOVING AND FINISHING EACH EDGE OF JOINT WITH GROOVING TOOL TO A ¼ INCH RADIUS. REPEAT GROOVING OF CONSTRUCTION JOINTS AFTER APPLYING SURFACE FINISHES. ELIMINATE TOOL MARKS ON CONCRETE SURFACES. EDGES OF COLORED CONCRETE NOT CONTAINED BY STANDARD CONCRETE SHALL BE TOOLED IN THE SAME MANNER.
- D. FINISH: COLORED CONCRETE SHALL HAVE A BROOMED FINISH. PULL BROOM ACROSS FRESHLY FLOATED CONCRETE TO PRODUCE TEXTURE INDICATED IN STRAIGHT LINES PERPENDICULAR TO MAIN LINE OF TRAFFIC. DO NOT DAMPEN BROOMS. ROUNDABOUT TRUCK APRONS SHALL HAVE A LIGHT BROOM FINISH.
- E. CURING: APPLY CURING COMPOUND FOR COLORED CONCRETE IN ACCORDANCE WITH THE MANUFACTURER'S INSTRUCTIONS. APPLY CURING COMPOUND AT CONSISTENT TIME FOR EACH POUR TO MAINTAIN CLOSE COLOR CONSISTENCY.
- F. PROTECT ADJACENT FINISHED SURFACES FROM SPLATTERS.
- G. DO NOT ADD WATER TO CONCRETE AT JOB SITE, FOG OR SPRAY SURFACE WITH WATER, OR PUT INTO PUMPS OR ONTO TOOLS OR BROOMS.
- H. DO NOT APPLY COLOR ADDITIVES MEANT FOR INTEGRAL COLORING TO SURFACE OF CONCRETE.

PAYMENT WILL INCLUDE THE COST OF FURNISHING AND PLACING ALL OF THE MATERIALS, FINISHING, AND TESTING. THE DEPARTMENT WILL PAY FOR ACCEPTED QUANTITIES AT THE CONTRACT PRICE PER SQUARE YARD FOR ITEM 609 - 6" CONCRETE TRAFFIC ISLAND, AS PER PLAN, TOOLED AND STAINED.

ITEM 452 - NON-REINFORCED CONCRETE PAVEMENT, MISC.: 12.25" TRUCK APRON STAINED

THIS WORK SHALL CONSIST OF CONSTRUCTING THE CONCRETE INCLUDING A STAIN COLORING FOR THE ROUNDABOUT TRUCK APRONS.

MATERIALS:

- A. CONCRETE SHALL BE IN ACCORDANCE WITH THE PLANS AND SECTION 452 OF THE ODOT STANDARD SPECIFICATIONS. DO NOT COMPLY WITH THE REQUIREMENTS OF 451.14. CONCRETE SHALL BE CLASS QC 1P.
- B. THE CONCRETE COLOR IS TO MATCH THE SPLITTER ISLANDS AND SHALL BE "BRICK RED" AS MANUFACTURED BY BOMANITE OR APPROVED EQUAL; PHONE 303-369-1115, E-MAIL INFO@BOMANITE.COM OR INTERNET WWW.BOMANITE.COM.
- C. COLORED CONCRETE WILL BE AN INTEGRAL COLORING APPLICATION, WITH COLORING ADDITIVES MIXED IN ACCORDANCE WITH MANUFACTURER'S INSTRUCTIONS. MIX UNTIL COLOR ADDITIVES ARE UNIFORMLY DISPERSED THROUGHOUT MIXTURE. COLOR SHALL BE UNIFORM THROUGHOUT THE CONCRETE.
- D. CURING COMPOUND FOR COLORED CONCRETE: CURING COMPOUND SHALL COMPLY WITH ASTM C309 AND BE APPROVED BY COLOR ADDITIVE MANUFACTURER FOR USE WITH COLORED CONCRETE. PROVIDE JS CLEAR COAT SEALER OR APPROVED EQUAL ON ALL SURFACES.
- E. ADMIXTURES: DO NOT USE CALCIUM CHLORIDE ADMIXTURES.

CONSTRUCTION REQUIREMENTS:

- A. PREPARE SUBGRADE AND INSTALL COLORED CONCRETE IN ACCORDANCE WITH THE PLANS AND SECTION 452 OF THE ODOT STANDARD SPECIFICATIONS, EXCEPT AS NOTED HEREIN.
- B. FINISH: COLORED CONCRETE SHALL HAVE A BROOMED FINISH. PULL BROOM ACROSS FRESHLY FLOATED CONCRETE TO PRODUCE TEXTURE INDICATED IN STRAIGHT LINES PERPENDICULAR TO MAIN LINE OF TRAFFIC. DO NOT DAMPEN BROOMS. ROUNDABOUT TRUCK APRONS SHALL HAVE A LIGHT BROOM FINISH.
- C. CURING: APPLY CURING COMPOUND FOR COLORED CONCRETE IN ACCORDANCE WITH THE MANUFACTURER'S INSTRUCTIONS. APPLY CURING COMPOUND AT CONSISTENT TIME FOR EACH POUR TO MAINTAIN CLOSE COLOR CONSISTENCY.
- D. PROTECT ADJACENT FINISHED SURFACES FROM SPLATTERS.
- E. DO NOT ADD WATER TO CONCRETE AT JOB SITE, FOG OR SPRAY SURFACE WITH WATER, OR PUT INTO PUMPS OR ONTO TOOLS OR BROOMS.
- F. DO NOT APPLY COLOR ADDITIVES MEANT FOR INTEGRAL COLORING TO SURFACE OF CONCRETE.

PAYMENT WILL INCLUDE THE COST OF FURNISHING AND PLACING ALL OF THE MATERIALS, FINISHING, AND TESTING. THE DEPARTMENT WILL PAY FOR ACCEPTED QUANTITIES AT THE CONTRACT PRICE PER SQUARE YARD FOR ITEM 452 - NON-REINFORCED CONCRETE PAVEMENT, MISC.: 12.25" TRUCK APRON STAINED.

ROUTINE MAINTENANCE

BETWEEN THE TIME THAT BIDS ARE TAKEN AND THE START OF CONSTRUCTION, THE MAINTAINING AGENCY MAY ENTER UPON THE PROJECT AND PERFORM ROUTINE MAINTENANCE SUCH AS CRACK SEALING, PATCHING, AND BERM AND SHOULDER REPAIR. THE EFFECTS, IF ANY, OF THE PERFORMANCE OF ROUTINE MAINTENANCE SHALL BE CONSIDERED AS INHERENT IN WORK OF THE CHARACTER PROVIDED FOR IN THE PLAN AND THE RESULTING CONDITIONS SHALL NOT BE CONSIDERED AS DIFFERING MATERIALLY FROM THOSE EXISTING AT THE TIME BIDS WERE TAKEN.

ITEM 206 - CHEMICALLY STABILIZED SUBGRADE

CONSTRUCT THE SUBGRADE AS FOLLOWS AND IN THE FOLLOWING SEQUENCE:

1. SHAPE THE SUBGRADE TO WITHIN 0.2 FEET OF THE PLAN SUBGRADE ELEVATION. ALL BORROW SOIL TO BE PLACED AS BORROW FILL WITHIN 2 FEET OF THE SUBGRADE SHALL, PRIOR TO PLACEMENT, BE TESTED TO VERIFY THE BORROW HAS A PLASTICITY INDEX (PI) LESS THAN 20. THE COST TO PERFORM THIS TESTING SHALL BE INCLUDED IN THE UNIT COST OF ITEM 203, EMBANKMENT, AS PER PLAN.
2. THE ENTIRE FULL DEPTH PAVEMENT SECTIONS EXCEPT FOR STATION 47+10.00 TO 49+10.68 ON TR 68 SHALL BE STABILIZED TO A 12" DEPTH USING CEMENT. THE ABOVE REFERENCED SECTION SHALL BE STABILIZED TO A 14" DEPTH USING CEMENT. SPREAD THE CHEMICAL UNIFORMLY ON THE SUBGRADE.
3. IMMEDIATELY AFTER SPREADING THE CHEMICAL, MIX THE SOIL AND CHEMICAL ACCORDING TO CMS 206.05.B.
4. COMPACT THE SOIL PER CMS 206.05.C.
5. BY THE END OF EACH DAY, APPLY A CURING COAT PER CMS 206.05.D.
6. PROOF ROLL THE STABILIZED AREAS ACCORDING TO C&MS 206.05.E TO VERIFY STABILITY.
7. PROTECT THE SUBGRADE ACCORDING TO CMS 206.05.F.
8. FINE GRADE THE SUBGRADE ACCORDING TO CMS 206.05.C.

CURB CUT AND EROSION CONTROL FLUMES

AT CURB CUTS INDICATED ON THE PLANS, PROVIDE AN EROSION CONTROL FLUME AS DETAILED IN SCD DM-4.1. ANCHOR THE UPSTREAM END PER THE MANUFACTURER'S RECOMMENDATIONS.

PROVIDE 5'-6" OF DROPPED CURB SIMILAR TO SCD BP-4.1 EXCEPT THE TOP OF THE CURB SHALL BE FLUSH WITH THE GUTTER. DEPRESS THE GUTTER SIMILAR TO SECTION A-A OF SCD DM-4.1. THE COST OF THE DROPPED CURB AND DEPRESSED GUTTER SHALL BE INCIDENTAL TO THE UNIT PRICE OF THE COMBINATION CURB AND GUTTER.

PAYMENT FOR THE FLUME WILL BE AS INDICATED ON SCD DM-4.1.

EXISTING SUBSURFACE DRAINAGE

PROVIDE UNOBSTRUCTED OUTLETS FOR ALL EXISTING UNDERDRAINS OR AGGREGATE DRAINS ENCOUNTERED DURING CONSTRUCTION.

PROVIDE AN OUTLET PER STANDARD CONSTRUCTION DRAWING DM-1.1 FOR ALL UNDERDRAINS THAT OUTLET TO A SLOPE. UNDERDRAINS THAT CAN BE CONNECTED TO THE NEW OR EXISTING UNDERDRAINS AT THE END OF THE PROJECT LIMITS AS WELL AS ALL NECESSARY BENDS OR BRANCHES REQUIRED FOR CONNECTION ARE INCLUDED IN THE BASIS OF PAYMENT FOR UNCLASSIFIED PIPE UNDERDRAINS.

THE FOLLOWING ESTIMATED QUANTITIES HAVE BEEN INCLUDED IN THE GENERAL SUMMARY FOR THE WORK NOTED ABOVE:

601, TIED CONCRETE BLOCK MAT, TYPE 1 7 SQ. YD.
605, AGGREGATE DRAINS 50 FT.
611, 6" CONDUIT, TYPE F, AS PER PLAN 100 FT.
611, PRECAST REINFORCED CONCRETE OUTLET 4 EACH
605, 6" UNCLASSIFIED PIPE UNDERDRAINS, AS PER PLAN 100 FT.

BENCHING OF FOUNDATION SLOPES

ALTHOUGH CROSS-SECTIONS INDICATE SPECIFIC DIMENSIONS FOR PROPOSED BENCHING OF THE EMBANKMENT FOUNDATIONS IN CERTAIN AREAS, NO WAIVER OF THE SPECIFICATIONS IS INTENDED. BENCH ALL OTHER SLOPED EMBANKMENT AREAS AS SET FORTH IN SECTION 203.05 OF THE CONSTRUCTION AND MATERIAL SPECIFICATIONS (C&MS). NO ADDITIONAL PAYMENT WILL BE MADE FOR BENCHING REQUIRED UNDER THE PROVISIONS OF SECTION 203.05.

ITEM 611 - RESIDENTIAL AND COMMERCIAL DRAINAGE CONNECTIONS

EXISTING ROOF DRAINS, FOOTER DRAINS, OR YARD DRAINS DISTURBED BY THE WORK, SHALL BE PROVIDED WITH UNOBSTRUCTED OUTLETS BY CONNECTING A CONDUIT THROUGH THE CURB OR INTO A DRAINAGE STRUCTURE. THE LOCATION, TYPE, SIZE AND GRADE OF THE NEW CONDUIT REQUIRED TO REPLACE OR EXTEND THE EXISTING DRAIN WILL BE DETERMINED BY THE ENGINEER.

THE FOLLOWING CONDUIT TYPES MAY BE USED: 707.33, 707.41 NON-PERFORATED, 707.42, 707.43, 707.45, 707.46, 707.47, 701.51, 701.52 SDR35.

PAYMENT FOR ALL LABOR AND MATERIALS WILL BE PERFORMED BY CHANGE ORDER.

POST CONSTRUCTION STORM WATER TREATMENT

THIS PLAN UTILIZES STRUCTURAL BEST MANAGEMENT PRACTICES (BMP'S) FOR POST CONSTRUCTION STORM WATER TREATMENT

VEGETATED BIOFILTER

THIS PLAN UTILIZES VEGETATED BIOFILTERS FOR POST CONSTRUCTION STORM WATER TREATMENT. PLACE EITHER ITEM 660 SODDING OR ITEM 659 SEEDING AND MULCHING WITH A 4-INCH LIFT OF TOPSOIL AS SHOWN IN THE PLANS TO ANY DISTURBED AREA ON THE SHOULDER AND FORESLOPE DRAINING TO A VEGETATED BIOFILTER. THE DITCH FOR EACH VEGETATED BIOFILTER SHALL BE TRAPEZOIDAL, AS SHOWN IN THE PLAN CROSS SECTIONS. PROVIDE ITEM 670 AS SPECIFIED

VEGETATED FILTER STRIP

THIS PLAN UTILIZES VEGETATED FILTER STRIP(S) FOR POST CONSTRUCTION STORM WATER TREATMENT. PLACE EITHER ITEM 660 SODDING OR ITEM 659 SEEDING AND MULCHING WITH A 4-INCH LIFT OF TOPSOIL AND ITEM 670, SLOPE EROSION PROTECTION TO ALL DISTURBED AREAS DESIGNATED AS VEGETATED FILTER STRIPS, THE EDGE OF SHOULDER, AND THE FORESLOPE AS SPECIFIED IN THE PLANS.

OUPS NOTE

WHEN THE PROJECT BEGINS AND THE CONTRACTOR HAS TAKEN OVER THE MAINTENANCE OF THE EXISTING SYSTEM, THEY SHALL PROVIDE ALL REQUIRED LAYOUTS AND LOCATIONS OF ODOT'S EXISTING AND PROPOSED ELECTRICAL CIRCUITS WITHIN THE PROJECT LIMITS. THE CONTRACTOR SHALL LOCATE AND MARK THESE UNDERGROUND ELECTRICAL CIRCUITS DURING THE DURATION OF THE PROJECT.

ENVIRONMENTAL COMMITMENT PLAN NOTE

ODOT WILL OBTAIN AND ADHERE TO ALL APPROPRIATE WATERWAY PERMITS PRIOR TO ANY WORK BELOW THE ORDINARY HIGH-WATER MARK OF ANY WATERWAY AND ALL SPECIAL PROVISIONS FOR WATERWAY PERMITS WILL BE INCLUDED IN THE PROJECT PLANS.



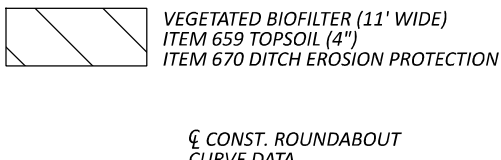

**CONST. ROUNDABOUT
CURVE DATA**
P.I. = STA. 1+70.21
 $\Delta = 70^{\circ}28'08''$ LT
 $D_c = 68^{\circ}12'33''$
 $R = 84.00'$
 $T = 59.33'$
 $L = 103.31'$
 $E = 18.84'$

4 CONST. ROUNDABOUT
 CURVE DATA
 P.I. = STA. 2+96.31
 $\Delta = 109^{\circ}31'52''$ LT
 $D_c = 98^{\circ}47'09''$
 $R = 58.00'$
 $T = 82.12'$ PRECAST RE
 $L = 110.88'$ CONCRETE
 $E = 42.53'$ PER S
 EC-13 CURB

CONST. ROUNDABOUT
CURVE DATA
P.I. = STA. 3+84.40
 $\Delta = 70^\circ 28' 08''$ LT
 $D_c = 68^\circ 12' 33''$
 $R = 84.00'$
 $T = 59.33'$
 $L = 103.31'$
 $E = 18.84'$ CURVE

ITEM 601, TCBM TYPE 2
PER DM-4.1 5.5' x 13.0'
C CURB CUT
Q CONST. TR 68 TH#
CURVE DATA
P.I. = STA. 50+70.40
 $\Delta = 09^{\circ}01'38''$ LT
 $Dc = 57^{\circ}17'45''$
 $R = 100.00'$
 $T = 7.89'$
 $L = 15.76'$
 $E = 0.31'$

Q CONST. TR 68
CURVE DATA
 P.I. = STA. 52+09.12
 $\Delta = 22^\circ 59' 00''$ RT
 $D_c = 11^\circ 27' 33''$
 $R = 500.00'$
 $T = 101.65'$
 $L = 200.57'$
 $E = 10.23'$

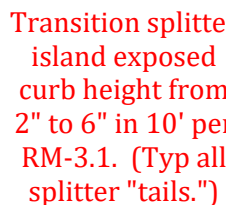

CROSS REFERENCES	
SHEET NO.	DESCRIPTION
P.23 - P.24	ROADWAY PROFILE
P.16 - P.18	ESTIMATED QUANTITIES
P.59 - P.60	DRIVE DETAILS
P.83 - P.89	CULVERT DETAIL AND QUANTITIES
P.55	INTERSECTION DETAIL
P.61	STORM SEWER PROFILES
P.62 - P.63	ROUNDABOUT GEOMETRY DETAILS
P.64 - P.65	EDGE OF PAVEMENT PROFILES
P.66	TEST HOLE DETAILS

NOTE 1:
**AEP TRANSMISSION 69 kV LINE WITH AN ATTACHED
12,470 VOLT OHIO EDISON DISTRIBUTION TO REMAIN
IN PLACE THROUGHOUT PROJECT**

Centralize signs.
Co-mount if possible.
Post immediately
adjacent if unable to
co-mount. (typ all)

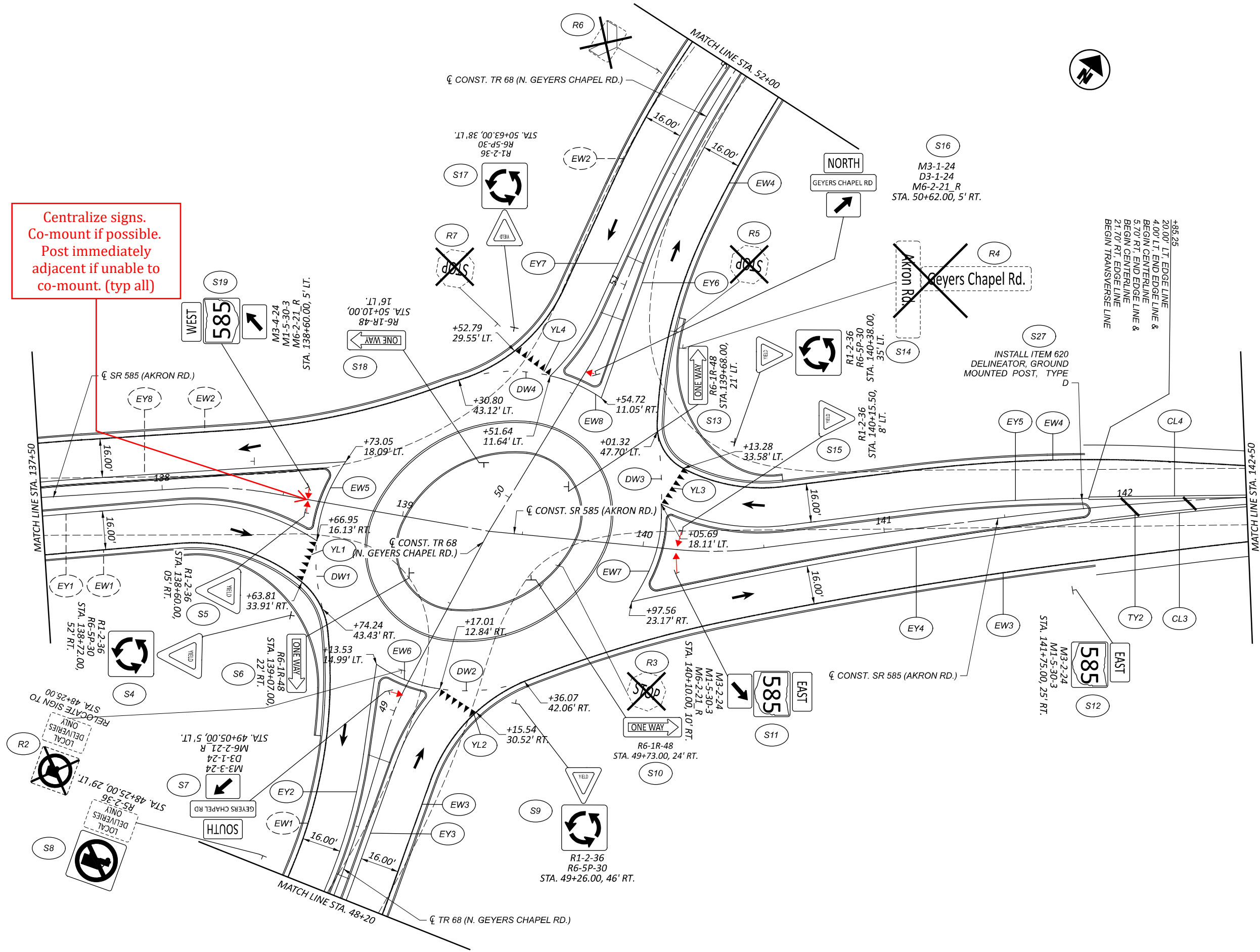

TRAFFIC CONTROL PLAN - ROUNDABOUT

SR 585 STA. 137+50.00 TO STA. 142+50.00, TR 68 STA. 48+20.00 TO STA. 52+00.00

DESIGN AGENCY

Mead
& Hunt

CLIENT

DESIGNER

LNB

REVIEWER

DLW 01/13/25

PROJECT ID

118336

SHEET

P.70

TOTAL

93

HORIZONTAL
SCALE IN FEET

0 20 40