

O.D.O.T. DISTRICT 2 SURVEY OFFICE (USE ONLY)

PERSONNEL \_\_\_\_\_ REFERENCE NO. 5 SHEET 7 OF 27  
 NOTES HOMAN DATE 11/25/12 ROUTE SR 357  
 H.C. HOMAN WEATHER PTLY CLOUDY COUNTY OTTAWA  
 R.C. ROUSOS TEMP. 53° SOUTH BASS  
 \_\_\_\_\_ ISLAND

DWG BY RHOADES PID 25525

TYPE MONUMENT P.K.NAIL

ON SURFACE - ~~BELOW~~ ON

OFFSET 0.8' ~~±~~ : RT

8.4' TO RT EDGE PAVEMENT

STATION: 85+10.55

HORIZ.DATUM: NAD 1983 GEOID: 2003

GRID: NORTHING: 725579.514 EASTING: 1884804.753



RECORD:  
 FD P.K.NAIL  
 RSV143  
 9/20/07, RGN  
 POINT RECOVERED  
 RSV143  
 9/25/12  
 SET MAG/WASHER  
 11/25/12, DCH

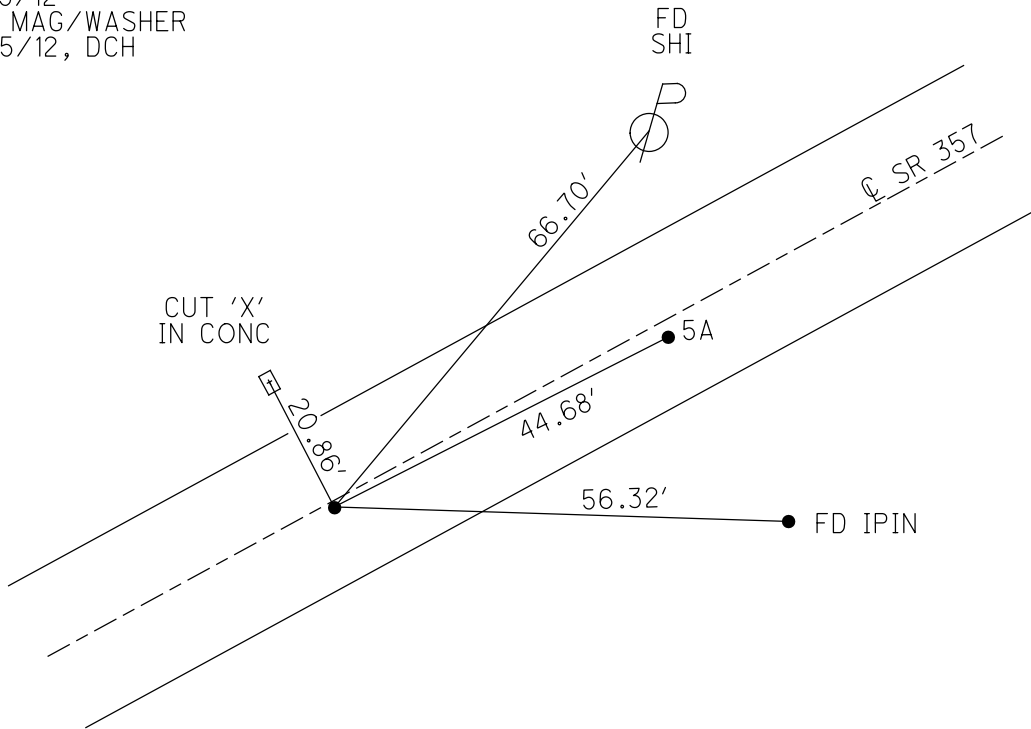

O.D.O.T. DISTRICT 2 SURVEY OFFICE

PERSONNEL

REFERENCE NO. \_\_\_\_\_

SHEET \_\_\_\_\_ OF \_\_\_\_\_

NOTES Huss

H.C. Ryan

R.C. Huss

DATE 9-20-07

WEATHER \_\_\_\_\_

TEMP. \_\_\_\_\_

ROUTE 357

COUNTY \_\_\_\_\_

TOWNSHIP \_\_\_\_\_

SECTION \_\_\_\_\_

T \_\_\_\_\_ R \_\_\_\_\_

TYPE MONUMENT A PK  
B PK

ON SURFACE - BELOW Surf

LEFT - PAV'T. - RIGHT 8.8'

8.4' TO 8.25' RT. EDGE PAVEMENT

S.L.M. \_\_\_\_\_

