

*R/W checked  
easements obtained  
JES  
3/24/64*

S.H. 199 SEC. TIFFIN (Pt.) & E (Pt.)  
SENECA COUNTY  
R/W PLANS

STATE OF OHIO  
DEPARTMENT OF HIGHWAYS  
S.H. 199 SEC. TIFFIN (Pt.) & E (Pt.)  
RIGHT-OF-WAY PLANS  
SENECA COUNTY

R/100  
3  
G-4

CLINTON TWP. SEC. 29  
T2N. R15E

CITY OF  
TIFFIN

AGNES S. HANSON

ALLEN & GRACE BARNES

ERVIN J. & VERNA FIEGELIST

DORA B. SWARTZMILLER  
Lillian S. Delavan  
Frances D. Schieber  
L.L. Knowlton  
C.M. & L.K. Day  
John F. Bond

Phillip Q. Freeman  
Margaret A. Freeman

LOT NO. 1  
LOT NO. 2  
LOT NO. 3  
LOT NO. 4

Sign Board

STATION 0+597.21  
S.H. 199 SEC. TIFFIN (PT)  
BEGINNING OF PROJECT

STATION 0+00  
END OF SEC. TIFFIN (PT)  
BEGINNING OF SEC. E (PT)

IDA M. & WILLIAM H. HOPPLE

CITIZEN'S HOSPITAL & ORPHAN ASYLUM

Mother Fabian, Mother Superior  
TIFFIN, OHIO.

CLINTON TWP. SEC. 29  
T2N. R15E

CLINTON TWP. SEC. 29  
T2N. R15E

CLINTON TWP. SEC. 32

ERVIN J. & VERNA FIEGELIST

R.F.D. #1  
Tiffin, Ohio

OLGA H. DANIELS

450 So. Washington St.  
Tiffin, Ohio.

CITIZEN'S HOSPITAL & ORPHAN ASYLUM

Mother Fabian, Mother Superior  
TIFFIN, OHIO.

PEARL B. DEPPEN

R.F.D. #1  
TIFFIN, O.

RANSON J. HIGGINS

R.F.D. #1  
TIFFIN, OHIO

CLINTON TWP. SEC. 29  
T2N. R15E.

CLINTON TWP. SEC. 32  
T2N. R15E.

Revised: 12-26-35 S.G.R.  
1-15-36 S.G.R.

Surveyed July 1907

End Sheet Sta. 4+50

End Sheet Sta. 20+50

CLINTON TWP SEC. 32  
T2N. R15E.

6  
**OLGA H. DANIELS**  
450 So. Washington St.  
Tiffin, Ohio.

7  
**FRANCE**  
1800 Second Nat'l Bank Bldg.  
Toledo, Ohio.

STONE CO.

5  
**RANSON J. HIGGINS**  
R.F.D. #1  
Tiffin, Ohio.

8  
**MAMIE E. GILLIG**  
R.F.D. #1  
Tiffin, Ohio.

FOR TREE TABLE  
SEE SHEET NO.

CLINTON TWP SEC. 32  
T2N R15E

CLINTON TWP SEC. 32  
T2N R15E.

7  
**THE FRANCE STONE CO.**  
1800 Second Nat'l. Bank Bldg.  
Toledo, Ohio.

9  
**GORDON & CLARA BUTON**  
228 Wentz Street  
Tiffin, Ohio.

11  
**MARY HORN  
LENHART**

8  
**MAMIE E. GILLIG**  
R.F.D. #1  
Tiffin, Ohio.

10  
**C. THERESA & BENJAMIN PITTINGER**  
174 Malmore Street  
Tiffin, Ohio.

CLINTON TWP SEC. 32  
T2N R15E.

Revised 12-26-35 J.G.R.  
1-15-36 J.G.R.

Created  
July 1947

Sta. 20+50  
Begin Sheet

Sta. 36+50  
End Sheet

Sta. 36+50  
Begin Sheet

Sta. 52+50  
End Sheet

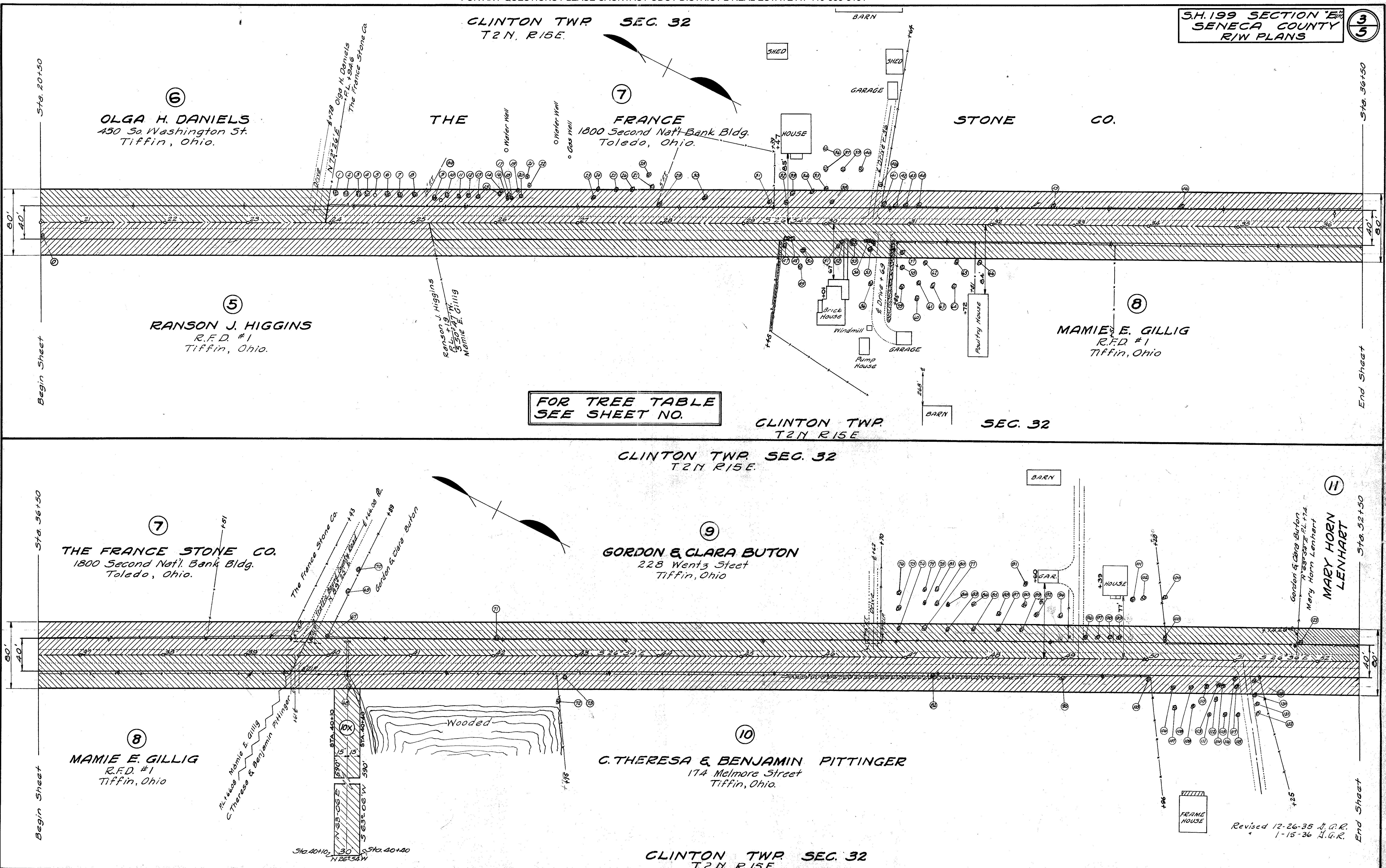



CLINTON TWP SEC. 32  
T2N. R15E.

EDEN TWP SEC. 4  
T1N. R15E.

S.H. 199 SECTION E<sup>th</sup>  
SENECA COUNTY  
R/W PLANS

5  
5

11  
**MARY HORN LENHART**  
205 Dryden Road  
Zanesville, Ohio.

Note: Curve widening on 172.01 Rad.  
established for S.H. 272 Fed. Proj.  
No. 493-A. Purchased in 1927.

15  
**SENECA COUNTY COMMISSIONERS,  
COURT HOUSE,  
TIFFIN, OHIO.**

13  
**EVANGELINE MOORE**  
80 Hunter St.  
Tiffin, Ohio.

14  
**SENECA COUNTY COMMISSIONERS  
COURT HOUSE  
TIFFIN, OHIO.**

CLINTON TWP SEC. 32  
T2N. R15E.

EDEN TWP SEC. 5  
T1N. R15E.

EDEN TWP SEC. 4  
T1N. R15E.

EDEN TW. SEC. 5  
T1N. R15E.

NOTICE  
G.K. Gahr's  
Section Line  
Seneca County Commissioners

14  
**SENECA COUNTY COMMISSIONERS  
COURT HOUSE  
TIFFIN, OHIO.**

EDEN TWP SEC. 5  
T1N. R15E.

EDEN TWP SEC. 4  
T1N. R15E.

Revised 12-26-35 A.G.R.  
1-15-36 S.A.R.

STATION 71+0744  
S.H. 199 SEC. E. (PT)  
END OF PROJECT.

