

O.D.O.T. DISTRICT 2 SURVEY OFFICE (USE ONLY)

PERSONNEL \_\_\_\_\_ REFERENCE NO. 93 SHEET 12 OF 13  
 NOTES WESTFALL DATE 10-21-13 ROUTE SR 105  
 H.C. LEU WEATHER PTLY CLOUDY COUNTY WOOD  
 R.C. WESTFALL TEMP. 53°F TOWNSHIP FREEDOM  
 \_\_\_\_\_ SECTION 1  
 \_\_\_\_\_ T 5 N R 12 E

TYPE MONUMENT PK NAIL/WASHER  
 ON SURFACE - ~~BELOW~~ ON \_\_\_\_\_  
 LEFT - ☉ PAV'T - ~~RIGHT~~ 5.0'  
4.3' TO LT EDGE PAVEMENT  
 S.L.M. 628+02.48  
 Grid: Northing: 641897.3109 Easting: 1716439.1301

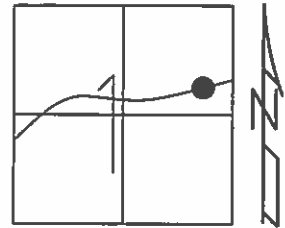

RECORD: STA 631+83.40  
 P.I. 84  
 $\Delta=7^{\circ}02'00''$   
 SET PK/WASHER  
 11-17-94, MRC  
 PREVENTIVE MAINTENANCE  
 CHIP & SEAL 2004  
 EXISTING POINT UNCOVERD  
 08-10-04, MC

FD. PK  
 GPS, REF93  
 10-21-13, RJL

GPS, REF93  
 7-27-15, JFO

SET MAG/WASHER  
 GPS, NEWREF93  
 9-7-16, JFO

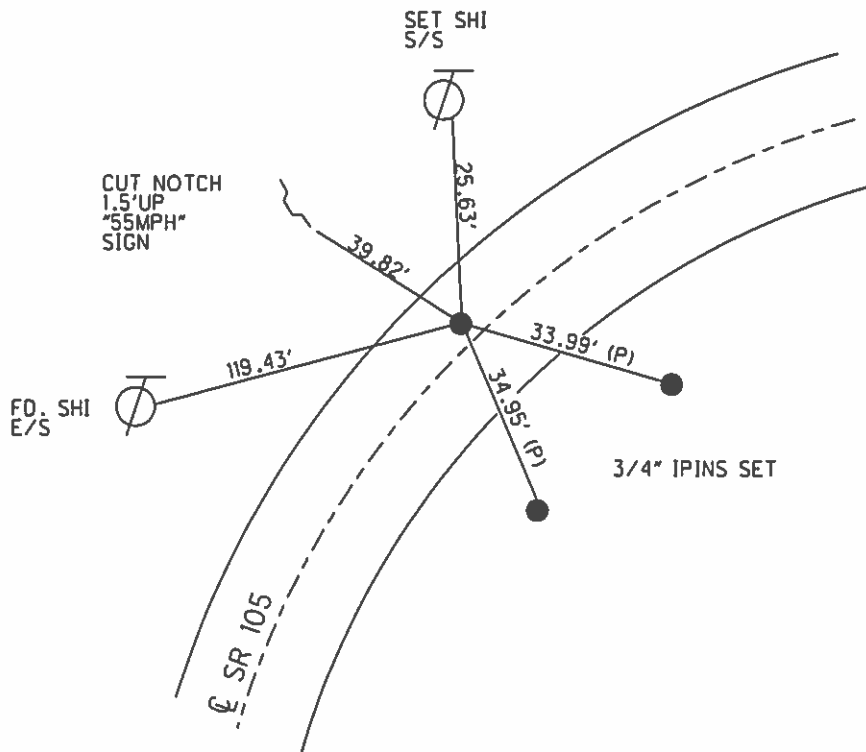

# O.D.O.T. DISTRICT 2 SURVEY OFFICE

PERSONNEL

REFERENCE NO. 93

SHEET 49 OF 49

NOTES CHANEY

H.C. RIPPLE

R.C. BARBOUR

DATE 8-8-94

WEATHER FAIR

TEMP. +72°

ROUTE S.R. 105

COUNTY WOOD

TOWNSHIP FREEDOM

SECTION 1

T 5 N R 12 E

TYPE MONUMENT PK NAIL / WASHER

ON SURFACE - BELOW ON SURFACE

LEFT - Q PAV'T. - RIGHT 5.0' LT. of Q

4.3' TO LT EDGE PAVEMENT

S.L.M. 629 + 97

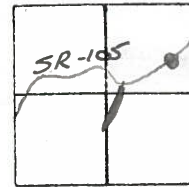

RECORD: STA 631 + 83.40 P.I. #84

$\Delta = 7^{\circ} - 02'' - 00''$  RT.

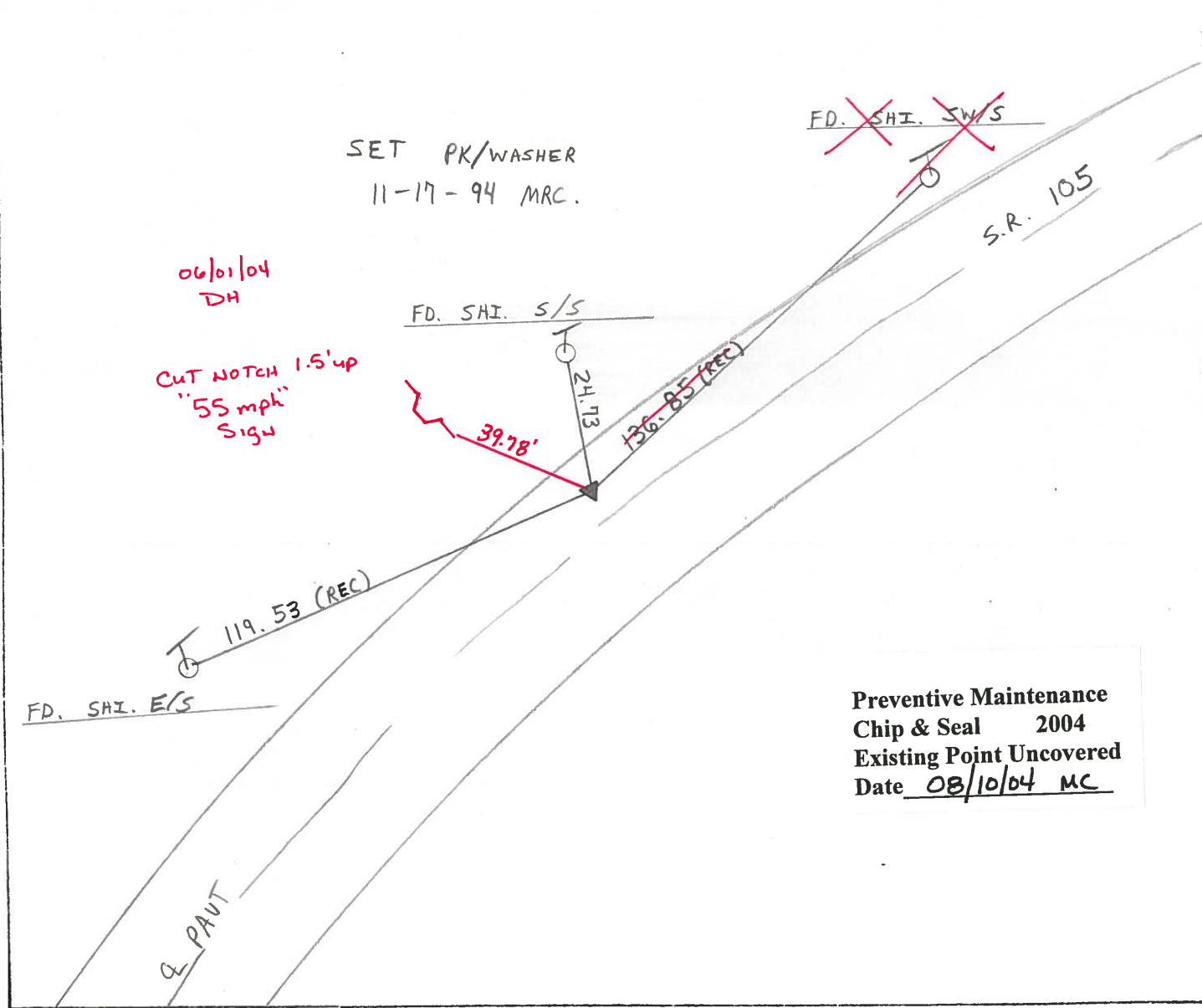

Preventive Maintenance  
 Chip & Seal 2004  
 Existing Point Uncovered  
 Date 08/10/04 MC

County WOOD S.R. 105

Date 8-10-84

Township FREEDOM

Weather PE CLOUDY

Section 1

Temp. +84

TSN, RIZE

Personnel BARNY HC

HOUSCHOLDER RL

LOEHRKE TD

HOFFMAN P

# 93

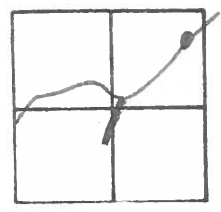

RECORD  
 631 + 83.40  
 P.I. #84  
 Δ = 7°-02" Rt

Fd: Sm P.K. NAIL @ SURFACE

5.4 LEP

13.9 REP

SET PK + WASHER

1.8 LP of Q PAINT

10-4-84 SWH.

SLM = 627 + 88

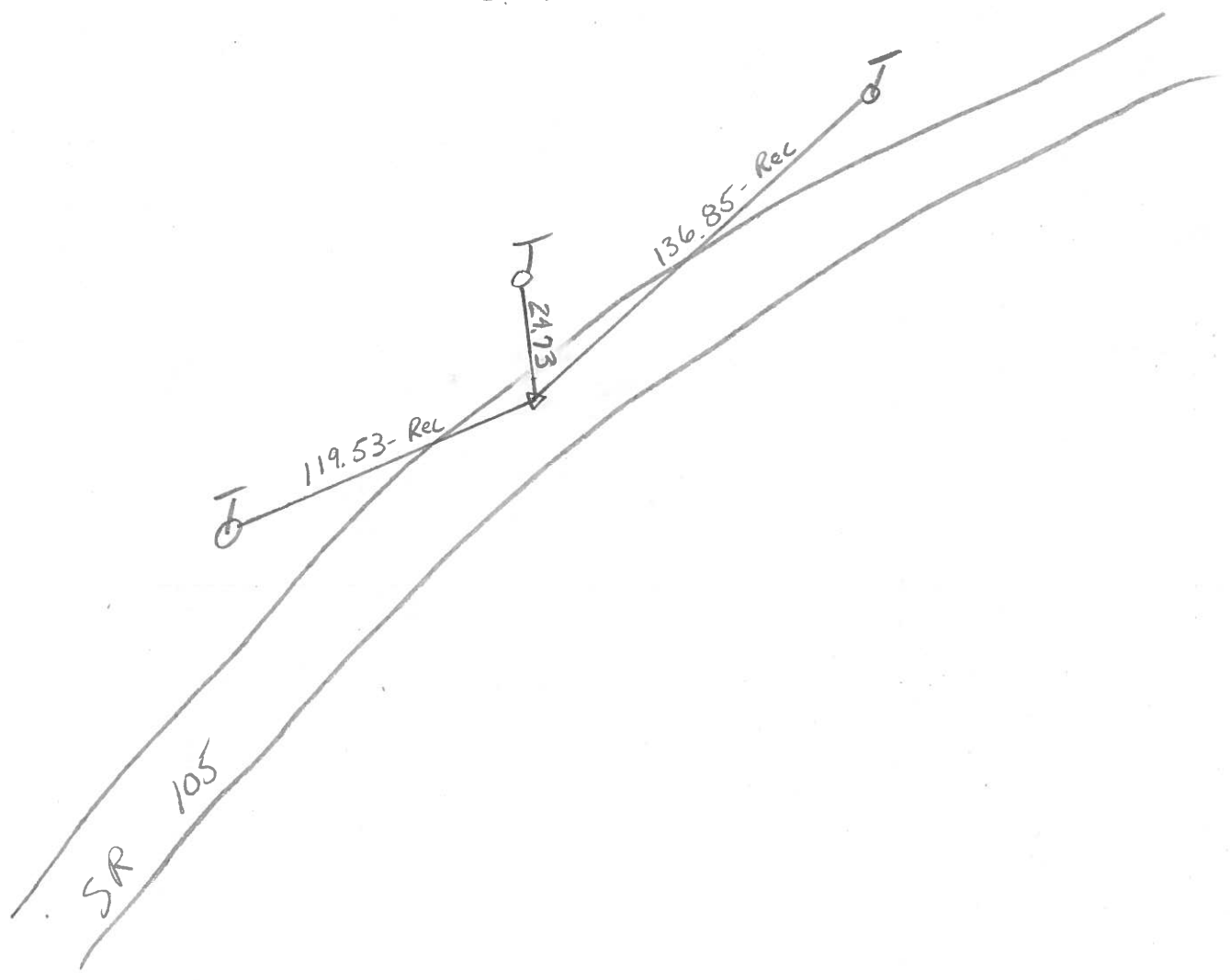

PERSONNEL TITLE PERSONNEL TITLE

COUNTY Wood DATE Mar 12, '74

Stone \_\_\_\_\_

S. R. 105 WEATHER cold

Denno \_\_\_\_\_

SEC. \_\_\_\_\_ TEMP. 34°

Curtis \_\_\_\_\_

DESCRIPTION References To Control Points JOB NO. \_\_\_\_\_

