

O.D.O.T. DISTRICT 2 SURVEY OFFICE (USE ONLY)

PERSONNEL

REFERENCE NO. 7

SHEET 9 OF 15

NOTES NIESE

DATE 2/10/23

ROUTE SR 281

H.C. AUBLE

WEATHER MISTY

COUNTY WOOD

R.C. MILLER

TEMP. 39°

TOWNSHIP MILTON

SECTION 21

DWG BY RHOADES PID CHIP SEAL

T 4 N R 9 E

TYPE MONUMENT MAG SHANK

~~ON SURFACE~~ - BELOW 1/2"

OFFSET \odot PAVEMENT 7.3' LT : ~~RT~~

3' TO LT EDGE PAVEMENT

STATION: 133+43

HORZ.DATUM: NAD83 2011

GEOID: NAVD88 2018

GRID: NORTHING: 592265.677

EASTING: 1601844.883

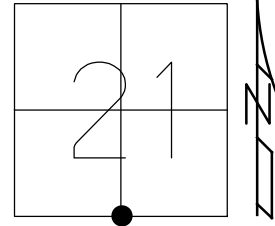

RECORD:
 $\Delta = 01^\circ 51' RT$
 FD P.K./WASHER
 5/23/90, MB
 SET P.K./WASHER
 7/2/90, MB
 FD P.K./WASHER
 7/2/12, DCH
 SET MAG/WASHER
 NEWREF7
 9/24/12, DCH
 FD MAG SHANK
 REF7
 7/15/22, DSA
 2/10/23, TDN

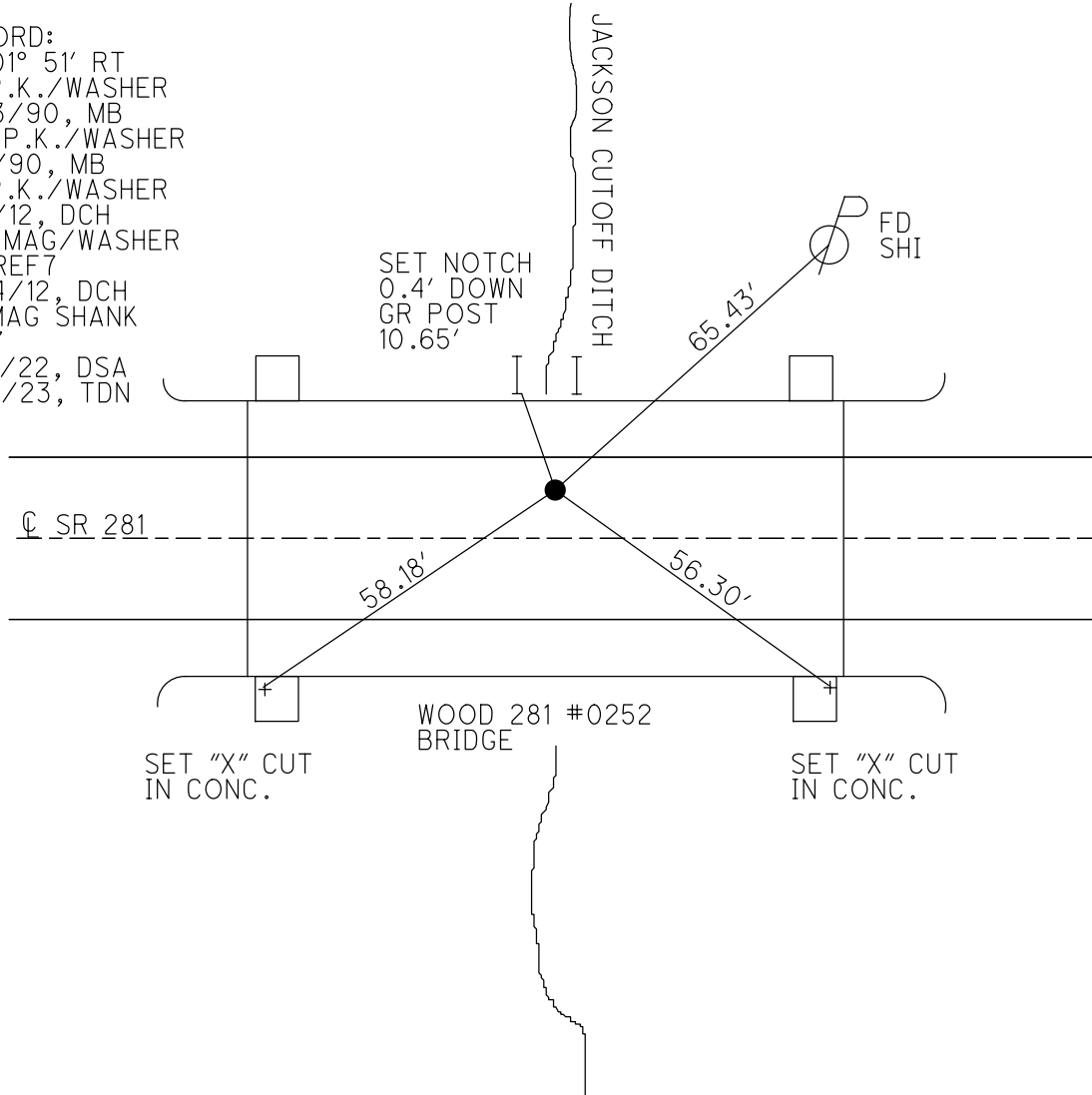

O.D.O.T. DISTRICT 2 SURVEY OFFICE (USE ONLY)

PERSONNEL _____ REFERENCE NO. 7 SHEET 9 OF 15
 NOTES HOMAN DATE 7/3/12 ROUTE SR 281
 H.C. ROUSOS WEATHER CLOUDY COUNTY WOOD
 R.C. COUTCHER TEMP. 70° TOWNSHIP MILTON
HARBAUGH SECTION 21
T 4 N R 9 E

TYPE MONUMENT P.K./WASHER
 ON SURFACE - ~~BELOW~~ ON _____
 LEFT - ☉ PAV'T - ~~RIGHT~~ 7.3'
3.0' TO LT EDGE PAVEMENT
 S.L.M. 133+43

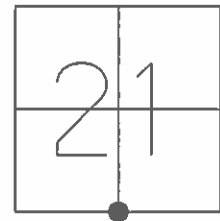

GRID: NORTHING: 592265.681 EASTING: 1601844.820

RECORD:
 $\Delta = 01^\circ 51' RT$

FD P.K./WASHER
 5/23/90, MB

SET P.K./WASHER
 7/2/90, MB

FD P.K./WASHER
 7/2/12, DCH

SET MAG/WASHER
 WITH GPS, NEWREF7
 ALL TIES WERE REPLACED
 9/24/12, DCH

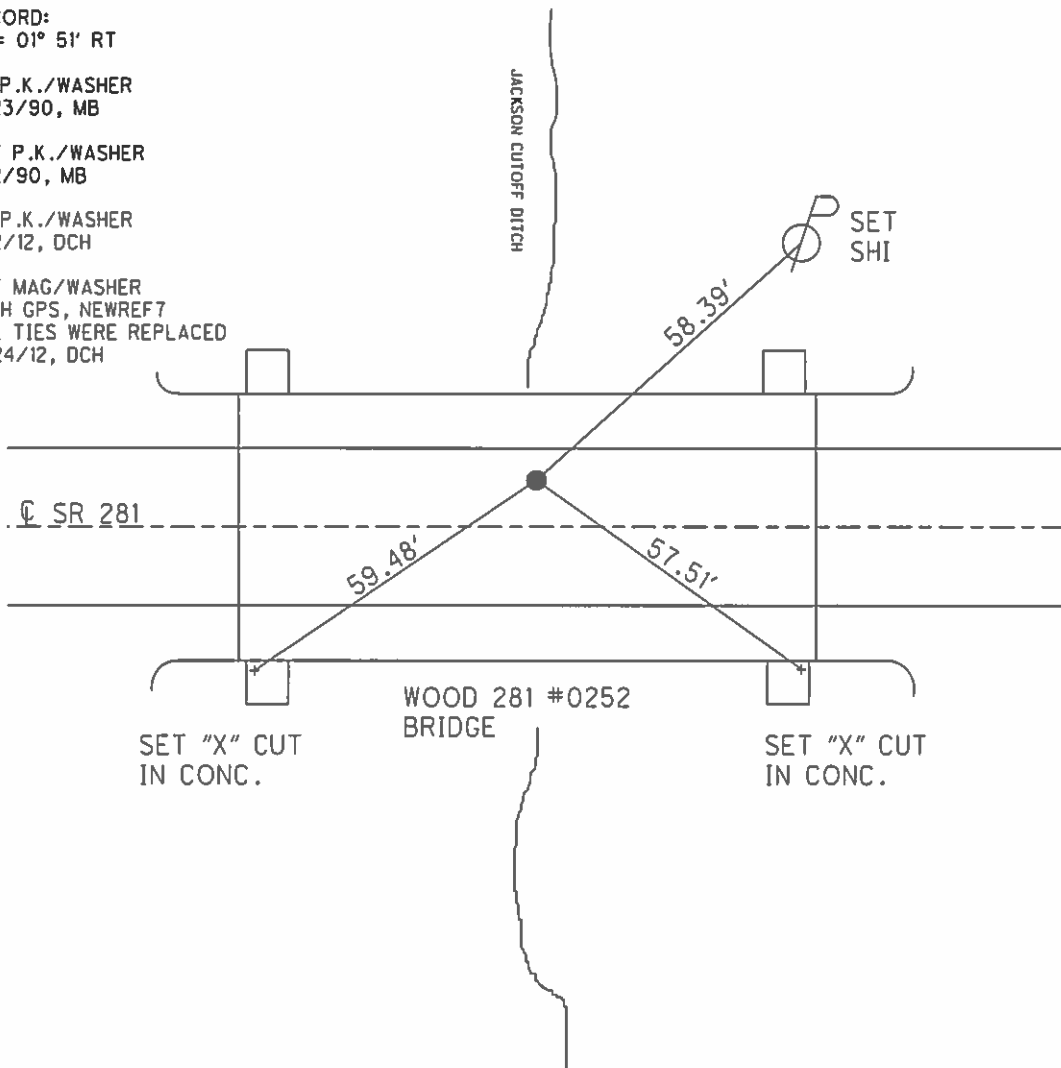

O.D.O.T. DISTRICT 2 SURVEY OFFICE

PERSONNEL _____

REFERENCE NO. 7

SHEET _____ OF _____

NOTES BARNHISEL

H.C. " "

DATE 5-23-90

ROUTE 281

R.C. HOFFMAN

WEATHER SUNNY

COUNTY Wood

TEMP. +65°

TOWNSHIP Milton

SECTION 21

T4N R9E

TYPE MONUMENT P.K. & Washer

ON SURFACE - ~~BELOW~~ yes

LEFT-~~C~~ PAV'T. - RIGHT 7.3

3.0 TO LT EDGE PAVEMENT

S.L.M. 133+43

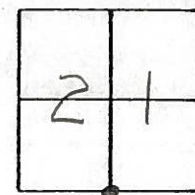

Record
 ~~$\Delta = 10^\circ 51' RT$~~

Set P.K. & Washer
7-2-90
mB

$\Delta = 10^\circ 51' RT$

Cut "x" ON FACE OF I-BEAM POST FOR GUARD RAIL

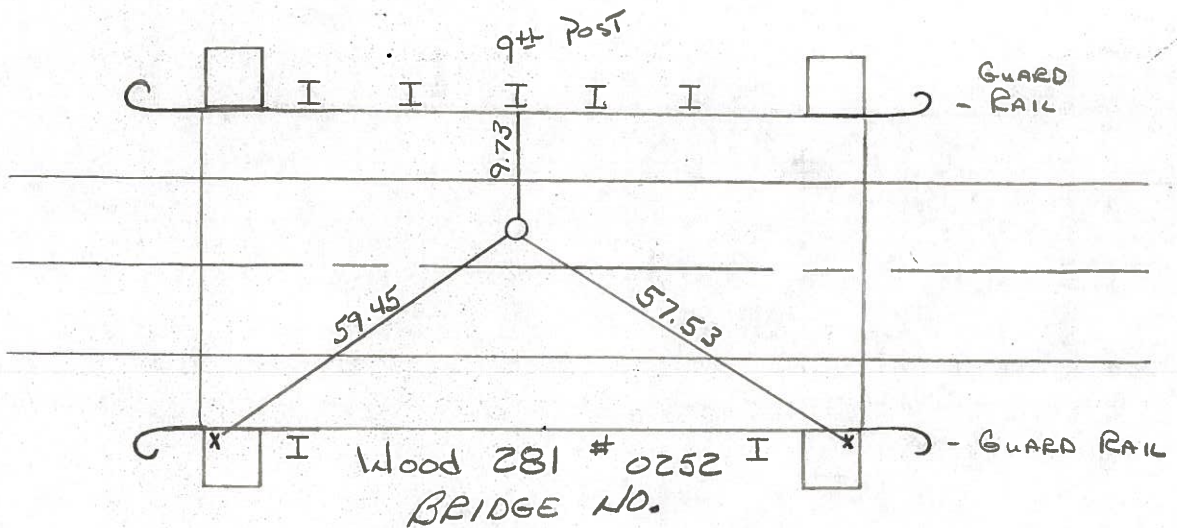

Fd "x" CUT ON CONC IN BOTH CORNERS
OF THE BRIDGE SYS

Q.D.O.T. DISTRICT 2 SURVEY OFFICE

Sht. ___ of ___

County Wood S.R. 281

Date 5-20-81
OK-7-27-82 - 75° - S.W.H.

Township MILTON

Weather Clear

Section 21

Temp. 60°

T4N, R9E

Personnel S Hoffman

C. Loehrke

L. Householder

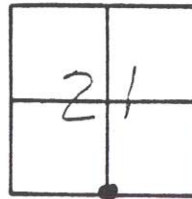

#7

NOTE: POINT SET ON LINE E
DOUBLE DIST. BETWEEN
POINTS #6 & #6-A

$\Delta = 10 - 51'$ RT.

Fd. SMALL R.R. SPK
7.4' N. OF E PAUT.

.133+43
3.0 TO LT Edge
7.3 LT OF E

SET P.K. & WASHER
8-12-82
S.W.H.

"+" CUT S. FACE of
STEEL POST - 9th STEEL POST FROM W. END
STEEL GUARD RAIL & POSTS

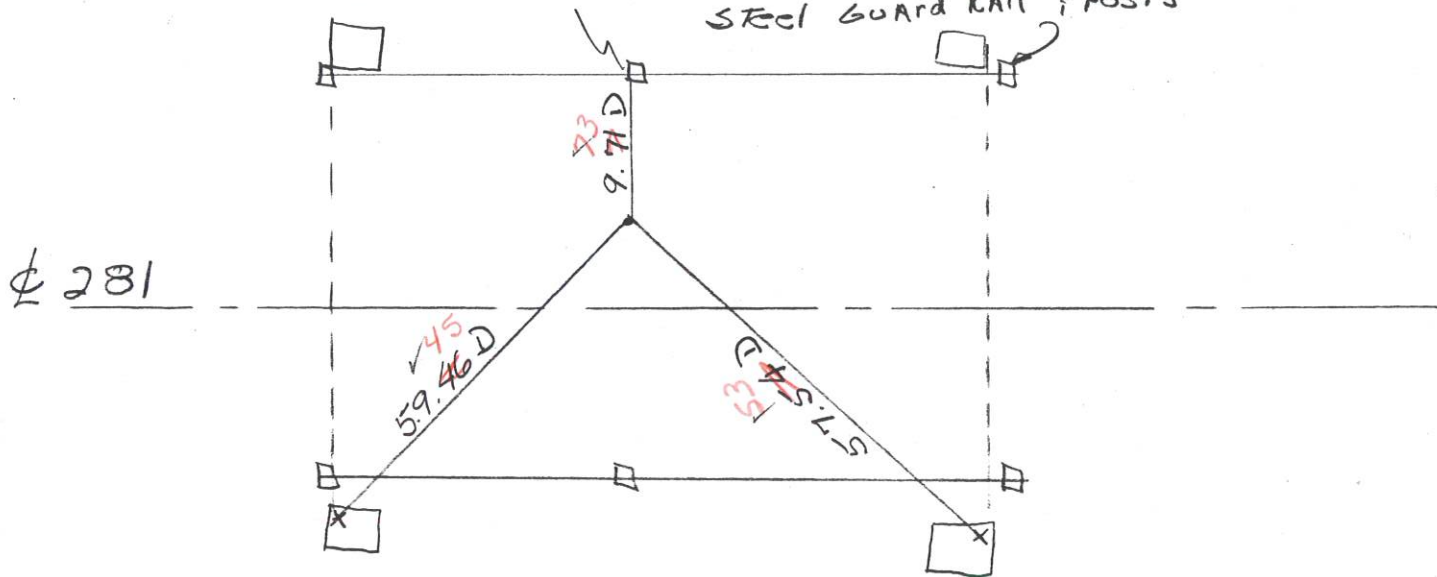

BRIDGE #

WOOD 281 0252

Q.D.O.T. DISTRICT 2 SURVEY OFFICE

Sht. ___ of ___

County Wood S.R. 281

Date 5-20-81 OK-7-27-82 -75°-S.W.H.

Township MILTON

Weather Clear

Section 21

Temp. 60°

T4N, R9E

Personnel S. Hoffmann

C. Loehrke

L. Householder

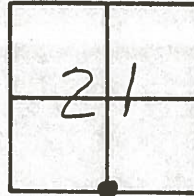

#7

NOTE: POINT SET ON LINE & DOUBLE DIST. BETWEEN POINTS #6 & #6-A

$\Delta = 10-51'$ RT.
Fd. SMALL R.R. SPK.
7.4' N. OF Φ PAVT.

SET P.K. & WASHER
8-12-82
S.W.H.

"+" CUT S. FACE of
STEEL POST - 9th STEEL POST FROM W. END
STEEL GUARD RAIL & POSTS

Φ 281

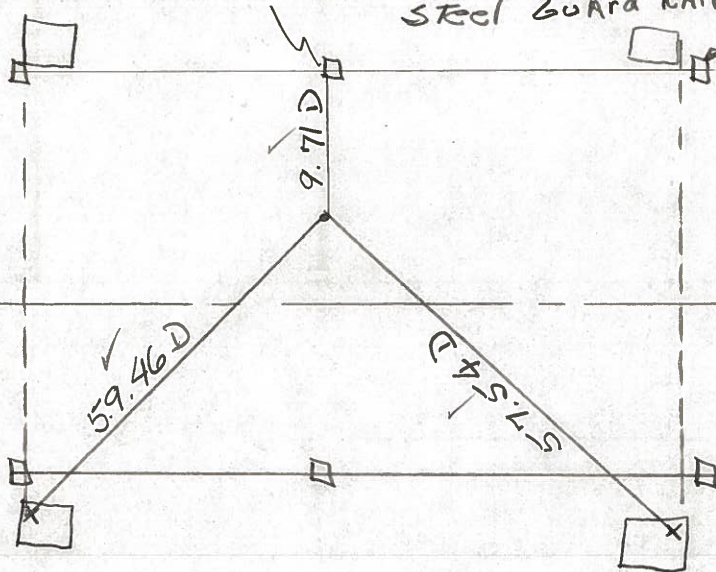

BRIDGE #.

WOOD 281 0252

PERSONNEL TITLE PERSONNEL TITLE

COUNTY Wood

DATE OK 12-4-5

S. R. #281

Swoeben 3-22-6
Silvester 2-28-6

SEC.

TEMP.

DESCRIPTION

LEFT

CENTER LINE

RIGHT

JOB NO.

Sta. 120+11.4

S.W. 1/4 post sec. 21 Milton

Twp. Stone Iron pin

$\Delta = 0^{\circ} 16' E$

(Fd. small

R.R. spk)

S.W. Cor. school Fdn. N.W.W.

88.4

X on S.E. cor. walk to school

53.1

S.W. cor. 1st step walk bet. Ch. & sch.

85.1

N.W. cor. block fdn. house S.E.

64.1

N.E. cor. stone fdn. house S.W.

71.1

Shiner in T.P. S.

28.1

6-A

#148-A

S. 1/4 post sec. 21 Milton

Twp. Shi. in Δ of bridge

$\Delta = 1^{\circ} 51' E$

(Gone! new bridge) (Beaver creek)

No

End of bridge

30'

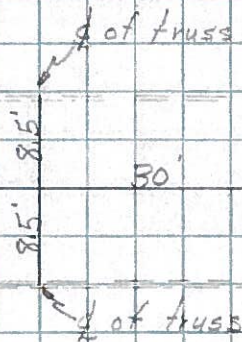

End of bridge

7

#149

Sta. 158+62.0

S.W. Cor. sec. 22 Milton (Fd. P.K.)

Twp. Iron pin

$\Delta = 2^{\circ} - 21\frac{1}{2}' E$ (Milton Rd)

Shiner in P.P. N.W. 40.28

40.2

Shiner in br. pole S.W.

39.1

Shiner in T.P. S.E. 40.47'

40.4

Conc. mon. S.W. (leaning) 49.12'

49.2

8

#150

Sta. 185+28.39

S. 1/4 post Sec. 22 Milton (Fd.)

Twp. Set. R.R. spk.

$\Delta = 0^{\circ} - 18' E$ P.I.

N. To Δ on Top steel Sign Post 51K. 150

S. " " " " " " " " 150

S.S.E. "X" Cut in S end 60" Conc. Pipe. 26.1

E.S.E. Shiner in East Guard Rail Post (Plum be

Shiner Guard Rail Post N. 17.67) 31.1

E.N.E. Shiner in East Guard Rail Post

Shiner Guard Rail Post S.W. 18.22) 32.1

N.N.E. "X" Cut in North end 60" Conc. Pip

plumbed 27.8

S.E. "V" Near Top Retaining Wall (Plum be

9

#151

31.02 Shiner in Guard Rail Post S.E.

32.30 " " " " " " N.E.