

TOWN 6 NORTH RANGE 10 EAST

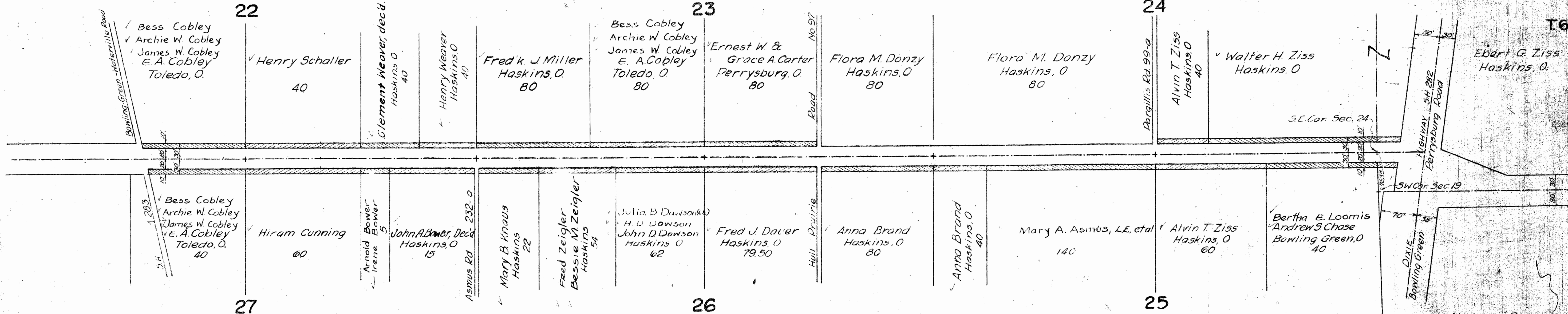

SCALE E & W 1"=600'
SCALE N & S 1"=100'

DESCRIPTION OF LAND DEDICATED

The North 10 Feet of the South 30 Feet of Sec. 22 East of SH 283, the North 10 Feet of the South 30 Feet of Sections 23 and 24, the South 10 Feet of the North 30 Feet of Sec. 27 East of SH 283, the South 10 Feet of the North 30 Feet of Sections 26 and 25, all in Town 6 North, Range 10 East; the North 10 Feet of the South 106.35 Feet and the North 10 Feet of the South 56.35 Feet of Section 19, T.6 N., R.11 E., West of SH 282. Parcels shown thus:

We, the undersigned, owners of the above described property hereby dedicate the same to public use for road and other public purposes consistent therewith clear of all obstructions which interfere with the improvement and/or maintenance of the highway.

County of Wood } ss
State of Ohio }

On or about December 7, 1938 before me the County Engineer for said county, personally appeared the following: - Walter H. Ziss, Alvin T. Ziss, Fred'k J. Miller, Bertha E. Loomis, Andrew S. Chase, Julia Ryder, daughter of Clement Weaver, decd, Gordon Bower, Arnold Bower, Fred J. Dauer, Ernest W. Carter, Grace A. Carter, Anna Brand, Irene Bower, Mrs. Cora Bower, Fred Zeigler, John Dudley Dawson, Mrs. Bessie Zeigler, Mary B. Knauss, Henry Weaver, Bess Cobby, Archie W. Cobby, James W. Cobby, E. A. Cobby, Hiram Cunning, Mary A. Asmus, Henry Schaller, who acknowledged the signing of this plat to be their voluntary act and deed for the purposes hereon mentioned. Witness my hand and seal this 7th day of Dec. 1938

E. F. Metzger
County Engineer, Wood Co., Ohio

APPROVED AS TO OWNERS this 12th day of December 1938
RECORDED in Vol. _____ Page _____ of Wood County Road Record this _____ day of _____ 1938

C. L. Felger
County Auditor

OFFICE OF THE COUNTY COMMISSIONERS
WOOD COUNTY, BOWLING GREEN, OHIO.
This PLAT has been approved and accepted by us this 12th day of December 1938.

E. F. Metzger
John F. Grobe
R. H. Eckert
Board of County Commissioners.

APPROVED and ACCEPTED by me this 13th day of December 1938
E. F. Metzger
County Engineer

| OWNERS | WITNESS | WITNESS |
|---|------------------|-----------------------|
| Walter H. Ziss | Paul A. Dunipace | E. F. Metzger |
| Alvin T. Ziss | Paul A. Dunipace | E. F. Metzger |
| Fred'k J. Miller | Walter H. Ziss | E. F. Metzger |
| Bertha E. Loomis | Paul A. Dunipace | E. F. Metzger |
| Julia Ryder, daughter of Clement Weaver | Paul A. Dunipace | Wayne Wilkinson |
| Gordon Bower | Paul A. Dunipace | E. F. Metzger |
| Arnold Bower | Paul A. Dunipace | E. F. Metzger |
| Fred J. Dauer | Paul A. Dunipace | E. F. Metzger |
| Ernest W. Carter | Paul A. Dunipace | E. F. Metzger |
| Grace A. Carter | Paul A. Dunipace | E. F. Metzger |
| Anna Brand | Paul A. Dunipace | E. F. Metzger |
| Irene Bower | Paul A. Dunipace | E. F. Metzger |
| Mrs. Cora Bower | Paul A. Dunipace | E. F. Metzger |
| Fred Zeigler | Paul A. Dunipace | E. F. Metzger |
| Bessie M. Zeigler | Paul A. Dunipace | E. F. Metzger |
| John Dudley Dawson | Paul A. Dunipace | R. H. Eckert |
| Mrs. Bessie Zeigler | Paul A. Dunipace | R. H. Eckert |
| Mary B. Knauss | Paul A. Dunipace | Lucy E. Knauss |
| Henry Weaver | Walter H. Ziss | E. F. Metzger |
| Bess Cobby | Paul A. Dunipace | Arthur W. Keple, N.P. |
| Archie W. Cobby | Paul A. Dunipace | Mary E. Dunipace |
| James W. Cobby | Paul A. Dunipace | Arthur W. Keple, N.P. |
| E. A. Cobby | Paul A. Dunipace | Mary E. Dunipace |
| Hiram Cunning | Paul A. Dunipace | E. F. Metzger |
| Mary A. Asmus | Paul A. Dunipace | Wayne Wilkinson |
| Henry Schaller | Paul A. Dunipace | E. F. Metzger |

DEDICATION PLAT
HASKINS - DUNBRIDGE ROAD No 20-A (PT) & B
FROM BOWLING GREEN-WATERVILLE RD (SH 283) TO DIXIE HWY (SH 282)
OFFICE OF E. F. METZGER, COUNTY ENGINEER
By J. M. Berry DEPUTY

MIDDLE TOWN TWP. TOWN 6 NORTH RANGE 10 EAST

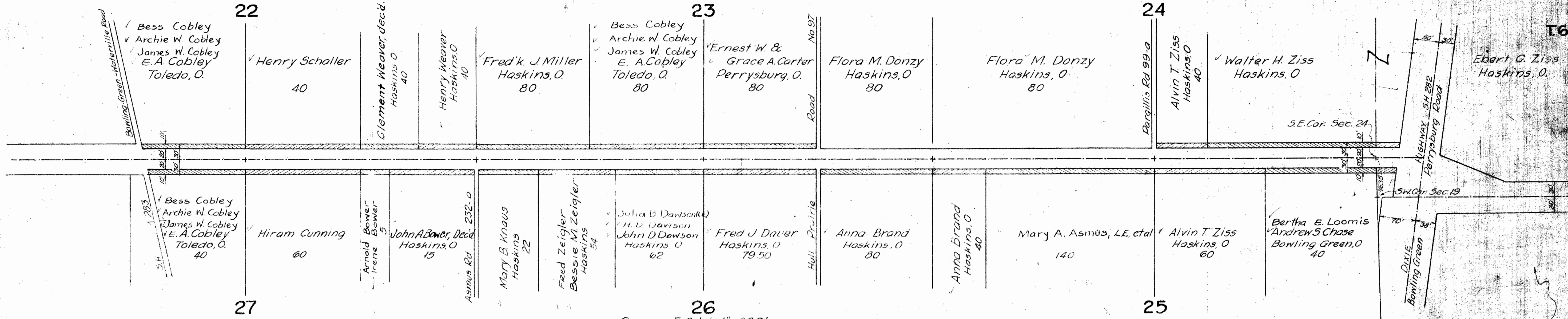

SCALE E & W 1"=600'
SCALE N & S 1"=100'

DESCRIPTION OF LAND DEDICATED

The North 10 Feet of the South 30 Feet of Sec 22 East of SH 283, the North 10 Feet of the South 30 Feet of Sections 23 and 24, the South 10 Feet of the North 30 Feet of Sec. 27 East of SH 283, the South 10 Feet of the North 30 Feet of Sections 26 and 25, all in Town 6 North, Range 10 East; the North 10 Feet of the South 106.35 Feet and the North 10 Feet of the South 56.35 Feet of Section 19, T.6 N., R.11 E., West of SH 282. Parcels shown thus: [hatched symbol]

We, the undersigned, owners of the above described property hereby dedicate the same to public use for road and other public purposes consistent therewith clear of all obstructions which interfere with the improvement and/or maintenance of the highway.

County of Wood } 55
State of Ohio

On or about December 7, 1938 before me the County Engineer for said county, personally appeared the following: - Walter H. Ziss, Alvin T. Ziss, Fredk J. Miller, Bertha E. Loomis, Andrew S. Chase, Julia Ryder, daughter of Clement Weaver, decd, Gordon Bower, Arnold Bower, Fred J. Dauer, Ernest W. Carter, Grace A. Carter, Anna Brand, Irene Bower, Mrs. Cora Bower, Fred Zeigler, John Duitley Dawson, Mrs. Bessie Zeigler, Mary B. Knauss, Henry Weaver, Bess Cobley, Archie W. Cobley, James W. Cobley, E. A. Cobley, Hiram Cunning, Mary A. Asmus, Henry Schaller, who acknowledged the signing of this plat to be their voluntary act and deed for the purposes hereon mentioned. Witness my hand and seal this 7th day of Dec. 1938

E. F. Metzger
County Engineer, Wood Co., Ohio

APPROVED AS TO OWNERS this 12th day of December 1938

RECORDED in Vol. _____ Page _____ of Wood County Road Record this _____ day of _____ 1938

C. L. Felton
County Auditor

OFFICE OF THE COUNTY COMMISSIONERS
WOOD COUNTY, BOWLING GREEN, OHIO.
This PLAT has been approved and accepted by us this 12th day of December 1938

[Signatures]
Board of County Commissioners.

APPROVED and ACCEPTED by me this 13th day of December 1938

E. F. Metzger
County Engineer

DEDICATION PLAT
HASKINS ~ DUNBRIDGE ROAD No 20-A (PT) & B
FROM BOWLING GREEN-WATERVILLE RD (SH 283) TO DIXIE HWY (SH 282)
OFFICE OF E. F. METZGER, COUNTY ENGINEER
BY J. M. BERRY DEPUTY

State of W. Virginia }
County of Brooke }
Mary B. Knauss
Henry Weaver
Bess Cobley
Archie W. Cobley
James W. Cobley
E. A. Cobley
Hiram Cunning
Mary A. Asmus
Henry Schaller

R-5582
718