

North East quarter Sec 30 Town 16 Range 18
 Benjamin Helms and Benjamin Griffith the joint owners

North East quarter Sec 30 Town 16 Range 18

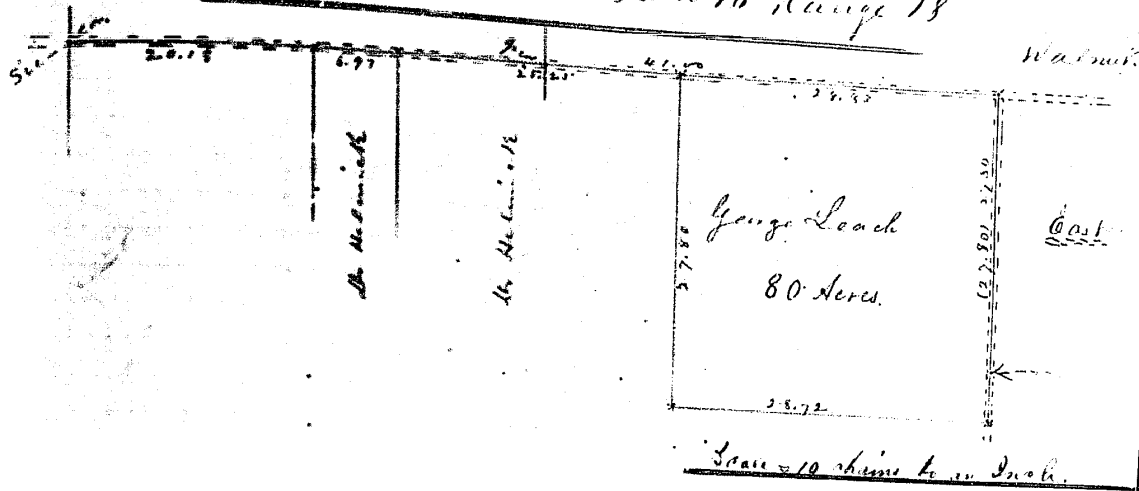

Course	Distance		Remarks
	Old	New	
West	28	83	Begun at the South East corner of Section 30 Stone at Cross Roads Thence West on 95° 11' 28" W
	11		Temporary stake for corner between Helms & Smith at old line, Intersected to line South of 95.1128 corner old Stone in Road. Returned to 28.83 old stake connected on true line set Stone up 50 lbs. Thence South on 88° 10' on old line
South	27	80	Intersected old maple high tree Set Temporary Stake for corner
East	28	72	Thence East on 95° 11' Intersected East boundary line
South	22	18	Went to Beginning Thence South on 88° 10'
	27	80	Intersected Helms house To Temporary Stake set Stone for corner Sep 18 lbs. 20 lb brass set back at the South West corner on Helms old line, up to high 40 lbs. Containing 80 Acres

At Test

Geo. L. Harmon
 County Surveyor