

NOTES:
 1) THE POWER SERVICE SHALL DELIVER 120 VOLTS TO THE CCTV CABINET. POWER SERVICE CABLE SHALL BE #4 AWG COPPER.
 2) ALL NETWORK EQUIPMENT WILL BE INSTALLED BY OTHERS.

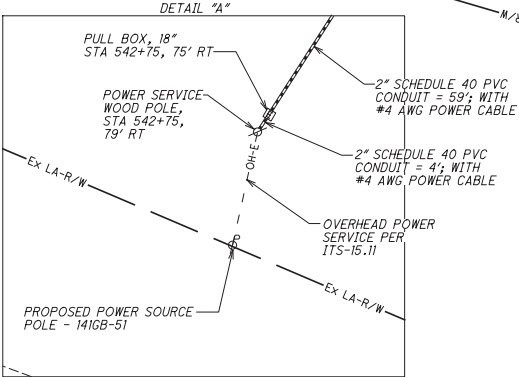
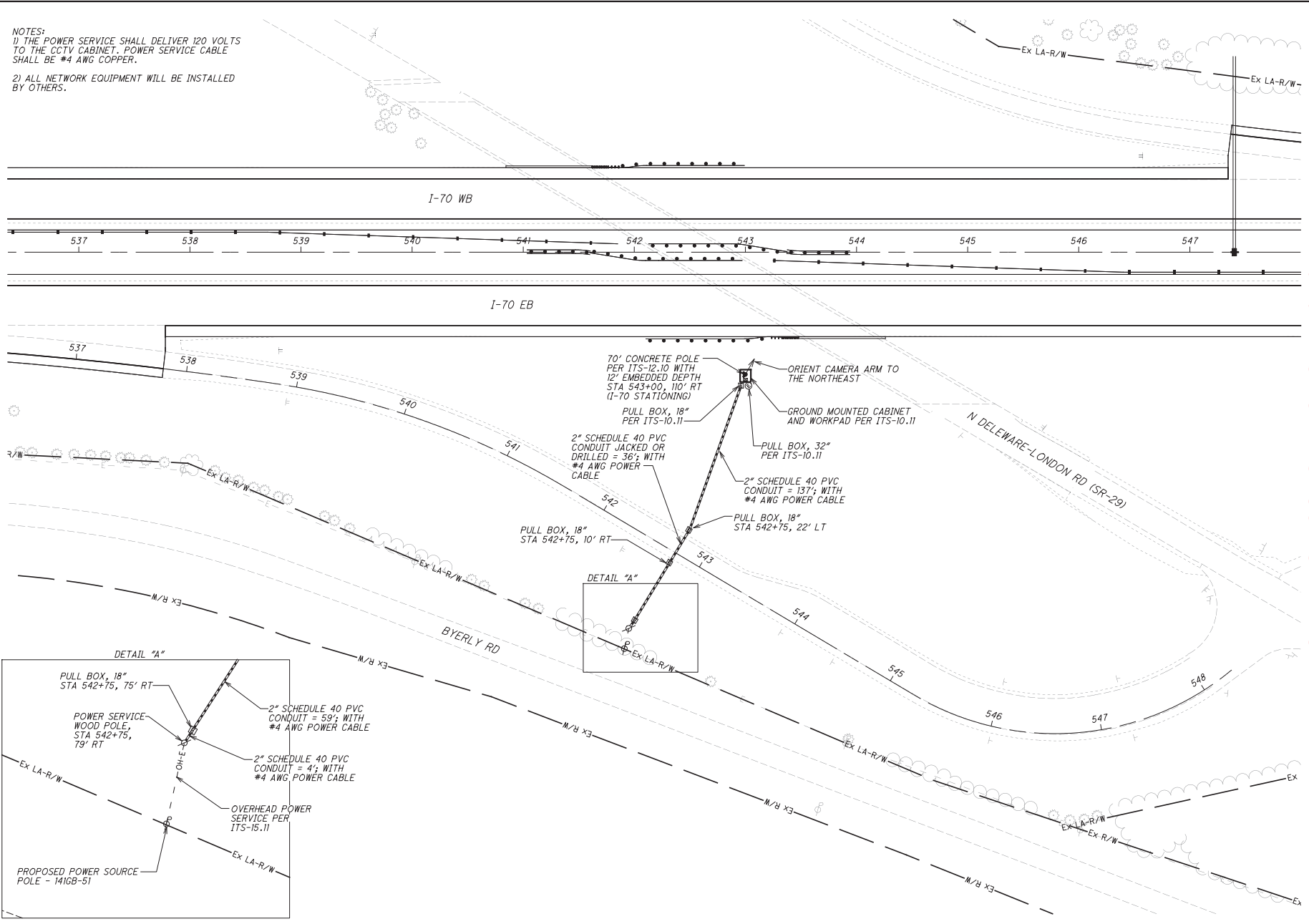

CALCULATED: M.J.H.
 CHECKED: K.A.E.

APPROVED FOR CONSTRUCTION - 3/20/2019
 ITS PLAN
 CAMERA #1 - I-70 AT SR-29 INTERCHANGE

MAD-70-8.62

455
470

C:\ECC\Projects\MAD-70\ELR\CADD\signals\Sheets\0709_CP00.dgn Design 3/19/2009 12:45:55 PM mhunter