

SCOPE NARRATIVE

HAM-LG-FY2029

PID 105502

4/16/2026

PURPOSE:

- THE SERVICES INCLUDE THE DEVELOPMENT OF DETAILED DESIGN PLANS FOR THE REPLACEMENT OF THE EXISTING HIGHWAY LIGHTING ON IR-71 MAINLINE AND RAMPS FROM THE NORTHERN PORTAL OF LYTLE TUNNEL (1.4 MILE MARKER) TO FREDONIA AVENUE (4.1 MILE MARKER.) SEE ATTACHMENT FOR SCHEMATIC DRAWINGS OF THE EXISTING CIRCUITS TO BE REPLACED AS PART OF THIS DESIGN CONTRACT.
- WORK IS EXPECTED TO INCLUDE COMPLETE REPLACEMENT OF THE ROADWAY AND UNDERDECK LIGHTING SYSTEMS: FOUNDATIONS, SUPPORTS, LUMINAIRES, CONDUIT SYSTEMS, CABLING, AND POWER SERVICES.
- NO WORK IS EXPECTED TO OCCUR WITHIN THE LYTLE TUNNEL OR ON THE LIGHTING FOR THE PEDESTRIAN BRIDGE NEAR COURT STREET.

DESIGN REQUIREMENTS:

- DESIGNER SHALL BE PREQUALIFIED IN ODOT'S HIGHWAY LIGHTING - COMPLEX DESIGN AND ROADWAY - NON-COMPLEX DESIGN CATEGORIES.
- THE DESIGNER SHALL FOLLOW THE SECTION 1100-HIGHWAY LIGHTING OF ODOT'S TRAFFIC ENGINEERING MANUAL (TEM), SUPPLEMENTAL SPECIFICATIONS, AND STANDARD CONSTRUCTION DRAWINGS FOR DESIGN REQUIREMENTS.
- THE DESIGNER'S STAGE 1 SUBMITTAL SHALL INCLUDE A PRELIMINARY ILLUMINATION ANALYSIS AND RECOMMENDATIONS ON THE LIGHTING SUPPORT AND FIXTURE TYPES THAT WILL MINIMIZE CONSTRUCTION COST AND NUMBER OF SUPPORTS AND FIXTURES THAT WILL HAVE TO BE MAINTAINED BY ODOT. THE LAYOUT SHALL TAKE INTO CONSIDERATION LIGHTING TRESPASS ONTO SENSITIVE PROPERTIES, THE ADJACENT LAND USE, MAINTENANCE ACCESS, AVAILABLE RIGHT-OF-WAY, MINIMIZING OR ELIMINATING LIGHTING ON STRUCTURES AND MEDIAN BARRIERS, CONFLICTS WITH EXISTING CONDUIT AND DRAINAGE SYSTEMS, AND ADJACENT LIGHTING TYPES. THE INITIAL SUBMITTAL SHALL ALSO INCLUDE RECOMMENDATIONS TO REPLACE OR REUSE FOUNDATIONS OR ATTACHMENTS FOR MEDIAN, WALL, AND BRIDGE MOUNTED LIGHTS DEPENDENT ON CONDITION.
- THE DELIVERABLES SHALL INCLUDE A COMPLETE SET OF CONSTRUCTION PLANS INCLUDING: PROPOSED LIGHTING PLANS, EXISTING LIGHTING REMOVAL PLANS, SUBSUMMARIES PER INTERCHANGE LOCATION/CIRCUIT, GENERAL NOTES, CONSTRUCTION ESTIMATE, ILLUMINATION ANALYSIS USING VISUAL SOFTWARE, VOLTAGE DROP CALCULATIONS, AND CIRCUIT SCHEMATICS TO BE USED BY MAINTENANCE PERSONNEL.
- THE DESIGNER SHALL DESIGN A PROPOSED LIGHTING PLAN THAT PROVIDES CONTINUOUS FREEWAY LIGHTING USING LED LIGHT FIXTURES. THE DESIGNER SHALL

NOT BE REQUIRED TO PERFORM LIGHTING WARRANTS EXCEPT FOR DETERMINING IF UNDERPASS LIGHTING IS REQUIRED FOR EACH STRUCTURE ALONG IR-71.

- FOR OVERPASSES THAT WARRANT UNDERDECK LIGHTING, THE DESIGN SHOULD PROVIDE WALL-MOUNTED LIGHTING. THE USE OF LIGHTING FIXTURES MOUNTED OVER TRAFFIC SHOULD BE AVOIDED UNLESS WALL-MOUNTED FIXTURES AREN'T FEASIBLE.
- THE PROPOSED DESIGN SHALL INCLUDE PROVIDING NEW METERED 120/240 VOLT 3-WIRE POWER SERVICES FOR THE ODOT MAINTAINED CIRCUITS.
- WHERE EXISTING LOCAL STREET AND INTERSTATE LIGHTS ARE PART OF THE SAME CIRCUIT, THE PROPOSED DESIGN SHALL SEPARATE THE PROPOSED ODOT CIRCUITS FROM THE LOCAL STREET CIRCUITS. WORK SHALL BE INCLUDED TO KEEP THE LOCAL STREET CIRCUIT IN OPERATION WITH A NEW POWER SERVICE ACCORDING TO CITY STANDARD.
- NEW SIGN LIGHTING IS NOT REQUIRED AND ANY OLD SIGN LIGHTING CIRCUITS ENCOUNTERED SHALL BE REMOVED WITH THIS PROJECT. PREVIOUS SIGN LIGHTING WAS TYPICALLY FED FROM THE LIGHTING CIRCUITS. WHILE ALL EXISTING SIGN LIGHTING FOR SIGNS ON IR-71 SHOULD HAVE BEEN PREVIOUSLY REMOVED, THE DESIGNER SHOULD REMOVE ANY SIGN LIGHTING SERVICES, IF ENCOUNTERED.
- ANY OUTAGES TO THE HIGHWAY LIGHTING NECESSARY TO COMPLETE THIS WORK SHOULD BE KEPT TO A MINIMUM DURATION FOR ONLY WHAT IS NECESSARY TO COMPLETE THE WORK AT EACH LOCATION.
- THE PLANS SHALL SPECIFY THAT THE CONTRACTOR SHALL ASSUME MAINTENANCE OF THE HIGHWAY LIGHTING WHILE WORKING ON A CIRCUIT.
- FOR THE REPLACEMENT OF ODOT'S EXISTING LIGHTING INFRASTRUCTURE, THE INTENT IS FOR EVERYTHING TO BE REMOVED AND REPLACED WITH NEW OR "LIKE NEW" CONDITIONS. WITH ODOT'S APPROVAL, PERMITTABLE ITEMS FOR REUSE INCLUDE EXISTING CONDUITS IN STRUCTURES AND FOUNDATIONS OR ATTACHMENTS FOR MEDIAN, WALL, AND BRIDGE MOUNTED LIGHTS DEPENDENT ON CONDITION AND THE AMOUNT OF WORK ANTICIPATED TO PROVIDE A NEW FOUNDATION OR ATTACHMENT. THE DESIGNER SHALL EVALUATE THE EXISTING FOUNDATIONS TO DETERMINE IF REUSE IS ACCEPTABLE. ALSO, ANY RECENTLY INSTALLED/UPGRADED INFRASTRUCTURE MAY BE KEPT AND REUSED AT THE DISCRETION OF ODOT.
- FOR THE REMOVAL ITEMS, THE DESIGNER SHALL SPECIFY TO DISPOSE OF ALL ITEMS. ALL EXISTING FOUNDATIONS AND ANY OTHER UNDERGROUND INFRASTRUCTURE SHALL BE REMOVED COMPLETELY OR TO A MINIMUM DEPTH OF 1 FOOT BELOW GRADE AND MARKED AS ABANDONED. CONDUITS MAY BE ABANDONED IN PLACE, BUT ALL CABLE SHALL BE REMOVED.
- CLEARING/GRUBBING AND SITE RESTORATION SHALL BE PERFORMED TO RESTORE ALL WORK AREAS TO PRE-CONSTRUCTION CONDITIONS.
- THE FINAL PLANS SHALL SPECIFY THAT ODOT SHALL RECEIVE COMPLETE AS-BUILT PLANS/FILES AND GPS COORDINATES OF ALL INFRASTRUCTURE IN THE ODOT ASSET COLLECTOR SYSTEM VIA PLAN NOTE.
- ODOT WILL PROVIDE ORIGINAL HIGHWAY LIGHTING PLANS.

UTILITIES:

- THE NEW LIGHTING AND ASSOCIATED INFRASTRUCTURE SHALL GENERALLY BE PLACED TO AVOID UTILITY CONFLICTS. SUBSURFACE UTILITY EXPLORATION (SUE) IS NOT REQUIRED, BUT IF DEEMED NECESSARY BY THE DESIGNER AND ODOT, IT CAN BE PERFORMED VIA ODOT'S TASK ORDER. THE DESIGNER AND ODOT SHALL AGREE UPON POTENTIAL LOCATIONS FOR EXPLORATION. THE DESIGNER SHALL ANTICIPATE 3 MONTHS IN THEIR SCHEDULE TO COMPLETE THE SUE PROCESS.

RIGHT OF WAY IS NOT ANTICIPATED WITH THIS PROJECT, BUT, IF NECESSARY, THE PROJECT SHALL ENSURE THAT ENOUGH RW IS ACQUIRED TO ACCOMMODATE RELOCATION OF IMPACTED UTILITIES.

CONSULTANT TO TRY TO AVOID UTILITY CONFLICTS THROUGHOUT DESIGN WHILE HOLDING TO THE SCOPE OF WORK. IF UTILITY CONFLICTS CANNOT BE AVOIDED, THEY SHOULD BE MINIMIZED. CONSULTANT TO PROVIDE A COPY OF THE OUPS TICKET INFORMATION TO ODOT PM. UP TO DATE UTILITY CONTACTS SHALL BE USED AT EACH PLAN SUBMISSION. UTILITY CONTACT INFORMATION CAN BE REQUESTED BY CONSULTANT FROM ODOT PM. IF OUPS AND OGPUPS TICKET ARE MORE THAN TWO (2) YEARS OLD, A DESIGN NON-MARKING TICKET SHALL BE REQUESTED TO OBTAIN MOST UP TO DATE UTILITY MEMBERS LIST. THE TICKET DOES NOT NEED TO BE SUBMITTED TO OBTAIN THE UTILITY MEMBERS LIST.

CONSULTANT TO PROVIDE A UTILITY SET OF PLANS WITH THE UTILITY LINES SHOWN IN COLOR USING THE MOST RECENT VERSION OF ODOTCADD_UTPEN.TBL AT EACH PLAN SUBMISSION. THIS FILE IS FOUND IN THE STANDARD ODOTCADD EXECUTABLE FILE THAT CAN BE DOWNLOADED FROM THE CADD SERVICES WEBPAGE.

CONSULTANT TO PREPARE A SUMMARY OR TABLE OF POTENTIAL UTILITY CONFLICTS AT EACH PLAN SUBMISSION. SUMMARY TO BE PROVIDED TO UTILITY COMPANIES AT EACH PLAN SUBMISSION. SUMMARY TO INCLUDE, BUT NOT LIMITED TO STATION AND OFFSET OF CONFLICT, TYPE OF CONFLICT (DIRECT, DECREASED COVER, PROXIMITY, ETC.), UTILITY OWNER (IF KNOWN) AND UTILITY TYPE.

CONSULTANT TO COMPILE UTILITY COMPANY RESPONSES AND FORWARD TO THE ODOT PM. FINAL COMPILATION OF UTILITY CORRESPONDENCE IS DUE 35 DAYS AFTER PLAN SUBMISSION TO UTILITIES. A "NO RESPONSE" FROM A UTILITY ON A PLAN SUBMISSION REVIEW CANNOT BE CONSIDERED AS "NO COMMENT", "NO CONFLICTS" AND/OR "A CONFIRMATION OF THE CONSULTANT'S FINDINGS" FROM THE UTILITY. A WRITTEN RESPONSE (EMAIL IS SUFFICIENT) MUST BE RECEIVED FROM THE UTILITY VERIFYING THAT THEY HAVE NO COMMENTS, NO CONFLICTS AND/OR THEY AGREE WITH THE CONFLICTS IDENTIFIED BY THE CONSULTANT.

CONSULTANT TO REVIEW THE UTILITY COMPANY RESPONSES AND EVALUATE. THE EVALUATION OF THE RESPONSES SHALL INCLUDE VALIDATING THAT A

CONFLICT DOES EXIST OR THAT A UTILITY MAY REMAIN IN PLACE. IF A CONFLICT DOES EXIST, CONSULTANT SHOULD PROVIDE AN EVALUATION OF THE FEASIBILITY OF POTENTIAL RESOLUTIONS. A DISPOSITION OF UTILITY STATUS (I.E. UTILITY TO STAY IN PLACE, UTILITY FACILITY RELOCATION PLAN IN WRITING OR PLAN FORMAT) IS REQUIRED AT THE STAGE 3 SUBMISSION. THIS DISPOSITION SHALL BE INCLUDED TO THE UTILITIES WITH THE STAGE 3 PLAN SUBMISSION. THIS DISPOSITION SHALL BE FORMULATED BASED ON UTILITY RESPONSES FROM PREVIOUS PLAN SUBMISSIONS.

REAL ESTATE:

- ODOT ANTICIPATES THAT ADDITIONAL RIGHT OF WAY WILL NOT BE NEEDED TO CONSTRUCT THIS PROJECT. EVERY EFFORT WILL BE MADE TO NOT NEED RIGHT OF WAY – TEMPORARY AND/OR PERMANENT.

ENVIRONMENTAL:

- ODOT WILL PERFORM ALL THE ENVIRONMENTAL ACTIVITIES ASSOCIATED WITH THIS PROJECT

DRAINAGE:

- THE CONSULTANT WILL BE RESPONSIBLE FOR LOCATING ANY EXISTING DRAINAGE ITEMS. THE NEW STRUCTURES AND INFRASTRUCTURE SHALL GENERALLY BE PLACED SO ALL DRAINAGE CONFLICTS ARE AVOIDED. PROPOSED LIGHT POLES AND TOWERS SHALL BE LOCATED OUTSIDE OF DITCH LINES.

GEOTECHNICAL:

- ODOT ANTICIPATES THAT GEOTECHNICAL DESIGN SERVICES WILL NOT BE NEEDED FOR THIS PROJECT UNLESS HIGH MAST LIGHT TOWERS WILL BE UTILIZED FOR THE PROPOSED LIGHTING. ANY GEOTECH SERVICES NEEDED AT THE TIME WOULD BE 'IF AUTHORIZED.'

GEOMETRICS:

- FOR ANY MEDIAN BARRIER WALL WORK NEEDED, THE BARRIER WALL SHALL BE REBUILT TO BE LIKE NEW AND FOLLOWING CURRENT STANDARDS WHILE INSTALLING ANY NEW CONDUIT RACEWAYS NEEDED TO MAKE SEEMLESS CONNECTIONS THOUGH THE BARRIER WALL. ANY BARRIER WALL WORK NEEDED SHALL ALSO BE SETUP WITH APPROPRIATE MAINTENANCE OF TRAFFIC PROVIDED AND ALL LANES MAINTAINED DURING CONSTRUCTION.

MAINTENANCE OF TRAFFIC:

THE PROPOSED WORK WILL REQUIRE CLOSURE OF SHOULDERS AND SOME ROLLING LANE CLOSURES. MOST OF THE MAINTENANCE OF TRAFFIC (MOT) NEEDS CAN BE HANDLED BY STANDARD DRAWINGS BUT THE PROJECT NEEDS TO BE EVALUATED FOR ANY ADDITIONAL MOT

NEEDS. THE CREATION OF MOT PLANS MIGHT BE NEEDED AND WILL BE DETERMINED AS THE DESIGN PROGRESSES.

SURVEY:

DETAILED SURVEY TO COLLECT INFORMATION FOR DESIGN IS REQUIRED FOR THIS PROJECT BY THE CONSULTANT.

THE SURVEY NEEDS TO LOCATE THE EXISTING LA RIGHT OF WAY. THE DESIGNER NEEDS TO COLLECT EXISTING TOPOGRAPHIC DATA IN THE PROJECT AREA, SUCH AS UTILITIES, SIGNS AND SUPPORTS, GUARDRAIL/BARRIER, AND EXISTING DRAINAGE. THE EDGE OF PAVEMENT AND ADJACENT GROUND ELEVATIONS NEED TO BE LOCATED, SO THE INFRASTRUCTURE CAN BE PLACED AT THE CORRECT ELEVATION.

PROJECT MANAGEMENT:

A PROJECT KICKOFF MEETING/CALL SHALL BE SCHEDULED WITH THE DESIGNER IN ORDER TO REVIEW THE PROJECT SCOPE WITH THE ODOT DISTRICT 8 TRAFFIC OPERATIONS DEPARTMENT. AFTER THE DESIGNER DOES THEIR INITIAL RESEARCH AND INFORMATION GATHERING, ANOTHER MEETING/CALL MAY BE SCHEDULED TO DISCUSS ANY LOCATIONS AHEAD OF THE STAGE 1 SUBMITTAL.

FOR PLAN STAGE DEVELOPMENT, THE DESIGNER SHALL FOLLOW THE ODOT PROJECT DEVELOPMENT PROCESS (PDP), TRAFFIC ENGINEERING MANUAL, AND THE BELOW ADDITIONAL EXPECTATIONS.

THE PLAN SET SHALL INCLUDE A PROJECT OVERVIEW MAP SCHEMATIC INCLUDED IN THE FRONT OF THE PLANS, WITH A TABLE OF LOCATION NAMES AND PLAN SHEET NUMBERS FOR EACH CIRCUIT.

STAGE 1 PLANS SHALL INCLUDE PRELIMINARY LAYOUT OF THE NEW LIGHT SUPPORTS AND POWER SERVICES AND UTILITIES COORDINATION SUMMARY.

STAGE 2 PLANS SHALL INCLUDE THE BULK OF THE DESIGN, INCLUDING ALL PROPOSED LIGHT SUPPORTS AND FIXTURES, POWER SERVICES, CONDUITS AND PULLBOXES, ROADWAY/GUARDRAIL/BARRIER WORK, MAINTENANCE OF TRAFFIC, ETC.

IN ADDITION, INCLUDE THE FOLLOWING WITH THE STAGE 2 SUBMISSION:

1. DETAILS ON SIZE OF CABLES AND LOAD AT EACH POWER SERVICE.
2. SUPPORTING CALCULATIONS FOR THE ILLUMINATION DESIGN FOR THREE DIFFERENT ODOT-APPROVED LED LIGHT FIXTURES.
3. ANY FURTHER UTILITY COORDINATION SHALL ALSO BE SUPPLIED AT THIS STAGE.

STAGE 3 PLANS SHALL INCLUDE ADDRESSING ANY COMMENTS FROM PREVIOUS STAGES, FINAL QUANTITIES AND PLAN NOTES, ETC.

FINAL PLANS SHALL BE SUBMITTED ADDRESSING ALL PREVIOUS COMMENTS AND STAMPED/SEALED BY A PROFESSIONAL ENGINEER.

ALL PLAN REVIEWS SHALL BE SUBMITTED TO ODOT DISTRICT 8 TRAFFIC OPERATIONS PROJECT MANAGER.

MISCELLANEOUS:

THE DESIGNER SHALL EVALUATE ANY MATERIAL LEAD TIME REQUIREMENTS, MOT IMPACTS, TREE CLEARING OR OTHER ISSUES THAT WOULD WARRANT THE SALE OF THE PROJECT AT A SPECIFIC TIME OF YEAR. THIS EVALUATION SHOULD BE MADE AT STAGE 1, SO THE SCHEDULE CAN BE ADJUSTED PRIOR TO LOCKDOWN.

UNERPASS LIGHTING:

Please Note: The below work will be sold under a separate construction contract. Consultant to perform plan preparation for construction plans though the final engineering PDP phase. This design work will be managed by District 8 under the PID 105502 consultant agreement. District 8 will provide the final plans to District 7 for them to manage for project award and construction.

Project Identification

General Description of project: Replace underdeck lighting at the GRE-35 overpass of I-675



Services Requested

Consultant to produce construction plans that will remove the current underdeck lighting, conduits, and cables and replace with a pier mounted system. See rough sketch below:



Proposed design shall meet the standards and requirements of TEM section 1100, the LDRP and other applicable highway lighting standards. Both NB and SB lanes shall be lit (also including portions of exit ramps under the bridge). Due to roadway width, it is anticipated that lights will need to be mounted on each side of the roadway in the NB and SB directions to minimize occlusion. Daylighting is not required.

Consultant to obtain any necessary survey data to complete the design.

Existing power service (located south of the US 35 EB flyover ramp to NB 675) will be re-used. It is anticipated that the work will connect to this power service at the nearest pullbox via an unfused connection at the bridge abutment.

For all proposed conduit: The preference is to have conduits supported by bridge crossframes. If this is not possible, the conduit may be supported by the stiffeners, as shown in the following detail:

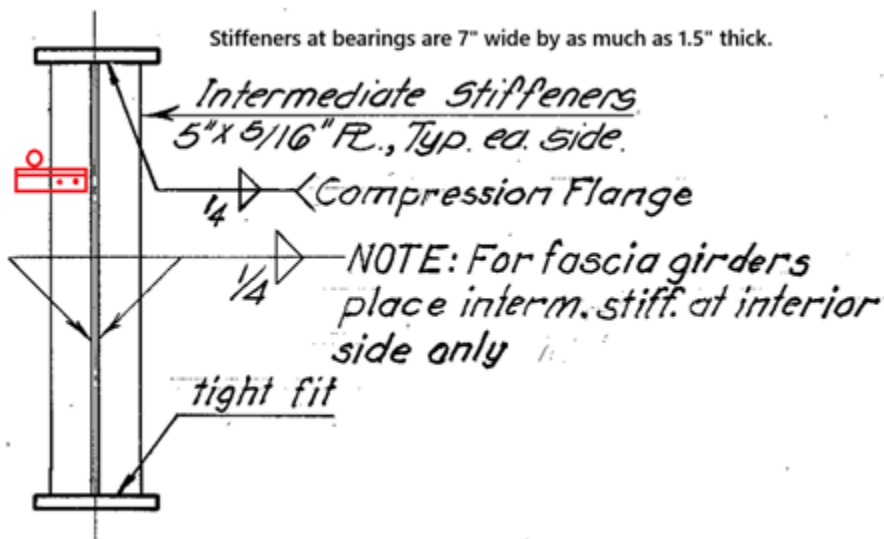

All conduits shall be attached to an interior beam as added protection from over-height vehicle bridge strikes.

Plans shall consist of:

Lighting plan sheets, lighting analysis, voltage drop calculations, general notes specific to this underpass installation, sub-summary of quantities and pay items, circuit schematic with control center data chart (existing may be used), and lighting details (underpass elevation views). It is anticipated that SCD and general notes will be used for MOT and will be handled by ODOT. However, ODOT would like the consultant to advise whether detailed MOT plans are required to construct this improvement. If detailed MOT plans are needed, the consultant will be tasked to create them. Please include hours for MOT plans as an 'If Authorized' task.

If it is determined by District 7 to incorporate into one of their in-house lighting projects for sale, the consultant shall provide a sub-summary of quantities and pay items to enable ODOT to produce the general summary for the overall project. Sheet numbers may be omitted and will be inserted by ODOT. The consultant will be required to stamp the title sheet of this project for their portion of the work. All cost estimates will be handled by ODOT.

Deliverables:

1. PDF copy of all plan sheets, 11x17 size.
2. Microstation drawing files with associated base mapping, reference files and control points noted.
3. Excel spreadsheets used for plan development and calculations.
4. Visual lighting files.

Documentation Provided

Existing bridge plans and highway lighting plans see below ftp site:

<ftp.dot.state.oh.us - /pub/Districts/D08/Programmatic/2026-May/105502/08c1002/>

Project Schedule

Initial Submission consisting of preliminary plan sheets showing layout, lighting analysis and voltage drop – February 1, 2027

Stage 3 level submission – July 2, 2027

Final Plans – November 1, 2027

**Dates are tentative and may push out.