

SEE 2001 CUY-71-0.00 PLANS FOR MODIFICATIONS TO STORM SEWERS

CUYAHOGA COUNTY
MED- 42-26.17
CUY- 42-0.00

REV. NO.	DATE	REVISION
2	01/10	I-71-5(15)233

38
302

CFN 180710034
SLM 0.34, 113"x72"
SEE SHEET 215

SLM 0.51, 15"
SEE SHEET 69

CFN 180710035
SLM 0.35, 60"
CHANGE ORDER
NO PLANS

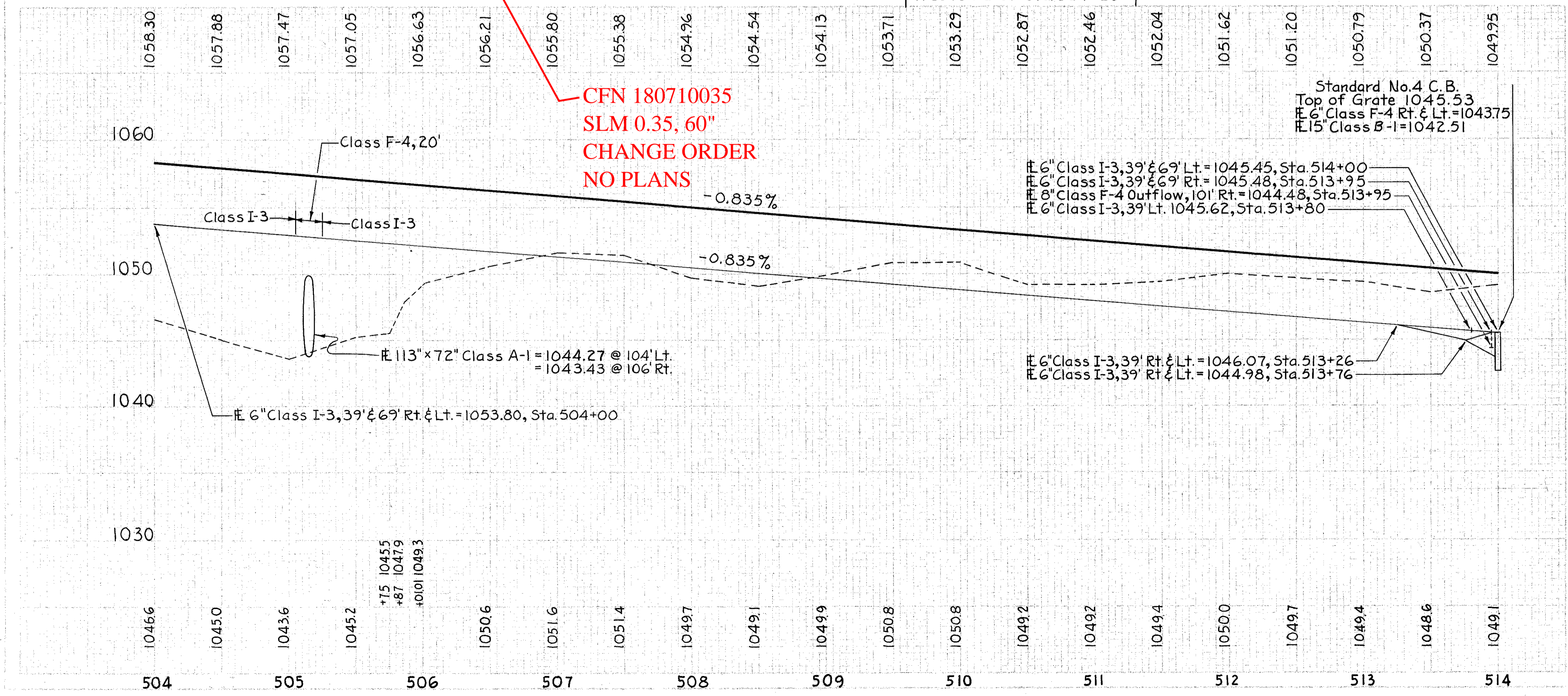
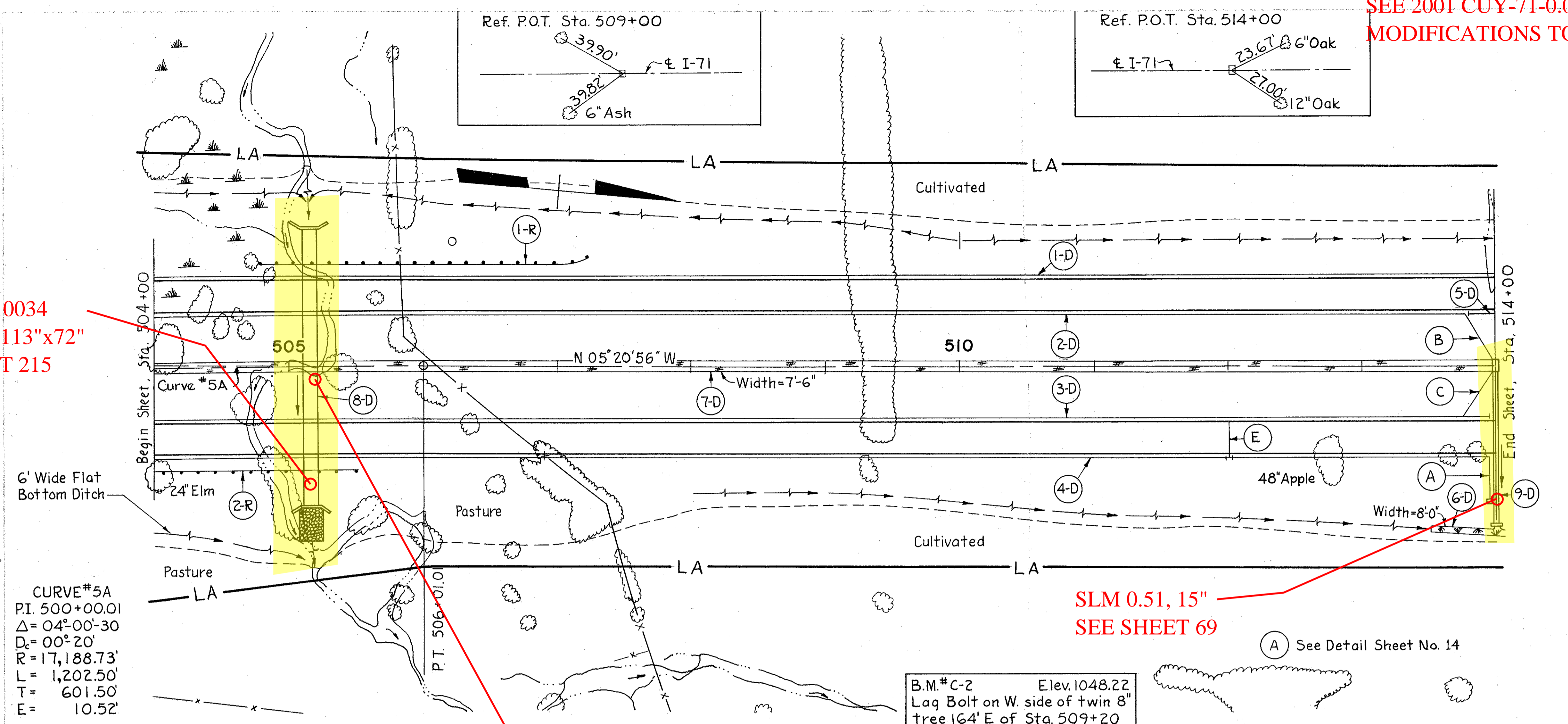

ESTIMATED QUANTITIES

REF. NO.	STATION TO STATION	SIDE	Class	Sec. W. 206.1(a)	Class	Class F-4 Pipe	Masonry	I-2	I-5	I-6	I-10	I-15	L-10	L-120
1-D	504+00 to 514+00	Lt.	Class I-3	980	20									
2-D	504+00 to 513+76	Lt.	Class I-3	990	30									
3-D	504+00 to 513+95	Rt.	Class I-3	1009	30									
4-D	504+00 to 513+95	Rt.	Class I-3	1025	20	10								
5-D	513+80 to 514+00	Lt.	Class I-3	20										
6-D	513+50 to 514+00	Rt.	Class I-3											
7-D	513+50 to 514+00	Med.	Class I-3											
8-D	504+00 to 514+00	Rt.	Class I-3	210	122									
9-D	504+00 to 514+00	Rt.	Class I-3											
1-R	504+75 to 507+25	Lt.												
2-R	504+00 to 505+50	Rt.												
TOTALS														833