

PEARL ROAD  
SLM 5.52 = MM 234.23

SLM 5.47, 12"  
SEE SHEET 71

SLM 5.51, 15"  
SEE SHEET 149

SLM 5.57, 15"  
SEE SHEET 149

SLM 5.58, 12"  
SEE SHEET 149

SLM 5.63, 15"  
SEE SHEET 150

CUYAHOGA COUNTY  
CUY - 42 - 3.38

DWG I-71-5(11)236

31  
263

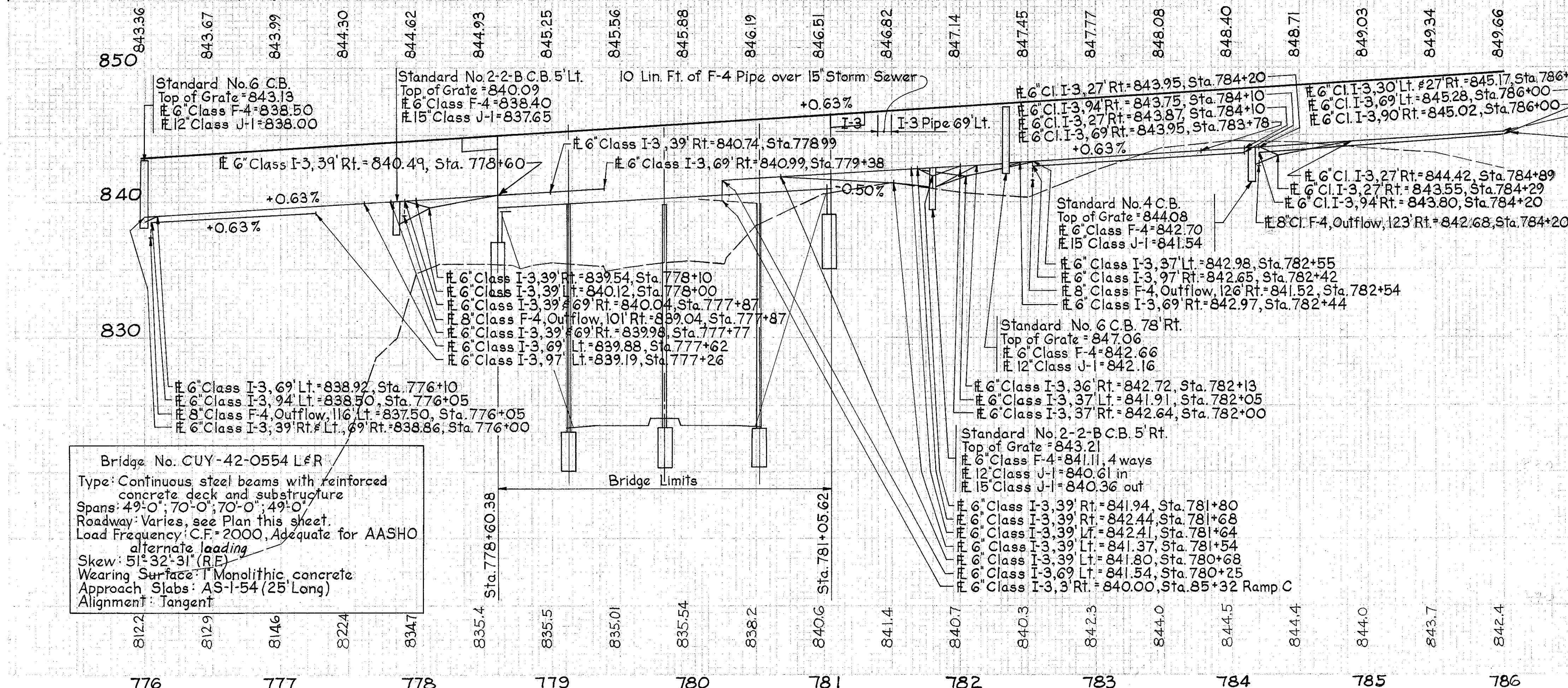
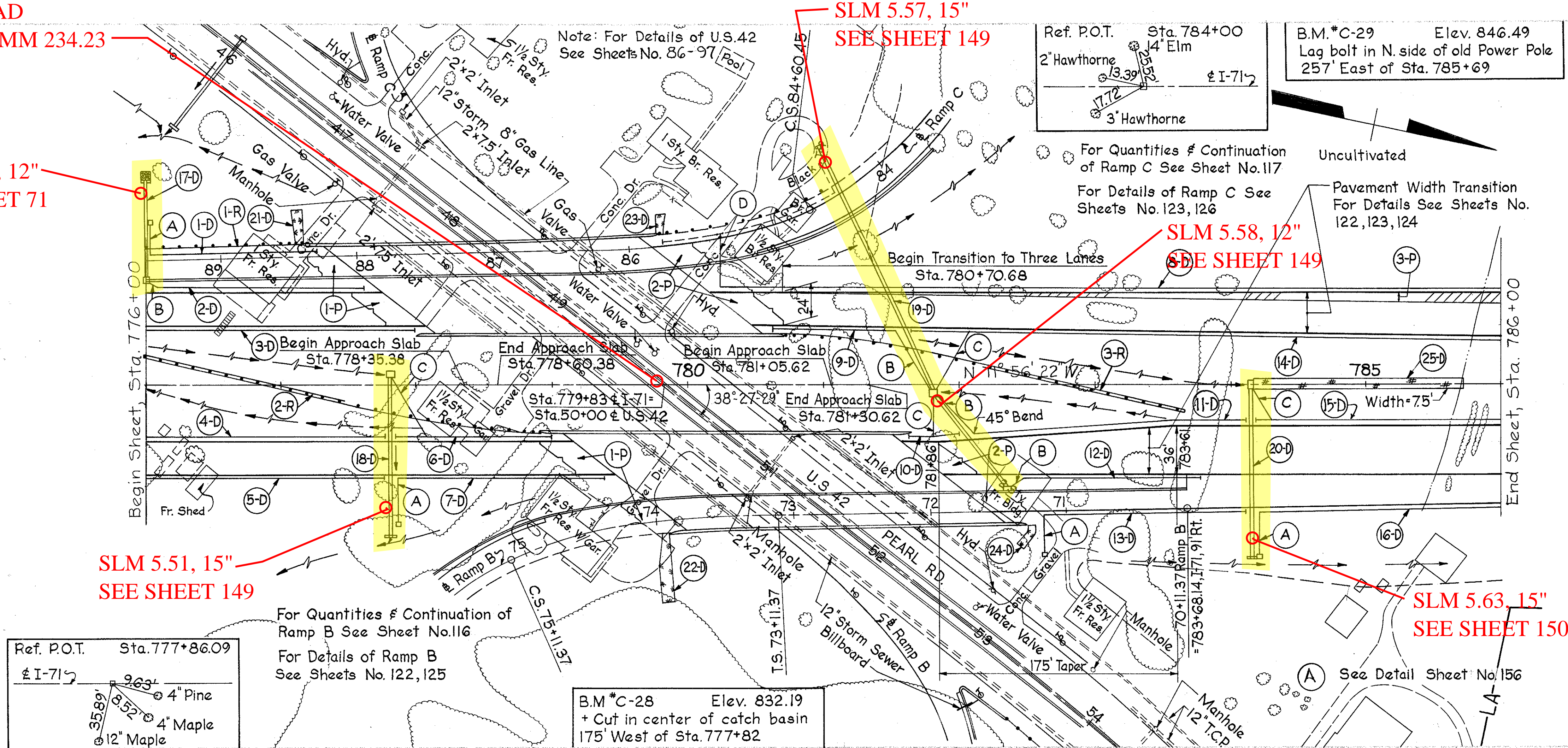

REF NO.	SIDE	STATION TO STATION	ESTIMATED QUANTITIES
I-D	Lt.	776+05 to 777+26	
2-D	Lt.	776+00 to 777+62	
3-D	Lt.	776+00 to 778+00	
4-D	Rt.	776+00 to 777+77	
5-D	Rt.	776+00 to 777+99	
6-D	Rt.	777+87 to 778+99	
7-D	Rt.	777+87 to 779+38	
8-D	Lt.	780+25 to 786+00	
9-D	Lt.	780+68 to 781+80	
10-D	Lt.	781+68 to 782+00	
11-D	Rt.	781+80 to 784+10	
12-D	Rt.	782+34 to 783+78	
13-D	Lt.	782+42 to 784+00	
14-D	Lt.	781+64 to 786+00	
15-D	Rt.	784+20 to 786+00	
16-D	Rt.	784+20 to 786+00	
17-D	Lt.	776+00 to 777+82	
18-D	Lt.	777+82 to 781+80	
19-D	Lt.	781+80 to 784+15	
20-D	Lt.	777+15 to 779+82	
21-D	Lt.	779+82 to 782+54	
22-D	Lt.	779+82 to 782+54	
23-D	Lt.	779+82 to 782+54	
24-D	Lt.	782+54 to 785+72	
25-D	Med.	784+22 to 785+72	
I-P	Rt.	778+35.38 to 778+60.38	
2-P	Rt.	781+05.62 to 781+30.62	
3-P	Lt.	780+70.68 to 786+00	
I-R	Lt.	776+00 to 777+12.50	
2-R	Med.	775+97 to 778+92	
3-R	Med.	780+73 to 783+18	

Sta. 776+00 to 786+00