

☉ Run-Around ☉ 24" Water Main
 Δ = 30°-00'-00" Δ = 30°-00'-00"
 D = 7°-00'-00" D = 6°-52'-26.54"
 R = 818.51' R = 833.51'
 T = 219.319' T = 223.31'
 L = 428.57' L = 436.42'

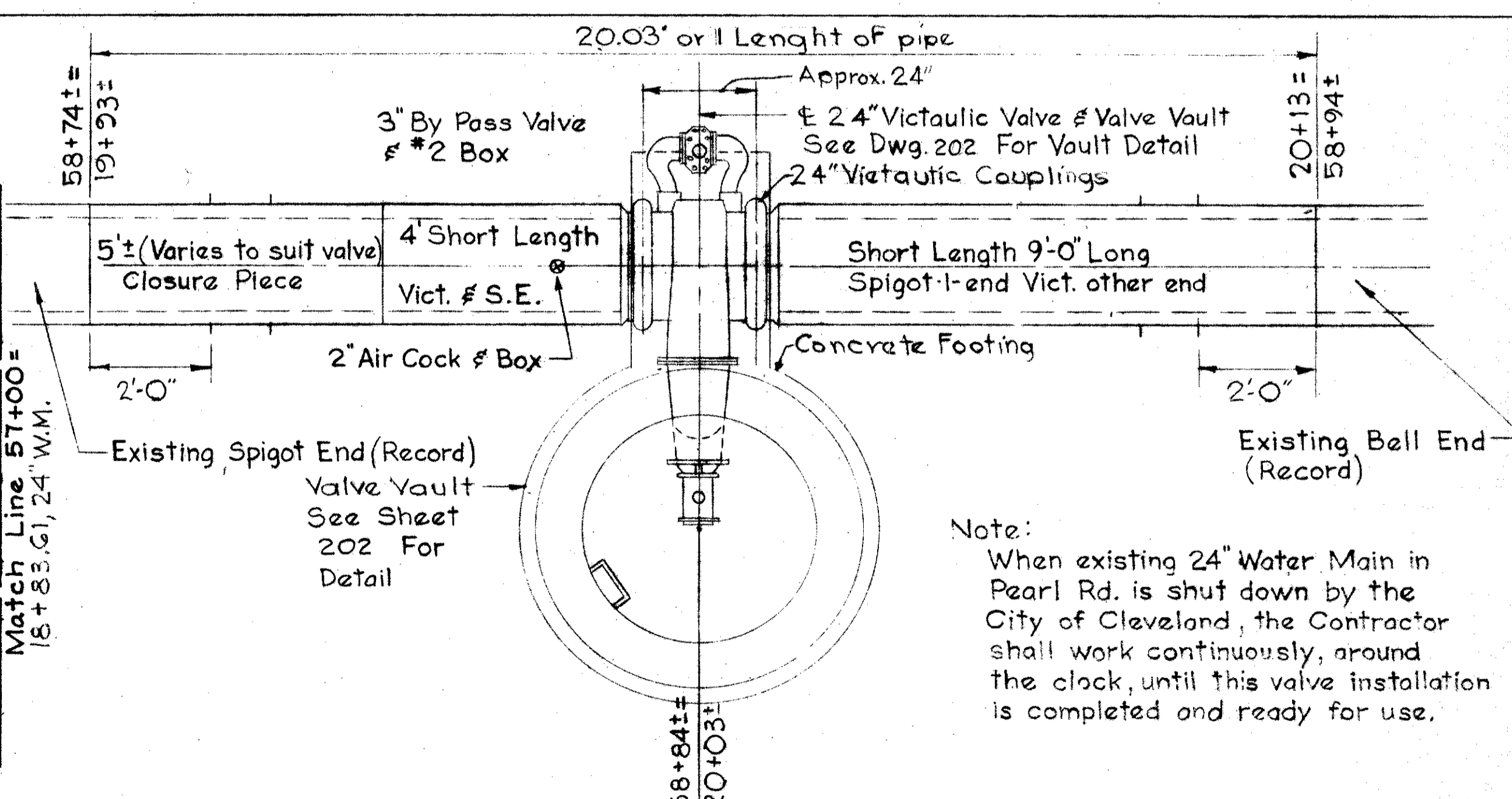

Note:
When existing 24" Water Main in Pearl Rd. is shut down by the City of Cleveland, the Contractor shall work continuously, around the clock, until this valve installation is completed and ready for use.

24" VALVE INSTALLATION AT STA. 58+88± (Pearl Rd.)=20+03±, 24"W.M.
Location to be determined when pipe is exposed.
No Scale

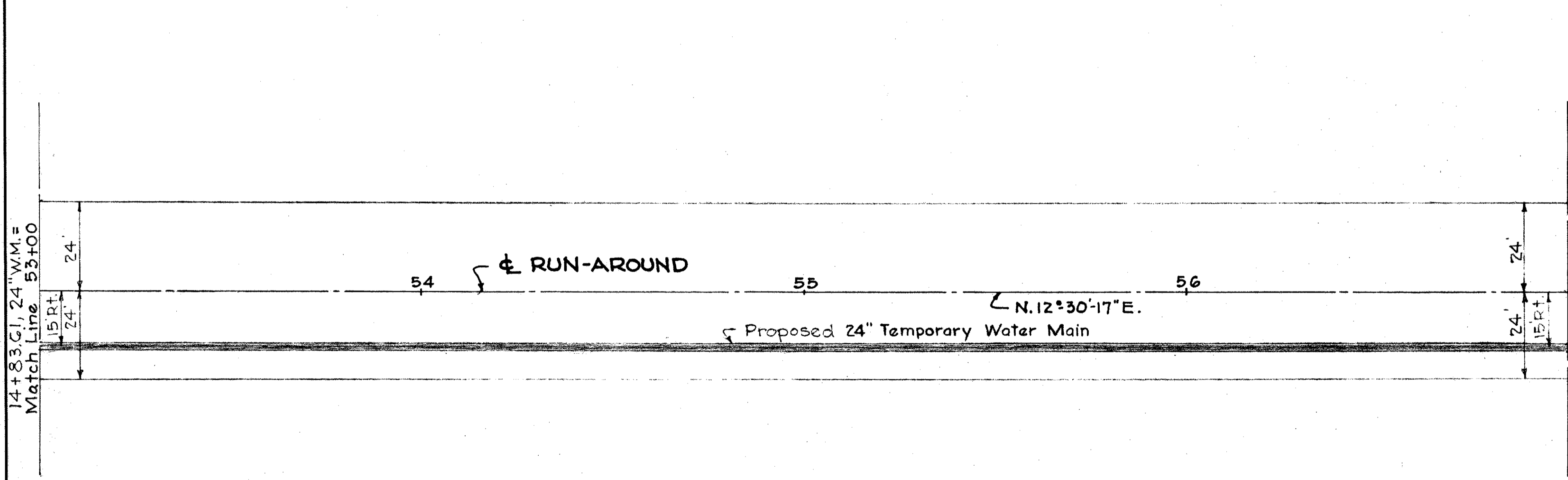
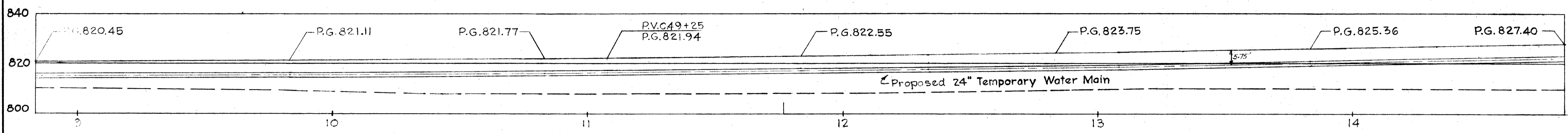
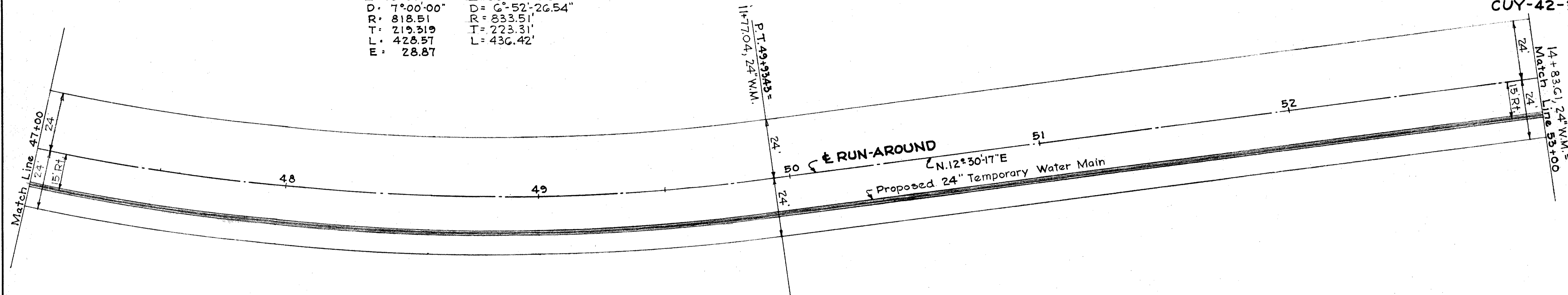
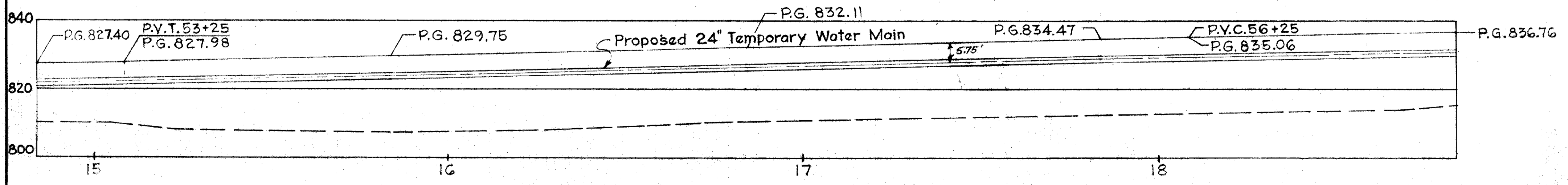

PREPARED BY J.E. GREINER COMPANY
CONSULTING ENGINEERS
BALTIMORE-1, MARYLAND

DEPARTMENT OF PUBLIC UTILITIES DIVISION OF WATER AND HEAT CLEVELAND, OHIO		2ND HIGH SERVICE ZONE	
APPROVED _____ IS _____ DIRECTOR OF PUBLIC UTILITIES		SUBJECT 24" BY PASS WATER LINE IN PEARL RD. RUNAROUND	
COMMISSIONER OF WATER AND HEAT COMMISSIONER-DIVISION OF UTILITIES ENGINEERING		DRAWN BY M.B.W. SCALE 1"=20' H&V	
ENGINEER OF CONSTRUCTION & SURVEYS		TRACED BY M.B.W.	
ENGINEER OF DESIGN		CHECKED BY _____ DATE _____	