

FED. RD. DIST. NO.	STATE	FED. AID PROJECT	FISCAL YEAR
10	OHIO	388 E	1927

I.C.H. 324 SEC. F.
GEAUGA COUNTY

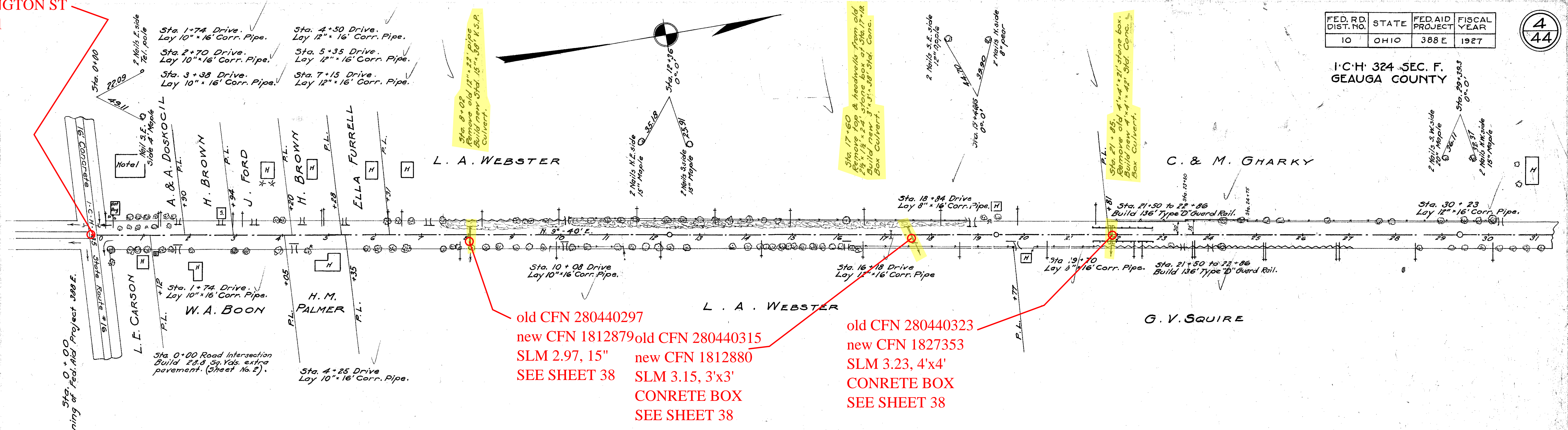

old CFN 280440297
new CFN 1812879
SLM 2.97, 15"
SEE SHEET 38

old CFN 280440315
new CFN 1812880
SLM 3.15, 3'x3'
CONCRETE BOX
SEE SHEET 38

old CFN 280440323
new CFN 1827353
SLM 3.23, 4'x4'
CONCRETE BOX
SEE SHEET 38

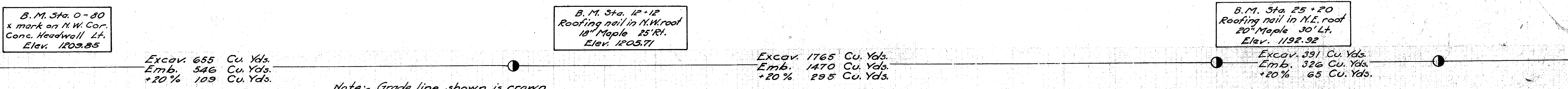

Note:- Grade line shown is crown of finished pavement.

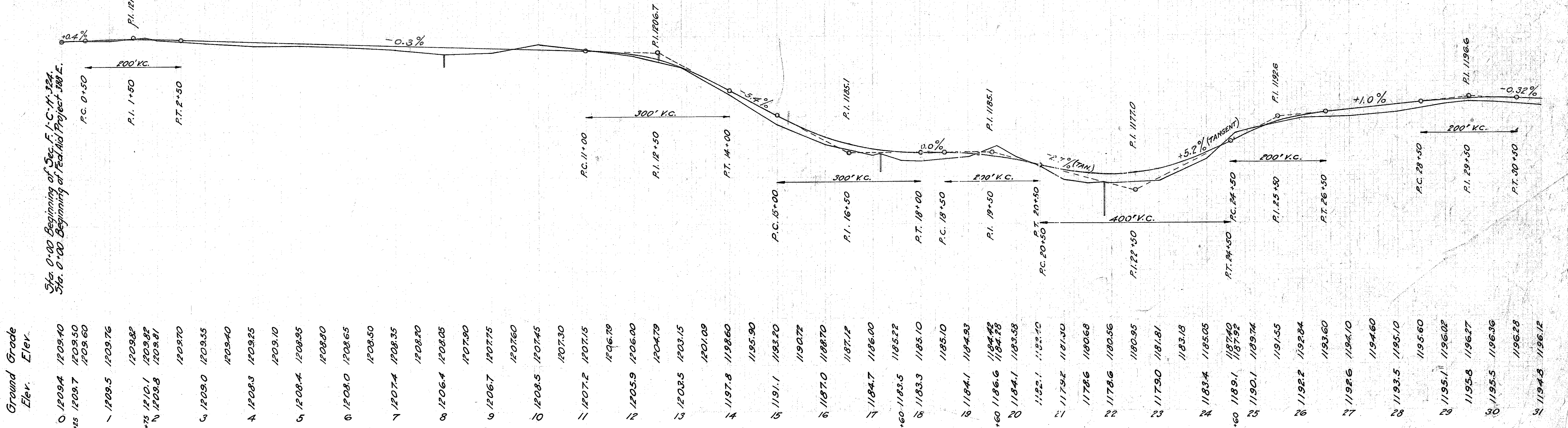

Station	Ground Grade Elev.
0	1209.40
1	1209.50
2	1209.60
3	1209.76
4	1209.82
5	1209.82
6	1209.81
7	1209.70
8	1209.55
9	1209.40
10	1209.25
11	1209.10
12	1208.95
13	1208.80
14	1208.65
15	1208.50
16	1208.35
17	1208.20
18	1208.05
19	1207.90
20	1207.75
21	1207.60
22	1207.45
23	1207.30
24	1207.15
25	1206.79
26	1206.00
27	1204.79
28	1203.15
29	1201.09
30	1197.8
31	1192.60
32	1195.90
33	1191.1
34	1187.2
35	1184.7
36	1186.00
37	1185.22
38	1183.3
39	1185.10
40	1185.10
41	1184.1
42	1184.23
43	1184.42
44	1184.78
45	1184.1
46	1183.58
47	1182.1
48	1182.40
49	1179.2
50	1181.90
51	1178.6
52	1180.68
53	1178.6
54	1180.36
55	1180.35
56	1179.0
57	1181.81
58	1183.18
59	1183.4
60	1185.05
61	1187.40
62	1187.52
63	1190.1
64	1189.74
65	1191.55
66	1192.2
67	1192.84
68	1193.60
69	1192.6
70	1194.10
71	1194.60
72	1193.5
73	1195.10
74	1195.60
75	1195.1
76	1196.02
77	1195.8
78	1196.27
79	1195.5
80	1196.36
81	1196.28
82	1194.8
83	1196.12