

FED. RD. DIST. NO.	STATE	FED. AID PROJECT	FISCAL YEAR
10	OHIO	388 E	1927

1'-C'H' 324 SEC. F.
GEAUGA COUNTY

STAFFORD ROAD
SLM 4.53

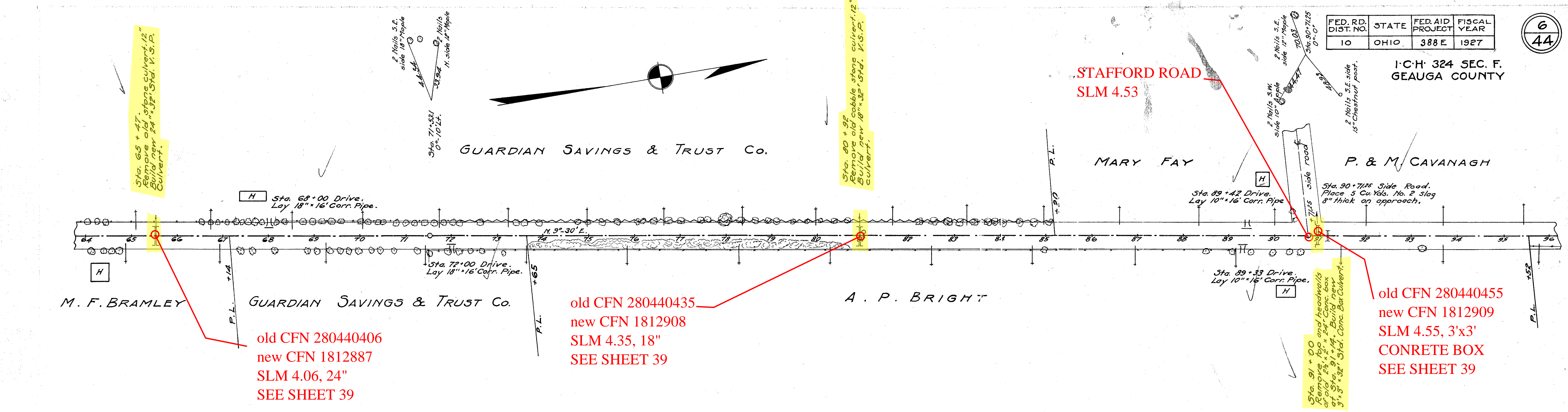

old CFN 280440406
new CFN 1812887
SLM 4.06, 24"
SEE SHEET 39

old CFN 280440435
new CFN 1812908
SLM 4.35, 18"
SEE SHEET 39

old CFN 280440455
new CFN 1812909
SLM 4.55, 3'x3'
CONCRETE BOX
SEE SHEET 39

B. M. Sta. 72+10
Roofing nail in N.E. root
14" Maple 30' Lt.
Elev. 1241.00

B. M. Sta. 85+10
Roofing nail in N.E. root
12" Maple 35' Lt.
Elev. 1267.17

Note:- Grade line shown is crown
of finished pavement.

