

1 NO. 4 CATCH BASIN CONSTRUCTED BY OTHERS DURING FUTURE SECTION 7-1. ALL UNDERDRAIN CONNECTIONS TO NO. 4 CATCH BASIN (CONSTRUCTED BY OTHERS) SHALL BE TEMPORARILY CONNECTED TO ADJACENT EXISTING CATCH BASINS.

3 GUARDRAIL AND IMPACT ATTENUATOR CONSTRUCTED BY OTHERS DURING FUTURE SECTION 7-1.

175' - 15" Type B
 See Below

91' - 15" Type B
 See Below

CONSTRUCTION C
 CURVE No. 1
 D = 0'-28'-00"
 R = 12,277.67'
 L = 6,131.80'
 T = 3,131.26'
 P.I. STA. 390+31.26
 Δ = 28°-36'-54"

ESTIMATED QUANTITIES

REF.	FROM	TO	SIDE	202				603				604				660	
				PIPE REMOVED, 24" AND UNDER	CATCH BASIN REMOVED	CATCH BASIN ABANDONED	CATCH BASIN ABANDONED, AS PER PLAN	15" CONDUIT, TYPE B, 706.02	15" CONDUIT, TYPE C, 706.02	18" CONDUIT, TYPE B, 706.02	18" CONDUIT, TYPE C, 706.02	CATCH BASIN, No. 4 WITH E GRATE	INLET, No. 3B50, A.P.P.	MANHOLE No. 1	SODDING		
D1	376+25		69.3'L			1											
D2	376+25.0		63'L	7				7			1					100	
D3	376+25		9.6'L	17	1			17									
D4	376+25.5		3'R												1		
D5	376+26		12.6'R	14	1					14							
D6	376+25.2		63'R	7							7	1				100	
D7	376+25		72.2'R	13	1						13						
D8	380+76		69.9'L			1											
D9	380+75.0		63'L	7						7						100	
D11	380+75.0		63'R	7						7					1	100	
D12	380+75		72.4'R	14	1					14							
D13	384+26		69.3'L		1												
D14	384+25.9	384+67.5	L	7						7					1	100	
D15	384+25		10.5'L	17	1					17							
D16	384+25.0		3'R	6						6							
D18	384+25		72.0'R								1						
D19	383+35		80.5'R							91						1	
TOTALS				116	6	2	1	131	42	14	20	5	2	1	500		

REFERENCE R# LOCATED ON ROADWAY SUB-SUMMARY, SHT 32.

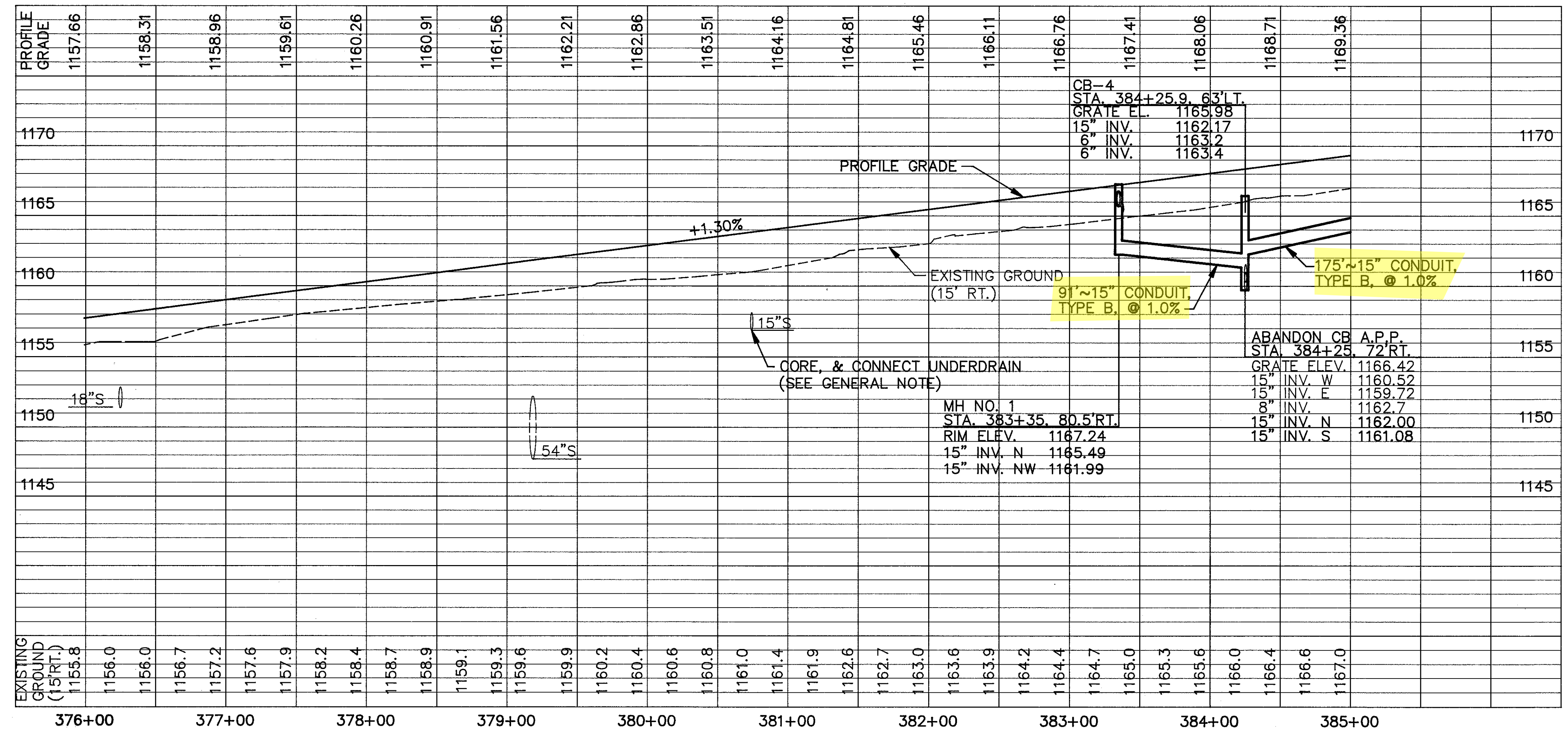

REF.	FROM	TO	SIDE	603		605	
				15" CONDUIT, AS PER PLAN	6" CONDUIT, TYPE F	6" SHALLOW PIPE UNDERDRAIN	6" FITTINGS
D20	383+35	384+71	80.5'R	136			
U1	376+25.0		L		26		1
U2	376+25.0	380+86	L		27	448	1
U3	376+25.5	380+73	R		10	438	
U4	376+25.2	380+86	R		27	448	1
U5	376+25.2	376+39.8	R		30		1
U6	380+75.0	380+89.6	L		30		1
U7	380+75.0	384+36	L		27	348	1
U8	380+75.0	384+23	R		10	338	1
U9	380+75.0	384+36	R		27	348	1
U10	380+75.0	380+89.6	R		30		1
U11	384+25.9		L		28		1
U12	384+25.9	387+86	L		25	347	1
U13	384+25.0	387+73	R		10	338	
U14	384+25.0	387+86	R		37	348	1
TOTALS				136	344	3401	