

**DRAINAGE LEGEND**

- Proposed Drainage Ditch
- Proposed Storm and Sanitary Sewers
- Proposed Underdrains
- Existing Storm Sewers
- Existing Sanitary Sewers
- Existing Water Mains
- Proposed Storm Manhole
- Proposed Sanitary Manhole
- Proposed Median Inlet
- Proposed Paved Shoulder Inlet
- Proposed Ditch Catch Basin
- Proposed Pavement Catch Basin
- Existing Storm and Sanitary Manholes
- Existing Storm Inlets
- Jute Matting
- Rock Channel Protection
- Sod
- Paved Gutter

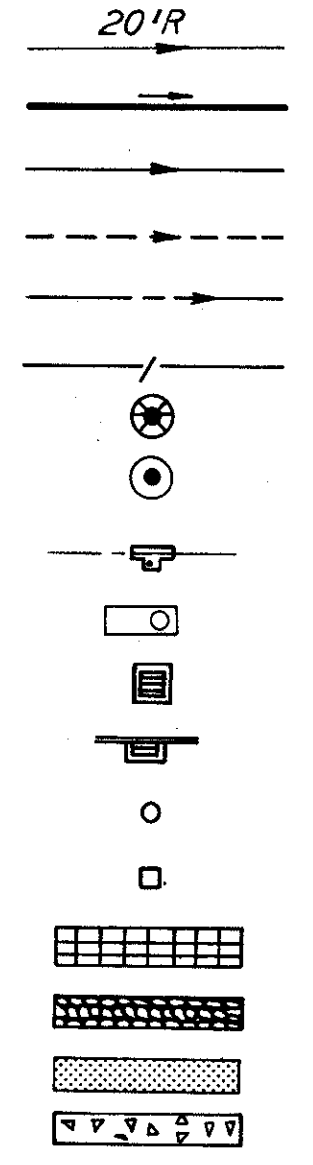

Note: Connect exist. ditch to inlets with 20' Lead-in ditch 2' wide

DATE	BY

DATE	BY

DATE	BY

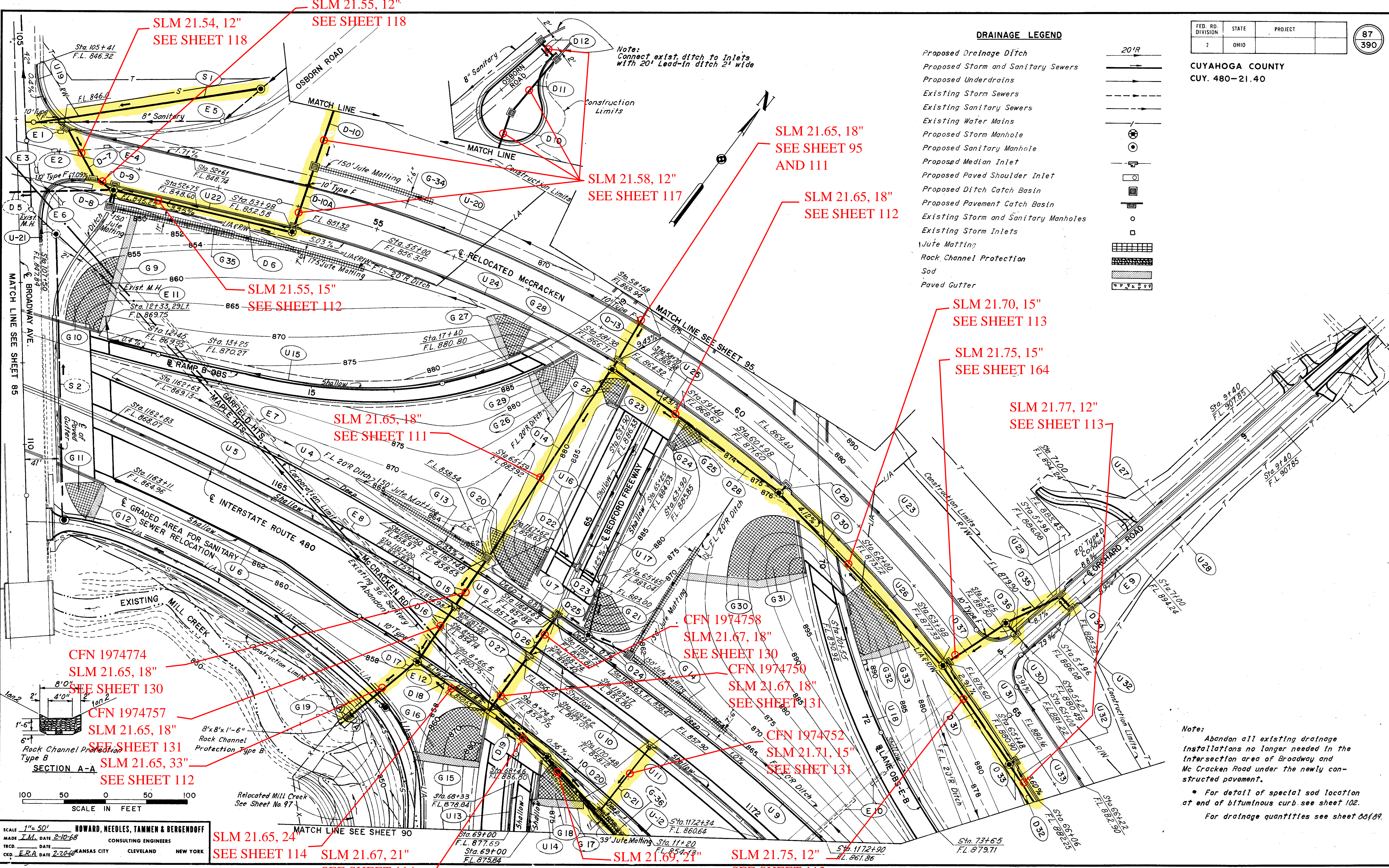

SLM 21.54, 12"  
SEE SHEET 118

SLM 21.55, 12"  
SEE SHEET 118

SLM 21.58, 12"  
SEE SHEET 117

SLM 21.65, 18"  
SEE SHEET 95  
AND 111

SLM 21.65, 18"  
SEE SHEET 112

SLM 21.55, 15"  
SEE SHEET 112

SLM 21.70, 15"  
SEE SHEET 113

SLM 21.75, 15"  
SEE SHEET 164

SLM 21.65, 18"  
SEE SHEET 111

SLM 21.77, 12"  
SEE SHEET 113

CFN 1974774  
SLM 21.65, 18"  
SEE SHEET 130

CFN 1974758  
SLM 21.67, 18"  
SEE SHEET 130

CFN 1974750  
SLM 21.67, 18"  
SEE SHEET 131

CFN 1974757  
SLM 21.65, 18"  
SEE SHEET 131

CFN 1974752  
SLM 21.71, 15"  
SEE SHEET 131

SLM 21.65, 33"  
SEE SHEET 112

SLM 21.65, 24"  
SEE SHEET 114

SLM 21.67, 21"  
SEE SHEET 114

SLM 21.69, 21"  
SEE SHEET 114

SLM 21.75, 12"  
SEE SHEET 113

Note: Abandon all existing drainage installations no longer needed in the intersection area of Broadway and Mc Cracken Road under the newly constructed pavement.

\* For detail of special sod location at end of bituminous curb see sheet 102.  
For drainage quantities see sheet 08f89.

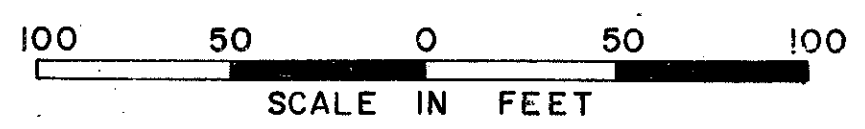

SCALE IN FEET  
1" = 50'  
HOWARD, NEEDLES, TAMMEN & BERGENDOFF  
CONSULTING ENGINEERS  
KANSAS CITY CLEVELAND NEW YORK