

FED. RD. DIVISION	STATE	PROJECT
2	OHIO	

100
241

CUYAHOGA COUNTY
CUY-71-17.18

5
28

- CODE IDENTIFICATION**
- (P) STORM SEWER PIPE
 - (S) STORM SEWER STRUCTURE
 - (SP) SANITARY OR COMBINED SEWER PIPE
 - (SS) SANITARY SEWER STRUCTURE
 - (E) EXISTING STRUCTURE OR SEWER PIPE
 - (U) UNDERDRAIN PIPE
 - (D) DITCH PROTECTION

CODE	LOCATION	E-12		I-1		I-8		I-16		
		Pipe Removed 15" And Under	Pipe Removed Over 15"	Cl. B-1 M 6.8(B)	Cl. B-1 M 6.8(B)	Std. No. 1 M.H.	Std. No. 2 M.H.	Cl. B-1 M 6.8(B) Tee 6"x12"x12"	C.B. Aban.	M.H. Aban.
EXISTING STRUCTURES		Lin. Ft.		Lin. Ft.		Each		Each		
E-1	Dover Ave. E 0+45 to 0+70		25							
E-2	W.35th E 3+11									1
E-3	W.35th Lt. 2+82								1	
E-4	W.35th Rt. 2+84								1	
E-7	Dover Ave. Lt. 1+03								1	
E-8	Dover Ave. Lt. 1+03	25								
E-9	Dover Ave. E 1+20									1
E-10	Dover Ave. Rt. 1+02	25								
E-11	Dover Ave. Rt. 1+02								1	
E-12	Dover Ave. E 1+20 to 4+22	302								
E-13	Dover Ave. E 4+22 to 9+95		573							
E-16	Dover Ave. E 4+22									1
E-17	Dover Ave. E 9+75									1
E-19	W.32nd St. E 1+82 to 6+33	451								
E-22	W.32nd St. E 1+82									1
SANITARY SEWERS										
SP-1				155						
SP-11				78						
SP-12	W.32nd Lt. 2+20		10							
SP-13	W.32nd Lt. 1+90		10							
SP-14	W.32nd Rt. 2+35		10							
SP-15	W.32nd Lt. 6+32		60							
SS-1										1
SS-2										1
SS-3										1
Total		823	598	90	233	2	1	4	4	4

CODE	LOCATION	I-1		I-5	
		Cl. I-3 Deep 6"	Cl. I-3 Shallow 6"	Cl. I-4 6"	Cl. I-3 60" Bend 6"
UNDERDRAINS		Lin. Ft.		Each	
U-1	Ramp O Rt. 12+20 to Lane J Rt. 3+41	739		8	1
U-2	Ramp O Rt. 9+10 to 12+17	307			
U-3	Lane J Rt. 23+95 to 26+00	205			
U-4	S.B. Medina Lt. 879+49 to 887+00	741		10	
U-5	S.B. Medina Lt. 887+04 to 890+00	296			
U-6	E Medina Frwy. Rt. 879+49 to 885+50		587	12	
U-7	E Medina Frwy. Rt. 885+54 to 887+00		134	10	
U-8	E Medina Frwy. Rt. 887+04 to 890+00		296		
U-9	N.B. Medina Rt. 879+49 to 887+00	746		10	1
U-10	N.B. Medina Rt. 887+03 to 890+00	297			
U-11	Lane H Lt. 9+25 to 10+60	135			
U-12	Ramp G Lt. 6+00 to 6+75	75			
U-13	Lane H Rt. 0+00 to Ramp G Rt. 3+75	761		8	1
U-14	Ramp G Rt. 3+78 to 6+75	297			
Total		4599	1017	58	3

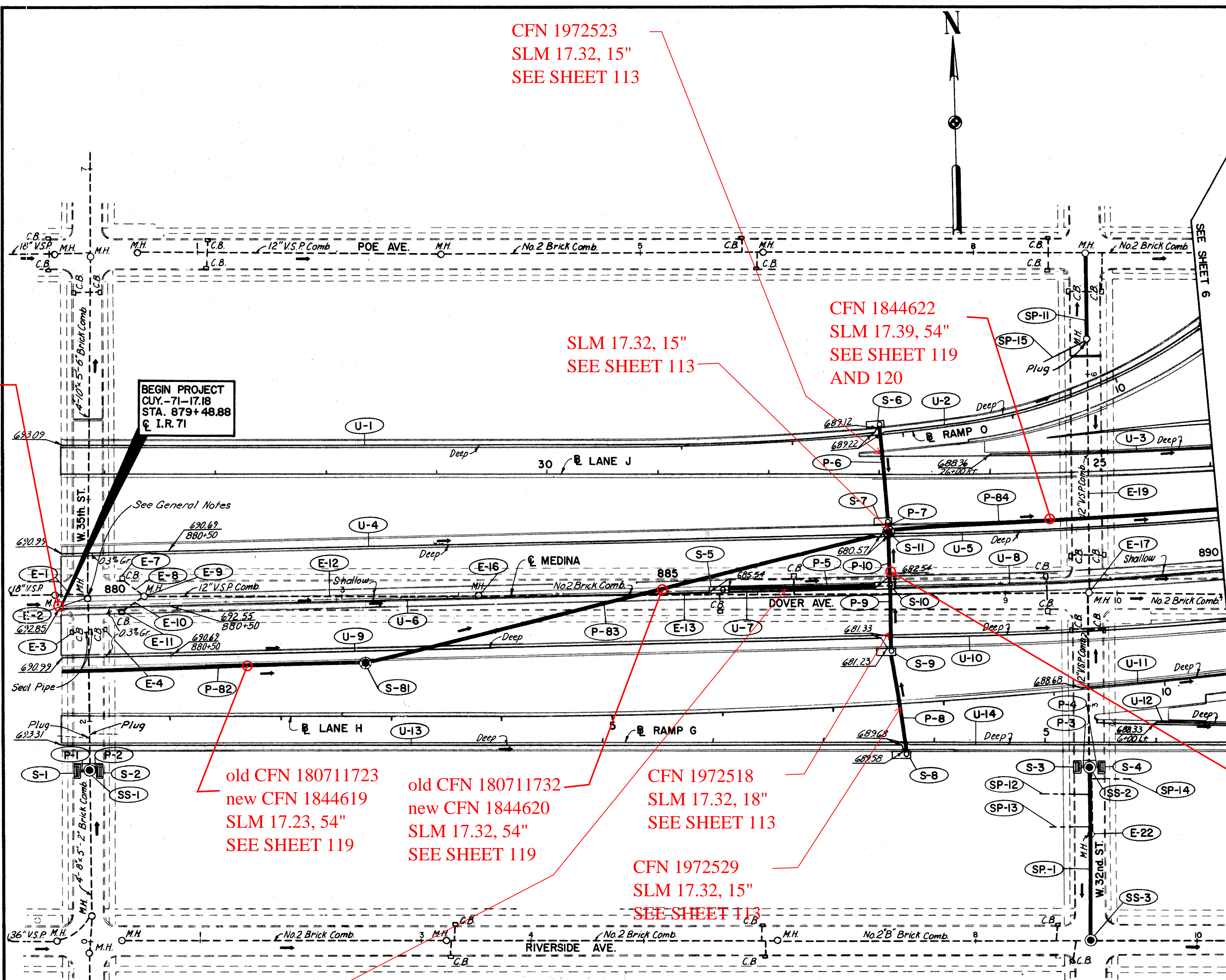

CFN 1972523
SLM 17.32, 15"
SEE SHEET 113

SLM 17.32, 15"
SEE SHEET 113

CFN 1844622
SLM 17.39, 54"
SEE SHEET 119
AND 120

SLM 17.18

BEGIN PROJECT
CUY.-71-17.18
STA. 879+48.88
I.R. 71

old CFN 180711723
new CFN 1844619
SLM 17.23, 54"
SEE SHEET 119

old CFN 180711732
new CFN 1844620
SLM 17.32, 54"
SEE SHEET 119

CFN 1972518
SLM 17.32, 18"
SEE SHEET 113

CFN 1972529
SLM 17.32, 15"
SEE SHEET 113

CFN 1972512
SLM 17.32, 18"
SEE SHEET 113

CFN 1972665
SLM 17.32, 15"
SEE SHEET 113

- DRAINAGE LEGEND**
- (M) PROPOSED STORM SEWER MANHOLE
 - (SM) PROPOSED SANITARY MANHOLE
 - (PSI) PROPOSED PAVED SHOULDER INLET
 - (DCB) PROPOSED DITCH CATCH BASIN
 - (PCB) PROPOSED PAVEMENT CATCH BASIN
 - (SS) PROPOSED STORM OR SANITARY SEWER
 - (M) EXISTING MANHOLE
 - (CB) EXISTING CATCH BASIN
 - (SS) EXISTING STORM OR SANITARY SEWER
 - (JM) JUTE MATTING
 - (SD) SODDED DITCH

SCALE: 1"=40'
MADE: RDL DATE 5-11-65
TRCD: DATE
CKD: RJT DATE 2-11-65

HOWARD, NEEDLES, TAMMEN & BERGENDOFF
CONSULTING ENGINEERS
KANSAS CITY CLEVELAND NEW YORK

100 50 0 50 100
SCALE IN FEET