

B.M. #7... R.R. SPIKE, N. SIDE, 36" MAPLE  
STA. 88+10 (106'L) ADJ. ELEV. = 722.554

B.M. #8... SPIKE, W. ROOT, 24" BEECH  
STA. 92+75 (85'L) ADJ. ELEV. = 770.772

SLM XX, 66"  
See Below

SLM XX, 90"  
See Below

old CFN 43090059  
new CFN 1875638  
SLM 0.59, 66"  
SEE BELOW

SLM XX, 66"  
See Below

CFN XXXXXX  
SLM 0.59, 18"  
See Sheet 231

NORTHBOUND PAVT. CURVE DATA

Δc = 65°-59'-53"
Δc = 2°-30'-00"
Δc = 66°-08'-09.8"
L = 1492.21'
L = 2645.44'
Ca = 442.98'

SOUTHBOUND PAVT. CURVE DATA

Δc = 66°-16'-19.4"
Δc = 2°-27'-39.6"
Δc = 66°-43'-59.0"
L = 1519.58'
L = 452.08'
L = 2254.44'
L = 2439.21'
L = 804.05'

EUCLID SPUR R/W & CURVE DATA

R = 2291.83'
Δc = 2°-30'-00"
Δc = 66°-08'-09.8"
L = 1492.21'
L = 2645.44'
Ca = 442.98'

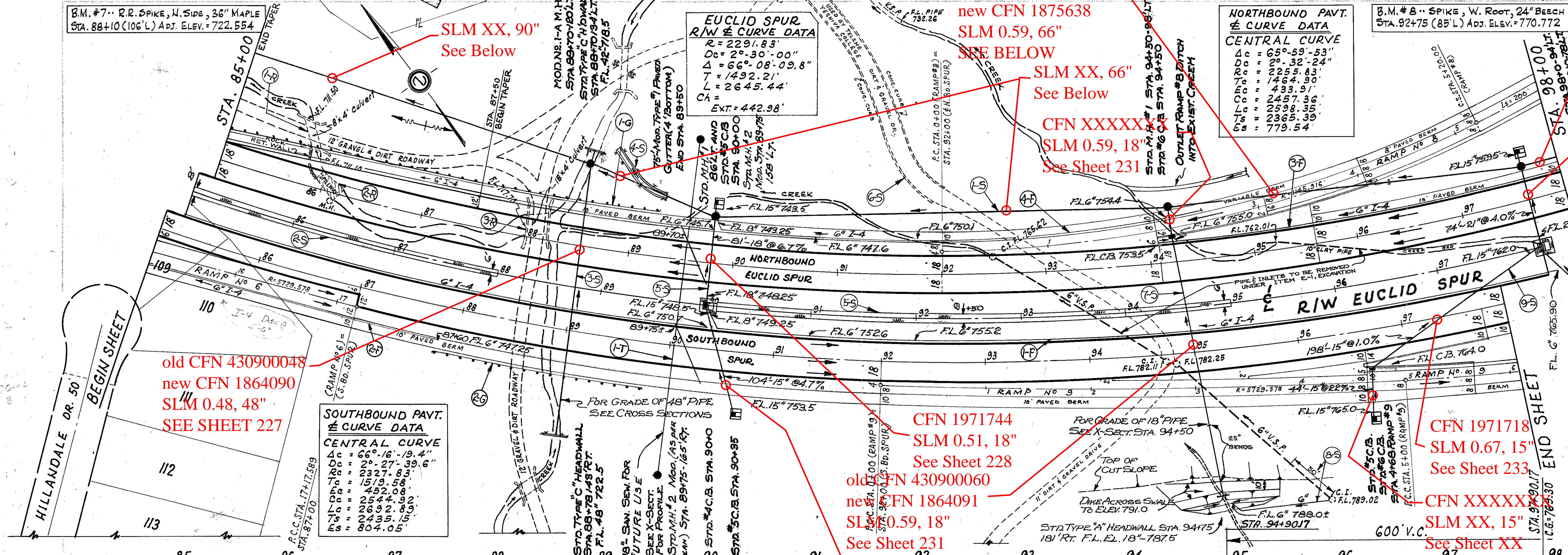

STATION	85	86	87	88	89	90	91	92	93	94	95	96	97	98													
NORTHBOUND MEDIAN EDGE OF PAVT. = DATUM	743.50	744.50	745.50	746.50	747.50	748.50	749.50	750.50	751.50	752.50	753.50	754.50	755.50	756.50	757.50	758.50	759.50	760.50	761.50	762.50	763.50	764.50	765.50	766.50	767.50	768.50	769.50
SOUTHBOUND MEDIAN EDGE OF PAVT. = DATUM SHOWN ON PROFILE	743.50	744.50	745.50	746.50	747.50	748.50	749.50	750.50	751.50	752.50	753.50	754.50	755.50	756.50	757.50	758.50	759.50	760.50	761.50	762.50	763.50	764.50	765.50	766.50	767.50	768.50	769.50

I-15 GUARD RAIL

REF No.	STATIONS	SIDE	STANDARD
I-G	85+00 TO 89+22	L	412.5
I-C	87+32 TO 89+76	R	2000
TOTAL			612.5

6" UNDERDRAIN

REF No.	STATION	SIDE	I-4	I-5	EACH			
I-F	85+19 TO 98+47	R	580	816	10	1	1	
I-R	85+00 TO 87+60	L		260				
I-T	94+10 TO 98+00	R		388				
I-U	85+00 TO 94+24	R	544	440	10	1	1	
TOTAL			1124	260	1644	20	3	2

SANITARY SEWERS

REF No.	STATION	I-2 LIN. FT. 18" M-6.8(b) ENCASED 5" MIN. CL 15" CONGR.	I-8 EACH STD # 2 MANHOLE MODIFIED
I-T	89+75	318	2
TOTAL		318	2

S-24 REMOVAL OF EXIST. STRUCTURE

REF No.	STATION & DESCRIPTION	SIDE	LUMP SUM
I-R	85+95 TO 87 CONC. BOX CONVERT WITH HEADWALL	L	LUMP
I-R	87+30 CONC. SPILLWAY	L	LUMP
I-R	87+30 TO 88 CONC. BOX CONVERT WITH HEADWALL	L	LUMP

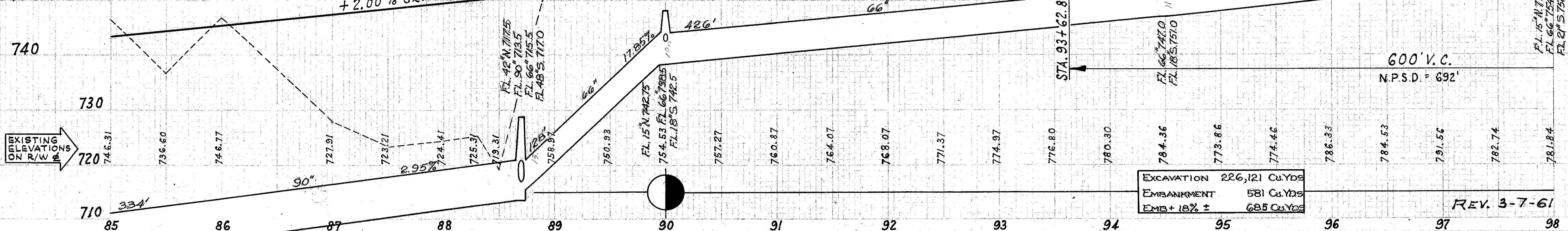

EXCAVATION	226,121 Cu.Yds
EMBANKMENT	581 Cu.Yds
EMB + 18% ±	685 Cu.Yds

REV. 3-7-61

PLAN & PROFILE •• EUCLID SPUR •• STA. 85+00 to STA. 98+00

SEWERS

REF No.	CLASS	SIDE	FROM TO	NO. OF	DIAMETER	DEPTH	LENGTH	REMARKS
I-1	M6.5	R	85+00 TO 88+00	1	18"	48"	126	134
I-2	M6.5	R	88+00 TO 88+50	1	18"	48"	50	52
I-3	M6.5	R	88+50 TO 89+50	1	18"	48"	100	102
I-4	M6.5	R	89+50 TO 90+00	1	18"	48"	50	52
I-5	M6.5	R	90+00 TO 94+24	1	18"	48"	424	426
I-6	M6.5	R	94+24 TO 98+00	1	18"	48"	376	378
TOTAL							1200	1202

SLM XX, 66"  
See Below

CFN 1971724  
SLM 0.67, 21"  
See Sheet 233

CFN 1971718  
SLM 0.67, 15"  
See Sheet 233

CFN XXXXXX  
SLM XX, 15"  
See Sheet XX

CFN 1971720  
SLM 0.51, 15"  
See Sheet 228

CUYAHOGA COUNTY  
Sec. CUY-2-28.16 & CUY-525-0.00  
LAKE COUNTY  
Sec. LAK-525-0.00