

CFN 1971629
SLM XX, 12"
SEE BELOW

FOR PAVEMENT DETAILS & ELEVATIONS
SEE SHEET NOS 71 & 72

FWY CURVE NO 5-E-E DATA
D=0°-20'-00"
Δ=2°-40'-00"
T=400.07'
R=17188.74'
L=800.00'
LC=799.93'
E=4.66'

BM: O.M.X-63 ELEV 641.30
Approx. 31 ft. S.E. of C.L. of Lakeland Blvd and 296 ft. S.W. of C.L. of E. 260th St. 21.26 ft. E. of N.V. I.T. 08T pole #13468 on S.E. side of Lakeland. 54.85 ft. W. of N.W. cor. of 1 story brick bldg #25900 Lakeland.
BM: O.M.G.28 ELEV 641.143
Approx. 35 ft. W. of C.L. of E. 260th St and 27 ft. N. of C.L. of Lakeland Blvd. 31.30 ft. N.W. of MON. at C.L. Int. 12.23 ft. N.E. of C.E.I. pole #234811 on N.W. cor.

FED. RD. DIVISION	STATE	PROJECT	FISCAL YEAR
2	OHIO	I-329(13)	

CUYAHOGA COUNTY
C.U.Y. 2-25.96

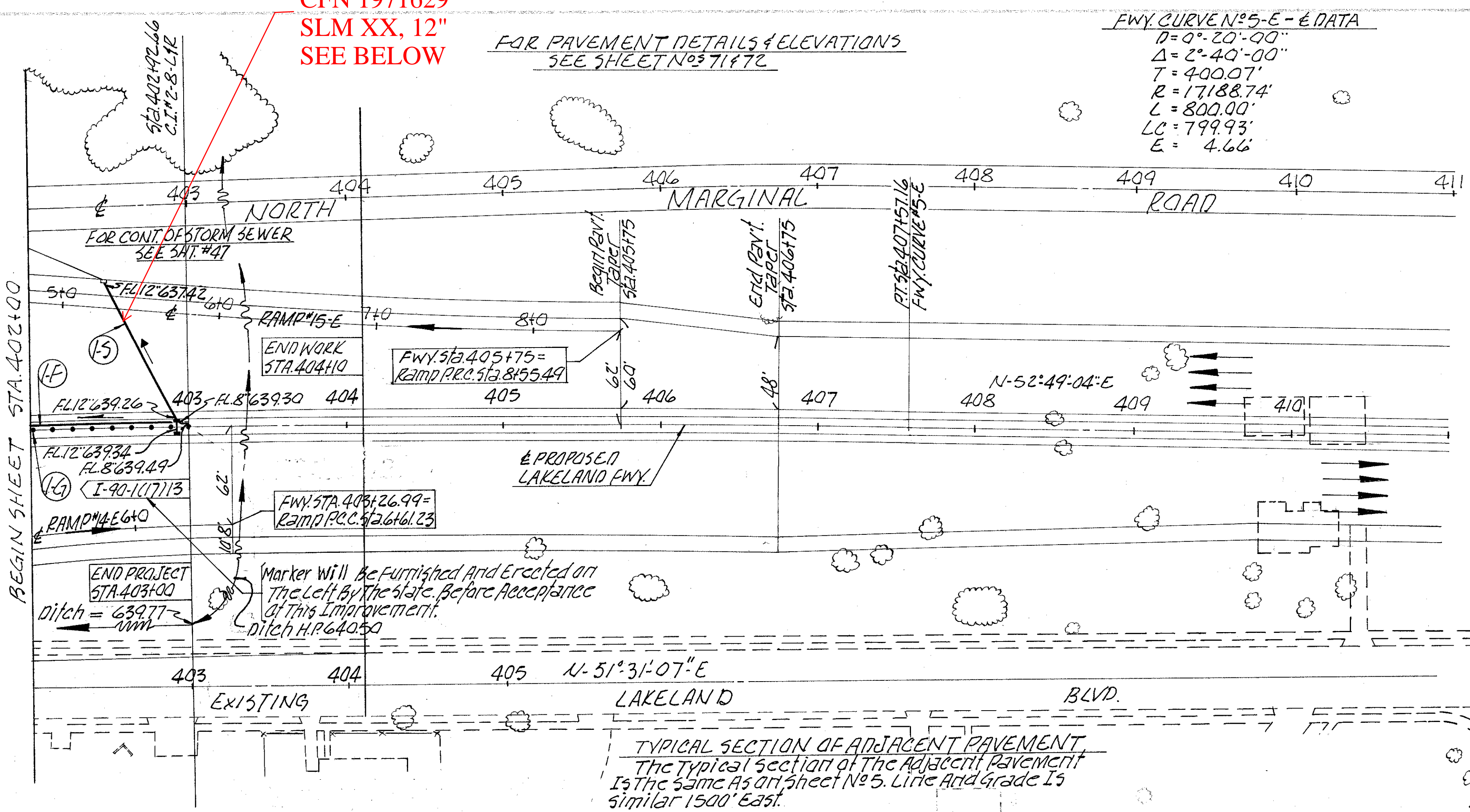

TYPICAL SECTION OF ADJACENT PAVEMENT
The typical section of the adjacent pavement is the same as on sheet No. 5. Line and grade is similar 1500' East.

ITEM No	STATION		SIDE	I-4 LIN. FT.		I-5 EACH								
	FROM	TO		SHALLOW	DEEP	SHALLOW	DEEP	ELBOW	TEE	WYE	BEND	BEND		
1-F	402+00	403+00	E	92										
MAINLINE SHT. NO 35				92										
SUB-TOTAL SHT. NO 35														
2-F	0+00	8+48	L&R	205	26	20	236			2	2			
EXT. LAKELAND BLVD.														
3-F	343+70	347+47	L			355	20							
4-F	0+00	2+50	R	250		10					1			
5-F	3+00	9+00	L	576		20							2	
6-F	0+00	2+00	L	200		10					1			
7-F	2+00	7+15	R	490		20							2	
EXT. LAKELAND BLVD.														
8-F	358+50	363+30	L			458	20							
RAMP NOS 8-E, 9-E, 10-E, 11-E														
SUB-TOTAL SHT. NO 46				1721	839	130	1071	2	3	3	1		4	
1-F	0+00	6+25	R	585		30							3	
2-F	6+25	8+35	L	216		10					1			
3-F	EXT. LAKELAND BLVD.		L			546	30						1	
4-F	0+00	6+41	L&R	620		10							1	
5-F	0+00	6+35	L&R	638		10					3	1		
6-F	EXT. LAKELAND BLVD.		L			547	20						1	
7-F	0+00	2+35	R	244		10							1	
8-F	2+35	5+78	L	321		20							1	
RAMP NOS 12-E, 13-E, 14-E, 15-E														
SUB-TOTAL SHT. NO 47				2624	1093	140					3	2	1	6
TOTAL THIS SHEET				4437	1932	276	1071	2	3	6	3	1	10	1

ITEM No	STATION		SIDE	I-15 LIN. FT.	
	FROM	TO		STEEL BEAM TYPE	BARRIER DESIGN
1-G	402+00	403+00	E	100.00	
TOTAL				100.00	

ITEM No	STATION		SIDE	I-2 LIN. FT.				I-5 EACH		I-8 EACH					I-16 EA. ABANDON	LOCATION OF STRUCTURE	
	FROM	TO		12" CLA	12" CLB	15" CLA	15" CLB	8" CLA	12" CLB	STD. M.H. #1	STD. C.I. #2	STD. C.I. #2	SPEC. C.B. #4	SPEC. C.I. #4			STD. C.B. #5
1-3	402+48	403+00	E&L		6											402+92.66	
MAINLINE SHT. NO 35					6												
SUB-TOTAL SHT. NO 35																	
1-5	4+98	5+00	L					5								5+00	
2-5	LAKELAND	344+25	R					40								EXT. LAKELAND BLVD. 344+25; 271+89; 2+50; 2+74	
3-5	LAKELAND	347+47	L&R					15	17							EXT. LAKELAND BLVD. 347+47; 151+30	
4-5	LAKELAND	355+98	L					22	147							1+00; 2+50; 3+00; 5+22	
5-5	LAKELAND	360+46	L					49								EXT. LAKELAND BLVD. 355+98; 358+89	
RAMP NOS 8-E, 9-E, 10-E, 11-E								22	147								360+43; 1+46; 3+67-RAMP #11-E
SUB-TOTAL SHT. NO 46								15	111							7	
1-5	1+50	2+25	L&R					80								EXT. LAKELAND BLVD. 387+48; 1+75	
2-5	5+92	6+15	R					10								5+92.75; 6+15	
3-5	1+69	4+43	L&R				50	46	284							2+00; 4+38	
4-5	1+55	3+23	L&R	31				30	4							EXT. LAKELAND 399+63; 173; 3+23	
5-5	0+00	2+35	L&R			8		12	216							0+00; 2+35	
6-5	4+52	5+25	L			72										5+25	
RAMP NOS 12-E, 13-E, 14-E, 15-E								30	152	216	284	2	2	1			
SUB-TOTAL SHT. NO 47								31	72	8	50						3
TOTAL THIS SHEET								31	100	8	197						10

STA. 400+00 TO STA. 404+10
Excavation 1536 CU.YDS.
EMBANKMENT 5528 CU.YDS.
EMBANKMENT +22% 6744 CU.YDS.

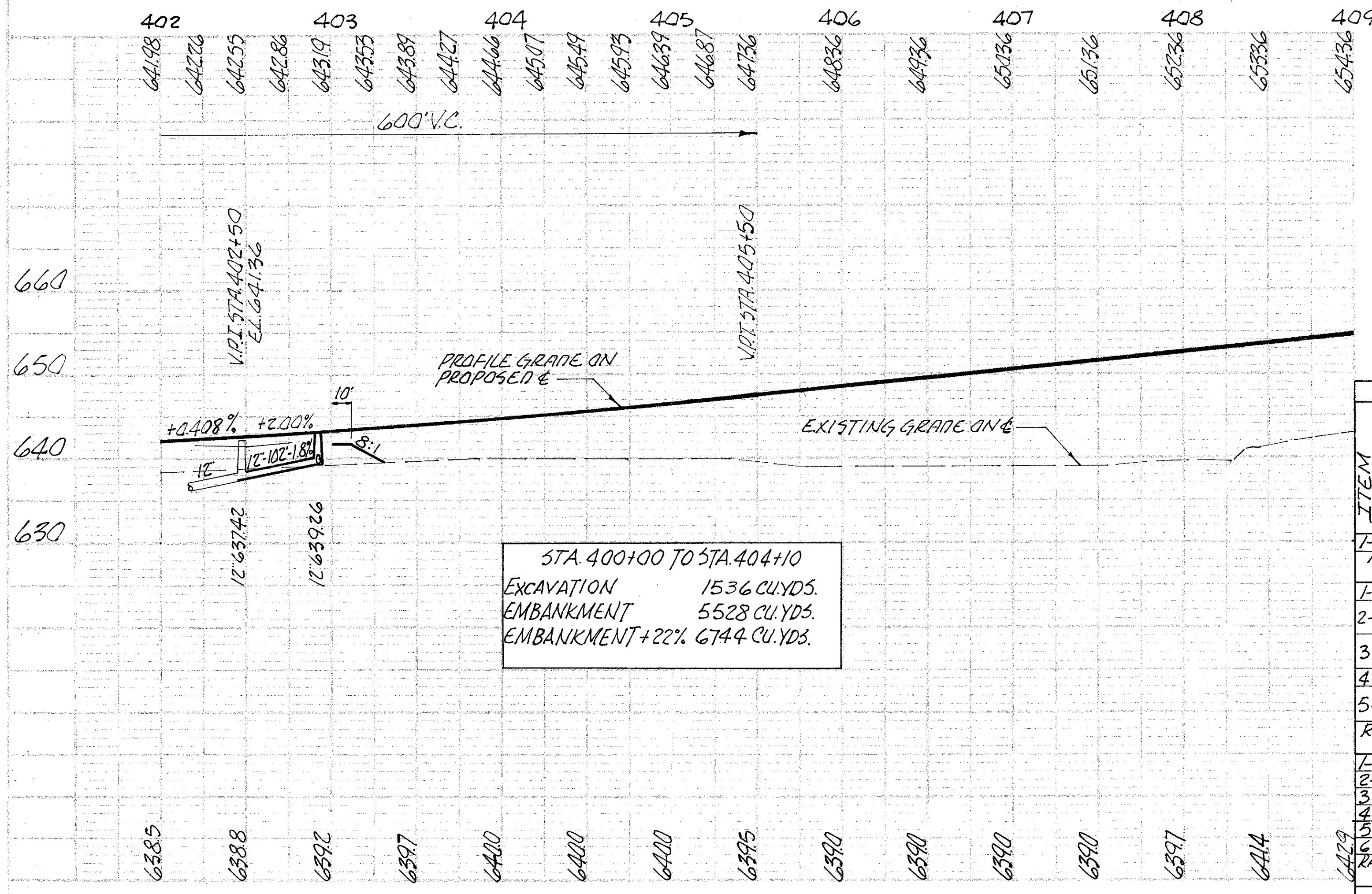

PLAN & PROFILE - MAIN LINE - STA. 402+00 TO STA. 415+00