

CURVE # D-1 Δ = 81°-44'-57" D = 38°-11'-50" R = 150.00' L = 214.02' T = 129.82' E = 48.37'	CURVE # C-D-1 Δ = 80°-23'-33" D = 23°-03'-24" R = 248.50' L = 348.67' T = 209.97' E = 76.83'	CURVE # C-1 Δ = 89°-11'-33" Δc = 64°-16'-53" Dc = 24°-54'-40" Lc = 258.04' Tc = 144.51' Ls1 = 200.00' Ls2 = 0.00' θs = 24.91' p = 7.20' k = 99.37' Xc = 196.25' Yc = 28.60' LT = 134.68' ST = 67.89' Tsl = 326.05' Tsz = 233.98'	CURVE # C-2 Δ = 150°-45'-48" Δc = 125°-51'-08" Dc = 24°-54'-40" Lc = 505.20' Tc = 449.96' Ls1 = 0.00' Ls2 = 200.00' θs = 24.91' p = 7.20' k = 99.37' Xc = 196.25' Yc = 28.60' LT = 134.68' ST = 67.89' Tsl = 326.05' Tsz = 233.98'	CURVE # D-2 Dc = θs = 21°-27'-33" Rc = 267.00' Lc = 0.00' Ls1 = 200.00' p = 6.21' k = 99.53' Xc = 197.21' Yc = 24.72' LT = 134.33' ST = 67.57' Tsl = 366.53' Tsz = 273.21'	CURVE # D-3 Δ = 33°-10'-08" Δc = 25°-10'-08" Dc = 8°-00' Lc = 716.20' Tc = 314.61' Ls1 = 200.00' Ls2 = 0.00' θs = 8°-00' p = 2.33' k = 99.94' Xc = 199.61' Yc = 9.30' LT = 133.47' ST = 66.79' Tsl = 309.67' Tsz = 217.55'	CURVE # D-4 Δ = 9°-30'-00" Ls = 200.00' θa = 6°-30'-00" T1 = 123.06' T2 = 77.40' ΔI=D1 = 1°-30'-00" Δ2=D2 = 8°-00'-00" R1 = 3819.72' R2 = 716.20'	CURVE # D-5 Δ = 6°-50'-00" D = 1°-30'-00" R = 3819.72' L = 455.56' T = 228.05' E = 6.80'	CURVE # 2, U.S. 42 Δ = 20°-05'-46" D = 3°-00" R = 1909.86' L = 669.87' T = 338.41' E = 29.75'
---	---	---	---	---	---	---	---	--

ESTIMATED QUANTITIES

REF. NO.	STATION TO STATION	SIDE	ESTIMATED QUANTITIES															See Sheet No.						
			Class J-1 Pipe				Class I-3 Pipe		Class F-4 Pipe		Class E-1 Pipe		Pipe Specials class I-3				Class I-1		Class I-8		Class I-15		L-10	
			12" Lin.Ft.	15" Lin.Ft.	18" Lin.Ft.	24" Lin.Ft.	6" Shallow Lin.Ft.	8" Lin.Ft.	10" Lin.Ft.	18" Lin.Ft.	Cu.Yd.	Each	Each	Each	Each	Each	Each		Each	Each	Each	Each	Sq.Yd.	
1-D	72+25 to 74+20 Ramp C	Rt.					209	10																
2-D	74+30 to 84+42 Ramp C	Rt.					1026	10																
3-D	84+58 to 85+76 Ramp C	Rt.					146		10															
4-D	74+00 to 75+45 Ramp D	Lt.					135	10																
5-D	75+55 to 83+05 Ramp D	Lt.					766	10																
6-D	83+15 to 89+50 Ramp D	Lt.					657		10															
7-D	72+80 to 82+00 Ramp C	Rt.																				810		
8-D	75+75 to 77+00 Ramp C-D	-	125																					152
9-D	46+00 U.S. 42 to 75+75 Ramp C-D	-	52	106						164														152
10-D	46+00 U.S. 42	-					218																	152
11-D	83+10 Ramp D	-																						150
12-D	73+80 to 74+25 Ramp C-D	Lt.					35	10																
13-D	73+80 to 74+95 Ramp C-D	Rt.					135	10																
14-D	73+00 to 74+00 Ramp D	Lt.					90	10																
1-R	83+88.5 to 85+76 Ramp C	Rt.																						1875
2-R	84+30 to 89+00 Ramp D	Lt.																						450
TOTALS			177	106	218	3199		70	20	164	1.2	2	2	1	4	92	1	2	4	2	637.5	828		

REF. NO.	STATION TO STATION	SIDE	I-12 Concrete Curb				I-21 Portland Cement Conc. Median		I-125 Curb & Island Marking		Channel-Diagonal Stripping	
			Std. Typ. 2A Lin.Ft.	Std. Typ. 7 Lin.Ft.	Std. Typ. 8 Lin.Ft.	Sq.Yd.	Sq.Yd.	Sq.Yd.	Sq.Yd.	Lump	Miles	Lump
1-P	73+72 to 74+30 Ramp C-D	Lt.	209									
2-P	72+91 to 75+30 Ramp D	Lt.	239									
3-P	45+75 to 46+93 U.S. 42	Lt.	146	55								
4-P	73+79 to 79+55 Ramp C-D	Lt.				192						
5-P	79+55 to 81+50 Ramp C	Lt.	108			29						
6-P	83+72 to 89+60 Ramp C	Lt.			114	248						
7-P	787+70 to 788+71	Rt.	106	100			28					
8-P	775+00											
9-P	73+50 Ramp C	Lt.										
TOTALS			808	155	114	248	221	46				

CFN 1972244
SLM 5.45, 12"
SEE SHEET 152

CFN 1972243
SLM 5.45, 12"
SEE SHEET 152

SLM 5.45, 18"
SEE SHEET 152

SLM 5.45, 18"
SEE SHEET 152

CFN 1972245
SLM 5.45, 18"
SEE SHEET 152

CFN 1935342
SLM 5.47, 12"
SEE SHEET 31
AND 71

CFN 1972226
SLM XX, 24"
SEE SHEET 152

SLM XX, 24"
SEE SHEET 152

SLM XX, 24"
SEE SHEET 152

CFN 1935342
SLM 5.57, 15"
SEE SHEETS 77
AND 149

old CFN 180710562
new CFN 1844602
SLM 5.62, 24"
SEE SHEET 150

For Details of Ramps C, C-D, D
See Sheets No. 123, 124, 126

For Details of Pearl Rd.-U.S. 42
See Sheets No. 86 to 97

See Sheet No. 32 for
Details of Grading
beyond end of Project.

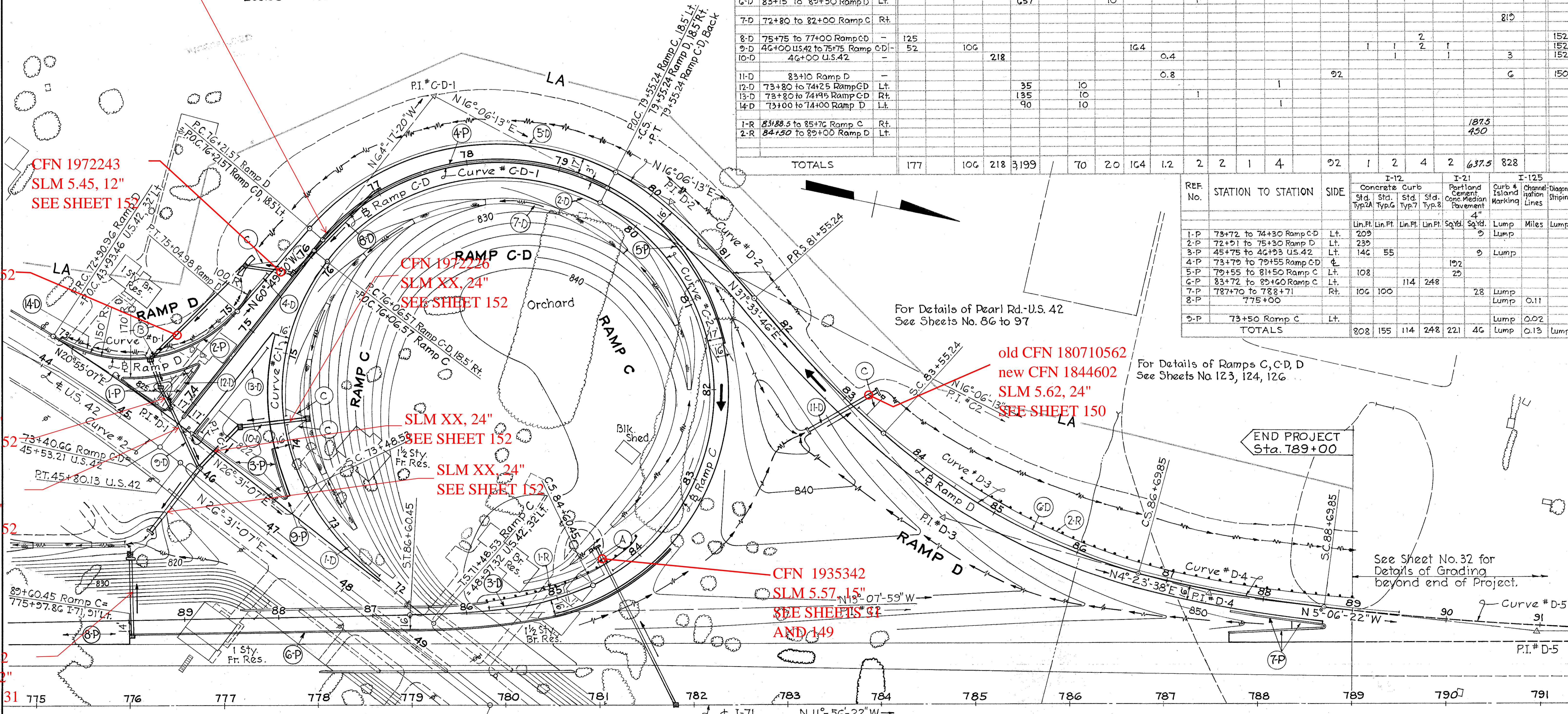

© See Detail Sheet No. 15G.