

ESTIMATED QUANTITIES					
		I-16 ABANDONED CATCH BASINS EACH	L-120 MAN- HOLES EACH	5-24 JUTE MATTING SQ.YD.	REMOVAL OF EXISTING STRUCTURE LUMP
1-DR	775+93	6			
2-DR	778+23				
3-DR	781+19	2	3		
4-DR	784+79	2	2		
5-DR	787+78	2	2		
6-DR	789+73		2		
7-DR	781+64				LUMP
8-DR	783+18				LUMP
1-D	778+07			32	
2-D	778+57			125	
3-D	778+43			125	
4-D	780+07			125	
5-D	786+43			125	
6-D	788+07			53	
7-D	787+93			125	
8-D	789+57			36	
TOTALS		6	12	744	LUMP

FOR SEWER PROFILES  
 SEE SHEET NOS 314, 327, 328 & 329

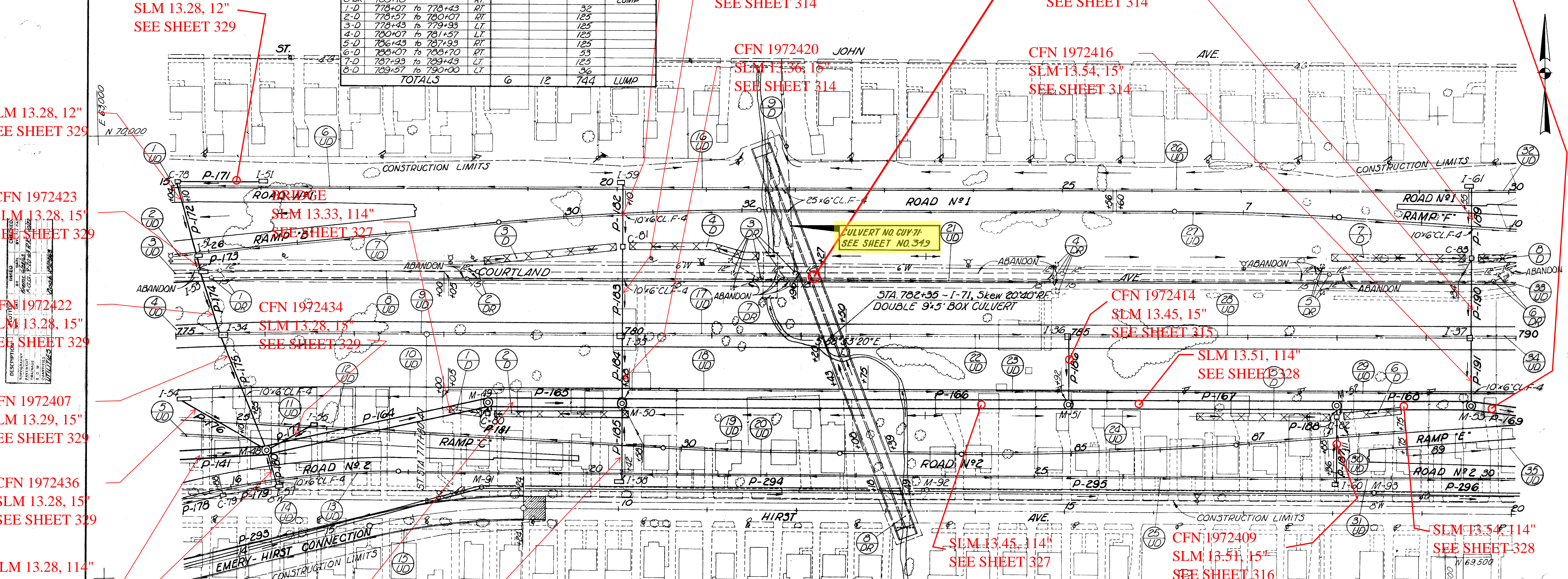

SLM 13.28, 12"  
SEE SHEET 329

SLM 13.28, 12"  
SEE SHEET 329

CFN 1972423  
SLM 13.28, 15"  
SEE SHEET 329

CFN 1972422  
SLM 13.28, 15"  
SEE SHEET 329

CFN 1972407  
SLM 13.29, 15"  
SEE SHEET 329

CFN 1972436  
SLM 13.28, 15"  
SEE SHEET 329

SLM 13.28, 114"  
SEE SHEET 325

CFN 1972421  
SLM 13.28, 12"  
SEE SHEET 329

CFN 1972412  
SLM 13.36, 15"  
SEE SHEET 314

CFN 1972424  
SLM 13.36, 15"  
SEE SHEET 314

CFN 1972420  
SLM 13.36, 15"  
SEE SHEET 314

CFN 1972418  
SLM 13.54, 15"  
SEE SHEET 314

CFN 1972405  
SLM 13.54, 15"  
SEE SHEET 314

CFN 1972416  
SLM 13.54, 15"  
SEE SHEET 314

BRIDGE  
SLM 13.59, 114"  
SEE SHEET 328

SLM 13.36, 114"  
SEE SHEET 327

CFN 1972406  
SLM 13.36, 15"  
SEE SHEET 314

ESTIMATED QUANTITIES N°1											
REF.	STATION TO STATION	SIDE	CLASS I-1			I-5 PIPE SPL			I-3		
			CLASS F-4	SHALLOW	DEEP	60" BEND	60" WYE	TEE	60" BEND	60" WYE	
1-UD	15+01 N°1	to 15+07 N°1	LT.	6		3					
2-UD	25+59 B	to 25+81 B	RT.			22					
3-UD	775+00	to 775+26	LT.					26			
4-UD	775+00	to 775+46	E					46			
5-UD	24+37 C	to 25+10 C	RT.					73			
6-UD	15+07 N°1	to 20+07 N°1	LT.	6		497			1		
7-UD	15+85 B	to 25+56 N°1	RT.			471		45			
8-UD	775+30	to 781+36	LT.	20		531		269		2	
9-UD	775+50	to 779+96	E	10		261		175			
10-UD	775+00	to 779+96	RT.	20		195		285		2	
11-UD	25+25 C	to 25+85 C	LT.	10				50			
12-UD	25+85 C	to 29+30 C	LT.	10				295		40	
13-UD	15+42 N°2	to 20+35 N°2	RT.	15				254		235	
SUB-TOTAL TO QUANT. BLOCK N°3				97		732		2162		1242	
TOTALS				CONT.		CONT.		CONT.		CONT.	5

ESTIMATED QUANTITIES N°2											
REF.	STATION TO STATION	SIDE	CLASS I-1			I-5 PIPE SPL			I-3		
			CLASS F-4	SHALLOW	DEEP	60" BEND	60" WYE	TEE	60" BEND	60" WYE	
14-UD	13+35 E-H	to 17+24 E-H	LT.			349					
15-UD	13+35 E-H	to 17+24 E-H	RT.			349					
16-UD	20+07 N°1	to 25+56 N°1	LT.	6		521					
17-UD	780+00	to 782+20	E	10		210					
18-UD	780+00	to 782+34	RT.	10				241			
19-UD	29+32 C	to 23+08 N°2	LT.	10				310		1	
20-UD	20+39 N°2	to 23+18 N°2	RT.	6				276		1	
21-UD	782+27	to 789+50	LT.	10		273		468			
22-UD	782+50	to 785+00	RT.	10		240					
23-UD	782+75	to 785+00	RT.	10				215			
24-UD	23+39 N°2	to 30+00 E	LT.	10				500			
25-UD	23+49 N°2	to 23+39 N°2	RT.	6				490			
26-UD	25+60 N°1	to 29+38 N°1	LT.	6		240		155		1	
SUB-TOTAL TO QUANT. BLOCK N°3				94		2182		2635		1354	
TOTALS				CONT.		CONT.		CONT.		CONT.	5

ESTIMATED QUANTITIES N°3											
REF.	STATION TO STATION	SIDE	CLASS I-1			I-5 PIPE SPL			I-3		
			CLASS F-4	SHALLOW	DEEP	60" BEND	60" WYE	TEE	60" BEND	60" WYE	
27-UD	25+60 N°1	to 10+05 E	RT.	10		293		148			
28-UD	785+04	to 789+50	E	10		436					
29-UD	785+04	to 790+00	RT.	10				486			
30-UD	88+00 E	to 88+25 E	LT.	10		87				1	
31-UD	28+43 N°2	to 30+39 N°2	RT.					196			
32-UD	29+58 N°1	to 30+08 N°1	LT.					46			
33-UD	789+54	to 790+00	LT.					46		46	
34-UD	789+54	to 790+00	E					46		46	
35-UD	88+73 E	to 89+97 E	RT.					122			
SUB-TOTALS FROM QUANT. BLOCK N°1				97		732		2162		1242	
SUB-TOTALS FROM QUANT. BLOCK N°2				94		2182		2635		1354	
SUB-TOTALS				191		950		4797		2596	
TOTALS				251		9745		1354		2596	5