

CFN 1972355
SLM 9.91, 33"
SEE SHEET 70

SLM 9.91, 15"
SEE SHEET 70

SLM 9.94, 36"
SEE SHEET 70

CUYAHOGA COUNTY
CUY - 71 - 9.60

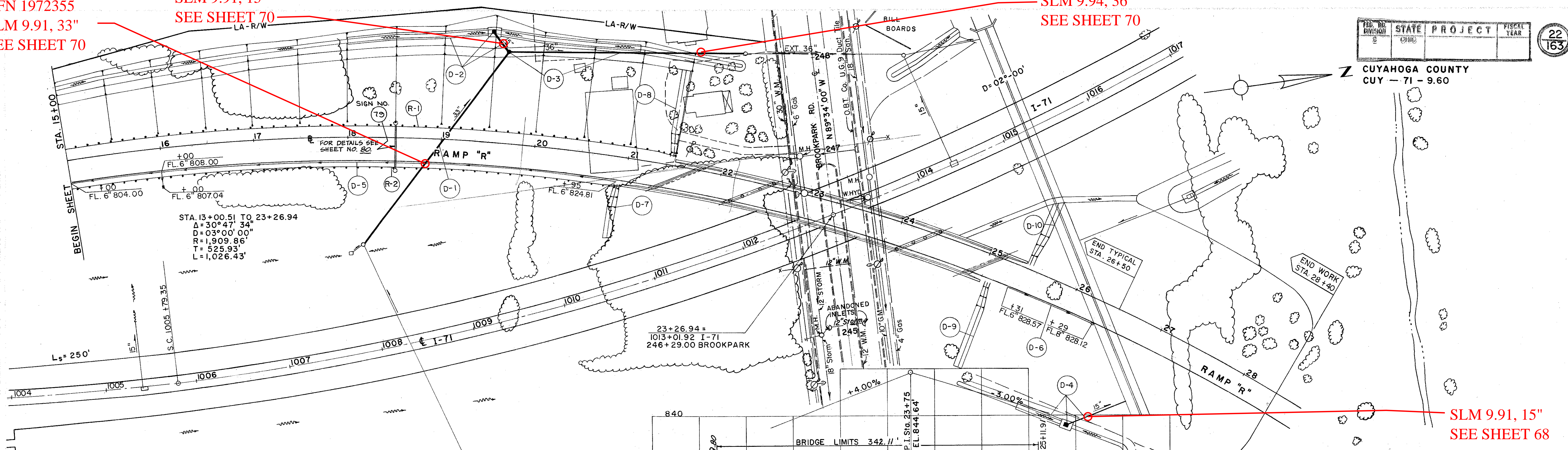

SLM 9.91, 15"
SEE SHEET 68

NOTE:
EMBANKMENT & DRAINAGE ONLY TO BE
CONSTRUCTED UNDER THIS CONTRACT
BETWEEN STA. 25+11 TO STA. 28+40.

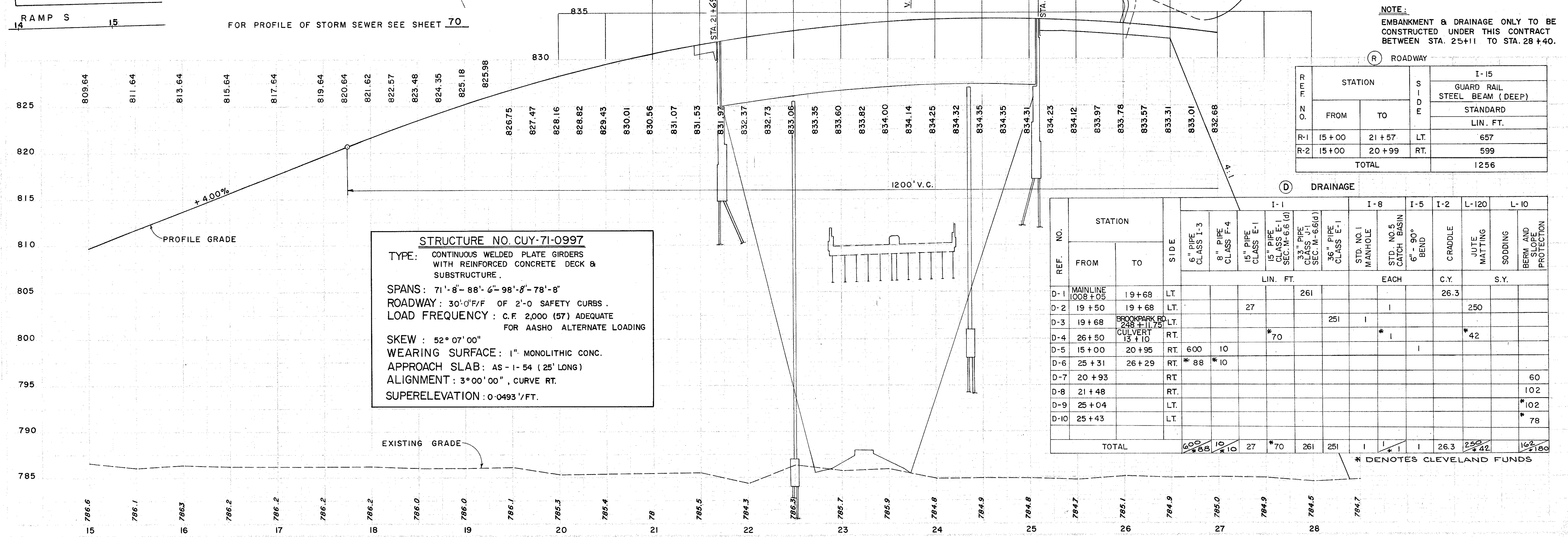

STRUCTURE NO. CUY-71-0997
TYPE: CONTINUOUS WELDED PLATE GIRDERS WITH REINFORCED CONCRETE DECK & SUBSTRUCTURE.
SPANS: 71'-8" - 88'-6" - 98'-8" - 78'-8"
ROADWAY: 30'-0" F/F OF 2'-0" SAFETY CURBS.
LOAD FREQUENCY: C.F. 2,000 (57) ADEQUATE FOR AASHO ALTERNATE LOADING
SKEW: 52° 07' 00"
WEARING SURFACE: 1" MONOLITHIC CONC.
APPROACH SLAB: AS - 1-54 (25' LONG)
ALIGNMENT: 3° 00' 00", CURVE RT.
SUPERELEVATION: 0-0493' / FT.

STATION	STATION		SIDE	I-15 GUARD RAIL STEEL BEAM (DEEP) STANDARD LIN. FT.
	FROM	TO		
R-1	15+00	21+57	LT.	657
R-2	15+00	20+99	RT.	599
TOTAL				1256

REF. NO.	STATION		SIDE	DRAINAGE												
	FROM	TO		6" PIPE CLASS I-3	8" PIPE CLASS F-4	15" PIPE CLASS E-1	15" PIPE CLASS E-1 SEC. M-6.6 (d)	33" PIPE CLASS J-1 SEC. M-6.6 (d)	36" PIPE CLASS E-1	I-8 STD. NO. 1 MANHOLE	I-5 STD. NO. 5 CATCH BASIN	I-2 6" - 90° BEND	L-120 CRADLE	L-10 JUTE MATTING	L-10 SODDING	L-10 BERM AND SCAPE PROTECTION
D-1	1008+05	19+68	LT.					261								
D-2	19+50	19+68	LT.			27								250		
D-3	19+68	248+11.75	LT.					251								
D-4	26+50	248+11.75	RT.				*70							*42		
D-5	15+00	20+95	RT.													
D-6	25+31	26+29	RT.	*88	*10											
D-7	20+93		RT.													60
D-8	21+48		RT.													102
D-9	25+04		LT.													*102
D-10	25+43		LT.													*78
TOTAL				600	10	27	*70	261	251	1	1	1	26.3	250	42	160

* DENOTES CLEVELAND FUNDS