

PK. Set N.E. Side
Comm. Pole # 1.2424 M
PK. Set S.E. Side
1st pole South.
L.I.P. @ P.I.
45.20'

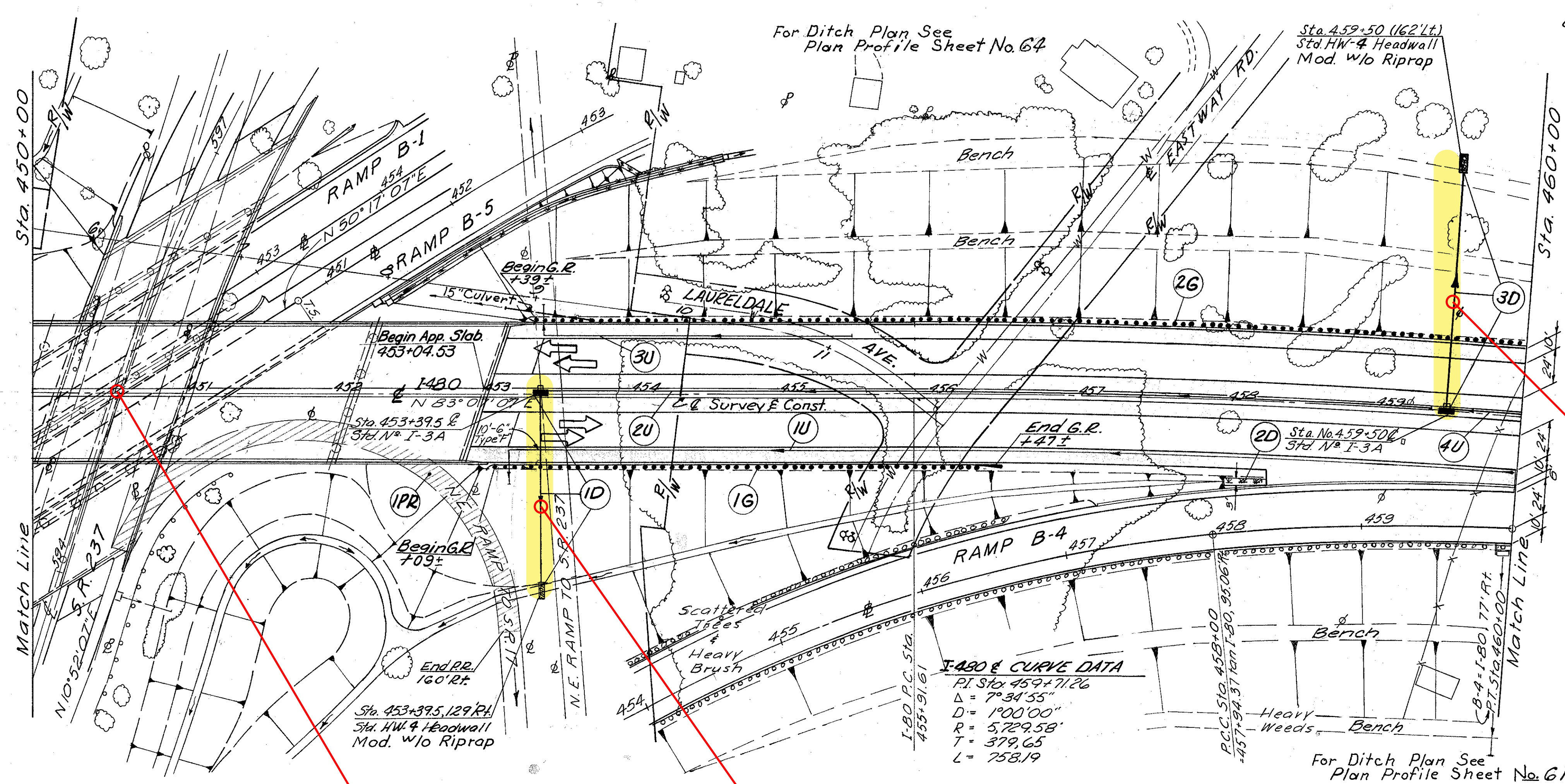

ROADWAY

Ref. Side	Location	S.Y.	Pavement Removed		Anchor Assembly		Guard Rail Type		Bridge Terminal Assy.	
			202	606	Type F	5 Standard	Type F	Type E		
1G Rt.	453+09 to 456+47				1	1			337.5	
2G Lt.	453+39 to 460+00								664.5	1
1PR Lt.	460+00 to 453+20	572								
Total		572			1	1			1002.0	1

Tree Removal
450+00 to 460+00

18"	70
30"	7

CFN 1974223
SLM 8.18, 15"
SEE SHEET 231

DRAINAGE

Ref. No.	Side	Location	Rock Channel		Type "F"		Median Inlet		Deep		Shallow		Unclassified		Bends & Branches		Sodding	
			6"	15"	6"	15"	6"	15"	6"	15"	6"	15"	6"	15"	6"	15"	6"	15"
1D	Rt.	453+39.5	3.1	.27														
2D	Rt.	458+00 to 458+30																10
3D	Lt.	459+50	2.7	0.27														
1U	Rt.	453+17 to 460+00																
2U	Med.	453+40 to 459+38																
3U	Lt.	453+40 to 455+50																
4U	Med.	459+50 to 460+00																
Total			5.8	.54	50	194	114	2										10

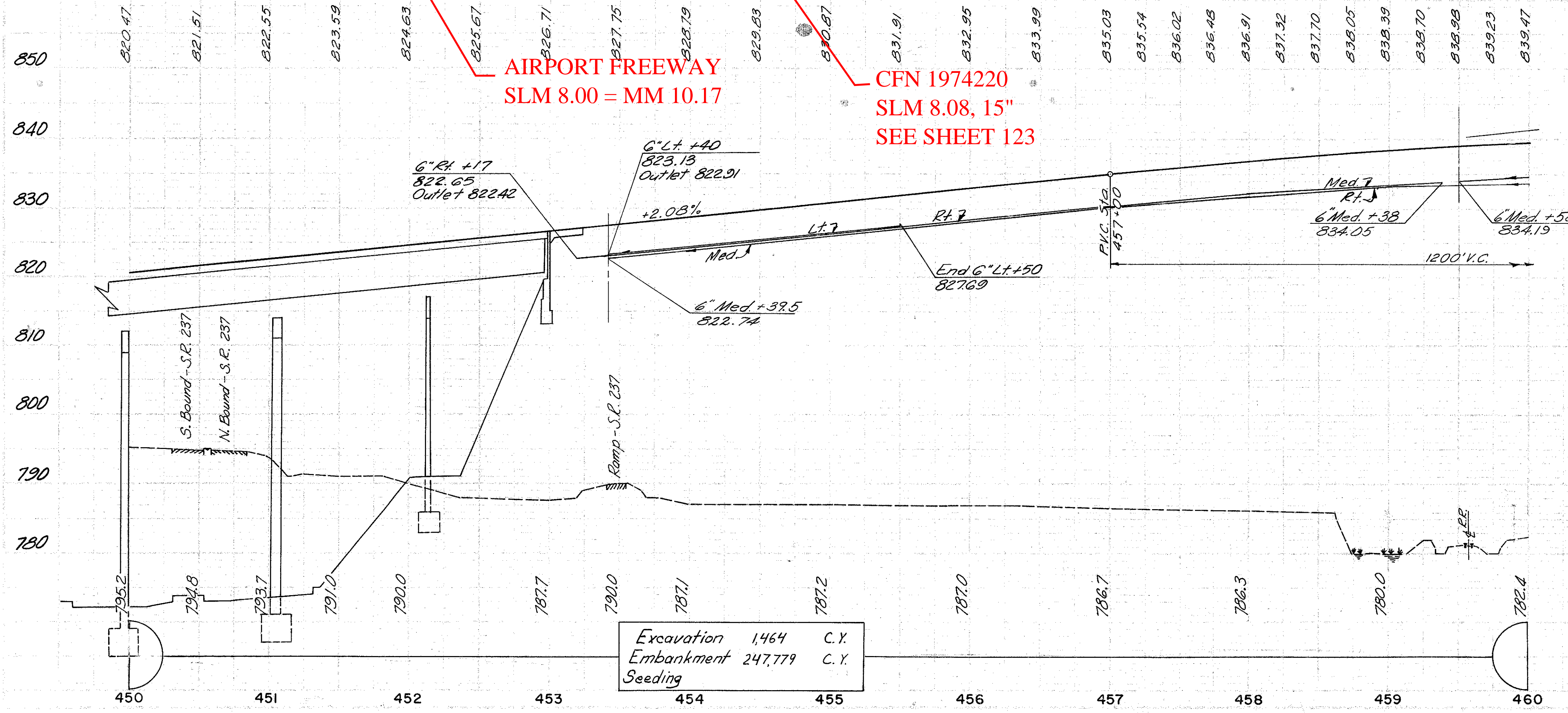

AIRPORT FREEWAY
SLM 8.00 = MM 10.17

CFN 1974220
SLM 8.08, 15"
SEE SHEET 123

Excavation	1,464	C.Y.
Embankment	247,779	C.Y.
Seeding		

PROPOSED STRUCTURE NO. CUY-480-0800

TYPE: Superstructure, continuous steel plate girder with reinforced concrete deck. Substructure, reinforced concrete at abutments and Piers 1 & 4. Steel box girder cap or reinforced concrete at Piers 2 & 3.

SPANS: 87'-0", 109'-0", 109'-0", 87'-0" 5/8" Big.

ROADWAY: 96'-0" 1/4" parapets with Type 1 Railing and 6'-0" raised median.

LOADING: C.F.-2000 (1957) Adequate for A.A. 3H.0 alternate loading.

WEARING SURFACE: 1" Monolithic concrete.

SKREW: 17° 45' Lt. Fwd. with respect to Ref. Tan.

ALIGNMENT: Tangent

APPROACH SLABS: AS-1-67 (25' long)

CROSS REFERENCE

Sht. No.	Item
123,231	Storm Sewer Profile
79	Pavement Details
188	Water Line Work
409,433	Structures (Stack)
467	Retaining Wall: B-5