

SLM 8.22, 12"
SEE SHEET 188

SLM 8.29, 12"
SEE SHEET 188

SLM 8.33, 24"
SEE SHEET 188

SLM 8.35, 24"
SEE SHEET 188

HOLLAND ROAD
SLM 8.35=MM 237.06

STATE	PROJECT	FISCAL YEAR
OHIO		

CUYAHOGA COUNTY
CUY - 71 - 5.72

FOR DETAILS ON STRUCTURE NO. I-71-836
SEE SHEETS 318 TO 327

STA. 928+48.69 I-71
STA. 9+41.98 HOLLAND RD.

④ DRAINAGE

REF. NO.	STATION	SIDE	ITEM										C.Y.	S.Y.						
			I-1	I-2	I-3	I-4	I-5	I-6	I-7	I-8	I-9	I-10								
D-1	919+00	LT.	857	20																
D-2	919+00	RT.	825	20																
D-3	919+80	LT.			98															
D-4	919+00	LT.																		
D-5	923+80	LT.			62	46														
D-6	922+40	LT.																		
D-7	927+53	LT.																		
D-8	927+48	LT.																		
D-9	926+21	RT.																		
D-10	928+83	LT.																		
D-11	927+52	LT.																		
D-12	927+62	RT.																		
TOTAL			1682	40	160	46	38	466	1	2	2	3	1	1	1	0.23	2	250	380	71

④ DRAINAGE HOLLAND ROAD

REF. NO.	STATION	SIDE	ITEM					REF. NO.	LOCATION	EA.	
			I-6	I-1	E-12	I-16	E-12				
D-13	8+20	RT.	208	48	208	2	46	W-14	924 + 07	7' RT.	1
D-14	8+67	RT.						W-15	924 + 40	75' LT.	1
TOTAL			208	48	208	2	46	TOTAL			2

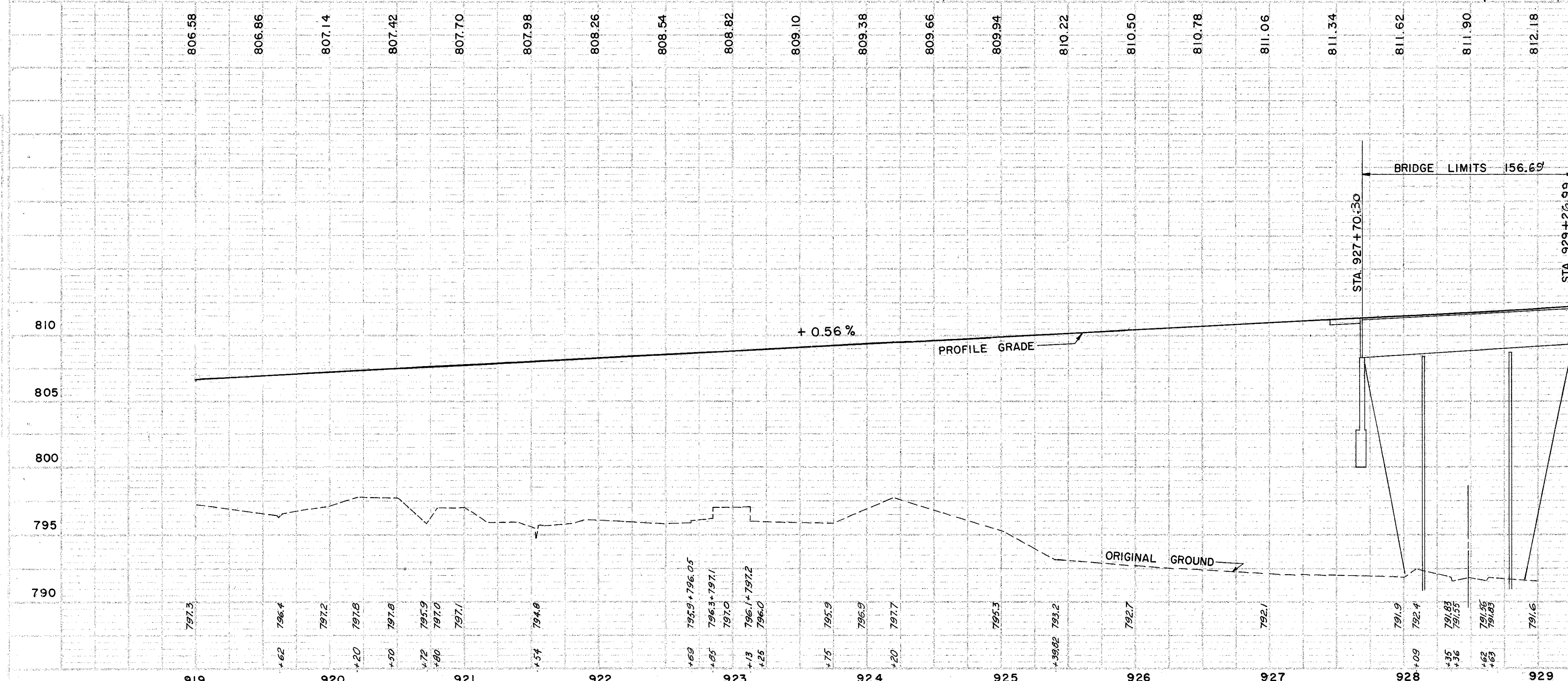

ROADWAY

REF. NO.	STATION	SIDE	ITEM T-15		LIN. FT.
			GUARD	RAIL FENCE	
GR 39	919+095	RT.	862.5	-	
GR 40	920+96	LT.	650	-	
GR 41	919+00	M.	LESS STRUCTURE	870	
TOTAL			1587.5	870	

STRUCTURE NO. CUY-71-0836

TYPE: CONTINUOUS STEEL BEAM WITH REINFORCED CONCRETE DECK AND SUBSTRUCTURE

SPANS: 44'-6" - 63'-2" - 44'-6" C/C BEARINGS

ROADWAY: 108'-0" F/F OF PARAPETS

LOAD FREQUENCY: C.F. = 2000 (57)

ADEQUATE FOR AASHTO ALTERNATE LOADING

SKIEW: 3° 31' 55"

WEARING SURFACE: 1" MONOLITHIC CONCRETE

APPROACH SLAB: AS-I-54 (25' LONG)

ALIGNMENT: 1° 15' CURVE LEFT

PLAN & PROFILE - STA. 919 + 00 TO STA. 929 + 00