

CUYAHOGA COUNTY
CITY OF CLEVELAND
MEDINA-CLARK INTERCHANGE
CUY- 71-18.54
CUY- 90-13.81

I-B STRUCTURES					
CODE	LOCATION	M.H. No. I-A Mod.	M.H. No. 2	M.H. No. I-A Bolt Down Cover	
178	950+46 Clark Freeway 58' LT.	1			
128	951+50 Clark Freeway 58' LT.	1	1		
177	953+80 Clark Freeway 58' LT.	1			
173	23+59 Lane S-E 14' RT.		1		
163	0+00 Outfall Sewer 4'			1	
TOTALS		2	2	1	

I-1 PIPE								
CODE	ROADWAY	INLET CODE		CLASS B-1	CLASS B-1	CLASS E-1	CLASS E-1	CLASS
		FROM	TO	Sec. M-106.6(c) 90"	Sec. M-106.6(c) 90" R-75'	90"	Sec. M-6.6(b) 90"	G-1 M-206.7(a) 113" x 72"
P-178	Clark Freeway	178	128				102	
P-128	Clark Freeway	128	177	228				
P-177	Clark Freeway	177	173	361	49			
P-173	Lane S-E	173	163	59		101		
P-163	Outfall Sewer	163	-					25
TOTALS				648	49	101	102	25

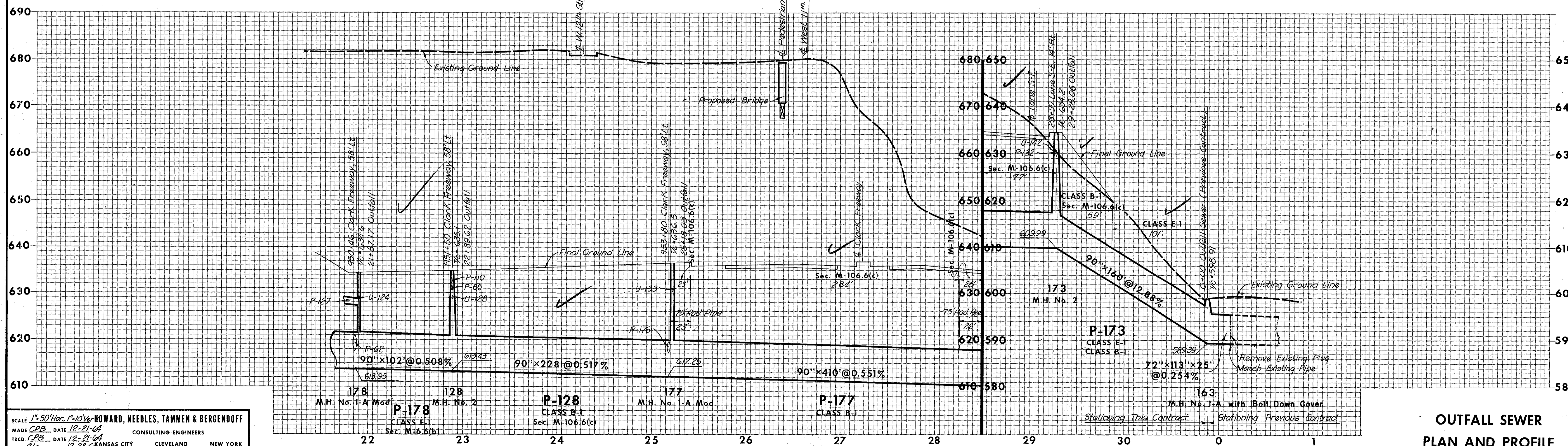
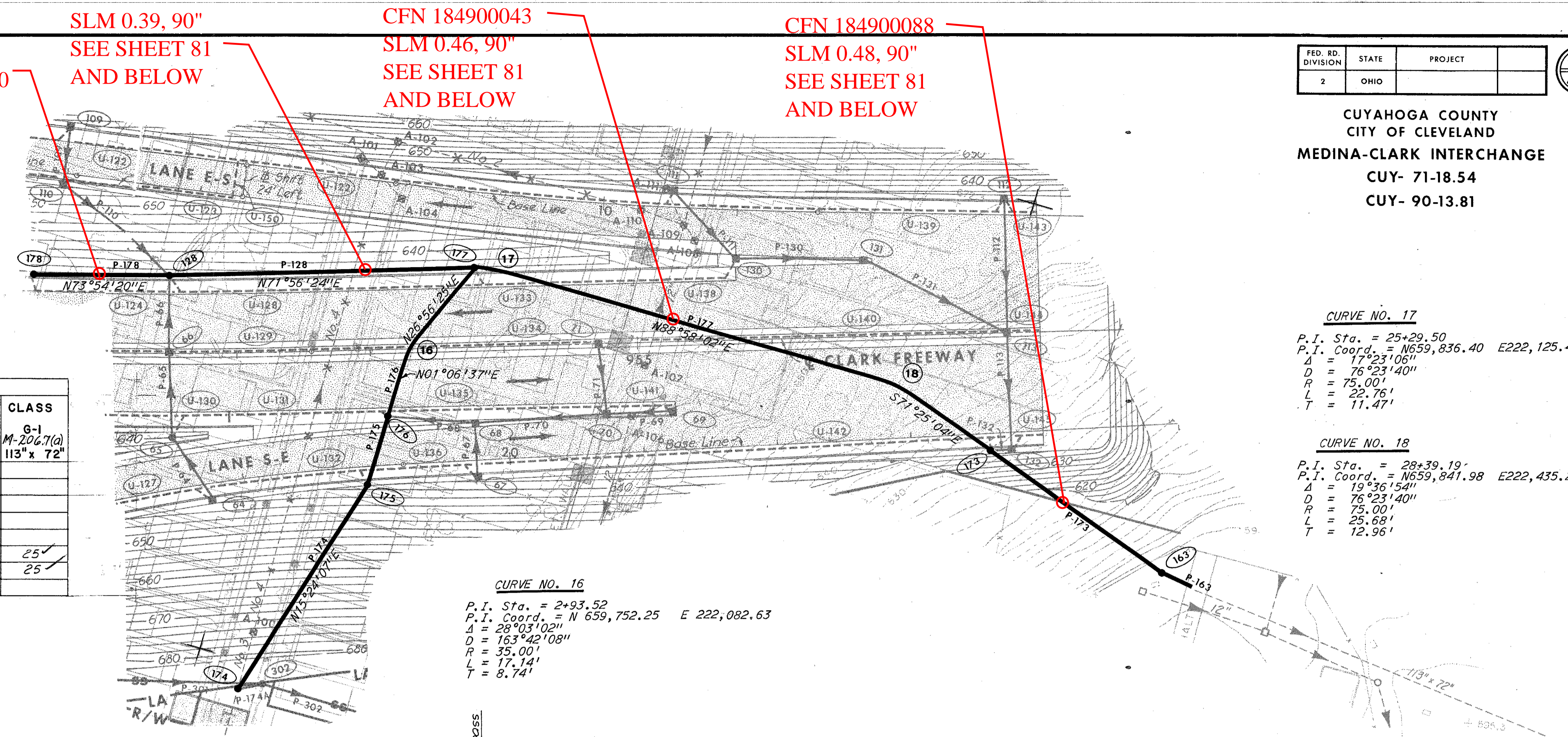

SCALE 1"=50' Hor., 1"=10' Ver. HOWARD, NEEDLES, TAMMEN & BERGENDOFF
MADE CBB DATE 12-21-64 CONSULTING ENGINEERS
TRCD CBB DATE 12-21-64
CKD: Cfs DATE 12-22-64 KANSAS CITY CLEVELAND NEW YORK

OUTFALL SEWER
PLAN AND PROFILE