

I:\ProjectData\ATH\4589-ATH-329-5.26\Design\Roadway\Sheets\4589\_MN002.dgn\_Sheet 3/4/2022 8:41:55 AM amorelan

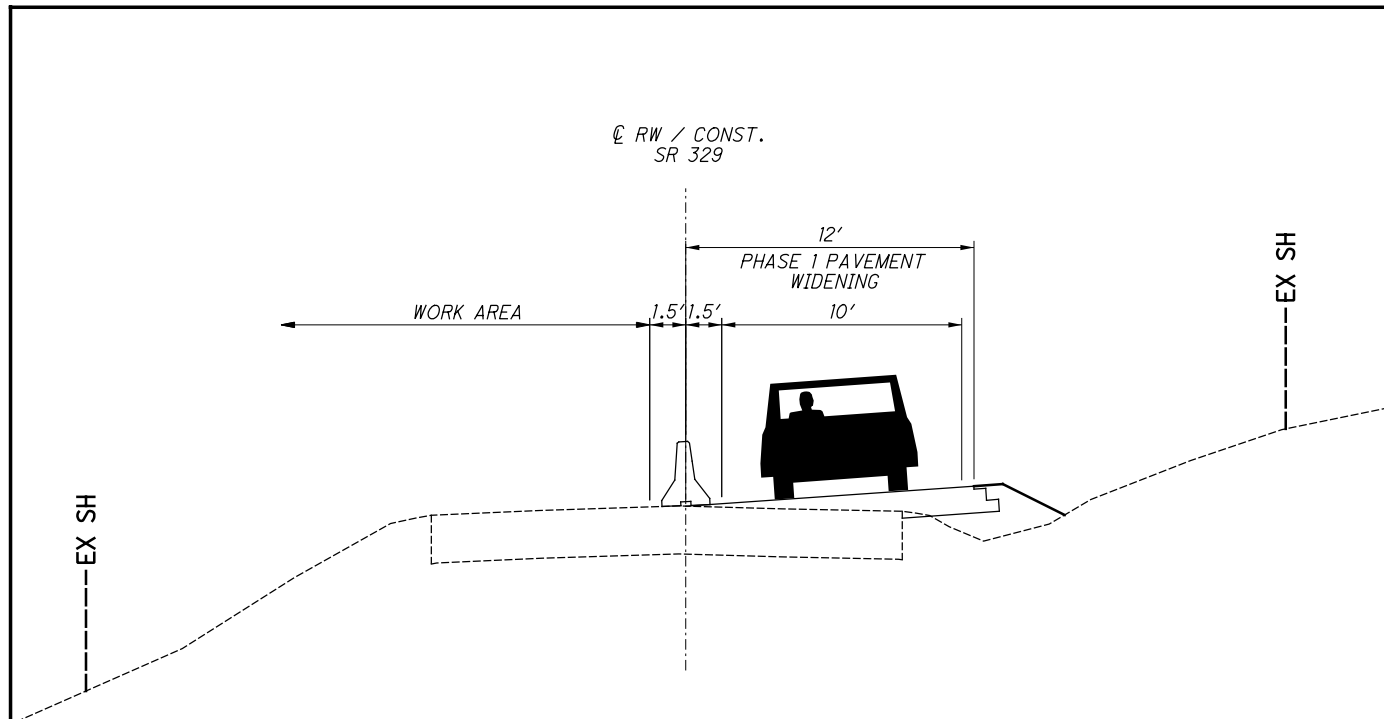

TYPICAL PHASE 2 MOT

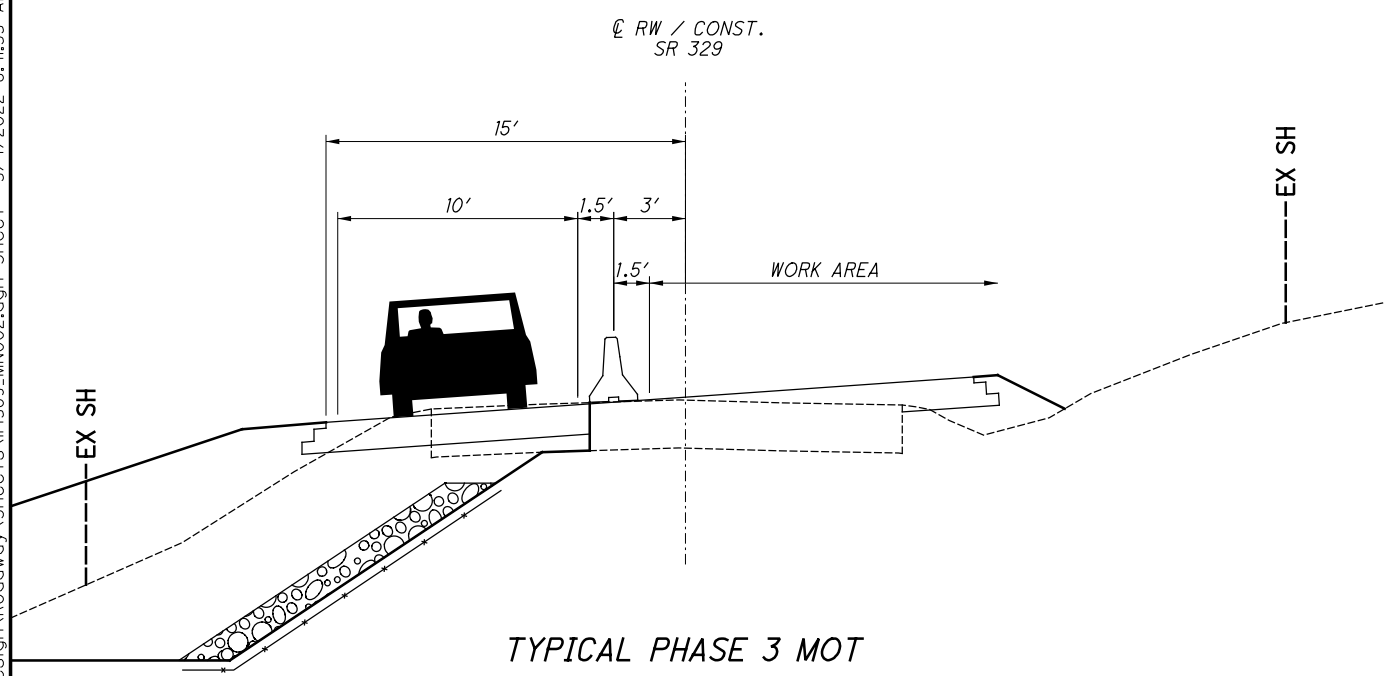

TYPICAL PHASE 3 MOT

SUPERELEVATION TABLE												
P.I. STATION - N/A						DC = N/A						
LEFT SIDE					CENTERLINE CONTROL		RIGHT SIDE					REMARKS
EDGE ELEVATION	TRANSITION RATE	ELEVATION CORRECTION	CROSS SLOPE #	TRANSITION WIDTH #	STATION	PROFILE GRADE	WIDTH	CROSS SLOPE	ELEVATION CORRECTION	TRANSITION RATE	EDGE ELEVATION	
624.29	-	-0.24	-0.016	15	276 + 50.00	624.53	12	-0.016	-0.19	-	624.33	MATCH EX.
625.17	-	-0.24	-0.016	15	277 + 00.00	625.41	12	0	0	-	625.41	
624.7	-	-0.24	-0.016	15	277 + 25.00	624.94	12	0.016	0.19	-	625.13	
624.11	-	-0.30	-0.02	15	277 + 50.00	624.41	12	0.02	0.24	-	624.65	
623.01	-	-0.60	-0.04	15	278 + 00.00	623.61	12	0.04	0.48	-	624.09	
622.91	-	-0.90	-0.06	15	278 + 50.00	623.81	12	0.06	0.72	-	624.53	
622.85	-	-1.20	-0.08	15	279 + 00.00	624.05	12	0.08	0.96	-	625.25	
622.35	-	-1.20	-0.08	15	279 + 50.00	623.55	12	0.08	0.96	-	624.75	
620.49	-	-1.20	-0.08	15	280 + 00.00	621.69	12	0.08	0.96	-	622.89	
618.92	-	-1.20	-0.08	15	280 + 50.00	620.12	12	0.08	0.96	-	621.32	
618.23	-	-1.20	-0.08	15	281 + 00.00	619.43	12	0.08	0.96	-	620.63	
617.97	-	-1.20	-0.08	15	281 + 50.00	619.17	12	0.08	0.96	-	620.37	
617.22	-	-1.20	-0.08	15	282 + 00.00	618.42	12	0.08	0.96	-	619.62	
616.92	-	-1.20	-0.08	15	282 + 25.00	618.12	12	0.08	0.96	-	619.32	
616.92	-	-1.05	-0.07	15	282 + 50.00	617.97	12	0.07	0.84	-	618.81	
617.49	-	-0.75	-0.05	15	283 + 00.00	618.24	12	0.05	0.60	-	618.84	
618.36	-	-0.45	-0.03	15	283 + 50.00	618.81	12	0.03	0.36	-	619.17	
618.33	-	-0.23	-0.016	14.5	284 + 00.00	618.57	12	0.016	0.156	-	618.72	
618.22	-	-0.22	-0.016	14.25	284 + 25.00	618.00	12	0	0	-	618.00	
617.73	-	-0.22	-0.016	14	284 + 50.00	617.51	12	-0.016	-0.19	-	617.31	MATCH EX.

CALCULATED  
ARM  
CHECKED  
XXX

MAINTENANCE OF TRAFFIC GENERAL NOTES

ATH-329-5.26

I:\Project\DATA\ATH-329-5.26\Design\Roadway\Sheets\4589\_G0001.dgn Sheet 3/7/2022 10:42:24 AM cmorelan

SHEET NUM.										PART.			ITEM	ITEM	GRAND	UNIT	DESCRIPTION	SEE SHEET NO.	CALCULATED	ARM	CHECKED	XXX
5	8	28	29	30	31	35	39			01/STR/OT			EXT	TOTAL								
																	<b>ROADWAY</b>					
	536									LS		201	11000	LS			CLEARING AND GRUBBING					
		40	40	47	40					536		202	23000	536	SY		PAVEMENT REMOVED					
	228									167		202	35100	167	FT		PIPE REMOVED, 24" AND UNDER					
	1									228		202	38000	228	FT		GUARDRAIL REMOVED					
	6,443									1		202	42206	1	EACH		ANCHOR ASSEMBLY REMOVED					
	8,015									6,443		203	10000	6,443	CY		EXCAVATION					
	336									8,015		203	20000	8,015	CY		EMBANKMENT					
	1,113									336		203	35001	336	CY		GRANULAR EMBANKMENT, AS PER PLAN				4	
	2,519									1,113		203	35121	1,113	CY		GRANULAR MATERIAL, TYPE C, AS PER PLAN				4	
	825									2,519		204	10000	2,519	SY		SUBGRADE COMPACTION					
	1									825		606	45030	825	FT		GUARDRAIL, TYPE MGS					
	1,003									1		606	26150	1	EACH		ANCHOR ASSEMBLY, MGS TYPE E, MASH 2016					
										1,003		SPECIAL	690200	1,003	SY		GEOTEXTILE FABRIC, #2.09, TYPE A				4	
																	<b>EROSION CONTROL</b>					
	2,408									2,408		601	27001	2,408	CY		DUMPED ROCK FILL, TYPE C, AS PER PLAN				4	
		6	25	38	25					94		601	34400	94	CY		ROCK CHANNEL PROTECTION, WITH GROUT, TYPE C					
	7,677									7,677		659	10000	7,677	SY		SEEDING AND MULCHING					
	0.69									0.69		659	20000	0.69	TON		COMMERCIAL FERTILIZER					
	1.6									1.6		659	31000	1.6	ACRE		LIME					
	42									42		659	35000	42	MGAL		WATER					
										10,000		832	30000	10,000	EACH		EROSION CONTROL					
																	<b>DRAINAGE</b>					
		LS	LS	LS	LS					LS		503	11100	LS			COFFERDAMS AND EXCAVATION BRACING					
		30		23	23					76		511	52110	76	CY		CLASS QC MS CONCRETE					
		0.31	0.93	0.93	0.93					3.1		602	20000	3.1	CY		CONCRETE MASONRY					
	198									198		605	31100	198	FT		AGGREGATE DRAINS					
	1,191									1,191		611	01400	1,191	FT		6" CONDUIT, TYPE E, 707.31 (PERFORATED)					
	256									256		611	01500	256	FT		6" CONDUIT, TYPE F, 707.33 (NON-PERFORATED)					
	7									7		611	99710	7	EACH		PRECAST REINFORCED CONCRETE OUTLET					
		39		56	58					153		611	07200	153	FT		18" CONDUIT, TYPE A, 706.02					
			60							60		611	07200	60	FT		18" CONDUIT, TYPE A					
			27							27		613	41200	27	CY		LOW STRENGTH MORTAR BACKFILL					
																	<b>PAVEMENT</b>					
	405									405		301	56000	405	CY		ASPHALT CONCRETE BASE, PG64-22, (449)					
	391									391		304	20000	391	CY		AGGREGATE BASE					
	226									226		407	20000	226	GAL		NON-TRACKING TACK COAT					
	189									189		441	70000	189	CY		ASPHALT CONCRETE SURFACE COURSE, TYPE 1, (449), PG64-22					
	103									103		441	70200	103	CY		ASPHALT CONCRETE INTERMEDIATE COURSE, TYPE 1, (449)					
																	<b>TRAFFIC CONTROL</b>					
	39									39		621	00100	39	EACH		RPM					
	39									39		621	54000	39	EACH		RAISED PAVEMENT MARKER REMOVED					
	0.58									0.58		642	00104	0.58	MILE		EDGE LINE, 6", TYPE 1					
	0.29									0.29		642	00300	0.29	MILE		CENTER LINE, TYPE 1					
																	<b>MAINTENANCE OF TRAFFIC</b>					
	4									4		614	12384	4	EACH		WORK ZONE IMPACT ATTENUATOR, 24" WIDE HAZARDS, (BIDIRECTIONAL)					
	1									1		614	12740	1	EACH		WORK ZONE LIGHTING SYSTEM					
	62									62		614	13310	62	EACH		BARRIER REFLECTOR, TYPE 1, BIDIRECTIONAL					
	62									62		614	13360	62	EACH		OBJECT MARKER, TWO WAY					
	1.12									1.12		614	22010	1.12	MILE		WORK ZONE EDGE LINE, CLASS 1, 6"					
	22									22		614	26000	22	FT		WORK ZONE STOP LINE, CLASS 1					
	2,860									2,860		622	41100	2,860	FT		PORTABLE BARRIER, UNANCHORED					
							4,851			4,851		507	00400	4,851	FT		STEEL PILES, MISC.:SOLDIER PILES, W24x146				4	
							47			47		511	46510	47	CY		CLASS QCI CONCRETE, FOOTING					
							432			432		518	21050	432	SY		POROUS BACKFILL WITH GEOTEXTILE FABRIC					
							4,250			4,250		524	94703	4,250	FT		DRILLED SHAFTS, 36" DIAMETER, ABOVE BEDROCK, AS PER PLAN				4	
							1,722			1,722		524	94705	1,722	FT		DRILLED SHAFTS, 36" DIAMETER, INTO BEDROCK, AS PER PLAN				4	
							18			18		524	95000	18	FT		DRILLED SHAFTS, MISC.:EXTENSION				34	
							456			456		SPECIAL	53000400	456	EACH		STRUCTURES PRE-CAST CONCRETE LAGGING NO. 1				35	
							1			1		SPECIAL	53000400	1	EACH		STRUCTURES PRE-CAST CONCRETE LAGGING NO. 2				35	
							1			1		SPECIAL	53000400	1	EACH		STRUCTURES PRE-CAST CONCRETE LAGGING NO. 3				35	
																	<b>INCIDENTALS</b>					
										LS		614	11000	LS			MAINTAINING TRAFFIC					
										LS		623	10000	LS			CONSTRUCTION LAYOUT STAKES AND SURVEYING					
										LS		624	10000	LS			MOBILIZATION					

GENERAL SUMMARY

ATH-329-5.26