

STATIC GRADE LINE (SGL) THIS DWG: 1283

**HYDRAULIC GRADE LINE MAPS**

The Hydraulic Grade Line (HGL) noted at each map location is the calculated head condition based upon the simultaneous operation of the six existing sewage lift stations (Oak View, Fox Commerce Park, Airport Road, Jamboree in the Hills, Pine Lake, and Union Local School District); with consideration for some additional flows into the force main at Country Club Rd (CR56), Friends Church Rd (Twp 273) SR331/US40 intersection and at the provided Morrystown tie-in.

As other pumps are connected to this system, the force main hydraulic conditions will change. Designers are cautioned to anticipate system head conditions which will vary, depending upon the instantaneous pumping activity of the various pumping stations.

Adding new pump stations to this force main system may have a significant effect upon the operation of the existing pumps. This evaluation does not address changes to system head conditions which occur as other pumps are added to this system.

SGL = STATIC GRADE LINE  
 ○ = HYDRAULIC GRADE LINE

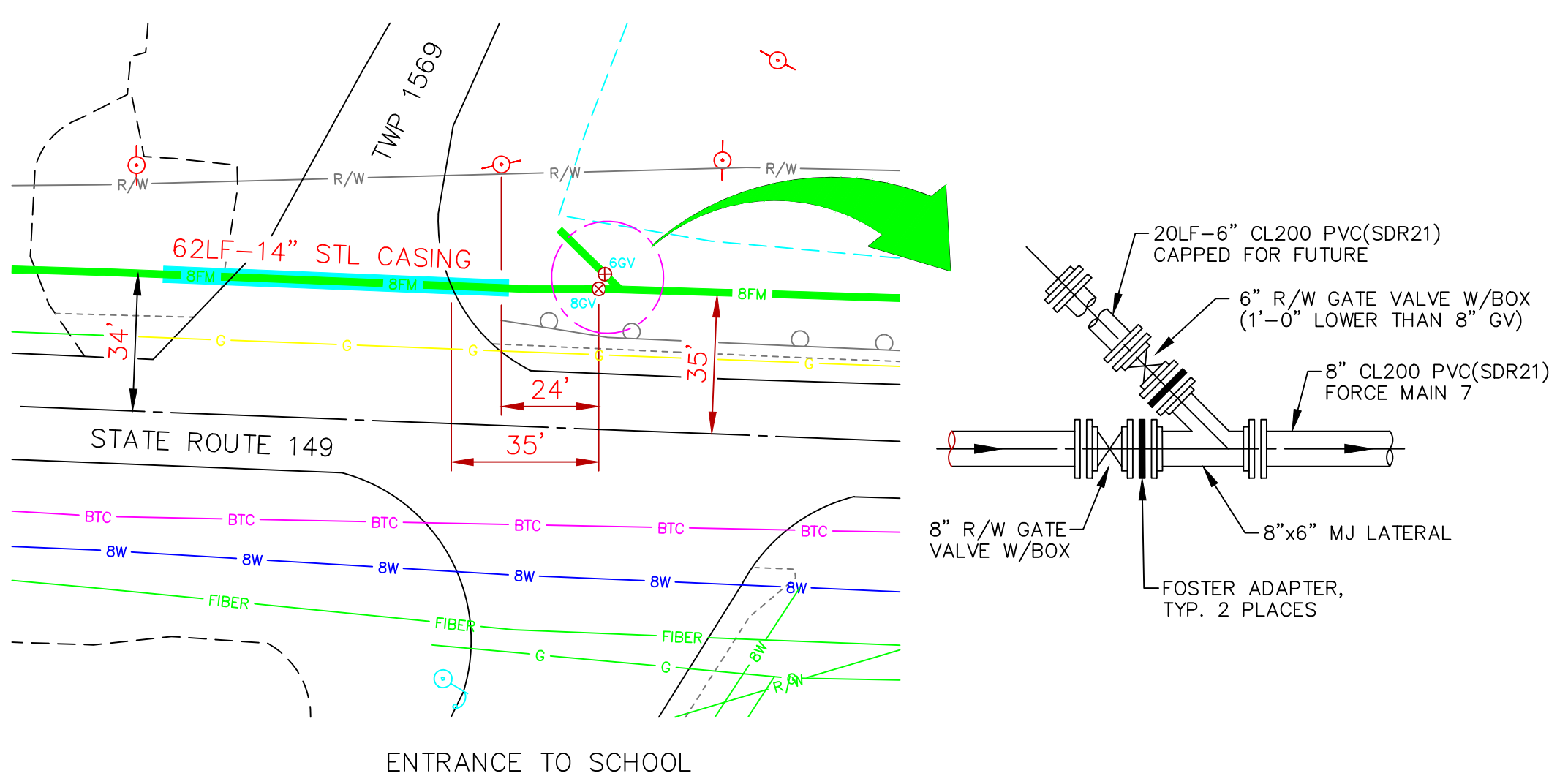

DETAIL "A" WITH VALVE LOCATIONS  
 NO SCALE

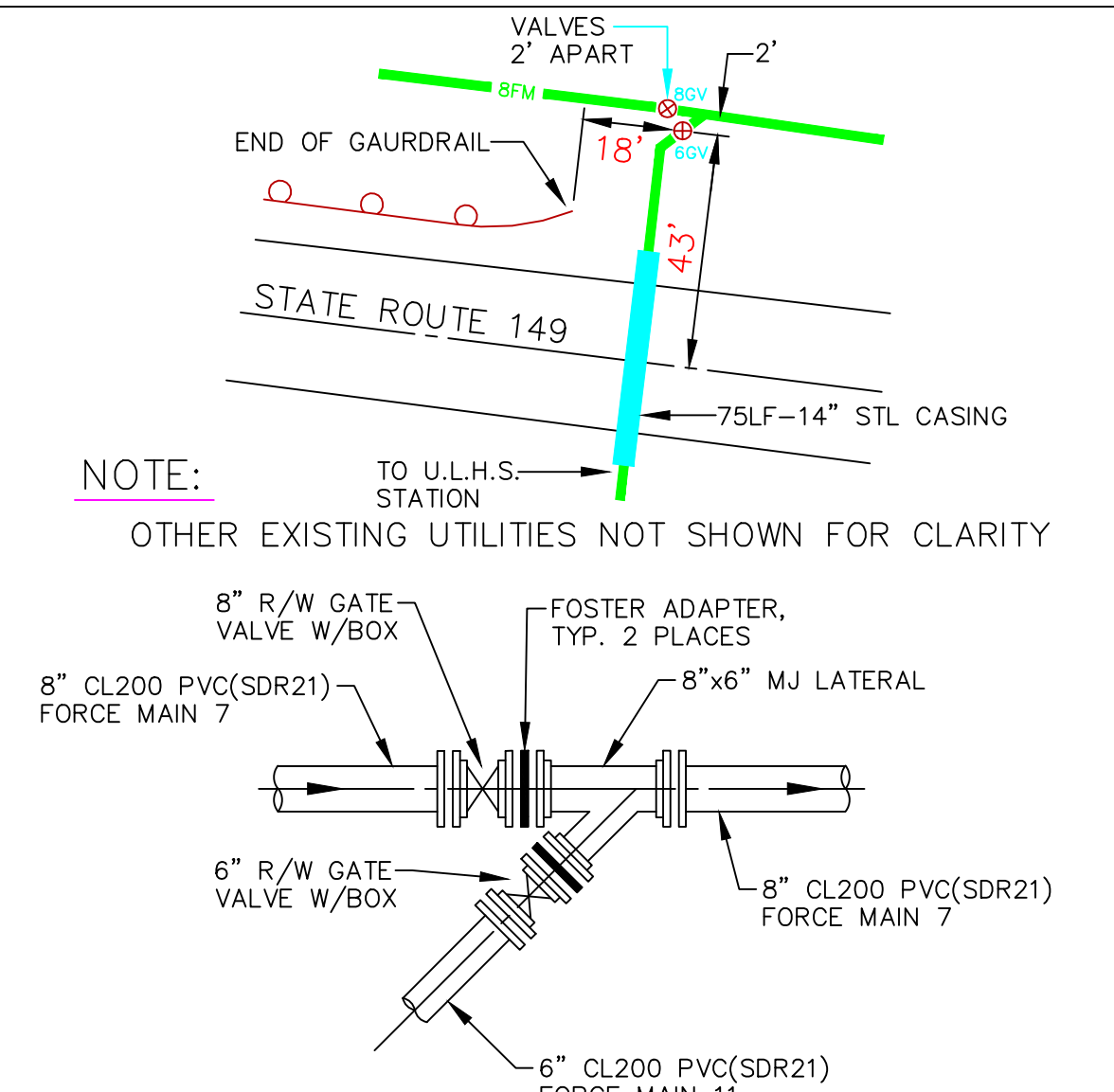

DETAIL "B" WITH VALVE LOCATIONS  
 NO SCALE

FORCE MAIN 7 (CONT.)  
 8" CL200 PVC(SDR21)

FLOW →

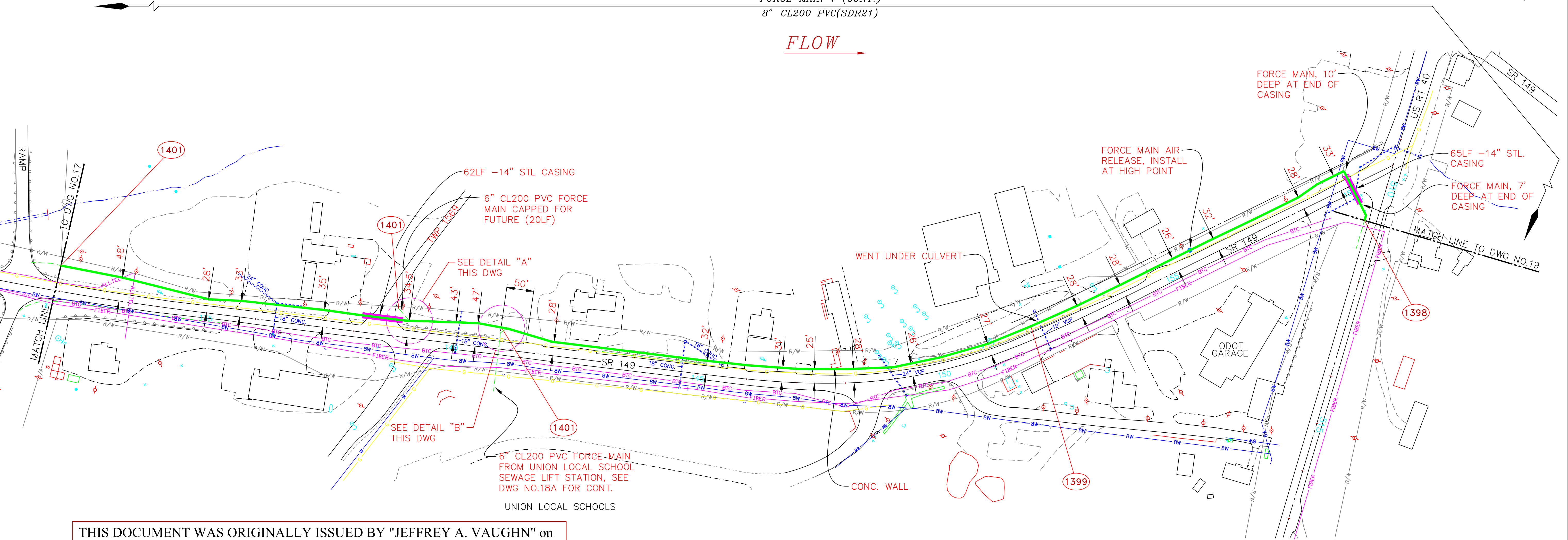

THIS DOCUMENT WAS ORIGINALLY ISSUED BY "JEFFREY A. VAUGHN" on Feb. 13, 2003. THIS DOCUMENT IS NOT CONSIDERED A SEALED DOCUMENT

WASTE WATER LINE 2809.51 FT. / .53 MI. (2-23-23) JGH DRAWINGS OF RECORD 12/02

NO.	DATE	REVISION	MLD
1	5/05	REVISED FORCE MAIN DIMENSIONS NEAR TWP RT 1569	

DRAWN BY: DAVID STEWART  
 CHECKED BY: JEFFREY A. VAUGHN

BELMONT COUNTY SANITARY SEWER DISTRICT  
 STATE ROUTES 149 AND 40 FORCE MAINS  
 BELMONT COUNTY, OHIO

STATE ROUTES 149 AND 40 FORCE MAINS  
 ALONG ST. ROUTE 149 TO INTERSECTION OF U.S. ROUTE 40  
 FORCE MAIN 7 AND DETAILS

SCALE: 1"=100' (22"x34") 1"=200' (11"x17")	PROJECT NO. 00016
DATE: SEPT. 2000	DRAWING NO. 18