

STATE OF OHIO
DEPARTMENT OF TRANSPORTATION
D12-BH-FY2009-VANDAL FENCE

PROJECT DESCRIPTION:
This project consists of installing Vandal Protection Fence and sealing of the barriers.

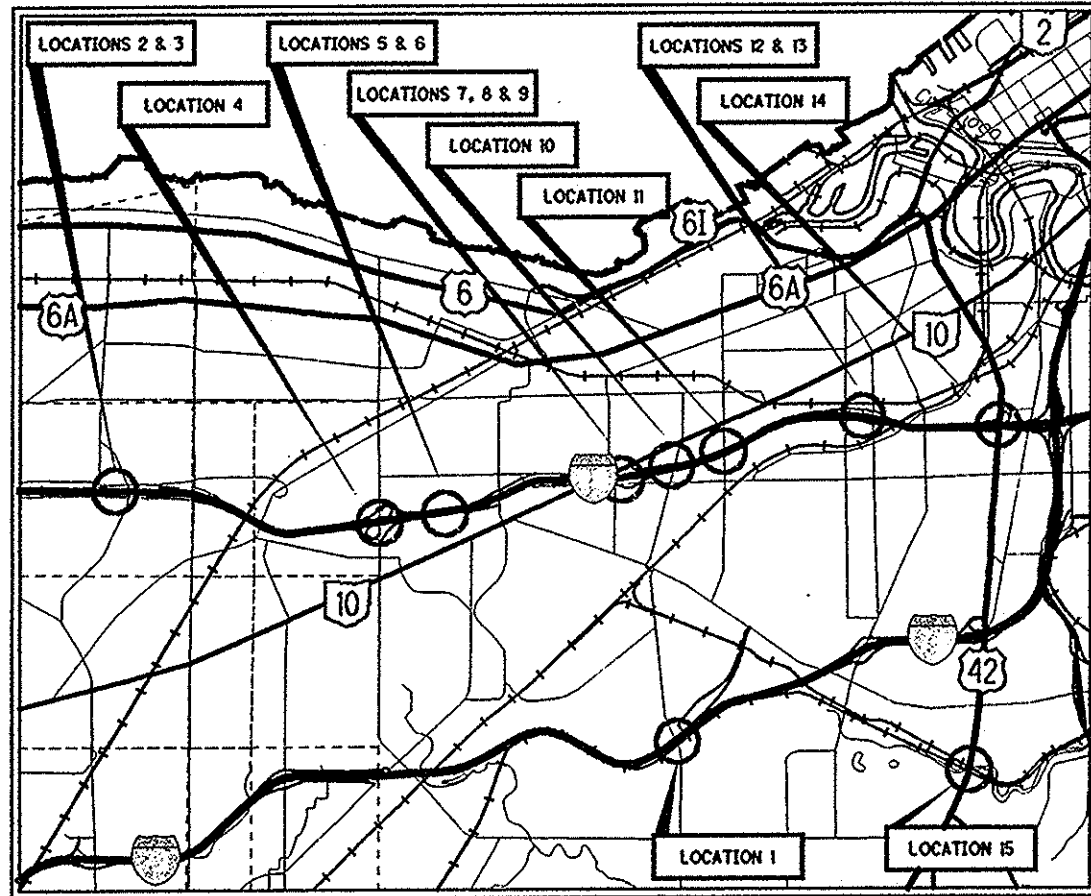

LOCATION	BRIDGE NUMBER	STRUCTURAL FILE NUMBER	CITY, TOWNSHIP, OR VILLAGE	LOCATION	BRIDGE NUMBER	STRUCTURAL FILE NUMBER	CITY, TOWNSHIP, OR VILLAGE
1	CUY-71-1559	1805177	CLEVELAND	9	CUY-90-1214	1808486	CLEVELAND
2	CUY-90-0892	1808117	CLEVELAND	10	CUY-90-1237	1808532	CLEVELAND
3	CUY-90-0909	1808125	CLEVELAND	11	CUY-90-1270	1808699	CLEVELAND
4	CUY-90-1062	1808249	CLEVELAND	12	CUY-90-1345	1807811	CLEVELAND
5	CUY-90-1094	1808273	CLEVELAND	13	CUY-90-1361	1807846	CLEVELAND
6	CUY-90-1110	1808303	CLEVELAND	14	CUY-90-1435	1807889	CLEVELAND
7	CUY-90-1185	1808451	CLEVELAND	15	CUY-42-1457	1803271	CLEVELAND
8	CUY-90-1201	1808478	CLEVELAND				

INDEX OF SHEETS

TITLE	1
LOCATION MAPS	2-4
GENERAL NOTES	5-7
GENERAL SUMMARY	8
BRIDGE DATA SHEET	9
LOCATION 1 (CUY-71-1559)	10-11
LOCATIONS 2-14 (CUY-90-XXXX)	12
LOCATION 15 (CUY-42-1457)	13-14
MAINTENANCE OF TRAFFIC	15-18

2008 SPECIFICATIONS

The standard specifications of the State of Ohio, Department of Transportation, including changes and supplemental specifications listed in the proposal shall govern this improvement.

I hereby approve these plans and declare that the making of this improvement will not require the closing to traffic of the highway and that provisions for the maintenance and safety of traffic will be as set forth on the plans and estimates.

LATITUDE: N 41°26'53" LONGITUDE: W 81°44'09" FOR LOCATION 1
FOR OTHER LOCATIONS, SEE LOCATION MAPS

UNDERGROUND UTILITIES
TWO WORKING DAYS
BEFORE YOU DIG
CALL 1-800-362-2764 (TOLL FREE)
OHIO UTILITIES PROTECTION SERVICE
NON-MEMBERS
MUST BE CALLED DIRECTLY

PLAN PREPARED BY: ODOT - DISTRICT TWELVE
PRODUCTION DEPARTMENT
5500 TRANSPORTATION BLVD.
GARFIELD HTS., OHIO 44125

THIS IS A MAINTENANCE PROJECT
PROJECT EARTH DISTURBED AREA = N/A (MAINT. PROJECT)
ESTIMATED CONTRACTOR EARTH DISTURBED AREA = N/A (MAINT. PROJECT)
NOTICE OF INTENT EARTH DISTURBED AREA = N/A (MAINT. PROJECT)

ENGINEER OF RECORD	STANDARD CONSTRUCTION DRAWINGS				SUPPLEMENTAL SPECIFICATIONS			
<p>Natalie R. Benedictis-Conley E-63855 REGISTERED PROFESSIONAL ENGINEER</p> <p><i>D.R. Benedictis-Conley</i></p>		TC-41.20	01/19/01	MT-95.50	09/05/06	800	01/16/09	
	VPF-1-90	07/19/02	TC-52.10	01/19/07		832	04/25/06	
			TC-52.20	01/19/07	MT-97.10	09/05/06		
			MT-35.10	04/20/01	MT-105.10	10/18/02		
					MT-105.11	10/18/02		
			MT-95.30	09/05/06	MT-110.20	10/18/02		
			MT-95.31	09/05/06				
			MT-95.32	09/05/06				
							SPECIAL PROVISIONS	

Approved *Berita G. Jansen, P.E.*
Date 01/26/09 District Deputy Director of Transportation

Approved *John M. Molitor, III*
Date 2-4-09 Director, Department of Transportation

D12 - VA-BH-FY2009-VANDAL FENCE
 090241 PID - 83561
 Dist 12 4/15/2009

FEDERAL PROJECT NO.
NON-FEDERAL

PID NO.
83561

CONSTRUCTION PROJECT NO.

RAILROAD INVOLVEMENT
NS / CSX

D12-BH-FY2009
FENCE

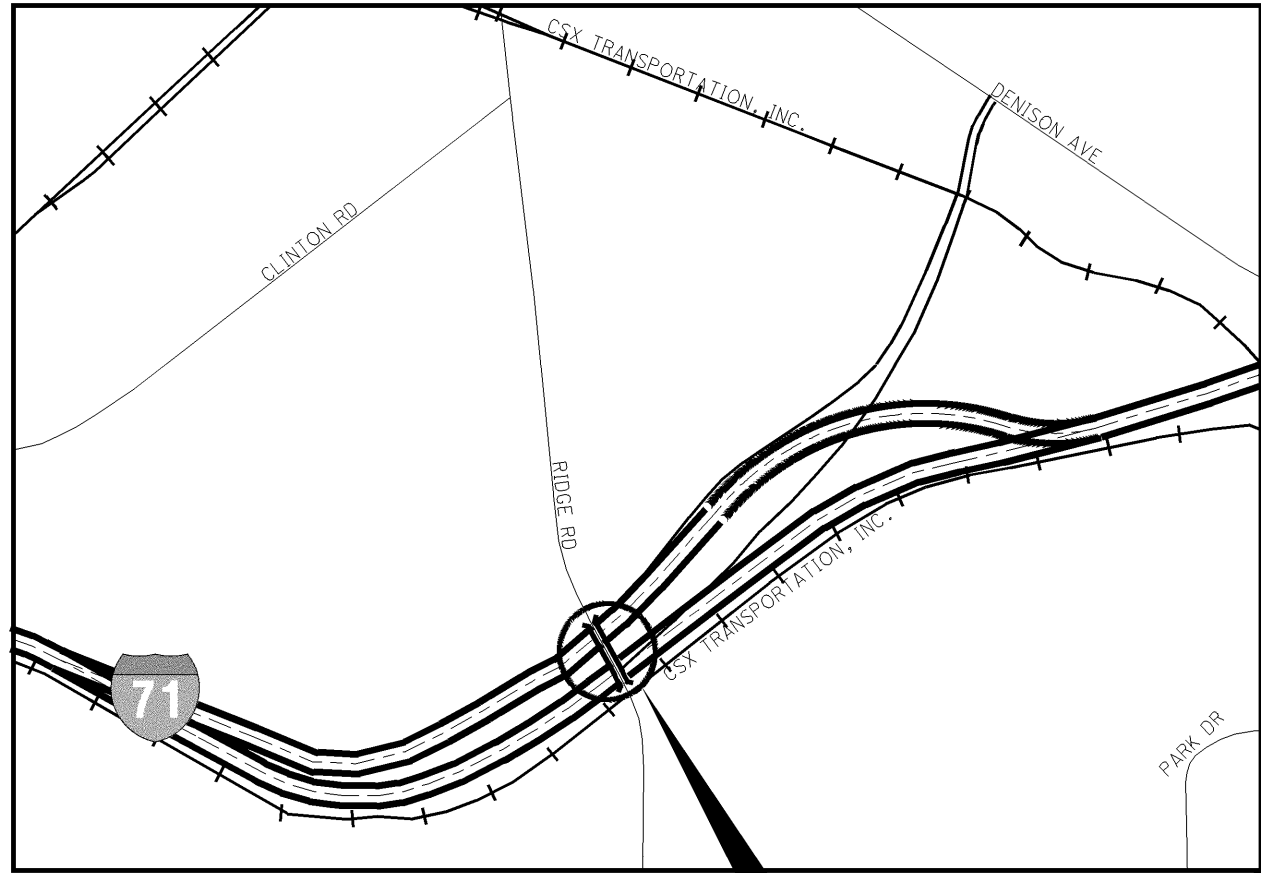

LOCATION 1
CUY-71-1559
SFN 1805177
N 41°26'53"
W 81°44'09"

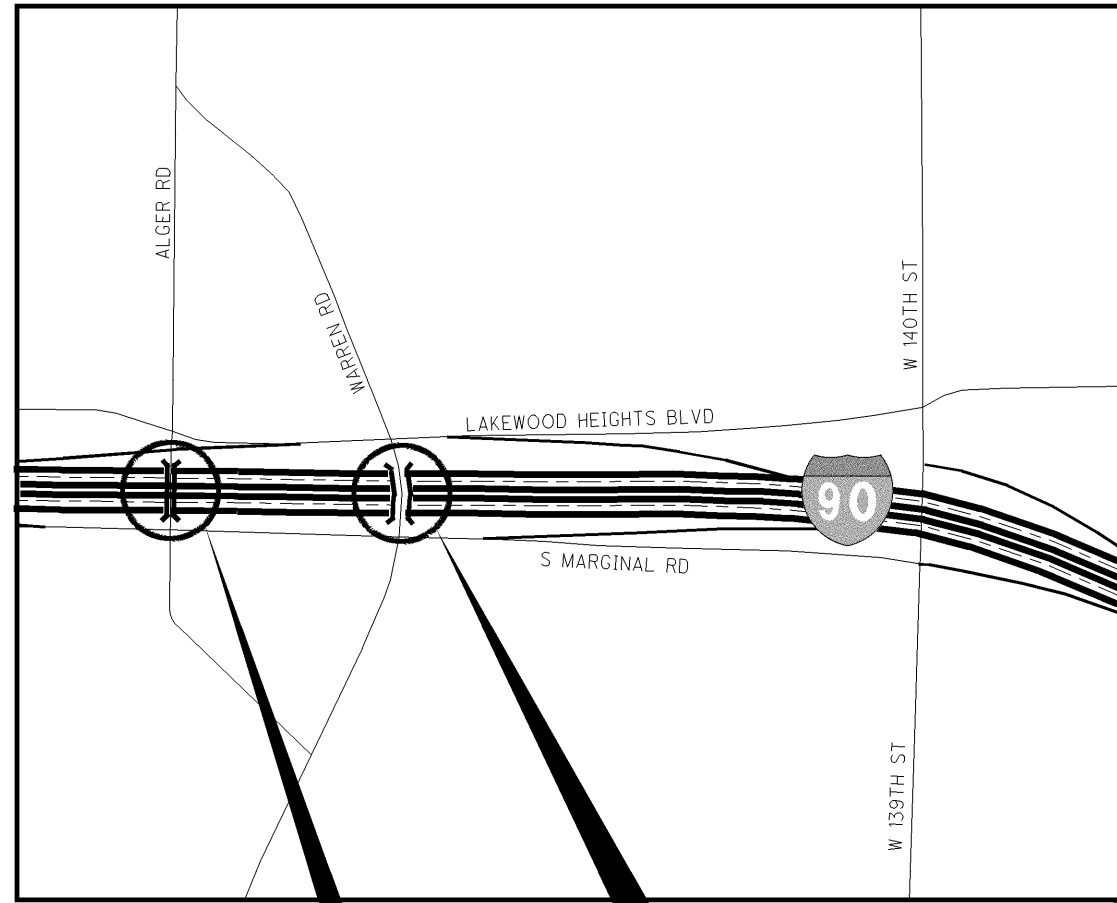

LOCATION 2
CUY-90-0892
SFN 1808117
N 41°28'10"
W 81°48'02"

LOCATION 3
CUY-90-0909
SFN 1808125
N 41°28'10"
W 81°47'50"

LOCATION 4
CUI-90-1062
SFN 1808249
N 41°28'00"
W 81°46'08"

LOCATION 5
CUI-90-1094
SFN 1808273
N 41°28'02"
W 81°45'47"

LOCATION 6
CUI-90-1110
SFN 1808303
N 41°28'03"
W 81°45'38"

LOCATION 10
CUI-90-1237
SFN 1808532
N 41°28'15"
W 81°44'09"

LOCATION 11
CUI-90-1270
SFN 1808699
N 41°28'20"
W 81°43'47"

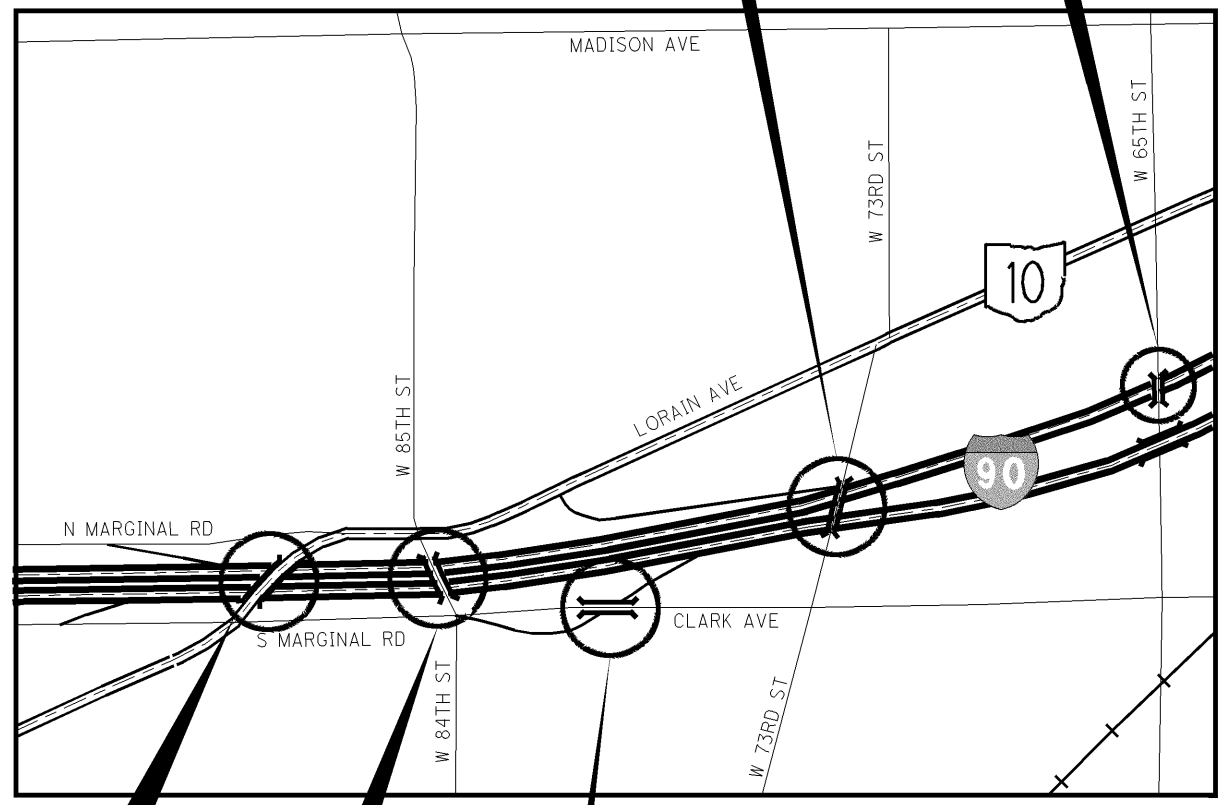
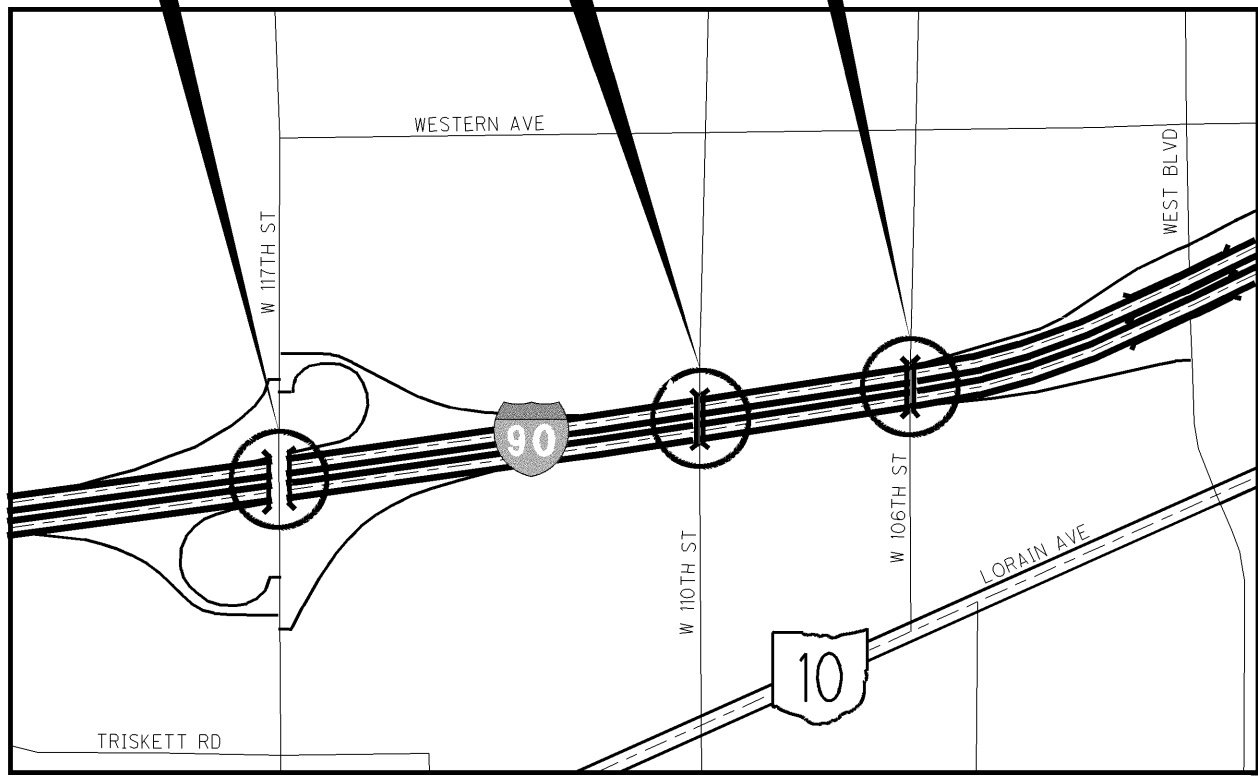

LOCATION 7
CUI-90-1185
SFN 1808451
N 41°28'12"
W 81°44'49"

LOCATION 8
CUI-90-1201
SFN 1808478
N 41°28'12"
W 81°44'36"

LOCATION 9
CUI-90-1214
SFN 1808486
N 41°28'13"
W 81°44'26"

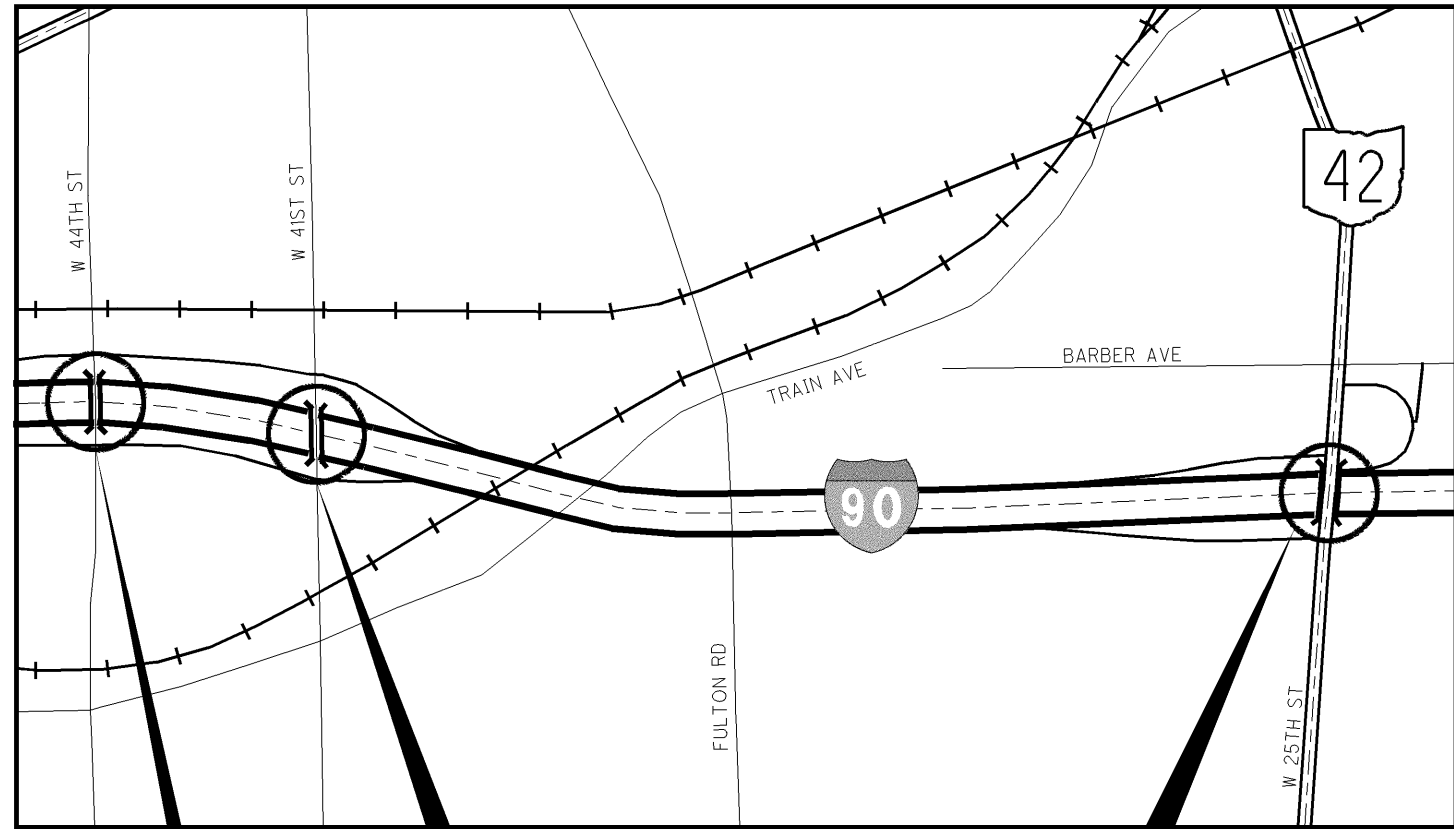

LOCATION 12
CUY-90-1345
SFN 1807811
N 41°28'31"
W 81°42'59"

LOCATION 13
CUY-90-1361
SFN 1807846
N 41°28'29"
W 81°42'48"

LOCATION 14
CUY-90-1435
SFN 1807889
N 41°28'27"
W 81°41'57"

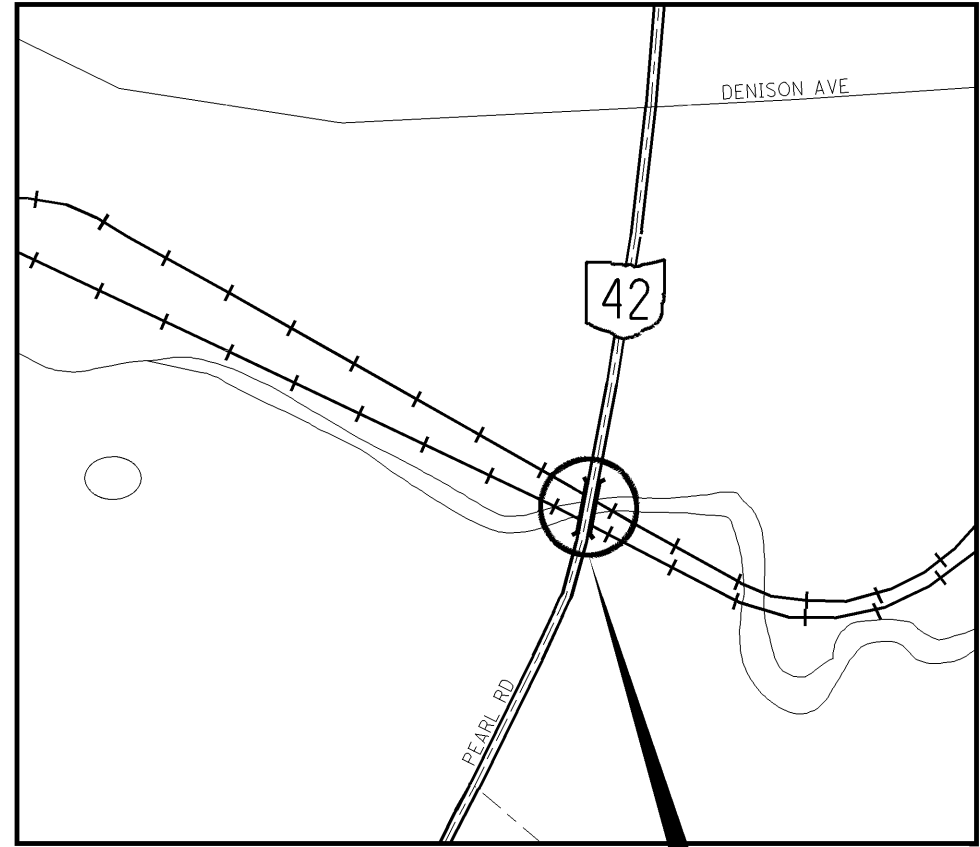

LOCATION 15
CUY-42-1457
SFN 1803271
N 41°26'40"
W 81°42'11"

PROJECT DESCRIPTION

THIS PROJECT CONSISTS OF VANDAL PROTECTION FENCE INSTALLATION AND SEALING OF CONCRETE SURFACES.

REFER TO STANDARD BRIDGE DRAWINGS

LISTED ON TITLE SHEET

AND TO SUPPLEMENTAL SPECIFICATIONS

LISTED ON TITLE SHEET

AND TO PROPOSAL NOTES

STEEL PRICE ADJUSTMENT NOTE

DESIGN SPECIFICATIONS

THE STRUCTURES CONFORM TO "STANDARD SPECIFICATIONS FOR HIGHWAY BRIDGES" ADOPTED BY THE AMERICAN ASSOCIATION OF STATE HIGHWAY AND TRANSPORTATION OFFICIALS, 17TH EDITION, 2002 AND THE ODOT BRIDGE DESIGN MANUAL.

RIGHT OF WAY

ALL WORK IS TO BE PERFORMED WITHIN THE EXISTING RIGHT OF WAY OR EASEMENTS OR WITHIN STATE PROPERTY.

EXISTING STRUCTURE VERIFICATION

DETAILS AND DIMENSIONS SHOWN ON THESE PLANS PERTAINING TO THE EXISTING STRUCTURE HAVE BEEN OBTAINED FROM PLANS OF THE EXISTING STRUCTURE AND FROM FIELD OBSERVATIONS AND MEASUREMENTS. CONSEQUENTLY, THEY ARE INDICATIVE OF THE EXISTING STRUCTURE AND THE PROPOSED WORK BUT THEY SHALL BE CONSIDERED TENTATIVE AND APPROXIMATE. THE CONTRACTOR IS REFERRED TO SECTIONS 102.05, 105.02, AND 513.04 OF THE 2008 CONSTRUCTION AND MATERIAL SPECIFICATIONS.

BASE CONTRACT BID PRICES UPON A RECOGNITION OF THE UNCERTAINTIES DESCRIBED ABOVE AND UPON A PRE-BID EXAMINATION OF THE EXISTING STRUCTURE BY THE CONTRACTOR. HOWEVER, THE DEPARTMENT WILL PAY FOR ALL PROJECT WORK BASED UPON ACTUAL DETAILS AND DIMENSIONS THAT HAVE BEEN VERIFIED IN THE FIELD.

THE EXISTING STRUCTURE PLANS MAY BE REVIEWED AT THE:

OHIO DEPARTMENT OF TRANSPORTATION
DISTRICT 12 OFFICE
5500 TRANSPORTATION BOULEVARD
GARFIELD HEIGHTS, OH 44125

COOPERATION BETWEEN CONTRACTORS

THE CONTRACTOR SHALL COOPERATE AND COORDINATE HIS/HER OPERATIONS WITH THE CONTRACTORS ON OTHER PROJECTS THAT MAY BE IN FORCE DURING THE LIFE OF THE CONTRACT. NO WAIVER OF ANY PROVISIONS OF 105.08 OF THE 2008 CONSTRUCTION AND MATERIAL SPECIFICATIONS IS INTENDED.

UTILITY OWNERSHIP

THE NATURE OF THE WORK REQUIRED BY THIS PROJECT WILL NOT AFFECT ANY KNOWN UTILITIES IN THE WORK AREAS.

LIMITATION OF OPERATIONS

THE CONTRACTOR'S ACTIVITIES AND WORK SCHEDULE SHALL BE CONSTRAINED BY THE FOLLOWING LIMITATION:

MAINTENANCE OF TRAFFIC RESTRICTIONS (REFER TO THE MAINTENANCE OF TRAFFIC SHEETS IN THIS PLAN).

EXISTING DIMENSIONS

ALL DIMENSIONS ARE ±. THE CONTRACTOR IS RESPONSIBLE FOR VERIFYING THE EXISTING FENCE LENGTHS, POST SPACING AND DIMENSIONS OF THE EXISTING BASE PLATES AND OTHER HARDWARE PRIOR TO ORDERING OR INSTALLING NEW VANDAL PROTECTION FENCE.

GENERAL FENCE REPAIR/REPLACEMENT NOTES

THE CONTRACTOR SHALL ONLY REMOVE THE PORTION OF FENCE THAT CAN BE REPLACE/REPAIRED WITHIN THAT DAY'S OPERATION.

THE CONTRACTOR MUST MAINTAIN PEDESTRIAN TRAFFIC ACROSS THE STRUCTURE AT ALL TIMES.

THE CONTRACTOR MAY CLOSE THE SIDEWALK IF PERMITTED BY THE PROJECT ENGINEER. THE CLOSURE SHALL BE PER THE STANDARD DRAWING MT-110.20.

THE CONTRACTOR SHOULD BE AWARE THAT SOME STRUCTURES HAVE SIGNS ON/NEAR THEM AND THEY WILL NEED TO AVOID COVERING OR DAMAGING THE SIGNS.

ITEM 202-FENCE REMOVED, AS PER PLAN "A"

THIS ITEM IS USED FOR:
LOCATION 1 - CUY-71-1559

THE CONTRACTOR SHALL REMOVE AND DISPOSE OF THE EXISTING FENCE FABRIC. CARE SHALL BE TAKEN TO NOT DAMAGE THE EXISTING POSTS, BASE PLATES AND HARDWARE THAT IS TO REMAIN.

PAYMENT FOR ALL OF THE ABOVE SHALL BE AT THE UNIT PRICE BID PER FOOT FOR ITEM 202-FENCE REMOVED, AS PER PLAN "A" AND SHALL INCLUDE ALL LABOR, EQUIPMENT, MATERIALS AND INCIDENTALS NECESSARY TO COMPLETE THE ABOVE WORK.

GENERAL NOTES

D12 - BH - FY2009
FENCE

ITEM 202-FENCE REMOVED, AS PER PLAN "B"

THE CONTRACTOR SHALL REMOVE AND DISPOSE OF ALL FENCE AND INCIDENTAL HARDWARE EXCEPT FOR THE POSTS. THE POSTS SHALL BE CUT TO THE LIMITS SHOWN IN THE PLAN.

PAYMENT FOR ALL OF THE ABOVE SHALL BE AT THE UNIT PRICE BID PER FOOT FOR ITEM 202-FENCE REMOVED, AS PER PLAN "B" AND SHALL INCLUDE ALL LABOR, EQUIPMENT, MATERIALS AND INCIDENTALS NECESSARY TO COMPLETE THE ABOVE WORK.

ITEM 512-SEALING OF CONCRETE SURFACES (EPOXY-URETHANE)

THE COLOR OF THE FINISH COAT SHALL BE AS INDICATED ON THE BRIDGE DATA SHEET.

ITEM SPECIAL-URETHANE TOP COAT SEALER

THE CONTRACTOR SHALL REFER TO CMS 512 FOR REQUIREMENTS, WITH THE FOLLOWING EXCEPTIONS:

(512.03E AND 512.03F) THE EXISTING URETHANE TOP COAT SHALL NOT BE REMOVED. THE REQUIREMENT FOR A "SURFACE THAT FEELS LIKE 100 GRIT SANDPAPER" IS WAIVED FOR THIS NOTE. USE ONLY A WATER BLAST AT 7000 PSI TO PREPARE THE SURFACE. DO NOT REPAIR SPALLED AND STRUCTURALLY UNSOUND AREAS.

THE COLOR OF THE FINISH COAT SHALL BE AS INDICATED ON THE BRIDGE DATA SHEET.

PAYMENT FOR ALL OF THE ABOVE SHALL BE AT THE UNIT PRICE BID PER SQUARE YARD FOR ITEM SPECIAL - URETHANE TOP COAT SEALER AND SHALL INCLUDE ALL LABOR, EQUIPMENT, MATERIALS AND INCIDENTALS NECESSARY TO COMPLETE THE ABOVE WORK.

ITEM 514 - FIELD PAINTING, MISC.: PAINT EXISTING FENCE POSTS, RAILS, AND APPURTENANCES

THIS ITEM IS USED FOR:
LOCATION 1 - CUY-71-1559

THIS ITEM SHALL CONSIST OF PAINTING ALL ELEMENTS OF THE EXISTING FENCE EXCEPT THE FABRIC. CMS 514.04 AND 514.07 SHALL APPLY TO THIS ITEM.

SURFACE PREPARATION:

1. VISIBLE DEPOSITS OF OIL, GREASE OR OTHER MATERIALS THAT MAY INTERFERE WITH COATING ADHESION SHALL BE REMOVED IN ACCORDANCE WITH SSPC-SP1 SOLVENT CLEANING. THIS CAN BE ACCOMPLISHED USING, DEVCO COATINGS, DEVPREP 88 HEAVY DUTY CLEANER. APPLY THE SOLUTION WITH BRUSH, ROLLER OR LOW PRESSURE SPRAY. IF SURFACE IS HOT, WET BEFORE APPLYING CLEANER SOLUTION. MODERATE SCRUBBING WILL AID IN PERFORMANCE AND SPEED OF CLEANING. ALLOW CLEANER TO REMAIN FOR FIVE TO TEN MINUTES, BUT DO NOT ALLOW THE SURFACE TO DRY. RINSE WITH LARGE AMOUNTS OF CLEAN WATER. IF PROTECTED, THIS CAN ALSO BE ACCOMPLISHED WITH A POWER WASHER (1500 PSI MINIMUM). A THOROUGH RINSING IS VERY IMPORTANT BECAUSE ALL OF THE DEVPREP 88 CLEANER MUST BE REMOVED. DO NOT ALLOW THE CLEANER TO DRY ON THE SURFACE.
2. THEN CONTINUE THE SURFACE PREPARATION WITH SSPC-SP2 HAND TOOL CLEANING TO REMOVES ALL LOOSE MILL SCALE, LOOSE RUST, AND ANY OTHER LOOSE DETRIMENTAL FOREIGN MATTER. HAND TOOL CLEANING CAN BE ACCOMPLISHED WITH HAND WIRE BRUSHING, HAND ABRADING, OR HAND SCRAPING.

3. AFTER HAND TOOL CLEANING AND PRIOR TO PAINTING, REMOVE DIRT, DUST, OR SIMILAR CONTAMINANTS FROM THE SURFACE. THE ACCEPTABLE METHOD WOULD BE BY BLOW OFF WITH CLEAN DRY AIR. FOLLOW COMPLETELY ALL REQUIREMENTS OF SSPC-SP1 SOLVENT CLEANING AND SSPC-SP2 HAND TOOL CLEANING METHODS.

PRODUCTS AND APPLICATION:

1. AREAS WHICH ARE NOT TO BE PAINTED SHALL BE COVERED SO THAT SPILLAGE DOES NOT OCCUR ON THESE AREAS.
2. APPLY 1 COAT OF EPOXY MASTIC, SUCH AS DEVCO COATINGS, BAR RUST 231 MULTI-PURPOSE EPOXY MASTIC OR APPROVED EQUAL BY BRUSH, ROLLER OR IF ALLOWED BY SPRAY APPLICATION AT 3.0-5.0 MILS DFT. STRIPE COATING IS REQUIRED AROUND ALL ATTACHMENTS, BOLTS, WELDS, AND SHARP EDGES. AREAS WHICH ARE NOT TO BE PAINTED SHALL BE COVERED SO THAT SPILLAGE DOES NOT OCCUR ON THESE AREAS. REFER TO MANUFACTURER'S RECOMMENDATIONS FOR ANY OTHER APPLICATION REQUIREMENTS.
3. APPLY 1 COAT OF URETHANE GLOSS ENAMEL SUCH AS DEVCO COATINGS, DEVTHANE 379UVA ALIPHATIC URETHANE GLOSS ENAMEL OR APPROVED EQUAL IN THE COLOR BLACK BY BRUSH, ROLLER, OR IF ALLOWED BY SPRAY APPLICATION AT 2.0-3.0 MILS DFT. STRIPE COATING IS REQUIRED AROUND ALL ATTACHMENTS, BOLTS, WELDS, AND SHARP EDGES. REFER TO MANUFACTURER'S RECOMMENDATIONS FOR ANY OTHER APPLICATION REQUIREMENTS.

PAYMENT FOR ALL OF THE ABOVE SHALL BE AT THE UNIT PRICE BID PER FOOT FOR ITEM 514 - FIELD PAINTING, MISC.: PAINT EXISTING FENCE POSTS, RAILS, AND APPURTENANCES AND SHALL INCLUDE ALL LABOR, EQUIPMENT, MATERIALS AND INCIDENTALS NECESSARY TO COMPLETE THE ABOVE WORK.

ITEM 519-PATCHING CONCRETE STRUCTURE, AS PER PLAN

THIS ITEM IS INTENDED TO BE USED TO REPAIR THE AREA NECESSARY FOR PROPER FENCE INSTALLATION. THIS ITEM IS USED FOR:
LOCATION 14 - CUY-90-1435

PRIOR TO THE SURFACE CLEANING SPECIFIED IN 519.04 AND WITHIN 24 HOURS OF PLACING PATCHING MATERIAL, BLAST CLEAN ALL SURFACES TO BE PATCHED, INCLUDING THE EXPOSED REINFORCING STEEL. ACCEPTABLE METHODS INCLUDE HIGH-PRESSURE WATER BLASTING WITH OR WITHOUT ABRASIVES IN THE WATER, ABRASIVE BLASTING WITH CONTAINMENT OR VACUUM ABRASIVE BLASTING.

ALL EQUIPMENT, LABOR, AND MATERIALS TO PERFORM THE ABOVE WORK SHALL BE INCLUDED IN PAYMENT UNDER ITEM 519 - PATCHING CONCRETE STRUCTURE, AS PER PLAN.

ITEM 607-VANDAL PROTECTION FENCE, 6' STRAIGHT, COATED FABRIC, AS PER PLAN

THIS ITEM SHALL BE USED TO INSTALL NEW VANDAL PROTECTION FENCE PER THE DETAILS SHOWN IN THE PLANS.

AT LOCATIONS WHERE THE EXISTING FENCE SPANS ACROSS THE EXPANSION JOINT, DO NOT INSTALL LINE RAILS AND EXPANSION JOINT SLEEVES; HOWEVER, THE FABRIC SHALL REMAIN CONTINUOUS ACROSS THE EXPANSION JOINT.

THE FENCE, FENCE FABRIC, RAILS, POSTS, PLATES, TIEWIRES, NUTS, BOLTS, ANCHOR BOLTS, CAULK AND ANY ADDITIONAL VISIBLE HARDWARE SHALL BE COATED BLACK.

CALCULATED
FLK
CHECKED
NRC

GENERAL NOTES

D12-BH-FY2009
FENCE

6
18

I:\PROJECTS\pid83561\dgn\83561_gen_notes.dgn 26 - JAN - 2009 9:14AM fkonopka

AT LOCATIONS WHERE THE EXISTING RIGHT-OF-WAY FENCE IS CONNECTED TO THE EXISTING FENCE ON THE STRUCTURE, THE CONTRACTOR SHALL RECONNECT THE EXISTING RIGHT-OF-WAY FENCE TO THE NEWLY INSTALLED VANDAL PROTECTION FENCE. THIS WORK IS INCLUDED IN THIS ITEM.

PAYMENT FOR ALL OF THE ABOVE SHALL BE AT THE UNIT PRICE BID PER FOOT FOR ITEM 607 – VANDAL PROTECTION FENCE, 6' STRAIGHT, COATED FABRIC, AS PER PLAN AND SHALL INCLUDE ALL LABOR, EQUIPMENT, MATERIALS AND INCIDENTALS NECESSARY TO COMPLETE THE ABOVE WORK.

ITEM 607-FENCE, MISC.: VANDAL PROTECTION FABRIC, COATED

THIS ITEM IS USED FOR:
LOCATION 1 – CUY-71-1559

THE CONTRACTOR SHALL INSTALL NEW VANDAL PROTECTION FABRIC PER STANDARD DRAWING VPF-1-90. THE PVC COATING SHALL BE BLACK AND MATCH THE NEWLY PAINTED POSTS.

PAYMENT FOR ALL OF THE ABOVE SHALL BE AT THE UNIT PRICE BID PER FOOT FOR ITEM 607-FENCE, MISC.: VANDAL PROTECTION FABRIC, COATED AND SHALL INCLUDE ALL LABOR, EQUIPMENT, MATERIALS AND INCIDENTALS NECESSARY TO COMPLETE THE ABOVE WORK.

ITEM 607-FENCE, MISC.: INSTALL NEW LINE RAIL

THIS ITEM IS USED FOR:
LOCATION 15 – CUY-42-1457

THE CONTRACTOR SHALL REPLACE THE MISSING SECTIONS OF LINE RAIL WITH A NEW ALUMINUM LINE RAIL THAT IS COMPATIBLE WITH THE EXISTING FENCE. ANY ADDITIONAL HARDWARE REQUIRED FOR INSTALLATION TO THE EXISTING FENCE IS INCLUDED IN THIS ITEM.

PAYMENT FOR ALL OF THE ABOVE SHALL BE AT THE UNIT PRICE BID PER FOOT FOR ITEM 607-FENCE, MISC.: INSTALL NEW LINE RAIL WHICH SHALL INCLUDE ALL LABOR, EQUIPMENT, MATERIALS, DISPOSAL AND INCIDENTALS NECESSARY TO COMPLETE THE ABOVE WORK.

ITEM 607-FENCE, MISC.: ACCESS OPENING AND COVER AT LIGHT POLE

THIS ITEM IS USED FOR:
LOCATION 15 – CUY-42-1457

PROVIDE ACCESS HOLES AND COVER PLATES AT ALL LIGHT POLE LOCATIONS IN ACCORDANCE WITH STANDARD CONSTRUCTION DRAWING VPF-1-90. THE COVERS AND ALL INCIDENTAL HARDWARE REQUIRED FOR INSTALLATION IN THE EXISTING FENCE IS INCLUDED IN THIS ITEM.

PAYMENT FOR ALL OF THE ABOVE SHALL BE AT THE UNIT PRICE BID PER EACH FOR ITEM 607-FENCE, MISC.: ACCESS OPENING AND COVER AT LIGHT POLE WHICH SHALL INCLUDE ALL LABOR, EQUIPMENT, MATERIALS, DISPOSAL AND INCIDENTALS NECESSARY TO COMPLETE THE ABOVE WORK.

ITEM 607-FENCE, MISC.: REPAIR OR REPLACE EXISTING TRUSS ROD

THIS ITEM IS USED FOR:
LOCATION 15 – CUY-42-1457

RECONNECT OR REPLACE THE EXISTING TRUSS RODS AT THE EXPANSION JOINT LOCATIONS AND BRIDGE ENDS WITH ALUMINUM PARTS COMPATIBLE WITH THE EXISTING CHAIN LINK FENCE. ADDITIONAL HARDWARE MAY BE REQUIRED FOR THIS WORK.

PAYMENT FOR ALL OF THE ABOVE SHALL BE AT THE UNIT PRICE BID PER EACH FOR ITEM 607 – FENCE, MISC.: REPAIR OR REPLACE EXISTING TRUSS ROD WHICH SHALL INCLUDE ALL LABOR, EQUIPMENT, MATERIALS, DISPOSAL AND INCIDENTALS NECESSARY TO COMPLETE THE ABOVE WORK.

ITEM 607-FENCE, MISC.: REPLACE LOOP CAPS

THIS ITEM IS USED FOR:
LOCATION 15 – CUY-42-1457

THE CONTRACTOR SHALL REMOVE AND DISPOSE OF ANY EXISTING LOOP CAPS PER CMS 202. THE EXISTING TOP LINE RAIL IS TO REMAIN AND SHOULD BE USED WITH THE NEW LOOP CAPS. RECONNECT THE EXISTING TOP LINE RAIL TO THE EXISTING FENCE FABRIC IF NECESSARY.

PAYMENT FOR ALL OF THE ABOVE SHALL BE AT THE UNIT PRICE BID PER EACH FOR ITEM 607-FENCE, MISC.: REPLACE LOOP CAPS WHICH SHALL INCLUDE ALL LABOR, EQUIPMENT, MATERIALS, DISPOSAL AND INCIDENTALS NECESSARY TO COMPLETE THE ABOVE WORK.

ITEM 607-FENCE, MISC.: REPLACE EXTRUDED POST

THIS ITEM IS USED FOR:
LOCATION 15 – CUY-42-1457

AT THE POST LOCATION, THE CONTRACTOR IS PERMITTED TO DETACH A PORTION OF THE FENCE FABRIC NECESSARY TO PERFORM THIS WORK.

REMOVE THE EXISTING POST THAT HAS SLIPPED OUT OF THE ORIGINAL SLEEVE. FILL THE EXISTING HOLES WITH NONSHRINK, NONMETALLIC GROUT. INSTALL A BASE PLATE, ADD NEW FENCE POST AND RECONNECT THE EXISTING FENCE PER DETAILS IN THE PLAN. IF ANY ADDITIONAL PATCHING IS REQUIRED FOR THE DOWELING OF ANCHOR BOLTS BY THE ENGINEER, IT SHALL BE INCLUDED IN THIS ITEM.

PAYMENT FOR ALL OF THE ABOVE SHALL BE AT THE UNIT PRICE BID PER EACH FOR ITEM 607-FENCE, MISC.: REPLACE EXTRUDED POST WHICH SHALL INCLUDE ALL LABOR, EQUIPMENT, MATERIALS, DISPOSAL AND INCIDENTALS NECESSARY TO COMPLETE THE ABOVE WORK.

ITEM 607-FENCE, MISC.: REPAIR FENCE FABRIC

THIS ITEM IS USED FOR:
LOCATION 15 – CUY-42-1457

REPAIR ANY OPEN AREAS OF THE FENCE FABRIC WITH ALUMINUM FABRIC WITH THE SAME FENCE OPENING SIZE AND WIRE DIAMETER.

PAYMENT FOR ALL OF THE ABOVE SHALL BE AT THE UNIT PRICE BID PER SQUARE FOOT FOR ITEM 607 – FENCE, MISC.: REPAIR FENCE FABRIC WHICH SHALL INCLUDE ALL LABOR, EQUIPMENT, MATERIALS AND INCIDENTALS NECESSARY TO COMPLETE THE ABOVE WORK.

CALCULATED
FLK
CHECKED
NRC

GENERAL NOTES

D12-BH-FY2009
FENCE

7
18

I:\PROJECTS\pid83561\dgn\83561_gen_sum.dgn 26-JAN-2009 9:15AM fkonopka

LOCATION / BRIDGE NO.															ITEM	ITEM EXT.	GRAND TOTAL	UNIT	DESCRIPTION	SEE SHEET NO.		
1	2	3	4	5	6	7	8	9	10	11	12	13	14	15							GENERAL	
CUY-7-1559 1805177 Ridge Rd	CUY-90-0892 1808117 Alger Rd	CUY-90-0909 1808125 Warren Rd	CUY-90-1062 1808249 West 117th St	CUY-90-1094 1808273 West 110th St	CUY-90-1110 1808303 West 106th St	CUY-90-1185 1808451 US-10 (Lorain Blvd)	CUY-90-1201 1808478 W 84th St - W 85th St	CUY-90-1214 1808486 Clark Ave	CUY-90-1237 1808532 West 73rd St	CUY-90-1270 1808699 West 65th St	CUY-90-1345 1807811 West 44th St	CUY-90-1361 1807846 West 41st St	CUY-90-1435 1807889 US-42 (West 25th St)	CUY-42-1457 1803271 US-42 (West 25th St) over Big Creek	GENERAL							
															LUMP	201	11000	LUMP		CLEARING AND GRUBBING		
1572																202	75001	1572	FT	FENCE REMOVED, AS PER PLAN A	5, 11	
	502	589	470	437	448	636	457	503	566	393	364	378	437			202	75001	6180	FT	FENCE REMOVED, AS PER PLAN B	6, 12	
											146	151	173			512	10100	470	SQ YD	SEALING OF CONCRETE SURFACES (EPOXY-URETHANE)	9	
585	197	229	185	173	177	247	181	198	221	147					SPEC	512E71500	2540	SQ YD	URETHANE TOP COAT SEALER	9		
1572																514	27710	1572	FT	FIELD PAINTING, MISC.: PAINT EXISTING FENCE POSTS, RAILS, AND APPURTENANCES		
																519	11101	5	SQ FT	PATCHING CONCRETE STRUCTURE, AS PER PLAN	6, 9	
	502	589	470	437	448	636	457	503	566	393	364	378	437			607	39901	6180	FT	VANDAL PROTECTION FENCE, 6' STRAIGHT, COATED FABRIC, AS PER PLAN	6, 12	
1572																607	98000	1572	FT	FENCE, MISC.: VANDAL PROTECTION FABRIC, COATED		
																607	98000	26	FT	FENCE, MISC.: INSTALL NEW LINE RAIL		
																607	98100	17	EACH	FENCE, MISC.: INSTALL LIGHT POLE ACCESS OPENING AND COVER		
																607	98100	28	EACH	FENCE, MISC.: REPAIR OR REPLACE EXISTING TRUSS ROD		
																607	98100	376	EACH	FENCE, MISC.: REPLACE EXISTING LOOP CAPS		
																607	98100	12	EACH	FENCE, MISC.: REPLACE EXTRUDED POST		
																607	98300	19	SQ FT	FENCE, MISC.: REPAIR FENCE FABRIC		
																LUMP	614	11000	LUMP	MAINTAINING TRAFFIC		
																50	614	11100	50	HOUR	LAW ENFORCEMENT OFFICER WITH PATROL CAR	
																4	614	18601	4	SIGN-MO	PORTABLE CHANGEABLE MESSAGE SIGN, AS PER PLAN	16
																6	619	16010	6	MONTH	FIELD OFFICE, TYPE B	
																LUMP	624	10000	LUMP	MOBILIZATION		
																1000	832	30000	1000	EACH	EROSION CONTROL	

CALCULATED	EJK	CHECKED	NRC
GENERAL SUMMARY			
D12-BH-FY2009 FENCE			
8 18			

LOCATION	BRIDGE NUMBER SFN DESCRIPTION	STRUCTURE TYPE	STRUCTURE LIMITS	ROADWAY WIDTH (±/± curbs)	LANES ON	LANES UNDER	PROPOSED WORK (* Fence and Sealing Details can be found on sheet 12)	LENGTH OF EXISTING AND PROPOSED FENCE	SEALER Federal Color No. 595b-
1	CUY-71-1559 1805177 Ridge Rd. over IR-71 and CSX	8 Span Continuous Steel Beam	756' ◊	52' - 0" ◊	4	9	Refer to plan sheets for work at this location.	769' - 8" ◊ Left 801' - 9 1/2" ◊ Right	27778 (Light Neutral, semigloss)
2	CUY-90-0892 1808117 Alger Rd. over IR-90	2 Span Continuous Steel Beam	255' ◊	28' - 0" ◊	2	8	- Replace existing bridge fence * - Reconnect proposed bridge fence with existing R/W fence. - Seal portions of concrete parapet with Urethane *	249' - 2 3/8" ◊ Left 252' - 7 3/4" ◊ Right	27722 (Buff, semigloss)
3	CUY-90-0909 1808125 Warren Rd. over IR-90	2 Span Continuous Steel Beam	298' ◊	64' - 0" ◊	5	8	- Replace existing bridge fence * - Reconnect proposed bridge fence with existing R/W fence. - Seal portions of concrete parapet with Urethane *	294' - 5" ◊ Left 294' - 1 1/4" ◊ Right	27722 (Buff, semigloss)
4	CUY-90-1062 1808249 W. 117th St. over IR-90	3 Span Continuous Steel Beam	239' ◊	84' - 0" ◊ (w/ 4' - 0" ◊ median)	6	10	- Replace existing bridge fence * - Reconnect proposed bridge fence with existing R/W fence. - Seal portions of concrete parapet with Urethane *	234' - 11" ◊ Left 234' - 11" ◊ Right	27722 (Buff, semigloss)
5	CUY-90-1094 1808273 W. 110th St. over IR-90	3 Span Continuous Steel Beam	222' ◊	28' - 0" ◊	2	10	- Replace existing bridge fence * - Reconnect proposed bridge fence with existing R/W fence. - Seal portions of concrete parapet with Urethane *	218' - 3 1/2" ◊ Left 218' - 3 1/2" ◊ Right	27722 (Buff, semigloss)
6	CUY-90-1110 1808303 W. 106th St. over IR-90	3 Span Continuous Steel Beam	228' ◊	28' - 0" ◊	2	10	- Replace existing bridge fence * - Reconnect proposed bridge fence with existing R/W fence. - Seal portions of concrete parapet with Urethane *	224' - 1 1/4" ◊ Left 224' - 1 1/4" ◊ Right	27722 (Buff, semigloss)
7	CUY-90-1185 1808451 US-10/Lorain Ave. over IR-90	3 Span Continuous Steel Beam	321' ◊	54' - 0" ◊	4	10	- Replace existing bridge fence * - Seal portions of concrete parapet with Urethane *	312' - 11 3/8" ◊ Left 322' - 7 3/8" ◊ Right	27722 (Buff, semigloss)
8	CUY-90-1201 1808478 W. 84th St./W. 85th St. Connector over IR-90	3 Span Continuous Steel Beam	234' ◊	52' - 0" ◊	4	8	- Replace existing bridge fence * - Seal portions of concrete parapet with Urethane *	228' - 6" ◊ Left 228' - 6" ◊ Right	27722 (Buff, semigloss)
9	CUY-90-1214 1808486 Clark Ave. over IR-90	3 Span Continuous Steel Beam	223' ◊	52' - 0" ◊	4	2	- Replace existing bridge fence * - Seal portions of concrete parapet with Urethane *	255' - 2 1/4" ◊ Left 248' - 3 1/8" ◊ Right	27722 (Buff, semigloss)
10	CUY-90-1237 1808532 W. 73rd St. over IR-90	3 Span Continuous Steel Beam	287' ◊	36' - 0" ◊	2	11	- Replace existing bridge fence * - Seal portions of concrete parapet with Urethane *	283' - 2 1/4" ◊ Left 283' - 2 1/4" ◊ Right	27722 (Buff, semigloss)
11	CUY-90-1270 1808699 W. 65th St. over IR-90 WB	3 Span Continuous Steel Beam	196' ◊	40' - 0" ◊	2	4	- Replace existing bridge fence * - Seal portions of concrete parapet with Urethane *	196' - 5 1/4" ◊ Left 196' - 5 1/4" ◊ Right	27722 (Buff, semigloss)
12	CUY-90-1345 1807811 W. 44th St. over IR-90	2 Span Continuous Steel Beam	186' ◊	36' - 0" ◊	2	8	- Replace existing bridge fence * - Seal portions of concrete parapet with Epoxy-Urethane *	181' - 11" ◊ Left 181' - 11" ◊ Right	27722 (Buff, semigloss)
13	CUY-90-1361 1807846 W. 41st St. over IR-90	2 Span Continuous Steel Beam	193' ◊	40' - 0" ◊	3	8	- Replace existing bridge fence * - Seal portions of concrete parapet with Epoxy-Urethane *	189' - 0" ◊ Left 189' - 0" ◊ Right	27722 (Buff, semigloss)
14	CUY-90-1435 1807889 US-42/W. 25th St. over IR-90	2 Span Continuous Steel Beam	222' ◊	48' - 0" ◊	4	9	- Patch existing parapet at Northeast Corner - Replace existing bridge fence * - Seal portions of concrete parapet with Epoxy-Urethane *	218' - 3" ◊ Left 218' - 3" ◊ Right	27722 (Buff, semigloss)
15	CUY-42-1457 1803271 US-42/W. 25th St. over Big Creek, NSC and CSX	18 Span Continuous Steel Beam	1714' ◊	52' - 0" ◊	4	RR	Refer to plan sheets for work at this location.	n/a	n/a

I:\PROJECTS\p183561\bridge_data.dgn 26-JAN-2009 9:16AM fkonopka

I:\PROJECTS\pid83561\dgn\83561_C71_1559_RidgeRd.dgn 26-JAN-2009 9:17AM fkonopka

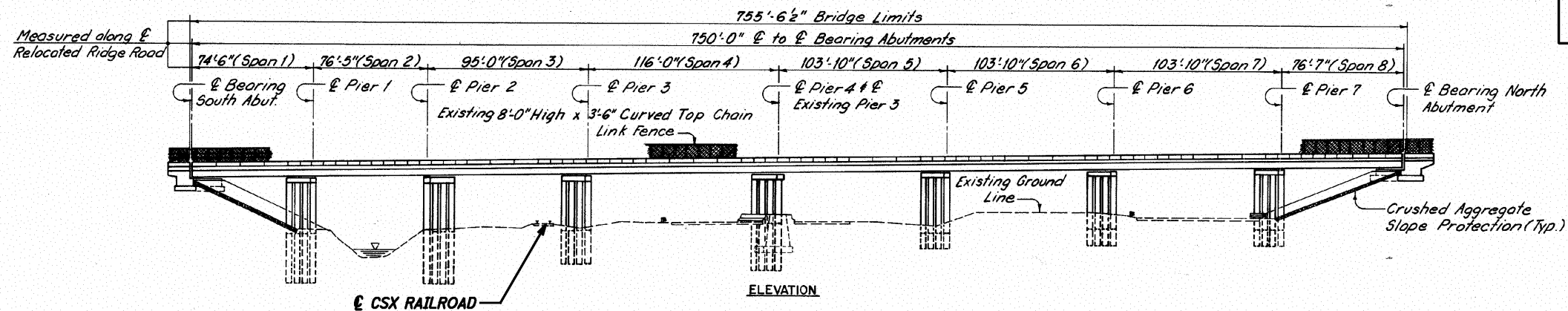
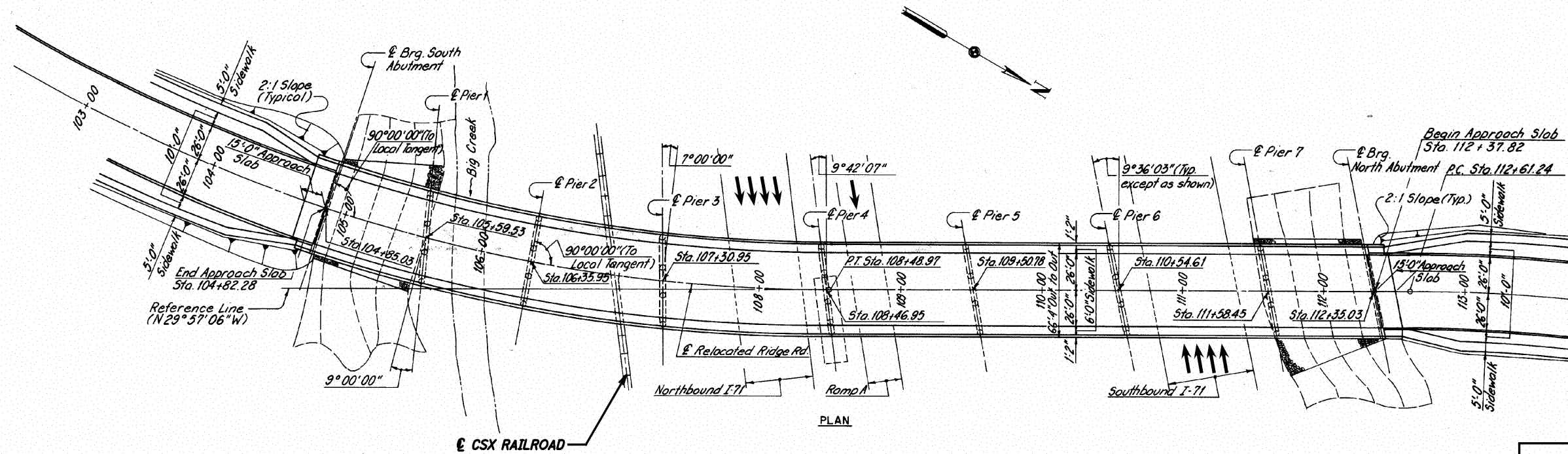

PROPOSED WORK:

- Remove existing fence fabric
- Paint existing posts, line rails, and remaining hardware
- Install new black-coated VPF fabric, including light pole access covers
- Seal top and inside face of barrier with urethane

PLAN AND ELEVATION VIEWS ARE TAKEN FROM ORIGINAL PLANS AND SHOULD BE USED FOR INFORMATIONAL PURPOSES.

ALL DIMENSIONS ARE 1/4".

DO ONLY WORK LISTED UNDER PROPOSED WORK.

DESIGNED EJK/NRC CHECKED	DRAWN EJK REVISED	REVIEWED KJM	DATE 01/09	DESIGN AGENCY Ohio Dept. of Transportation	
		STRUCTURE FILE NUMBER 1805177	DISTRICT District 12		
		GENERAL PLAN			
		Bridge No. CUY-71-1559			
Ridge Road over IR-71 & CSX RR					
D12 BH FY 2009	PID No. 83561				
1/2					
10					
18					

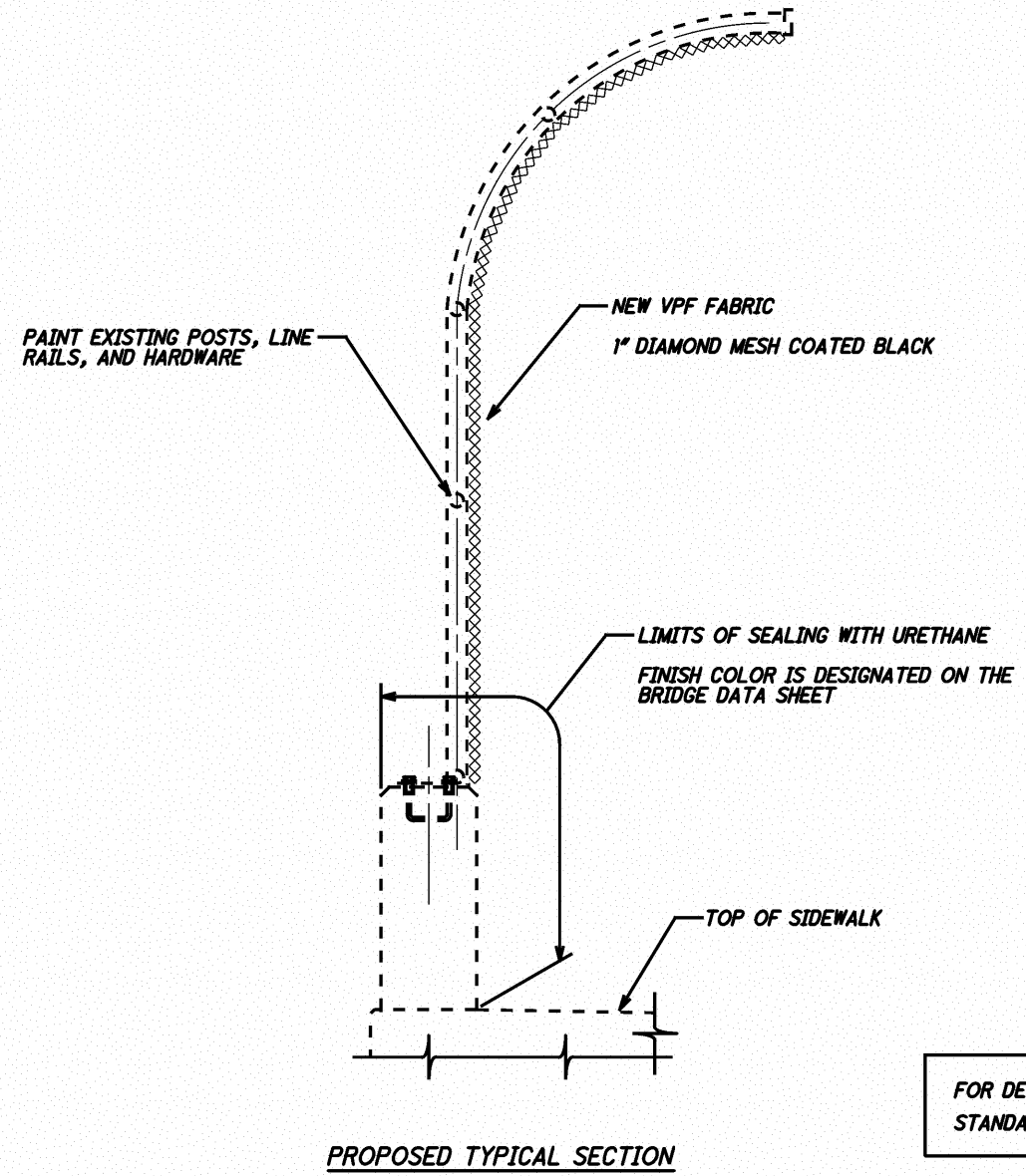
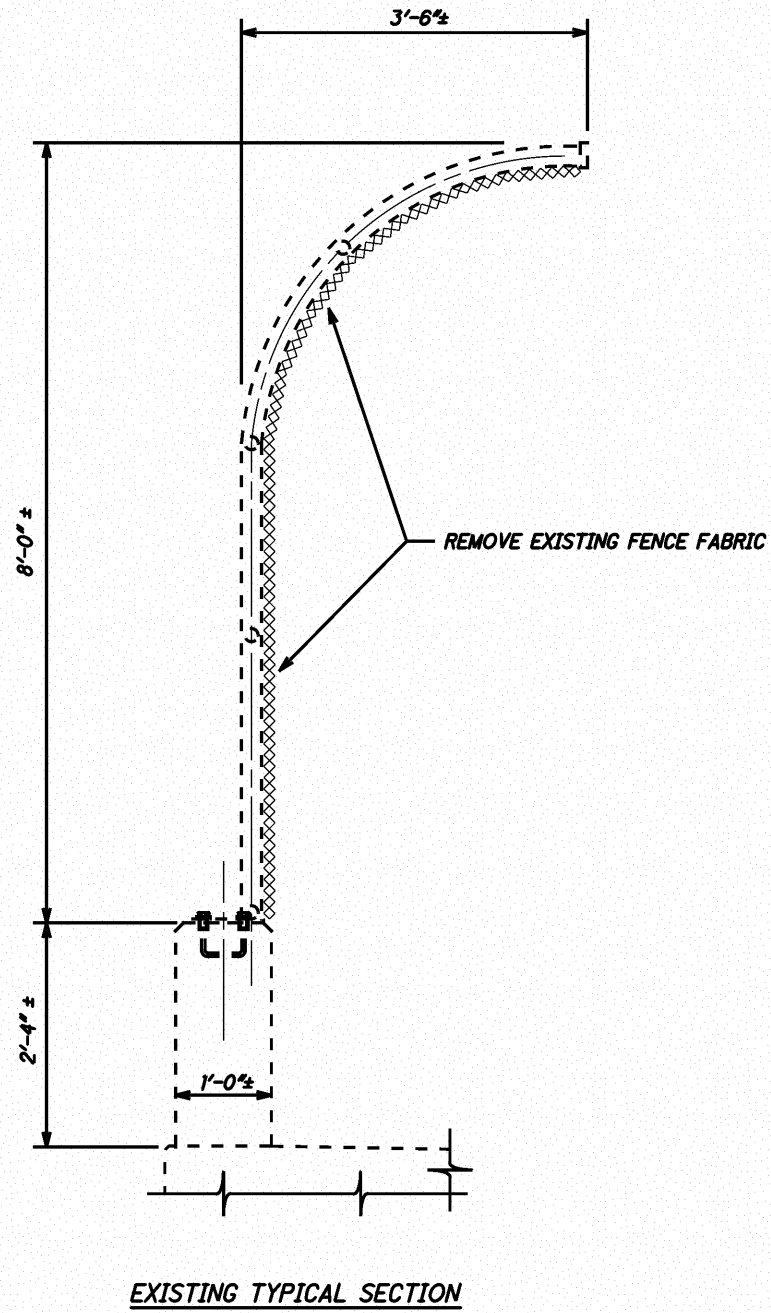

FOR DETAILS NOT SHOWN, REFER TO
STANDARD DRAWING NO. VPF-1-90

D12-BH-FY2009 PID No. 83561	FENCE DETAILS Bridge No. CUY-71-1559 Ridge Road over IR-71 & CSX RR		DESIGNED EJK/NRC CHECKED	DRAWN EJK REVISED	REVIEWED KJM STRUCTURE FILE NUMBER 1805177	DATE 01/09	DESIGN AGENCY Ohio Dept. of Transportation District 12
	2 / 2	11 18					

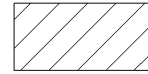

ITEM 202 - FENCE REMOVED, AS PER PLAN

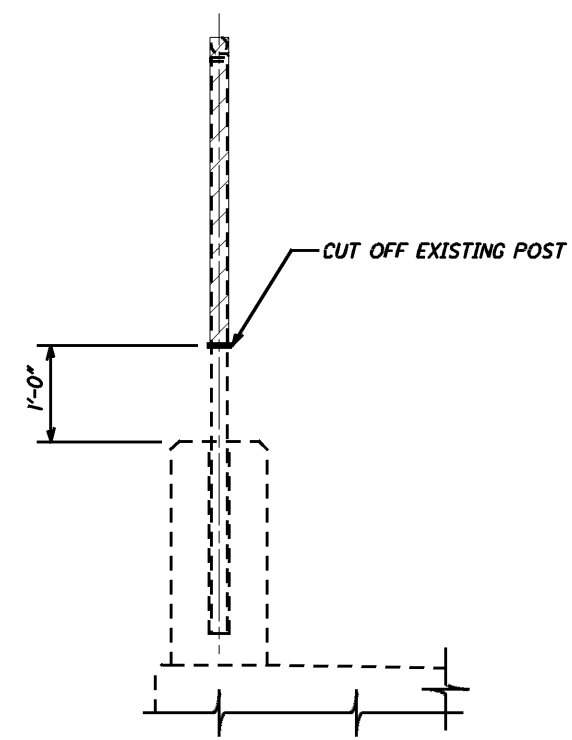

EXISTING TYPICAL SECTION

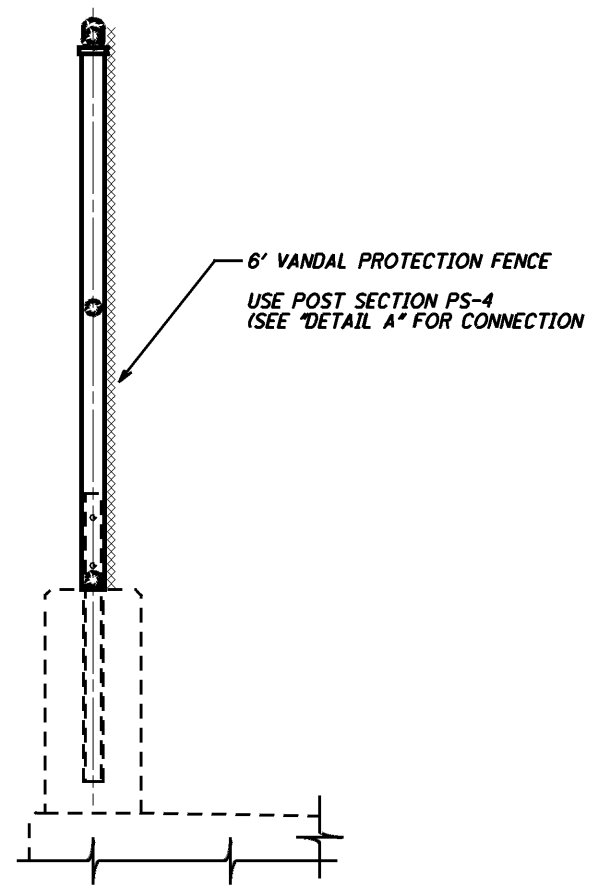

PROPOSED TYPICAL SECTION

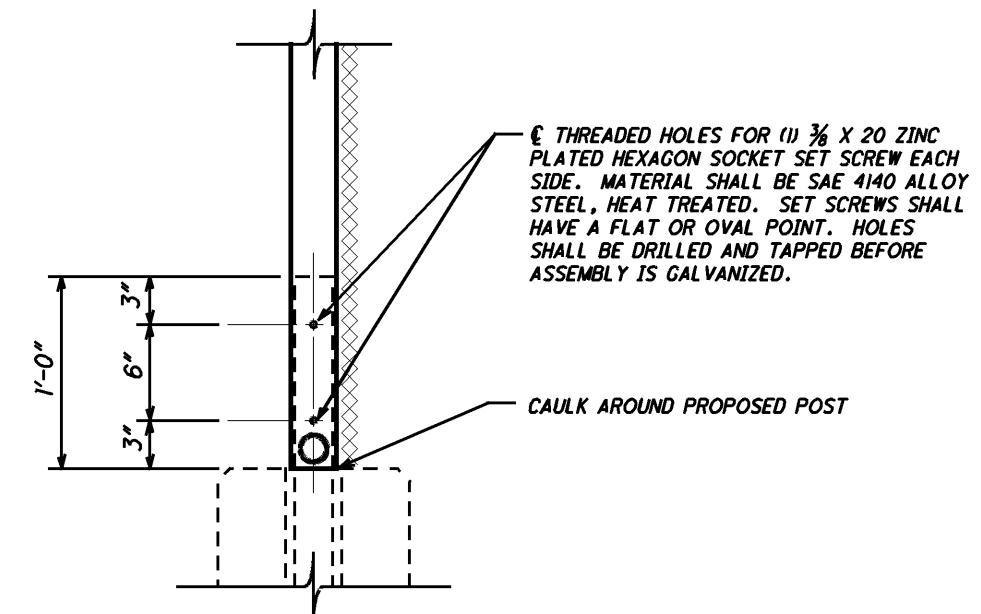

DETAIL A

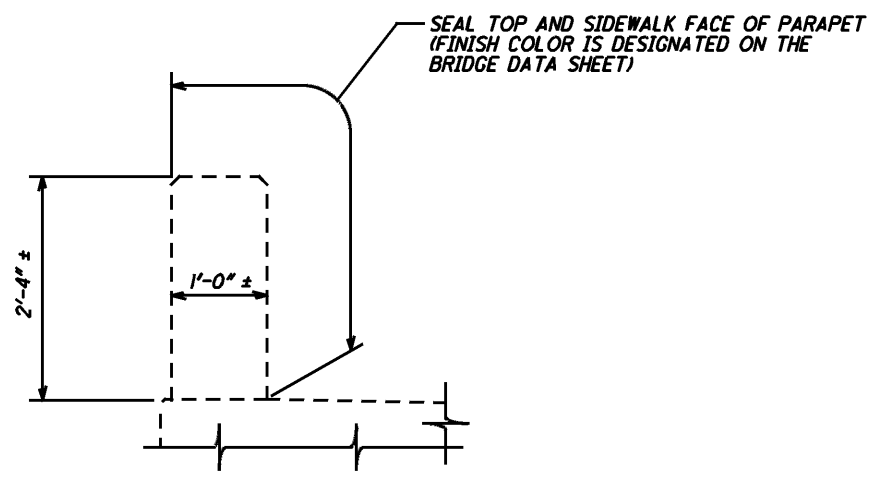

SEALING LIMITS

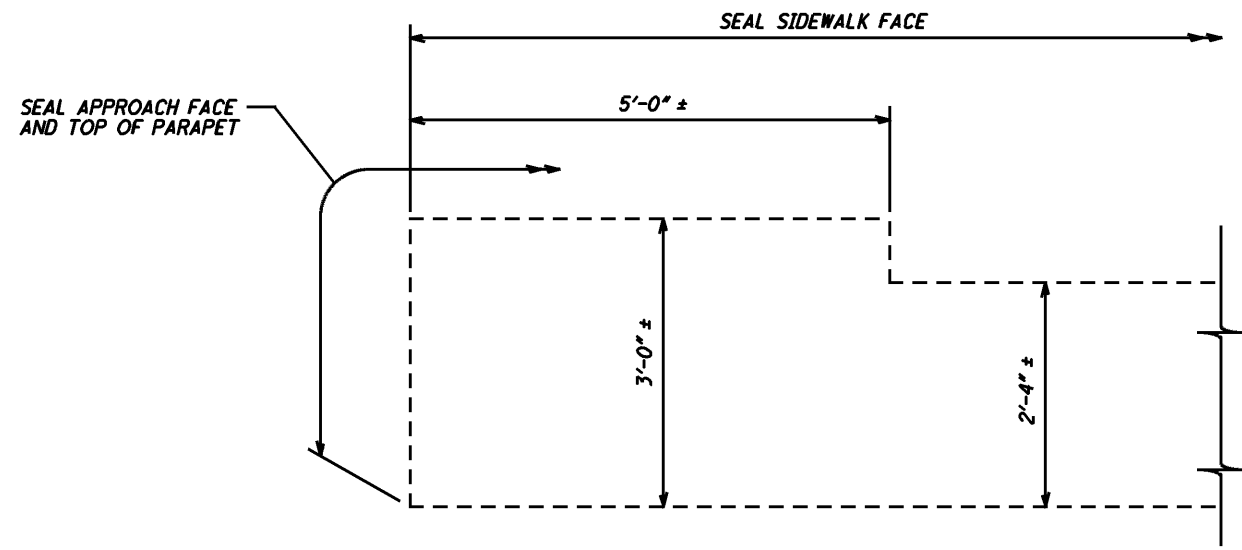

SEALING LIMITS PARTIAL ELEVATION

I:\PROJECTS\pid83561\dgn\83561_Details_FenceSealing.dgn 26-JAN-2009 9:18AM fkonopka

DESIGNED EJK/NRC	CHECKED	DRAWN EJK	REVIEWED KJW	DATE 01/09	DESIGN AGENCY Ohio Dept. of Transportation
		REVIS	STRUCTURE FILE NUMBER VARIES	District 12	
FENCE REPLACEMENT AND SEALING DETAILS					
For Locations 2 - 14					
D12 BH FY 2009			PID No. 83561		
1 / 1		12 / 18			

*** CSX REQUIREMENTS:**
 THE CONTRACTOR SHALL NOT ENTER ONTO RAILROAD PROPERTY, INCLUDING RAILROAD MAINTENANCE ROADS, FOR ANY REASON, UNLESS PRIOR APPROVAL IS RECEIVED FROM RAILROAD CONSTRUCTION REPRESENTATIVE. IF SUCH APPROVAL IS RECEIVED FROM RAILROAD CONSTRUCTION REPRESENTATIVE, THE CONTRACTOR SHALL STRICTLY ABIDE BY THE INSTRUCTIONS OF RAILROAD FLAGGER, IF FLAGGER IS REQUIRED BY RAILROAD.

**** NS REQUIREMENTS:**
 THE CONTRACTOR SHALL NOT ENTER ONTO RAILROAD PROPERTY FOR ANY REASON. THE USE OF RAILROAD MAINTENANCE ROADS TO ACCESS THE WORK AREA IS STRICTLY PROHIBITED.

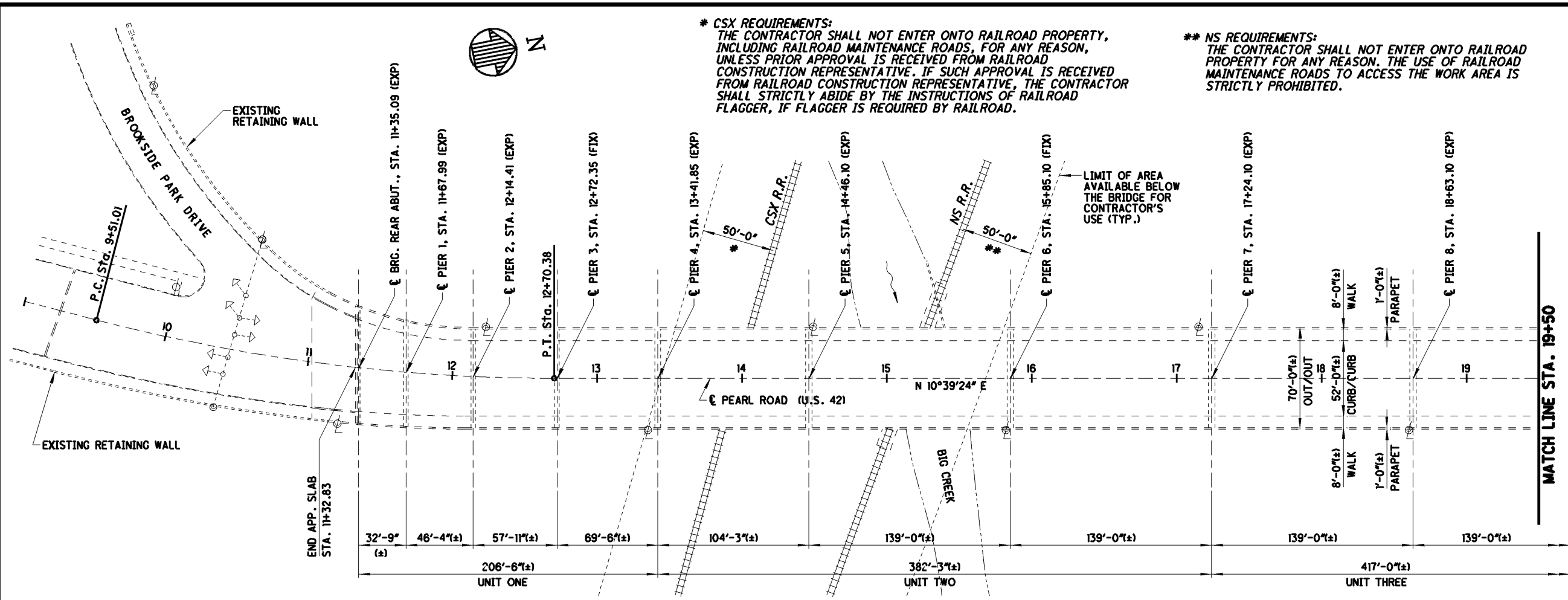

GENERAL PLAN

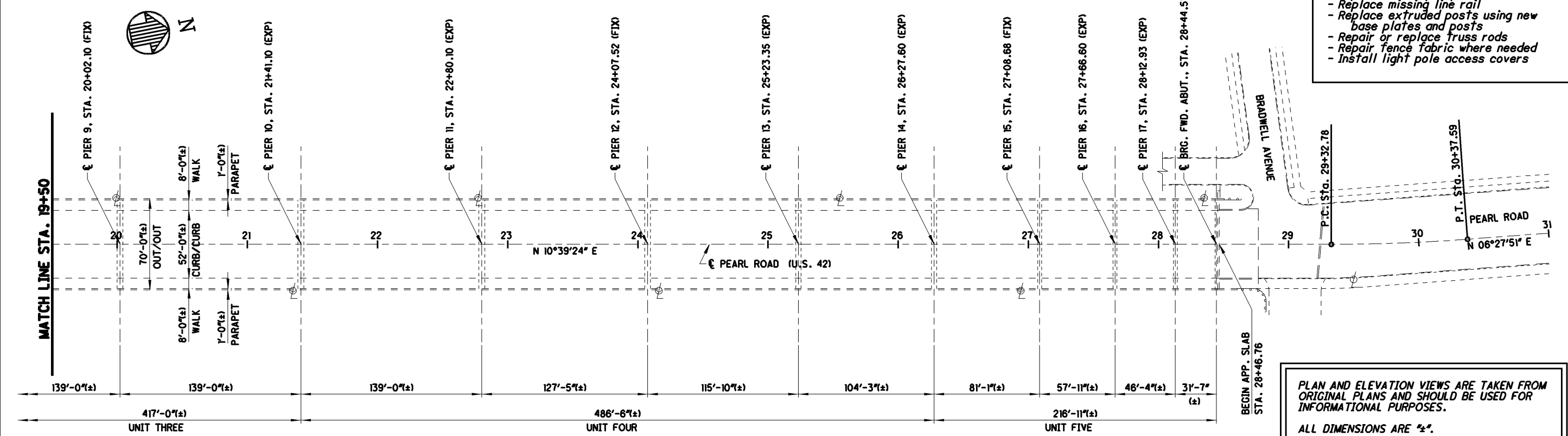

GENERAL PLAN

PROPOSED WORK:

- Repair portions of the existing fence:
- Replace all loop caps
- Replace missing line rail
- Replace extruded posts using new base plates and posts
- Repair or replace truss rods
- Repair fence fabric where needed
- Install light pole access covers

PLAN AND ELEVATION VIEWS ARE TAKEN FROM ORIGINAL PLANS AND SHOULD BE USED FOR INFORMATIONAL PURPOSES.
 ALL DIMENSIONS ARE ±".
 DO ONLY WORK LISTED UNDER PROPOSED WORK.

I:\PROJECTS\pid83561\p83561.dgn 26-JAN-2009 9:19AM fkonopka

DESIGNED EJK/NRC CHECKED	DRAWN EJK REVISED	REVIEWED KJW	DATE 01/09	DESIGN AGENCY Ohio Dept. of Transportation District 12
		STRUCTURE FILE NUMBER 1803271		
GENERAL PLAN (1)				Bridge No. CUY-42-1457
D12 BH FY2009				
PID No. 83561				US-42 over Big Creek, NSC, & CSX
1 / 2				
13				18

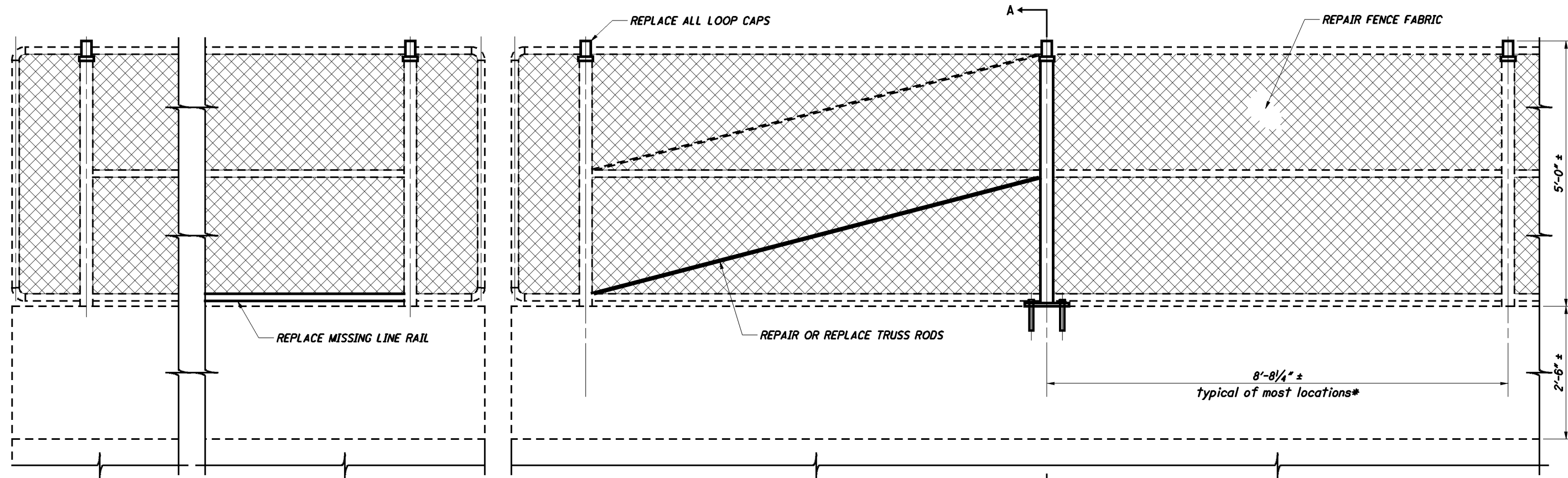

TYPICAL SECTION

*Contractor shall verify all dimensions prior to ordering materials

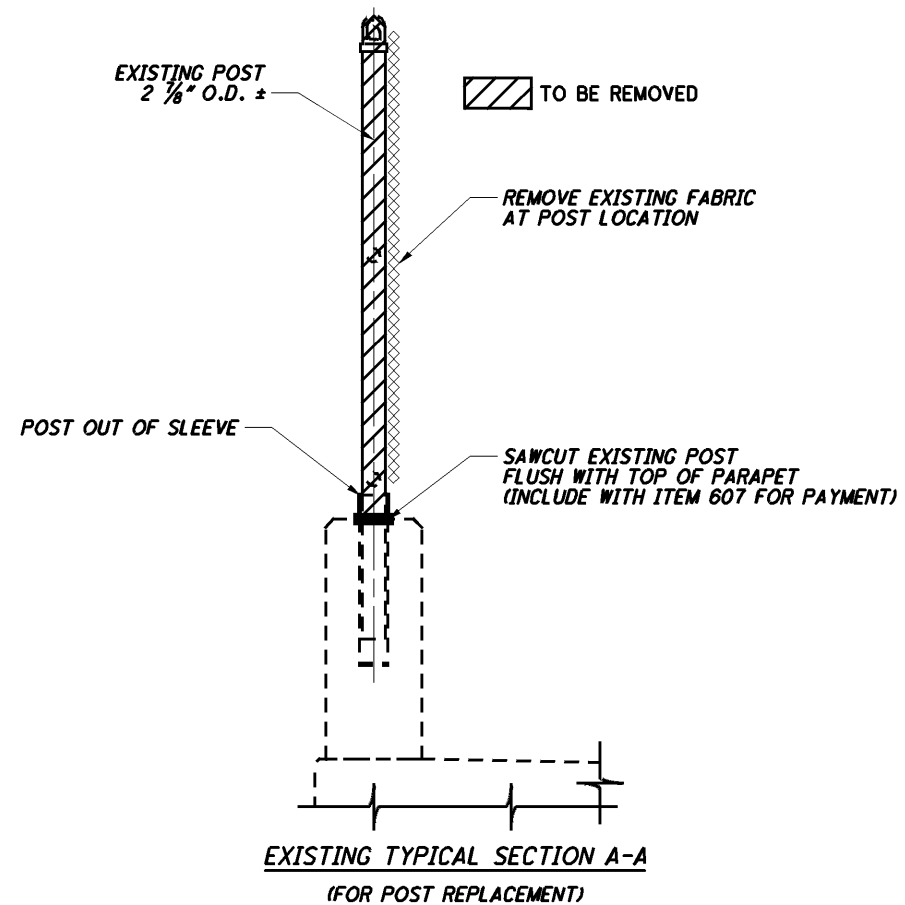

EXISTING TYPICAL SECTION A-A
(FOR POST REPLACEMENT)

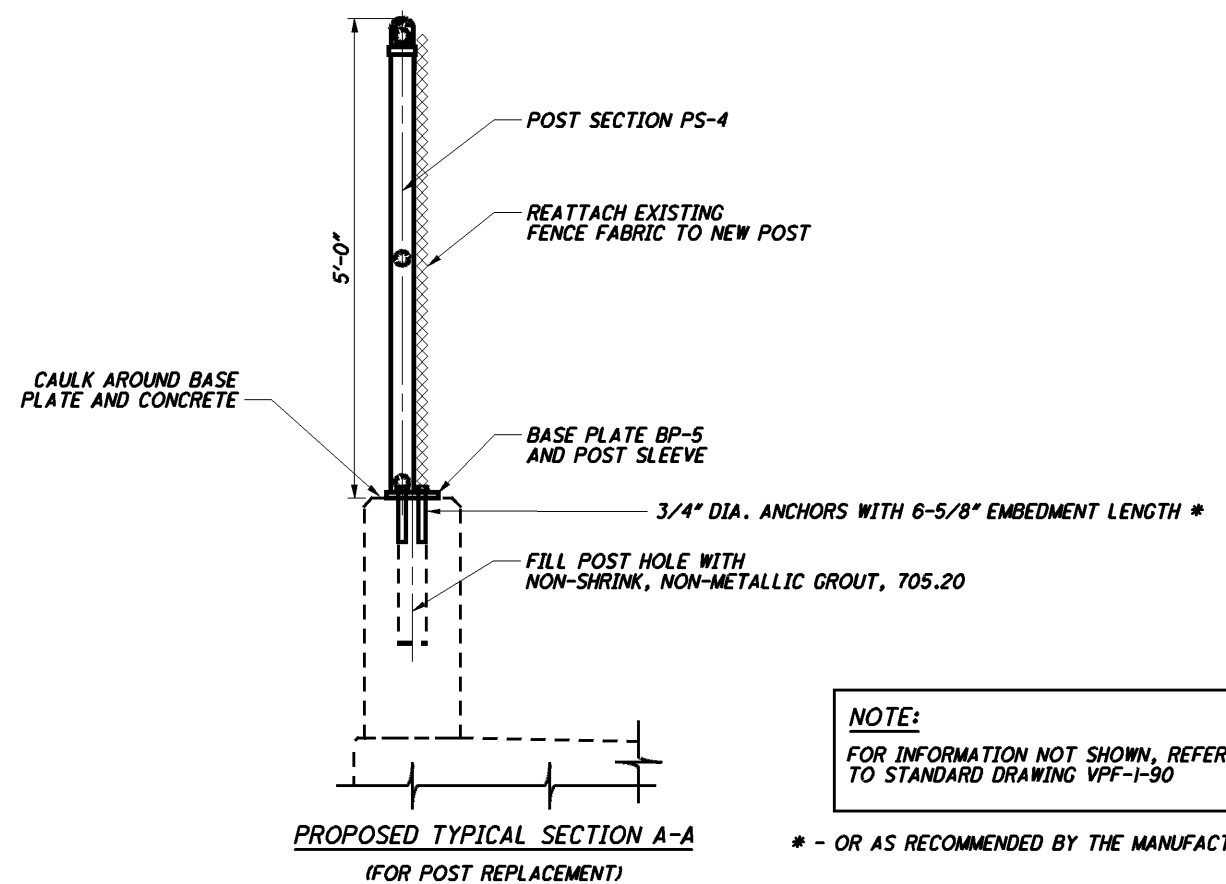

PROPOSED TYPICAL SECTION A-A
(FOR POST REPLACEMENT)

NOTE:
FOR INFORMATION NOT SHOWN, REFER TO STANDARD DRAWING VPF-1-90

* - OR AS RECOMMENDED BY THE MANUFACTURER

I:\PROJECTS\pid83561\dgn\83561_C42_1457.dgn 26-JAN-2009 9:19AM fkonopka

DESIGN AGENCY Ohio Dept. of Transportation District 12	
DATE 01/09	REVIEWED KJW
STRUCTURE FILE NUMBER 1803271	DRAWN EJK
DESIGNED EJK/NRC	CHECKED
FENCE REPAIR DETAILS Bridge No. CUY-42-1457 US-42 over Big Creek, NSC. & CSX	
D12 BH FY2009 PID No. 83561	
2 / 2	

ITEM 614 - MAINTAINING TRAFFIC

GENERALLY THE CONTRACTOR SHALL CONDUCT HIS OPERATIONS AS TO MAKE THE PROPOSED REPAIR WITH A MINIMUM OF HAZARD, DELAY AND INCONVENIENCE TO THE MOTORISTS USING THE HIGHWAY AFFECTED BY THE WORK DONE UNDER THIS CONTRACT. IN ADDITION TO THE CONSTRUCTION AND MATERIAL SPECIFICATIONS, THE FOLLOWING SPECIFIC PROVISIONS ARE MANDATORY.

I. NOTIFICATION

SINCE FUNCTIONAL TRAFFIC CONTROL IS A MAJOR CONCERN ON THIS PROJECT, IT IS ESSENTIAL THAT THE MOTORING PUBLIC BE ADEQUATELY FOREWARNED OF FUTURE LANE CLOSURES AND TRAFFIC CONSTRUCTIONS. THEREFORE, THE CONTRACTOR MUST SUBMIT A WRITTEN SCHEDULE TO THE ENGINEER, RESPONSIBLE LAW ENFORCEMENT AGENCIES, CITY ENGINEER'S OFFICE, AND THE ODOT PUBLIC INFORMATION OFFICE (216-584-2007) INDICATING THE LOCATIONS AND DATES OF THE LANE CLOSURES AT LEAST 3 DAYS PRIOR TO THE IMPLEMENTATION OF ANY SUCH CLOSURES. USE PORTABLE CHANGEABLE MESSAGE SIGNS TO ALERT MOTORISTS 3 DAYS PRIOR TO THE IMPLEMENTATION OF ANY CHANGES SUCH AS LANE CLOSURES OR OTHER RESTRICTIONS.

II. LANE CLOSURE RESTRICTIONS

1. LANE CLOSURES MAY ONLY BE IMPLEMENTED AT THE TIMES PERMITTED BY THE "DISTRICT 12 PERMITTED LANE CLOSURE TIMES" LIST WHICH IS LOCATED ON THE ODOT WEB SITE:

www.dot.state.oh.us/districts/D12/HighwayManagement/Pages/PermittedLaneClosures.aspx

THE LATEST REVISION AT 14 DAYS PRIOR TO THE BID DATE SHALL BE IN EFFECT FOR THIS PROJECT.

2. ANY ROADWAY NOT LISTED IN THE "DISTRICT 12 PERMITTED LANE CLOSURE TIMES" SHALL NOT HAVE ANY WEEKDAY CLOSURES FROM 7:00AM - 9:00AM OR 3:00PM - 6:00 PM.
3. UNLESS OTHERWISE NOTED, EXIT AND ENTRANCE RAMP LANES SHALL REMAIN OPEN AT ALL TIMES AND EXHIBIT A MINIMUM WIDTH OF TEN (10) FEET.
4. NO LANE OR SHOULDER CLOSURES SHALL BE IN PLACE WHEN NO WORK IS BEING PERFORMED.
5. MAINTENANCE OF TRAFFIC SHALL FOLLOW THE INSTRUCTION OF THE STANDARD CONSTRUCTION DRAWINGS LISTED ON THE TITLE SHEET AND THE LATEST REVISION OF THE OMUTCD.
6. PEDESTRIAN TRAFFIC SHALL BE PERMITTED AND ACCOMMODATED ON AT LEAST ONE SIDE OF THE STRUCTURE AT ALL TIMES.

NOTWITHSTANDING THE ABOVE, NO LANE CLOSURES SHALL OCCUR DURING THE PERIOD BEGINNING AT 12:00 NOON ON THE DAY PRECEDING AND CONTINUING UNTIL 12:00 A.M. ON THE DAY FOLLOWING LEGAL HOLIDAYS AND HOLIDAY WEEKENDS SUCH AS MEMORIAL DAY, FOURTH OF JULY, AND LABOR DAY. FURTHERMORE, NO LANE CLOSURES ARE TO BE IMPLEMENTED OR IN PLACE DURING INCREASED TRAFFIC VOLUMES CAUSED BY SPECIAL EVENTS OR WHEN THE ENGINEER DEEMS THE CLIMATOLOGICAL CONDITIONS TOO HAZARDOUS.

III. MAINTENANCE OF TRAFFIC SYSTEMS

1. WHEN REQUIRED

WHENEVER ANY PART OF THE TRAVELED SURFACE IS BEING WORKED UPON OR IS OTHERWISE NOT SUITABLE FOR SAFE AND CONVENIENT USE BY VEHICLES, TRAFFIC CONTROL DEVICES SUFFICIENT TO PROTECT SUCH AREAS TO ASSURE THE SAFE AND CONVENIENT PASSAGE OF VEHICULAR TRAFFIC SHALL BE INSTALLED AND MAINTAINED. SUCH TRAFFIC CONTROL DEVICES AND THE MANNER IN WHICH THEY ARE USED SHALL BE CONSISTENT WITH THESE PLANS AND THE OHIO MANUAL OF UNIFORM TRAFFIC CONTROL DEVICES FOR STREETS AND HIGHWAYS, HEREINAFTER REFERRED TO AS THE "MANUAL". THE TRAFFIC CONTROL DEVICE SYSTEM SHALL CONSTITUTE THE MINIMUM PROVISIONS FOR TRAFFIC CONTROL FOR EACH PARTICULAR SITUATION. WHENEVER THE ENGINEER DEEMS IT NECESSARY ESPECIALLY WHERE A GRADE, CURVE, OR MERGE CONDITIONS EXISTS, HE MAY DIRECT THAT ADDITIONAL OR ALTERNATIVE DEVICES BE USED.

2. CONDITIONS

DURING ALL PARTS OF THIS PROJECT FLAGGERS, SIGNING, BARRICADES, FLASHING ARROWS, ETC. SHALL BE LOCATED AS INDICATED IN THE "MANUAL" OR AS SHOWN IN THE STANDARD DRAWINGS. TWO-WAY TRAFFIC SHALL BE MAINTAINED ON ONE LANE AT LEAST 10' WIDE AT ALL TIMES.

3. ADVANCE WARNING SIGNS

ALL ADVANCE WARNING SIGNS FOR ANY CONDITION WHICH RESTRICTS TRAFFIC SHALL BE ERECTED BEFORE ANY SUCH RESTRICTION IS PUT INTO EFFECT. ALL SUCH SIGNS SHALL BE COVERED OR REMOVED FROM THE VIEW OF TRAFFIC WHENEVER THEY ARE NOT APPLICABLE.

4. FLAGGERS

AT LEAST TWO FLAGGERS ARE REQUIRED FOR EACH CLOSURE. THE CONTRACTOR SHALL FURNISH ADDITIONAL FLAGGERS AS DIRECTED BY THE ENGINEER.

5. PROTECTION OF PUBLIC

PERSONAL CARS SHALL NOT BE PARKED WITHIN THE RIGHT OF WAY.

6. FAILURE TO COMPLY

IF THERE IS ANY FAILURE TO COMPLY WITH PROVISIONS FOR TRAFFIC CONTROL SET OUT IN THESE PLANS AND NOTES, OR WITH THE PROVISIONS OF THE "MANUAL", THE HIGHWAY IN THE VICINITY OF THE WORK AREA SHALL NOT BE CONSIDERED IN A CONDITION FOR THE SAFE AND CONVENIENT USE BY THE TRAVELING PUBLIC. ANY FAILURE TO KEEP THE HIGHWAY, IN THE VICINITY OF THE WORK AREA, IN A CONDITION FOR THE SAFE AND CONVENIENT USE BY THE TRAVELING PUBLIC SHALL BE CONSIDERED A BREACH OF THIS CONTRACT. WORK SHALL BE SUSPENDED UNTIL THE CONTRACTOR COMPLIES WITH THE PROVISIONS OF THE AFOREMENTIONED ITEMS.

IV. MAINTENANCE OF TRAFFIC MATERIALS

1. SIGNS

SIGN DIMENSIONS AND SPECIFICATIONS, INCLUDING LETTER SIZES ARE TO BE AS PROVIDED IN THE "MANUAL", OR IN DESIGN DRAWINGS PROVIDED BY THE DEPARTMENT OF TRANSPORTATION. THE SIGNS SHALL BE SUBJECT TO APPROVAL OF THE ENGINEER PRIOR TO THE START OF THE PROJECT.

2. SIGN SUPPORT

SIGN SUPPORTS SHALL BE OF SUFFICIENT SIZE AND MASS AS TO SUPPORT THE SIGNS AT THE APPROPRIATE HEIGHT. SUPPORTS SHALL BE AS SHOWN ON THE STANDARD DRAWINGS.

3. FLASHING ARROW REQUIREMENT

WHENEVER ANY PART OF THE TRAVELED SURFACE IS CLOSED, THE MOTORISTS SHALL BE WARNED AND DIRECTED BY THE CONTRACTOR THROUGH THE USE OF ONE FLASHING ARROW PANEL FOR EACH LANE CLOSED. THE CONTRACTOR SHALL REFER TO STANDARD DRAWING MT-35.10 AND THE PROVISIONS SET FORTH IN THE "MANUAL" FOR ALL INFORMATION REGARDING FURNISHING, MAINTAINING, AND USE OF FLASHING ARROW PANELS. PAYMENT FOR THE ABOVEMENTIONED ITEMS SHALL BE INCLUDED IN THE LUMP SUM BID FOR ITEM 614 - MAINTAINING TRAFFIC.

4. DRUMS

DRUMS SHALL BE IN ACCORDANCE WITH PERTINENT SECTIONS OF THE "MANUAL". ALL COSTS FOR INSTALLING, MAINTAINING, AND SUBSEQUENT REMOVAL OF SAID DRUMS IS TO BE INCLUDED IN THE LUMP SUM BID PRICE FOR ITEM 614 - MAINTAINING TRAFFIC.

5. CONES

CONES, IF UTILIZED, ARE TO BE LOCATED AS SHOWN IN THE "MANUAL" AND THE STANDARD DRAWINGS.

6. FLASHERS

FLASHERS SHALL BE 12 VOLT BATTERY-OPERATED MODELS WITH 7 INCH DIAMETER YELLOW LENSES ILLUMINATED BY RAPID INTERMITTENT FLASHERS OF SHORT DURATION AND ARE TO BE PLACED ON ALL SIGNS AT ALL TIMES AS REQUIRED BY THE "MANUAL" AND THE STANDARD CONSTRUCTION DRAWINGS.

V. PAYMENT

PAYMENT FOR PROVIDING, ERECTING, MAINTAINING AND REMOVING TEMPORARY MAINTENANCE OF TRAFFIC CONTROL DEVICES SHALL BE MADE UNDER THE LUMP SUM PRICE BID FOR ITEM 614 - MAINTAINING TRAFFIC.

ITEM 614 – LAW ENFORCEMENT OFFICER WITH PATROL CAR

IN ADDITION TO THE REQUIREMENTS OF ITEM 614 AND THE LATEST EDITION OF THE OHIO MANUAL OF UNIFORM TRAFFIC CONTROL DEVICES (OMUTCD), A UNIFORMED LAW ENFORCEMENT OFFICER AND OFFICIAL PATROL CAR WITH WORKING TOP MOUNTED EMERGENCY FLASHING LIGHTS SHALL BE PROVIDED FOR CONTROLLING TRAFFIC FOR THE FOLLOWING TASKS:

- FOR LANE CLOSURES: DURING INITIAL SET-UP PERIODS, TEAR DOWN PERIODS, SUBSTANTIAL SHIFTS OF A CLOSURE OR WHEN NEW LANE CLOSURE ARRANGEMENTS ARE INITIATED.
- WHEN DIRECTED BY THE ENGINEER.

LAW ENFORCEMENT OFFICERS (L.E.O.'S) SHOULD NOT BE USED WHERE THE OMUTCD INTENDS THAT FLAGGERS BE USED. THE LEO'S ARE CONSIDERED TO BE EMPLOYED BY THE CONTRACTOR AND THE CONTRACTOR SHALL BE RESPONSIBLE FOR THEIR ACTIONS. ALTHOUGH THEY ARE EMPLOYED BY THE CONTRACTOR, THE PROJECT ENGINEER SHALL HAVE CONTROL OVER THEIR PLACEMENT.

THE OFFICIAL PATROL CAR SHALL BE A PUBLIC SAFETY VEHICLE AS REQUIRED BY THE OHIO REVISED CODE.

LAW ENFORCEMENT OFFICERS WITH PATROL CARS REQUIRED BY THE TRAFFIC MAINTENANCE TASKS ABOVE SHALL BE PAID FOR ON A UNIT PRICE (HOURLY) BASIS UNDER ITEM 614 – LAW ENFORCEMENT OFFICER WITH PATROL CAR. THE FOLLOWING ESTIMATED QUANTITIES HAVE BEEN CARRIED TO THE GENERAL SUMMARY:

ITEM 614 - LAW ENFORCEMENT OFFICER WITH PATROL CAR.....50 HOURS

THE HOURS PAID SHALL INCLUDE MINIMUM SHOW-UP TIME REQUIRED BY THE LAW ENFORCEMENT AGENCY INVOLVED.

IF THE CONTRACTOR WISHES TO UTILIZE LEO'S FOR FLAGGING AND TRAFFIC CONTROL OTHER THAN FOR THAT REQUIRED IN THESE PLANS, HE MAY DO SO AT HIS OWN EXPENSE.

CONSTRUCTION TRAFFIC

ALL CONSTRUCTION TRAFFIC SHALL USE ACCEPTABLE TRUCK ROUTES TO ACCESS THE CONSTRUCTION AREA. USE OF LOCAL RESIDENTIAL STREETS IS STRICTLY PROHIBITED UNLESS ALLOWED IN WRITING BY THE LOCAL ENFORCEMENT AUTHORITY.

EQUIPMENT AND MATERIAL STORAGE

IN ORDER TO PROVIDE FOR THE SAFETY OF THE TRAVELING PUBLIC THE CONTRACTOR'S ATTENTION IS DIRECTED TO 614.03. IN ADDITION THE FOLLOWING PROVISIONS SHALL APPLY:

1. ANY REMOVED ITEMS SHALL NOT BE STORED ON THE RIGHT OF WAY FOR MORE THAN THIRTY (30) DAYS.
2. THE STORAGE OF EQUIPMENT, MATERIALS, AND VEHICLES WITHIN THE HIGHWAY RIGHT OF WAY WILL BE PERMITTED. THE NUMBER OF AREAS AND EXACT LOCATIONS SHALL BE APPROVED BY THE ENGINEER.
3. ALL DISTURBED AREAS SHALL BE RETURNED TO THEIR ORIGINAL CONDITION AT NO EXPENSE TO THE STATE.

CONTRACTORS EQUIPMENT AND OPERATION

ALL VEHICLES AND EQUIPMENT MUST BE EQUIPPED WITH AT LEAST ONE FLASHING, ROTATING, OR OSCILLATING AMBER LIGHT THAT IS VISIBLE IN ALL DIRECTIONS OF TRAFFIC FOR AT LEAST ONE QUARTER MILE, DAY OR NIGHT.

UNLESS BEHIND CONCRETE BARRIER, THE CONTRACTOR'S EQUIPMENT SHALL BE OPERATED IN THE DIRECTION OF TRAFFIC ONLY.

ITEM 614 - PORTABLE CHANGEABLE MESSAGE SIGNS, AS PER PLAN

THE CONTRACTOR SHALL FURNISH, INSTALL, MAINTAIN AND REMOVE, WHEN NO LONGER NEEDED, A CHANGEABLE MESSAGE SIGN, ON SITE, FOR THE DURATION OF THE PROJECT. THE SIGN SHALL BE OF A TYPE SHOWN ON A LIST OF APPROVED PCMS UNITS MAINTAINED BY THE DIRECTOR (OFFICE OF MATERIALS MANAGEMENT).

I:\PROJECTS\pid83561\dgn\83561_mot_notes.dgn 26-JAN-2009 9:21AM fkonopka

CALCULATED
FLK
CHECKED
NRC

MAINTENANCE OF TRAFFIC NOTES

D12 - BH - FY 2009
FENCE

16
18

THE APPROVED LIST OF PORTABLE CHANGEABLE MESSAGE SIGNS CAN BE FOUND ON THE ODOT WEBSITE BY CLICKING ON THE SERVICES MENU, THEN CLICKING ON MATERIALS MANAGEMENT. THE LIST CONTAINS CLASS A AND B UNITS WITH MINIMUM LEGIBILITY DISTANCES OF 475 FT. AND 650 FT. RESPECTIVELY.

EACH SIGN SHALL BE TRAILER-MOUNTED AND EQUIPPED WITH A FUNCTIONAL DIMMING MECHANISM, TO DIM THE SIGN DURING DARKNESS, AND A TAMPER AND VANDAL PROOF ENCLOSURE.

EACH SIGN SHALL BE PROVIDED WITH APPROPRIATE TRAINING AND OPERATION INSTRUCTIONS TO ENABLE ON-SITE PERSONNEL TO OPERATE AND TROUBLESHOOT THE UNIT.

THE SIGN SHALL ALSO BE CAPABLE OF BEING POWERED BY AN ELECTRICAL SERVICE DROP FROM A LOCAL UTILITY COMPANY.

PCMS TRAILERS SHOULD BE DELINEATED ON A PERMANENT BASIS BY AFFIXING RETROREFLECTIVE MATERIAL, IN A CONTINUOUS LINE ON THE FACE OF THE TRAILER AS SEEN BY ONCOMING ROAD USERS.

PLACEMENT, OPERATION, MAINTENANCE AND ALL ACTIVATION OF THE SIGNS BY THE CONTRACTOR SHALL BE AS DIRECTED BY THE ENGINEER. THE PCMS SHALL BE LOCATED IN A HIGHLY VISIBLE POSITION YET PROTECTED FROM TRAFFIC. THE CONTRACTOR SHALL, AT THE DIRECTION OF THE ENGINEER, RELOCATE THE PCMS TO IMPROVE VISIBILITY OR ACCOMMODATE CHANGED CONDITIONS. WHEN NOT IN USE, THE PCMS SHALL BE TURNED OFF. ADDITIONALLY, WHEN NOT IN USE FOR EXTENDED PERIODS OF TIME, THE PCMS SHALL BE TURNED, FACING AWAY FROM ALL TRAFFIC, AND SHALL DISPLAY ONE OR MORE TYPE G YELLOW RETROREFLECTIVE SHEETING SURFACES OF 9-INCH BY 15-INCH MINIMUM SIZE FACING TRAFFIC.

THE ENGINEER SHALL BE PROVIDED ACCESS TO EACH SIGN UNIT AND SHALL BE PROVIDED WITH APPROPRIATE TRAINING AND OPERATION INSTRUCTIONS TO ENABLE ODOT PERSONNEL TO OPERATE AND TROUBLESHOOT THE UNIT, AND TO REVISE SIGN MESSAGES, IF NECESSARY. THE CONTRACTOR SHALL IMPLEMENT A SYSTEM WHEREBY CHANGEABLE MESSAGES WILL BE IMPLEMENTED WITHIN 1 HOURS FOLLOWING TELEPHONE NOTIFICATION FROM THE PROJECT ENGINEER TO A DESIGNATED PHONE.

ALL MESSAGES TO BE DISPLAYED ON THE SIGN WILL BE PROVIDED BY THE ENGINEER. A LIST OF ALL REQUIRED PRE-PROGRAMMED MESSAGES WILL BE GIVEN TO THE CONTRACTOR AT THE PROJECT PRECONSTRUCTION CONFERENCE. THE SIGN SHALL HAVE THE CAPABILITY TO STORE UP TO 99 MESSAGES. MESSAGE MEMORY OR PRE-PROGRAMMED DISPLAYS SHALL NOT BE LOST AS A RESULT OF POWER FAILURES TO THE ON-BOARD COMPUTER.

THE SIGN LEGEND SHALL BE CAPABLE OF BEING CHANGED IN THE FIELD. THREE-LINE PRESENTATION FORMATS WITH UP TO SIX MESSAGE PHASES SHALL BE SUPPORTED. PCMS FORMAT SHALL PERMIT THE COMPLETE MESSAGE FOR EACH PHASE TO BE READ AT LEAST TWICE.

THE PCMS SHALL CONTAIN AN ACCURATE CLOCK AND PROGRAMMING LOGIC WHICH WILL ALLOW THE SIGN TO BE ACTIVATED, DEACTIVATED OR MESSAGES CHANGED AUTOMATICALLY AT DIFFERENT TIMES OF THE DAY FOR DIFFERENT DAYS OF THE WEEK.

THE PCMS UNIT SHALL BE MAINTAINED IN GOOD WORKING ORDER BY THE CONTRACTOR IN ACCORDANCE WITH THE PROVISIONS OF CMS 614.07. THE CONTRACTOR SHALL, PRIOR TO ACTIVATING THE UNIT, MAKE ARRANGEMENTS, WITH AN AUTHORIZED SERVICE AGENT FOR THE PCMS, TO ASSURE PROMPT SERVICE IN THE EVENT OF FAILURE. ANY FAILURE SHALL NOT RESULT IN THE SIGN BEING OUT OF SERVICE FOR MORE THAN 12 HOURS, INCLUDING WEEKENDS. FAILURE TO COMPLY MAY RESULT IN AN ORDER TO STOP WORK AND OPEN ALL TRAFFIC LANES AND/OR IN THE DEPARTMENT TAKING APPROPRIATE ACTION TO SAFELY CONTROL TRAFFIC.

THE ENTIRE COST TO CONTROL TRAFFIC, ACCRUED BY THE DEPARTMENT DUE TO THE CONTRACTOR'S NONCOMPLIANCE, WILL BE DEDUCTED FROM MONEYS DUE, OR TO BECOME DUE TO THE CONTRACTOR ON HIS CONTRACT.

THE CONTRACTOR SHALL BE RESPONSIBLE FOR 24-HOUR-PER-DAY OPERATION AND MAINTENANCE OF THESE SIGNS ON THE PROJECT FOR THE DURATION OF THE PHASES WHEN THE PLAN REQUIRES THEIR USE.

PAYMENT FOR THE ABOVE DESCRIBED ITEM SHALL BE AT THE CONTRACT UNIT PRICE. PAYMENT SHALL INCLUDE ALL LABOR, MATERIALS, EQUIPMENT, FUELS, LUBRICATING OILS, SOFTWARE, HARDWARE AND INCIDENTALS TO PERFORM THE ABOVE DESCRIBED WORK.

THERE SHALL BE ONE PORTABLE CHANGEABLE MESSAGE SIGN FOR 4 MONTHS.

ITEM 614, PORTABLE CHANGEABLE MESSAGE SIGN, AS PER PLAN**4 SIGN-MONTH**

CONTINUOUS ACCESS

THE CONTRACTOR SHALL MAINTAIN SAFE AND ADEQUATE DRIVEWAYS AND WALKWAYS IN ORDER TO PROVIDE CONTINUOUS ACCESS FOR PEDESTRIANS, PASSENGER VEHICLES, TRUCKS, AND SAFETY EQUIPMENT TO ALL ADJOINING PROPERTIES. THE COST FOR ALL MATERIALS, EQUIPMENT AND LABOR NECESSARY TO PROVIDE CONTINUOUS ACCESS SHALL BE INCLUDED IN THE LUMP SUM PRICE BID FOR ITEM 614 - MAINTAINING TRAFFIC.

MAINTENANCE OF TRAFFIC SCHEME

THE CONTRACTOR SHALL DEVISE A SIMPLE MAINTENANCE OF TRAFFIC SCHEME, WHICH SHALL BE STAMPED BY A PROFESSIONAL ENGINEER (SCHEME MAY BE A HAND SKETCH) AND PRESENTED TO THE DISTRICT WORK ZONE SAFETY ENGINEER AND PROJECT ENGINEER FOR ACCEPTANCE AT LEAST TWO WEEKS PRIOR TO IMPLEMENTATION. IN GENERAL, THE METHODS FOR MAINTAINING TRAFFIC THAT THE CONTRACTOR PROPOSES TO USE FOR CONDUCTING THE REQUIRED WORK IN A SAFE AND EFFICIENT MANNER, SUPPORTED BY HAND SKETCHES AS NECESSARY. THE MAINTENANCE OF TRAFFIC SCHEME SHALL BE IN CONFORMANCE WITH THE OHIO MANUAL OF UNIFORM TRAFFIC CONTROL DEVICES, LATEST REVISION, THE REFERENCES STANDARD CONSTRUCTION DRAWINGS, THE ATTACHED MAINTENANCE OF TRAFFIC SHEETS, AND THE SPECIFICATIONS. THE CONTRACTOR SHALL NOT COMMENCE WORK UNTIL THE MAINTENANCE OF TRAFFIC SCHEME HAS BEEN APPROVED.

ALL WORK SHALL BE CONDUCTED FROM WITHIN A ONE OR TWO (1 OR 2) LANE CLOSURE USING DRUMS ACCORDING TO THE RESTRICTIONS AND THE CONCEPTS PRESENTED IN MT-95.30 AND ASSOCIATED STANDARD CONSTRUCTION DRAWINGS MT-98.12 THRU MT-98.16 (SEE TITLE SHEET), AND THESE PLANS.

IF DURING THE PROJECT THE ENGINEER DETERMINES THAT THE APPROVED MAINTENANCE OF TRAFFIC PLAN IS NOT PERFORMING AS DESIRED, THE WORK SHALL BE SUSPENDED UNTIL THE PROBLEM IS RESOLVED TO THE SATISFACTION OF THE ENGINEER AND THE MAINTENANCE OF TRAFFIC PLAN IS REVISED ACCORDINGLY. ANY COSTS OR DELAYS INCURRED AS A RESULT OF THE FAILURE OF THE SATISFACTION OF THE ENGINEER SHALL BE THE FULL RESPONSIBILITY OF THE CONTRACTOR.

DURING NON-WORKING HOURS, ALL LANES SHALL BE IN FULL OPERATION WITH ALL TRAFFIC CONTROL SIGNS, EXCEPT OW-124 (ROAD CONSTRUCTION AHEAD) SIGNS, REMOVED OR COVERED AND ALL CHANNELIZING DEVICES REMOVED FROM THE PAVEMENT SURFACES. CHANNELIZING DEVICES MAY BE STORED OR DEPLOYED TEMPORARILY ADJACENT TO THE SHOULDER TO MINIMIZE THE NIGHTLY TRAFFIC CONTROL SET-UP TIME.

WORKSITE TRAFFIC SUPERVISOR

THE CONTRACTOR SHALL EMPLOY, SUBJECT TO THE APPROVAL OF THE ENGINEER/SUPERVISOR, A CERTIFIED WORKSITE TRAFFIC SUPERVISOR (WTS). THE WTS SHALL BE CERTIFIED FROM ONE OF THE FOLLOWING ORGANIZATIONS:

1. AMERICAN TRAFFIC SAFETY SERVICE ASSOCIATION (ATSSA), PHONE NUMBER 1-800-272-8772, CERTIFIED TRAFFIC CONTROL SUPERVISOR (TCS).
2. NATIONAL HIGHWAY INSTITUTE, DESIGN AND OPERATION OF WORK ZONE TRAFFIC CONTROL, PHONE NUMBER 1-703-235-0528.
3. THE OHIO CONTRACTORS ASSOCIATION, TRAFFIC CONTROL SUPERVISOR (OCA/TCS) WORK ZONE CLASS, ONLY IF TAKEN AFTER MAY 5, 2004, PHONE NUMBER 1-614-599-7915.
4. OHIO LABORERS' TRAINING, TRAFFIC CONTROL SUPERVISORS CLASS, PHONE NUMBER 1-740-599-7915.

THE WTS POSITION IS ESTABLISHED FOR THE PURPOSE OF SUPERVISING THE INSTALLATION OF THE WORK ZONE, MONITORING IT AND CORRECTING ANY DEFICIENCIES IN THE WORK ZONE. THE WTS SHALL OVERSEE ALL OPERATIONS THAT AFFECT THE MOVEMENT OF VEHICULAR AND PEDESTRIAN TRAFFIC THROUGH THE WORK ZONE.

THE WTS SHALL BE PRESENT WHEN THE CONTRACTOR OR SUBCONTRACTOR INSTALLS A TRAFFIC RESTRICTION, LANE CLOSURE, ETC. IN LIEU OF THE WTS BEING PRESENT WHEN A SUBCONTRACTOR HAS A TRAFFIC CONTROL ZONE IN PLACE THE SUBCONTRACTOR MAY USE HIS OWN PERSONNEL THAT IS A CERTIFIED WTS. THE CONTRACTOR AND SUBCONTRACTOR MUST PRESENT A COPY OF HIS WTS CERTIFICATE TO THE PROJECT ENGINEER.

A WTS MUST BE PRESENT FOR ANY CLOSURE OR TRAFFIC RESTRICTION THAT TAKES PLACE ON THE PROJECT. THE WTS MAY BE A PART OF THE WORKING CREW AND MUST BE IN CHARGE OF SETTING UP THE WORK ZONE. AFTER THE WORK ZONE IS IN PLACE THE WTS MAY RESUME OTHER DUTIES NOT RELATED TO WORK ZONE TRAFFIC CONTROL. IF THE RESTRICTIONS ARE SHORT TERM, THE WTS SHALL MONITOR THE ZONE FOR COMPLIANCE. TRAFFIC CONTROL WILL BE THE WTS'S MAIN DUTY DURING IMPLEMENTATION OF THE WORK ZONES. THE WTS SHALL HAVE THE AUTHORITY TO HAVE THE DEFICIENCIES CORRECTED AS SOON AS POSSIBLE. THE WTS SHALL PROVIDE THE PROJECT ENGINEER A SKETCH OF THE (TCP) TRAFFIC CONTROL PLAN EVERY DAY THERE IS TO BE A SHORT TERM TRAFFIC RESTRICTION, LANE CLOSURE, ETC. THIS TCP SHALL SHOW HOW THE WORK ZONES ARE TO BE IMPLEMENTED.

A 24-HOUR PHONE NUMBER SHALL BE MADE AVAILABLE TO THE PROJECT ENGINEER/SUPERVISOR IN ORDER TO CONTACT THE WTS. THE WTS SHALL HAVE A PAGER AND/OR CELL PHONE NUMBER PROVIDED TO THE PROJECT ENGINEER.

FAILURE OF THE CONTRACTOR TO COMPLY WITH ANY OF THE ABOVE, SHALL CONSTITUTE CAUSE FOR THE PROJECT ENGINEER / SUPERVISOR TO DEDUCT \$500.00 PER DAY FROM MONEY DUE THE CONTRACTOR NOT AS A PENALTY BUT AS A LIQUIDATED DAMAGE.

PAYMENT FOR THE WTS SHALL BE INCLUDED UNDER THE LUMP SUM ITEM 614 – MAINTAINING TRAFFIC.