

C:\USERS\SAT89729\APPDATA\LOCAL\PROJECTWISE\WORKDIR\WOTT-USE-FW-20\DO13920\10942_MS001.DWG - MOT SUB 01 - BRIDGE_FULL.CTB - PLOTTED 5/3/2023 3:48 PM BY SIDHARTH SATANI

LOCATION	INTERSECTION		614	614	614	614	614		614	614	614	614	614	614	614	614	614		
			ASPHALT CONCRETE FOR MAINTAINING TRAFFIC	WORK ZONE LANE LINE, WHITE, CLASS 1, 4", 642 PAINT	WORK ZONE EDGE LINE, WHITE, CLASS 1, 642 PAINT	WORK ZONE EDGE LINE, YELLOW, CLASS 1, 642 PAINT	WORK ZONE CENTERLINE SOLID AND BROKEN, DOUBLE, YELLOW, CLASS 1, 642 PAINT	WORK ZONE STOP LINE, CLASS 1, 642 PAINT		WORK ZONE LANE LINE, WHITE, CLASS 1, 4", 740.06 TYPE 1	WORK ZONE CHANNELIZING, WHITE, CLASS 1, 8", 740.06 TYPE 1	WORK ZONE EDGE LINE, WHITE, CLASS 1, 740.06 TYPE 1	WORK ZONE CENTER LINE, SOLID, DOUBLE, YELLOW, CLASS 1, 740.06 TYPE 1	WORK ZONE CENTERLINE SOLID AND BROKEN, DOUBLE, YELLOW, CLASS 1, 740.06 TYPE 1	WORK ZONE CENTERLINE SOLID AND BROKEN, DOUBLE, WHITE, CLASS 1, 740.06 TYPE 1	WORK ZONE DOTTED LINE, CLASS 1, 4" 740.06 TYPE 1	WORK ZONE TRANSVERSE/DIAGONAL LINE CLASS 1, 740.06 TYPE 1	WORK ZONE STOP LINE, CLASS 1, 740.06 TYPE 1	WORK ZONE ARROW, CLASS 1, 740.06 TYPE 1
			CY	FT (MILE)	FT (MILE)	FT (MILE)	FT (MILE)	FT		FT (MILE)	FT	FT (MILE)	FT (MILE)	FT (MILE)	FT (MILE)	FT	FT	FT	EACH
PHASE 1 EUCLID AVE	HILLSBORO RD.	E. 191 ST.	100	13569		13569													
PHASE 2 EUCLID AVE	HILLSBORO RD.	E. 191 ST.	100		7036		13200	40		80	854	255		160	167		80	30	
PHASE 3 EUCLID AVE	HILLSBORO RD.	E. 191 ST.	100						165	100	7890	255	13200			140	80	30	
SUBTOTAL			300	13569	7036	13569	13200	40	165	180	8744	510	13200	160	167	140	160	60	
TOTALS CARRIED TO GENERAL SUMMARY			300	(2.57)	(3.90)	(2.50)	40		(0.03)	180	(1.66)		(2.63)		167	140	160	60	

CALCULATED
SMS
CHECKED
SJP

MAINTENANCE OF TRAFFIC SUBSUMMARY

EUCLID AVENUE
CUY-US 006-23.30

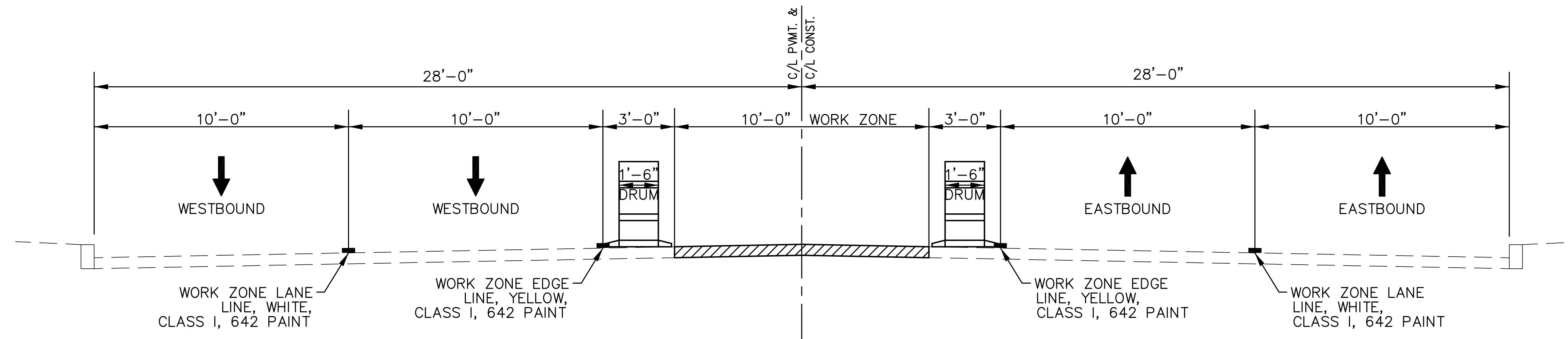

MAINTENANCE OF TRAFFIC PLAN – PHASE 1
EUCLID AVENUE – TYPICAL TWO-WAY TRAFFIC SECTION
EUCLID AVENUE

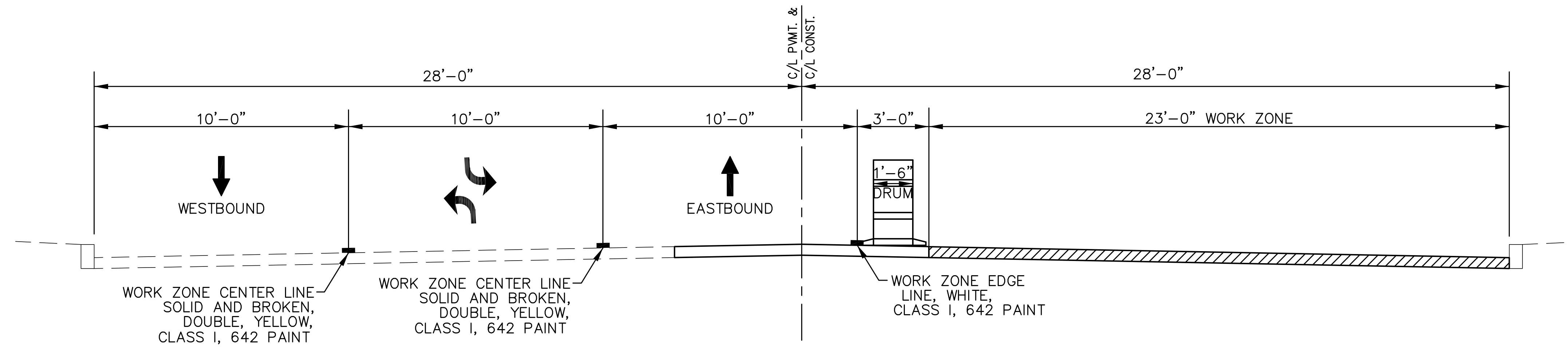

MAINTENANCE OF TRAFFIC PLAN – PHASE 2
EUCLID AVENUE – TYPICAL TWO-WAY TRAFFIC SECTION
EUCLID AVENUE

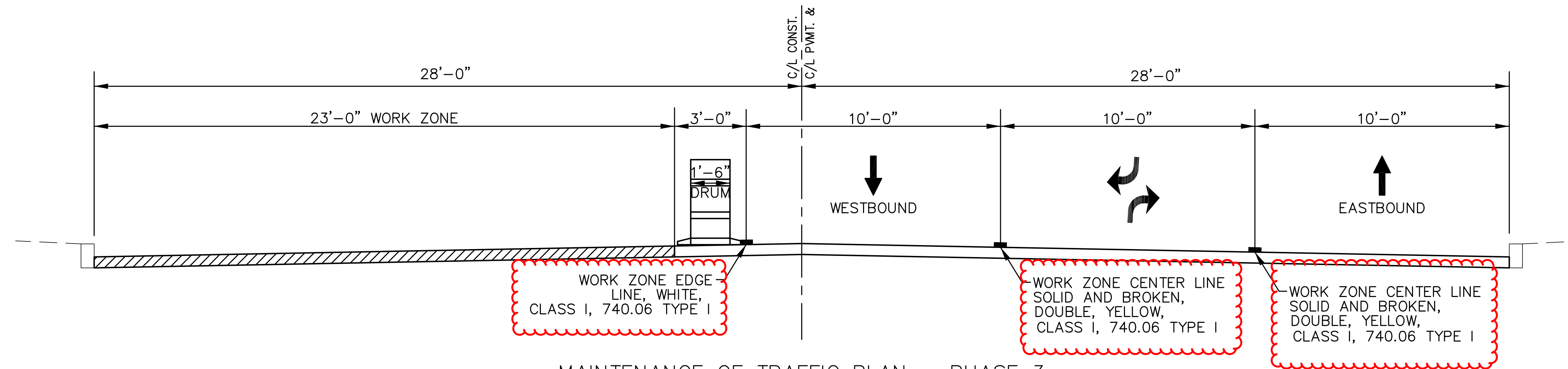

MAINTENANCE OF TRAFFIC PLAN – PHASE 3
EUCLID AVENUE – TYPICAL TWO-WAY TRAFFIC SECTION
EUCLID AVENUE

MAINTENANCE OF TRAFFIC TYPICAL SECTIONS

EUCLID AVENUE
CUY-US 006-23.30

C:\USERS\SAT89729\APPDATA\LOCAL\PROJECTWISE\WORKDIR\WOTT-USE-FW-20\01\9320\10942_MT001.DWG - MOT TYP 01 - BRIDGE_FULL.CTB - PLOTTED 5/3/2023 12:04 PM BY SIDDHARTH SATANI

C:\USERS\SAT89729\APPDATA\LOCAL\PROJECTWISE\WORKDIR\WOT-USE-FW-20\DO13929\10942_66001.DWG -- 66001 -- BRIDGE_FULL.CTB -- PLOTTED 5/3/2023 8:33 AM BY SIDDHARTH SATANI

SHEET NUM.								PART.		ITEM	ITEM EXT	GRAND TOTAL	UNIT	DESCRIPTION	SEE SHEET NO.
10	11	12	13	27	28	01/NHS/P V	02/NFP/05								
ROADWAY															
LUMP							LUMP	201	11001	LS			CLEARING AND GRUBBING, AS PER PLAN	10	
				127			127	202	23001	127	SY		PAVEMENT REMOVED, AS PER PLAN	9	
1,000					8,212		9,212	202	30001	9,212	SF		WALK REMOVED, AS PER PLAN	9	
500					788		1,288	202	32001	1,288	FT		CURB REMOVED, AS PER PLAN	9	
					13		13	202	38000	13	FT		GUARDRAIL REMOVED		
					3		3	202	58100	3	EACH		CATCH BASIN REMOVED		
					1		1	202	98100	1	EACH		REMOVAL MISC.: POST FOUNDATION REMOVED	9	
240							240	202	98200	240	FT		REMOVAL MISC.: RAILING REMOVED AND REFURBISHED	9	
				22			22	203	10000	22	CY		EXCAVATION		
				51			51	203	20000	51	CY		EMBANKMENT		
	500				5,507		6,007	608	10001	6,007	SF		4" CONCRETE WALK, AS PER PLAN	11	
					2,704		2,704	608	52001	2,704	SF		CURB RAMP, AS PER PLAN	11	
					216		216	608	53021	216	SF		DETECTABLE WARNING, AS PER PLAN	11	
2					13		15	623	39501	15	EACH		MONUMENT ASSEMBLY ADJUSTED TO GRADE, AS PER PLAN	10	
4							2	2	623	40001	EACH		MONUMENT ASSEMBLY REMOVED AND RESET, AS PER PLAN	10	
14							14	623	40900	14	EACH		MONUMENT, MISC.: MONUMENT REFERENCING	10	
2							2	SPECIAL	69098000	2	EACH		SPECIAL: ADJUST STREET CASTINGS TO GRADE (CPP)	10	
EROSION CONTROL															
	111						111	653	10000	111	CY		TOPSOIL FURNISHED AND PLACED		
	2						2	659	00100	2	EACH		SOIL ANALYSIS TEST		
	1,000						1,000	659	00501	1,000	SY		SEEDING AND MULCHING, CLASS 1, AS PER PLAN	11	
	0.15						0.15	659	20000	0.15	TON		COMMERCIAL FERTILIZER		
	0.21						0.21	659	31000	0.21	ACRE		LIME		
	5.4						5.4	659	35000	5.4	MGAL		WATER		
		10,000					10,000	832	30001	10,000	EACH		EROSION CONTROL, AS PER PLAN	11	
DRAINAGE															
		100			332		432	605	11110	432	FT		6" SHALLOW PIPE UNDERDRAINS WITH GEOTEXTILE FABRIC		
		50					50	611	00510	50	FT		6" CONDUIT, TYPE F FOR UNDERDRAIN OUTLETS		
		18					18	611	04401	18	FT		12" CONDUIT, TYPE B, AS PER PLAN	12	
			2		71		73	611	98631	73	EACH		CATCH BASIN ADJUSTED TO GRADE, AS PER PLAN	13	
					1		1	611	98645	1	EACH		CATCH BASIN GRATE, AS PER PLAN	13	
					3		3	611	98690	3	EACH		CATCH BASIN, MISC.:CITY OF CLEVELAND CB-1	12	
			4		46		50	611	99655	50	EACH		MANHOLE ADJUSTED TO GRADE, AS PER PLAN	13	
			2				2	611	99661	2	EACH		MANHOLE RECONSTRUCTED TO GRADE, AS PER PLAN	13	
		20,000					20,000	SPECIAL	61199820	20,000	LB		MISCELLANEOUS METAL	12	
PAVEMENT															
			3,871				3,871	251	01001	3,871	SY		PARTIAL DEPTH PAVEMENT REPAIR (441), AS PER PLAN	13	
				41,764			41,347	417	254	01001	41,764	SY	PAVEMENT PLANING, ASPHALT CONCRETE, AS PER PLAN	14	
			2,044				2,044	254	01600	2,044	SY		PATCHING PLANED SURFACE		
			1,488				1,488	255	10011	1,488	SY		FULL DEPTH PAVEMENT REMOVAL AND RIGID REPLACEMENT, CLASS QC1, AS PER PLAN	13	
			41				41	255	10200	41	SY		FULL DEPTH PAVEMENT REMOVAL AND RIGID REPLACEMENT, MISC.:BUS PAD REPAIR	13	
			3,000		292		3,292	255	20000	3,292	FT		FULL DEPTH PAVEMENT SAWING		
					4,176		4,134	42	407	13900	GAL		TACK COAT, 702.13		
					3,132		3,101	31	407	20000	GAL		NON-TRACKING TACK COAT		
					1,450		1,436	14	441	50101	CY		ASPHALT CONCRETE SURFACE COURSE, TYPE 1, (448), AS PER PLAN, PG70-22	14	
					14		14	441	50201	14	CY		ASPHALT CONCRETE INTERMEDIATE COURSE, TYPE 1, (448), AS PER PLAN , (1.25" MAX), PG 64-22	14	
				2,030			2,010	20	441	50300	CY		ASPHALT CONCRETE INTERMEDIATE COURSE, TYPE 2, (448), PG64-22		
					797		797	609	26001	797	FT		CURB, TYPE 6, AS PER PLAN	11	
					6,526		5,950	576	872	10000	FT		VOID REDUCING ASPHALT MEMBRANE (VRAM)		
WATER WORK															
		2			42		44	638	10801	44	EACH		VALVE BOX ADJUSTED TO GRADE, AS PER PLAN	13	

GENERAL SUMMARY
EUCLID AVENUE
CUY-US 006-23.30

CALCULATED
SMS
CHECKED
SJP

C:\USERS\SAT89729\APPDATA\LOCAL\PROJECTWISE\WORKDIR\WOT-USE-FW-20\DO13929\10942_GG001.DWG - GG002 - BRIDGE_FULL.CTB - PLOTTED 5/3/2023 3:53 PM BY SIDDHARTH SATANI

SHEET NUM.										PART.		ITEM	ITEM EXT	GRAND TOTAL	UNIT	DESCRIPTION	SEE SHEET NO.	
10	15	16	18	20	28	53	55	56	71	01/NHS/P V	02/NFP/05							
TRAFFIC CONTROL																		
								186			186	630	02100	186	FT	GROUND MOUNTED SUPPORT, NO. 2 POST		
								33			33	630	79500	33	EACH	SIGN SUPPORT ASSEMBLY, POLE MOUNTED		
								221			221	630	80100	221	SF	SIGN, FLAT SHEET		
								15			15	630	84900	15	EACH	REMOVAL OF GROUND MOUNTED SIGN AND DISPOSAL		
								14			14	630	86002	14	EACH	REMOVAL OF GROUND MOUNTED POST SUPPORT AND DISPOSAL		
											31	630	87500	31	EACH	REMOVAL OF POLE MOUNTED SIGN AND DISPOSAL		
									2.03		2.03	644	00200	2.03	MILE	LANE LINE, 4"		
									1.88		1.88	644	00301	1.88	MILE	CENTER LINE, AS PER PLAN	53	
									0.12		0.05	0.07	644	00100	0.12	MILE	EDGE LINE, 4"	
									898		898	644	00400	898	FT	CHANNELIZING LINE, 8"		
									993		993	644	00500	993	FT	STOP LINE		
									3,938		3,938	644	00620	3,938	FT	CROSSWALK LINE, 12"		
									168		70	98	644	00700	168	FT	TRANSVERSE/DIAGONAL LINE	
									56		56	644	01300	56	EACH	LANE ARROW		
TRAFFIC SIGNALS																		
									1		1	625	30701	1	EACH	PULL BOX, 725.08, 18", AS PER PLAN	53	
									8		10	625	31600	10	EACH	PULL BOX, MISC.: PULL BOX ADJUSTED TO GRADE	53	
											1	631	92001	1	EACH	SIGN FLASHER ASSEMBLY, AS PER PLAN	53	
											6	632	20731	6	EACH	PEDESTRIAN SIGNAL HEAD (LED), TYPE D2, COUNTDOWN, AS PER PLAN	71	
											6	632	26001	6	EACH	PEDESTRIAN PUSHBUTTON, AS PER PLAN	71	
								18			18	632	26501	18	EACH	DETECTOR LOOP, AS PER PLAN	53	
									600		600	632	40500	600	FT	SIGNAL CABLE, 5 CONDUCTOR, NO. 14 AWG		
MAINTENANCE OF TRAFFIC																		
								128			128	614	11111	128	HOURL	LAW ENFORCEMENT OFFICER WITH PATROL CAR FOR ASSISTANCE, AS PER PLAN	16	
											300	614	13000	300	CY	ASPHALT CONCRETE FOR MAINTAINING TRAFFIC		
									12		12	614	18000	12	EACH	MAINTAINING TRAFFIC, MISC.: MAINTAINING EXISTING TRAFFIC SIGNALS	18	
									8		8	614	18601	8	SNMT	PORTABLE CHANGEABLE MESSAGE SIGN, AS PER PLAN	18	
									2.57		2.57	614	20100	2.57	MILE	WORK ZONE LANE LINE, CLASS I, 4", 642 PAINT		
									0.03		0.03	614	20200	0.03	MILE	WORK ZONE LANE LINE, CLASS I, 4", 740.06, TYPE I		
									2.5		2.5	614	21100	2.5	MILE	WORK ZONE CENTER LINE, CLASS I, 642 PAINT		
									2.63		2.63	614	21200	2.63	MILE	WORK ZONE CENTER LINE, CLASS I, 740.06, TYPE I		
									3.9		3.9	614	22100	3.9	MILE	WORK ZONE EDGE LINE, CLASS I, 4", 642 PAINT		
									1.66		1.66	614	22200	1.66	MILE	WORK ZONE EDGE LINE, CLASS I, 4", 740.06, TYPE I		
								180			180	614	23400	180	FT	WORK ZONE CHANNELIZING LINE, CLASS I, 8", 740.06, TYPE I		
								167			167	614	24400	167	FT	WORK ZONE DOTTED LINE, CLASS I, 4", 740.06, TYPE I		
								140			140	614	25400	140	FT	WORK ZONE TRANSVERSE/DIAGONAL LINE, CLASS I, 740.06, TYPE I		
								40			40	614	26200	40	FT	WORK ZONE STOP LINE, CLASS I, 642 PAINT		
								160			160	614	26400	160	FT	WORK ZONE STOP LINE, CLASS I, 740.06, TYPE I		
									60		60	614	30400	60	EACH	WORK ZONE ARROW, CLASS I, 740.06, TYPE I		
									10		10	616	10000	10	MGAL	WATER		
									1		1	616	20000	1	TON	CALCIUM CHLORIDE		
INCIDENTALS																		
												614	11001	LS		MAINTAINING TRAFFIC, AS PER PLAN	15	
												623	10001	LS		CONSTRUCTION LAYOUT STAKES AND SURVEYING, AS PER PLAN	10	
												624	10000	LS		MOBILIZATION		

CALCULATED	SMS	CHECKED	SJP
GENERAL SUMMARY			
EUCLID AVENUE			
CUY-US 006-23.30			
26			
103			