

LOR-2 & SR 58

D03-LG-FY2010

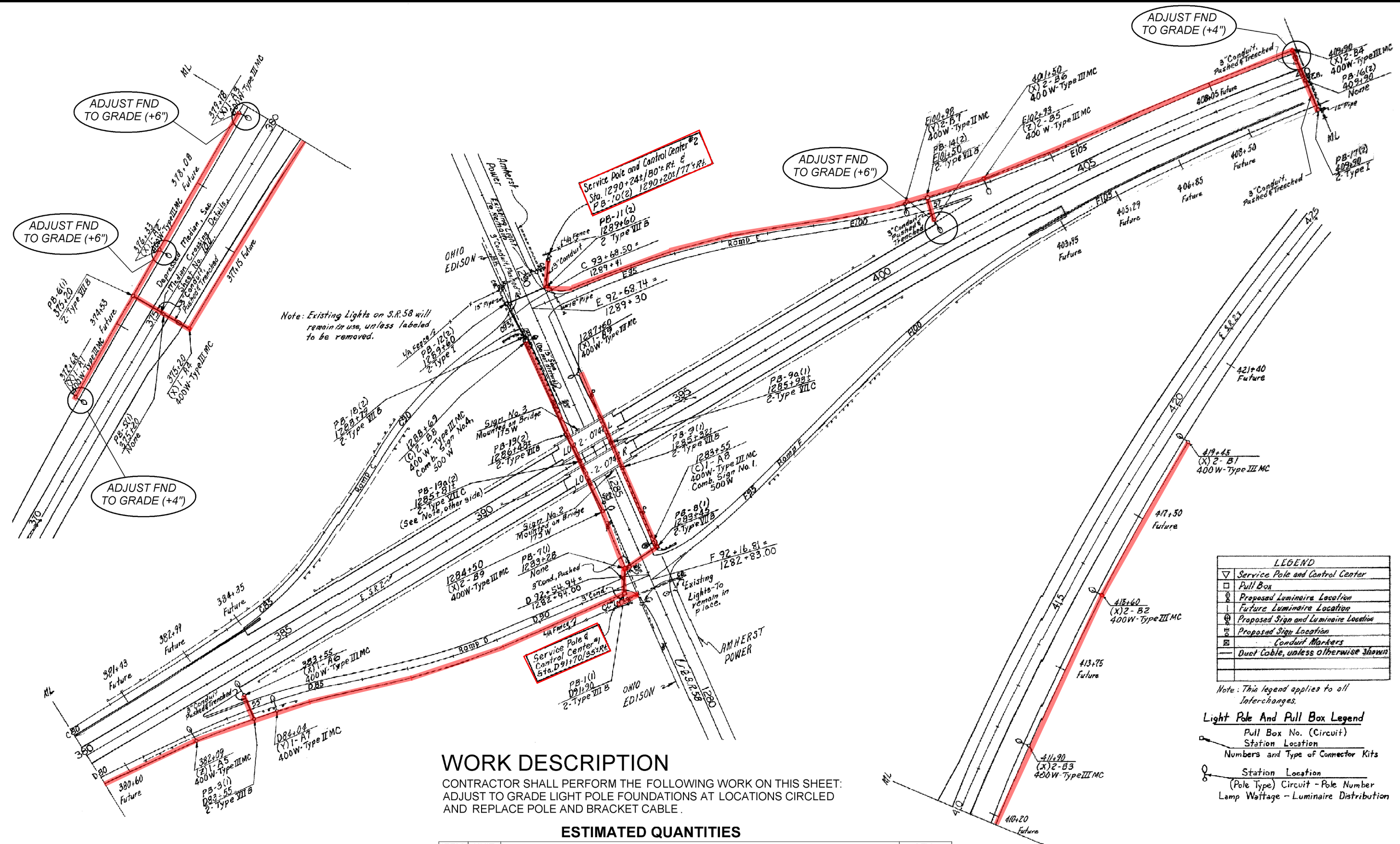

Note: Existing Lights on S.R. 58 will remain in use, unless labeled to be removed.

### WORK DESCRIPTION

CONTRACTOR SHALL PERFORM THE FOLLOWING WORK ON THIS SHEET:  
ADJUST TO GRADE LIGHT POLE FOUNDATIONS AT LOCATIONS CIRCLED AND REPLACE POLE AND BRACKET CABLE.

### ESTIMATED QUANTITIES

ITEM	UNIT	DESCRIPTION	QTY.
625	EACH	CONNECTOR KIT, TYPE II	5
625	EACH	CONNECTOR KIT, TYPE III	5
625	EACH	LIGHT POLE FOUNDATION, MISC: ADJUST TO GRADE, AS PER PLAN	5
625	FT	NO. 10 POLE AND BRACKET CABLE, AS PER PLAN	520
625	EACH	REMOVE AND REERECT EXISTING LIGHT POLE	5

LEGEND	
	Service Pole and Control Center
	Pull Box
	Proposed Luminaire Location
	Future Luminaire Location
	Proposed Sign and Luminaire Location
	Proposed Sign Location
	Conduit Markers
	Duct Cable, unless otherwise shown

Note: This legend applies to all Interchanges.

### Light Pole And Pull Box Legend

- Pull Box No. (Circuit) Station Location
- Numbers and Type of Connector Kits
- Station Location (Pole Type) Circuit - Pole Number Lamp Wattage - Luminaire Distribution

### Pole Types

- (X) = AT 15B 34.2
- (Y) = AT 10B 34.2
- (Z) = T 15B 34.2
- (C) = Combination Light and Sign Support, No. 12.30, Design 3 (15B 35)