

PORTION TO BE IMPROVED _____
 STATE & FEDERAL ROUTES _____
 OTHER ROADS _____

DESIGN DESIGNATION

CURRENT ADT (2000)	56,530
DESIGN YEAR ADT (2020)	72,470
DESIGN HOURLY VOLUME (2020)	7,247
DIRECTIONAL DISTRIBUTION	55 %
TRUCKS (24 HOUR B&C)	22 %
DESIGN SPEED	70 MPH
LEGAL SPEEDS	55 MPH and 65 MPH

DESIGN FUNCTIONAL CLASSIFICATION -
 Interstate Rural/Urban

DESIGN EXCEPTIONS
 IR 71 - NONE REQUIRED

PLAN PREPARED BY: GRANGER RD APPRV DATE SHT
 District One SSD 12/14/99 408,409
 Ohio Department of Transportation SHOULDER WIDTH 12/14/99 402

ENGINEERS SEAL:

 SIGNED: John W. Rogers
 DATE: December 15, 1999
 For additional Seal Blocks, See Sheet 2 of 940.

STATE OF OHIO
 DEPARTMENT OF TRANSPORTATION
MED - 71 - 15.78
 City of Brunswick
 Medina, Granger, Brunswick Hills
 And Montville Townships
 Medina County

INDEX OF SHEETS:

Title Sheet	1	Noise Walls	664-679
Schematic Plan	2-7	Structure Index & Misc. Sheets	680-686
Typical Sections - Proposed	8-22	MED-71-1685 L&R over SR 18	687-720,720A
Typical Sections - Existing	23-30	MED-71-1828 Granger Road over IR 71	721-736
General Notes	31-36	MED-71-1870 L&R OVER IR 271	737-775
Maintenance Of Traffic	37-67, 42A, 42B, 42C, 43A	MED-71-1918 L&R over Wilbur Road	776-797
General Summary	68-74	MED-71-1988 over ROCKY RIVER	798-820
Subsummary Sheets	75-76, 76A, 77-128	MED-71-2088E RAMP B @ SR3	821-836
Calculation Sheets	129-146A	MED-71-2090 L&R over SR 3	837-867
Superelevation Tables	147-148	MED-71-2092W RAMP C @ SR 3	868-895
Storm Water Pollution Prevention Plan	149-171	MED-71-2402 L&R over SR 303	896-931
IR 71 Plan & Profile Sheets	172-218	Miscellaneous Overhead Sheets	932-940
IR 71 Cross-Sections	219-374		
SR 18	375-382, 384-401	Sheets Not Used - 383, 420, 481, 644, 645 & 646	
Granger Road	402-419		
IR 271 Connector "W"	421-448		
IR 271 Connector "E"	449-452		
SR 3	453-457, 457A, 458-465		
Rest Areas	466-480		
SR 303	482-484, 484A, 485, 485A, 486-500		
Miscellaneous Details	501-502		
Drainage Details	503-512, 512A, 513-516		
Culvert Details	517-530		
Drainage Profiles	531-536, 536A		
Underdrain Details	537-550		
Traffic Control	551-560, 560A-560B		
Lighting	561-606, 561A, 569A-E, 574A-C		
Landscaping	607-643		
	647-663		

UNDERGROUND UTILITIES
 TWO WORKING DAYS
BEFORE YOU DIG
 CALL 1-800-362-2764 (TOLL FREE)
 OHIO UTILITIES PROTECTION SERVICE
 NON-MEMBERS
 MUST BE CALLED DIRECTLY

OIL & GAS PRODUCERS
 UNDERGROUND PROTECTION SERVICE
 P.O. Box 206
 Granville, OH 43023-0206
 800-925-0988
 (Fax) 740-587-0446

APPROVED: James D. Mawhor
 DATE: 12-17-99 DISTRICT DEPUTY DIRECTOR

APPROVED: _____
 DATE: _____ DIRECTOR, DEPARTMENT OF TRANSPORTATION

PROJECT DESCRIPTION
 Reconstruction of 10.6 miles of IR 71 existing lanes and shoulders including construction of widened inside shoulders from Begin Project to SR 303 and additional lanes from SR 303 to End Project. Also reconstruction of the connection lanes between IR 71 and IR 271. The work shall consist of but is not limited to new pavement and shoulders, new underdrains, rehabilitation or replacement of existing drainage, new guardrail, upgrading of signing, replacement of fencing, lighting at the IR 271, SR 3 and SR 303 interchanges, noise walls, replacement of Rest Area parking Areas, pavement markings and rehabilitation or replacement of structures.

LIMITED ACCESS
 THIS IMPROVEMENT IS ESPECIALLY DESIGNED FOR THROUGH TRAFFIC AND HAS BEEN DECLARED A LIMITED ACCESS HIGHWAY OR FREEWAY BY ACTION OF THE DIRECTOR IN ACCORDANCE WITH THE PROVISIONS OF SECTION 5511.02 OF THE REVISED CODE OF OHIO.

1997 SPECIFICATIONS
 The Standard Specifications of the State of Ohio, Department of Transportation, including changes and supplemental specifications listed in the proposal shall govern this improvement.

I hereby approve the plans and declare that the making of this improvement will not require the closing to traffic of the highway and provisions for the maintenance and safety of the traffic will be as set forth on the plans and estimate.

"Under authority of Section 4511.21, Division (1) of the Revised Code of Ohio, the revised prima facie speed limits as indicated herein are determined to be reasonable and safe and are hereby established for the duration of this project. The prima facie speed limit or limits hereby established shall become effective when appropriate signs giving notice thereof are erected."

STANDARD CONSTRUCTION DRAWINGS

STANDARD CONSTRUCTION DRAWINGS												SUPPLEMENTAL SPECIFICATIONS		SPECIAL PROVISIONS				
BP-1.1M	10-28-94	GR-1.1M	10-21-97	CB-1.2M	7-12-95	AS-1.81	09-15-94	TC-22.10M	03-13-97	TC-61.10M	03-31-94	HL-20.22M	03-31-95	MT-95.40M	04-25-94	806	09-09-97	Waterway Permit
BP-2.1M	04-08-97	GR-1.2M	1-3-96	CB-2.1M	7-12-95	GR-3.5M	10-21-97	TC-22.20M	02-01-94	TC-65.10M	11-01-95	HL-20.23M	03-31-95	MT-97.10M	04-25-94	814	06-02-98	NWP# DATE:
BP-2.2M	10-21-97	GR-1.3M	11-30-94	CB-2.2M	7-12-95	BR-1M	01-06-99	TC-31.21M	03-31-94	TC-65.11M	11-01-95			MT-98.12M	06-24-93	815	05-30-96	3 & 14 01-28-98
BP-2.3	04-29-99	GR-2.1M	04-14-98	CB-3.1M	7-12-95	BS-1.93	12-19-94	TC-32.10M	03-31-94	TC-65.12M	11-01-95	HL-30.11M	03-31-95	MT-98.13M	06-24-93	816	04-21-97	
BP-2.4M	10-28-94	GR-3.1M	10-21-97	CB-3.2M	7-12-95	CS-1.93	06-30-95	TC-32.11M	03-31-94	TC-71.10M	09-01-93	HL-30.21M	05-01-95	MT-98.14M	06-24-93	825	9-14-99	
BP-2.5M	04-08-97	GR-3.2M	10-21-97	CB-3.4M	7-12-95	EXJ-4-87M	02-18-97	MT-102.10M	01-30-95	TC-72.20M	09-01-93	HL-30.22M	03-31-95	MT-98.15M	06-24-93	842	01-06-99	
BP3.1M	10-28-94	GR-4.1M	11-30-94	HW-2.1M	07-12-95	VPF-1.90M	03-20-95	TC-41.10M	03-31-94	TC-82.10M	11-24-93	HL-30.31M	05-01-95	MT-98.16M	06-24-93	844	01-06-99	
BP-4.1M	10-28-94	GR-4.2M	10-21-97	HW-2.2M	07-12-95	GSD-1.96	02-12-97	TC-41.20M	07-01-94	TC-83.10M	11-24-93	GR-4.3M	10-27-97	MT-98.17M	04-25-94	855	6-30-98	SUPPLEMENTAL SPECIFICATIONS
BP-5.1M	10-28-94	GR-6.1M	1-3-96	I-2.2M	09-06-95	PCB-1.91	07-06-99	TC-41.50M	07-01-94	RM-4.5M	10-21-97	HL-40.10M	03-31-95	MT-98.18M	04-25-94	863	10-12-99	
BP-9.1	04-29-99	GR-6.2M	1-3-96	MH-1.1M	10-21-97	SBR-1.99	01-12-99	TC-42.10M	03-31-94	HL-10.11M	05-01-95	HL-50.11M	03-31-95	MT-99.20M	01-30-95	870	08-10-99	
BP-9.2	04-29-99	RM-1.1	04-29-99	MH-1.2M	09-06-95	HW-1.1M	07-12-95	TC-42.20M	03-31-94	HL-10.12M	05-01-95	HL-50.21M	08-31-94	MT-101.60M	04-25-94	899	10-21-98	910 07-28-98
F-1.1M	4-8-97	RM-4.1M	10-21-97	MH-3.1M	09-06-95	TC-7.65M	02-01-94	TC-82.11M	01-19-99	HL-10.13M	05-01-95	HL-60.11M	05-01-95	MT102.20M	01-30-95	880	06-15-99	911 07-10-97
F-2.1M	4-8-97	RM-4.2M	10-21-97	DM-1.1M	10-21-97	TC-12.30M	02-01-94	TC-51.11M	09-30-94	HL-10.31M	03-31-95	HL-60.21M	03-31-95	MT-105.10M	04-25-94	904	05-05-98	954 09-09-97
F-3.1M	4-21-95	RM-4.3M	10-21-97	DM-4.2M	6-30-95	TC-18.26M	02-01-94	TC-51.12M	03-31-94	HL-20.11M	03-31-95	HL-60.31M	03-31-95	MT-105.11M	04-25-94	905	04-01-98	877 4-13-99
F-3.3M	4-21-95	RM-4.4M	10-21-97	DM-4.3	04-29-99	TC-21.10M	12-10-96	TC-52.10M	07-29-94	HL-20.15M	03-31-95	MT-95.31M	04-25-94	MT-95.32M	04-25-94	906	05-05-98	925 9-14-99
F-3.4M	4-8-97	CB-1.1M	7-12-95	DM-4.4	04-29-99	TC-21.20M	12-10-96	TC-52.20M	07-29-94	HL-20.21M	08-31-94	MT-95.30M	04-25-94			887	08-10-99	

FEDERAL PROJECT NO. TE21-G000(267)
 PID NO. 7885
 CONSTRUCTION PROJECT NO. NONE
 RAILROAD INVOLVEMENT NONE
MED - 71 - 15.78
 940

LIGHTING GENERAL NOTES

POWER SERVICE, AS PER PLAN

THE POWER SUPPLYING AGENCY FOR THIS PROJECT IS:

Ohio Edison Company - Distribution Ohio Edison Company - Transmission
6326 Lake Avenue 76 South Main Street
Elyria, Ohio 44035 Akron, Ohio 44308
440-324-0231 330-384-5180

THIS PROJECT WILL RECEIVE 480 VOLT, THREE WIRE GROUNDED NEUTRAL

ELECTRICAL ENERGY FROM EXISTING POWER SERVICES SHALL CONTINUE TO BE CHARGED TO THE MAINTAINING AGENCY. THE CONTRACTOR SHALL PAY ELECTRICAL ENERGY CHARGES FOR NEW POWER SERVICES ESTABLISHED BY THIS PROJECT. AFTER ACCEPTANCE OF THE LIGHTING WORK, POWER SERVICE ELECTRICAL ENERGY ACCOUNTS SHALL BE TRANSFERRED TO THE OHIO DEPARTMENT OF TRANSPORTATION. THIS SHALL INCLUDE NEW POWER SERVICE ESTABLISHED BY THIS PROJECT AS WELL AS REASSIGNMENT OF THE EXISTING SERVICE DUE TO WORK PERFORMED BY THIS PROJECT.

CONVENTIONAL LUMINAIRES

STYLE B LUMINAIRES SHALL HAVE SINGLE RATED 480 V, 400 W, INTEGRAL REGULATOR BALLASTS FOR USE WITH HIGH PRESSURE SODIUM LAMPS AND SHALL BE GENERAL ELECTRIC M400, WESTINGHOUSE OV-25, ITT AMERICAN 400, OR EQUAL APPROVED BY THE ENGINEER.

UNDERPASS LUMINAIRES

UNDERPASS LUMINAIRES SHALL BE HOLOPHANE "UNDERPASS WALLPACK", WESTINGHOUSE, OR GENERAL ELECTRIC WL-250 UNDERPASS UNIT OR EQUAL APPROVED BY THE ENGINEER, AND SHALL BE FURNISHED WITH AN INTEGRAL FUSE HOLDER AND 10-AMPERE FUSE. THE INTEGRAL HIGH PRESSURE SODIUM BALLAST SHALL BE OF A REGULATOR TYPE RATED FOR 480 VOLTS, 100 WATTS.

LAMPS

HIGH PRESSURE SODIUM LAMPS SHALL BE GENERAL ELECTRIC "LUCALOX", WESTINGHOUSE "CERAMALUX", SYLVANIA "LUMALUX", OR EQUAL APPROVED BY THE ENGINEER.

UNDERDRAINS FOR PULL BOXES

REFERENCE IS MADE TO STANDARD DRAWING HL-30.11 FOR DETAILS OF DRAINING PULL BOXES. UNDERDRAINS FOR PULL BOXES SHALL BE USED AS DIRECTED BY THE ENGINEER, AND SHALL BE PROVIDED WHERE THE LENGTH REQUIRED FOR A SATISFACTORY OUTLET DOES NOT EXCEED APPROXIMATELY 20 FEET. AN ESTIMATED QUANTITY OF 1240 LINEAR FEET OF ITEM 603 4" CONDUIT, TYPE E IS INCLUDED IN THE LIGHTING GENERAL SUMMARY FOR THIS PURPOSE.

CONDUIT ON STRUCTURE

EXPANSION FITTINGS FOR CONDUIT ON STRUCTURES SHALL BE OZ TYPE AX, CROUSE-HINDS TYPE XJ-4, APPLETON TYPE XJ-4, OR EQUAL APPROVED BY THE ENGINEER, FOR THE FOLLOWING BRIDGES:

MED-71-2088E
MED-71-2092W

EACH EXPANSION FITTING SHALL HAVE A COPPER EXTERNAL BINDING JUMPER.

HIGH VOLTAGE DIRECT CURRENT TEST

A HIGH VOLTAGE DIRECT CURRENT TEST SHALL BE PERFORMED ON NEW CIRCUITS ONLY. EXISTING CIRCUITS SHALL NOT BE TESTED. THE TEST SHALL NOT BE PERFORMED UNTIL AFTER ALL NEW CONSTRUCTION, SUCH AS GUARDRAIL, FENCE, DELINEATOR POSTS, SIGN SUPPORTS, ETC., IN THE IMMEDIATE VICINITY OF THE LOCATION OF CABLE RUN BEING TESTED, HAS BEEN COMPLETED.

A LUMP SUM PAYMENT FOR THIS TEST HAS BEEN INCLUDED IN THE LIGHTING GENERAL SUMMARY.

PADLOCKS AND KEYS

PADLOCKS FURNISHED SHALL BE EITHER BRASS OR BRONZE, EQUAL TO MASTER NO. 4BKA OR WILSON BOHANNAN 660A, AND SHALL BE KEYED IN ACCORDANCE WITH SPECIFICATION 631.08 PARAGRAPH 3. PAYMENT SHALL BE INCLUDED IN THE BID FOR THE ITEMS BEING LOCKED.

ITEM 625 - SERVICE TO UNDERPASS LIGHTING

THIS ITEM SHALL CONSIST OF PROVIDING COMPLETE ELECTRICAL SERVICE, EXCEPT FOR LUMINAIRES AND STRUCTURE GROUNDING, FOR THE UNDERPASS LIGHTING SYSTEM ON A BRIDGE AS SHOWN IN THE PLANS.

THE INSTALLATION WORK SHALL INCLUDE CONDUITS, CONDUIT GROUNDING, MOUNTINGS, FITTINGS, JUNCTION BOXES, CABLES, AND ALL INCIDENTALS NECESSARY TO COMPLETE, READY FOR USE, THE SERVICE AS DETAILED ON SHEETS 630 & 636. PAYMENT WILL BE MADE AT THE UNIT PRICE BID FOR EACH "ITEM 625 - SERVICE TO UNDERPASS LIGHTING" AND SHALL INCLUDE ALL EQUIPMENT, LABOR, AND MATERIALS NECESSARY TO COMPLETE THE WORK AS SPECIFIED. COMPONENT PARTS NOT SPECIFICALLY MENTIONED BUT REQUIRED FOR SATISFACTORY OPERATION OF THIS ITEM SHALL BE FURNISHED AND CONSIDERED PAID FOR AS PART OF THE ITEM.

ITEM 202-LIGHT POLE REMOVED

THE ITEM OF WORK SHALL CONSIST OF REMOVING AN EXISTING LIGHT POLE INCLUDING THE BRACKET ARM(S) AND TRANSFORMER BASE (IF USED). THE CONTRACTOR SHALL TAKE POSSESSION OF THE LIGHT POLE AND DISPOSE OF IT PROPERLY OFF THE PROJECT SITE.

PAYMENT WILL BE MADE AT THE UNIT BID PRICE PER EACH ITEM 202 "LIGHT POLE REMOVED."

ITEM 202-LIGHT POLE FOUNDATION REMOVED

THIS ITEM OF WORK WILL CONSIST OF REMOVING AN EXISTING LIGHT POLE FOUNDATION TO A MINIMUM OF ONE FOOT BELOW FINISHED GRADE, BACKFILLING THE RESULTANT DEPRESSION WITH COMPACTED SOIL AND RESTORING THE DISTURBED AREA.

PAYMENT WILL BE MADE FOR EACH ITEM 202 "LIGHT POLE FOUNDATION REMOVED"

ITEM 202-PULLBOX REMOVED

THIS ITEM OF WORK WILL CONSIST OF REMOVING AN EXISTING PULLBOX WHICH SHALL THEN BE PROPERLY DISPOSED OF. THE RESULTANT OPENING SHALL THEN BE BACKFILLED TO GRADE WITH SUITABLE COMPACTED SOIL AND RESTORED TO MATCH SURROUNDING AREA.

PAYMENT WILL BE MADE FOR EACH ITEM 202 "PULLBOX REMOVED."

ITEM 202 POWER SERVICE REMOVED, AS PER PLAN

THIS ITEM OF WORK INCLUDES THE REMOVAL OF THOSE PORTIONS OF THE EXISTING POWER SERVICE NOT BEING REUSED. EXISTING UNDERGROUND CONDUIT AND WIRING MAY BE ABANDONED IN PLACE EXCEPT WHEN NEW WIRING IS TO BE PLACED IN EXISTING CONDUITS OR PULL BOXES. IN THIS LATTER CASE, THE OLD WIRES SHALL BE REMOVED. REMOVED MATERIALS SHALL BECOME THE PROPERTY OF THE CONTRACTOR AND SHALL BE REMOVED FROM THE PROJECT SITE. ALL DISTURBED AREAS SHALL BE RESTORED AS TO MATCH THE SURROUNDING AREA.

THIS ITEM WILL ALSO COMPENSATE THE CONTRACTOR FOR COORDINATING WITH THE POWER COMPANY TO INSURE THAT THEY DISCONNECT AND REMOVE ANY OF THEIR ITEMS THAT ARE A PART OF THE POWER SERVICE. IT ALSO INCLUDES RETURNING TO THE POWER COMPANY ANY ITEMS BELONGING TO THEM THAT WERE REMOVED BY THE CONTRACTOR, SUCH AS THE METER BASE.

PAYMENT WILL BE MADE FOR EACH ITEM "POWER SERVICE REMOVED, AS PER PLAN" AND SHALL BE FULL COMPENSATION INCLUDING ALL LABOR, MATERIALS, AND INCIDENTALS REQUIRED TO COMPLETE THE INSTALLATION IN A SATISFACTORY WORKMAN-LIKE MANNER.

ITEM 202 LUMINAIRE REMOVED

THIS ITEM OF WORK SHALL CONSIST OF THE REMOVAL AND DISPOSAL OF AN EXISTING LUMINAIRE.

THE LUMINAIRE SHALL BECOME THE PROPERTY OF THE CONTRACTOR AND SHALL BE DISPOSED OF PROPERLY, OFF OF THE PROJECT SITE.

PAYMENT SHALL BE MADE AT THE UNIT PRICE BID FOR EACH "ITEM 202 LUMINAIRE REMOVED" AND SHALL BE FULL COMPENSATION FOR ALL LABOR, MATERIALS, AND INCIDENTALS REQUIRED TO COMPLETE THE WORK SATISFACTORYLY.

HIGH MAST LUMINAIRES

THE LUMINAIRE ARRAYS AND ASSOCIATED ILLUMINATION TEST AREAS SPECIFIED IN SECTION 713.21 OF THE CONSTRUCTION AND MATERIAL SPECIFICATIONS ARE HEREBY WAIVED FOR THIS PROJECT. INSTEAD, THE LUMINAIRES FOR TOWER LIGHTING SHALL MEET THE FOLLOWING REQUIREMENTS.

ASYMMETRIC, TYPE I, LUMINAIRES FOR TOWER LIGHTING MAY BE HOLOPHANE "HMST" TEST #36801 OR #36802, OR GENERAL ELECTRIC "HM" TEST #7349, OR COOPER "HMC" TEST #764130.

ASYMMETRIC, TYPE II OR TYPE III, LUMINAIRES FOR TOWER LIGHTING MAY BE HOLOPHANE "HMST" TEST #36648, OR GENERAL ELECTRIC "HM" TEST #7349, OR COOPER "HMC" TEST #764130.

SYMMETRIC, TYPE V, LUMINAIRES FOR TOWER LIGHTING MAY BE HOLOPHANE "HMST" TEST #36383, OR GENERAL ELECTRIC "HM" TEST #6312, OR COOPER "HAL" TEST # 48381.

IN ADDITION, OTHER LUMINAIRES WILL BE CONSIDERED IF THE DESIGNED INTENSITY AND UNIFORMITY ARE PROVIDED USING THE THE DESIGNED POLE LOCATIONS AND THE DESIGNED NUMBER AND TYPE OF FIXTURES PER POLE.



CALCULATED
CHECKED

Lighting General Notes

MED-71-15.78

607
940

GENERAL NOTES

REF. FILE #1 LEVELS ON
REF. FILE #2 LEVELS ON
REF. FILE #3 LEVELS ON
REF. FILE #4 LEVELS ON

REF. FILE #1 LEVELS ON
REF. FILE #2 LEVELS ON
REF. FILE #3 LEVELS ON
REF. FILE #4 LEVELS ON

FILE NAME: I:\001\001\MED-71-15.78\LIGHTING\GENERAL NOTES.DWG
DATE & TIME: 09-DEC-1999 16:24
USER NAME: mfox
PROJECT: NONE

LEVELS ON: 15.78
PLOT: 15.78
PLOT TABLE: I:\001\001\MED-71-15.78\Cross.DWG

GENERAL NOTES

LOW MAST LUMINAIRES

THE LUMINAIRE ARRAYS AND ASSOCIATED ILLUMINATION TEST AREAS SPECIFIED IN SECTION 713.21 OF THE CONSTRUCTION AND MATERIAL SPECIFICATIONS ARE HEREBY WAIVED FOR THIS PROJECT. INSTEAD, THE LUMINAIRES FOR LOW MAST LIGHTING SHALL MEET THE FOLLOWING REQUIREMENTS.

ASYMMETRIC, TYPE II OR TYPE III, LUMINAIRES FOR LOW MAST LIGHTING MAY BE HOLOPHANE "HMST" TEST #36648, OR GENERAL ELECTRIC "HM" TEST #7349, OR COOPER "HMC" TEST #764130.

SYMMETRIC, TYPE V, LUMINAIRES FOR LOW MAST LIGHTING MAY BE HOLOPHANE "HMST" TEST #36383, OR GENERAL ELECTRIC "HM" TEST #6312, OR COOPER "HAL" TEST #48381.

IN ADDITION, OTHER LUMINAIRES WILL BE CONSIDERED IF THE DESIGNED INTENSITY AND UNIFORMITY ARE PROVIDED USING THE DESIGNED POLE LOCATIONS AND THE TYPE OF FIXTURE PER POLE.

RECONNECTION OF OVERHEAD SIGNS TO NEW LIGHTING CIRCUITS

THE EXISTING LIGHTED SIGNS SHALL BE RECONNECTED TO THE NEW OFF STRUCTURE CANTILEVERED OVERHEAD SIGN SUPPORT LIGHTING CIRCUITS. PAYMENT FOR THIS WORK WILL BE UNDER THE FOLLOWING ITEMS:

DISCONNECTION OF THE SIGN FROM THE EXISTING CIRCUIT SHALL BE PAID BY ITEM SPECIAL - "DISCONNECT EXISTING CIRCUIT".

REMOVAL OF THE EXISTING PULL BOX SHALL BE ITEM 202 - "PULL BOX REMOVED".

REPLACEMENT OF A NEW PULL BOX AT THE SPECIFIED LOCATION SHALL BE PAID UNDER ITEM 625 - "PULL BOX, 18", 713.08".

RECONNECTION OF THE SIGNS TO THE NEW LIGHTING CIRCUIT SHALL BE PROVIDED BY ITEM 625 - "CABLE SPLICE KITS" (2 PER PULL BOX).

ITEM 202 - DISCONNECT EXISTING CIRCUIT

THIS ITEM OF WORK SHALL CONSIST OF THE DISCONNECTION OF AN EXISTING LIGHT CIRCUIT AT A PULL BOX OR AT A LIGHT POLE.

DISCONNECTION AT A PULL BOX SHALL INVOLVE CUTTING THE EXISTING CIRCUIT AND REMOVING ALL SPLICE KITS. ANY CABLE THAT IS TO BE ABANDONED SHALL BE TERMINATED IN A MANNER SUCH THAT NO CABLE IS LEFT REMAINING IN THE PULL BOX.

DISCONNECTION AT A LIGHT POLE SHALL INVOLVE THE REMOVAL OF THAT PART OF THE CABLE THAT IS TO BE ABANDONED FROM THE POLE. THESE ENDS OF THE CONNECTOR KITS FROM WHICH THE ABANDONED CABLE IS REMOVED SHALL BE PLUGGED AND TAPED.

ANY CABLE THAT IS TO BE REUSED IN A PULL BOX OR LIGHT POLE SHALL BE CUT IN A MANNER SO THAT THERE IS SUFFICIENT LENGTH OF CABLE LEFT FOR RECONNECTION. CABLE SPLICE KITS AND CONNECTOR KITS WILL BE PAID FOR RESPECTIVELY UNDER EACH ITEM 625.

PAYMENT WILL BE MADE AT THE UNIT BID PRICE FOR EACH ITEM 202 - "DISCONNECT EXISTING CIRCUIT" AND SHALL BE FULL COMPENSATION INCLUDING ALL LABOR, MATERIALS, AND INCIDENTALS REQUIRED TO COMPLETE THE WORK.

PORTABLE POWER UNIT

THE CONTRACTOR SHALL SUPPLY A PORTABLE POWER UNIT AS SPECIFIED IN THE O.D.O.T. CONSTRUCTION AND MATERIAL SPECIFICATIONS. A QUANTITY OF "1 EACH" OF ITEM 625, "PORTABLE POWER UNIT", IS INCLUDED IN THE GENERAL SUMMARY FOR THIS PURPOSE.

LIGHT TOWER FOUNDATIONS, AS PER PLAN

IN LIEU OF THE TOP OF FOUNDATION RELATIONSHIP SHOWN IN THE STANDARD DRAWINGS, LIGHT TOWER FOUNDATIONS SHALL EXTEND 6" ABOVE GROUND OR PLATFORM. THE 6" EXTENSION IS INCLUDED IN THE FOUNDATION DEPTH.

ITEM SPECIAL - MAINTAIN EXISTING LIGHTING

EXISTING ROADWAYS WHICH ARE TO REMAIN OPEN TO TRAFFIC DURING CONSTRUCTION OF THIS PROJECT AND WHICH ARE LIGHTED SHALL HAVE THE LIGHTING MAINTAINED AS DESCRIBED HEREIN.

BEFORE ANY WORK IS STARTED IN THE IMMEDIATE VICINITY OF ANY EXISTING LIGHTING CIRCUITS, REPRESENTATIVES OF THE STATE, THE MAINTAINING AGENCY AND THE CONTRACTOR SHALL MAKE A VISUAL INSPECTION OF THE EXISTING ROADWAY LIGHTING CIRCUITS TO BE MAINTAINED. DURING THIS INSPECTION, A WRITTEN RECORD OF THE CONDITION OF THE EXISTING LIGHTING SHALL BE MADE BY THE STATE'S REPRESENTATIVE. THIS WRITTEN REPORT SHALL NOTE INDIVIDUAL LUMINAIRES WHICH ARE NOT IN WORKING ORDER, INDIVIDUAL POLES WHICH ARE NOT STANDING, AND INDIVIDUAL CIRCUITS WHICH ARE NOT IN WORKING ORDER. THE COMPLETED REPORT SHALL BE SIGNED BY THE REPRESENTATIVES OF THE STATE, THE MAINTAINING AGENCY, AND THE CONTRACTOR. IF AS A RESULT OF THIS INSPECTION, IT IS DETERMINED THAT THE CONDITION OF THE EXISTING SYSTEM IS BELOW THAT REQUIRED FOR THE SAFETY OF THE TRAVELING PUBLIC, THEN THE MAINTAINING AGENCY SHALL MAKE REPAIRS NECESSARY TO RETURN THE SYSTEM TO AN ACCEPTABLE CONDITION. FOLLOWING THESE REPAIRS, THE SYSTEM SHALL AGAIN BE INSPECTED AND A REPORT MADE AND SIGNED AS OUTLINED HEREIN.

WHEN THE EXISTING SYSTEM IS IN AN ACCEPTABLE CONDITION, IT SHALL BE TURNED OVER TO THE CONTRACTOR WHO SHALL THEN BE REQUIRED TO MAINTAIN THE EXISTING LIGHTING TO THE CONDITION OUTLINED IN THIS REPORT WITH THE EXCEPTION OF KNOCKDOWNS DUE TO TRAFFIC ACCIDENTS.

REPLACEMENT OF KNOCKED-DOWN UNITS SHALL BE DONE ONLY WHEN THE ENGINEER HAS DETERMINED THAT THE REPLACEMENT OF THE KNOCKED-DOWN UNIT IS NECESSARY AND SHALL BE PAID SEPARATELY ON A UNIT BASIS.

BETTERMENTS SHALL BE COVERED IN ITEMS OF WORK PERTAINING TO THE CONSTRUCTION OF PERMANENT IMPROVEMENTS.

SHOULD THE CONTRACTOR DESIRE THE REMOVAL OF THE EXISTING LIGHTING BEFORE THE NEW LIGHTING IS OPERATIONAL, THE CONTRACTOR SHALL THEN BE RESPONSIBLE FOR ADEQUATE TEMPORARY LIGHTING OF THAT PORTION OF THE EXISTING ROADWAY AFFECTED BY THE REMOVAL OF THE EXISTING LIGHTING.

PRIOR TO INSTALLING SUCH LIGHTING, THE CONTRACTOR SHALL PREPARE AND SUBMIT FOUR (4) SETS OF THE TEMPORARY LIGHTING PLAN TO THE DIRECTOR FOR REVIEW AND APPROVAL.

THIS PLAN SHALL SHOW LOCATION OF POLES, LENGTH OF BRACKET ARMS, STYLE OF LUMINAIRES, MOUNTING HEIGHT, WIRING METHODS, AND OTHER PERTINENT INFORMATION. THE TEMPORARY LIGHTING SHALL PROVIDE AN AVERAGE INITIAL INTENSITY OF 1.2 FOOTCANDLES WITH AN AVERAGE TO MINIMUM UNIFORMITY NOT TO EXCEED 4:1. MOUNTING HEIGHT FOR TEMPORARY LUMINAIRES SHALL NOT BE LESS THAN 27' AND MINIMUM OVERHEAD CONDUCTOR CLEARANCE SHALL BE 20'. TEMPORARY OVERHEAD CONSTRUCTION SHALL NOT BE LESS THAN GRADE "A" FOR STRENGTH REQUIREMENT AS DEFINED BY THE NATIONAL ELECTRIC SAFETY CODE. WOOD POLES WITH OVERHEAD WIRING MAY BE USED. HOWEVER, TEMPORARY LIGHTING SHALL MEET FEDERAL AND STATE SAFETY CRITERIA. IF BREAKAWAY POLES ARE USED TO MEET THESE CRITERIA, THEN UNDERGROUND WIRING SHALL BE USED. RECONDITIONED OR USED MATERIALS MAY BE FURNISHED FOR TEMPORARY LIGHTING.

ALL MATERIALS NECESSARY TO COMPLETE THE TEMPORARY LIGHTING SHALL BE FURNISHED AND INSTALLED BY THE CONTRACTOR. WHEN NO LONGER NEEDED, THE TEMPORARY LIGHTING INSTALLATION SHALL BE REMOVED AND PROPERLY DISPOSED OF BY THE CONTRACTOR.

THE MAINTAINING AGENCY WILL PAY FOR ELECTRICAL ENERGY CONSUMED BY EXISTING POWER SERVICES AND BY PROPOSED PERMANENT POWER SERVICES AFTER ACCEPTANCE. THE CONTRACTOR WILL PAY FOR ELECTRICAL ENERGY, INSTALLATION, REMOVAL, AND MAINTENANCE OF ANY TEMPORARY POWER SERVICES.

THE LUMP SUM PRICE BID FOR ITEM SPECIAL - MAINTAINING EXISTING LIGHTING, SHALL INCLUDE PAYMENT FOR ALL LABOR, EQUIPMENT, MATERIALS, AND INCIDENTALS NECESSARY TO MAINTAIN THE EXISTING LIGHTING AS SPECIFIED HEREIN.

ADDITIONAL PULL BOXES AND CABLE SPLICING KITS

AN ESTIMATED QUANTITY OF 60 EACH OF ITEM 625 PULL BOX, 713.08, 18" AND A QUANTITY OF 180 EACH OF ITEM 625 CABLE SPLICING KIT ARE PROVIDED AS DIRECTED BY THE ENGINEER. THE LIGHTING PLANS WILL HAVE A "PB" INDICATING APPROXIMATELY WHERE THE PULL BOXES SHOULD BE PLACED.

ITEM 625 - CONDUIT JACKED OR DRILLED, AS PER PLAN

THIS ITEM SHALL CONSIST OF FURNISHING AND INSTALLING CONDUIT OF THE SIZE OR SIZES INDICATED UNDER EXISTING PAVEMENT AND CONTIGUOUS SHOULDERS BY AN APPROVED METHOD SUCH AS "DRILLING" OR "JACKING".

THE CONTRACTOR SHALL PLACE THE CONDUIT WITH THE LEAST AMOUNT OF DISTURBANCE TO THE EXISTING PAVEMENT, SUBBASE, BERM PAVEMENT, OR SHOULDERS OF THE ROADWAY. ALL PUSH PITS OR ANY NECESSARY EXCAVATIONS SHALL BE BACKFILLED AND RESTORED IN ACCORDANCE WITH 625.01.

MEASUREMENT OF THE CONDUIT SHALL BE THE ACTUAL AMOUNT OF LINEAL FEET INSTALLED UNDER PAVEMENT AND SHOULDERS, MEASURED IN PLACE AS ACCEPTED BY THE ENGINEER. THE UNIT PRICE BID FOR ITEM 625 "CONDUIT JACKED OR DRILLED, AS PER PLAN" SHALL BE FULL COMPENSATION FOR EXCAVATION, DRILLING OR JACKING, BACKFILLING, COMPACTION, RESTORATION, AND ALL LABOR, MATERIAL, EQUIPMENT AND INCIDENTALS NECESSARY TO COMPLETE THE WORK AS SPECIFIED.

LIGHT TOWER LUMINAIRE MOUNTING ARRANGEMENT

LUMINAIRE MOUNTING ARMS FOR TOWER LIGHTING UNITS SHALL BE INSTALLED BY THE POLE MANUFACTURERS SO THAT THE REQUIRED NUMBER OF LUMINAIRES CAN BE INSTALLED ON THE LUMINAIRE MOUNTING RING IN A SYMMETRICAL ARRANGEMENT. WHEN ONLY TWO (2) ARMS ARE REQUIRED THEY SHALL BE POSITIONED SO THE ARMS ARE PARALLEL TO THE CENTERLINE OR BASELINE OF THE PAVEMENT FROM WHICH THE TOWER IS STATIONED.

UNLESS OTHERWISE SPECIFIED IN THE PLANS, ALL LUMINAIRES WITH ASYMMETRIC DISTRIBUTIONS SHALL BE INSTALLED SO THE "ARROW" OR "STREET SIDE" DESIGNATION ON THE OPTICAL ASSEMBLY IS POSITIONED PERPENDICULAR TO THE CENTERLINE OR BASELINE OF THE PAVEMENT FROM WHICH THE TOWER IS STATIONED. ANY OPTICAL ROTATION CALLED FOR WILL BE EXPRESSED AS A CLOCKWISE (CW) OR COUNTERCLOCKWISE (CCW) ANGULAR MEASUREMENT FROM THE NORMAL "ARROW" ORIENTATION.

GLARE SHEILDS, AS PER PLAN

ALL LUMINAIRES MOUNTED AT THE TOWERS LOCATIONS SPECIFIED SHALL HAVE THE 90 DEGREE GLARE SHIELD INSTALLED ON THE HOUSE SIDE.

PAYMENT WILL BE MADE AT THE UNIT BID PRICE FOR EACH ITEM 625 "GLARE SHEILDS, AS PER PLAN".

CONTINGENCY QUANTITIES

THE CONTRACTOR SHALL NOT ORDER MATERIALS OR PERFORM WORK FOR ITEMS DESIGNATED BY PLAN NOTE TO BE USED "AS DIRECTED BY THE ENGINEER" UNLESS AUTHORIZED BY THE ENGINEER. THE ACTUAL WORK LOCATIONS AND QUANTITIES USED FOR SUCH ITEMS SHALL BE INCORPORATED INTO THE FINAL CHANGE ORDER GOVERNING COMPLETION OF THIS PROJECT.

ANCHOR BASE FOUNDATIONS

ALL LIGHT POLE FOUNDATIONS DESIGNATED FOR ANCHOR BASE POLES (NOT ALUMINUM TRANSFORMER BASE POLES) SHALL HAVE THEIR FOUNDATION FORMED SUCH THAT THE TOP OF FOUNDATION SHALL BE 8' TO 12' ABOVE FINISHED GRADE.



Lighting General Notes

MED-71-15.78

608
940

GENERAL NOTES

REF. FILE #1 LEVELS ON:
 REF. FILE #2 LEVELS ON:
 REF. FILE #3 LEVELS ON:
 REF. FILE #4 LEVELS ON:
 REF. FILE #5 LEVELS ON:
 REF. FILE #6 LEVELS ON:
 REF. FILE #7 LEVELS ON:
 REF. FILE #8 LEVELS ON:
 REF. FILE #9 LEVELS ON:
 REF. FILE #10 LEVELS ON:
 REF. FILE #11 LEVELS ON:
 REF. FILE #12 LEVELS ON:
 REF. FILE #13 LEVELS ON:
 REF. FILE #14 LEVELS ON:
 REF. FILE #15 LEVELS ON:
 REF. FILE #16 LEVELS ON:
 REF. FILE #17 LEVELS ON:
 REF. FILE #18 LEVELS ON:
 REF. FILE #19 LEVELS ON:
 REF. FILE #20 LEVELS ON:
 REF. FILE #21 LEVELS ON:
 REF. FILE #22 LEVELS ON:
 REF. FILE #23 LEVELS ON:
 REF. FILE #24 LEVELS ON:
 REF. FILE #25 LEVELS ON:
 REF. FILE #26 LEVELS ON:
 REF. FILE #27 LEVELS ON:
 REF. FILE #28 LEVELS ON:
 REF. FILE #29 LEVELS ON:
 REF. FILE #30 LEVELS ON:
 REF. FILE #31 LEVELS ON:
 REF. FILE #32 LEVELS ON:
 REF. FILE #33 LEVELS ON:
 REF. FILE #34 LEVELS ON:
 REF. FILE #35 LEVELS ON:
 REF. FILE #36 LEVELS ON:
 REF. FILE #37 LEVELS ON:
 REF. FILE #38 LEVELS ON:
 REF. FILE #39 LEVELS ON:
 REF. FILE #40 LEVELS ON:
 REF. FILE #41 LEVELS ON:
 REF. FILE #42 LEVELS ON:
 REF. FILE #43 LEVELS ON:
 REF. FILE #44 LEVELS ON:
 REF. FILE #45 LEVELS ON:
 REF. FILE #46 LEVELS ON:
 REF. FILE #47 LEVELS ON:
 REF. FILE #48 LEVELS ON:
 REF. FILE #49 LEVELS ON:
 REF. FILE #50 LEVELS ON:
 REF. FILE #51 LEVELS ON:
 REF. FILE #52 LEVELS ON:
 REF. FILE #53 LEVELS ON:
 REF. FILE #54 LEVELS ON:
 REF. FILE #55 LEVELS ON:
 REF. FILE #56 LEVELS ON:
 REF. FILE #57 LEVELS ON:
 REF. FILE #58 LEVELS ON:
 REF. FILE #59 LEVELS ON:
 REF. FILE #60 LEVELS ON:
 REF. FILE #61 LEVELS ON:
 REF. FILE #62 LEVELS ON:
 REF. FILE #63 LEVELS ON:
 REF. FILE #64 LEVELS ON:
 REF. FILE #65 LEVELS ON:
 REF. FILE #66 LEVELS ON:
 REF. FILE #67 LEVELS ON:
 REF. FILE #68 LEVELS ON:
 REF. FILE #69 LEVELS ON:
 REF. FILE #70 LEVELS ON:
 REF. FILE #71 LEVELS ON:
 REF. FILE #72 LEVELS ON:
 REF. FILE #73 LEVELS ON:
 REF. FILE #74 LEVELS ON:
 REF. FILE #75 LEVELS ON:
 REF. FILE #76 LEVELS ON:
 REF. FILE #77 LEVELS ON:
 REF. FILE #78 LEVELS ON:
 REF. FILE #79 LEVELS ON:
 REF. FILE #80 LEVELS ON:
 REF. FILE #81 LEVELS ON:
 REF. FILE #82 LEVELS ON:
 REF. FILE #83 LEVELS ON:
 REF. FILE #84 LEVELS ON:
 REF. FILE #85 LEVELS ON:
 REF. FILE #86 LEVELS ON:
 REF. FILE #87 LEVELS ON:
 REF. FILE #88 LEVELS ON:
 REF. FILE #89 LEVELS ON:
 REF. FILE #90 LEVELS ON:
 REF. FILE #91 LEVELS ON:
 REF. FILE #92 LEVELS ON:
 REF. FILE #93 LEVELS ON:
 REF. FILE #94 LEVELS ON:
 REF. FILE #95 LEVELS ON:
 REF. FILE #96 LEVELS ON:
 REF. FILE #97 LEVELS ON:
 REF. FILE #98 LEVELS ON:
 REF. FILE #99 LEVELS ON:
 REF. FILE #100 LEVELS ON:
 REF. FILE #101 LEVELS ON:
 REF. FILE #102 LEVELS ON:
 REF. FILE #103 LEVELS ON:
 REF. FILE #104 LEVELS ON:
 REF. FILE #105 LEVELS ON:
 REF. FILE #106 LEVELS ON:
 REF. FILE #107 LEVELS ON:
 REF. FILE #108 LEVELS ON:
 REF. FILE #109 LEVELS ON:
 REF. FILE #110 LEVELS ON:
 REF. FILE #111 LEVELS ON:
 REF. FILE #112 LEVELS ON:
 REF. FILE #113 LEVELS ON:
 REF. FILE #114 LEVELS ON:
 REF. FILE #115 LEVELS ON:
 REF. FILE #116 LEVELS ON:
 REF. FILE #117 LEVELS ON:
 REF. FILE #118 LEVELS ON:
 REF. FILE #119 LEVELS ON:
 REF. FILE #120 LEVELS ON:
 REF. FILE #121 LEVELS ON:
 REF. FILE #122 LEVELS ON:
 REF. FILE #123 LEVELS ON:
 REF. FILE #124 LEVELS ON:
 REF. FILE #125 LEVELS ON:
 REF. FILE #126 LEVELS ON:
 REF. FILE #127 LEVELS ON:
 REF. FILE #128 LEVELS ON:
 REF. FILE #129 LEVELS ON:
 REF. FILE #130 LEVELS ON:
 REF. FILE #131 LEVELS ON:
 REF. FILE #132 LEVELS ON:
 REF. FILE #133 LEVELS ON:
 REF. FILE #134 LEVELS ON:
 REF. FILE #135 LEVELS ON:
 REF. FILE #136 LEVELS ON:
 REF. FILE #137 LEVELS ON:
 REF. FILE #138 LEVELS ON:
 REF. FILE #139 LEVELS ON:
 REF. FILE #140 LEVELS ON:
 REF. FILE #141 LEVELS ON:
 REF. FILE #142 LEVELS ON:
 REF. FILE #143 LEVELS ON:
 REF. FILE #144 LEVELS ON:
 REF. FILE #145 LEVELS ON:
 REF. FILE #146 LEVELS ON:
 REF. FILE #147 LEVELS ON:
 REF. FILE #148 LEVELS ON:
 REF. FILE #149 LEVELS ON:
 REF. FILE #150 LEVELS ON:
 REF. FILE #151 LEVELS ON:
 REF. FILE #152 LEVELS ON:
 REF. FILE #153 LEVELS ON:
 REF. FILE #154 LEVELS ON:
 REF. FILE #155 LEVELS ON:
 REF. FILE #156 LEVELS ON:
 REF. FILE #157 LEVELS ON:
 REF. FILE #158 LEVELS ON:
 REF. FILE #159 LEVELS ON:
 REF. FILE #160 LEVELS ON:
 REF. FILE #161 LEVELS ON:
 REF. FILE #162 LEVELS ON:
 REF. FILE #163 LEVELS ON:
 REF. FILE #164 LEVELS ON:
 REF. FILE #165 LEVELS ON:
 REF. FILE #166 LEVELS ON:
 REF. FILE #167 LEVELS ON:
 REF. FILE #168 LEVELS ON:
 REF. FILE #169 LEVELS ON:
 REF. FILE #170 LEVELS ON:
 REF. FILE #171 LEVELS ON:
 REF. FILE #172 LEVELS ON:
 REF. FILE #173 LEVELS ON:
 REF. FILE #174 LEVELS ON:
 REF. FILE #175 LEVELS ON:
 REF. FILE #176 LEVELS ON:
 REF. FILE #177 LEVELS ON:
 REF. FILE #178 LEVELS ON:
 REF. FILE #179 LEVELS ON:
 REF. FILE #180 LEVELS ON:
 REF. FILE #181 LEVELS ON:
 REF. FILE #182 LEVELS ON:
 REF. FILE #183 LEVELS ON:
 REF. FILE #184 LEVELS ON:
 REF. FILE #185 LEVELS ON:
 REF. FILE #186 LEVELS ON:
 REF. FILE #187 LEVELS ON:
 REF. FILE #188 LEVELS ON:
 REF. FILE #189 LEVELS ON:
 REF. FILE #190 LEVELS ON:
 REF. FILE #191 LEVELS ON:
 REF. FILE #192 LEVELS ON:
 REF. FILE #193 LEVELS ON:
 REF. FILE #194 LEVELS ON:
 REF. FILE #195 LEVELS ON:
 REF. FILE #196 LEVELS ON:
 REF. FILE #197 LEVELS ON:
 REF. FILE #198 LEVELS ON:
 REF. FILE #199 LEVELS ON:
 REF. FILE #200 LEVELS ON:
 REF. FILE #201 LEVELS ON:
 REF. FILE #202 LEVELS ON:
 REF. FILE #203 LEVELS ON:
 REF. FILE #204 LEVELS ON:
 REF. FILE #205 LEVELS ON:
 REF. FILE #206 LEVELS ON:
 REF. FILE #207 LEVELS ON:
 REF. FILE #208 LEVELS ON:
 REF. FILE #209 LEVELS ON:
 REF. FILE #210 LEVELS ON:
 REF. FILE #211 LEVELS ON:
 REF. FILE #212 LEVELS ON:
 REF. FILE #213 LEVELS ON:
 REF. FILE #214 LEVELS ON:
 REF. FILE #215 LEVELS ON:
 REF. FILE #216 LEVELS ON:
 REF. FILE #217 LEVELS ON:
 REF. FILE #218 LEVELS ON:
 REF. FILE #219 LEVELS ON:
 REF. FILE #220 LEVELS ON:
 REF. FILE #221 LEVELS ON:
 REF. FILE #222 LEVELS ON:
 REF. FILE #223 LEVELS ON:
 REF. FILE #224 LEVELS ON:
 REF. FILE #225 LEVELS ON:
 REF. FILE #226 LEVELS ON:
 REF. FILE #227 LEVELS ON:
 REF. FILE #228 LEVELS ON:
 REF. FILE #229 LEVELS ON:
 REF. FILE #230 LEVELS ON:
 REF. FILE #231 LEVELS ON:
 REF. FILE #232 LEVELS ON:
 REF. FILE #233 LEVELS ON:
 REF. FILE #234 LEVELS ON:
 REF. FILE #235 LEVELS ON:
 REF. FILE #236 LEVELS ON:
 REF. FILE #237 LEVELS ON:
 REF. FILE #238 LEVELS ON:
 REF. FILE #239 LEVELS ON:
 REF. FILE #240 LEVELS ON:
 REF. FILE #241 LEVELS ON:
 REF. FILE #242 LEVELS ON:
 REF. FILE #243 LEVELS ON:
 REF. FILE #244 LEVELS ON:
 REF. FILE #245 LEVELS ON:
 REF. FILE #246 LEVELS ON:
 REF. FILE #247 LEVELS ON:
 REF. FILE #248 LEVELS ON:
 REF. FILE #249 LEVELS ON:
 REF. FILE #250 LEVELS ON:
 REF. FILE #251 LEVELS ON:
 REF. FILE #252 LEVELS ON:
 REF. FILE #253 LEVELS ON:
 REF. FILE #254 LEVELS ON:
 REF. FILE #255 LEVELS ON:
 REF. FILE #256 LEVELS ON:
 REF. FILE #257 LEVELS ON:
 REF. FILE #258 LEVELS ON:
 REF. FILE #259 LEVELS ON:
 REF. FILE #260 LEVELS ON:
 REF. FILE #261 LEVELS ON:
 REF. FILE #262 LEVELS ON:
 REF. FILE #263 LEVELS ON:
 REF. FILE #264 LEVELS ON:
 REF. FILE #265 LEVELS ON:
 REF. FILE #266 LEVELS ON:
 REF. FILE #267 LEVELS ON:
 REF. FILE #268 LEVELS ON:
 REF. FILE #269 LEVELS ON:
 REF. FILE #270 LEVELS ON:
 REF. FILE #271 LEVELS ON:
 REF. FILE #272 LEVELS ON:
 REF. FILE #273 LEVELS ON:
 REF. FILE #274 LEVELS ON:
 REF. FILE #275 LEVELS ON:
 REF. FILE #276 LEVELS ON:
 REF. FILE #277 LEVELS ON:
 REF. FILE #278 LEVELS ON:
 REF. FILE #279 LEVELS ON:
 REF. FILE #280 LEVELS ON:
 REF. FILE #281 LEVELS ON:
 REF. FILE #282 LEVELS ON:
 REF. FILE #283 LEVELS ON:
 REF. FILE #284 LEVELS ON:
 REF. FILE #285 LEVELS ON:
 REF. FILE #286 LEVELS ON:
 REF. FILE #287 LEVELS ON:
 REF. FILE #288 LEVELS ON:
 REF. FILE #289 LEVELS ON:
 REF. FILE #290 LEVELS ON:
 REF. FILE #291 LEVELS ON:
 REF. FILE #292 LEVELS ON:
 REF. FILE #293 LEVELS ON:
 REF. FILE #294 LEVELS ON:
 REF. FILE #295 LEVELS ON:
 REF. FILE #296 LEVELS ON:
 REF. FILE #297 LEVELS ON:
 REF. FILE #298 LEVELS ON:
 REF. FILE #299 LEVELS ON:
 REF. FILE #300 LEVELS ON:
 REF. FILE #301 LEVELS ON:
 REF. FILE #302 LEVELS ON:
 REF. FILE #303 LEVELS ON:
 REF. FILE #304 LEVELS ON:
 REF. FILE #305 LEVELS ON:
 REF. FILE #306 LEVELS ON:
 REF. FILE #307 LEVELS ON:
 REF. FILE #308 LEVELS ON:
 REF. FILE #309 LEVELS ON:
 REF. FILE #310 LEVELS ON:
 REF. FILE #311 LEVELS ON:
 REF. FILE #312 LEVELS ON:
 REF. FILE #313 LEVELS ON:
 REF. FILE #314 LEVELS ON:
 REF. FILE #315 LEVELS ON:
 REF. FILE #316 LEVELS ON:
 REF. FILE #317 LEVELS ON:
 REF. FILE #318 LEVELS ON:
 REF. FILE #319 LEVELS ON:
 REF. FILE #320 LEVELS ON:
 REF. FILE #321 LEVELS ON:
 REF. FILE #322 LEVELS ON:
 REF. FILE #323 LEVELS ON:
 REF. FILE #324 LEVELS ON:
 REF. FILE #325 LEVELS ON:
 REF. FILE #326 LEVELS ON:
 REF. FILE #327 LEVELS ON:
 REF. FILE #328 LEVELS ON:
 REF. FILE #329 LEVELS ON:
 REF. FILE #330 LEVELS ON:
 REF. FILE #331 LEVELS ON:
 REF. FILE #332 LEVELS ON:
 REF. FILE #333 LEVELS ON:
 REF. FILE #334 LEVELS ON:
 REF. FILE #335 LEVELS ON:
 REF. FILE #336 LEVELS ON:
 REF. FILE #337 LEVELS ON:
 REF. FILE #338 LEVELS ON:
 REF. FILE #339 LEVELS ON:
 REF. FILE #340 LEVELS ON:
 REF. FILE #341 LEVELS ON:
 REF. FILE #342 LEVELS ON:
 REF. FILE #343 LEVELS ON:
 REF. FILE #344 LEVELS ON:
 REF. FILE #345 LEVELS ON:
 REF. FILE #346 LEVELS ON:
 REF. FILE #347 LEVELS ON:
 REF. FILE #348 LEVELS ON:
 REF. FILE #349 LEVELS ON:
 REF. FILE #350 LEVELS ON:
 REF. FILE #351 LEVELS ON:
 REF. FILE #352 LEVELS ON:
 REF. FILE #353 LEVELS ON:
 REF. FILE #354 LEVELS ON:
 REF. FILE #355 LEVELS ON:
 REF. FILE #356 LEVELS ON:
 REF. FILE #357 LEVELS ON:
 REF. FILE #358 LEVELS ON:
 REF. FILE #359 LEVELS ON:
 REF. FILE #360 LEVELS ON:
 REF. FILE #361 LEVELS ON:
 REF. FILE #362 LEVELS ON:
 REF. FILE #363 LEVELS ON:
 REF. FILE #364 LEVELS ON:
 REF. FILE #365 LEVELS ON:
 REF. FILE #366 LEVELS ON:
 REF. FILE #367 LEVELS ON:
 REF. FILE #368 LEVELS ON:
 REF. FILE #369 LEVELS ON:
 REF. FILE #370 LEVELS ON:
 REF. FILE #371 LEVELS ON:
 REF. FILE #372 LEVELS ON:
 REF. FILE #373 LEVELS ON:
 REF. FILE #374 LEVELS ON:
 REF. FILE #375 LEVELS ON:
 REF. FILE #376 LEVELS ON:
 REF. FILE #377 LEVELS ON:
 REF. FILE #378 LEVELS ON:
 REF. FILE #379 LEVELS ON:
 REF. FILE #380 LEVELS ON:
 REF. FILE #381 LEVELS ON:
 REF. FILE #382 LEVELS ON:
 REF. FILE #383 LEVELS ON:
 REF. FILE #384 LEVELS ON:
 REF. FILE #385 LEVELS ON:
 REF. FILE #386 LEVELS ON:
 REF. FILE #387 LEVELS ON:
 REF. FILE #388 LEVELS ON:
 REF. FILE #389 LEVELS ON:
 REF. FILE #390 LEVELS ON:
 REF. FILE #391 LEVELS ON:
 REF. FILE #392 LEVELS ON:
 REF. FILE #393 LEVELS ON:
 REF. FILE #394 LEVELS ON:
 REF. FILE #395 LEVELS ON:
 REF. FILE #396 LEVELS ON:
 REF. FILE #397 LEVELS ON:
 REF. FILE #398 LEVELS ON:
 REF. FILE #399 LEVELS ON:
 REF. FILE #400 LEVELS ON:
 REF. FILE #401 LEVELS ON:
 REF. FILE #402 LEVELS ON:
 REF. FILE #403 LEVELS ON:
 REF. FILE #404 LEVELS ON:
 REF. FILE #405 LEVELS ON:
 REF. FILE #406 LEVELS ON:
 REF. FILE #407 LEVELS ON:
 REF. FILE #408 LEVELS ON:
 REF. FILE #409 LEVELS ON:
 REF. FILE #410 LEVELS ON:
 REF. FILE #411 LEVELS ON:
 REF. FILE #412 LEVELS ON:
 REF. FILE #413 LEVELS ON:
 REF. FILE #414 LEVELS ON:
 REF. FILE #415 LEVELS ON:
 REF. FILE #416 LEVELS ON:
 REF. FILE #417 LEVELS ON:
 REF. FILE #418 LEVELS ON:
 REF. FILE #419 LEVELS ON:
 REF. FILE #420 LEVELS ON:
 REF. FILE #421 LEVELS ON:
 REF. FILE #422 LEVELS ON:
 REF. FILE #423 LEVELS ON:
 REF. FILE #424 LEVELS ON:
 REF. FILE #425 LEVELS ON:
 REF. FILE #426 LEVELS ON:
 REF. FILE #427 LEVELS ON:
 REF. FILE #428 LEVELS ON:
 REF. FILE #429 LEVELS ON:
 REF. FILE #430 LEVELS ON:
 REF. FILE #431 LEVELS ON:
 REF. FILE #432 LEVELS ON:
 REF. FILE #433 LEVELS ON:
 REF. FILE #434 LEVELS ON:
 REF. FILE #435 LEVELS ON:
 REF. FILE #436 LEVELS ON:
 REF. FILE #437 LEVELS ON:
 REF. FILE #438 LEVELS ON:
 REF. FILE #439 LEVELS ON:
 REF. FILE #440 LEVELS ON:
 REF. FILE #441 LEVELS ON:
 REF. FILE #442 LEVELS ON:
 REF. FILE #443 LEVELS ON:
 REF. FILE #444 LEVELS ON:
 REF. FILE #445 LEVELS ON:
 REF. FILE #446 LEVELS ON:
 REF. FILE #447 LEVELS ON:
 REF. FILE #448 LEVELS ON:
 REF. FILE #449 LEVELS ON:
 REF. FILE #450 LEVELS ON:
 REF. FILE #451 LEVELS ON:
 REF. FILE #452 LEVELS ON:
 REF. FILE #453 LEVELS ON:
 REF. FILE #454 LEVELS ON:
 REF. FILE #455 LEVELS ON:
 REF. FILE #456 LEVELS ON:
 REF. FILE #457 LEVELS ON:
 REF. FILE #458 LEVELS ON:
 REF. FILE #459 LEVELS ON:
 REF. FILE #460 LEVELS ON:
 REF. FILE #461 LEVELS ON:
 REF. FILE #462 LEVELS ON:
 REF. FILE #463 LEVELS ON:
 REF. FILE #464 LEVELS ON:
 REF. FILE #465 LEVELS ON:
 REF. FILE #466 LEVELS ON:
 REF. FILE #467 LEVELS ON:
 REF. FILE #468 LEVELS ON:
 REF. FILE #469 LEVELS ON:
 REF. FILE #470 LEVELS ON:
 REF. FILE #471 LEVELS ON:
 REF. FILE #472 LEVELS ON:
 REF. FILE #473 LEVELS ON:
 REF. FILE #474 LEVELS ON:
 REF. FILE #475 LEVELS ON:
 REF. FILE #476 LEVELS ON:
 REF. FILE #477 LEVELS ON:
 REF. FILE #478 LEVELS ON:
 REF. FILE #479 LEVELS ON:
 REF. FILE #480 LEVELS ON:
 REF. FILE #481 LEVELS ON:
 REF. FILE #482 LEVELS ON:
 REF. FILE #483 LEVELS ON:
 REF. FILE #484 LEVELS ON:
 REF. FILE #485 LEVELS ON:
 REF. FILE #486 LEVELS ON:
 REF. FILE #487 LEVELS ON:
 REF. FILE #488 LEVELS ON:
 REF. FILE #489 LEVELS ON:
 REF. FILE #490 LEVELS ON:
 REF. FILE #491 LEVELS ON:
 REF. FILE #492 LEVELS ON:
 REF. FILE #493 LEVELS ON:
 REF. FILE #494 LEVELS ON:
 REF. FILE #495 LEVELS ON:
 REF. FILE #496 LEVELS ON:
 REF. FILE #497 LEVELS ON:
 REF. FILE #498 LEVELS ON:
 REF. FILE #499 LEVELS ON:
 REF. FILE #500 LEVELS ON:
 REF. FILE #501 LEVELS ON:
 REF. FILE #502 LEVELS ON:
 REF. FILE #503 LEVELS ON:
 REF. FILE #504 LEVELS ON:
 REF. FILE #505 LEVELS ON:
 REF. FILE #

REF-FILE #1 LEVELS ON:
 REF-FILE #2 LEVELS ON:
 REF-FILE #3 LEVELS ON:
 REF-FILE #4 LEVELS ON:
 REF-FILE #5 LEVELS ON:
 REF-FILE #6 LEVELS ON:
 REF-FILE #7 LEVELS ON:
 REF-FILE #8 LEVELS ON:
 REF-FILE #9 LEVELS ON:
 REF-FILE #10 LEVELS ON:
 REF-FILE #11 LEVELS ON:
 REF-FILE #12 LEVELS ON:
 REF-FILE #13 LEVELS ON:
 REF-FILE #14 LEVELS ON:
 REF-FILE #15 LEVELS ON:
 REF-FILE #16 LEVELS ON:
 REF-FILE #17 LEVELS ON:
 REF-FILE #18 LEVELS ON:
 REF-FILE #19 LEVELS ON:
 REF-FILE #20 LEVELS ON:

LOCATION - SHEET NUMBER											ITEM	ITEM EXT.	GRAND TOTAL	UNIT	DESCRIPTION	SEE SHEET NO.
GENERAL NOTES		S.R. 18		I.R. 271	S.R. 3	NB REST AREA	S.R. 303									
607	608	611	612	618	613	614	615	616	617	682						
					28			16	8		625	28001	52	EACH	GLARE SHIELD, AS PER PLAN	608
		6,985	2,673		6,910	6,790	2,122	7,540	2,210		625	29002	35,330	LIN FT	TRENCH, 24" DEEP	
	60	5	7		6	7		2	6		625	30700	93	EACH	PULL BOX, 713.08, 18"	
										24	625	30707	24	EACH	PULL BOX, 713.08, 24", AS PER PLAN	683
		18			28	18	9	34	9		625	32000	116	EACH	GROUND ROD	
					3	1			2		625	33000	6	EACH	STRUCTURE GROUNDING SYSTEM	
			2		1	1		2			625	34001	6	EACH	POWER SERVICE, AS PER PLAN	607
					4				4		625	37100	8	EACH	SERVICE TO UNDERPASS LIGHTING	
LUMP											625	38000	LUMP		HIGH VOLTAGE TEST	
	LUMP										SPECIAL	62540000	LUMP		MAINTAIN EXISTING LIGHTING	608

LIGHTING GENERAL SUMMARY

MED - 71 - 15.78

LIGHTING SUB-SUMMARY

QUANTITIES	
CALC. BY: AFS	DATE: 5/16/94
CHKD. BY: MCB	DATE: 6/1/94



SHEET No.	REF. No.	STATION		SIDE	625																		
					CONNECTOR KIT, TYPE II	CONNECTOR KIT, TYPE III	CONNECTOR KIT, TYPE VII B	CABLE SPICING KIT	LIGHT POLE DESIGN, AT12B41.7	LIGHT POLE DESIGN, AT15B41.7	LIGHT POLE FOUNDATION 24" X 8" DEEP	NO. 4 AWG 5000 VOLT DISTRIBUTION CABLE	NO. 10 AWG POLE AND BRACKET CABLE	1.5" DUCT CABLE WITH THREE NO. 4 AWG 5000 V CABLES	CONDUIT, 2", 713.04	CONDUIT, 3", 713.04	CONDUIT JACKED OR DRILLED UNDER PAVEMENT 3/4" P.P.	TRENCH 24" DEEP	LUMINAIRE, STYLE B, TYPE II, 200 W, HPS 713.11, 480V	PULLBOX 713.08, 18"	GROUND ROD	POWER SERVICE AS PER PLAN	STRUCTURE GROUNDING SYSTEM
FROM	TO	EACH	EACH	EACH	EACH	EACH	EACH	EACH	EACH	NO. 4 AWG 5000 VOLT DISTRIBUTION CABLE	NO. 10 AWG POLE AND BRACKET CABLE	1.5" DUCT CABLE WITH THREE NO. 4 AWG 5000 V CABLES	CONDUIT, 2", 713.04	CONDUIT, 3", 713.04	CONDUIT JACKED OR DRILLED UNDER PAVEMENT 3/4" P.P.	TRENCH 24" DEEP	LUMINAIRE, STYLE B, TYPE II, 200 W, HPS 713.11, 480V	PULLBOX 713.08, 18"	GROUND ROD	POWER SERVICE AS PER PLAN	STRUCTURE GROUNDING SYSTEM	GLARE SHIELD AS PER PLAN	
I.R.71 AND S.R.3 NEW INSTALLATION																							
CIRCUIT A																							
631	CC-J	896+55 S.R.3	81+20 RAMP B	RT																			
		896+55 S.R.3	81+20 RAMP B	RT/LT						330				100			100				1		
	PB-B1	81+20 RAMP B	895+60 S.R.3	LT						4									1				
		81+20 RAMP B	895+60 S.R.3	LT/LT																			
	AJ-1	895+60 S.R.3	897+15 S.R.3	LT	1	1																	
		81+20 RAMP B	897+15 S.R.3	LT/RT						1	1												
	AJ-2	897+15 S.R.3	904+00 S.R.3	RT	1	1																	
		897+15 S.R.3	904+00 S.R.3	RT																			
	PB-A1	904+00 S.R.3	904+00 S.R.3	RT						4													
		904+00 S.R.3	904+00 S.R.3	RT/LT																			
	AJ-3	904+00 S.R.3	905+60 S.R.3	LT	1	1																	
		904+00 S.R.3	905+60 S.R.3	RT						1	1												
631	AJ-4	905+60 S.R.3		RT	1	1																	
CIRCUIT B																							
631	CC-J	896+55 S.R.3	81+20 RAMP B	RT																			
		896+55 S.R.3	81+20 RAMP B	RT/LT						330													
	PB-B1	81+20 RAMP B	1087+69 I.R.71	LT																			
		81+20 RAMP B	1087+69 I.R.71	LT/LT						2													
	BJ-1	1087+69 I.R.71	1084+69 I.R.71	LT	1	1																	
		1087+69 I.R.71	1084+69 I.R.71	LT																			
	BJ-2	1084+69 I.R.71	1081+69 I.R.71	LT	1	1	2																
		1084+69 I.R.71	1081+69 I.R.71	LT																			
	BJ-3	1081+69 I.R.71	1085+34 I.R.71	LT/RT	1	1																	
		1081+69 I.R.71	1085+34 I.R.71	LT																			
	BJ-4	1085+34 I.R.71	1090+00 I.R.71	RT	1	1																	
		1085+34 I.R.71	1090+00 I.R.71	RT																			
	PB-B2	1090+00 I.R.71	70+55 RAMP B	RT/RT						4													
		1090+00 I.R.71	70+55 RAMP B	RT																			
	BJ-5	70+55 RAMP B	72+50 RAMP B	RT	1	1																	
		70+55 RAMP B	72+50 RAMP B	RT																			
	BJ-7	72+50 RAMP B	1093+39 I.R.71	RT/RT	1	1																	
		72+50 RAMP B	1093+39 I.R.71	RT																			
631	BJ-6	1093+39 I.R.71		RT	1	1																	
CIRCUIT C																							
632	CC-J	896+55 S.R.3	81+20 RAMP B	RT																			
		896+55 S.R.3	81+20 RAMP B	RT/LT						330													
	PB-B1	81+20 RAMP B	896+00 S.R.3	LT						2													
		81+20 RAMP B	896+00 S.R.3	LT/LT																			
	PB-C1	896+00 S.R.3	83+50 RAMP C	LT																			
		896+00 S.R.3	83+50 RAMP C	LT/LT						2													
	PB-C2	83+50 RAMP C	84+50 RAMP C	LT																			
		83+50 RAMP C	84+50 RAMP C	LT/LT																			
	PB-C3	84+50 RAMP C	93+45 RAMP C	LT						2													
		84+50 RAMP C	93+45 RAMP C	LT/LT																			
	CJ-6	93+45 RAMP C	1115+24 I.R.71	LT	1	1	2																
		93+45 RAMP C	1115+24 I.R.71	LT/LT						1	1												
	CJ-7	1115+24 I.R.71	95+40 RAMP C	LT	1	1																	
		1115+24 I.R.71	95+40 RAMP C	LT																			
	CJ-5	95+40 RAMP C	1118+61 I.R.71	LT/LT	1	1																	
		95+40 RAMP C	1118+61 I.R.71	LT						1	1												
	PB-C4	1118+61 I.R.71	1123+24 I.R.71	LT						2													
		1118+61 I.R.71	1123+24 I.R.71	LT																			
	CJ-4	1123+24 I.R.71	1123+94 I.R.71	LT	1	1																	
		1123+24 I.R.71	1123+94 I.R.71	LT/RT																			
	CJ-2	1123+94 I.R.71	1120+94 I.R.71	RT	1	1	2																
		1123+94 I.R.71	1120+94 I.R.71	RT						1	1												
	CJ-1	1120+94 I.R.71	1126+94 I.R.71	RT	1	1																	
		1120+94 I.R.71	1126+94 I.R.71	RT																			
632	CJ-3	1126+94 I.R.71		RT	1	1																	
		1126+94 I.R.71		RT																			
SHEET TOTALS					18	18	6	24	4	14	18	5070	3021	6490	80	375	860	6790	18	7	18	1	1

CALCULATED	CHECKED
------------	---------

Lighting Sub-Summary

MED-71-15.78

614
940

REF. FILE #1 LEVELS ON: REF. FILE #2 LEVELS ON: REF. FILE #3 LEVELS ON: REF. FILE #4 LEVELS ON:
 Sht-367
 FILE NAME: I:\WORK\med\11\lighting\summary\summary.dwg
 DATE & TIME: 10-DEC-1999 09:20
 USERNAME: rthor
 PROJECT: NONE
 LEVELS ON: FILE #1
 PLOT: QUELLE\0001\plot008
 PEEK TABLE: I:\WORK\med\11\lighting\summary\summary.dwg



LIGHTING SUB-SUMMARY

QUANTITIES
CALC. BY: AFS
DATE: 5/16/94
CHKD. BY: MCB
DATE: 6/1/94

REF. FILE #1 LEVELS ON:
REF. FILE #2 LEVELS ON:
REF. FILE #3 LEVELS ON:
REF. FILE #4 LEVELS ON:
REF. FILE #5 LEVELS ON:

Main table with columns: SHEET. No., REF. No., STATION, SIDE, CONNECTOR KIT, CABLE SPICING KIT, LIGHT POLE DESIGN, LIGHT TOWER FOUNDATION, LIGHT TOWER FOUNDATION 36" X 25" DEEP AS PER PLAN, NO. 4 AWG 5000 VOLT DISTRIBUTION CABLE, NO. 10 AWG POLE AND BRACKET CABLE, 1.5" DUCT CABLE WITH THREE NO. 4 AWG 5000 V CABLES, CONDUIT 3" 713.04, CONDUIT JACKED OR DRILLED UNDER PAVEMENT 3", TRENCH 24" DEEP, LIGHT TOWER BBBB100, LIGHT TOWER BBBB110, LIGHT TOWER BBBB120, LUMINAIRE, STYLE B, TYPE III 310 W, HPS 713.11, 480W, LUMINAIRE, ASYMMETRIC 400 W HPS 713.21, 480V, LUMINAIRE, SYMMETRIC 400 W, HPS 713.21, 480V, LUMINAIRE, UNDERPASS, 713.13, PULLBOX 713.08, 18", GROUND ROD, SERVICE TO UNDERPASS LIGHTING, GLARE SHIELD AS PER PLAN, STRUCTURE GROUNDING SYSTEM, DISCONNECT EXISTING CIRCUIT.

CALCULATED
CHECKED

Lighting Sub-Summary

MED-71-15.78

617
940

LIGHTING SUB-SUMMARY

LEVELS ON: 1-647
DATE & TIME: 10-DEC-99 10:24
USER NAME: rhrmon
PROJECT: NONE

LIGHTING SUB-SUMMARY

NOTE: 631 ITEMS CARRIED TO TRAFFIC CONTROL GENERAL SUMMARY SHEETS 562,563

QUANTITIES	
CALC. BY: AFS	DATE: 5/16/94
CHKD. BY: MCB	DATE: 6/1/94



REF. FILE #1 LEVELS ON
 REF. FILE #2 LEVELS ON
 REF. FILE #3 LEVELS ON
 REF. FILE #4 LEVELS ON

SHEET No.	REF. No.	STATION		SIDE	SIGN SERVICE EACH	SIGN WIRED EACH	DISCONNECT SWITCH WITH ENCLOSURE, 30 AMP EACH	SWITCH ENCLOSURE MOUNTING BRACKET ASSEMBLY EACH	BALLAST, TYPE CMRI-175-480, REMOTE EACH	BALLAST, TYPE CMRI-175-480, INTEGRAL EACH	BALLAST, TYPE CMRI-250-480, INTEGRAL EACH	MERCURY VAPOR LUMINAIRE, TYPE TC-31.21 WITH 175 W LAMP EACH	MERCURY VAPOR LUMINAIRE, TYPE TC-31.21 WITH 250 W LAMP EACH													
		FROM	TO																							
I.R. 71 AND S.R. 18 NEW INSTALLATION																										
623	SIGN-B108A	149+70	S.R. 18	RT	1	1	1	1	1				1													
622	SIGN - 6	870+81	I.R. 71	RT	1	2	1			2	1		2	1												
624	SIGN-D109A	154+35	S.R. 18	LT	1	2	1			1			1													
624	SIGN-D109	151+75	S.R. 18	LT	1	1	1	1	1				1													
I.R. 71 AND I.R. 271 NEW INSTALLATION																										
629	SIGN 30	97+00	IR-71	RT	1	2	1			4			4													
I.R. 71 AND S.R. 3 NEW INSTALLATION																										
631	SIGN-B52	1084+40	I.R. 71	RT	1	1	1				2			2												
632	SIGN-C60	1124+35	I.R. 71	LT	1	1	1				2			2												
I.R. 71 AND S.R. 303 NEW INSTALLATION																										
634	SIGN-C82	1248+48	I.R. 71	RT	1	1	1				2			2												
635	SIGN-A92	1287+20	I.R. 71	LT	1	1	1				2			2												
I.R. 71 AND S.R. 303 REVISIONS TO EXISTING SYSTEM																										
636	SIGN-T151	51+25	S.R. 303	LT	1	1	1			1			1													
636	SIGN-S150B	49+00	S.R. 303	RT	1	1	1			1			1													
I.R. 71 AND S.R. 18 NEW INSTALLATION (Cont.)																										
624	SIGN 12A	90+00	IR-71	LT	1	2	1			2	2		2	2												
626	SIGN 17A	927+40	IR-71	LT	1	2	1			2	3		2	3												
627	SIGN 24A	932+25.30	IR-71	RT	1	2	1			2	3		2	3												
628	SIGN 26	953+80	IR-71	LT	1	2	1			2	2		2	2												
SHEET TOTALS					15	22	15	2	2	17	19	19	19	19												

SIGN LIGHTING SUB-SUMMARY

MED - 71 - 15.78



VELS 04/11/641
 OT QUELLE \\DPI\LOT\...
 TIME: 10-DEC-1999 07:02
 FILE: I:\DPI\LOT\...
 PROJECT NAME

REF. FILE *1:\work\med-71\71\71\grmm1.dgn
LEVELS ON: 12+4, 8+39, #1-52, 54-57, 62, 64
REF. FILE *2:\work\med-71\71\71\grmm1.dgn
LEVELS ON: 12+4, 8+39, #1-52, 54-57, 62, 64
REF. FILE *3:\work\med-71\71\71\grmm1.dgn
LEVELS ON: 12+4, 8+39, #1-52, 54-57, 62, 64
REF. FILE *4:\work\med-71\71\71\grmm1.dgn
LEVELS ON: 12+4, 8+39, #1-52, 54-57, 62, 64

FILENAME: \work\med-71\71\71\grmm1.dgn
DATE: 12-09-98 10:18
PROJECT: NONE
LEVELS ON: 12+4, 8+39, #1-52, 54-56, 58-60, 63, 64
JOB: 71-15-78
USER: med-71

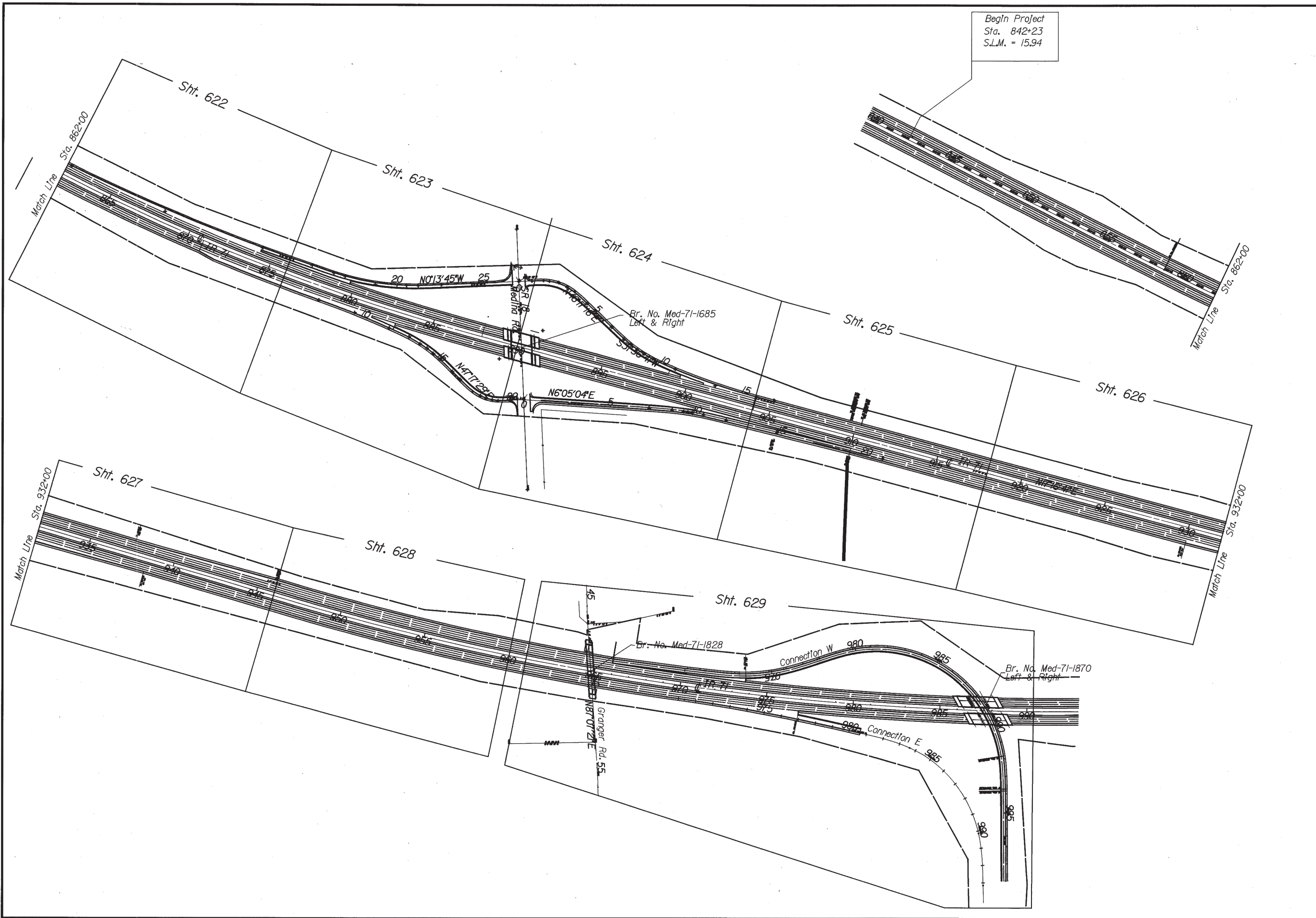

REF. FILE #1: h:\a\med_71\71\plan\lighting\71885.dgn
 REF. FILE #2: h:\a\med_71\71\plan\lighting\71885.dgn
 REF. FILE #3: h:\a\med_71\71\plan\lighting\71885.dgn
 REF. FILE #4: h:\a\med_71\71\plan\lighting\71885.dgn
 REF. FILE #5: h:\a\med_71\71\plan\lighting\71885.dgn
 REF. FILE #6: h:\a\med_71\71\plan\lighting\71885.dgn
 REF. FILE #7: h:\a\med_71\71\plan\lighting\71885.dgn
 REF. FILE #8: h:\a\med_71\71\plan\lighting\71885.dgn
 REF. FILE #9: h:\a\med_71\71\plan\lighting\71885.dgn
 REF. FILE #10: h:\a\med_71\71\plan\lighting\71885.dgn

FILE NAME: h:\a\med_71\71\plan\lighting\71885.dgn
 PLOT: ONEVIEW\DDI\PLT001.dwg
 DATE & TIME: 10-DEC-1999 13:26
 USER: NAME: mof
 PROJECT: NONE

LEVELS: ON: 12-4-8, 10-32, 54-57, 59, 62, 64
 LEVELS: ON: 12-4-8, 10-32, 54-57, 59, 62, 64
 LEVELS: ON: 12-4-8, 10-32, 54-57, 59, 62, 64
 LEVELS: ON: 12-4-8, 10-32, 54-57, 59, 62, 64
 LEVELS: ON: 12-4-8, 10-32, 54-57, 59, 62, 64
 LEVELS: ON: 12-4-8, 10-32, 54-57, 59, 62, 64
 LEVELS: ON: 12-4-8, 10-32, 54-57, 59, 62, 64
 LEVELS: ON: 12-4-8, 10-32, 54-57, 59, 62, 64
 LEVELS: ON: 12-4-8, 10-32, 54-57, 59, 62, 64
 LEVELS: ON: 12-4-8, 10-32, 54-57, 59, 62, 64
 LEVELS: ON: 12-4-8, 10-32, 54-57, 59, 62, 64

LEVELS: ON: 12-4-8, 10-32, 54-57, 59, 62, 64
 LEVELS: ON: 12-4-8, 10-32, 54-57, 59, 62, 64
 LEVELS: ON: 12-4-8, 10-32, 54-57, 59, 62, 64
 LEVELS: ON: 12-4-8, 10-32, 54-57, 59, 62, 64
 LEVELS: ON: 12-4-8, 10-32, 54-57, 59, 62, 64
 LEVELS: ON: 12-4-8, 10-32, 54-57, 59, 62, 64
 LEVELS: ON: 12-4-8, 10-32, 54-57, 59, 62, 64
 LEVELS: ON: 12-4-8, 10-32, 54-57, 59, 62, 64
 LEVELS: ON: 12-4-8, 10-32, 54-57, 59, 62, 64
 LEVELS: ON: 12-4-8, 10-32, 54-57, 59, 62, 64
 LEVELS: ON: 12-4-8, 10-32, 54-57, 59, 62, 64

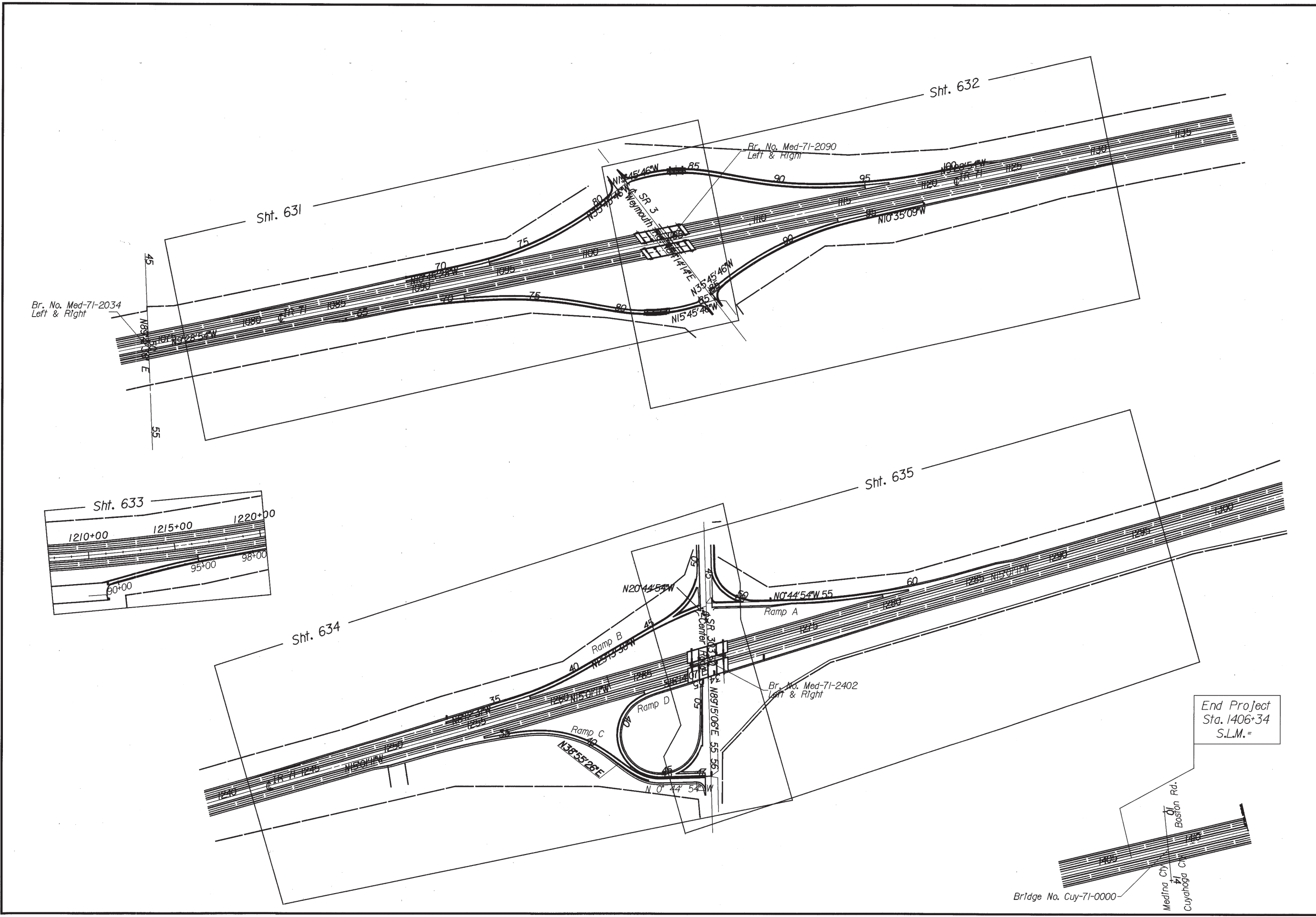

SCHEMATIC PLAN

MED-71-15.78

621
940

End Project
Sta. 1406+34
S.L.M. =

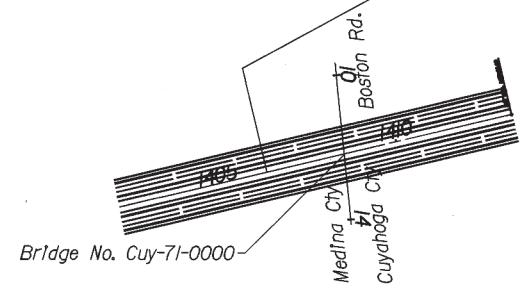

REF-FILE *1:INVA_MED_LIGHTING\CONTRACTOR.dgn
 REF-FILE *1:LEVELS ON:135-38.dwg
 REF-FILE *2:INVA_med LIGHTING\CONTRACTOR.dgn
 REF-FILE *2:LEVELS ON:12-4,8,16,18,20-52,54-59,61,62,64.dwg
 REF-FILE *3:INVA_MED_LIGHTING\CONTRACTOR.dgn
 REF-FILE *3:LEVELS ON:135-39.dwg
 REF-FILE *4:LEVELS ON:

FILENAME:INVA_MED_LIGHTING\CONTRACTOR.dgn
 DATE & TIME:10DEC-99 13:20
 USERNAME:ntox
 PROJECT: NONE
 LEVELS ON:135-38
 FILE:CONTRACTOR.dwg
 FROM:TABLE:INVA_MED_LIGHTING\CONTRACTOR.dwg

NOTES: FOR LEGEND, SEE SHEET 622

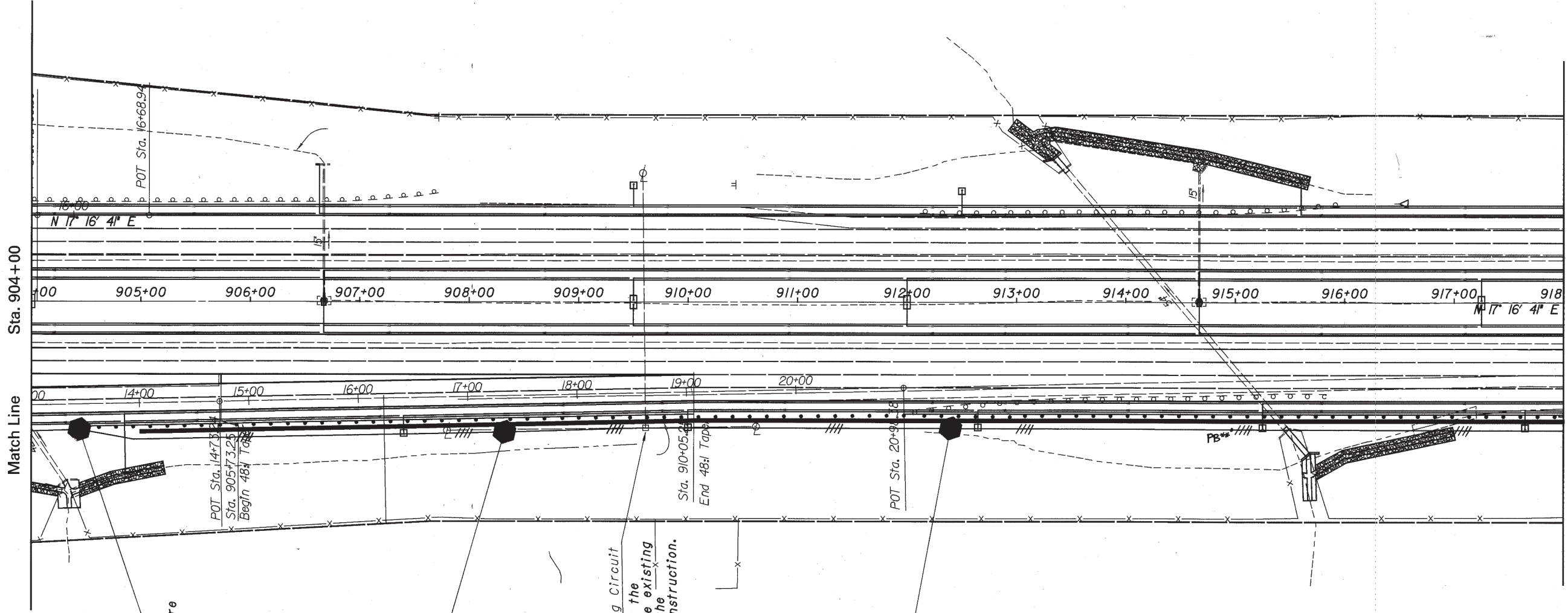

DC-3
 STA. 904+44 I-71
 1500 RT
 1 310 Watt Luminaire
 50' Pole, 15' Arm

DC-4
 STA. 908+32 I-71
 2500 RT
 1 310 Watt Luminaire
 50' Pole, 25' Arm

PB-D0 (Ex.)
 Sta. 909+58 I.R.-71
 Re-Connect Existing Circuit
 Care should be exercised by the contractor to insure that the existing conduit is not damaged by the guardrail and noise wall construction.

DC-5
 STA. 912+40 I-71
 2500 RT
 1 310 Watt Luminaire
 50' Pole, 25' Arm

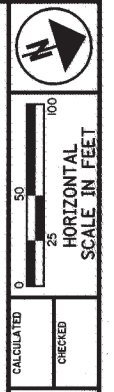

CALCULATED
 CHECKED

S.R. 18 Interchange
 Partial Lighting

MED-71-15.78

625
 940

REF. FILE *1\A00_MED_171\CON Lighting\conventional.dgn
 REF. FILE *1\LEVELS_0M_135_36.dwg
 REF. FILE *2\A00_Med_171\CON Lighting\conventional.dgn
 REF. FILE *2\LEVELS_0M_12_4_8-16_18_20-52_54-59_61_62.dwg
 REF. FILE *3\A00_MED_171\CON Lighting\conventional.dgn
 REF. FILE *1\LEVELS_0M_135_36.dwg
 REF. FILE *4\LEVELS_0M_135_36.dwg
 REF. FILE *4\LEVELS_0M

FILE NAME: I:\A00_MED_171\CON Lighting\conventional.dgn
 DATE & TIME: 10-DEC-1999 13:20
 USERNAME: mfox
 PROJECT: NONE
 LEVELS: ON: 1-64
 QUOTE: ON: 1-64
 PREP: TABLE: I:\A00_Med_171\CON Lighting\conventional.dgn

NOTES: FOR LEGEND, SEE SHEET 622

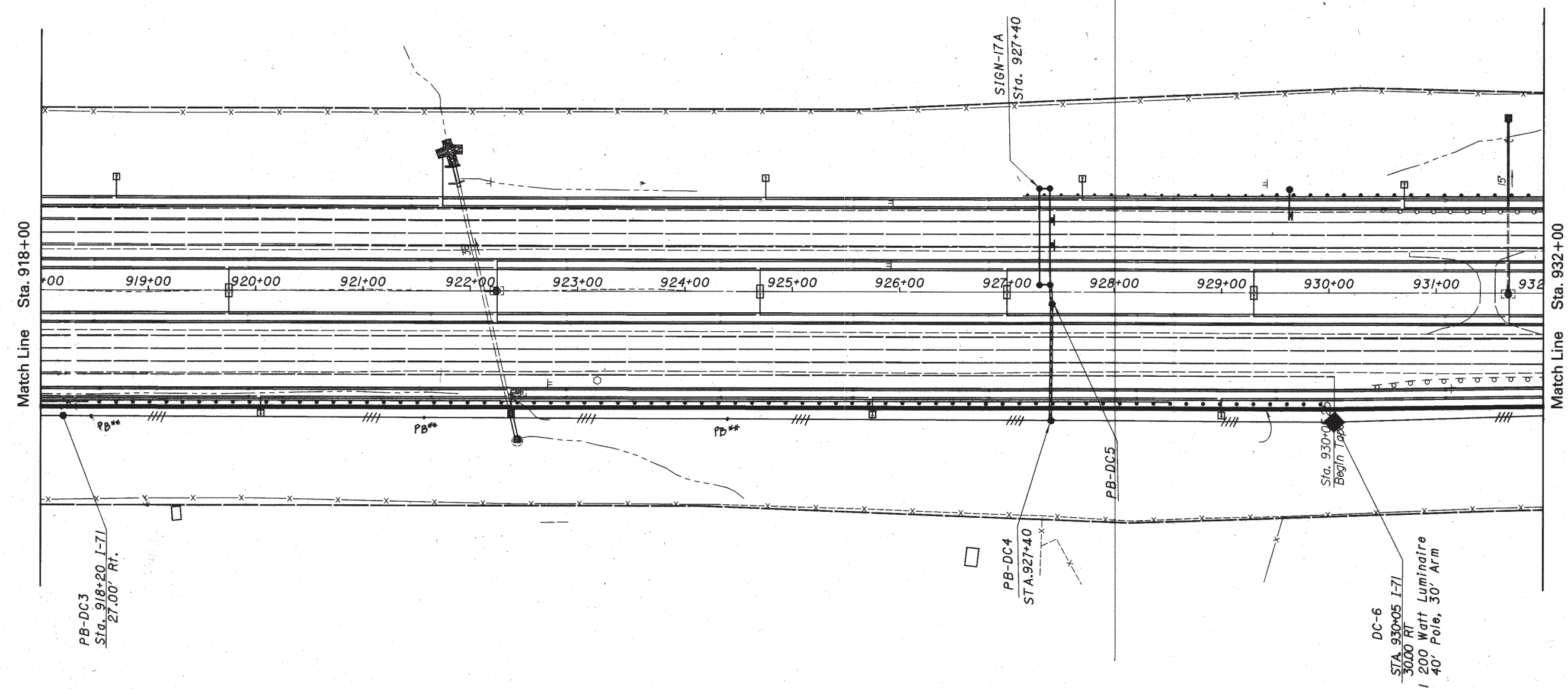

CALCULATED
 CHECKED

0 50 100
 HORIZONTAL
 SCALE IN FEET

S.R. 18 Interchange
 Partial Lighting

MED-71-15.78

626
 940

REF. FILE *1: H:\000_MEL\171\JAN\171\Lighting\000\000\000.dgn
 REF. FILE *1: LEVELS ON: 135, 37, 38, 647
 REF. FILE *2: H:\000_MEL\171\JAN\171\Lighting\000\000\000.dgn
 REF. FILE *2: LEVELS ON: 12, 4, 8, 16, 18, 20, 52, 54, 59, 61, 62, 647

FILE NAME: I:\000_MEL\171\JAN\171\Lighting\000\000\000.dgn
 DATE & TIME: 10-DEC-1999 13:21
 USERNAME: mfox
 PROJECT: NONE

REF. FILE *3: H:\000_MEL\171\JAN\171\Lighting\000\000\000.dgn
 REF. FILE *3: LEVELS ON: 13, 5, 9, 37, 39, 52, 59, 61, 62, 647
 REF. FILE *4: LEVELS ON:
 REF. FILE *4: LEVELS ON:

LEVELS ON: 17, 647
 PREP: TABLE: 171000\Lighting\000\000\000.dgn

NOTES: FOR LEGEND, SEE SHEET 622

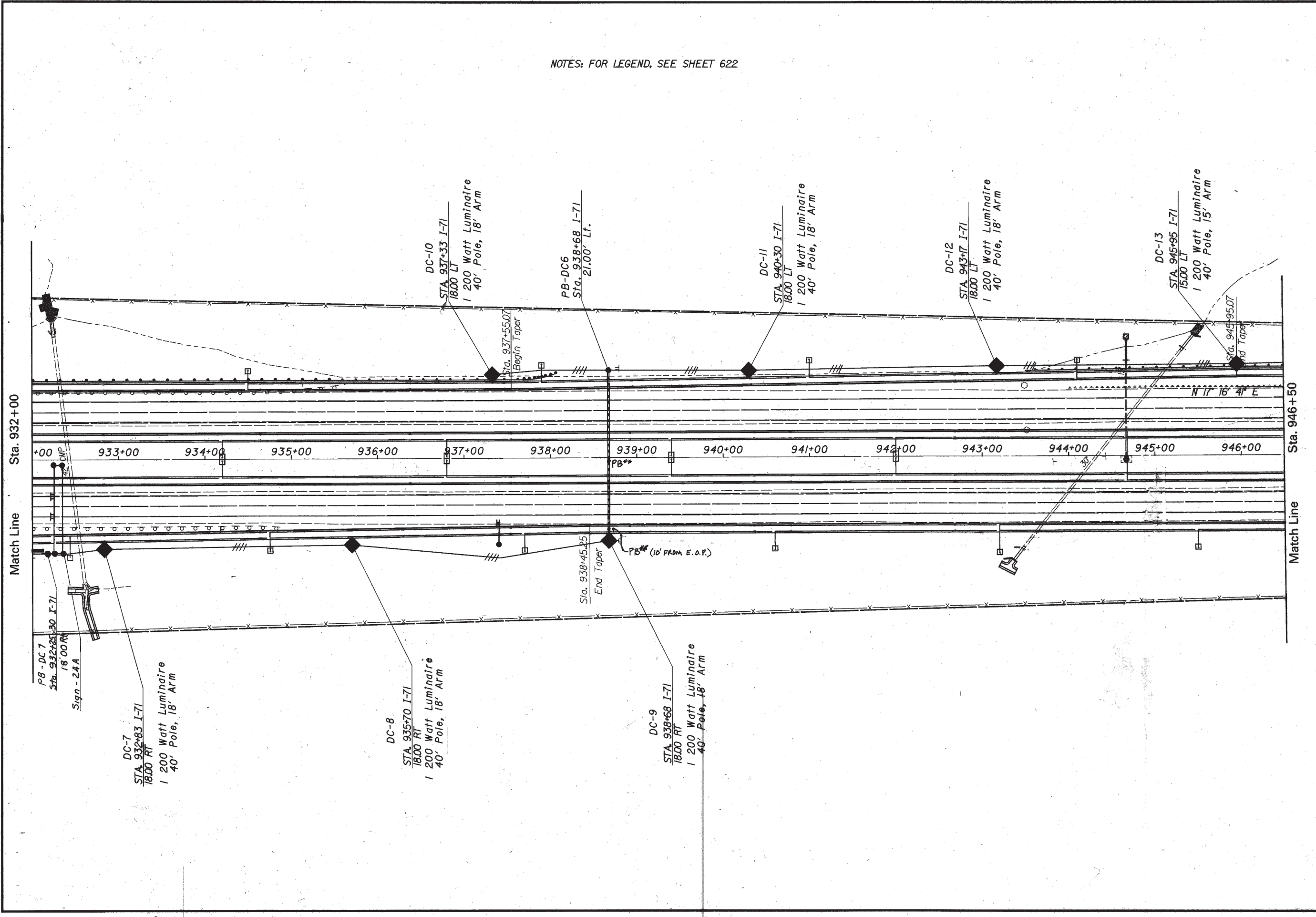

**S. R. 18 Interchange
Partial Lighting**

MED - 71 - 15.78

627
940

CALCULATED
CHECKED

SCALE IN FEET
0 25 50 100
HORIZONTAL

REF. FILE *1\A\A\A\WELL\IT\A\A\A\Lighting\conventional.dgn
 REF. FILE *1\A\A\A\WELL\IT\A\A\A\Lighting\conventional.dgn
 REF. FILE *2\A\A\A\WELL\IT\A\A\A\Lighting\conventional.dgn
 REF. FILE *2\A\A\A\WELL\IT\A\A\A\Lighting\conventional.dgn
 REF. FILE *3\A\A\A\WELL\IT\A\A\A\Lighting\conventional.dgn
 REF. FILE *3\A\A\A\WELL\IT\A\A\A\Lighting\conventional.dgn
 REF. FILE *4\A\A\A\WELL\IT\A\A\A\Lighting\conventional.dgn
 REF. FILE *4\A\A\A\WELL\IT\A\A\A\Lighting\conventional.dgn

FILENAME: I:\A\A\A\WELL\IT\A\A\A\Lighting\conventional.dgn
 DATE & TIME: 10-DEC-1999 13:21
 USERNAME: mfox
 PROJECT: NONE
 LEVELS ON: 1-601
 PLT: I:\A\A\A\WELL\IT\A\A\A\Lighting\conventional.dgn
 PLOT: I:\A\A\A\WELL\IT\A\A\A\Lighting\conventional.dgn
 REIN. TABLE: I:\A\A\A\WELL\IT\A\A\A\Lighting\conventional.dgn

NOTES: FOR LEGEND, SEE SHEET 622

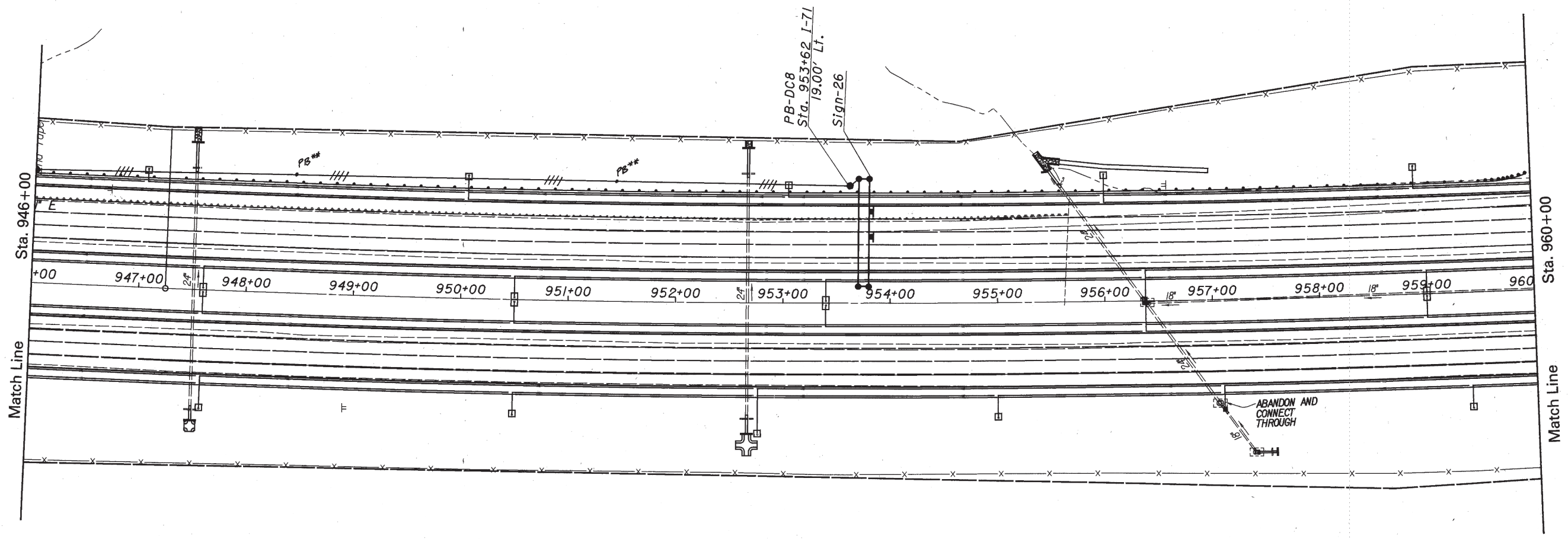

CALCULATED
 CHECKED
 0 50 100
 HORIZONTAL SCALE IN FEET

S.R. 18 Interchange
Partial Lighting

MED-71-15.78

628
940

REF. FILE: 74.1000_0000_1711010000.dgn
 REF. FILE: 74.1000_0000_1711010000.dgn
 REF. FILE: 74.1000_0000_1711010000.dgn
 REF. FILE: 74.1000_0000_1711010000.dgn

REF. FILE: 74.1000_0000_1711010000.dgn
 REF. FILE: 74.1000_0000_1711010000.dgn
 REF. FILE: 74.1000_0000_1711010000.dgn
 REF. FILE: 74.1000_0000_1711010000.dgn

CONTROL CENTER DATA							
CONTROL CENTER	CONNECTED LOAD KVA	SERVICE ENTRANCE CONDUCTOR SIZE-AWG	ENCLOSURE RATING AMPS	CIRCUIT NUMBER	CIRCUIT LOAD AMPS.	CIRCUIT FUSE SIZE AMPS.	MAINTENANCE AGENCY
SR-3							
J	5.11	4	60	A	2.12	30	ODOT
				B	4.01	30	
				C	4.51	30	



NOTE: Structure plans show 2 Inch conduit 1s within the concrete parapet.
 The length of the conduit in the concrete parapet 1s 75.5 feet.
 Where the conduit leaves the structure an expansion sleeve should be Included.
 TWO ADDITIONAL PULL BOXES, 713.08, 24" HAVE BEEN INCLUDED IN THE LIGHTING GENERAL SUMMARY FOR BRIDGE NO. MED-71-2092W WHICH WERE NOT INCLUDED IN THE COMMON STRUCTURE SHEET - ITS CONDUIT DETAILS TABLE ON PAGE 682

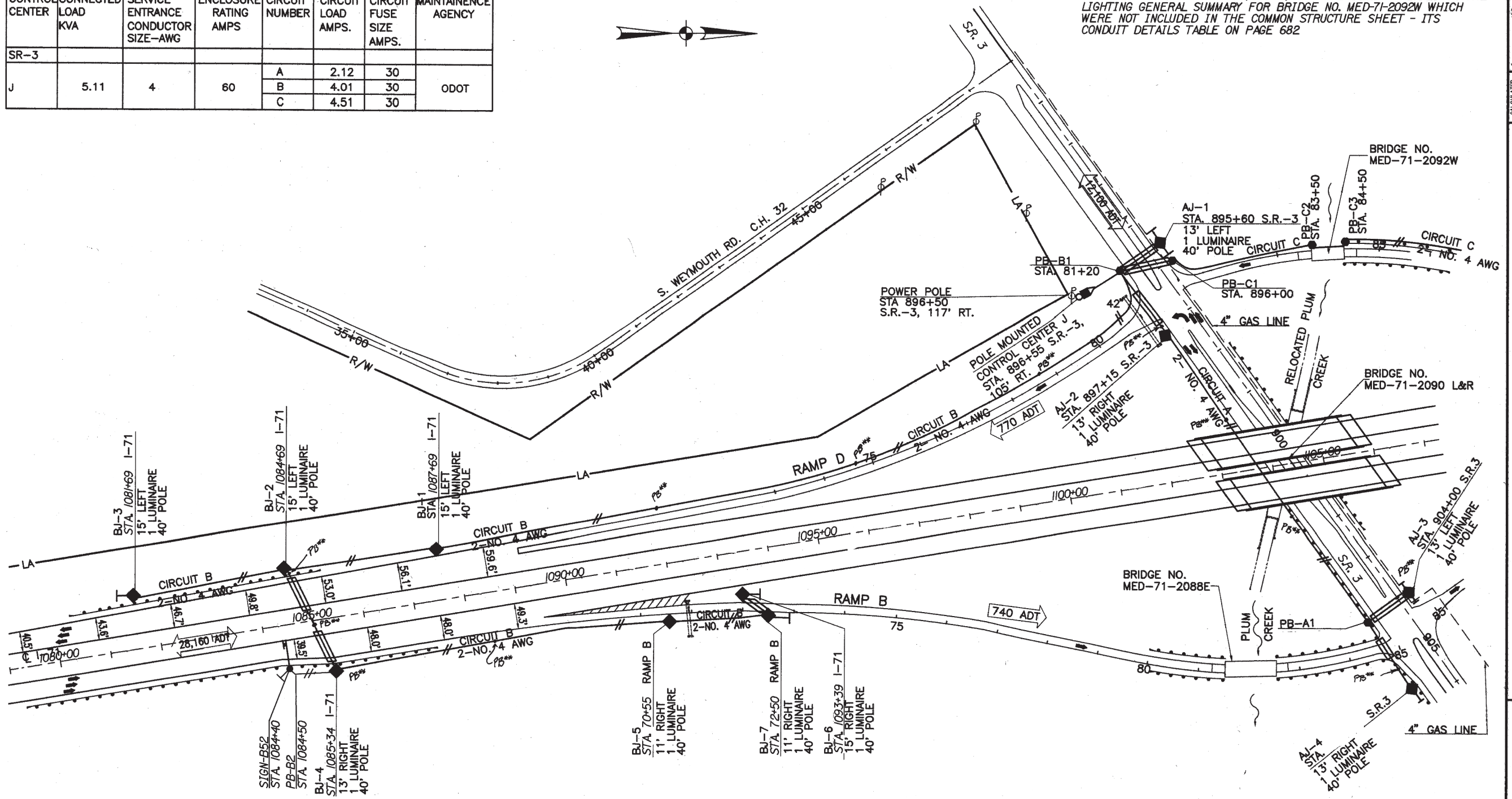

NOTES: FOR LEGEND, SEE SHEET 622.
 2" CONDUIT SHALL BE INSTALLED IN THE RIGHT PARAPET WALL OF BRIDGE NO. MED-71-2088E AND CAPPED AT EACH END OF THE PARAPET. SEE SHEET 682 FOR DETAILS.

Note:
 All references to 2 - No. 4 AWG & 2 - No. 2 AWG
 Shall Be: 3 - No. 4 AWG & 3 - No. 2 AWG

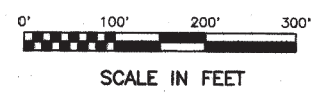

S.R. 3 Interchange
 Partial Lighting

MED-71-15.78

631
 940

FILE NAME: I:\WORK\1711010000\1711010000.dgn
 DATE & TIME: 10-DEC-1999 13:22
 USERNAME: m0x
 PROJECT: NONE

LEVELS ON FILE: 3
 PLOT QUEUED: 1711010000.dgn
 PLOT TABLE: 1711010000.dgn

REF. FILE #1: I:\A.MED.1971\061\Lighting\alignmtdgn
 REF. FILE #1: I:\A.MED.1971\061\Lighting\alignmtdgn
 REF. FILE #2: I:\A.MED.1971\061\Lighting\alignmtdgn
 REF. FILE #3: I:\A.MED.1971\061\Lighting\alignmtdgn

REF. FILE #3: I:\A.MED.1971\061\Lighting\alignmtdgn
 REF. FILE #3: I:\A.MED.1971\061\Lighting\alignmtdgn
 REF. FILE #3: I:\A.MED.1971\061\Lighting\alignmtdgn
 REF. FILE #3: I:\A.MED.1971\061\Lighting\alignmtdgn

FILE NAME: I:\A.MED.1971\061\Lighting\alignmtdgn
 DATE & TIME: 10-DEC-1999 13:24
 USERNAME: mfox
 PROJECT: NONE

LEVELS: ON L52, 54, 60, 62, 64
 PLOT: QUOTE, UNQUOTE
 PEN: TABLE, INDIATOR, OPEN, CROSS, DCE, DCP

NOTE: All stationing refers to mainline I-71 unless otherwise specified.

NOTE: FOR LEGEND, SEE SHEET 622.

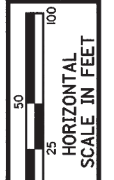
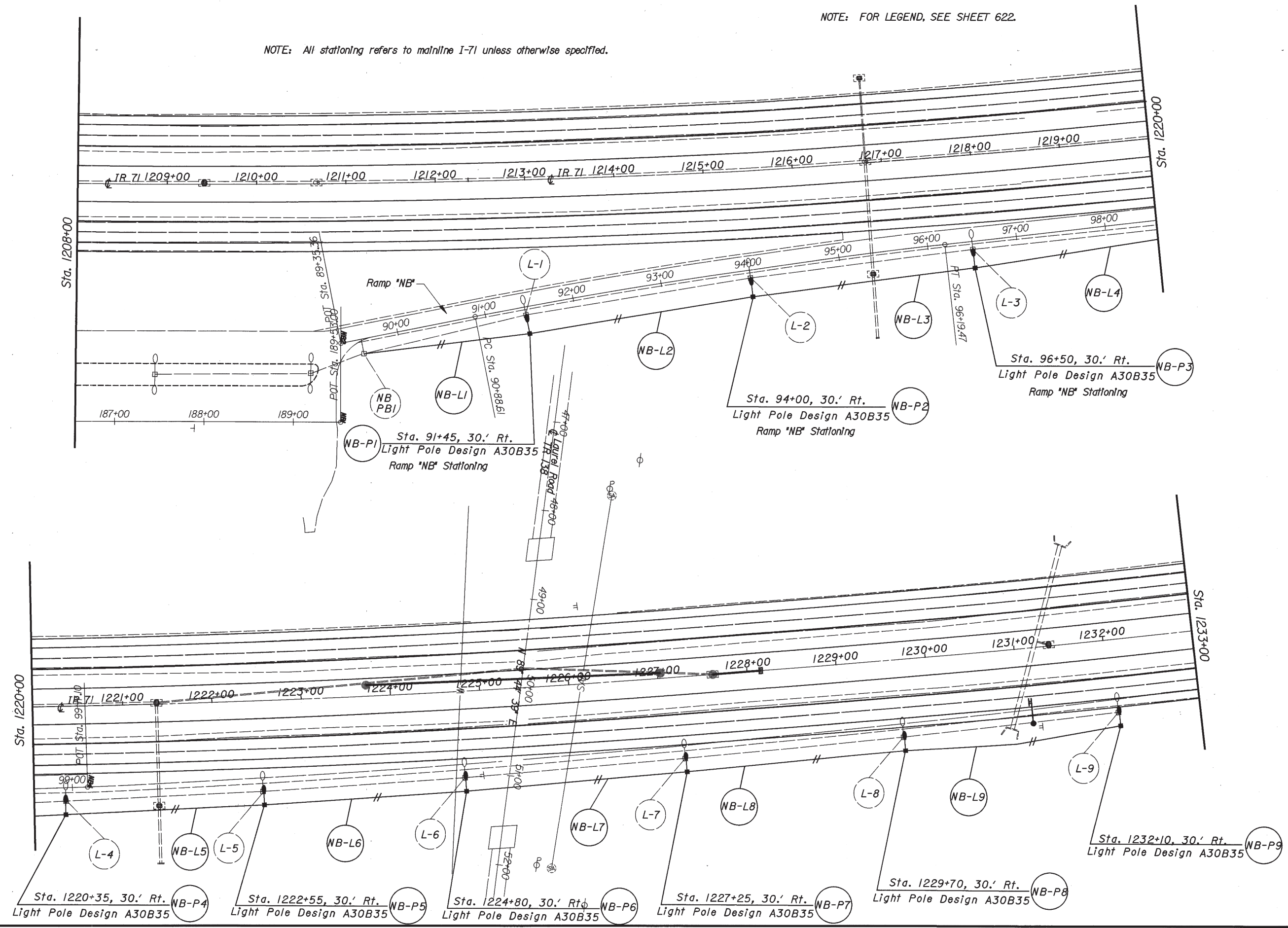

CALCULATED
 CHECKED

N.B. Rest Area Lighting Sheet
 ENTRANCE RAMP

MED - 71 - 15.78

633
 940

REF. FILE: *11000_0001.IT (11/01/00) 000
 REF. FILE: *LEVELS ON 13.5.5.37.39-52.54-57.59.60.64
 REF. FILE: *21000_MED.IT (02/01/00) 000
 REF. FILE: *2 LEVELS ON 137.38.61.64
 REF. FILE: *3 LEVELS ON
 REF. FILE: *4 LEVELS ON
 REF. FILE: *5 LEVELS ON
 REF. FILE: *6 LEVELS ON
 REF. FILE: *7 LEVELS ON
 REF. FILE: *8 LEVELS ON
 REF. FILE: *9 LEVELS ON
 REF. FILE: *10 LEVELS ON
 REF. FILE: *11 LEVELS ON
 REF. FILE: *12 LEVELS ON
 REF. FILE: *13 LEVELS ON
 REF. FILE: *14 LEVELS ON
 REF. FILE: *15 LEVELS ON
 REF. FILE: *16 LEVELS ON
 REF. FILE: *17 LEVELS ON
 REF. FILE: *18 LEVELS ON
 REF. FILE: *19 LEVELS ON
 REF. FILE: *20 LEVELS ON
 REF. FILE: *21 LEVELS ON
 REF. FILE: *22 LEVELS ON
 REF. FILE: *23 LEVELS ON
 REF. FILE: *24 LEVELS ON
 REF. FILE: *25 LEVELS ON
 REF. FILE: *26 LEVELS ON
 REF. FILE: *27 LEVELS ON
 REF. FILE: *28 LEVELS ON
 REF. FILE: *29 LEVELS ON
 REF. FILE: *30 LEVELS ON
 REF. FILE: *31 LEVELS ON
 REF. FILE: *32 LEVELS ON
 REF. FILE: *33 LEVELS ON
 REF. FILE: *34 LEVELS ON
 REF. FILE: *35 LEVELS ON
 REF. FILE: *36 LEVELS ON
 REF. FILE: *37 LEVELS ON
 REF. FILE: *38 LEVELS ON
 REF. FILE: *39 LEVELS ON
 REF. FILE: *40 LEVELS ON
 REF. FILE: *41 LEVELS ON
 REF. FILE: *42 LEVELS ON
 REF. FILE: *43 LEVELS ON
 REF. FILE: *44 LEVELS ON
 REF. FILE: *45 LEVELS ON
 REF. FILE: *46 LEVELS ON
 REF. FILE: *47 LEVELS ON
 REF. FILE: *48 LEVELS ON
 REF. FILE: *49 LEVELS ON
 REF. FILE: *50 LEVELS ON
 REF. FILE: *51 LEVELS ON
 REF. FILE: *52 LEVELS ON
 REF. FILE: *53 LEVELS ON
 REF. FILE: *54 LEVELS ON
 REF. FILE: *55 LEVELS ON
 REF. FILE: *56 LEVELS ON
 REF. FILE: *57 LEVELS ON
 REF. FILE: *58 LEVELS ON
 REF. FILE: *59 LEVELS ON
 REF. FILE: *60 LEVELS ON
 REF. FILE: *61 LEVELS ON
 REF. FILE: *62 LEVELS ON
 REF. FILE: *63 LEVELS ON
 REF. FILE: *64 LEVELS ON
 REF. FILE: *65 LEVELS ON
 REF. FILE: *66 LEVELS ON
 REF. FILE: *67 LEVELS ON
 REF. FILE: *68 LEVELS ON
 REF. FILE: *69 LEVELS ON
 REF. FILE: *70 LEVELS ON
 REF. FILE: *71 LEVELS ON
 REF. FILE: *72 LEVELS ON
 REF. FILE: *73 LEVELS ON
 REF. FILE: *74 LEVELS ON
 REF. FILE: *75 LEVELS ON
 REF. FILE: *76 LEVELS ON
 REF. FILE: *77 LEVELS ON
 REF. FILE: *78 LEVELS ON
 REF. FILE: *79 LEVELS ON
 REF. FILE: *80 LEVELS ON
 REF. FILE: *81 LEVELS ON
 REF. FILE: *82 LEVELS ON
 REF. FILE: *83 LEVELS ON
 REF. FILE: *84 LEVELS ON
 REF. FILE: *85 LEVELS ON
 REF. FILE: *86 LEVELS ON
 REF. FILE: *87 LEVELS ON
 REF. FILE: *88 LEVELS ON
 REF. FILE: *89 LEVELS ON
 REF. FILE: *90 LEVELS ON
 REF. FILE: *91 LEVELS ON
 REF. FILE: *92 LEVELS ON
 REF. FILE: *93 LEVELS ON
 REF. FILE: *94 LEVELS ON
 REF. FILE: *95 LEVELS ON
 REF. FILE: *96 LEVELS ON
 REF. FILE: *97 LEVELS ON
 REF. FILE: *98 LEVELS ON
 REF. FILE: *99 LEVELS ON
 REF. FILE: *100 LEVELS ON

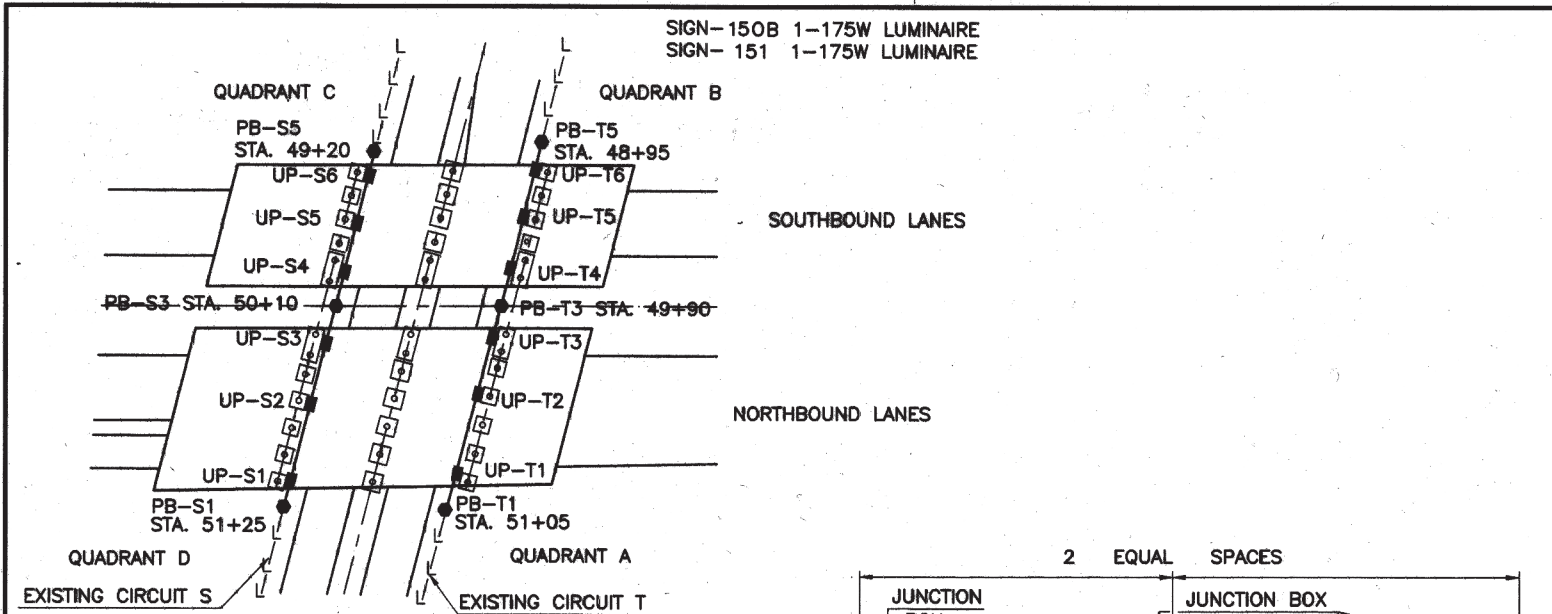

PROPOSED UNDERPASS LIGHTING PLAN

Note:
 All references to 2 - No. 4 AWG &
 2 - No. 2 AWG

Shall Be:
 3 - No. 4 AWG &
 3 - No. 2 AWG

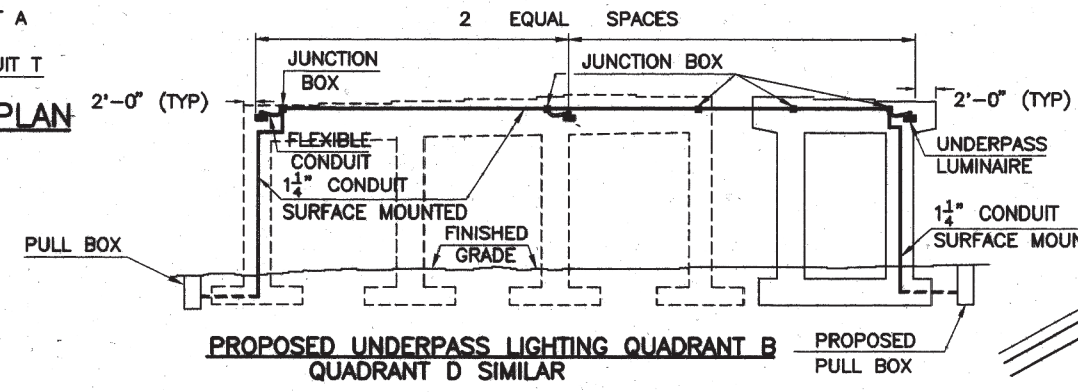

NOTE: 1-1/4" CONDUIT TO BRIDGE MOUNTED SIGN SHALL BE MOUNTED TO BOTTOM OF BRIDGE DECK.

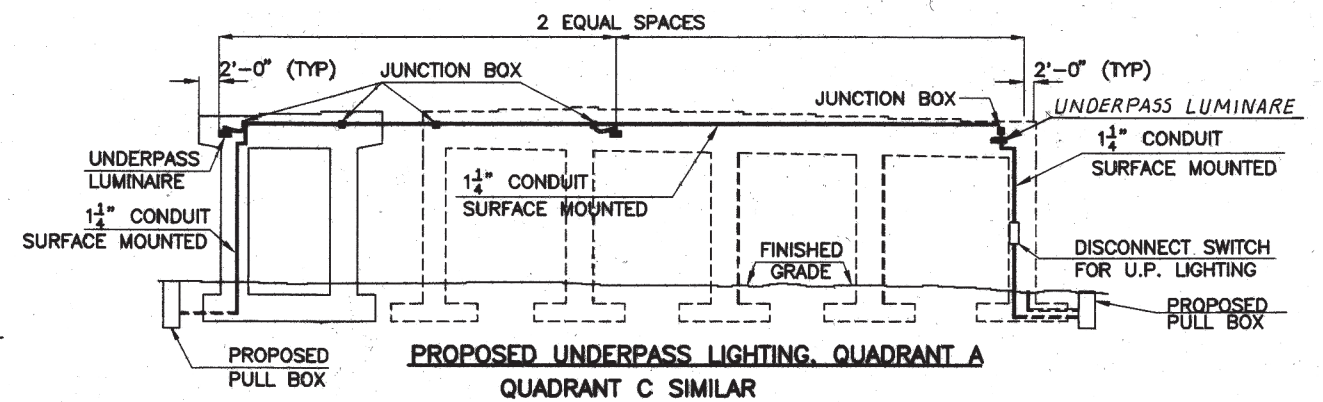

NOTE: S.R. 303 CIRCUITS S AND T SHALL REMAIN IN PLACE AND ALL LIGHTS DESIGNATED FOR REMOVAL SHALL BE REMOVED. THE UNDERPASS LIGHTING WILL BE ADDED TO S.R.303 CIRCUITS S AND T. ALL LIGHT POLE FOUNDATIONS SHALL BE REMOVED 4 FEET BELOW FINISHED GRADE. PAYMENT SHALL BE INCLUDED WITH ITEM 202, LIGHT POLE FOUNDATION REMOVED AND A ITEM 625, CABLE SPLICING KIT PROVIDED TO COMPLETE THE CIRCUIT.

FOR ADDITIONAL NOTES SEE SHEET 634.
 FOR LEGEND SEE SHEET 622.

NOTE: ALL EXISTING SIGN LIGHTING COMPONENTS SHALL BE REMOVED.

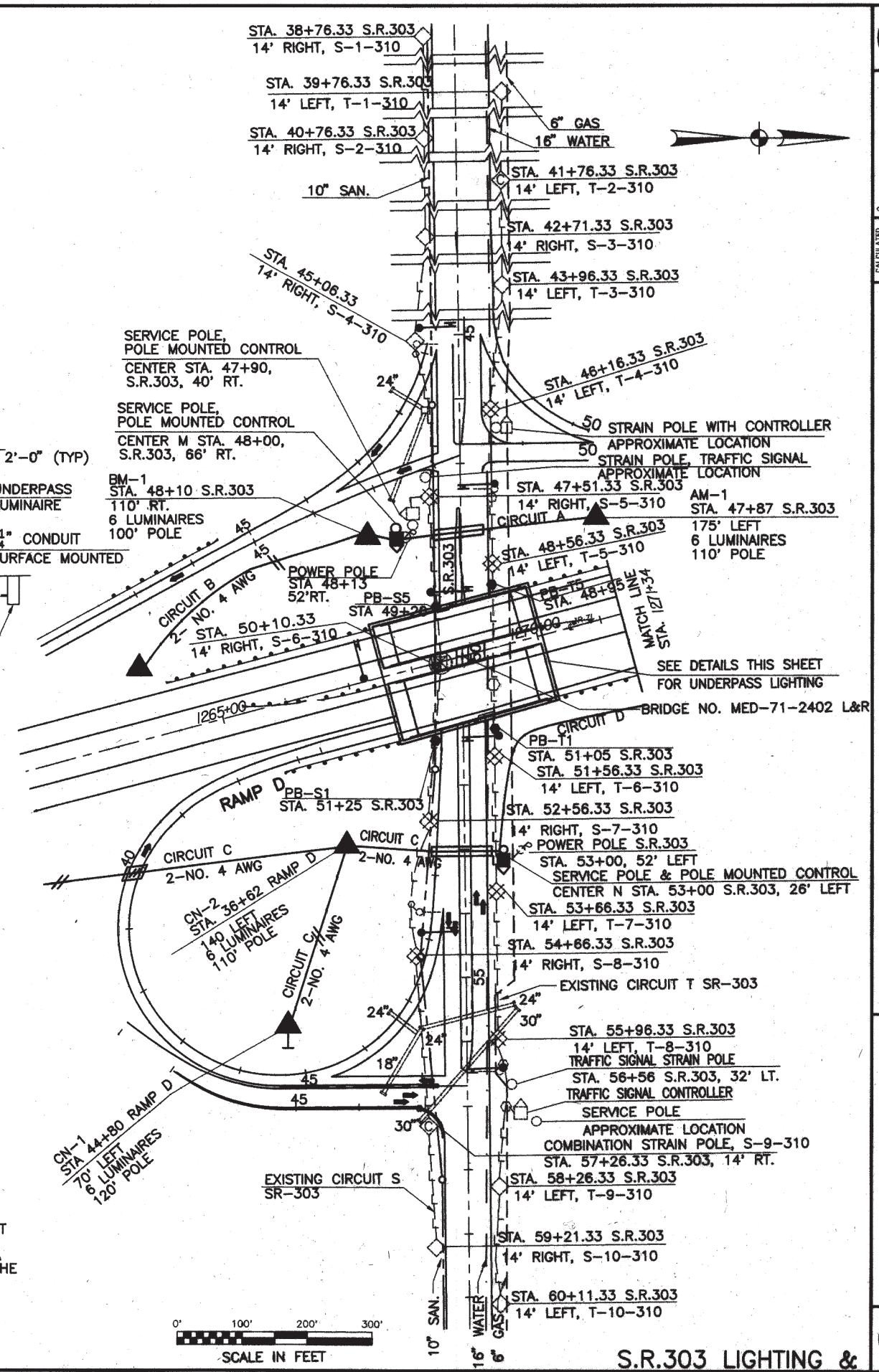

N

HORIZONTAL SCALE IN FEET

CALCULATED CHECKED

S.R. 303 Lighting and Underpass Lighting

MED-71-15.78

636
940

**S.R.303 LIGHTING &
 UNDERPASS LIGHTING**

