

# STATE OF OHIO DEPARTMENT OF HIGHWAYS POR-5-898

MICROFILMED  
AUG 28 1975  
REPRODUCTION

FED. RD. DIVISION	STATE	PROJECT	1 293
2	OHIO	STATE	

PORTAGE COUNTY  
POR-5-8.98

Project designation POR-5 (8.98-9.59) appearing throughout this Plan shall be considered to read POR-5-8.98.

## PORTAGE COUNTY ROOTSTOWN & RAVENNA TOWNSHIPS GRADE SEPARATION WITH THE B. & O. RAILROAD GRADE SEPARATION WITH THE PENNSYLVANIA RAILROAD CITY OF RAVENNA

**LIMITED ACCESS**  
This improvement has been declared a Limited Access Highway or Freeway by act of the Director of Highways in accordance with the provisions of Section 5511.02, Revised Code of Ohio, and is especially designed for through traffic.

**1965 SPECIFICATIONS**

The Standard Specifications of the State of Ohio, Department of Highways, including changes and supplemental specifications listed in the proposal shall govern this improvement.

The Right of Way for this improvement will be provided by the State of Ohio.

Hereby approve these plans and declare that the making of this improvement will not require the closing of the Highway to traffic and that provisions for the maintenance and safety of traffic will be as set forth on the plans and estimates.

- Approved *William M. Hubbard*  
Date 3-31-67 Division Deputy Director
- Approved *C. N. Albrecht*  
Date 2-18-65 Engineer of Bridges
- Approved *W. R. Pickett*  
Date 6-21-65 Engineer of Location & Design
- Approved *R. E. Shultz*  
Date 6-21-65 Deputy Director of Design & Construction
- Approved *T. H. Borne*  
Date 6-23-65 Deputy Director of Right of Way
- Approved *J. W. Wilson*  
Date 6-23-65 Deputy Director of Planning & Programming
- Approved \_\_\_\_\_  
Date \_\_\_\_\_ First Assistant Director
- Approved *R. E. Mashuta*  
Date 6-23-65 Director of Highways

**CONVENTIONAL SIGNS**

State Line	-----
County Line	-----
Township Line	-----
Section Line	-----
Center Line	-----
Corporation Line	-----
Fence Line	-----
Guard Rail (Existing)	-----
Guard Rail (Proposed)	-----
Railroad	-----
Power Poles	-----
Telephone Poles	-----
Trees or Stumps	-----
Trees or Stumps (To be Removed)	-----

**INDEX OF SHEETS**

Title Sheet	1
Location Map	2-3
Typical Sections	4-11
Details	12-14, 14A
General Notes	15-16
Calculations	17
Recapitulation & General Summary	18, 19, 19A, 20, 20A, 20B, 20C, 20D, 20E *
S.R. 44 Interchange	21-60
S.R. 5 Plan & Profile	61-77
Two to Four Lane Transition Detail	77A
Superelevation Tables	78
Cross Sections	79-116
Side Road Superelevation Tables	117
Sandy Lake Road	118-121
Hayes Road	122-123
Lake Street	124-125
New Milford Road	130-132
S.R. 14 Interchange	133, 133A-177
S.R. 5 Intersection	178, 178A-197
Riddle Road	198-203
Structures 20' Span & Under	204-222
Structures Over 20' Span	223-227
Right of Way	228-229

\* Sheets 20D & 20E have been added to revise this plan to 1965 Specifications.

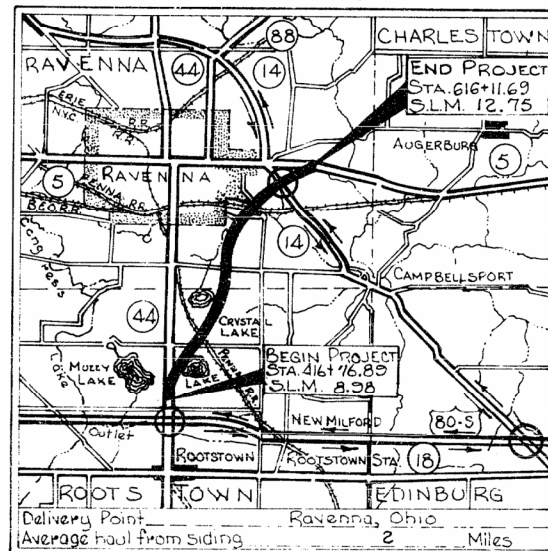

Portion to be improved  
State Roads  
Other Roads  
Outlets

**SCALES**

Plan & Profile 1" = 50' or 1" = 20'  
Cross Sections 1" = 10' or 1" = 5'

\* See Sheet No 12 for lists of 1963 Standard Drawings and Supplemental Specifications and the 1965 Standard Drawings and Supplemental Specifications which have superseded them.

* SUPPLEMENTAL PRINTS OF STANDARD CONSTRUCTION DRAWINGS						* SUPPLEMENTAL SPECIFICATIONS	
BP-6	6-1-65	C.B. 2-3 & 2-4	6-1-65	MC-6	6-1-65	SD 1-63 (shs 1, 2, 3 & 4)	11-12-63
MC-1	6-1-65	C.B. 2-2-A & B	6-1-65	MC-3	6-1-65	SD 2-64	11-25-64
BP-5	6-1-65	C.B. - 8	6-1-65	BP-1	6-1-65	FSB-1-62	1-15-63
L-1	6-1-65	C.B. - 6	6-1-65	SP-53	6-30-61	FR-1-65 (Sht. 1)	2-1-65
		M.H. - 1	6-1-65	AS-1-54	8-10-65	CSB 4-63 (sh 1)	12-30-63
		M.H. - 2	6-1-65	F-1	6-1-65		
BP-2	6-1-65	BP-7	6-1-65	F-3	6-1-65		811 3-29-65
BP-3	6-1-65	MC-5	6-1-65	HW-E	6-1-65		814 8-24-65
BP-4	6-1-65	GR-1	6-1-65	GR-5-B	6-1-65		
MC-4	6-1-65	GR-2A	9-1-65	GR-6	6-1-65		807 9-2-65
MH-1A	6-1-65						806 9-2-65

File No PORTAGE COUNTY POR-5-8.98  
Date of Letting \_\_\_\_\_ 196  
Contract No \_\_\_\_\_

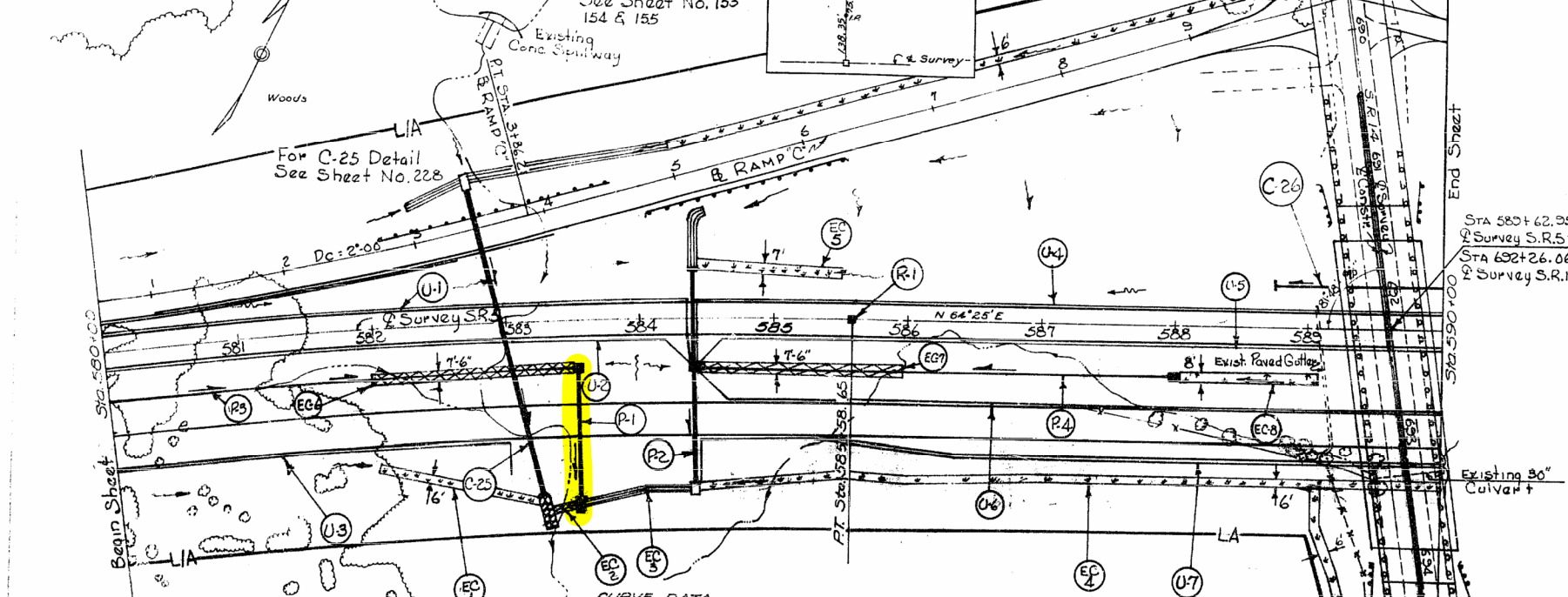

CURVE DATA  
 P.I. Sta 569+16.06  
 Δ = 46°31'  
 R = 120'  
 L = 4297.10'  
 ΔE = 1846.98'  
 ΔS = 3429.75'  
 ΔT = 390.11'

For S.R. 14 Details  
 See Sheet No. 133-137.

B.M. #20 R.R. Spike in S. Side 28' Maple 169' Lt. of Sta 584+25 Elev. 1103.804  
 B.M. #21 N.E. Corner bottom step to house 50' Lt. Sta 695+86 SR14 Elev. 1099.691

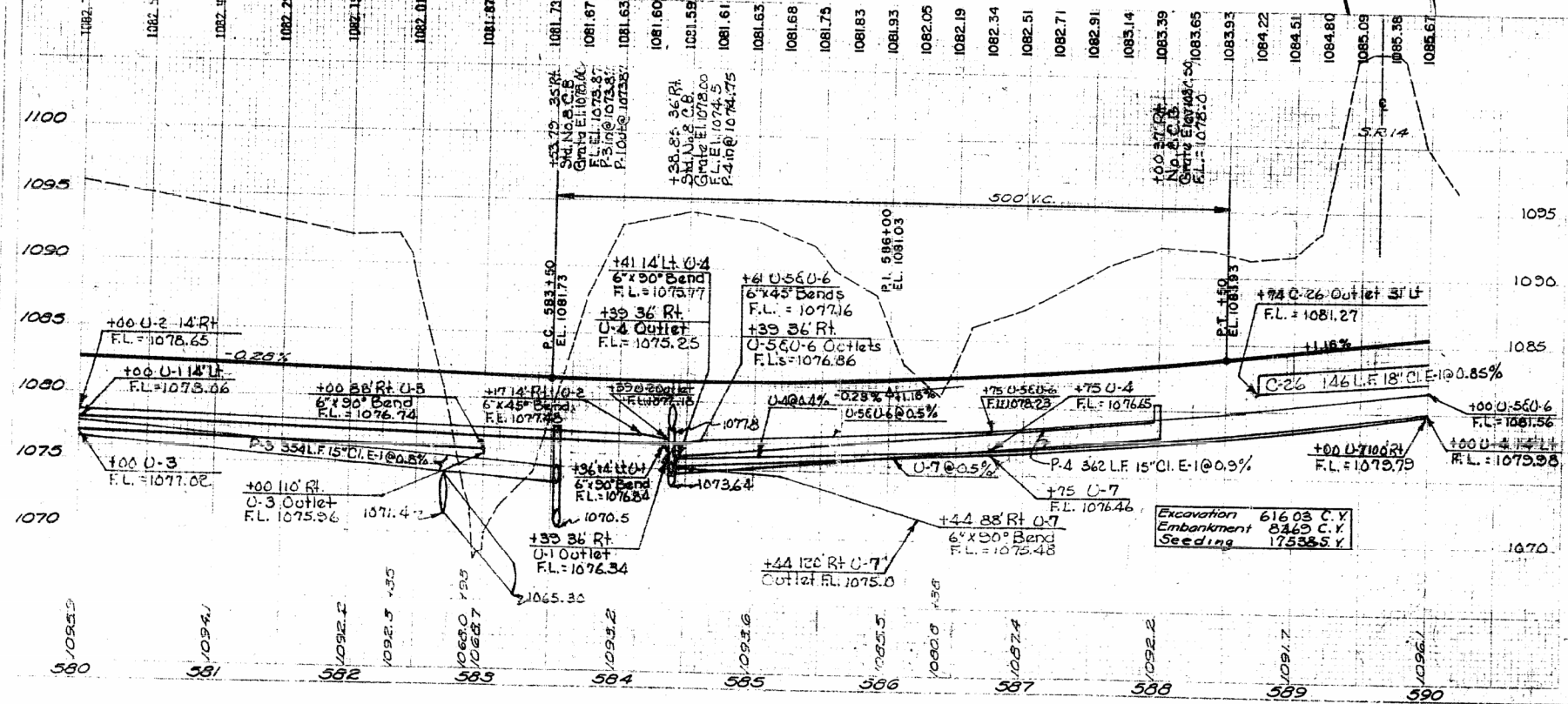

Excavation 616.03 C.Y.  
 Embankment 836.0 C.Y.  
 Seeding 17535.5 Y.

REF. NO.	STATION TO STATION	SID.	ESTIMATED QUANTITIES			
			Excavation	Embankment	Seeding	Other
C-25	580+00 to 580+10	RT	0.10	0.00	0.00	
U-3	580+10 to 580+20	RT	0.10	0.00	0.00	
U-4	580+20 to 580+30	RT	0.10	0.00	0.00	
U-5	580+30 to 580+40	RT	0.10	0.00	0.00	
U-6	580+40 to 580+50	RT	0.10	0.00	0.00	
U-7	580+50 to 580+60	RT	0.10	0.00	0.00	
C-26	580+60 to 580+70	RT	0.10	0.00	0.00	
U-1	580+70 to 580+80	RT	0.10	0.00	0.00	
U-2	580+80 to 580+90	RT	0.10	0.00	0.00	
U-3	580+90 to 580+100	RT	0.10	0.00	0.00	
U-4	580+100 to 580+110	RT	0.10	0.00	0.00	
U-5	580+110 to 580+120	RT	0.10	0.00	0.00	
U-6	580+120 to 580+130	RT	0.10	0.00	0.00	
U-7	580+130 to 580+140	RT	0.10	0.00	0.00	
C-26	580+140 to 580+150	RT	0.10	0.00	0.00	
U-1	580+150 to 580+160	RT	0.10	0.00	0.00	
U-2	580+160 to 580+170	RT	0.10	0.00	0.00	
U-3	580+170 to 580+180	RT	0.10	0.00	0.00	
U-4	580+180 to 580+190	RT	0.10	0.00	0.00	
U-5	580+190 to 580+200	RT	0.10	0.00	0.00	
U-6	580+200 to 580+210	RT	0.10	0.00	0.00	
U-7	580+210 to 580+220	RT	0.10	0.00	0.00	
C-26	580+220 to 580+230	RT	0.10	0.00	0.00	
U-1	580+230 to 580+240	RT	0.10	0.00	0.00	
U-2	580+240 to 580+250	RT	0.10	0.00	0.00	
U-3	580+250 to 580+260	RT	0.10	0.00	0.00	
U-4	580+260 to 580+270	RT	0.10	0.00	0.00	
U-5	580+270 to 580+280	RT	0.10	0.00	0.00	
U-6	580+280 to 580+290	RT	0.10	0.00	0.00	
U-7	580+290 to 580+300	RT	0.10	0.00	0.00	

94 360 3 284 160 132 146 193 50 20 56 1555 716 4 3 1 19 250

Seeding  
End  
Width  
140  
120  
100  
80  
60  
40  
20  
0  
20  
40  
60  
80  
100  
120  
140

PORTAGE COUNTY  
P. 5 (8.98-9.59)

End Area	CU	Vol.
Cut	Fill	Cut

172  
735  
169  
783  
136  
768  
121

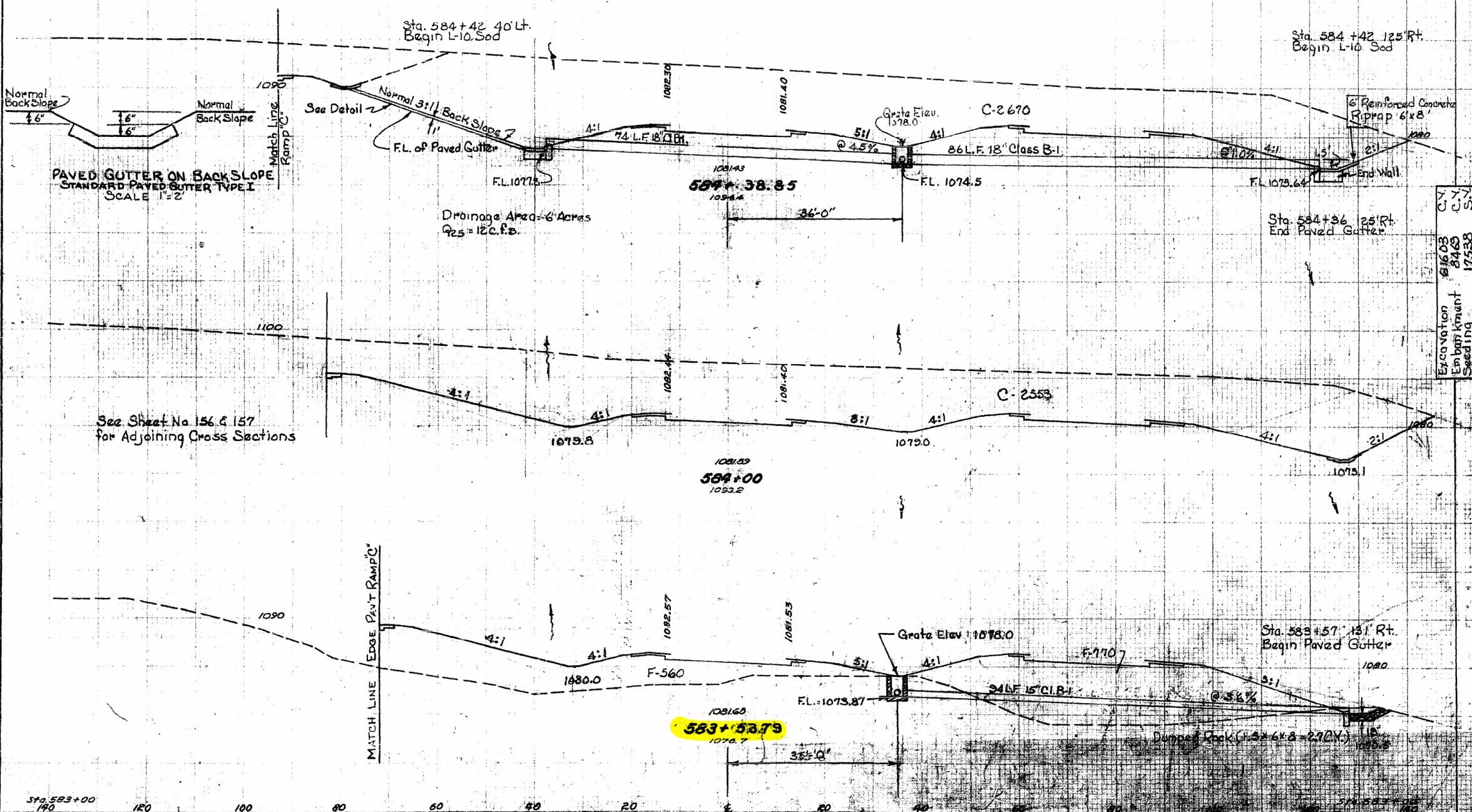

Excavation  
Embankment  
Seeding  
777  
616.03  
2429  
17538

583+53.79

See Sheet No. 156 & 157  
for Adjoining Cross Sections

PAVED GUTTER ON BACK SLOPE  
STANDARD PAVED GUTTER TYPE I  
SCALE 1"=2'

Drainage Area = 6 Acres  
Q<sub>25</sub> = 12 c.f.s.

Sta. 584+42.125 RT.  
Begin L-10 Sod

Sta. 584+36.25 RT.  
End Paved Gutter

Sta. 583+57.131 RT.  
Begin Paved Gutter

Sta. 583+00

Sta. 584+100