

STATE OF OHIO DEPARTMENT OF TRANSPORTATION

D05-CUL-FY2024

VARIOUS TOWNSHIPS

FAIRFIELD, GUERNSEY, LICKING,
MUSKINGUM & PERRY COUNTIES

FEDERAL PROJECT NUMBER

E200711

RAILROAD INVOLVEMENT

NONE

PROJECT DESCRIPTION

CULVERT REHABILITATION AT VARIOUS LOCATIONS IN FAIRFIELD, GUERNSEY, LICKING, MUSKINGUM & PERRY COUNTIES. SEE PLAN SHEETS FOR INDIVIDUAL SITE WORK DESCRIPTIONS.

EARTH DISTURBED AREAS

PROJECT EARTH DISTURBED AREA: 4.6 ACRES
ESTIMATED CONTRACTOR EARTH DISTURBED AREA: N/A
NOTICE OF INTENT EARTH DISTURBED AREA: N/A (NOI NOT REQUIRED)*

* ROUTINE MAINTENANCE PROJECT

LIMITED ACCESS

THIS IMPROVEMENT IS ESPECIALLY DESIGNED FOR THROUGH TRAFFIC AND HAS BEEN DECLARED A LIMITED ACCESS HIGHWAY OR FREEWAY BY ACTION OF THE DIRECTOR IN ACCORDANCE WITH THE PROVISIONS OF SECTION 5511.02 OF THE OHIO REVISED CODE.

2023 SPECIFICATIONS

THE STANDARD SPECIFICATIONS OF THE STATE OF OHIO, DEPARTMENT OF TRANSPORTATION, INCLUDING SUPPLEMENTAL SPECIFICATIONS LISTED IN THE PLANS, CHANGES LISTED IN THE PROPOSAL, AND THE SUPPLEMENTAL SPECIFICATION 800 VERSION INDICATED ON THE PROPOSAL SHALL GOVERN THIS IMPROVEMENT.

I HEREBY APPROVE THESE PLANS AND DECLARE THAT THE MAKING OF THIS IMPROVEMENT WILL NOT REQUIRE THE CLOSING TO TRAFFIC OF THE HIGHWAY AND THAT PROVISIONS FOR THE MAINTENANCE AND SAFETY OF TRAFFIC WILL BE AS SET FORTH ON THE PLANS AND ESTIMATES.

Jason L. Sturgeon
Jason L. Sturgeon, P.E.
District 05 Deputy Director

Jack Marchbanks
Jack Marchbanks, PhD
Director, Department of Transportation



LATITUDE: 39° 57' 06" LONGITUDE: 82° 24' 41"



PORTION TO BE IMPROVED	—————	—————
INTERSTATE HIGHWAY	—————	—————
FEDERAL ROUTES	—————	—————
STATE ROUTES	—————	—————
COUNTY & TOWNSHIP ROADS	—————	—————
OTHER ROADS	—————	—————

DESIGN DESIGNATION
FOR DESIGN DESIGNATION INFORMATION, SEE SHEET 2

DESIGN EXCEPTIONS

NONE

ADA DESIGN WAIVERS

NONE REQUIRED

UNDERGROUND UTILITIES
Contact Two Working Days
Before You Dig

OHIO811.org
Before You Dig

OHIO811, 8-1-1, or 1-800-362-2764
(Non members must be called directly)

PLAN PREPARED BY:
ODOT DISTRICT 5 PLANNING & ENGINEERING
9600 JACKSONTOWN ROAD SE
JACKSONTOWN, OH 43030

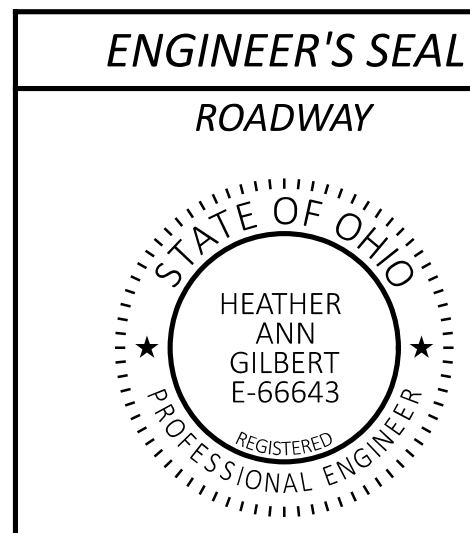

INDEX OF SHEETS:

TITLE SHEET	1
LOCATION MAP	2
GENERAL NOTES	3-11
GENERAL SUMMARY	12
SUBSUMMARIES	13-14
PLAN SHEETS	15-30
CULVERT DETAIL SHEETS	31-47

STANDARD CONSTRUCTION DRAWINGS				SUPPLEMENTAL SPECIFICATIONS	SPECIAL PROVISIONS
F-2.1	7/20/18	DM-4.3	1/15/16	800 10/20/23	WATERWAY
F-3.3	7/19/13	DM-4.4	1/15/16	832 7/21/23	PERMITS
F-3.4	7/19/13			833 7/21/23	CONDITIONS
				837 1/20/23	2/22/2024
				899 1/20/23	
RM-4.2	4/17/20				
MT-95.30	7/19/19				
MT-95.45	7/21/23				
MT-95.50	7/21/17				
MT-97.10	4/19/19				
MT-101.70	4/21/23				
MT-101.75	7/21/23				
MT-105.10	1/17/20				

D05-CUL-FY2024

MODEL: Sheet PAPER: 34x22 (in.) DATE: 3/4/2024 TIME: 11:01:47 AM USER: hglbar1 pvc:\ohiodot-pw-bentley.com\ohiodot-pw-02\Documents\01 Active Projects\District 05_D05107367400-Engineering\Roadway\Sheets\107367_GT001.dgn

SHEET TITLE

DESIGN AGENCY



DESIGNER
HG

REVIEWER

XXX MM-DD-YY

PROJECT ID

107367

SHEET TOTAL

P.01 | 47

*** DO NOT PLACE ANY TEMPORARY OR PERMANENT FILL WITHIN THE JURISDICTIONAL BOUNDARY WETLAND D DURING CONSTRUCTION OF THIS PROJECT, INCLUDING SCAFFOLDING OR BRACING. DO NOT PLACE ANY EQUIPMENT OR MATERIALS WITHIN THE JURISDICTIONAL BOUNDARY OF WETLAND D.**

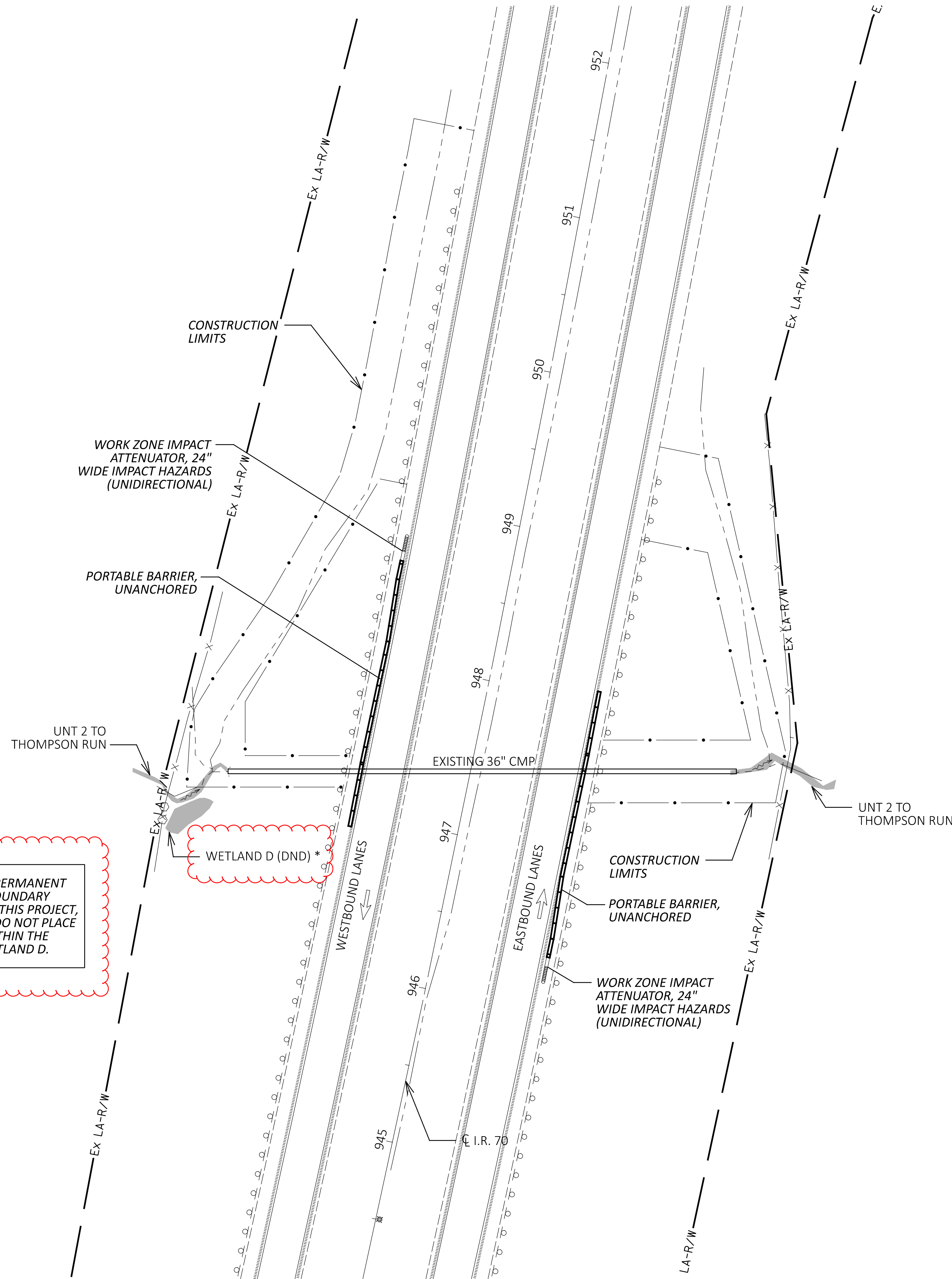

PROJECT DESCRIPTION:
 REHABILITATION OF AN EXISTING 36" CMP
 BY USE OF A CURED-IN-PLACE LINER

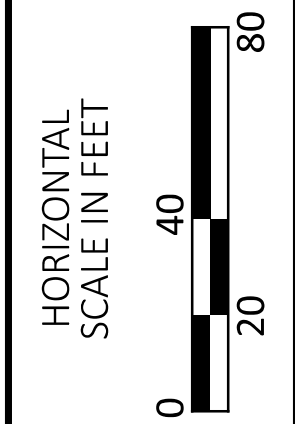
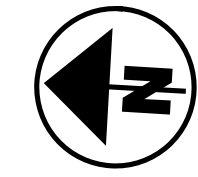

**PLAN SHEET (LOCATION 10)
 MUS-70-4.05 (CFN 1879309)**

ITEM 202 GUARDRAIL REMOVED FOR REUSE	50 FT
ITEM 606 GUARDRAIL REBUILT, TYPE 5	50 FT
ITEM 614 BARRIER REFLECTOR, TYPE 1, (1WAY)	10 EACH
ITEM 614 OBJECT MARKER, ONE WAY	10 EACH
ITEM 614 WORK ZONE IMPACT ATTENUATOR, 24" WIDE HAZARDS, (UNIDIRECTIONAL)	2 EACH
ITEM 622 PORTABLE BARRIER, UNANCHORED	344 FT

QUANTITIES CARRIED TO SUBSUMMARY

DESIGN AGENCY



DESIGNER

HG

REVIEWER

XXX MM-DD-YY

PROJECT ID

107367

SHEET TOTAL

P.24 47

* NOTE:
 DO NOT PLACE ANY TEMPORARY
 OR PERMANENT FILL WITHIN THE
 DITCH 3 FROM STA. 1147+50 TO
 STA. 1151+50

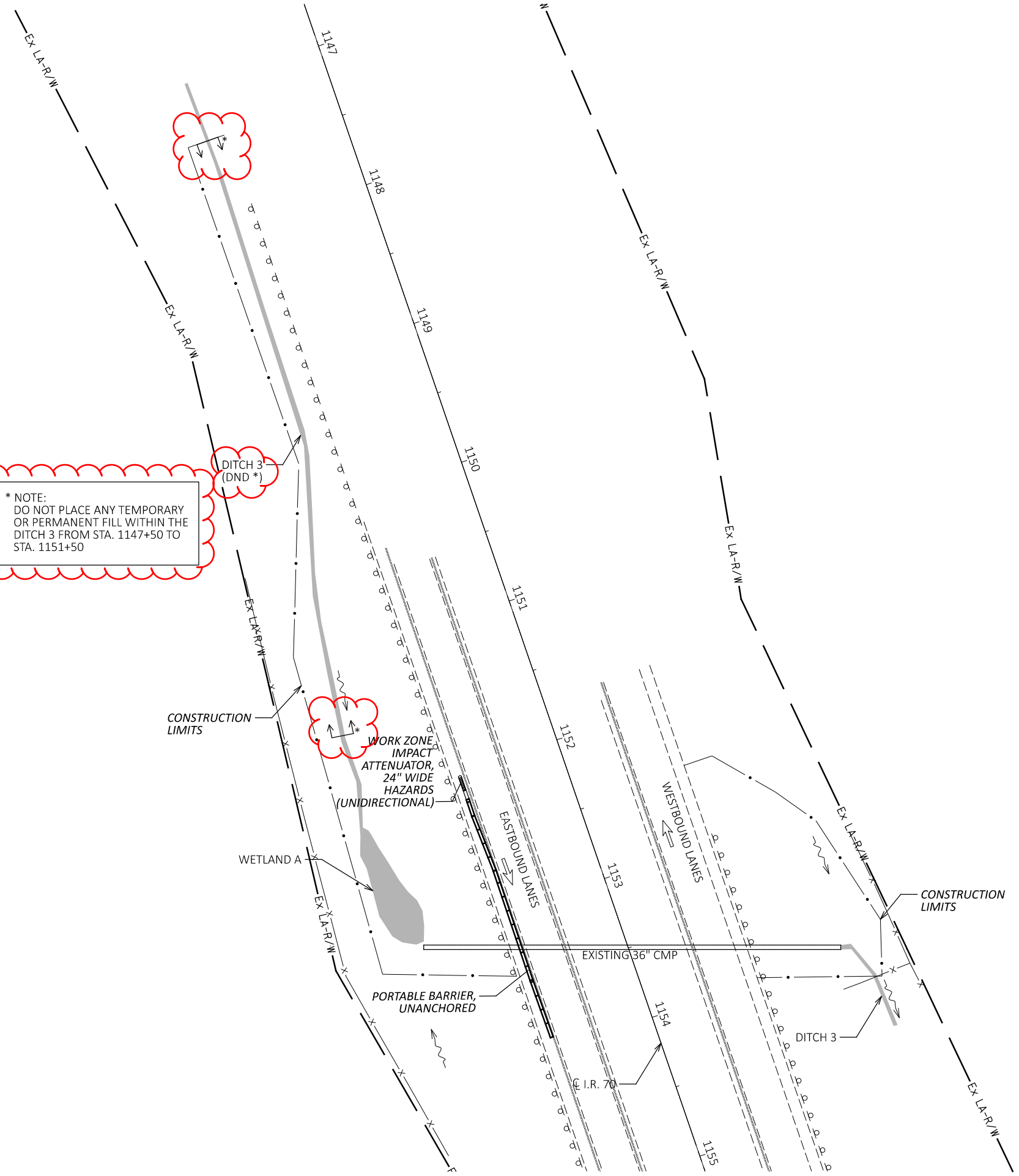

PROJECT DESCRIPTION:
 REHABILITATION OF AN EXISTING 36" CMP
 BY USE OF A CURED-IN-PLACE LINER

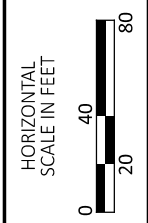

PLAN SHEET (LOCATION 12)
 MUS-70-7.942 (CFN 1828850)

ITEM 202 GUARDRAIL REMOVED FOR REUSE	25 FT
ITEM 606 GUARDRAIL REBUILT, TYPE 5	25 FT
ITEM 614 BARRIER REFLECTOR, TYPE 1, (1WAY)	5 EACH
ITEM 614 OBJECT MARKER, ONE WAY	5 EACH
ITEM 614 WORK ZONE IMPACT ATTENUATOR, 24" WIDE HAZARDS, (UNIDIRECTIONAL)	1 EACH
ITEM 622 PORTABLE BARRIER, UNANCHORED	172 FT

QUANTITIES CARRIED TO SUBSUMMARY

DESIGN AGENCY



DESIGNER
 HG

REVIEWER
 XXX MM-DD-YY

PROJECT ID
 107367

SHEET TOTAL
 P.26 47

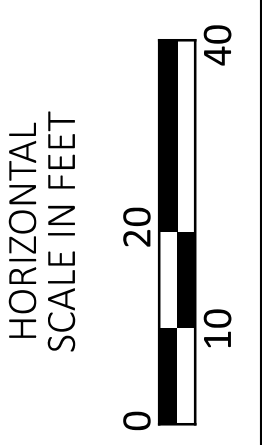
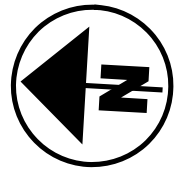
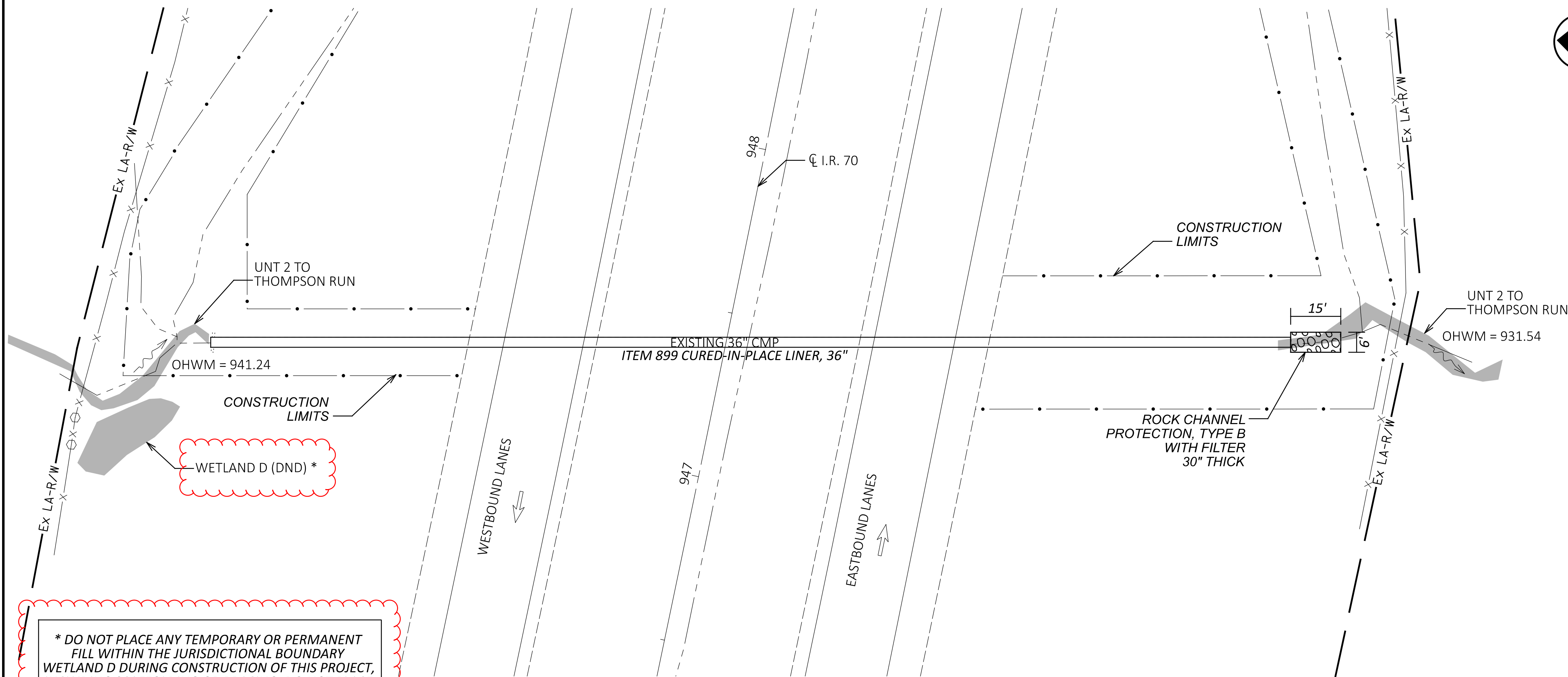

*** DO NOT PLACE ANY TEMPORARY OR PERMANENT FILL WITHIN THE JURISDICTIONAL BOUNDARY WETLAND D DURING CONSTRUCTION OF THIS PROJECT, INCLUDING SCAFFOLDING OR BRACING. DO NOT PLACE ANY EQUIPMENT OR MATERIALS WITHIN THE JURISDICTIONAL BOUNDARY OF WETLAND D.**

EXISTING STRUCTURE	
CFN: 1879309	
TYPE: CORRUGATED METAL PIPE	
DIAMETER: 36"	
LENGTH: 320'	
SKEW: 0°	
LAT: 39.947385	
LONG: -82.150787	

DRAINAGE AREA = 22 AC	
Q ₅₀ = 65 CFS	V ₅₀ = 17.0 FPS
Q ₁₀₀ = 81 CFS	V ₁₀₀ = 17.9 FPS

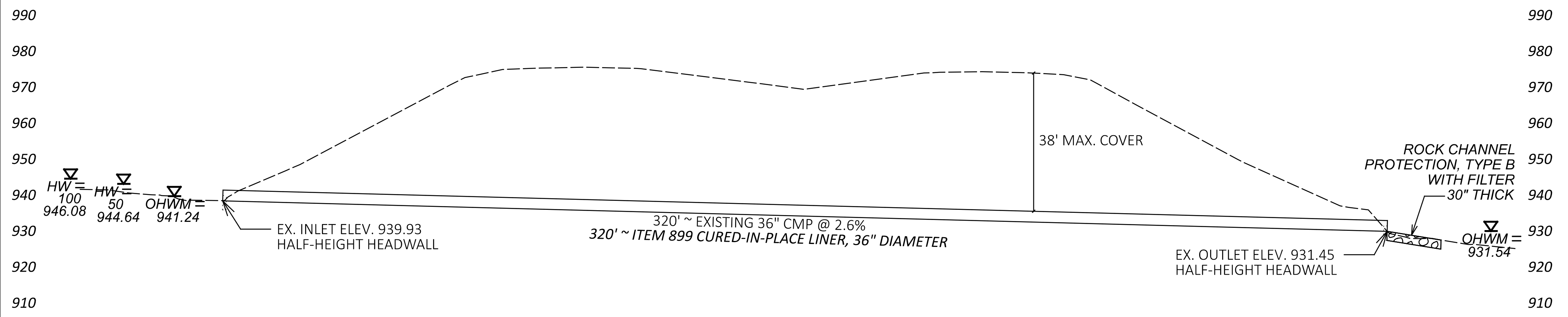

CALCULATIONS	
ITEM 601 ROCK CHANNEL PROTECTION, TYPE B WITH FILTER 15 FT X 6 FT X 2.5 FT = 225 CF / 27 CF = 8 CY	

REMOVAL MISC.: EXISTING PIPE CLEANOUT, 18" TO 108"	LS
ITEM 503 COFFERDAMS AND EXCAVATION BRACING	LS
ITEM 601 ROCK CHANNEL PROTECTION, TYPE B WITH FILTER	8 CY
ITEM 899 CURED-IN-PLACE LINER, 36" DIAMETER	320 FT

QUANTITIES CARRIED TO SUBSUMMARY

**CULVERT DETAIL SHEET (LOCATION 10)
 MUS-70-4.050 (CFN 1879309)**

DESIGN AGENCY



DESIGNER

REVIEWER

PROJECT ID

SHEET TOTAL

P.41 47